

1811

United States Department of the Interior National Park Service

National Register of Historic Places Registration Form

SEP 29 1989

NATIONAL REGISTER

This form is for use in nominating or requesting determinations of eligibility for individual properties or districts. See instructions in Guidelines for Completing National Register Forms (National Register Bulletin 16). Complete each item by marking "x" in the appropriate box or by entering the requested information. If an item does not apply to the property being documented, enter "N/A" for "not applicable." For functions, styles, materials, and areas of significance, enter only the categories and subcategories listed in the instructions. For additional space use continuation sheets (Form 10-900a). Type all entries.

1. Name of Property

historic name Callaway, Pompey, House other names/site number 60-434

2. Location

street & number north side of VA Rt. 754, 1/5 mi. east of U.S. 460 N/A not for publication city, town Elliston vicinity state Virginia code VA county Montgomery code 121 zip code 24087

3. Classification

Ownership of Property: [x] private, [] public-local, [] public-State, [] public-Federal. Category of Property: [x] building(s), [] district, [] site, [] structure, [] object. Number of Resources within Property: Contributing (1 building, 0 sites, 0 structures, 0 objects, 1 Total), Noncontributing (1 buildings, 0 sites, 0 structures, 0 objects, 1 Total). Name of related multiple property listing: Prehistoric and Historic Resources of Montgomery County. Number of contributing resources previously listed in the National Register: 0

4. State/Federal Agency Certification

As the designated authority under the National Historic Preservation Act of 1966, as amended, I hereby certify that this [x] nomination [] request for determination of eligibility meets the documentation standards for registering properties in the National Register of Historic Places and meets the procedural and professional requirements set forth in 36 CFR Part 60. In my opinion, the property [x] meets [] does not meet the National Register criteria. [] See continuation sheet. Signature of certifying official: [Signature], Date: 9/21/89, Director, Virginia Department of Historic Resources, State or Federal agency and bureau

In my opinion, the property [] meets [] does not meet the National Register criteria. [] See continuation sheet. Signature of commenting or other official: _____ Date: _____ State or Federal agency and bureau: _____

5. National Park Service Certification

I, hereby, certify that this property is: [x] entered in the National Register. [] See continuation sheet. [] determined eligible for the National Register. [] See continuation sheet. [] determined not eligible for the National Register. [] removed from the National Register. [] other, (explain:). Entered in the National Register 11/13/89. Signature of the Keeper: [Signature], Date of Action: _____

6. Function or Use

Historic Functions (enter categories from instructions)

DOMESTIC: single dwelling

Current Functions (enter categories from instructions)

DOMESTIC: single dwelling

7. Description

Architectural Classification

(enter categories from instructions)

OTHER: single-pile center-passage plan

Materials (enter categories from instructions)

foundation CONCRETE

walls BRICK

roof METAL: tin

other _____

Describe present and historic physical appearance.

The Pompey Callaway House is located in a historically black section of Elliston, which is east of the town, located along the North Fork of the Roanoke River. The brick house takes the regionally popular vernacular two-story, single-pile, center-passage form. It features many details, largely archaic by the time the house was built, which reinforce the traditional idiom used by the builder-owner. The seven-course American-bond brick house has a three-bay, symmetrical principal (south) facade with the entry door in the center equipped with sidelights and transom. The six-over-six double-hung sash windows and the door are headed with soldier course segmental arches. Basement vents (an early to mid-nineteenth-century feature typically) are segmentally arched with vertical iron bars. There are two on the front to the east of the entry and one to the west. The house is equipped with slightly projecting chimneys on each gable end. These chimneys do not actually serve fireplaces, as chimneys of similar form would have in the early to mid-nineteenth century, but only carry stove flues from each room. Another unusual, traditionally inspired feature are the four-light casement windows flanking the chimneys in each gable. The roof overhangs on all sides so that the rake boards are not flush with the end walls as would have been the case during earlier periods, and the exposed rafter ends on the front and rear are not typical of earlier, traditional buildings. A one-story, brick veneer frame ell was added by the present owners. It incorporates an enclosed porch along the west side. The front entry is sheltered by a hipped porch roof supported on modern wrought-iron members.

Inside, the house follows the simple decorative forms typical of the early twentieth century. An open-stringer stair rises conventionally in the passage. The west room on the second floor has been subdivided in recent years to create a bathroom. The window at the head of the stairs was at one time a door, indicating some sort of earlier wing or ell. The house has a full basement.

A pair of maples flank the front walk, and a modern, noncontributing garage is located to the northeast of the house. The house is in good condition, and all original features are intact.

8. Statement of Significance

Certifying official has considered the significance of this property in relation to other properties:

nationally statewide locally

Applicable National Register Criteria A B C D

Criteria Considerations (Exceptions) A B C D E F G

Areas of Significance (enter categories from instructions)
ARCHITECTURE

Period of Significance
1910

Significant Dates
1910

Cultural Affiliation
N/A

Significant Person
N/A

Architect/Builder
Pompey Callaway

State significance of property, and justify criteria, criteria considerations, and areas and periods of significance noted above.

The property is significant under criterion C as an unusual late example of a traditional form of dwelling with some features and details associating the building with earlier periods. Approximately 117 single-pile, two-story, center-passage houses were surveyed in the county that postdated 1865, and 270 from the post-1880 periods were identified in studies using a typology. Of these, no other early twentieth-century house retained the features of earlier examples to the degree that this house does. The house suggests an unusual identification with traditional forms on the part of the builder, for reasons which are not entirely clear. It is certainly one of the most substantial houses built for a black owner in Montgomery County before 1920.

Pompey Callaway was an ex-slave from Franklin County (where there is a community called Callaway). Based on local tradition, Callaway spent many years constructing the house before its completion in 1910. He had been the slave of, and tradition suggests a nephew of, a Mr. Callaway in Franklin County. He was employed as a station worker in Elliston. The house is said to have been modelled on the home of his former master.

Callaway built the house on weekends and would crush shale and clay in a "horse-mill", pack the substance in molds made by a Mr. Wells, and fire it in a kiln near the house. Water for the brickmaking was drawn from a forty-foot well nightly (Hendricks).

Minor alterations to the house have not had an impact on its significant form and detailing. The addition of a bathroom on the second floor and the construction of the ell serve to make the house a functional modern dwelling without compromising its historical features. The noncontributing garage sits well back from the house, and the ell is located to the rear of the house, and these additions do not detract from the setting.

See continuation sheet

9. Major Bibliographical References

Ellis, Billie Northcross. Interview, March 1988.

Hendricks, Mr. and Mrs. Vernon T. Interview, November 1985.

Previous documentation on file (NPS):

- preliminary determination of individual listing (36 CFR 67) has been requested
- previously listed in the National Register
- previously determined eligible by the National Register
- designated a National Historic Landmark
- recorded by Historic American Buildings Survey # _____
- recorded by Historic American Engineering Record # _____

See continuation sheet

Primary location of additional data:

- State historic preservation office
- Other State agency
- Federal agency
- Local government
- University
- Other

Specify repository:

Virginia Department of Historic Resources
221 Governor Street
Richmond, Virginia 23219

10. Geographical Data

Acreage of property Less than one acre.

UTM References

A 17 568310 4118960
 Zone Easting Northing

C _____

B _____
 Zone Easting Northing

D _____

See continuation sheet

Verbal Boundary Description

/Beginning at point A on the north side of VA Rt.754 1/5 mile east of U.S 460, proceed north 187 feet along the east side of a drive to point B, thence 140 feet east to point C, thence south 187 feet along the lot line to point D, thence 140 feet west along the north side of the road to the point of origin.

See continuation sheet

Boundary Justification

The boundaries were chosen to include the house, lawn, and domestic-related space as defined by the location of drive, property line, and road.

See continuation sheet

11. Form Prepared By

name/title Gibson Worsham

organization Gibson Worsham, Architect date January 1988

street & number Yellow Sulphur Springs, Route 2 telephone (703) 552-4730

city or town Christiansburg state Virginia zip code 24073

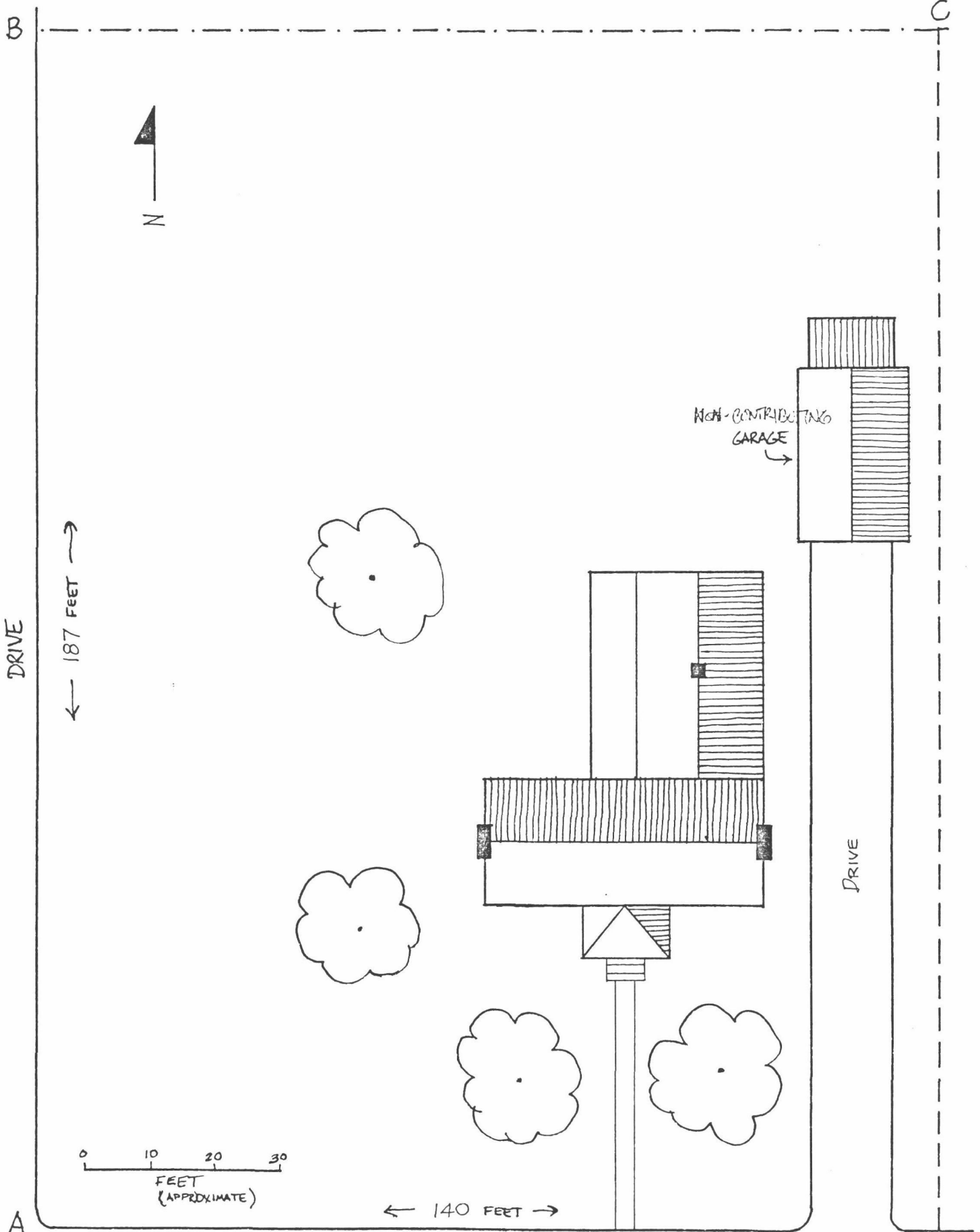

Rt. 754

D

United States Department of the Interior
National Park Service

9/29/89

National Register of Historic Places
Continuation Sheet

Section number _____ Page _____

Montgomery County MPS

VIRGINIA

Date Listed

		Date Listed
COVER	Substantive Review	11/13/89
1. Alleghany Springs Springhouse		11/13/89
2. Amiss--Palmer House		11/13/89
3. Barnett House	Substantive Review	11/13/89
4. M Barnett, William, House	Substantive Review	11/13/89
5. M Big Spring Baptist Church	Substantive Review	11/13/89
6. M Bishop House		11/13/89
7. M Blankenship Farm		11/13/89
8. Bridge over North Fork of Roanoke River	Substantive Review	1/10/91
9. M Callaway, Pompey, House		11/13/89
10. M Charlton, James, Farm	Substantive Review	11/13/89
11. M Crockett Springs Cottage		11/13/89
12. M Earhart House		11/13/89
13. M Gordon, Nealy, Farm	Substantive Review	11/13/89
14. M Grayson--Gravelly House		11/13/89
15. M Guerrant House		11/13/89
16. M Montgomery Primitive Baptist Church	Substantive Review	11/13/89
17. Kentland Farm Historic and Archeological District	Substantive Review	

UNITED STATES DEPARTMENT OF THE INTERIOR
NATIONAL PARK SERVICE

NATIONAL REGISTER OF HISTORIC PLACES
EVALUATION/RETURN SHEET

REQUESTED ACTION: NOMINATION

PROPERTY Callaway, Pompey, House
NAME:

MULTIPLE Montgomery County MPS
NAME:

STATE & COUNTY: VIRGINIA, Montgomery

DATE RECEIVED: 9/29/89 DATE OF PENDING LIST: 10/11/89
DATE OF 16TH DAY: 10/27/89 DATE OF 45TH DAY: 11/13/89
DATE OF WEEKLY LIST:

REFERENCE NUMBER: 89001811

NOMINATOR: STATE

REASONS FOR REVIEW:

APPEAL: N DATA PROBLEM: N LANDSCAPE: N LESS THAN 50 YEARS: N
OTHER: N PDIL: N PERIOD: N PROGRAM UNAPPROVED: N
REQUEST: N SAMPLE: N SLR DRAFT: N NATIONAL: N

COMMENT WAIVER: N

ACCEPT RETURN REJECT 11/13/89 DATE

Entered in the
National Register

ABSTRACT/SUMMARY COMMENTS:

RECOM./CRITERIA _____
REVIEWER _____
DISCIPLINE _____
DATE _____

DOCUMENTATION see attached comments Y/N see attached SLR Y/N

CLASSIFICATION

___ count ___ resource type

STATE/FEDERAL AGENCY CERTIFICATION

FUNCTION

___ historic ___ current

DESCRIPTION

___ architectural classification
___ materials
___ descriptive text

SIGNIFICANCE

Period Areas of Significance--Check and justify below

Specific dates Builder/Architect
Statement of Significance (in one paragraph)

- ___ summary paragraph
- ___ completeness
- ___ clarity
- ___ applicable criteria
- ___ justification of areas checked
- ___ relating significance to the resource
- ___ context
- ___ relationship of integrity to significance
- ___ justification of exception
- ___ other

BIBLIOGRAPHY

GEOGRAPHICAL DATA

___ acreage ___ verbal boundary description
___ UTMs ___ boundary justification

ACCOMPANYING DOCUMENTATION/PRESENTATION

___ sketch maps ___ USGS maps ___ photographs ___ presentation

OTHER COMMENTS

Questions concerning this nomination may be directed to

_____ Phone _____

Signed _____ Date _____



POMPEY CALLAWAY HOUSE 60-43A

ELLISTON, VIRGINIA

GIBSON WOESHAM

11/85

VIRGINIA STATE LIBRARY

VIEW FROM SOUTHEAST

Montgomery Co

Please refer to the map in the
Multiple Property Cover Sheet
for this property

Multiple Property Cover Sheet Reference Number: 64500684