

**NATIONAL REGISTER OF HISTORIC PLACES
INVENTORY - NOMINATION FORM**

(Type all entries - complete applicable sections)

STATE: Virginia	
COUNTY: Lunenburg	
FOR NPS USE ONLY	
ENTRY NUMBER	DATE
	FEB 23 1972

1. NAME

COMMON:
Lunenburg Court House Preservation Zone *Historic District*

AND/OR HISTORIC:
Lunenburg Court House Preservation Zone

2. LOCATION

STREET AND NUMBER: Boundary extending .2 mi. W of intersection of Rt. 40 and Rt. 49, extending .2 mi. N of the same intersection, extending .4 mi. E of

CITY OR TOWN: intersection of Rt. 40 (Rt. 49) and Rt. 675, and extending .4 mi. S of the same intersection

STATE Virginia	CODE 51	COUNTY: Lunenburg	CODE 111
-------------------	------------	----------------------	-------------

3. CLASSIFICATION

CATEGORY (Check One)	OWNERSHIP	STATUS	ACCESSIBLE TO THE PUBLIC
<input checked="" type="checkbox"/> District <input type="checkbox"/> Site <input type="checkbox"/> Building <input type="checkbox"/> Structure <input type="checkbox"/> Object	<input type="checkbox"/> Public <input type="checkbox"/> Private <input checked="" type="checkbox"/> Both	<input checked="" type="checkbox"/> Occupied <input type="checkbox"/> Unoccupied <input type="checkbox"/> Preservation work in progress	Yes: <input type="checkbox"/> Restricted <input checked="" type="checkbox"/> Unrestricted <input type="checkbox"/> No
PRESENT USE (Check One or More as Appropriate)			
<input type="checkbox"/> Agricultural <input type="checkbox"/> Commercial <input type="checkbox"/> Educational <input type="checkbox"/> Entertainment	<input checked="" type="checkbox"/> Government <input type="checkbox"/> Industrial <input type="checkbox"/> Military <input type="checkbox"/> Museum	<input type="checkbox"/> Park <input checked="" type="checkbox"/> Private Residence <input checked="" type="checkbox"/> Religious <input type="checkbox"/> Scientific	<input type="checkbox"/> Transportation <input type="checkbox"/> Comments <input checked="" type="checkbox"/> Other (Specify) Village

4. OWNER OF PROPERTY

OWNER'S NAME:
Various ownership - public and private

STREET AND NUMBER:

CITY OR TOWN:
Lunenburg

STATE: Virginia	CODE: 51
--------------------	-------------

5. LOCATION OF LEGAL DESCRIPTION

COURTHOUSE, REGISTRY OF DEEDS, ETC.:
Lunenburg County Court House, Clerk's Office

STREET AND NUMBER:

CITY OR TOWN:
Lunenburg

STATE: Virginia	CODE: 51
--------------------	-------------

6. REPRESENTATION IN EXISTING SURVEYS

TITLE OF SURVEY:
Historic American Buildings Survey Inventory

DATE OF SURVEY: 1958, 1969 Federal State County Local

DEPOSITORY FOR SURVEY RECORDS:
Library of Congress

STREET AND NUMBER:

CITY OR TOWN:
Washington

STATE: D. C.	CODE: 11
-----------------	-------------

SEE INSTRUCTIONS

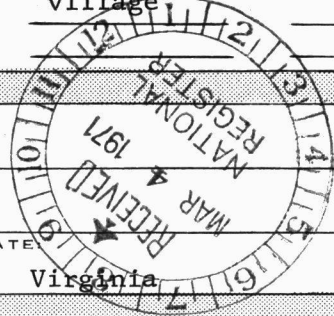

STATE: Virginia	ENTRY NUMBER FEB 23 1972	DATE
COUNTY: Lunenburg		
		FOR NPS USE ONLY

7. DESCRIPTION

CONDITION	(Check One)					
	<input type="checkbox"/> Excellent	<input checked="" type="checkbox"/> Good	<input type="checkbox"/> Fair	<input type="checkbox"/> Deteriorated	<input type="checkbox"/> Ruins	<input type="checkbox"/> Unexposed
	(Check One)			(Check One)		
	<input checked="" type="checkbox"/> Altered	<input type="checkbox"/> Unaltered	<input type="checkbox"/> Moved	<input checked="" type="checkbox"/> Original Site		

DESCRIBE THE PRESENT AND ORIGINAL (if known) PHYSICAL APPEARANCE

The small village of Lunenburg has changed little in size or appearance since ante-bellum times. The present population is still around forty. Dominating the village is the imposing court house -- a two-story, brick temple-form building fronted by a tetrastyle Roman Doric portico. As originally built, the court house was only four bays deep, but in 1939 it was extended back two additional bays to accommodate the clerk's office. The interior of the court house originally was arranged similar to other court houses of the period, having a two-story courtroom with a rear gallery. Around 1850, the courtroom was divided into two floors and the double flight of stairs leading up to the second floor was placed under the portico at that time.

To the west of the court house is a colonial style story-and-a-half brick structure built in 1938 that now houses the county office of the State Health Department. This building is one of many similar structures built at court houses throughout the State through the generosity of Mr. David K. Bruce. On the east side of the court house is a large, hipped-roofed frame house which was once a tavern known as the Lunenburg State Inn. Portions of this building were built as a residence before the town was laid out. Directly across the road from the court house is an early-nineteenth-century frame structure known as the Hotel Gary. Now in poor condition, this building has at various times accommodated a store, inn, post office, and residence. In addition to these chief structures the village also contains a sprinkling of other nineteenth-century buildings and outbuildings.

In its situation on high ground with surrounding cleared lands, the village presents a picturesque scene, especially from the south where the court house and its gleaming white pediment can be clearly seen above the smaller structures clustered about it.



SEE INSTRUCTIONS

3. SIGNIFICANCE

PERIOD (Check One or More as Appropriate)

- Pre-Columbian 16th Century 18th Century 20th Century
 15th Century 17th Century 19th Century

SPECIFIC DATE(S) (If Applicable and Known)

AREAS OF SIGNIFICANCE (Check One or More as Appropriate)

- | | | | |
|--|---|--|---|
| <input type="checkbox"/> Aboriginal | <input type="checkbox"/> Education | <input type="checkbox"/> Political | <input type="checkbox"/> Urban Planning |
| <input type="checkbox"/> Prehistoric | <input type="checkbox"/> Engineering | <input type="checkbox"/> Religion/Philosophy | <input checked="" type="checkbox"/> Other (Specify)
<u>History</u> |
| <input type="checkbox"/> Historic | <input type="checkbox"/> Industry | <input type="checkbox"/> Science | _____ |
| <input type="checkbox"/> Agriculture | <input type="checkbox"/> Invention | <input type="checkbox"/> Sculpture | _____ |
| <input checked="" type="checkbox"/> Architecture | <input type="checkbox"/> Landscape Architecture | <input type="checkbox"/> Social/Humanitarian | _____ |
| <input type="checkbox"/> Art | <input type="checkbox"/> Literature | <input type="checkbox"/> Theater | _____ |
| <input type="checkbox"/> Commerce | <input type="checkbox"/> Military | <input type="checkbox"/> Transportation | _____ |
| <input type="checkbox"/> Communications | <input type="checkbox"/> Music | | _____ |
| <input type="checkbox"/> Conservation | | | _____ |

STATEMENT OF SIGNIFICANCE

Under the authority of an act of the Lunenburg County Court of May, 1782, the location of the court house was designated to be in a "convenient place at or near the center of the county". Shortly afterwards, the exact site was selected and the plans were approved, but the two-room frame court house was not completed until 1787. Despite earlier fears that the geographical center of the county would be remote from the majority of the inhabitants, the new location of the court gained enough in importance so that in 1816 the place became an incorporated village named Lewiston in honor of Captain Lewis L. Taylor, who fell in the War of 1812. The new name did not last, however, for the village continues to be called Lunenburg Court House. Some thirty lots were laid out around the court house square and were sold off by the town's trustees.

By 1823, it was decided that the 1787 court house should be moved and replaced by a more substantial building. The citizens of Lunenburg seemed to be envious of neighboring Charlotte County's handsome new Roman Revival court house, for the commissioners appointed to supervise the construction of a new building were ordered "to advertise in the public papers that they will until the 20th day of December meet at Lunenburg Courthouse to receive proposals for building a new courthouse at this place which courthouse is proposed to be built after the plan of the new courthouse in Charlotte County". The new court house was completed by 1827, for in March of that year the Court was ordered to "hold its sitting therein".

Unfortunately neither the designer nor the builders of the court house were recorded, but the academic quality of the building's classical proportions and detail clearly indicates that the designer was knowledgeable in architecture and was familiar with Thomas Jefferson's Roman Revivalism. One of the handsomest of Virginia's numerous Roman-style court houses, the temple-form Lunenburg Court House stands as visible evidence of Jefferson's influence on the architecture of the State's public buildings. The architectural quality of the court house is much enhanced by the maintenance of its historic setting. The conservative growth of the village of Lunenburg has resulted in the preservation of one of Virginia's most picturesque court house communities. The court house still visually dominates the tiny community and the surrounding countryside as it has for nearly a century and a half.



SEE INSTRUCTIONS

9. MAJOR BIBLIOGRAPHICAL REFERENCES

Bell, Landon C. The Old Free State, 2 vols. Richmond: The William Byrd Press, Inc., 1927.
 Lunenburg County Order Book 24, 1821-1823, p. 408.
 Whiffen, Marcus. "The Early County Courthouses of Virginia." Journal of Society of Architectural Historians. Vol. XVIII, No. 1, March 1959.

10. GEOGRAPHICAL DATA

LATITUDE AND LONGITUDE COORDINATES DEFINING A RECTANGLE LOCATING THE PROPERTY				OR	LATITUDE AND LONGITUDE COORDINATES DEFINING THE CENTER POINT OF A PROPERTY OF LESS THAN TEN ACRES					
CORNER	LATITUDE		LONGITUDE		LATITUDE		LONGITUDE			
	Degrees	Minutes	Seconds	Degrees	Minutes	Seconds		Degrees	Minutes	Seconds
NW	36°	57'	49"	78°	16'	21"				
NE	36°	57'	49"	78°	15'	39"				
SE	36°	57'	23"	78°	15'	39"				
SW	36°	57'	23"	78°	16'	21"				

APPROXIMATE ACREAGE OF NOMINATED PROPERTY: **140 acres**

LIST ALL STATES AND COUNTIES FOR PROPERTIES OVERLAPPING STATE OR COUNTY BOUNDARIES

STATE:	CODE	COUNTY	CODE

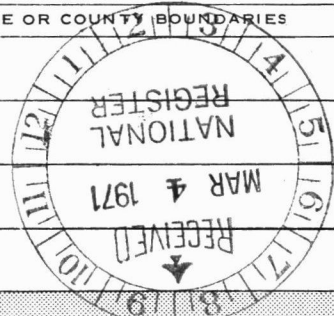

11. FORM PREPARED BY

NAME AND TITLE:
Staff, Virginia Historic Landmarks Commission, James W. Moody, Jr., Director

ORGANIZATION: **Virginia Historic Landmarks Commission** DATE: **December 16, 1970**

STREET AND NUMBER:
Room 1116, Ninth Street Office Building

CITY OR TOWN: **Richmond** STATE: **Virginia** CODE: **51**

12. STATE LIAISON OFFICER CERTIFICATION **NATIONAL REGISTER VERIFICATION**

As the designated State Liaison Officer for the National Historic Preservation Act of 1966 (Public Law 89-665), I hereby nominate this property for inclusion in the National Register and certify that it has been evaluated according to the criteria and procedures set forth by the National Park Service. The recommended level of significance of this nomination is:

National State Local

Name: **Dr. Edward P. Alexander**
 Title: **Chairman, Virginia Historic Landmarks Commission**
 Date: **3/2/71**

I hereby certify that this property is included in the National Register.

Ernest A. Connolly
 Chief, Office of Archeology and Historic Preservation

FEB 23 1972

Date: _____

ATTEST:
Madford
 Secretary of The National Register
 Date: **Jan. 10, 1972**

SEE INSTRUCTIONS
 17-8-75
 17-743880/4093340
 17-742810/4094100
 17-742810/4093300

Lunenburg Court House
 Preservation Zone
 Lunenburg
 Va.

RECEIPT

PROPERTY

STATE

Va.

REGISTER NUMBER

DATE OF RECEIPT

3/4/71

YES

NO

NUMBER

FEB 23 1972

DATA PAGE

PHOTO (S)

PHOTO DESCRIP (S)

MAP (S)

MAP DESCRIPTION (S)

LOGGED

ACKNOWLEDGE

3/5/71

RESUBMIT

72001509

REVIEW

(Rate drafted response to Mad's letter already) OK Guess
 was going to return for mail photos, more recent one, and
 street map, but Dr. Mustak's suggesting nature
 turn in light of letter attached. See his note

5 March
8/10/71

3/16/71

HISTORIAN

Looks okay in the brain of what is here.

Subs 10/25/71

ARCHAEOLOGIST

OK meany
11/1/71

ARCHITECT

Yajo warrants entry as a r.p. and is so unspoiled as they say, but I really
 resent our having to make a judgment of a district with only 1 photo of one bldg. OK

Chambas
9-9-71

ASST. KEEPER

OK Bradford for
1/10/72

KEEPER

ENTRY

CHIEF, OAHF

ell
2-23

EDITORIAL PROCESSING, EDITOR

HABS

We'll need boundaries, and some verbal
 description of the other bldgs. would be
 good to have.

CD etc
8/30/71

Federal Register Entry

4-4-72

Annual Edition Entry

FEB 23 1972

Logged

Card

FEB 23 1972

WORKING NUMBER

3.4.71.9

COMMENTS



Returned -
 - more photo, more
 recent to either
 - close up map
 - justify other
 bldgs. in #8.

1

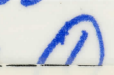

NPS Number 2,23.72
 Title: Lunenburg City, Va
View from South 

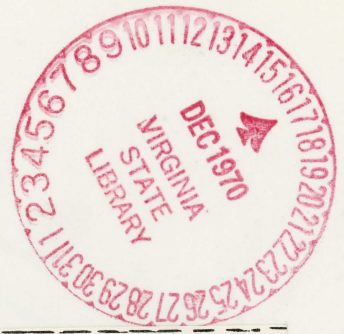

SEE INSTRUCTIONS

UNITED STATES DEPARTMENT OF THE INTERIOR
 NATIONAL PARK SERVICE

NATIONAL REGISTER OF HISTORIC PLACES
PROPERTY PHOTOGRAPH FORM

(Type all entries - attach to or enclose with photograph)

STATE Virginia	
COUNTY Lunenburg	
FOR NPS USE ONLY	
ENTRY NUMBER FEB 23 1972	DATE

1. NAME			
COMMON: Lunenburg Court House Preservation Zone			
AND/OR HISTORIC: Lunenburg Court House Preservation Zone			
2. LOCATION			
STREET AND NUMBER: Boundary extending .2 mi. W of intersection of Rt. 40 and Rt. 49, extending .2 mi. N of the same intersection, extending .4 mi. E of			
CITY OR TOWN: intersection of Rt. 40 (Rt. 49) and Rt. 675, and extending .4 mi. S of the same intersection			
STATE: Virginia	CODE 51	COUNTY: Lunenburg	CODE 111
3. PHOTO REFERENCE			
PHOTO CREDIT: Virginia State Library			
DATE OF PHOTO: 1937			
NEGATIVE FILED AT: Virginia State Library Richmond, Virginia			
4. IDENTIFICATION			
DESCRIBE VIEW, DIRECTION, ETC.			
View from the south.			

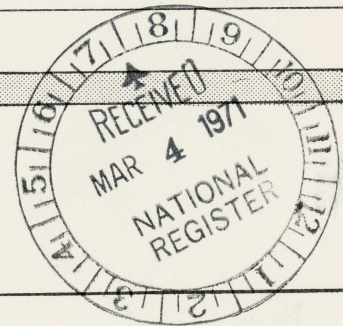

Lunenburg Court House

**NATIONAL REGISTER OF HISTORIC PLACES
PROPERTY MAP FORM**

(Type all entries - attach to or enclose with map)

STATE Virginia	
COUNTY Lunenburg	
FOR NPS USE ONLY	
ENTRY NUMBER FEB 23 1972	DATE

SEE INSTRUCTIONS

1. NAME

COMMON: Lunenburg Court House Preservation Zone

AND/OR HISTORIC: Lunenburg Court House Preservation Zone

2. LOCATION

STREET AND NUMBER: Boundary extending .2 mi. W of intersection of Rt. 40 and Rt. 49, extending .2 mi. N of the same intersection, extending .4 mi. E of

CITY OR TOWN: intersection of Rt. 40 (Rt. 49) and Rt. 675, and extending .4 mi. S of the intersection.

STATE: Virginia	CODE 51	COUNTY: Lunenburg	CODE III
--------------------	------------	----------------------	-------------

3. MAP REFERENCE

SOURCE:
U.S.G.S. 7½', quadrangle, Lunenburg, Va.

SCALE: 1:24000

DATE: 1966

4. REQUIREMENTS

TO BE INCLUDED ON ALL MAPS

1. Property boundaries where required.
2. North arrow.
3. Latitude and longitude reference.

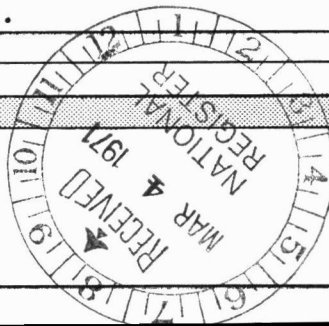

5358' N. E. 1.8 S. 5358' N. N.Y. (FORT MITCHELL)
KEYSVILLE 7 MI.
CHASE CITY 8 MI.
CHASE CITY 5.5 MI.
CHASE CITY 5.5 MI.

UNITED STATES
DEPARTMENT OF THE INTERIOR
GEOLOGICAL SURVEY

COMMONWEALTH OF VIRGINIA
DIVISION OF MINERAL RESOURCES
JAMES L. CALVER, STATE GEOLOGIST

LUNENBURG QUADRANGLE
VIRGINIA—LUNENBURG CO.
7.5 MINUTE SERIES (TOPOGRAPHIC)
NE/4 CHASE CITY 15 QUADRANGLE

LUNENBURG COURT HOUSE HISTORIC DISTRICT
J.M. R.C.
11-1-75 W.N.
A 17743870
4094100
B 17743880
4093340
C 17743890
4093300
D 17743900
4094010



Mapped, edited, and published by the Geological Survey
Control by USGS and USC&GS
Topography by photogrammetric methods from aerial
photographs taken 1964. Field checked 1966.
Polyconic projection. 1927 North American datum
10,000-foot grid based on Virginia coordinate system, south zone
1000-meter Universal Transverse Mercator grid ticks,
zone 17, shown in blue
Fine red dashed lines indicate selected fence and field lines where
generally visible on aerial photographs. This information is unchecked

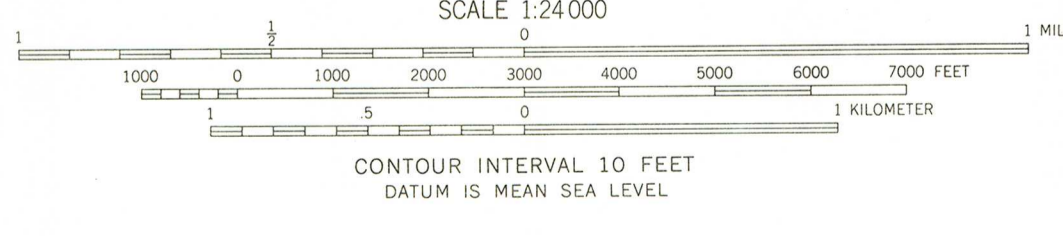
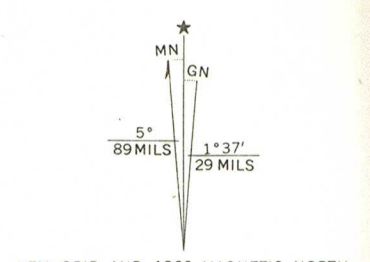

ROAD CLASSIFICATION
Medium-duty ——— Light-duty ———
Unimproved dirt - - - - -
State Route ○

THIS MAP COMPLIES WITH NATIONAL MAP ACCURACY STANDARDS
FOR SALE BY U.S. GEOLOGICAL SURVEY, WASHINGTON, D.C. 20242
AND VIRGINIA DIVISION OF MINERAL RESOURCES, CHARLOTTESVILLE, VIRGINIA 22903
A FOLDER DESCRIBING TOPOGRAPHIC MAPS AND SYMBOLS IS AVAILABLE ON REQUEST

LUNENBURG, VA.
NE/4 CHASE CITY 15 QUADRANGLE
N3652.5-W7815/7.5
1966
AMS 5357 IV NE—SERIES V834

U.S.G.S. 7½' quadrangle (Scale:1:24,000)
Lunenburg, Va. 1966

LUNENBURG COURT HOUSE PRESERVATION ZONE

Latitude	Longitude
NW 36° 57'49"	78° 16' 21"
NE 36° 57'49"	78° 15' 39"
SE 36° 57'23"	78° 15' 39"
SW 36° 57'23"	78° 16' 21"

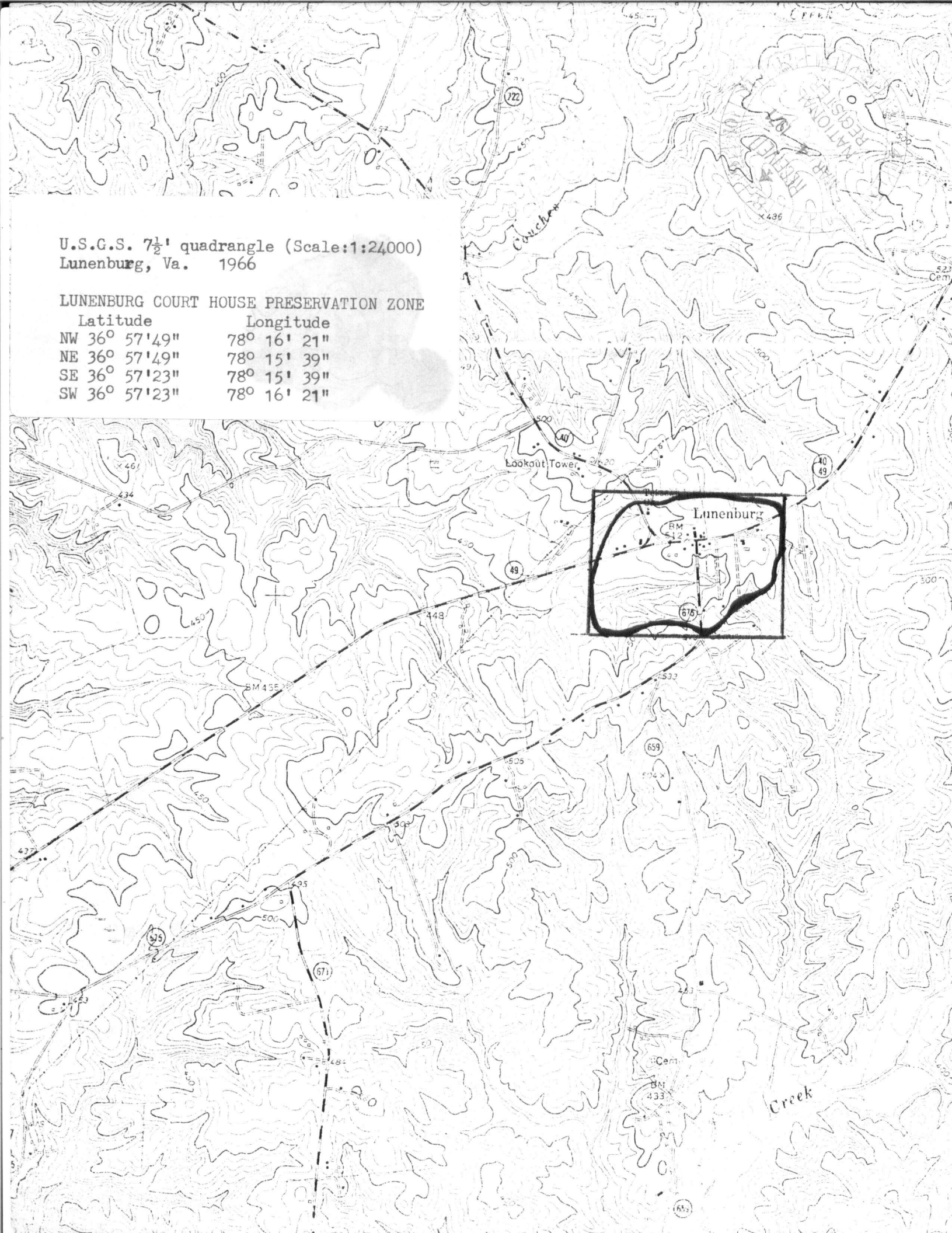

ENTRIES IN THE NATIONAL REGISTER

STATE VIRGINIA

Date Entered FEB 23 1972

<u>Name</u>	<u>Location</u>
The Glebe	Arlington County
Welbourne	Middlebury vicinity Louisa County
Lunenburg Court House Preservation Zone	Lunenburg County
Herbert House	Hampton
Castle Hill	Cissant vicinity Albemarle County
Barrett House	Richmond
Howard's Neck	Pemberton vicinity Goochland County
Beverley Mill	Plains vicinity Prince William County
Confederate Memorial Chapel	Richmond
Broad Street Station	Richmond
Crozet House	Richmond
Sears House	Staunton

Also Notified

Hon. Harry F. Byrd, Jr.
Hon. William B. Spong, Jr.
Hon. Joel T. Proynill
Hon. William L. Scott
Hon. Watkins M. Albitt
Hon. Thomas N. Downing
Hon. J. Kenneth Robinson
Hon. David E. Satterfield, III

State Liaison Officer
Mr. James W. Moody, Jr.
Chairman
Virginia Historic Landmarks Commission
State Ninth Street Office Building -
Room 1106
Richmond, Virginia 23219

Director, Southeast Region

2/15/72

HR
NRowland:mm

COMMONWEALTH OF VIRGINIA



MEMBERS

STANLEY W. ABBOTT
EDWARD P. ALEXANDER
MRS. BENJAMIN P. ALSOP
RANDOLPH W. CHURCH
FREDERICK HERMAN
JOHN M. JENNINGS
FREDERICK D. NICHOLS
WILLIAM R. SEWARD
MARVIN M. SUTHERLAND

VIRGINIA HISTORIC LANDMARKS COMMISSION

ROOM 1116
NINTH STREET STATE OFFICE BUILDING
RICHMOND, VIRGINIA 23219
TELEPHONE: 770-3143

OFFICERS

EDWARD P. ALEXANDER, CHAIRMAN
COLONIAL WILLIAMSBURG
WILLIAMSBURG, VIRGINIA 23185

JOHN M. JENNINGS, VICE CHAIRMAN
VIRGINIA HISTORICAL SOCIETY
RICHMOND, VIRGINIA 23221

JAMES W. MOODY, JR.
EXECUTIVE DIRECTOR

March 3, 1971

Dr. William J. Murtagh
Keeper of the National Register
Office of Archeology and Historic
Preservation
National Park Service
801-19th Street, N. W.
Washington, D. C. 20006

Dear Dr. Murtagh:

Today we are sending the following eleven submissions to the National Register of Historic Places: Belle Isle, Lancaster County; Christ Church Glendower, Albemarle County; Fluvanna County Court House Preservation District, Fluvanna County; Fort Chiswell Mansion, Wythe County; Fredericksburg Preservation District; Hebron Lutheran Church, Madison County; Hillsborough, King and Queen County; Lexington Preservation District, Rockbridge County; Lunenburg Court House Preservation Zone, Lunenburg County; Ripshin, Grayson County; and St. Paul's Church, Norfolk.

Sincerely,

Eleanor Lane

(Miss) Eleanor Lane
Researcher

EL:jt

Enclosures

