

**United States Department of the Interior
Heritage Conservation and Recreation Service**

**National Register of Historic Places
Inventory—Nomination Form**

See instructions in *How to Complete National Register Forms*
Type all entries—complete applicable sections

For HCERS use only

received

MAR 19 1982

date entered

APR 15 1982

1. Name

historic Cedar Lane

and/or common Fountain House

2. Location

N of Tarboro off NC 44

street & number East side NC 44,
0.35 mile South of NC 97 not for publication

city, town ~~Leggett~~ *Tarboro vic.* vicinity of congressional district Second

state North Carolina code 037 county Edgecombe code 065

3. Classification

Category	Ownership	Status	Present Use
<input type="checkbox"/> district	<input type="checkbox"/> public	<input checked="" type="checkbox"/> occupied	<input type="checkbox"/> agriculture
<input checked="" type="checkbox"/> building(s)	<input checked="" type="checkbox"/> private	<input type="checkbox"/> unoccupied	<input type="checkbox"/> commercial
<input type="checkbox"/> structure	<input type="checkbox"/> both	<input type="checkbox"/> work in progress	<input type="checkbox"/> educational
<input type="checkbox"/> site	Public Acquisition	Accessible	<input type="checkbox"/> entertainment
<input type="checkbox"/> object	<input type="checkbox"/> in process N/A	<input checked="" type="checkbox"/> yes: restricted	<input type="checkbox"/> government
	<input type="checkbox"/> being considered	<input type="checkbox"/> yes: unrestricted	<input type="checkbox"/> industrial
		<input type="checkbox"/> no	<input type="checkbox"/> military
			<input type="checkbox"/> museum
			<input type="checkbox"/> park
			<input checked="" type="checkbox"/> private residence
			<input type="checkbox"/> religious
			<input type="checkbox"/> scientific
			<input type="checkbox"/> transportation
			<input type="checkbox"/> other:

4. Owner of Property

name Mrs. Lula Fountain Goodwyn

street & number Duke Circle

city, town Rocky Mount vicinity of state North Carolina 27801

5. Location of Legal Description

courthouse, registry of deeds, etc. Edgecombe County Courthouse

street & number

city, town Tarboro state North Carolina 27886

6. Representation in Existing Surveys

title Architectural and Historic Resources of the
Tar-Neuse River Basin has this property been determined eligible? yes no

date 1977 federal state county local

depository for survey records Survey and Planning Branch, Division of Archives and History

city, town Raleigh state North Carolina 27611

7. Description

Condition		Check one	Check one
<input type="checkbox"/> excellent	<input type="checkbox"/> deteriorated	<input checked="" type="checkbox"/> unaltered	<input checked="" type="checkbox"/> original site
<input checked="" type="checkbox"/> good	<input type="checkbox"/> ruins	<input type="checkbox"/> altered	<input type="checkbox"/> moved date _____
<input type="checkbox"/> fair	<input type="checkbox"/> unexposed		

Describe the present and original (if known) physical appearance

Set at the end of a long lane flanked with old cedars and facing west, Cedar Lane is representative of a type and kind of vernacular Greek Revival house which helped to create the image of the successful antebellum agricultural complex. The two-story, frame house is double-pile, three bays wide and has a hip roof. A one-story porch stretches across its facade. A pair of interior chimneys interrupt the low pitched standing seam tin roof which replaced the original wood shingle roof (see documentary photo). This change and the replacement of the original porch steps seem to be the only alterations wrought by time.

The chief impact of the house is one of horizontality and attachment to the land. The single story porch rests on four square posts with abstracted capitals which support a plain architrave. Pilasters at the back corners of the porch echo the simplicity of the box cornice and deep unadorned entablature at the roof-line. The wide, unbeaded siding neatly joins the single molded and mitered window frames with six-over-six sash. Operable shutters flank each window.

The simplicity and neatness of the exterior is repeated on the interior. The wide central hall which bisects the house front to back is entered from the porch through a four panelled door with flat transom and side lights. The stairs rise on the south wall of the hall and have plain square balusters, newel and turned rail. The front hall ceiling is centered with a simple rosette. Other details of the hall--picture rail approximately two feet from the ten foot ceiling, deep shoe and toe moldings and the triple molded door frames--are repeated throughout the house. Interior doors which open into the hall are two panelled with a triple bead around the panels.

In all the rooms fireplaces are centered on the interior walls, placed back to back. This is repeated in the four bedrooms above. In the parlor recessed panels under the windows complement the fireplace surrounds which consist of flat panelled pilasters supporting a deep, plain entablature and simple molded shelf. In the dining room glass doors enclose shelf space in a niche to the left of the fireplace. The plaster on lathe walls and the wide boarded floors contribute to a sense of permanence and simplicity. The major change in the house consists of the attachment of the original kitchen to the rear of the house by a passage and screened porch.

A number of dependencies surround the house and date approximately from the time of its building. Like the house they are of heavy wood frame and weatherboarded. Standing seam tin roofs have replaced shingles. To the west is a cook's house--a single room with attached porch and exterior end chimney. Behind the house is a dairy and electric plant, a smokehouse, tool shed and barn. Located to the right of the entry road is the carriage house.

The consistent quality, scale and detail of the ensemble give it a remarkable unity and create a sense of the life of such a complex, an important aspect of the history of eastern North Carolina.

8. Significance

Period	Areas of Significance—Check and justify below			
<input type="checkbox"/> prehistoric	<input type="checkbox"/> archeology-prehistoric	<input type="checkbox"/> community planning	<input type="checkbox"/> landscape architecture	<input type="checkbox"/> religion
<input type="checkbox"/> 1400–1499	<input type="checkbox"/> archeology-historic	<input type="checkbox"/> conservation	<input type="checkbox"/> law	<input type="checkbox"/> science
<input type="checkbox"/> 1500–1599	<input type="checkbox"/> agriculture	<input type="checkbox"/> economics	<input type="checkbox"/> literature	<input type="checkbox"/> sculpture
<input type="checkbox"/> 1600–1699	<input checked="" type="checkbox"/> architecture	<input type="checkbox"/> education	<input type="checkbox"/> military	<input type="checkbox"/> social/ humanitarian
<input type="checkbox"/> 1700–1799	<input type="checkbox"/> art	<input type="checkbox"/> engineering	<input type="checkbox"/> music	<input type="checkbox"/> theater
<input checked="" type="checkbox"/> 1800–1899	<input type="checkbox"/> commerce	<input type="checkbox"/> exploration/settlement	<input type="checkbox"/> philosophy	<input type="checkbox"/> transportation
<input type="checkbox"/> 1900–	<input type="checkbox"/> communications	<input type="checkbox"/> industry	<input checked="" type="checkbox"/> politics/government	<input type="checkbox"/> other (specify)
		<input type="checkbox"/> invention		

Specific dates	Builder/Architect
n/a	unknown

Statement of Significance (in one paragraph)

Built in the late 1840s for James D. Savage, Cedar Lane was the seat of a modestly prosperous Edgecombe County plantation before and after the Civil War. A substantial, yet simple Greek Revival style farmhouse with contemporary outbuildings, the house has remained unchanged and is an excellent representative of the house type found on medium size agricultural complexes throughout eastern North Carolina. Purchased by Almon Fountain, the house was the childhood home of his nine children--all of whom became civic leaders active in the political, business, church and social life of the county, including Richard Tilman Fountain (1885–1945) who was elected lieutenant governor in the O. Max Gardner administration (1929–1933).

Criteria Assessment:

- A. As a moderate sized plantation before and after the Civil War, Cedar Lane is a part of the broad pattern of economic development in eastern North Carolina--an agriculturally rich area where both large and small farmers have been able to prosper.
- B. Cedar Lane is chiefly associated with the Almon Fountain family which produced local civic leaders as well as a North Carolina lieutenant governor (1929–1933), Richard Tilman Fountain.
- C. The plantation house with its complex of outbuildings is a representative example of vernacular Greek Revival architecture and with its substantial and straight-forward design typifies the antebellum house found on medium size farms throughout eastern North Carolina.
- D. A working farm which has undergone very few changes since the 1840s, Cedar Lane is likely to yield information about nineteenth and early twentieth century farm-life in rural Edgecombe County.

9. Major Bibliographical References

See continuation sheet.

10. Geographical Data

Acreeage of nominated property 46.1

ACREAGE NOT VERIFIED

Quadrangle name Tarboro

Quadrangle scale 1:62500

UMT References

UTM NOT VERIFIED

A

1	8	3	5	5	9	0	9	7	7	3	0	4	4	1
Zone		Easting						Northing						

B

1	8	3	5	5	9	0	16	7	7	3	0	4	15	1
Zone		Easting						Northing						

C

1	8	3	5	5	9	0	14	7	7	3	0	0	17	1
Zone		Easting						Northing						

D

1	8	3	5	5	9	0	13	7	7	3	0	4	18	1
Zone		Easting						Northing						

E

1	8	3	5	5	9	0	11	7	7	3	0	4	4	1
Zone		Easting						Northing						

F

Zone		Easting						Northing						

G

Zone		Easting						Northing						

H

Zone		Easting						Northing						

Verbal boundary description and justification

See Edgecombe County Tax Map, Book 1, page 21, outlined in red.

List all states and counties for properties overlapping state or county boundaries

state N/A code county N/A code

state code county code

11. Form Prepared By

name/title Charlotte V. Brown, Architectural Historian
Jim Sumner, Researcher

organization Survey & Planning Branch
Archeology & Historic Preservation Section date September, 1981

Division of Archives & History
street & number 109 East Jones Street telephone (919) 733-6545

city or town Raleigh state North Carolina 27611

12. State Historic Preservation Officer Certification

The evaluated significance of this property within the state is:

national state local

As the designated State Historic Preservation Officer for the National Historic Preservation Act of 1966 (Public Law 89-665), I hereby nominate this property for inclusion in the National Register and certify that it has been evaluated according to the criteria and procedures set forth by the Heritage Conservation and Recreation Service.

State Historic Preservation Officer signature William S. Paiv, Jr.

title State Historic Preservation Officer date February 16, 1982

For HCRS use only
I hereby certify that this property is included in the National Register
Entered in the National Register
date 4/15/82
for Alonzo Byers
Keeper of the National Register
Attest: _____ date _____
Chief of Registration

**United States Department of the Interior
Heritage Conservation and Recreation Service**

**National Register of Historic Places
Inventory—Nomination Form**

For HCERS use only

received

MAR 18 1982

date entered

Continuation sheet HISTORICAL SIGNIFICANCE Item number 8 Page 1

Cedar Lane is one of northern Edgecombe County's finest antebellum houses. Built in the late 1840s the house has been associated with a number of eastern North Carolina's most important twentieth century political figures.

In 1847 James D. Savage purchased 445 acres from Joshua Thomas Lawrence for \$1,800.¹ Local tradition maintains that Lawrence then built the house for his daughter Phoebe Ann, who had recently wed Savage. She died a short time after this marriage and in 1853 Savage married Jane Johnston, daughter of Aaron Johnston.² Savage was a successful farmer. The 1860 census shows that he had 228 acres under cultivation. His land was valued at \$14,000 while his livestock was valued at \$2,400. He grew 2,000 bushels of corn, 12 tons of hay, and 114 bales of cotton. He owned 24 slaves.³ Edgecombe County had one of antebellum North Carolina's most successful plantation economies and plantations with 100 or more slaves were not uncommon. Seen in this context Savage's agricultural holdings were not extraordinarily large.

Savage died sometime in the late 1860s. By 1880 Cedar Lane had been purchased by Almon Fountain.⁴ Almon Fountain, son of Loderick and Priscilla Fountain, was born in 1842 near Tarboro. He served in the Thirtieth North Carolina Infantry during the Civil War. He was captured at the Battle of Kelly's Ford in Virginia in 1863 and spent the remainder of the war in Point Lookout Federal prison. In 1870 he married Sarah Louisa Eagles, and the next year they had the first of their eleven children. They were Charles, 1871; Margaret, 1874; Arthur, 1876; Robert, 1878; Walter, 1881; Richard Tillman, 1885; Annie, 1886; Mary Lillian, 1888; Fannie, 1891; Lula, 1893; and Benjamin Eagles, 1897. Annie and Fannie died in infancy, while the other nine Fountain children were all civic leaders, active in politics, business, church, and social life.⁵

Richard Tillman Fountain (1885-1945) was educated at the public schools of Edgecombe County and also at Tarboro Male Academy. He obtained his law degree from the University of North Carolina in 1907 and passed the bar examination the same year. He began practicing law with his cousin G. M. T. Fountain in Rocky Mount. He continued this association until 1923 when G. M. T. Fountain died. Richard Fountain then went into practice with his brother Benjamin. In 1911 he was appointed judge of the first Municipal Court in Rocky Mount. He served in that capacity until 1918, when he was elected to the State Legislature as a Democrat. He was re-elected in 1920, 1922, 1924, and 1926. In all these elections Fountain ran unopposed, both in the primaries and in the general elections. He was elected speaker of the House in the 1927 session. Fountain was chairman of the Judiciary committee in 1925 and was a tireless advocate of education. He authored the bill that created the Eastern Carolina Industrial Training School for Boys, located in Rocky Mount. The school was later renamed the Richard T. Fountain School.⁶

In the fall of 1928 Fountain was elected lieutenant governor for the O. Max Gardner administration and served in that post from 1929 until 1933. Fountain ran for governor in 1932 and for United States senator in 1936. The former year he was defeated for the Democratic nomination by J. C. B. Ehringhaus in a close race, while in the latter year he lost the Democratic nomination to Josiah Bailey. He then retired from politics. Fountain was a trustee of the University of North Carolina, served as vice president of the North Carolina Bar Association in 1922 and 1923, was chairman of the State Board of Equalization, was active in the North Carolina Park Commission, and was active in a number of civic, church, and fraternal organizations.⁷

**United States Department of the Interior
Heritage Conservation and Recreation Service**

**National Register of Historic Places
Inventory—Nomination Form**

For HCRS use only

received

MARR 19 1982

date entered

Continuation sheet HISTORICAL SIGNIFICANCE Item number 8 Page 2

Benjamin Fountain (1897-1969) was also born and raised at Cedar Lane. He was educated at the University of North Carolina. He served in the General Assembly in 1943, 1945, 1947, 1949, 1951, 1953, and 1955, as a Democrat. Afterwards, he served the city of Rocky Mount as an alderman. Like his brother, Benjamin Fountain was interested in education and was a trustee of the Rocky Mount City Schools, and the Consolidated University of North Carolina. He was government appeal agent for the Local Draft Board from 1940 to 1942. He was also active in a number of civic organizations.⁸

Charles, Arthur, Robert, and Walter Fountain were all merchants and farmers in eastern North Carolina. Arthur Fountain was president of the Coastal Plain Agricultural Fair Association and was a member of the Highway Commission. Mary Fountain married Joshua Thomas Lawrence, a Leggett merchant. Margaret married Thomas Franklin Savage, while Lula Agnes married William L. Goodwyn. It is the latter two families that occupied Cedar Lane until recently.⁹

Thomas Savage lived at Cedar Lane until the death of Mrs. Savage in the middle 1930s. She left the land and house to her sister Lula Goodwyn who moved back into her ancestral home in 1935.¹⁰ Her husband was a merchant in the Leggett area. Mrs. Goodwyn was educated at East Carolina Teachers College (now a university) in Greenville and taught in the public schools prior to her 1922 marriage. She has been active in a number of historical organizations in the area, including the Daughters of the American Revolution, the United Daughters of the Confederacy, the Edgecombe County Historical Society, the Daughters of American Colonists, the North Carolina Historical Association, and numerous others. Like other members of her family Mrs. Goodwyn has actively promoted the cause of education in Edgecombe County, and has been active in the Presbyterian Church. The Goodwyns had three sons. William L. Goodwyn, Jr. is a Rocky Mount businessman, Arthur Fountain Goodwyn is retired from the United States Air Force and works for the Edgecombe County School system as Director of Buildings and Grounds, while George Goodwyn is an attorney.¹¹

William L. Goodwyn died in 1972. Mrs. Goodwyn moved to an apartment in Rocky Mount, where she still lives. The house has been rented since then. It is still in fine condition, and due to its long association with a family important to eastern North Carolina in so many ways, Cedar Lane has substantial historic importance to the area.

The structures of course are closely related to the surrounding environment. Archeological remains, such as trash pits, wells, and structural remains, which may by present, can provide information valuable to the understanding and interpretation of the structures. Information concerning use patterns, social standing and mobility, as well as structural details are often only evident in the archeological record. Therefore, archeological remains may well be an important component of the significance of the structure. At this time no investigation has been done to discover these remains, but it is probable that they exist, and this should be considered in any development of the property.

United States Department of the Interior
Heritage Conservation and Recreation Service

National Register of Historic Places
Inventory—Nomination Form

For HCRS use only

received

MAR 18 1982

date entered

Continuation sheet HISTORICAL SIGNIFICANCE Item number 8

Page 3

FOOTNOTES

¹ Edgecombe County Deed Book 24, p. 516.

² Ruth Smith Williams, "Brochure on Cedar Lane," Unpublished manuscript, copy in files, Survey and Planning Branch, Archaeology and Historic Preservation Section, Division of Archives and History, Raleigh, hereinafter cited as Williams, "Cedar Lane"; Rocky Mount Telegram, September 11, 1955.

³ Eighth Census of the United States, 1860, Edgecombe County, North Carolina, Agricultural Schedule.

⁴ The exact date of Fountain's purchase of the property is unknown as the deed appears to have been lost.

⁵ Rocky Mount Telegram, September 11, 1955; Weymouth T. Jordan, Jr. (compiler), North Carolina Troops 1861-1865: A Roster (Raleigh: Division of Archives and History, 7 volumes, 1966-1979), IV, 336; R. D. W. Connor and others, North Carolina: Rebuilding an Ancient Commonwealth (Chicago and New York: The American Historical Society, Inc., 4 volumes, 1929), III, 107-109, hereinafter cited as Connor, North Carolina; Williams, "Cedar Lane."

⁶ Connor, North Carolina, III, 107-109; News and Observer (Raleigh), February 22, 1945; William S. Powell, North Carolina Lives: The Tar Heel Who's Who (Hopkinsville, Kentucky: Historical Press Association, 1962), 450, hereinafter cited as Powell, North Carolina Lives.

⁷ Connor, North Carolina, III, 107-109; News and Observer (Raleigh), February 22, 1945; Powell, North Carolina Lives, 450.

⁸ Powell, North Carolina Lives, 449; News and Observer (Raleigh), February 2, 1969.

⁹ Powell, North Carolina Lives, 496-498; Williams, "Cedar Lane"; Rocky Mount Telegram, September 11, 1955.

¹⁰ Edgecombe County Will Book I, p. 165; Edgecombe County Estates Papers, Almon Fountain; Powell, North Carolina Lives, 496-498; Williams, "Cedar Lane."

¹¹ Powell, North Carolina Lives, 496-498; Williams, "Cedar Lane"; Rocky Mount Telegram, September 11, 1955.

United States Department of the Interior
Heritage Conservation and Recreation Service
National Register of Historic Places
Inventory—Nomination Form

For HCERS use only

received **MAR 18 1982**

date entered

Continuation sheet

BIBLIOGRAPHY

Item number 9

Page 1

- Connor, R. D. W. and others. North Carolina: Rebuilding an Ancient Commonwealth. Chicago and New York: The American Historical Society, Inc., 4 volumes, 1929.
- Edgecombe County Records. Deed Books, Will Books (microfilm copies), Estates Papers. Raleigh: Division of Archives and History.
- Jordan, Weymouth T., Jr. (Compiler). North Carolina Troops, 1861-1865: A Roster. Raleigh: Division of Archives and History, 7 volumes, 1966-1979.
- News and Observer (Raleigh). February 22, 1945. February 2, 1969.
- Powell, William S. North Carolina Lives: A Tar Heel Who's Who. Hopkinsville, Kentucky: Historical Press Association, 1962.
- Rocky Mount Telegram. September 11, 1955.
- United States Census Records. Eighth Census of the United States, 1860. Edgecombe County, North Carolina. Agricultural Schedule. Microfilm copy. Raleigh: Division of Archives and History.
- Williams, Ruth Smith. "Brochure on Cedar Lane." Unpublished manuscript, copy in files, Survey and Planning Branch, Archaeology and Historic Preservation Section, Division of Archives and History, Raleigh.

NATIONAL REGISTER OF HISTORIC PLACES

United States Department of the Interior
National Park Service

EVALUATION / RETURN SHEET

Property: Cedar Lane
State, County: NC, Edgercombe
Federal Agency: _____

Working No. 3-18-82-791
Fed. Reg. Date: 2-1-83
Date Due: 4-15-82 / 5-2-82
Action: ACCEPT 4/15/82
 RETURN
 REJECT
Entered in the National Register
photos
maps 82003451

resubmission
 nomination by person or local government
 owner objection
 appeal

Substantive Review: sample request appeal NR decision

Reviewer's comments:

Recom./Criteria _____
Reviewer _____
Discipline _____
Date _____
 see continuation sheet

Nomination returned for: technical corrections cited below
 substantive reasons discussed below

1. Name

2. Location

3. Classification

Category Ownership Status Present Use
Public Acquisition Accessible

4. Owner of Property

5. Location of Legal Description

6. Representation in Existing Surveys

has this property been determined eligible? yes no

7. Description

Condition excellent deteriorated good ruins fair unexposed
Check one unaltered altered
Check one original site moved date _____

Describe the present and original (if known) physical appearance

- summary paragraph
- completeness
- clarity
- alterations/integrity
- dates
- boundary selection

for NPS use only

8. Significance

Period _____ Areas of Significance—Check and justify below

Specific dates _____

Builder/Architect _____

Statement of Significance (in one paragraph)

- _____ summary paragraph
- _____ completeness
- _____ clarity
- _____ applicable criteria
- _____ justification of areas checked
- _____ relating significance to the resource
- _____ context
- _____ relationship of integrity to significance
- _____ justification of exception
- _____ other

9. Major Bibliographical References

10. Geographical Data

Acres of nominated property _____

Quadrangle name _____

UMT References _____

Verbal boundary description and justification _____

11. Form Prepared By

12. State Historic Preservation Officer Certification

The evaluated significance of this property within the state is:

_____ national _____ state _____ local

State Historic Preservation Officer signature _____

Site _____

date _____

13. Other

- _____ Maps
- _____ Photographs
- _____ Other

Questions concerning this nomination may be directed to _____

Signed _____ Date _____ Phone: 202 272 - 3504

Comments for any item may be continued on an attached sheet



NEGATIVE NUMBER N-81-8-109

PHOTOGRAPHER UNKNOWN

PHOTO DATE CA 1907/08 (OCT-NOV)

SUBJECT CEDAR LANE (Fountain Hse)
EDGE COMBE CO.

FROM DIVISION OF
ARCHIVES & HISTORY,
RALEIGH, N. C.

SEP 2 1981

PRINT BY
HISTORIC PRESERVATION SECTION



FROM DIVISION OF
ARCHIVES & HISTORY
RALEIGH, N. C.

SEP 2 1981

PRINT BY
HISTORIC PRESERVATION SECTION

NEGATIVE NUMBER N-81-2-108

PHOTOGRAPHER JOHNNIE HARPER

PHOTO DATE 1975

SUBJECT CEDAR LANE (Fountain Hse)
Edgecombe Co.

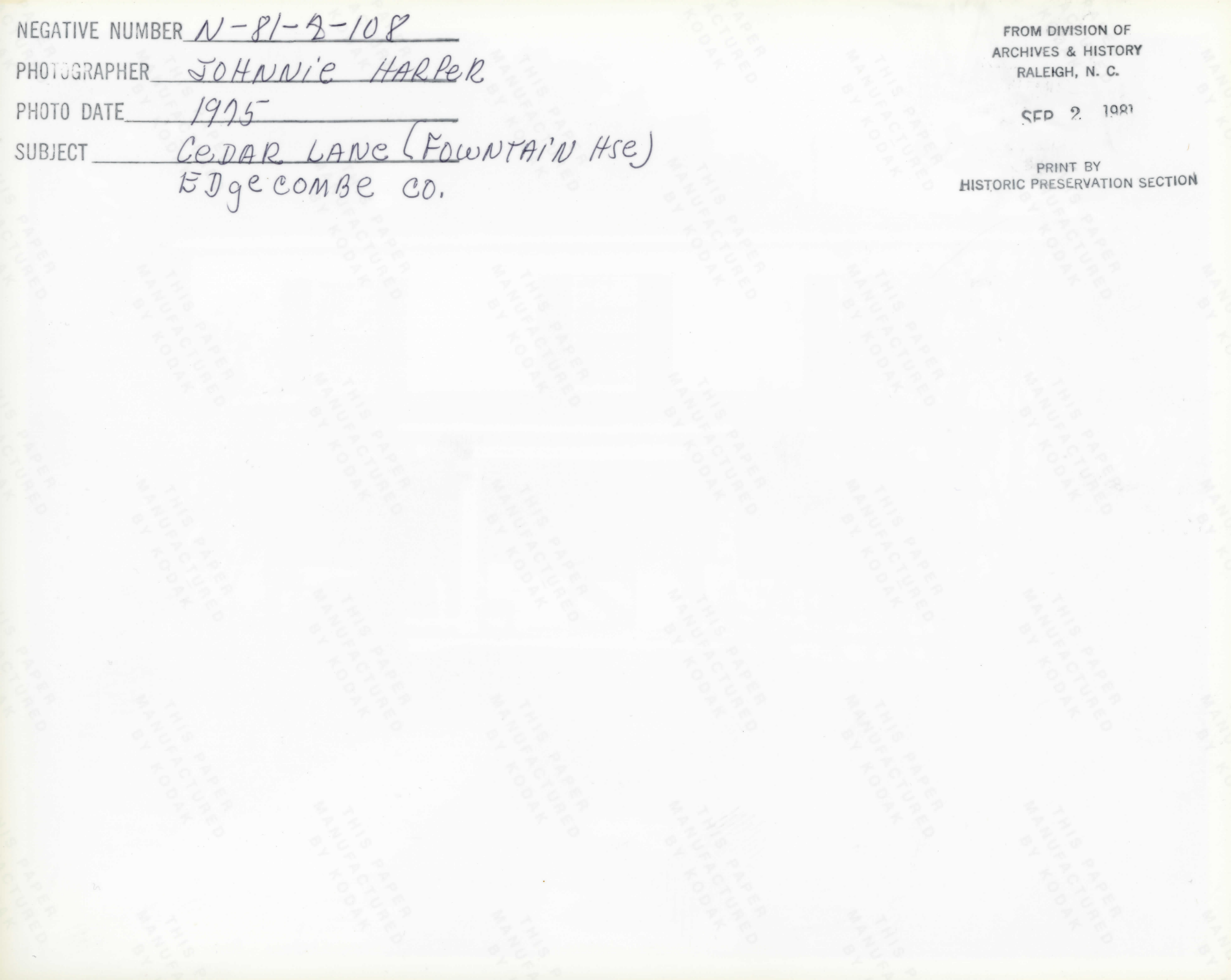



NEGATIVE NUMBER N-81-1-271

PHOTOGRAPHER CHARLOTTE V. BROWN

PHOTO DATE 8-80

SUBJECT FOUNTAIN HOWSE
EDGEcombe CO.

FROM DIVISION OF
ARCHIVES & HISTORY
RALEIGH, N. C.

SEP 2 1981

PRINT BY
HISTORIC PRESERVATION SECTION

271



NEGATIVE NUMBER N-76-8-1642

PHOTOGRAPHER C. COCKSHUTT

PHOTO DATE 8-76

SUBJECT FOUNTAIN HOUSE (CEDAR LANE)
EDGE COMBE CO.

FROM DIVISION OF
ARCHIVES & HISTORY
RALEIGH, N. C.

SEP 2 1981

PRINT BY
HISTORIC PRESERVATION SECTION

1642



NEGATIVE NUMBER N-81-1-273
PHOTOGRAPHER CHARLOTTE BROWN
PHOTO DATE 8-80
SUBJECT MOUNTAIN HOUSE
EDGE COMBE CO.

FROM DIVISION OF
ARCHIVES & HISTORY
RALEIGH, N. C.

SEP 2 1981

PRINT BY
HISTORIC PRESERVATION SECTION

(Drake 1:24,000)

(Hobgood 1:24,000)

(Whitakers 1:24,000)

(Draughn 1:24,000)

Cedar Lane
E. side N.C. 44, 0.35 mi. S. of N.C.
97, Leggett, N.C., 46.1 acres
Zone 18/35°59'09" 77°30'44"
Tarboro Quad Scale 1:62500

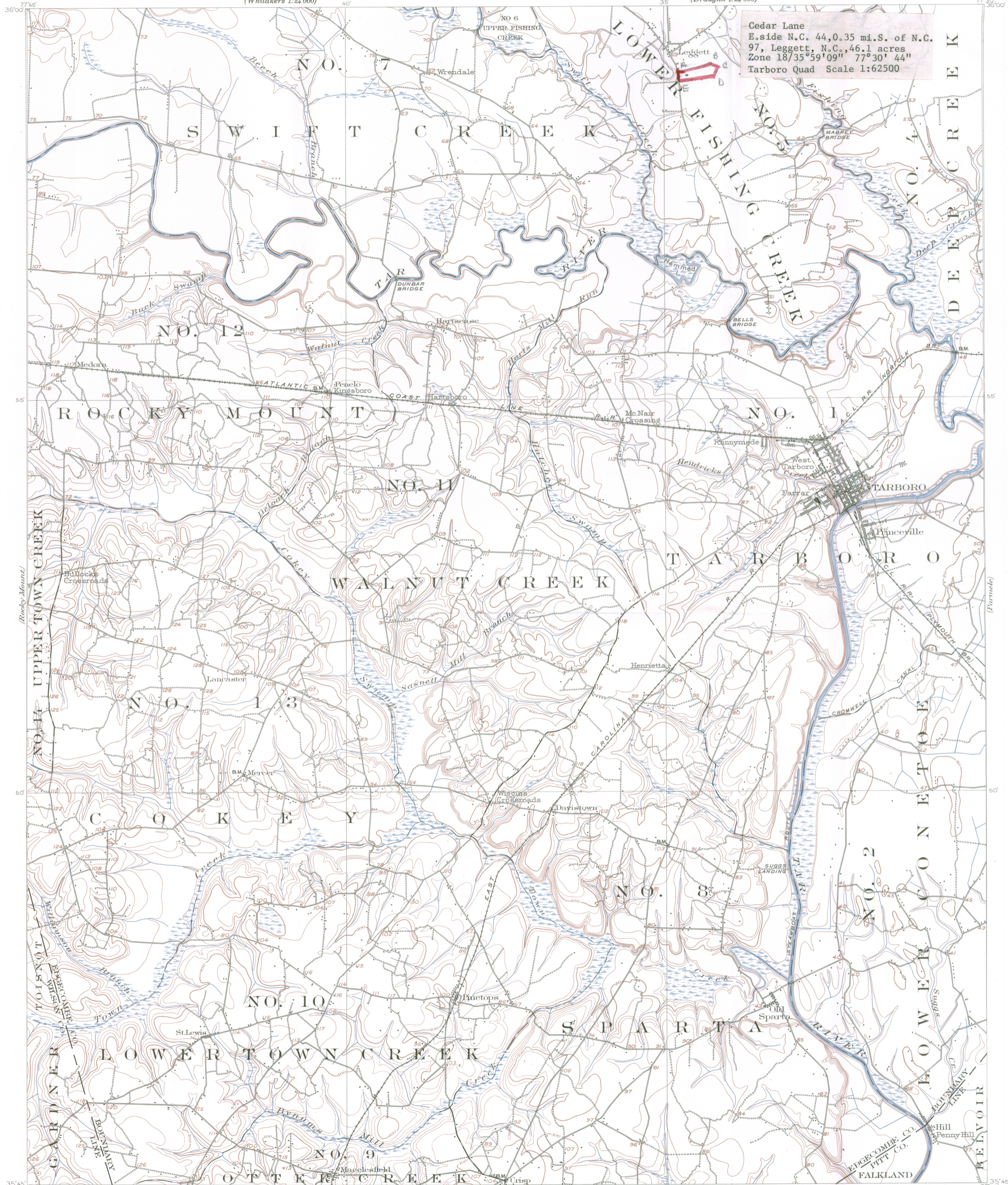

H. M. Wilson, Geographer in charge.
Control by Sledge Tatum, Oscar Jones and Robert Coe.
Topography by Albert Rike.
Surveyed in 1901-1902 in cooperation with the
North Carolina Department of Agriculture.

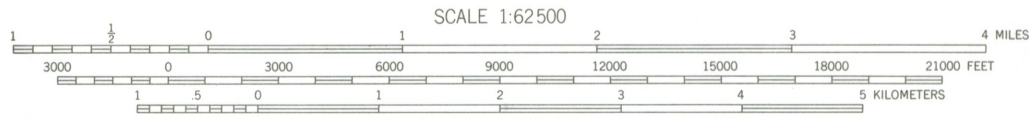

CONTOUR INTERVAL 10 FEET
DATUM IS MEAN SEA LEVEL

FOR SALE BY U.S. GEOLOGICAL SURVEY, WASHINGTON, D. C. 20242
A FOLDER DESCRIBING TOPOGRAPHIC MAPS AND SYMBOLS IS AVAILABLE ON REQUEST

TARBORO, N. C.
N3545—W7730/15

1902

Tolle

Map of Cedar Lane Est. of Almon Fountain Edgecombe Co. N.C.

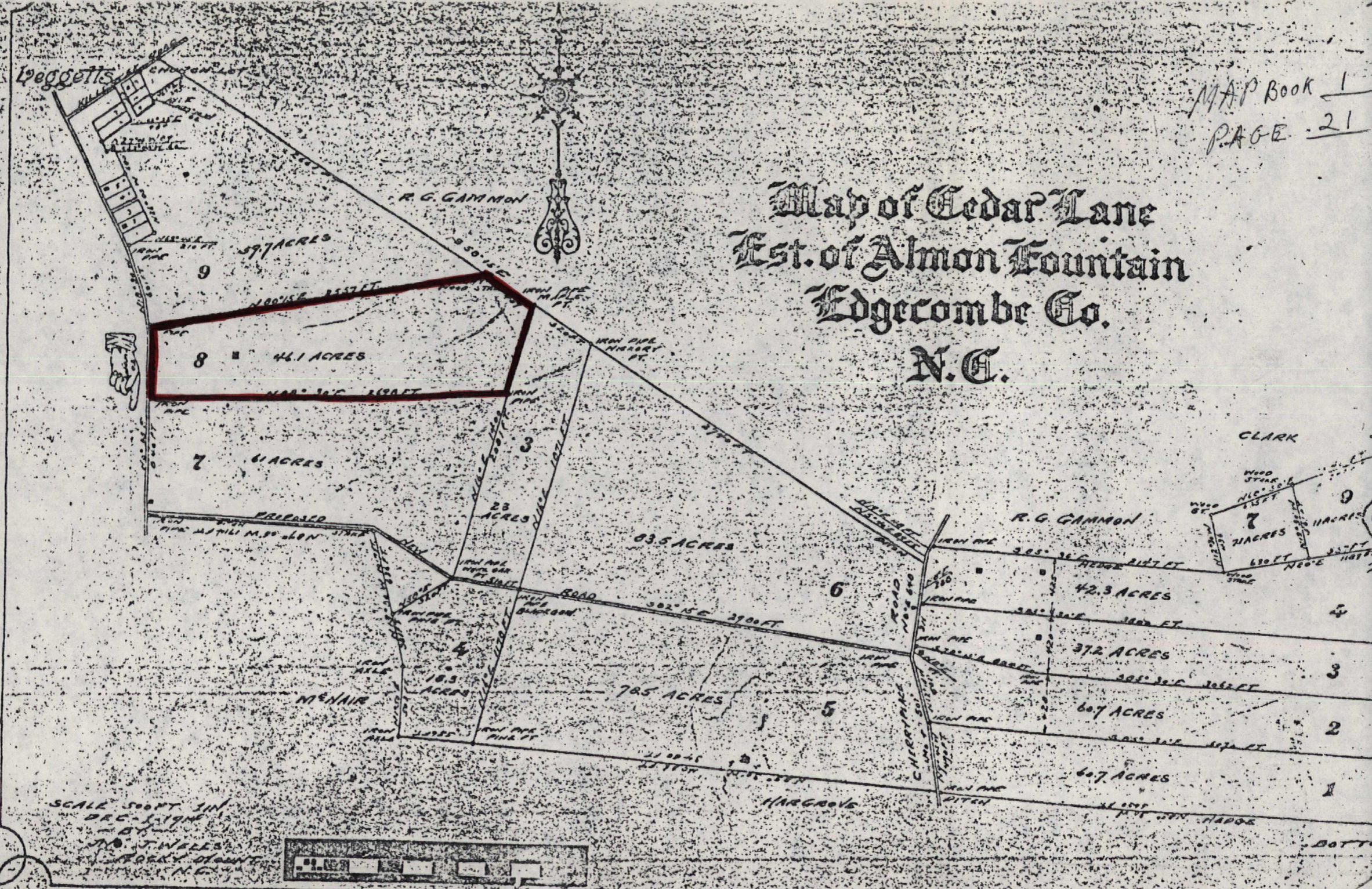

SCALE 500 FT. IN
ONE INCH
BY
T. W. WELLS
PLANNED
N.C.



NORTH
CAROLINA
DEPARTMENT
OF
CULTURAL
RESOURCES

Raleigh,
North Carolina
27611

Division of
Archives and History
William S. Price, Jr., Director

Sara W. Hodgkins,
Secretary
James B. Hunt, Jr.,
Governor

February 23, 1982

Ms. Carol Shull
National Register of Historic Places
U.S. Department of the Interior
National Park Service
440 G Street, N.W.
Washington, D.C. 20240

Dear Ms. Shull:

Enclosed is the nomination for Cedar Lane in Edgecombe County, North Carolina, to be entered in the National Register of Historic Places.

We trust that you will find this nomination in order. If there are any questions, please call us.

Sincerely yours,

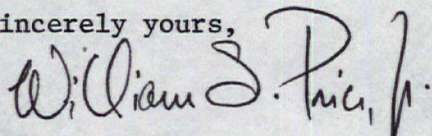

William S. Price, Jr.
State Historic Preservation Officer

WSP:bch

Enclosures

cc: Honorable John East
Honorable Jesse Helms
Honorable L. H. Fountain



Waiver by Property Owner

Dr. William S. Price, Jr.
109 E. Jones Street
Raleigh, N. C. 27611

Dear Dr. Price:

This will confirm that I am fully aware of the effects of listing a property in the National Register of Historic Places. I recognize that, under the National Historic Preservation Act, I am entitled to object to the proposed listing of my property by a notarized, written statement. If I am the sole owner and I object, my property will not be listed. If there are multiple owners of this property and a majority of the owners object, the property will not be listed.

Following is the address of my property:

R.F.D. # 2
TARBORO, NORTH CAROLINA
27886

I hereby waive my right to object to the proposed listing and notify you that I request that my property be listed in the National Register at the earliest possible date.

Sincerely,

MRS. U. L. Goodwyn &
Gray A. Goodwyn part on
GEORGE A. GOODWYN



Cedar Lake

ENTRIES IN THE NATIONAL REGISTER OF HISTORIC PLACES

STATE NORTH CAROLINA

Date Entered APRIL 15, 1982

Name

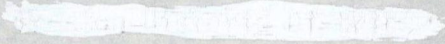
Cedar Lane

Location

Tarboro vicinity
Edgecombe County

Notified

Honorable L. H. Fountain
Honorable Jesse Helms
Honorable John Porter East

Southeast Regional Office, NPS

State Historic Preservation Officer
Dr. William S. Price, Jr.
Director, Division of Archives
& History
Department of Cultural Resources
109 East Jones Street
Raleigh, North Carolina 27611

For further information, please call the National Register at (202) 272-3504

DATE 5/12

TELEPHONE REPORT

TIME OF CALL AM PM

1. CALL TO: FROM (Name)

Walter Woodson

2. ADDRESS (Tel. No. if needed)

Cong. Fountain
225 - 4531

3. SUBJECT, PROJECT NO., ETC.

= Cedar Lane - Edgecombe - = April 15 =

4. DETAILS OF DISCUSSION

gave him basic info - date + reasons listed -

NAME OF PERSON PLACING/RECEIVING CALL

DUBIE

TITLE

HIST.

OFFICE