

NATIONAL REGISTER OF HISTORIC PLACES INVENTORY - NOMINATION FORM

(Type all entries - complete applicable sections)

STATE: North Carolina
COUNTY: Franklin
FOR NPS USE ONLY
ENTRY DATE: MAY 2 1975

1. NAME
COMMON: Dean Farm
AND/OR HISTORIC:

2. LOCATION
STREET AND NUMBER: 6 mi E of Louisburg on NC 56
North side of N.C. 56, just west of S.R. 1470
CITY OR TOWN: Louisburg vicinity
CONGRESSIONAL DISTRICT: Second
The Hon. L. H. Fountain
STATE: North Carolina
CODE: 37
COUNTY: Franklin
CODE: 069

3. CLASSIFICATION
CATEGORY (Check One): Building
OWNERSHIP: Private
STATUS: Occupied
ACCESSIBLE TO THE PUBLIC: No
PRESENT USE (Check One or More as Appropriate): Private Residence

4. OWNER OF PROPERTY
OWNER'S NAME: Mr. Jack Dean
STREET AND NUMBER: Stratford Drive
CITY OR TOWN: Louisburg
STATE: North Carolina
CODE: 37

5. LOCATION OF LEGAL DESCRIPTION
COURTHOUSE, REGISTRY OF DEEDS, ETC.: Franklin County Courthouse
STREET AND NUMBER:
CITY OR TOWN: Louisburg
STATE: North Carolina
CODE: 37

6. REPRESENTATION IN EXISTING SURVEYS
TITLE OF SURVEY:
DATE OF SURVEY:
DEPOSITORY FOR SURVEY RECORDS:
STREET AND NUMBER:
CITY OR TOWN:
STATE:

SEE INSTRUCTIONS

STATE: North Carolina
COUNTY: Franklin
ENTRY NUMBER:
DATE:
FOR NPS USE ONLY

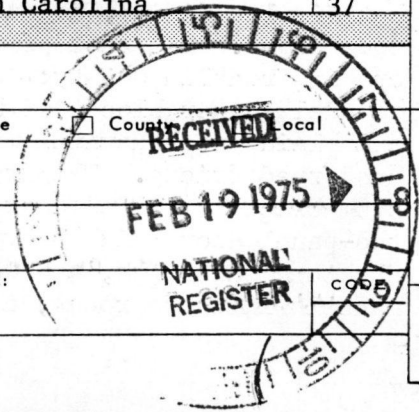

7. DESCRIPTION

CONDITION	(Check One)					
	<input type="checkbox"/> Excellent	<input checked="" type="checkbox"/> Good	<input type="checkbox"/> Fair	<input type="checkbox"/> Deteriorated	<input type="checkbox"/> Ruins	<input type="checkbox"/> Unexposed
	(Check One)			(Check One)		
	<input checked="" type="checkbox"/> Altered	<input type="checkbox"/> Unaltered	<input type="checkbox"/> Moved	<input checked="" type="checkbox"/> Original Site		

DESCRIBE THE PRESENT AND ORIGINAL (if known) PHYSICAL APPEARANCE

The Dean Farm complex is an unusually well-preserved cluster of buildings including a handsome vernacular Federal-Greek Revival house, plus several outbuildings, three of which are of considerable age and architectural interest. The complex is located on a slight rise near the main road (N.C. 56); a few hundred yards down the road--and included in the nomination--is the Dean family cemetery.

The farm dwelling is a two-story frame house with a gable roof. It is of traditional form and is distinguished by handsome and consistent Greek Revival finish. The front and back facades are three bays wide, as are the gable ends, which are pedimented--a feature very unusual in Franklin County. At each end are two large single-shoulder chimneys of large stone blocks. The elevations are defined by strong, wide baseboards, from which break out the bases of heavy, symmetrically molded corner posts treated as pilasters. These carry a wide, plain frieze that continues around the house. The house is covered with plain weatherboards, and the tympana of the pediments are flush-sheathed. The building rests on a foundation of stone; beneath the southwest room is a full cellar, which is entered by a weatherboarded bulkhead with a batten door hung with strap hinges. (The cellar, plus interior features and construction elements suggest that the southwest part of the house was built first, and the house as it now stands expanded around this core in the Greek Revival era.)

Across the main (south) facade extends a three-bay hip roof porch with fluted Doric columns connected by a turned balustrade; this porch replaced a one-bay pedimented entrance porch shown in a late nineteenth century photograph; the four extant columns resemble--and may in fact be--the four paired Doric columns shown in the photograph. The central entrance, a single door, is set in a simple frame as are the windows, with nine-over-nine sash at the first level and six-over-nine at the second. The side elevations have three evenly spaced bays separated by the two chimneys; to the rear extends a gable-roof one-story ell of recent but uncertain date.

The interior of the Dean House, as suggested by its exterior appearance, follows a center-hall plan two rooms deep. As is typical of Franklin County dwellings, an enclosed stair rises from the hall through the southwest front room. This front room has Federal style finish suggesting it is part of an earlier house. It has a simple three-part Federal mantel with an unusually tall frieze. The wainscot is flat-paneled with delicate Federal moldings, and door frames in this room are mitered molded ones. Similar but simpler finish, and a similar, two-part, Federal mantel exist in the room above. The rest of the house has finish typical of the Greek Revival era in Franklin County: symmetrically molded door and window frames with roundel corner blocks or molded ones with broad flat Greek Revival moldings; and plain Greek Revival mantels with simple pilasters supporting an unadorned frieze. The front hall and front east parlor have plastered walls, symmetrically molded door and window frames with roundel corner blocks, and two-panel doors with heavy Greek moldings. The rear two rooms have simple sheathed wainscots, and door frames with broad Greek Revival moldings. The mantels in these rooms, as upstairs, are simple Greek Revival ones, each

SEE INSTRUCTIONS

**NATIONAL REGISTER OF HISTORIC PLACES  
INVENTORY - NOMINATION FORM**

(Continuation Sheet)

STATE North Carolina	
COUNTY Franklin	
FOR NPS USE ONLY	
ENTRY NUMBER	DATE
MAY 2	1975

(Number all entries)

7.

with plain pilasters supporting an unadorned frieze.

In the front east parlor, there is an impressive, rather academic Greek Revival mantel, resembling one illustrated by Asher Benjamin and typical locally (in Franklin and Warren counties) of the work of Warrenton builder Jacob Holt. A symmetrically molded architrave with roundel corner blocks frames the rectangular fire opening. Flanking this, and projecting out beyond it, are paired tapered fluted Doric colonnettes that rest on heavy bases; these carry a heavy, unbroken frieze dominated by a high-relief horizontal fluted roll. Above, the heavy shelf breaks out at the end-block space. In this room, flat panels occur under the windows, framed by the window architraves.

Near the house, essentially in the side and rear yard, are several out-buildings, including a smokehouse, corncrib, harness room, and barn; the latter is of more recent date than the former three, which are probably of early nineteenth century vintage and are exceptionally fine and well-preserved examples of three different types of construction. Southwest of the dwelling is the corncrib, a gable-roof structure constructed of hewn logs joined in a diamond notch. It stands on rocks placed at intervals. The gables are weatherboarded, and there is a single opening, like a window, sheltered by a wooden batten shutter hung on strap hinges attached by pintils. The roof is covered with wooden shingles. Also west of the house, in the middle of the yard, is a small gable roof building said to have been the smokehouse; it is of frame, covered with beaded weatherboards, attached with rosehead nails. Its door is hung with wooden hinges. Beyond the fence that encloses the yard is the harness room or tack house. It is a small building constructed of finely hewn planks joined at the corners in a handsomely executed dovetail. Its door is missing. The barn, of frame covered with weatherboards, has a central aisle flanked by stalls. Formerly a kitchen stood to the rear of the dwelling but was torn down in recent years. Near the house stands a mounted farm bell.

The graveyard, at the edge of the highway and west of the house, contains marked family graves, including those of Thomas and Martha Dean, T. P. and Mary Dean, and several children. The visible presence of this family cemetery enhances the sense of continuity and stability that characterizes the Dean Farm.

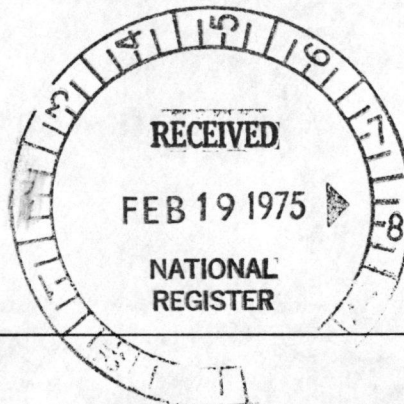

**8. SIGNIFICANCE**

PERIOD (Check One or More as Appropriate)

- |  |                                       |  |                                       |
|--|---------------------------------------|--|---------------------------------------|
| <input type="checkbox"/> Pre-Columbian | <input type="checkbox"/> 16th Century | <input type="checkbox"/> 18th Century            | <input type="checkbox"/> 20th Century |
| <input type="checkbox"/> 15th Century  | <input type="checkbox"/> 17th Century | <input checked="" type="checkbox"/> 19th Century |                                       |

SPECIFIC DATE(S) (If Applicable and Known)

AREAS OF SIGNIFICANCE (Check One or More as Appropriate)

- |  |   |  |  |
|--|---|--|--|
| <input type="checkbox"/> Aboriginal              | <input type="checkbox"/> Education              | <input type="checkbox"/> Political           | <input type="checkbox"/> Urban Planning        |
| <input type="checkbox"/> Prehistoric             | <input type="checkbox"/> Engineering            | <input type="checkbox"/> Religion/Philosophy | <input type="checkbox"/> Other (Specify) _____ |
| <input type="checkbox"/> Historic                | <input type="checkbox"/> Industry               | <input type="checkbox"/> Science             | _____  |
| <input checked="" type="checkbox"/> Agriculture  | <input type="checkbox"/> Invention              | <input type="checkbox"/> Sculpture           | _____  |
| <input checked="" type="checkbox"/> Architecture | <input type="checkbox"/> Landscape Architecture | <input type="checkbox"/> Social/Humanitarian | _____  |
| <input type="checkbox"/> Art                     | <input type="checkbox"/> Literature             | <input type="checkbox"/> Theater             | _____  |
| <input type="checkbox"/> Commerce                | <input type="checkbox"/> Military               | <input type="checkbox"/> Transportation      | _____  |
| <input type="checkbox"/> Communications          | <input type="checkbox"/> Music                  |  |  |
| <input type="checkbox"/> Conservation            |   |  |  |

STATEMENT OF SIGNIFICANCE

The Dean Farm, a well-preserved complex which has remained in the hands of a single family since 1842, is representative of the moderate-sized farm--described in 1883 as a "three-horse farm"--vital to the history of rural North Carolina. The Greek Revival dwelling and the several out-buildings--examples of log, weatherboard, and dovetailed plank construction--are unpretentious but unusually handsome and well-executed.

On December 9, 1840, Thomas Dean (1821-1883) and Martha Stokes (1820-1893) posted their marriage bonds in Franklin County. Just over a year later, on January 11, 1842, Thomas purchased from Martha's father, William Stokes, for \$225, a tract of 264½ acres on the south side of Peachtree Creek. The 1842 purchase coincided roughly with the birth of the Deans' (apparently) first child, Elizabeth. Evidently the Stokes family owned considerable land in the neighborhood, and the area was populated by close relatives: another Stokes daughter, Nancy, had married Allison Lea (Leigh) who also obtained Stokes land, bordering the Deans' land; Gray Stokes, a brother, also held land nearby, some of which Thomas Dean later bought (after the Civil War).

The small core of the present house--with Federal stylistic elements and earlier construction elements--probably existed before Dean purchased the land. It seems reasonably certain that it was for the growing Dean family that the house was expanded to its two-story-high, center-hall-plan, two-room-deep size and given the consistent Greek Revival finish; this was probably done in the 1840s. During the decades before the Civil War, Dean's primary holding was the 264-acre tract on Peachtree Creek, to which he added two more parcels to make 335 acres by 1860. He is listed as holding between 5 and 16 slaves. The 1860 census showed Dean, aged 47, a farmer with real estate evaluated at \$2,600, and personal property at \$10,560. His family included seven children ranging from eighteen to three years old; Allison and Nancy Leigh lived next door. The Dean Farm, with 167 acres improved and 167 unimproved, produced a standard range of crops. Dean owned fifteen slaves; his brother-in-law Leigh, thirteen.

After the Civil War, the Deans were able to hold on to the farm and even expand the property, to over 1,000 acres by 1883. At Dean's death in that year, he left his wife Martha for life 200 acres to include "my Mansion House, all out houses and other improvements," all the household and kitchen furniture, some livestock, and farming implements "sufficient

SEE INSTRUCTIONS

**NATIONAL REGISTER OF HISTORIC PLACES  
INVENTORY - NOMINATION FORM**

(Continuation Sheet)

STATE North Carolina	
COUNTY Franklin	
FOR NPS USE ONLY	
ENTRY NUMBER	DATE
MAY 2	1975

(Number all entries)

8.

to carry on a two horse farm." An inventory of personal property in his estate included

1 Apple Mill & press, 1 lot cider cask, 2 Stills, 1 horse cart, 1 ox cart, 1 one horse waggon, 1 two horse waggon, & harness, 1 buggy & harness, 1 Lot of farming implements for a 3 horse farm, 15 bbls of corn, 1,000 lbs fodder, 8 bus. oats, 30 bus. wheat, 300 lbs. bacon, 1 cotton gin, 120 lbs of Lint Cotton, 1 horse, 2 mules, 2 cows & calves, 1 yoke of oxen, 12 head of sheep, 10 head of hogs, 1 \_\_\_\_\_ mill

4 beds bedSteads & furniture, 4 mattress bed Steads & furniture, 10 pieces of parlor furniture, 10 chairs, 1 bottle case, 2 desk, 1 iron Safe, 3 tables, 1 clock, 2 pairs dining-room furniture, 1 large chest, 1 lot of crockery ware, 1 lot of kitchen furniture and one Sewing Machine.

After the death of Martha Dean in 1893, the two sons who had received specific bequests in the father's will subject to her life estate executed a pair of contracts between them. James A. Dean had been devised the mansion house tract, and T. P. Dean an adjoining tract. In deeds of March 13, 1894, they recorded their agreement to "exchange some portions of the tracts so that T. P. Dean should have the Dwelling house and out houses." The property has continued in the Dean family, and is kept in good condition by the present owner, who lives in town.

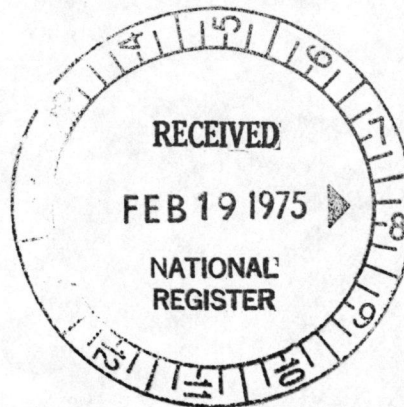

**9. MAJOR BIBLIOGRAPHICAL REFERENCES**

Franklin County Records, Franklin County Courthouse, Louisburg, North Carolina (Subgroups: Deeds, Wills).  
 Franklin County Records, Division of Archives and History, Raleigh, North Carolina (Subgroups: Deeds, Wills, Estate papers, Census records, Marriage records, Tax records).

**10. GEOGRAPHICAL DATA**

LATITUDE AND LONGITUDE COORDINATES DEFINING A RECTANGLE LOCATING THE PROPERTY			O R	LATITUDE AND LONGITUDE COORDINATES DEFINING THE CENTER POINT OF A PROPERTY OF LESS THAN TEN ACRES		
CORNER	LATITUDE	LONGITUDE		LATITUDE	LONGITUDE	
	Degrees Minutes Seconds	Degrees Minutes Seconds		Degrees	Minutes	Seconds
NW	36° 05' 31"	78° 10' 56"		0		
NE	36° 05' 31"	78° 10' 35"				
SE	36° 05' 12"	78° 10' 35"				
SW	36° 05' 12"	78° 10' 56"				

APPROXIMATE ACREAGE OF NOMINATED PROPERTY: **20 acres**

LIST ALL STATES AND COUNTIES FOR PROPERTIES OVERLAPPING STATE OR COUNTY BOUNDARIES

STATE:	CODE	COUNTY	CODE
STATE:	CODE	COUNTY:	CODE
STATE:	CODE	COUNTY:	CODE
STATE:	CODE	COUNTY:	CODE

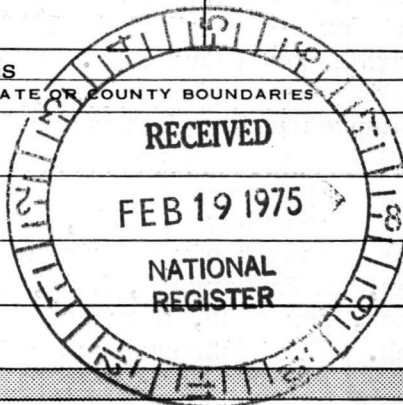

NO  
UTM  
CD

SEE INSTRUCTIONS

**11. FORM PREPARED BY**

NAME AND TITLE: Research and architectural description by Catherine W. Cockshutt, supervisor survey

ORGANIZATION: Division of Archives and History DATE: 30 January 1975

STREET AND NUMBER: 109 East Jones Street

CITY OR TOWN: Raleigh STATE: North Carolina CODE: 37

**12. STATE LIAISON OFFICER CERTIFICATION**

**NATIONAL REGISTER VERIFICATION**

As the designated State Liaison Officer for the National Historic Preservation Act of 1966 (Public Law 89-665), I hereby nominate this property for inclusion in the National Register and certify that it has been evaluated according to the criteria and procedures set forth by the National Park Service. The recommended level of significance of this nomination is:

National  State  Local

Name Robert E. Stipe

Title State Historic Preservation Officer

Date 30 January 1975

I hereby certify that this property is included in the National Register.

Al Mortensen  
 Director, Office of Archeology and Historic Preservation

Date 5/9/75

ATTEST:  
Charles H. Herring  
 Keeper of The National Register

Date 5-2-75

Property

*Dean Farm*

*Franklin*

State

*North Carolina*

Working Number

*2.19.75.261*

*75001267*

**TECHNICAL**

Photos 6

Maps 1

*Called 2.25. They are going to send original photo person*

**CONTROL**

*cm*

*OK 2.25.75*

**HISTORIAN**

*Accept*

*E. Smith*

*2-28-75*

**ARCHITECTURAL HISTORIAN**

*GOOD NOMINATION*

*ACCEPT*

*LEBOWITZ*

*2-26-75*

**ARCHEOLOGIST**

**OTHER**

**HAER**

Inventory \_\_\_\_\_

Review \_\_\_\_\_

**REVIEW UNIT CHIEF**

*Accept*

*Cole*

*3-3-75*

**BRANCH CHIEF**

**KEEPER**

*Franklin  
for Muntz  
5-2-75*

National Register Write-up \_\_\_\_\_

Send-back \_\_\_\_\_

Entered MAY 2 1975

Federal Register Entry 6-3-75

Re-submit \_\_\_\_\_

INT:2106-74



FORM 10-301 A  
(6/72)UNITED STATES DEPARTMENT OF THE INTERIOR  
NATIONAL PARK SERVICE  
NATIONAL REGISTER OF HISTORIC PLACES  
PROPERTY PHOTOGRAPH FORM*(Type all entries - attach to or enclose with photograph)*

## 1. NAME

COMMON

Dean Farm

AND/OR HISTORIC

NUMERIC CODE *(Assigned by NPS)*

MAY 2 1975

## 2. LOCATION

STATE

North Carolina

COUNTY

Franklin

TOWN

Louisburg vicinity

STREET AND NUMBER

North side of N.C. 56, just west of S.R. 1470

## 3. PHOTO REFERENCE

PHOTO CREDIT

Catherine W. Cockshutt

DATE

January, 1975

NEGATIVE FILED AT

Division of Archives and History

## 4. IDENTIFICATION

DESCRIBE VIEW, DIRECTION, ETC.

Log corner, looking south

# 1026

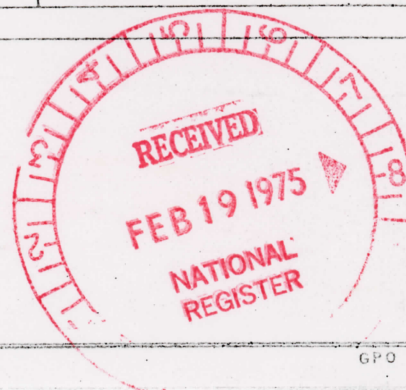

GPO 922-009

FROM STATE DEPARTMENT OF  
ARCHIVES AND HISTORY  
RALEIGH, N. C.

PROPERTY OF THE NATIONAL REGISTER 1975

PRINT BY NORTH CAROLINA  
MUSEUM OF HISTORY



PHOTOGRAPHER CATHERINE W. COOKSULT

DATE JAN 1975

FORM 10-301 A  
(6/72)

UNITED STATES DEPARTMENT OF THE INTERIOR  
NATIONAL PARK SERVICE

NATIONAL REGISTER OF HISTORIC PLACES  
PROPERTY PHOTOGRAPH FORM

(Type all entries - attach to or enclose with photograph)

1. NAME

COMMON Dean Farm	AND/OR HISTORIC	NUMERIC CODE (Assigned by NPS) MAY 2 1975
---------------------	-----------------	--

2. LOCATION

STATE North Carolina	COUNTY Franklin	TOWN Louisburg vicinity
-------------------------	--------------------	----------------------------

STREET AND NUMBER  
North side of N.C. 56, just west of S.R. 1470

3. PHOTO REFERENCE

PHOTO CREDIT Michael Southern	DATE January, 1975	NEGATIVE FILED AT Division of Archives and History
----------------------------------	-----------------------	---

4. IDENTIFICATION

DESCRIBE VIEW, DIRECTION, ETC.  
Plank tack house, looking southeast

#286



GPO 932-009

OFFICE OF  
ARCHIVES AND HISTORY,  
RALEIGH, N. C.

PROPERTY OF THE NATIONAL REGISTER FEB 28 1975

PRINT BY NORTH CAROLINA  
MUSEUM OF HISTORY



NEGATIVE NUMBER N74-12 — 1441

FORM 10-301 A  
(6/72)

UNITED STATES DEPARTMENT OF THE INTERIOR  
NATIONAL PARK SERVICE

NATIONAL REGISTER OF HISTORIC PLACES  
PROPERTY PHOTOGRAPH FORM

(Type all entries - attach to or enclose with photograph)

1. NAME

COMMON

AND/OR HISTORIC

NUMERIC CODE (Assigned by NPS)

Dean Farm

MAY 2 1975

2. LOCATION

STATE

COUNTY

TOWN

North Carolina

Franklin

Louisburg vicinity

STREET AND NUMBER

North side of N.C. 56, just west of S.R. 1470

3. PHOTO REFERENCE

PHOTO CREDIT

DATE

NEGATIVE FILED AT

Catherine W. Cockshutt

January, 1975

Division of Archives and History

4. IDENTIFICATION

DESCRIBE VIEW, DIRECTION, ETC.

Overall view of farm complex, looking northeast

#3084

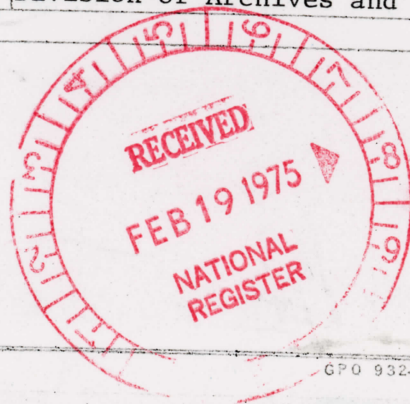

GPO 932-009

ARCHIVES AND HISTORY  
RALEIGH, N. C.

PROPERTY OF THE NATIONAL REGISTER

PRINT BY NORTH CAROLINA  
MUSEUM OF HISTORY



FORM 10-301 A  
(6/72)

UNITED STATES DEPARTMENT OF THE INTERIOR  
NATIONAL PARK SERVICE  
**NATIONAL REGISTER OF HISTORIC PLACES**  
**PROPERTY PHOTOGRAPH FORM**  
(Type all entries - attach to or enclose with photograph)

1. NAME

COMMON	AND/OR HISTORIC	NUMERIC CODE (Assigned by NPS)
Dean Farm		MAY 2 1975

2. LOCATION

STATE	COUNTY	TOWN
North Carolina	Franklin	Louisburg vicinity

STREET AND NUMBER

North side of N.C. 56, just west of S.R. 1470

3. PHOTO REFERENCE

PHOTO CREDIT	DATE	NEGATIVE FILED AT
Catherine W. Cockshutt	January, 1975	Division of Archives and History

4. IDENTIFICATION

DESCRIBE VIEW, DIRECTION, ETC.

Overall view of house, looking northeast

#4 26

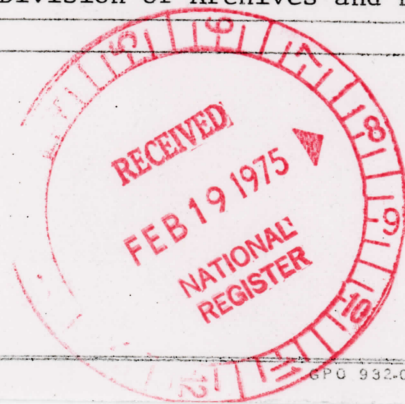

GPO 932-009

FROM STATE DEPARTMENT OF  
ARCHIVES AND HISTORY  
**PROPERTY OF THE NATIONAL REGISTER**  
JAN 28 1975  
PRINT BY NORTH CAROLINA  
MUSEUM OF HISTORY



NEGATIVE NUMBER N74-12 - 1447

PHOTOGRAPHER CATHERINE W. COCKSHUTT

PHOTO  
SUBJECT

FORM 10-301 A  
(6/72)

UNITED STATES DEPARTMENT OF THE INTERIOR  
NATIONAL PARK SERVICE  
NATIONAL REGISTER OF HISTORIC PLACES  
PROPERTY PHOTOGRAPH FORM  
(Type all entries - attach to or enclose with photograph)

1. NAME		NUMERIC CODE (Assigned by NPS)
COMMON	AND/OR HISTORIC	
Dean Farm		MAY 2 1975
2. LOCATION		
STATE	COUNTY	TOWN
North Carolina	Franklin	Louisburg
STREET AND NUMBER		
North side of N.C. 56, just west of S.R. 1470		
3. PHOTO REFERENCE		
PHOTO CREDIT	DATE	NEGATIVE FILED AT
Catherine W. Cockshutt	January, 1975	Division of Archives and History

4. IDENTIFICATION  
DESCRIBE VIEW, DIRECTION, ETC.

Mantel in southeast parlor

# 596

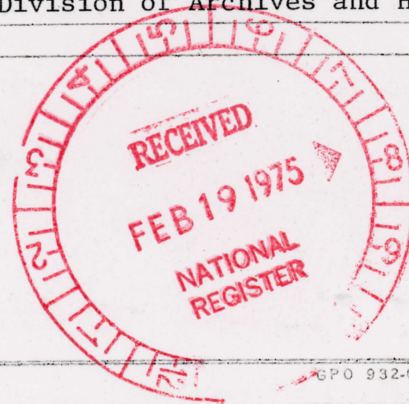

GPO 932-009

FROM STATE DEPARTMENT OF  
ARCHIVES AND HISTORY  
RALEIGH, N. C.

PROPERTY OF THE NATIONAL REGISTER

JAN 28 1975

PRINTED BY NORTH CAROLINA  
MUSEUM OF HISTORY



NEGATIVE NUMBER N74-12 - 1457

PHOTOGRAPHER CATHERINE W. COCKSHUTT

PHOTO  
SUBJECT

FORM 10-301 A  
(6/72)

UNITED STATES DEPARTMENT OF THE INTERIOR  
NATIONAL PARK SERVICE

NATIONAL REGISTER OF HISTORIC PLACES  
PROPERTY PHOTOGRAPH FORM

(Type all entries - attach to or enclose with photograph)

1. NAME

COMMON

Dean Farm

AND/OR HISTORIC

NUMERIC CODE (Assigned by NPS)

MAY 2 1975

2. LOCATION

STATE

North Carolina

COUNTY

Franklin

TOWN

Louisburg vicinity

STREET AND NUMBER

North side of N.C. 56, just west of S.R. 1470

3. PHOTO REFERENCE

PHOTO CREDIT

Catherine W. Cockshutt

DATE

January, 1975

NEGATIVE FILED AT

Division of Archives and History

4. IDENTIFICATION

DESCRIBE VIEW, DIRECTION, ETC.

Mantel in southwest parlor

#6036



GPO 932-009

FROM STATE ARCHIVES AND HISTORY

RALEIGH, N. C.

PROPERTY OF THE NATIONAL REGISTER

JAN 26 1975

PRINT BY NORTH CAROLINA  
MUSEUM OF HISTORY

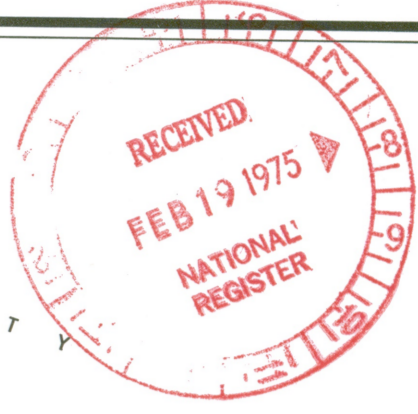

- LEGEND**
- FRONTAGE OR UNIMPROVED ROAD
  - GRADED AND DRAINED ROAD
  - SOIL GRAVEL OR STONE SURFACE ROAD
  - HARD SURFACE ROAD
  - 4 LANE UNWEAVED HIGHWAY
  - DIVIDED HIGHWAY
  - HIGHWAY WITH FRONTAGE ROADS
  - FUEL CONTROL ACCESS
  - FEDERAL AID INTERSTATE ROAD
  - FEDERAL AID PRIMARY ROAD
  - FEDERAL AID SECONDARY ROAD
  - NON-SYSTEM ROAD
  - PROJECTED LOCATION
  - INTERSECTION DISTANCE
  - TRAFFIC CIRCLE
  - HIGHWAY INTERCHANGE
  - DETAILED HIGHWAY INTERCHANGE
  - INTERSTATE HIGHWAY
  - U.S. NUMBERED HIGHWAY
  - N.C. NUMBERED HIGHWAY
  - SECONDARY ROAD NUMBERS
  - UNDERGROUND CABLE
  - RAILROAD ANY NUMBER OF TRACKS
  - USED BY SINGLE OPERATING COMPANY
  - RAILROAD ANY NUMBER OF TRACKS
  - USED BY MORE THAN ONE OPERATING COMPANY ON SAME OR ADJACENT RIGHTS-OF-WAY
  - RAILROAD STATION
  - RAILROAD CROSSING
  - RAILROAD TUNNEL
  - ARMY, NAVY OR MARINE CORPS FIELD
  - CONTR. OR MUNICIPAL AIRPORT
  - MARKED AUXILIARY FIELD
  - HANGAR ON FIELD "H" IN SYMBOL
  - ROCK, PIER OR LANDING
  - FIRE OR ISLAND FERRY
  - LIGHT, NAUTICAL
  - LIGHTHOUSE
  - COAST GUARD STATION
  - CANAL
  - NARROW STREAM
  - WIDE STREAM
  - DAM WITH LOCK
  - DAM
  - RESERVOIR, POND OR LAKE
  - PROMINENT PEAK, NUMERALS INDICATE ELEVATION
  - ROAD THROUGH MOUNTAIN PASS
  - HIGHWAY BRIDGE OVER 20 FT
  - GRAVY SHADE OR BRIDGE
  - HIGHWAY TUNNEL
  - FORD
  - STATE LINE
  - COUNTY LINE
  - CITY LIMITS
  - RESERVATION OR PARK BOUNDARY
  - REST AREA
  - DEEMED AREA, POPULATION EST.
  - COUNTY SEAT
  - OTHER TOWNS AND VILLAGES
  - TRANSCULATION STATION
  - INCORPORATED CITY OR VILLAGE GENERALIZED
  - SCHOOL
  - CHURCH
  - CHURCH WITH CEMETERY
  - CEMETERY
  - HOSPITAL
  - CORRECTIONAL OR PENAL INST.
  - HIGHWAY GARAGE, OR MARSH, YARD
  - HIGHWAY DIV. OR DIST. OFFICE
  - WIRELESS STATION
  - PARKS STATION
  - REST AREA
  - MONUMENT—SMALL HISTORICAL SITE

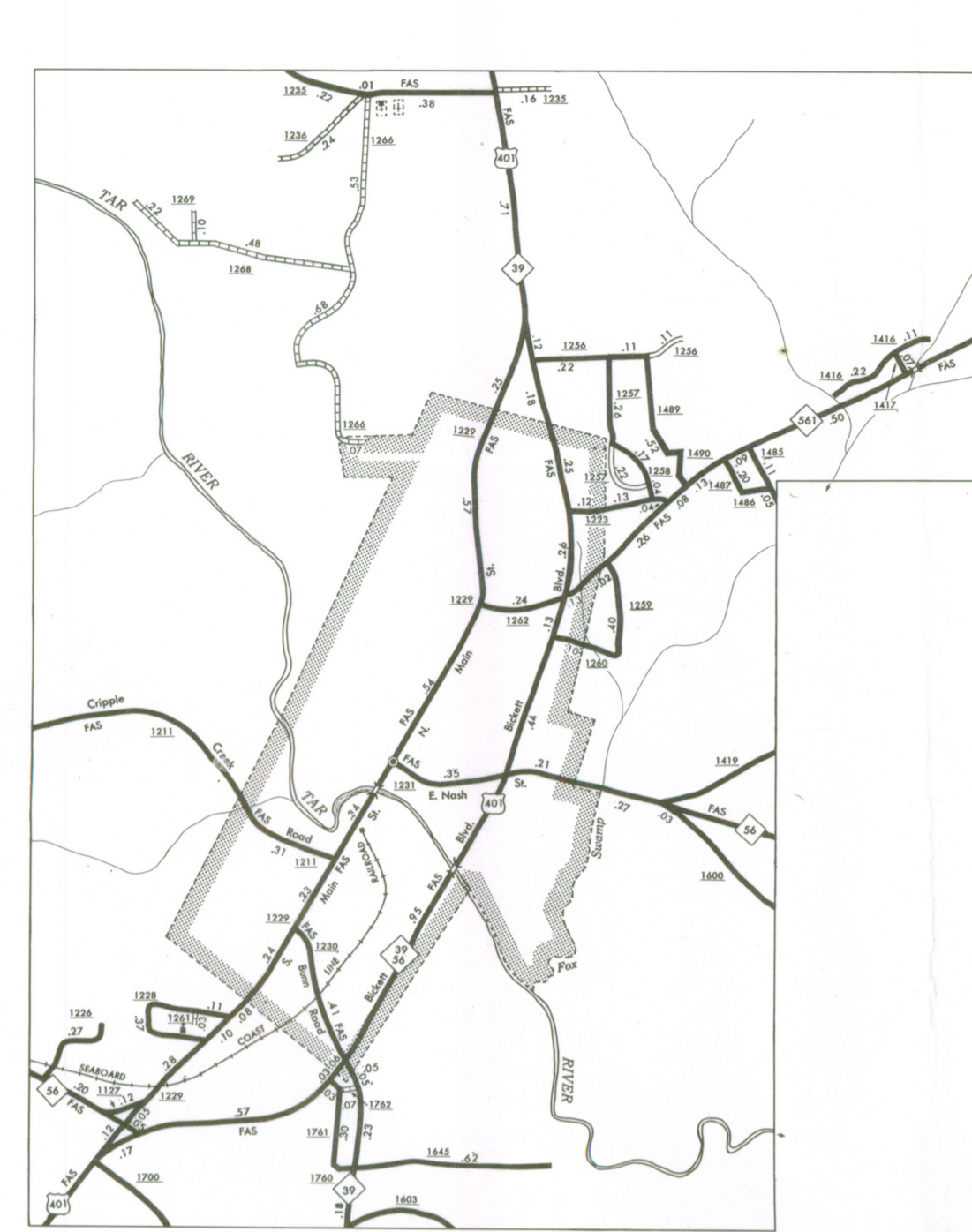

LOUISBURG POP. 2,941

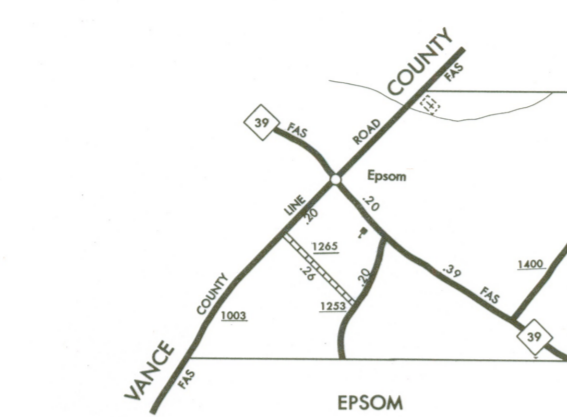

EPSOM

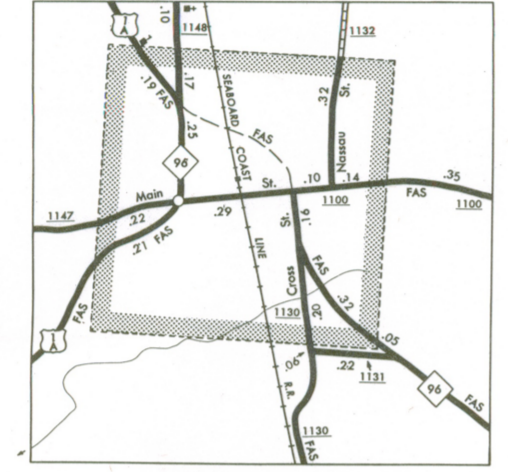

YOUNGVILLE POP. 555

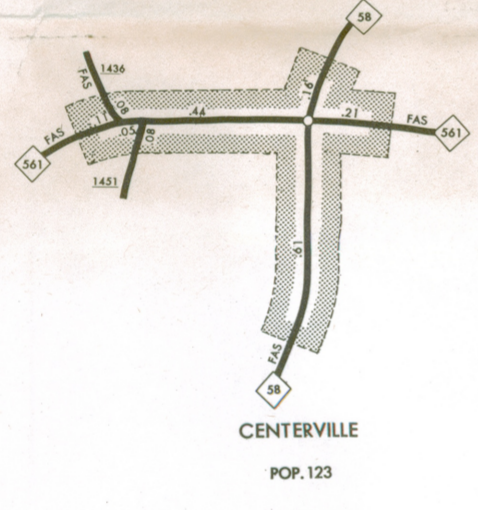

CENTERVILLE POP. 123



FRANKLINTON POP. 1,459

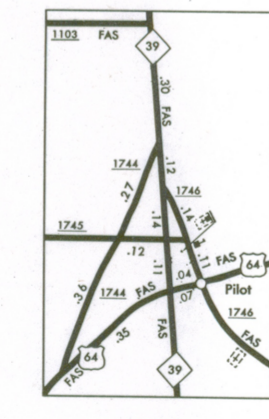

PILOT

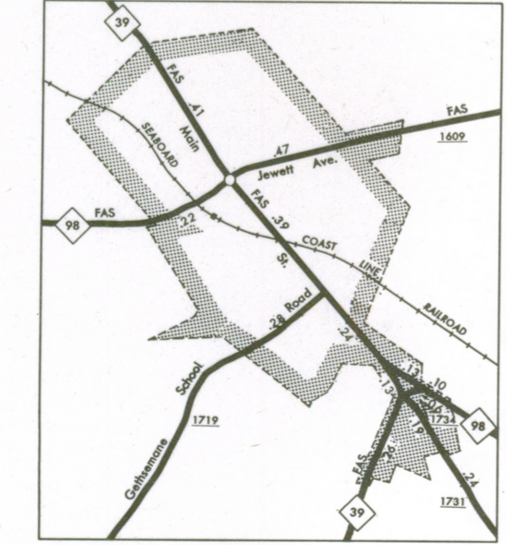

BUNN POP. 284

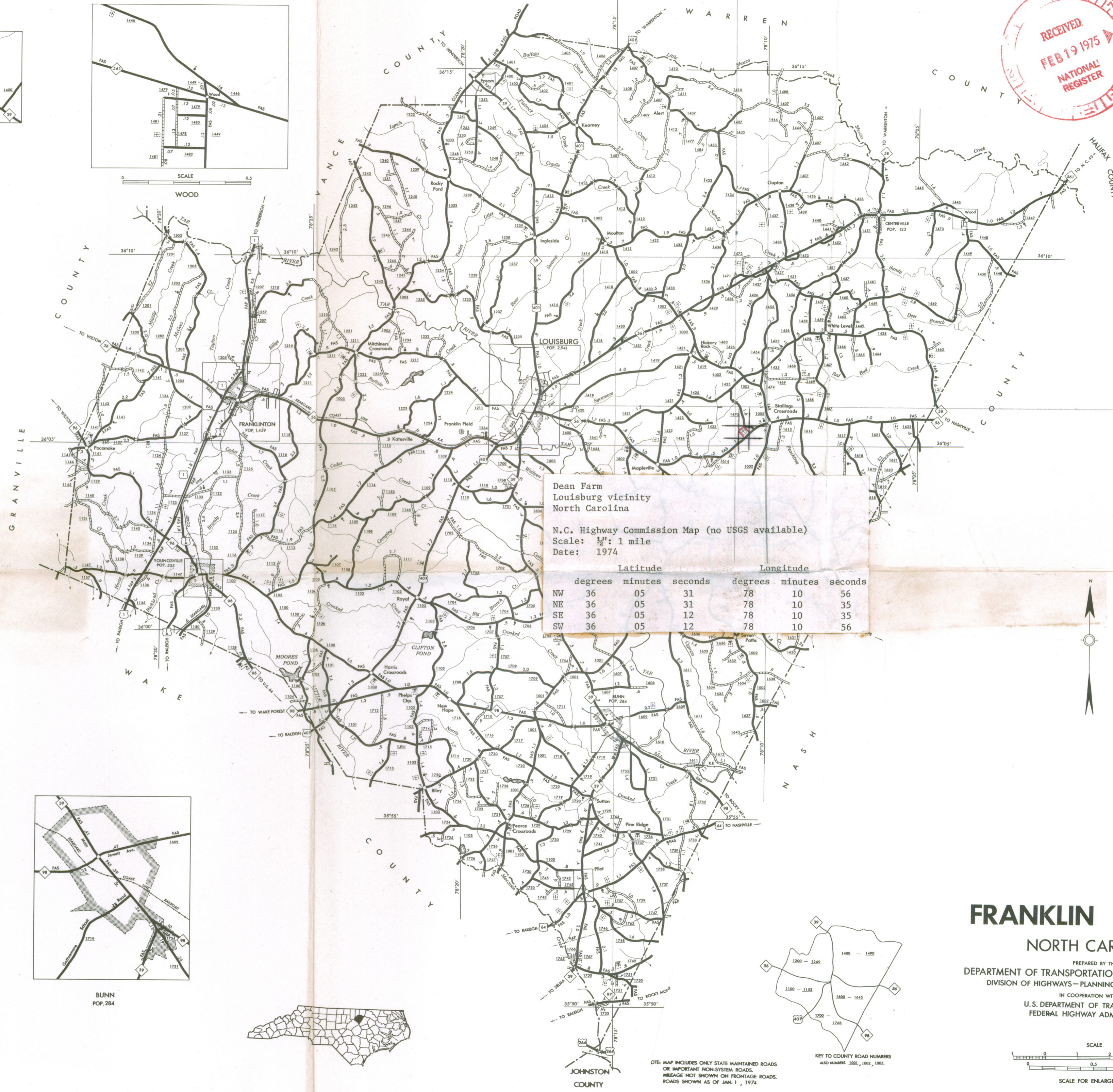

Dean Farm  
Louisburg vicinity  
North Carolina

N.C. Highway Commission Map (no USGS available)  
Scale: 1/4" = 1 mile  
Date: 1974

Latitude			Longitude		
degrees	minutes	seconds	degrees	minutes	seconds
NW	36	05	31	78	10
NE	36	05	31	78	10
SE	36	05	12	78	10
SW	36	05	12	78	10



# FRANKLIN COUNTY

## NORTH CAROLINA

PREPARED BY THE  
DEPARTMENT OF TRANSPORTATION AND HIGHWAY SAFETY  
DIVISION OF HIGHWAYS—PLANNING AND RESEARCH BRANCH  
IN COOPERATION WITH THE  
U.S. DEPARTMENT OF TRANSPORTATION  
FEDERAL HIGHWAY ADMINISTRATION

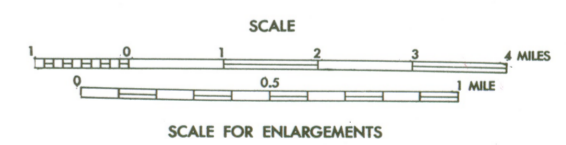

SCALE FOR ENLARGEMENTS

KEY TO COUNTY ROAD NUMBERS  
ALSO NUMBERS 1001, 1002, 1003.

DTS MAP INCLUDES ONLY STATE MAINTAINED ROADS  
OR IMPORTANT NON-SYSTEM ROADS.  
IMBRACE NOT SHOWN ON FRONTAGE ROADS.  
ROADS SHOWN AS OF JAN. 1, 1974.



COPIES OF THIS MAP ARE AVAILABLE  
TO THE PUBLIC AT THE FOLLOWING  
ADDRESS: MAPS, N.C. DEPARTMENT OF TRANSPORTATION  
AND HIGHWAY SAFETY—DIVISION OF HIGHWAYS  
RALEIGH, NORTH CAROLINA 27611

REVISION
1-1-61
1-1-64
1-1-66
1-1-68
1-1-70
1-1-72
1-1-74

UNITED STATES DEPARTMENT OF THE INTERIOR  
NATIONAL PARK SERVICE

**NATIONAL REGISTER OF HISTORIC PLACES  
PROPERTY MAP FORM**

*(Type all entries - attach to or enclose with map)*

**1. NAME**

COMMON

Dean Farm

AND/OR HISTORIC

NUMERIC CODE *(Assigned by NPS)*

MAY 2 1975

**2. LOCATION**

STATE

North Carolina

COUNTY

Franklin

TOWN

Louisburg vicinity

STREET AND NUMBER

North side of N.C. 56, just west of S.R. 1470

**3. MAP REFERENCE**

SOURCE

N.C. Highway Commission Map  
(no USGS map available)

DATE

1974

SCALE

1/2": 1 mile

REQUIREMENTS: PROPERTY BOUNDARIES, WHERE REQUIRED, AND NORTH ARROW:





STATE OF NORTH CAROLINA  
Department of Cultural Resources  
Raleigh 27611

30 January 1975

James E. Holshouser, Jr.  
Governor

Grace J. Rohrer  
Secretary

Division of Archives and History  
Robert E. Stipe, Director

Dr. William J. Murtagh  
National Register of Historic Places  
Department of the Interior  
National Park Service  
18th and C streets, N.W.  
Washington, D. C. 20240

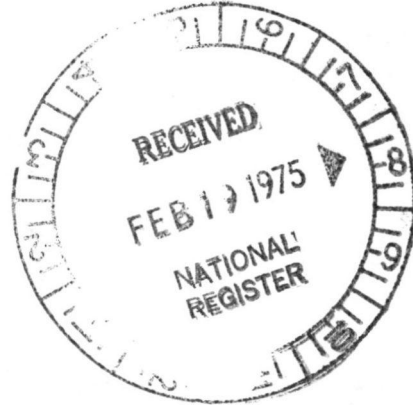

Dear Dr. Murtagh:

We are enclosing a nomination for the Dean Farm in Franklin County, North Carolina, to be entered in the National Register of Historic Places.

We trust you will find this nomination in order. If there are any questions, please call us.

Sincerely yours,

Robert E. Stipe  
State Historic Preservation Officer

enclosures

cc: Hon. Robert Morgan  
Hon. Jesse Helms  
Hon. L. H. Fountain

ENTRIES IN THE NATIONAL REGISTER

STATE NORTH CAROLINA

Date Entered MAY 2 1975

<u>Name</u>	<u>Location</u>
Dean Farm	Louisburg vicinity Franklin County

Also Notified

Hon. Robert B. Morgan  
Hon. Jesse Helms  
Hon. L. H. Fountain  
Regional Director, Southeast  
Region

State Historic Preservation Officer  
Mr. Robert E. Stipe  
Director, Division of Archives and History  
Dept. of Cultural Resources  
109 East Jones St.  
Raleigh, North Carolina 27611

NORTH  
CAROLINA  
DEPARTMENT  
OF  
CULTURAL  
RESOURCES

January 25, 1978



Raleigh,  
North Carolina  
27611

Dr. William J. Murtagh  
National Register of Historic Places  
Department of the Interior  
National Park Service  
18th and C Streets, NW  
Washington, DC 20240

Dear Dr. Murtagh:

This letter contains new information pertinent to a National Register nomination listed for North Carolina. Please correct your records accordingly.

CHANGE OF INFORMATION REGARDING NATIONAL REGISTER NOMINATIONS

Name of Property Dean Farm  
County & State Franklin County, North Carolina  
Town/Vicinity Louisburg vicinity

DESCRIPTION OF CHANGE: In significance:

The 414-acre farm was the home of Harvel Harris who bought it in 1857 for \$5,010 from William Jackson (DB 32, p. 414). It was sold to G. W. Stokes in 1867 for \$2,500. Stokes probably sold it to Thomas Dean, his brother-in-law (DB 34, p. 448). The place has stayed in the Dean family for the last century.

Sincerely yours,

*Catherine W. Bishir*

Catherine W. Bishir, Head  
Survey and Planning Branch  
Archeology/Historic Preservation Section

Division of  
Archives and History  
Larry E. Tise, Director

Sara W. Hodgkins,  
Secretary  
James B. Hunt, Jr.,  
Governor

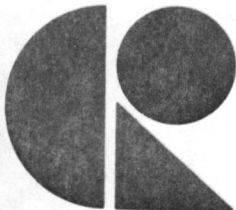

# NATIONAL REGISTER DATA SHEET

1 NAME as it appears on federal register: Dean Farm 2 OTHER NAMES: \_\_\_\_\_ 3 date of entry: 5-2-75 4 county code: 069

5 LOCATION street & number 6 mi. E of Louisburg on NC 56 city / town Louisburg vicinity of Louisburg state NC county Franklin 6 NPS REGION: Southeast

7 OWNER  PRIVATE  STATE  MUNICIPAL  COUNTY  MULTIPLE  FEDERAL (agency name) \_\_\_\_\_ 8 ADMINISTRATOR: \_\_\_\_\_

9 EXISTING SURVEYS  HABS  HAER  NHL 10 FUNDED?  YES  NO 11 CONGRESS. DISTRICT 2 12 SOURCE of NOMINATION  STATE  FEDERAL

13 WITHIN NATIONAL REGISTER HISTORIC DISTRICT?  YES NAME Dean Farm 14 WITHIN NATIONAL HISTORIC LANDMARK?  YES NAME \_\_\_\_\_ 15 ACREAGE 20 if state who prepared form? Maples + History  
 LOCAL  PRIVATE ORGANIZATION

16 CONDITION  deteriorated  altered  original site  
 excellent  ruins  unaltered  moved  
 good  unexposed  reconstructed  unknown  
 fair  unexcavated  excavated

17 features:  SUBSTANTIALLY INTACT-1  SUBSTANTIALLY INTACT-2  SUBSTANTIALLY INTACT-3  
 NOT INTACT-0  NOT INTACT-0  
 UNKNOWN-4  UNKNOWN-5  UNKNOWN-6  
 NOT APPLICABLE-7  NOT APPLICABLE-8  NOT APPLICABLE-9

18 ACCESS  YES-Restricted  YES-Unrestricted  No Access  Unknown 19 ADAPTIVE USE  YES  NO 20 SAVED?  YES  NO IS PROPERTY A HISTORIC DISTRICT?  yes  no

21 AREAS OF SIGNIFICANCE:  ENGINEERING-11  LANDSCAPE ARCH.-15  POLITICS/GOVT.-21  RECREATION-28  
 ARCHEOLOGY-prehistoric-2  COMMERCE-6  ENTERTAINMENT-26  LAW-16  RELIGION-22  SETTLEMENT-29  
 ARCHEOLOGY-historic-1  COMMUNICATIONS-7  EXPLORATION-12  LITERATURE-17  SCIENCE-23  URBAN PLANNING-31  
 AGRICULTURE-3  CONSERVATION-8  HEALTH-27  MILITARY-18  SOCIAL/HUMANITARIAN-24  OTHER (SPECIFY) \_\_\_\_\_  
 ARCHITECTURE-4  ECONOMICS-9  INDUSTRY-13  MUSIC-19  SOCIAL/CULTURAL-30  
 ART-5  EDUCATION-10  INVENTION-14  PHILOSOPHY-20  TRANSPORTATION-25

22 CLAIMS: explain  
 'first'   
 'oldest'   
 'only'

23 functions WHEN HISTORICALLY SIGNIFICANT: Residence 24 dates of initial construction: Unknown c. 1840s pre-1840 major alterations: \_\_\_\_\_ historic events: \_\_\_\_\_ 25 ETHNIC GROUP ASSOCIATION \_\_\_\_\_

26 architectural style(s): Transitional Federal - Greek Revival 27 architect: \_\_\_\_\_ 28 master builder: \_\_\_\_\_ 29 engineer: \_\_\_\_\_

30 landscape architect / garden designer: \_\_\_\_\_ 31 interior decorator: \_\_\_\_\_ 32 artist: \_\_\_\_\_ 33 artisan: \_\_\_\_\_ 34 builder/contractor: \_\_\_\_\_

35 NAMES give role & date  
 PERSONAL: \_\_\_\_\_  
 EVENTS: \_\_\_\_\_  
 INSTITUTIONAL: \_\_\_\_\_

36 NATIONAL REGISTER WRITE-UP  
frame, clapboard, stone foundation; 3 stories, h-shaped, gabled roof, twin stone end chimneys, 1-story hipped tetrastyle entrance porch with fluted columns and turned balustrade, simple gabled entrance, pent roofed side porches set between chimney bases, pedimented gable ends with flush siding, corner pilasters, wide frieze, interior Greek Revival and Federal moldings. On buildings; include 19th C. Smokehouse, corn cobs and harness store, family cemetery. Transitional →

30/ Federal  
Greek Revival. Well-preserved example of <sup>19<sup>th</sup> C</sup> rural N.C. farmstead featuring  
~~exhibiting~~ full complement of log and plank outbuildings; ~~in~~ <sup>one</sup> continuous  
use by ~~the~~ <sup>one</sup> family since construction.