

United States Department of the Interior  
National Park Service

National Register of Historic Places  
Inventory—Nomination Form

For NPS use only

received JAN - 9 1984

date entered

See instructions in *How to Complete National Register Forms*  
Type all entries—complete applicable sections

1. Name

historic Bear Creek Baptist Church

and/or common

2. Location

street & number Rural Route N of Kirksville off US 63 not for publication

city, town Kirksville Mo. X vicinity of

state MO code 29 county Adair code 001

3. Classification

Category	Ownership	Status	Present Use
<input type="checkbox"/> district	<input type="checkbox"/> public	<input type="checkbox"/> occupied	<input type="checkbox"/> agriculture
<input checked="" type="checkbox"/> building(s)	<input checked="" type="checkbox"/> private	<input checked="" type="checkbox"/> unoccupied	<input type="checkbox"/> commercial
<input type="checkbox"/> structure	<input type="checkbox"/> both	<input type="checkbox"/> work in progress	<input type="checkbox"/> educational
<input type="checkbox"/> site	<b>Public Acquisition</b>	<b>Accessible</b>	<input type="checkbox"/> entertainment
<input type="checkbox"/> object	<input type="checkbox"/> in process	<input checked="" type="checkbox"/> yes: restricted	<input type="checkbox"/> government
	<input type="checkbox"/> being considered	<input type="checkbox"/> yes: unrestricted	<input type="checkbox"/> industrial
		<input type="checkbox"/> no	<input type="checkbox"/> military
			<input type="checkbox"/> museum
			<input type="checkbox"/> park
			<input type="checkbox"/> private residence
			<input checked="" type="checkbox"/> religious
			<input type="checkbox"/> scientific
			<input type="checkbox"/> transportation
			<input type="checkbox"/> other:

4. Owner of Property

name Bear Creek Cemetery Association of Adair County

street & number c/o Cecelia Mihalevich  
810 E Mill St.

city, town Kirksville vicinity of state MO 63501

5. Location of Legal Description

courthouse, registry of deeds, etc. Recorder of Deeds

street & number Adair County Courthouse

city, town Kirksville state MO 63501

6. Representation in Existing Surveys

title Missouri State Historical Survey has this property been determined eligible? X yes no

date 1983 federal X state county local

depository for survey records Department of Natural Resources  
Historic Preservation Program

city, town P.O.Box 176 Jefferson City, state MO 65201

## 7. Description

**Condition**

excellent  
 good  
 fair  
 deteriorated  
 ruins  
 unexposed

**Check one**

unaltered  
 altered

**Check one**

original site  
 moved date \_\_\_\_\_

**Describe the present and original (if known) physical appearance**

This one room frame structure is rectangular in shape (approximately 39'8" x 24'6"), sits on a molded concrete block foundation and a hewn log sill, and has a gable roof covered in asphalt shingles. Of timber frame construction, it is sheathed in clapboarding which is accented by plain cornerboards and a raking cornice. Two single leaf entrances on the front gable end are capped by trabeated headers. This motif is repeated over the three 1-over-1 windows on both the east and west facades, and over the rear facade single leaf doorway. Typically the church building is of a plain one room styling and design found throughout the midwest.

Its interior detailing is also quite simple. Millwork is not a decorative feature; it has been painted a flat color. A 10'6" x 7'10" raised platform with pulpit is in the south end of the building. Its front corners are chamfered. Small, unadorned pews remain intact and are situated to form a central aisle. A stove in the north end provides heat.

Alterations including the current molded concrete foundation, which probably replaced a field stone footing, have been minimal and are not deterrents to the merits of the building. There has been some minor attempts to update the building's interior (see photo 3).

# 8. Significance

Period	Areas of Significance—Check and justify below			
<input type="checkbox"/> prehistoric	<input type="checkbox"/> archeology-prehistoric	<input type="checkbox"/> community planning	<input type="checkbox"/> landscape architecture	<input checked="" type="checkbox"/> religion
<input type="checkbox"/> 1400-1499	<input type="checkbox"/> archeology-historic	<input type="checkbox"/> conservation	<input type="checkbox"/> law	<input type="checkbox"/> science
<input type="checkbox"/> 1500-1599	<input type="checkbox"/> agriculture	<input type="checkbox"/> economics	<input type="checkbox"/> literature	<input type="checkbox"/> sculpture
<input type="checkbox"/> 1600-1699	<input checked="" type="checkbox"/> architecture	<input type="checkbox"/> education	<input type="checkbox"/> military	<input type="checkbox"/> social/
<input type="checkbox"/> 1700-1799	<input type="checkbox"/> art	<input type="checkbox"/> engineering	<input type="checkbox"/> music	<input type="checkbox"/> humanitarian
<input checked="" type="checkbox"/> 1800-1899	<input type="checkbox"/> commerce	<input checked="" type="checkbox"/> exploration/settlement	<input type="checkbox"/> philosophy	<input type="checkbox"/> theater
<input type="checkbox"/> 1900-	<input type="checkbox"/> communications	<input type="checkbox"/> industry	<input type="checkbox"/> politics/government	<input type="checkbox"/> transportation
		<input type="checkbox"/> invention		<input type="checkbox"/> other (specify)

Specific dates      c. 1860      Builder/Architect

### Statement of Significance (in one paragraph)

The Bear Creek Baptist Church is significant due to the fact that 1) it housed the first organized christian congregation formed within the county and that 2) it remains the oldest extant Adair County church building. The associations developed among the members of these early settlers played an important role both in their religious and social lives, as well as helping to develop within the group a sense of community, a sense of place. These features, combined with the most typical of early public architectural styles - a simple, one room, gable roofed building - embody the distinctive characteristics of the pioneer effort toward settlement and religion and, therefore, stability within their lives.

### Historical Data

About 1835, the early settlers of the area began to meet for religious services, with the earliest recorded service being held in 1836 and conducted by the Rev. Abraham Still, father of A.T. Still, founder of osepathic medicine. In late 1839 or early 1840, some of the christian families in the Bear Creek neighborhood, west of the present site of the city of Kirksville, met with the Rev. A.T. Hight, an itinerate Baptist preacher, at the home of Lewis Conner to organize a church. The resulting Bear Creek Church was the first organized christian congregation formed in the area that would be organized as Adair County (1841). For many years thereafter, services were held in the homes of the members with the Rev. Lewis Conner serving as the pastor until his death in 1856.

The Rev. Conner was buried in a plot on his land which he may have informally donated for a burial site and a church. Some bodies had already been interred there before 1856. Substantuating this idea, is the fact that the administrator of Conner's estate, his brother - Washington Conner, deeded in 1860 the plot, consisting of approximately 1.4 acres, to the Church of Bear Creek " for meetinghouse and public burying ground." Construction of the building began no later than 1860 and possibly somewhat earlier. The Civil War, however, delayed its completion until shortly after Appomattox.

Bear Creek Church grew and prospered during the ensuing years. It hosted the Macon Baptist Association in 1872 and continued to be a focal point of religious activity in the area until the last recorded service was held on February 7, 1914. Since then services have been held intermittently in the church. It last received public attention when, on October 27, 1946, the First Baptist Church of Kirksville dedicated a memorial erected near the church to the pioneers who founded the Bear Creek Baptist Church of Adair County. The memorial reads "This boulder marks the site of the First Church in Adair County known as Bear Creek Baptist Church, organized in 1838-39 by Rev. Talbot Hight. Charter members included the Asher, Barnes, Collett, Conner, Hibbard, Huston,

## 9. Major Bibliographical References

A Book of Adair County History, published by the Kirksville-Adair County Bicentennial Committee, Simpson Printing Co., Kirksville, MO., 1976  
Deed Record, Book I, p.132, Office of the Recorder of Deeds, Adair County Courthouse, Kirksville, MO

## 10. Geographical Data

Acreeage of nominated property 1.4 acres

Quadrangle name Novinger, MO 7'5 / Kirksville, MO 7.5'

Quadrangle scale 1:24,000

### UTM References

A 

1	5	5	3	1	8	7	0	4	4	5	4	4	4	0
Zone			Easting					Northing						

B 

Zone			Easting					Northing						

C 

Zone			Easting					Northing						

D 

Zone			Easting					Northing						

E 

Zone			Easting					Northing						

F 

Zone			Easting					Northing						

G 

Zone			Easting					Northing						

H 

Zone			Easting					Northing						

### Verbal boundary description and justification

The church and cemetery are contained in a 1.4 acre lot surrounded by a wire fence. The lot sits on the south side of County Road D, approximately 2¼ miles NW of Kirksville, MO. It is the original lot as deeded to the congregation, and is located in the NE¼ of the

### List all states and counties for properties overlapping state or county boundaries

state code county code

state code county code

## 11. Form Prepared By

name/title 1) Linda Donovan Harper, Historic Preservation Specialist

organization date 9-15-83

street & number #4 Shady Lane telephone 816-665-0806

city or town Kirksville state MO 63501

## 12. State Historic Preservation Officer Certification

The evaluated significance of this property within the state is:

national  state  local

As the designated State Historic Preservation Officer for the National Historic Preservation Act of 1966 (Public Law 89-665), I hereby nominate this property for inclusion in the National Register and certify that it has been evaluated according to the criteria and procedures set forth by the National Park Service.

State Historic Preservation Officer signature

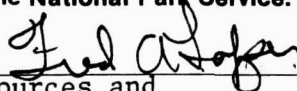

Director, Department of Natural Resources and

title State Historic Preservation Officer

date 12-5-83

For NPS use only

I hereby certify that this property is included in the National Register

date

Keeper of the National Register

Attest:

date

Chief of Registration

**United States Department of the Interior  
National Park Service**

**National Register of Historic Places  
Inventory—Nomination Form**

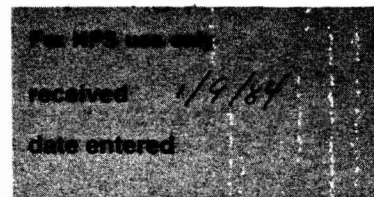

Continuation sheet BEAR CREEK BAPTIST CHURCH Item number 8 Page 1

Lloyd, Myers, and Willis Families. Erected by the Business Woman's Circle of the Women's Missionary Society of the First Baptist Church, Kirksville, Missouri, dedicated 1946"

Today, both the church and the nearby public cemetery are maintained by the Bear Creek Cemetery Association of Adair County, a not for profit corporation established on May 28, 1982.

Continuation Item number 9 Page 1

- Montgomery, Maxine, "Pioneer Days in Adair County," Kirksville Daily Express & News, Kirksville, MO., September 12, 1979.
- Ryle, Walter H., Centennial History of the First Baptist Church of Kirksville, Kirksville, MO., 1968, pp.24-32.
- Selby, Paul O., "The Rural and Village Churches of Adair County", MSS., 1964, Pickler Library, NMSU, p. 31.
- Violette, Eugene M., History of Adair County, Kirksville, MO, 1911, p. 129.

Continuation Item number 10 Page 1

NW $\frac{1}{4}$  of the NW $\frac{1}{4}$  of Section 30, T 63 N, R 15 W. The small frame church is located in the NW corner of the lot, sits close to the road, and faces north. The cemetery extends to the south and east. A narrow ravine divides the cemetery and creates gentle slopes within the fenced area.

Continuation Item number 11 Page 1

- 2) Dr. David March, Historian & Professor of History, NMSU  
9-15-83  
715 S. Halliburton 816-665-4502  
Kirksville MO 63501

**United States Department of the Interior  
National Park Service**

**National Register of Historic Places  
Inventory—Nomination Form**

For NPS use only

received

date entered

Continuation sheet BEAR CREEK BAPTIST CHURCH Item number 11

Page 2

- 3) James M. Denny, Chief, Survey & Registration  
and State Contact Person  
Division of Parks & Historic Preservation 9-15-83  
P.O. Box 176 314/751-4096  
Jefferson City, Mo. 65102

BEAR CREEK CHURCH  
ADAIR COUNTY, MO.

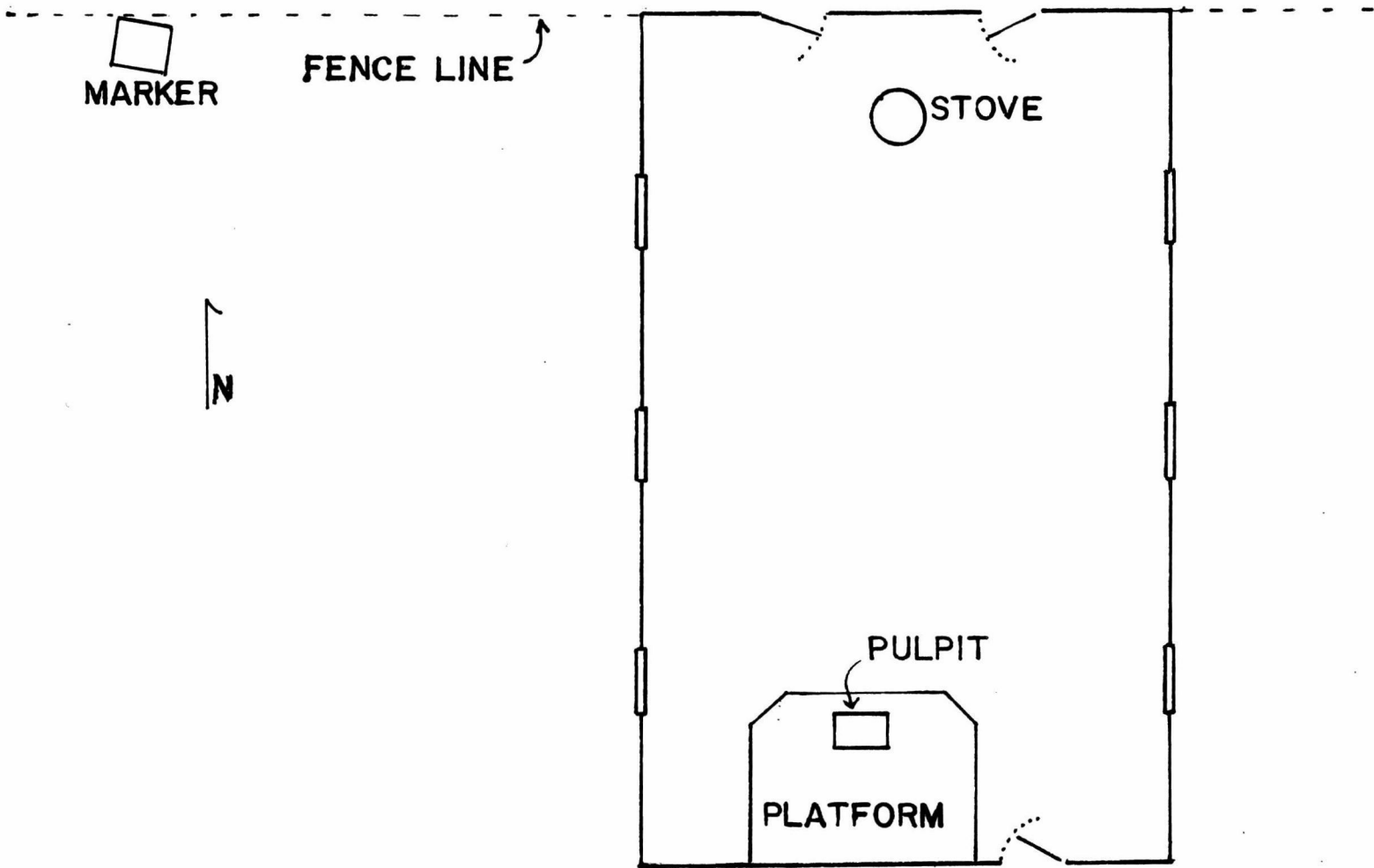

SCALE:  $1/8" = 1'$

NATIONAL REGISTER OF HISTORIC PLACES  
EVALUATION/RETURN SHEET

Bear Creek Baptist Church  
Adair County  
MISSOURI

Working No. JAN 9 1984

Fed. Reg. Date: \_\_\_\_\_

Date Due: 2/9/84 - 2/23/84

Action: ACCEPT

RETURN 1/30/84

REJECT

Federal Agency: \_\_\_\_\_

- resubmission
- nomination by person or local government
- owner objection
- appeal

Substantive Review:  sample  request  appeal  NR decision

Reviewer's comments:

Recom./Criteria \_\_\_\_\_

Reviewer \_\_\_\_\_

Discipline \_\_\_\_\_

Date \_\_\_\_\_

\_\_\_\_\_ see continuation sheet

Nomination returned for:  technical corrections cited below  
 substantive reasons discussed below

1. Name

2. Location

3. Classification

Category	Ownership <u>Public Acquisition</u>	Status Accessible	Present Use
----------	--	----------------------	-------------

4. Owner of Property

5. Location of Legal Description

6. Representation in Existing Surveys

Has this property been determined eligible?  yes  no

7. Description

Condition

- excellent
- good
- fair
- deteriorated
- ruins
- unexposed

Check one

- unaltered
- altered

Check one

- original site
- moved date \_\_\_\_\_

Describe the present and original (if known) physical appearance

- summary paragraph
- completeness
- clarity
- alterations/integrity
- dates
- boundary selection

**8. Significance**

Period      Areas of Significance—Check and justify below

Specific dates                      Builder/Architect  
Statement of Significance (*in one paragraph*)

- summary paragraph
- completeness
- clarity
- applicable criteria
- justification of areas checked
- relating significance to the resource
- context
- relationship of integrity to significance
- justification of exception
- other

**9. Major Bibliographical References**

X **10. Geographical Data**

Acreage of nominated property \_\_\_\_\_  
Quadrangle name \_\_\_\_\_  
UTM References \_\_\_\_\_

X Verbal boundary description and justification *Please provide a description of nominated area such as a tax parcel or lot number, measured boundary or plat map drawn to scale*

**11. Form Prepared By**

**12. State Historic Preservation Officer Certification**

The evaluated significance of this property within the state is:

\_\_\_\_ national      \_\_\_\_ state      \_\_\_\_ local

State Historic Preservation Officer signature

title                      date

**13. Other**

- Maps
- Photographs
- Other

Questions concerning this nomination may be directed to \_\_\_\_\_

Signed *Melvin Byers*      Date *1/30/84*      Phone: *202-343-9573*

United States Department of the Interior  
National Park Service

National Register of Historic Places  
Inventory—Nomination Form

For NPS use only  
received JAN 9 1984  
date entered

See instructions in *How to Complete National Register Forms*  
Type all entries—complete applicable sections

1. Name

historic Bear Creek Baptist Church

and/or common

2. Location

street & number Rural Route N of Kirksville off U.S. 63 not for publication

city, town Kirksville vic. X vicinity of

state MO code 29 county Adair code 001

3. Classification

Category	Ownership	Status	Present Use
<input type="checkbox"/> district	<input type="checkbox"/> public	<input type="checkbox"/> occupied	<input type="checkbox"/> agriculture
<input checked="" type="checkbox"/> building(s)	<input checked="" type="checkbox"/> private	<input checked="" type="checkbox"/> unoccupied	<input type="checkbox"/> commercial
<input type="checkbox"/> structure	<input type="checkbox"/> both	<input type="checkbox"/> work in progress	<input type="checkbox"/> educational
<input type="checkbox"/> site	<b>Public Acquisition</b>	<b>Accessible</b>	<input type="checkbox"/> entertainment
<input type="checkbox"/> object	<input type="checkbox"/> in process	<input checked="" type="checkbox"/> yes: restricted	<input type="checkbox"/> government
	<input type="checkbox"/> being considered	<input type="checkbox"/> yes: unrestricted	<input type="checkbox"/> industrial
	<input checked="" type="checkbox"/> NA	<input type="checkbox"/> no	<input type="checkbox"/> military
			<input type="checkbox"/> museum
			<input type="checkbox"/> park
			<input type="checkbox"/> private residence
			<input checked="" type="checkbox"/> religious
			<input type="checkbox"/> scientific
			<input type="checkbox"/> transportation
			<input type="checkbox"/> other:

4. Owner of Property

name Bear Creek Cemetery Association of Adair County

c/o Cecelia Mihalevich,  
street & number 810 E Mill St.

city, town Kirksville vicinity of state MO 63501

5. Location of Legal Description

courthouse, registry of deeds, etc. Recorder of Deeds

street & number Adair County Courthouse

city, town Kirksville state MO 63501

6. Representation in Existing Surveys

title Missouri State Historical Survey has this property been determined eligible? X yes no

date 1983 federal X state county local

depository for survey records Department of Natural Resources  
Historic Preservation Program

city, town P.O.Box 176 Jefferson City, state MO 65201

# 7. Description

<b>Condition</b>		<b>Check one</b>	<b>Check one</b>
<input type="checkbox"/> excellent	<input type="checkbox"/> deteriorated	<input type="checkbox"/> unaltered	<input checked="" type="checkbox"/> original site
<input checked="" type="checkbox"/> good	<input type="checkbox"/> ruins	<input checked="" type="checkbox"/> altered	<input type="checkbox"/> moved date _____
<input checked="" type="checkbox"/> fair	<input type="checkbox"/> unexposed		

### Describe the present and original (if known) physical appearance

This one room frame structure is rectangular in shape (approximately 39'8" x 24'6"), sits on a molded concrete block foundation and a hewn log sill, and has a gable roof covered in asphalt shingles. Of timber frame construction, it is sheathed in clapboarding which is accented by plain cornerboards and a raking cornice. Two single leaf entrances on the front gable end are capped by trabeated headers. This motif is repeated over the three 1-over-1 windows on both the east and west facades, and over the rear facade single leaf doorway. Typically the church building is of a plain one room styling and design found throughout the midwest.

Its interior detailing is also quite simple. Millwork is not a decorative feature; it has been painted a flat color. A 10'6" x 7'10" raised platform with pulpit is in the south end of the building. Its front corners are chamfered. Small, unadorned pews remain intact and are situated to form a central aisle. A stove in the north end provides heat.

Alterations including the current molded concrete foundation, which probably replaced a field stone footing, have been minimal and are not deterrents to the merits of the building. There has been some minor attempts to update the building's interior (see photo 3).

## 8. Significance

Period	Areas of Significance—Check and justify below			
<input type="checkbox"/> prehistoric	<input type="checkbox"/> archeology-prehistoric	<input type="checkbox"/> community planning	<input type="checkbox"/> landscape architecture	<input checked="" type="checkbox"/> religion
<input type="checkbox"/> 1400-1499	<input type="checkbox"/> archeology-historic	<input type="checkbox"/> conservation	<input type="checkbox"/> law	<input type="checkbox"/> science
<input type="checkbox"/> 1500-1599	<input type="checkbox"/> agriculture	<input type="checkbox"/> economics	<input type="checkbox"/> literature	<input type="checkbox"/> sculpture
<input type="checkbox"/> 1600-1699	<input checked="" type="checkbox"/> architecture	<input type="checkbox"/> education	<input type="checkbox"/> military	<input type="checkbox"/> social/ humanitarian
<input type="checkbox"/> 1700-1799	<input type="checkbox"/> art	<input type="checkbox"/> engineering	<input type="checkbox"/> music	<input type="checkbox"/> theater
<input checked="" type="checkbox"/> 1800-1899	<input type="checkbox"/> commerce	<input checked="" type="checkbox"/> exploration/settlement	<input type="checkbox"/> philosophy	<input type="checkbox"/> transportation
<input type="checkbox"/> 1900-	<input type="checkbox"/> communications	<input type="checkbox"/> industry	<input type="checkbox"/> politics/government	<input type="checkbox"/> other (specify)
		<input type="checkbox"/> invention		

**Specific dates** c. 1860

**Builder/Architect**

### Statement of Significance (in one paragraph)

The Bear Creek Baptist Church is significant due to the fact that 1) it housed the first organized christian congregation formed within the county and that 2) it remains the oldest extant Adair County church building. The associations developed among the members of these early settlers played an important role both in their religious and social lives, as well as helping to develop within the group a sense of community, a sense of place. These features, combined with the most typical of early public architectural styles - a simple, one room, gable roofed building - embody the distinctive characteristics of the pioneer effort toward settlement and religion and, therefore, stability within their lives.

### Historical Data

About 1835, the early settlers of the area began to meet for religious services, with the earliest recorded service being held in 1836 and conducted by the Rev. Abraham Still, father of A.T. Still, founder of osepopathic medicine. In late 1839 or early 1840, some of the christian families in the Bear Creek neighborhood, west of the present site of the city of Kirksville, met with the Rev. A.T. Hight, an itinerate Baptist preacher, at the home of Lewis Conner to organize a church. The resulting Bear Creek Church was the first organized christian congregation formed in the area that would be organized as Adair County (1841). For many years thereafter, services were held in the homes of the members with the Rev. Lewis Conner serving as the pastor until his death in 1856.

The Rev. Conner was buried in a plot on his land which he may have informally donated for a burial site and a church. Some bodies had already been interred there before 1856. Substantuating this idea, is the fact that the administrator of Conner's estate, his brother - Washington Conner, deeded in 1860 the plot, consisting of approximately 1.4 acres, to the Church of Bear Creek " for meetinghouse and public burying ground." Construction of the building began no later than 1860 and possibly somewhat earlier. The Civil War, however, delayed its completion until shortly after Appomattox.

Bear Creek Church grew and prospered during the ensuing years. It hosted the Macon Baptist Association in 1872 and continued to be a focal point of religious activity in the area until the last recorded service was held on February 7, 1914. Since then services have been held intermittently in the church. It last received public attention when, on October 27, 1946, the First Baptist Church of Kirksville dedicated a memorial erected near the church to the pioneers who founded the Bear Creek Baptist Church of Adair County. The memorial reads "This boulder marks the site of the First Church in Adair County known as Bear Creek Baptist Church, organized in 1838-39 by Rev. Talbot Hight. Charter members included the Asher, Barnes, Collett, Conner, Hibbard, Huston,

## 9. Major Bibliographical References

A Book of Adair County History, published by the Kirksville-Adair County Bicentennial Committee, Simpson Printing Co., Kirksville, MO., 1976  
 Deed Record, Book I, p.132, Office of the Recorder of Deeds, Adair County Courthouse, Kirksville, MO

## 10. Geographical Data

Acreeage of nominated property 1.4 acres

Quadrangle name Novinger, MO 7'5 / Kirksville, MO 7.5'

Quadrangle scale 1:24,000

### UTM References

A 

1	5
---	---

5	3	1	8	7	0
---	---	---	---	---	---

4	4	5	4	4	0
---	---	---	---	---	---

  
 Zone Easting Northing

B 

--	--

--	--	--	--	--	--

--	--	--	--	--	--

  
 Zone Easting Northing

C 

--	--

--	--	--	--	--	--

--	--	--	--	--	--

D 

--	--

--	--	--	--	--	--

--	--	--	--	--	--

E 

--	--

--	--	--	--	--	--

--	--	--	--	--	--

F 

--	--

--	--	--	--	--	--

--	--	--	--	--	--

G 

--	--

--	--	--	--	--	--

--	--	--	--	--	--

H 

--	--

--	--	--	--	--	--

--	--	--	--	--	--

### Verbal boundary description and justification

The church and cemetery are contained in a 1.4 acre lot surrounded by a wire fence. The lot sits on the south side of County Road D, approximately 2¼ miles NW of Kirksville, MO. It is the original lot as deeded to the congregation, and is located in the NE¼ of the

### List all states and counties for properties overlapping state or county boundaries

state	code	county	code

## 11. Form Prepared By

name/title 1) Linda Donovan Harper, Historic Preservation Specialist

organization   date 9-15-83

street & number #4 Shady Lane telephone 816-665-0806

city or town Kirksville state MO 63501

## 12. State Historic Preservation Officer Certification

The evaluated significance of this property within the state is:

national  state  local

As the designated State Historic Preservation Officer for the National Historic Preservation Act of 1966 (Public Law 89-665), I hereby nominate this property for inclusion in the National Register and certify that it has been evaluated according to the criteria and procedures set forth by the National Park Service.

State Historic Preservation Officer signature *Fred A. Lofgren*  
 Director, Department of Natural Resources and  
 title State Historic Preservation Officer date 12-5-83

For NPS use only	
I hereby certify that this property is included in the National Register	
<u><i>J. Nelson Bryan</i></u> Keeper of the National Register	Entered in the National Register date <u>3/29/84</u>
Attest:	date
Chief of Registration	



**United States Department of the Interior  
National Park Service**

**National Register of Historic Places  
Inventory—Nomination Form**

For NPS use only

received

date entered

Continuation sheet BEAR CREEK BAPTIST CHURCH Item number 11

Page 1

- 
- 2) Dr. David March, Historian & Professor of History, NMSU  
9-15-83  
715 S. Halliburton 816-665-4502  
Kirksville MO 63501
- 3) James M. Denny, Chief, Survey & Registration  
and State Contact Person  
Division of Parks & Historic Preservation 9-15-83  
P.O. Box 176 314/751-4096  
Jefferson City, Mo. 65102

BEAR CREEK CHURCH  
ADAIR COUNTY, MO.

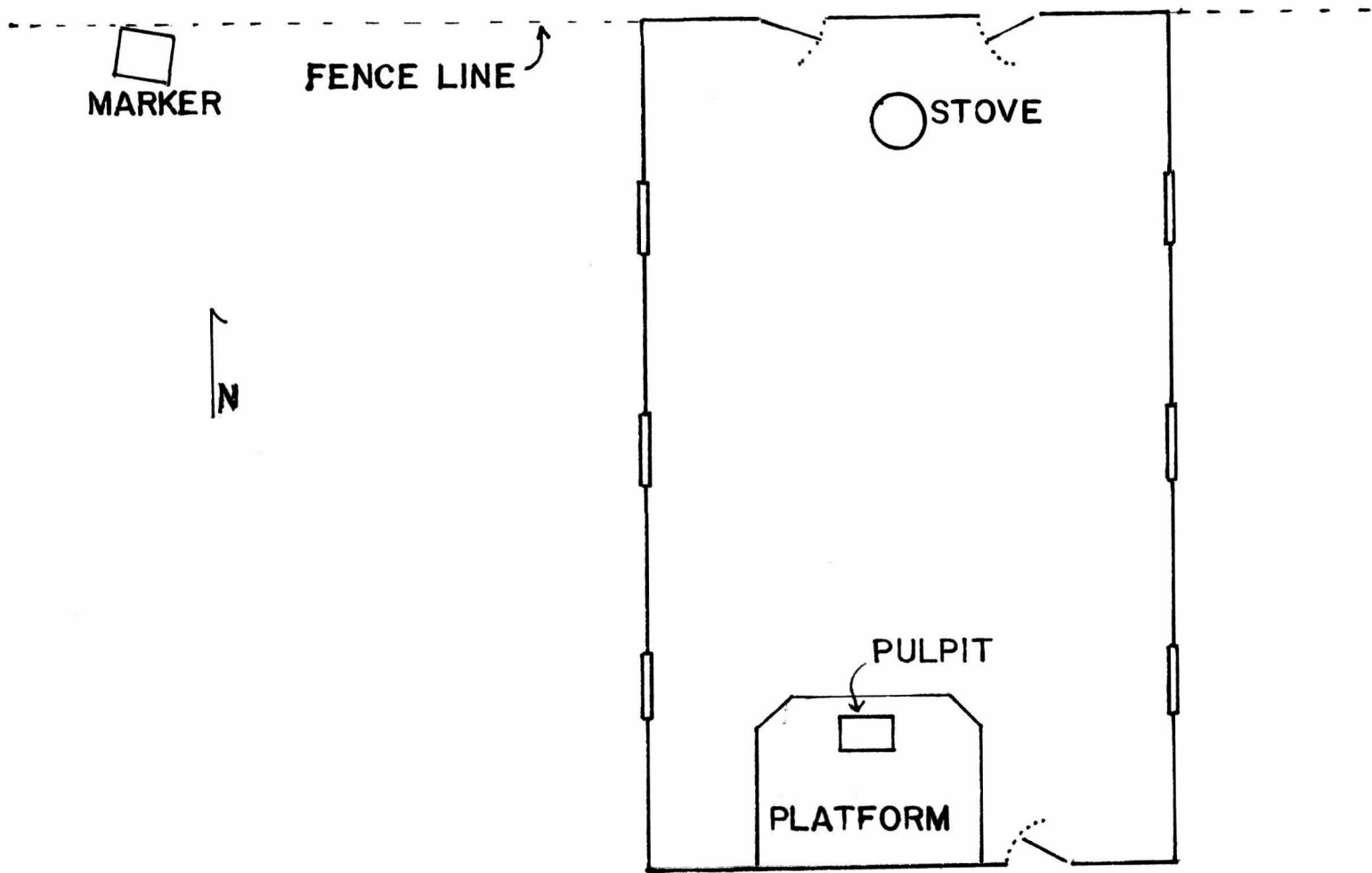

SCALE:  $1/8" = 1'$

NATIONAL REGISTER OF HISTORIC PLACES  
EVALUATION/RETURN SHEET

Bear Creek Baptist Church  
Adair County  
MISSOURI

Working No. Jan 9, 1984  
Fed. Reg. Date: 2/5/85  
Date Due: 5/4/84  
Action: ACCEPT 3/29/84  
Entered in the RETURN  
National Register REJECT  
Federal Agency: \_\_\_\_\_

- resubmission
- nomination by person or local government
- owner objection
- appeal

Substantive Review:  sample  request  appeal  NR decision

Reviewer's comments:

Recom./Criteria \_\_\_\_\_  
Reviewer \_\_\_\_\_  
Discipline \_\_\_\_\_  
Date \_\_\_\_\_  
\_\_\_\_\_ see continuation sheet

Nomination returned for: \_\_\_\_\_ technical corrections cited below  
\_\_\_\_\_ substantive reasons discussed below

1. Name

2. Location

3. Classification

Category	Ownership	Status	Present Use
	Public Acquisition	Accessible	

4. Owner of Property

5. Location of Legal Description

6. Representation in Existing Surveys

Has this property been determined eligible?  yes  no

7. Description

Condition

- excellent
- good
- fair
- deteriorated
- ruins
- unexposed

Check one

- unaltered
- altered

Check one

- original site
- moved date \_\_\_\_\_

Describe the present and original (if known) physical appearance

- summary paragraph
- completeness
- clarity
- alterations/integrity
- dates
- boundary selection

---

**8. Significance**

Period      Areas of Significance—Check and justify below

Specific dates                      Builder/Architect  
Statement of Significance (*in one paragraph*)

- summary paragraph
- completeness
- clarity
- applicable criteria
- justification of areas checked
- relating significance to the resource
- context
- relationship of integrity to significance
- justification of exception
- other

---

**9. Major Bibliographical References**

---

**10. Geographical Data**

Acreage of nominated property \_\_\_\_\_

Quadrangle name \_\_\_\_\_

UTM References

---

Verbal boundary description and justification

---

**11. Form Prepared By**

---

**12. State Historic Preservation Officer Certification**

The evaluated significance of this property within the state is:

\_\_\_\_ national      \_\_\_\_ state      \_\_\_\_ local

State Historic Preservation Officer signature

title                      date

---

**13. Other**

- Maps
- Photographs
- Other

Questions concerning this nomination may be directed to \_\_\_\_\_

Signed \_\_\_\_\_ Date \_\_\_\_\_ Phone: \_\_\_\_\_



HISTORIC  
BEAR CREEK CHURCH  
ORGANIZED 1836  
BY PRES. JAMES W. HAYES

BEAR CREEK BAPTIST CHURCH 1 of 4  
Rural Route, Kirksville, Adair County, MO

PHOTOGRAPHER: Linda Donovan Harper

DATE: July, 1983

NEG. LOC.: Adair County Historical  
Society

c/o Dr. David March

715 S. Halliburton

Kirksville, MO 63501

Primary facade (N) & secondary facade (E);  
looking southwest.



BEAR CREEK BAPTIST CHURCH 2 of 4  
Rural Route, Kirksville, Adair County, MO  
PHOTOGRAPHER: Linda Donovan Harper  
DATE: July, 1983  
NEG. LOC.: Adair County Historical  
Society  
c/o Dr. David March  
715 S. Halliburton  
Kirksville, MO 63501  
Rear facade (S) & secondary facade (W);  
looking northeast.



BEAR CREEK BAPTIST CHURCH 3 of 4  
Rural Route, Kirksville, Adair County, MO  
PHOTOGRAPHER: Linda Donovan Harper  
DATE: July, 1983  
NEG. LOC.: Adair County Historical  
Society  
c/o Dr. David March  
715 S. Halliburton  
Kirksville, MO 63501

Interior view; looking south toward the  
platform and pulpit.



BEAR CREEK BAPTIST CHURCH                      4 of 4  
Rural Route, Kirksville, Adair County MO  
PHOTOGRAPHER: Linda Donovan Harper  
DATE:                      July, 1983  
NEG. LOC.:                Adair County Historical  
                                 Society  
                                 c/o Dr. David March  
                                 715 S. Halliburton  
                                 Kirksville, MO 63501

View of cemetery, looking southeast  
from east facade of church.

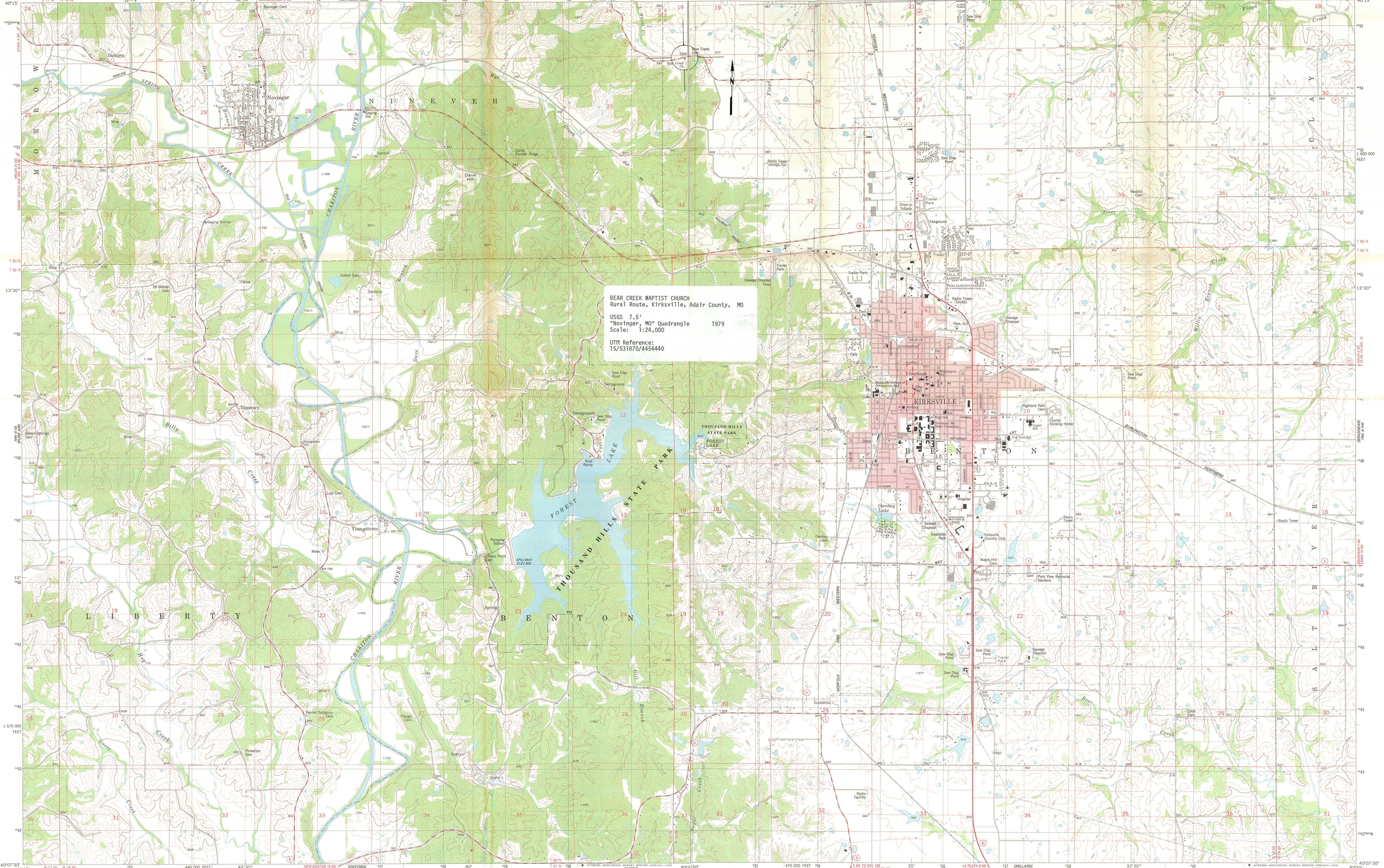

BEAR CREEK BAPTIST CHURCH  
Rural Route, Kirksville, Adair County, MO  
USGS 7.5' Novinger, MO Quadrangle 1979  
Scale: 1:24,000  
UTM Reference: 15/531870/4454440

Mapped, edited, and published by the Geological Survey

Control by USGS and NOS/NOAA  
Topography by photogrammetric methods from aerial photographs taken 1974. Field checked 1975. Map edited 1979  
Projection and 10,000-foot grid ticks: Missouri coordinate system, central zone (Transverse Mercator)  
1,000-meter Universal Transverse Mercator grid, zone 15 1927 North American datum  
Fine red dashed lines indicate selected fence and field lines where generally visible on aerial photographs. This information is unchecked

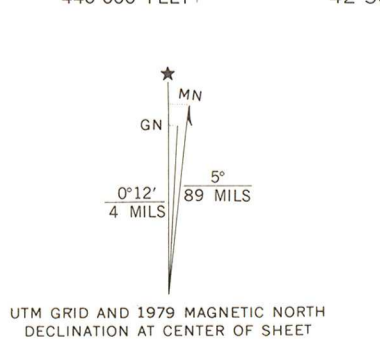

SCALE 1:24,000  
CONTOUR INTERVAL 20 FEET  
DOTTED LINES REPRESENT 10-FOOT CONTOURS  
NATIONAL GEODETIC VERTICAL DATUM OF 1929  
THIS MAP COMPLIES WITH NATIONAL MAP ACCURACY STANDARDS  
FOR SALE BY U. S. GEOLOGICAL SURVEY, DENVER, COLORADO 80225, OR RESTON, VIRGINIA 22092,  
AND THE DIVISION OF RESEARCH AND TECHNICAL INFORMATION  
MISSOURI DEPARTMENT OF NATURAL RESOURCES, ROLLA, MISSOURI 65401  
A FOLDER DESCRIBING TOPOGRAPHIC MAPS AND SYMBOLS IS AVAILABLE ON REQUEST



Mapped, edited, and published by the Geological Survey

Control by USGS and NOS/NOAA  
Topography by photogrammetric methods from aerial photographs taken 1974. Field checked 1975. Map edited 1979  
Projection and 10,000-foot grid ticks: Missouri coordinate system, central zone (Transverse Mercator)  
600-meter Universal Transverse Mercator grid, zone 15 1927 North American datum  
Red tint indicates area in which only landmark buildings are shown  
Fine red dashed lines indicate selected fence and field lines where generally visible on aerial photographs. This information is unchecked

SCALE 1:24,000  
CONTOUR INTERVAL 20 FEET  
NATIONAL GEODETIC VERTICAL DATUM OF 1929  
THIS MAP COMPLIES WITH NATIONAL MAP ACCURACY STANDARDS  
FOR SALE BY U. S. GEOLOGICAL SURVEY, DENVER, COLORADO 80225, OR RESTON, VIRGINIA 22092,  
AND THE DIVISION OF RESEARCH AND TECHNICAL INFORMATION  
MISSOURI DEPARTMENT OF NATURAL RESOURCES, ROLLA, MISSOURI 65401  
A FOLDER DESCRIBING TOPOGRAPHIC MAPS AND SYMBOLS IS AVAILABLE ON REQUEST

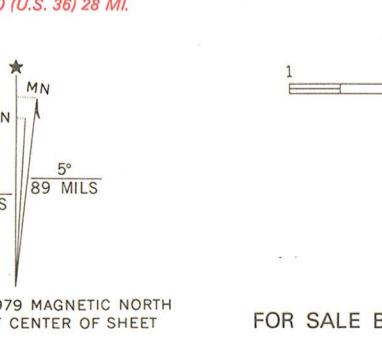

SCALE 1:24,000  
CONTOUR INTERVAL 20 FEET  
NATIONAL GEODETIC VERTICAL DATUM OF 1929  
THIS MAP COMPLIES WITH NATIONAL MAP ACCURACY STANDARDS  
FOR SALE BY U. S. GEOLOGICAL SURVEY, DENVER, COLORADO 80225, OR RESTON, VIRGINIA 22092,  
AND THE DIVISION OF RESEARCH AND TECHNICAL INFORMATION  
MISSOURI DEPARTMENT OF NATURAL RESOURCES, ROLLA, MISSOURI 65401  
A FOLDER DESCRIBING TOPOGRAPHIC MAPS AND SYMBOLS IS AVAILABLE ON REQUEST

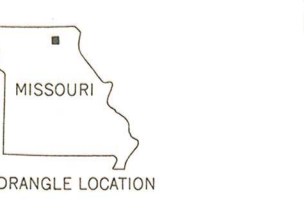

Mapped, edited, and published by the Geological Survey

Control by USGS and NOS/NOAA  
Topography by photogrammetric methods from aerial photographs taken 1974. Field checked 1975. Map edited 1979  
Projection and 10,000-foot grid ticks: Missouri coordinate system, central zone (Transverse Mercator)  
1,000-meter Universal Transverse Mercator grid, zone 15 1927 North American datum  
Fine red dashed lines indicate selected fence and field lines where generally visible on aerial photographs. This information is unchecked

SCALE 1:24,000  
CONTOUR INTERVAL 20 FEET  
NATIONAL GEODETIC VERTICAL DATUM OF 1929  
THIS MAP COMPLIES WITH NATIONAL MAP ACCURACY STANDARDS  
FOR SALE BY U. S. GEOLOGICAL SURVEY, DENVER, COLORADO 80225, OR RESTON, VIRGINIA 22092,  
AND THE DIVISION OF RESEARCH AND TECHNICAL INFORMATION  
MISSOURI DEPARTMENT OF NATURAL RESOURCES, ROLLA, MISSOURI 65401  
A FOLDER DESCRIBING TOPOGRAPHIC MAPS AND SYMBOLS IS AVAILABLE ON REQUEST

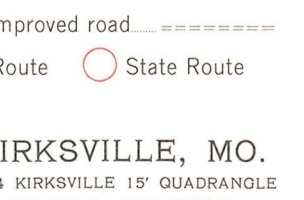

SCALE 1:24,000  
CONTOUR INTERVAL 20 FEET  
NATIONAL GEODETIC VERTICAL DATUM OF 1929  
THIS MAP COMPLIES WITH NATIONAL MAP ACCURACY STANDARDS  
FOR SALE BY U. S. GEOLOGICAL SURVEY, DENVER, COLORADO 80225, OR RESTON, VIRGINIA 22092,  
AND THE DIVISION OF RESEARCH AND TECHNICAL INFORMATION  
MISSOURI DEPARTMENT OF NATURAL RESOURCES, ROLLA, MISSOURI 65401  
A FOLDER DESCRIBING TOPOGRAPHIC MAPS AND SYMBOLS IS AVAILABLE ON REQUEST

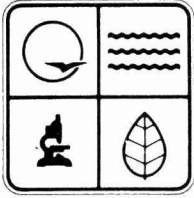

January 3, 1984

MISSOURI DEPARTMENT OF NATURAL RESOURCES

P.O. Box 176 Jefferson City, Missouri 65102 (314) 751-2479

Ms. Carol Shull  
National Register Branch  
Interagency Resources Division  
National Park Service  
1100 L Street, Room 6209  
Washington, D.C. 20240

Dear Carol:

Enclosed please find the following submission from Missouri for nomination to the National Register of Historic Places:

BEAR CREEK BAPTIST CHURCH  
Kirksville, Missouri

This nomination was approved by our State Review Board, the Missouri Advisory Council on Historic Preservation, on November 4, 1983, and has been signed by Missouri's State Historic Preservation Officer, Fred A. Lafser. In accordance with Section 60.6(h) 36 CFR 60, interim regulations, this nomination was not resubmitted to the review board, but all owners and appropriate elected public officials were notified and provided forty-five (45) days to comment on the above proposed nomination in accordance with Section 60.6(c) using the exact notification format recommended by the National Register. No objections, notarized or otherwise, were received for the above referenced nomination.

If there are any questions concerning this submission, please contact James M. Denny of my staff at 314/751-4096.

Sincerely,

DIVISION OF PARKS & HISTORIC PRESERVATION

B.H. Rucker  
Assistant Director

BHR:jkt

Enclosure

Christopher S. Bond Governor  
Fred A. Lafser Director

Division of Parks and Historic Preservation  
John Karel Director

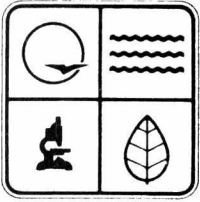

March 8, 1984

MISSOURI DEPARTMENT OF NATURAL RESOURCES

P.O. Box 176 Jefferson City, Missouri 65102 (314) 751-4422

Ms. Carol Shull  
National Register Branch  
Interagency Resources Division  
National Park Service  
1100 L Street, Room 6209  
Washington, D.C. 20240

Dear Carol:

Enclosed is Missouri's resubmission of the Bear Creek Baptist Church, Kirksville vicinity, Missouri.

I am enclosing a copy of the reviewer's comments concerning the reasons for the nomination's return. My staff has researched further the property and I believe the enclosed nomination addresses the reviewer's remarks.

Please contact James M. Denny of my staff immediately if there are additional concerns at 314/751-4096.

Sincerely,

DIVISION OF PARKS & HISTORIC PRESERVATION

  
B. H. Rucker  
Assistant Director

BHR:kn

Enclosures

MAR 20 1984

Christopher S. Bond Governor  
Fred A. Lafser Director