

**United States Department of the Interior
Heritage Conservation and Recreation Service**

**National Register of Historic Places
Inventory—Nomination Form**

For HCRS use only

received JUN 25 1980

date entered

SEP 4 1980

See instructions in *How to Complete National Register Forms*

Type all entries—complete applicable sections

1. Name

historic Iberia Academy and Junior College

and/or common

2. Location

street & number ^{SR SR} Highways 17 & 42 ___ not for publication

city, town Iberia ___ vicinity of congressional district 8th - Hon. Richard Ichord

state Missouri code 029 county Miller code 131

3. Classification

Category	Ownership	Status	Present Use	
<input type="checkbox"/> district	<input type="checkbox"/> public	<input type="checkbox"/> occupied	<input type="checkbox"/> agriculture	<input type="checkbox"/> museum
<input checked="" type="checkbox"/> building(s)	<input checked="" type="checkbox"/> private	<input checked="" type="checkbox"/> unoccupied	<input type="checkbox"/> commercial	<input type="checkbox"/> park
<input type="checkbox"/> structure	<input type="checkbox"/> both	<input type="checkbox"/> work in progress	<input type="checkbox"/> educational	<input checked="" type="checkbox"/> private residence
<input type="checkbox"/> site	Public Acquisition	Accessible	<input type="checkbox"/> entertainment	<input type="checkbox"/> religious
<input type="checkbox"/> object	<input type="checkbox"/> in process	<input checked="" type="checkbox"/> yes: restricted	<input type="checkbox"/> government	<input type="checkbox"/> scientific
	<input type="checkbox"/> being considered	<input type="checkbox"/> yes: unrestricted	<input type="checkbox"/> industrial	<input type="checkbox"/> transportation
		<input type="checkbox"/> no	<input type="checkbox"/> military	<input type="checkbox"/> other:

4. Owner of Property

name Oscar and Myrtle Wilson

street & number Highways 17 & 42

city, town Iberia ___ vicinity of state Missouri 65486

5. Location of Legal Description

courthouse, registry of deeds, etc. Miller County Courthouse

street & number Courthouse Square

city, town Tuscumbia state Missouri 65082

6. Representation in Existing Surveys

1. Lake of the Ozarks Council of
title Local Govt. Historical Survey has this property been determined eligible? ___ yes no

date December, 1979 ___ federal ___ state county ___ local

depository for survey records L.O.C.L.G., P.O. Box 786

city, town Camdenton state Missouri 65020

7. Description

Condition		Check one	Check one
<input type="checkbox"/> excellent	<input type="checkbox"/> deteriorated	<input type="checkbox"/> unaltered	<input checked="" type="checkbox"/> original site
<input checked="" type="checkbox"/> good	<input type="checkbox"/> ruins	<input checked="" type="checkbox"/> altered	<input type="checkbox"/> moved date _____
<input type="checkbox"/> fair	<input type="checkbox"/> unexposed		

Describe the present and original (if known) physical appearance

SITE

Sitting almost in the center of Iberia, Mo., the Iberia Academy and Junior College campus is comprised of four buildings that sit at odd angles within a triangle of approximately 2.66 acres. Three of the four buildings, the dormitory, the administration building and the gymnasium, were constructed largely with student labor. The fourth structure, the "president's home," is believed to have been an existing structure acquired by the academy and absorbed within the property around 1909.¹

A rock wall marks campus boundaries and at the east end of the triangle lies a stone gateway dedicated in the early 1900's by Harriet Nichols Smith, mother of the Academy's founder, G. Byron Smith.² A large stone monument stands about ten feet inside the gate.

EXTERIOR

All four buildings appear to be structurally sound and in good shape on the outside. Two of the structures, the gym and the "ad" building are of native limestone.

Stone for "Martin Gymnasium", named for an early benefactor, was gathered on the premises and from another spot north of Iberia. The coursed rubble stonework is set within large buttresses on a 45' by 90' rectangular floor plan. A pilaster-effect was added to the main entrance on the north side, cut in three pieces and installed by students. The pilasters' caps were hand-cut by stonemasons from Iberia as was the engraving in the triangular pediment above the main entrance of the gym.³

Finished in 1927, Martin Gymnasium was topped with a medium-gable shingled wood roof which is still intact. A shed type dormer was added near the southeast corner.

The same 45' x 90' dimensions were used for the floor plan of the other stone structure, the Administration Building. Built around 1922-1924 the present structure replaced the original structure which burned in 1917. Student laborers and Iberia stonemasons again used native limestone but the rusticated ashlar stonework of the "ad" building consists of larger and more evenly cut stones than those of the gym.⁴

Being basically a classroom building the architecture is rectangular and simple though lasting and functional. Stone lintels were placed above the windows as was a large entablature above the double doors of the main entrance on the east side of the administration building. The wood roof is flat and tar covered.

In contrast the girl's dormitory or "Alumni Hall," built in 1905, is a wood frame structure with a gambrel type roof. All 3 stories, originally shingled, are now covered with weatherboarding. Built on a 45' x 90' rectangular floor plan with an exterior brick chimney in the rear or the southwest facades, it resembles a large residential home more than a modern-day dormitory.

**NATIONAL REGISTER OF HISTORIC PLACES
INVENTORY -- NOMINATION FORM**

FOR HCRS USE ONLY	
RECEIVED	JUN 25 1980
DATE ENTERED	SEP. 4 1980

IBERIA ACADEMY AND JUNIOR COLLEGE

CONTINUATION SHEET

ITEM NUMBER 7 PAGE 1

The oldest building on campus is the president's home believed to have been built about 1888 and later incorporated into the Academy's campus.⁵ It is a two story frame I-type house with a medium gable roof and extended cross gables that cover the rear portion of the house and the front porch and balcony. A back porch wraps around the rear wing of the first floor. The house has two chimneys, one offset to the right and the other on the exterior of the west end. The interior chimney is brick while the exterior appears to be of larger rusticated random ashlar stonework, much the same as the stone used for the administration building. While the house is vernacular the ornate railings and columns of the front porch suggest Eastlake style influence.

INTERIOR

While the exteriors of all four buildings have undergone minimal changes that is not the case with the interiors. Only the Administration building remains unchanged inside. Although it stands vacant, the large high ceilinged class rooms, library and chapel room are just as they were when construction was finished in the early 1920's. Two original large stone fireplaces in the first floor are probably the most interesting interior architectural features of the administration building.

The interior of Martin Gymnasium was altered in the early 1960's to serve the industrial purposes of a raincoat company, although it is used today by another manufacturing company. A middle floor was added as was a one-story concrete block addition that extended the length of the first floor by 16 feet to the northwest.

The interior of Alumni Hall has also been modified to suit a purpose other than the original. Individual rental apartments are now sectioned off and basic remodeling has been done. The old dining room parlor and kitchen are now separate apartments and additional plumbing has been added to serve this purpose. Two things that have remained intact are the original woodwork and nameplates on several doors honoring benefactors that date to the year of construction, 1905.

While the President's house has always been a residence and remains so today, it too has undergone some interior remodeling. Plumbing has been added and repainting, carpeting and paneling have all been undertaken, however, no major structural changes have been made.

FOR HCRS USE ONLY
RECEIVED JUN 25 1980
DATE ENTERED SEP 4 1980

**NATIONAL REGISTER OF HISTORIC PLACES
INVENTORY -- NOMINATION FORM**

IBERIA ACADEMY AND JUNIOR COLLEGE

CONTINUATION SHEET

ITEM NUMBER 7 PAGE 2

ALTERATIONS

Other than the interior changes and the previously mentioned block addition to the gym relatively few alterations have been made through the years to the campus and buildings of Iberia Academy. A closed-in frame porch was added to Alumni Hall's north entrance in the 1950's. What had been an open portico entrance porch with wooden piers was enlarged with shed-roofed extensions to either side and enclosed with windows and weatherboarding. The original doorway and porch columns remain intact within this addition however.

FOOTNOTES

1. A personal interview with Oscar Wilson, present owner, by Launa Jones, April, 1979.
2. "Half Century of Progress: 1890-1940," Iberia Junior College Bulletin, semi-centennial number, New Series, vol. 15, no. 2, p. 3.
3. A personal interview with Rev. Earl Basil Brown, former student, by Launa Jones, April, 1979.
4. Ibid.
5. A personal interview with Robert Law, former student and board of directors member, by Launa Jones, April, 1979.

8. Significance

Period	Areas of Significance—Check and justify below			
<input type="checkbox"/> prehistoric	<input type="checkbox"/> archeology-prehistoric	<input type="checkbox"/> community planning	<input type="checkbox"/> landscape architecture	<input type="checkbox"/> religion
<input type="checkbox"/> 1400–1499	<input type="checkbox"/> archeology-historic	<input type="checkbox"/> conservation	<input type="checkbox"/> law	<input type="checkbox"/> science
<input type="checkbox"/> 1500–1599	<input type="checkbox"/> agriculture	<input type="checkbox"/> economics	<input type="checkbox"/> literature	<input type="checkbox"/> sculpture
<input type="checkbox"/> 1600–1699	<input type="checkbox"/> architecture	<input checked="" type="checkbox"/> education	<input type="checkbox"/> military	<input type="checkbox"/> social/ humanitarian
<input type="checkbox"/> 1700–1799	<input type="checkbox"/> art	<input type="checkbox"/> engineering	<input type="checkbox"/> music	<input type="checkbox"/> theater
<input checked="" type="checkbox"/> 1800–1899	<input type="checkbox"/> commerce	<input type="checkbox"/> exploration/settlement	<input type="checkbox"/> philosophy	<input type="checkbox"/> transportation
<input checked="" type="checkbox"/> 1900–	<input type="checkbox"/> communications	<input type="checkbox"/> industry	<input type="checkbox"/> politics/government	<input type="checkbox"/> other (specify)
		<input type="checkbox"/> invention		

Specific dates 1890–1951

Builder/Architect

Statement of Significance (in one paragraph)

As one of the first sources of secondary and college level education in the southern half of Miller County, the Iberia Academy is historically significant in the area of education. When the first class convened on October 1, 1890, there was not a high school within ten counties.¹

Not until the Public school system began in Iberia in the early 1940's did the academy discontinue the first two years of its four year secondary curriculum.²

Supported mainly by the Congregational Church, the Academy was known early on as the "Ozark Experiment", which was a reflection of its uniqueness in the area.³

It exemplified not only an educational interest from outside the rural Ozark community but also a determination from within the community itself not to be denied education.

The school was founded by a Congregational minister from Arkansas, Richard T. Marlow, and a couple from Illinois, Mabel and G. Byron Smith.⁴

As teachers and administrators the Smiths provided leadership for the Academy for half a century. But it was the students themselves that made the Ozark Experiment pay off. Work of every kind was done by student labor, including most of the construction of the buildings.⁵

While religion and athletics were prominent, the Academy also offered Latin and Greek besides English, history, math and science. According to Mabel Smith the result of this was: "Cabin homes are thus transformed from the commonplace to the centers of culture."⁶

In 1929, Mrs. Smith wrote that the south half of Miller County was a section of country almost as large as the State of Connecticut in which not an hour of college credit was offered. In that same year the Iberia Junior College was started at the Academy and dubbed "experiment number two".⁷

The success of this second endeavor would later have a direct effect on the area's educational system. According to Dr. John Bearden, superintendent of Iberia schools from 1958 to 1965, one-half of the faculty of those schools were graduates of the Iberia Junior College. In addition, teachers who had received their associates' degrees at the Academy made up the bulk of educators at nearby Crocker, Waynesville, Dixon, Tuscumbia and School of the Osage in Lake Ozark.⁸

However, the advent of the public school system began to hurt enrollment in the 1940's and church funding also began to dwindle resulting in a switch towards a more agricultural curriculum at the Academy.⁹

9. Major Bibliographical References

1. Bearden, Dr. John. "Determination of Needs, potential Support and Planning Sequences for a Lake of the Ozarks Junior College." Unpublished doctoral dissertation, 1970.

10. Geographical Data

UTM NOT VERIFIED

Acreeage of nominated property 2 1/2 acres

Quadrangle name "Iberia, Mo."

ACREAGE NOT VERIFIED

Quadrangle scale 1: 62,500

UMT References

A

1	5
---	---

5	6	1	6	7	7
---	---	---	---	---	---

4	2	1	5	8	5	9
---	---	---	---	---	---	---

B

--	--

--	--	--	--

--	--	--	--

C

--	--

--	--	--	--

--	--	--	--

D

--	--

--	--	--	--

--	--	--	--

E

--	--

--	--	--	--

--	--	--	--

F

--	--

--	--	--	--

--	--	--	--

G

--	--

--	--	--	--

--	--	--	--

H

--	--

--	--	--	--

--	--	--	--

Verbal boundary description and justification

The area being nominated is a triangular shaped tract beginning at a point on the inside curb where U.S. Highway 42 and Normal Street intersect, proceed 138 yards West along U.S. Highway 42 and 262 yards Northwest along Normal Street to a driveway and from there

List all states and counties for properties overlapping state or county boundaries

state	code	county	code

state	code	county	code

11. Form Prepared By

name/title 1. Roger Dillon - Historic Preservation Officer

organization Lake of the Ozarks Council of Local Governments date December, 1979

street & number P.O. Box 786 telephone 314/346-5616

city or town Camdenton state Missouri 65020

12. State Historic Preservation Officer Certification

The evaluated significance of this property within the state is:

national state local

As the designated State Historic Preservation Officer for the National Historic Preservation Act of 1966 (Public Law 89-665), I hereby nominate this property for inclusion in the National Register and certify that it has been evaluated according to the criteria and procedures set forth by the Heritage Conservation and Recreation Service.

State Historic Preservation Officer signature Fred A. Lopez

title Director, Department of Natural Resources and State Historic Preservation Officer date May 27, 1980

For HCRS use only

I hereby certify that this property is included in the National Register

acting Carol D. Skelton
Keeper of the National Register

date 9-4-80

Attest: Paula Storer Reed

date 8/29/80

Chief of Registration

**NATIONAL REGISTER OF HISTORIC PLACES
INVENTORY -- NOMINATION FORM**

FOR HCRS USE ONLY
RECEIVED JUN 25 1980
DATE ENTERED SEP 4 1980

IBERIA ACADEMY AND JUNIOR COLLEGE

CONTINUATION SHEET

ITEM NUMBER 8 PAGE 1

For a brief two years the Academy became Conservation College before closing permanently after the final commencement in 1951. Records and libraries were forwarded to Drury College in Springfield, Mo., another institution supported largely by the Congregational Churches of the state. The former campus, with its buildings, was sold to Henry Thompson of Iberia, who later sold the property to Oscar and Myrtle Wilson, the present owners.

FOOTNOTES

1. Mabel Smith, "An Experiment in the Ozarks," 1929. Reprinted in "A Half Century of Progress: 1890-1940".
2. Personal interview with Dr. John Bearden by Launa Jones, April 4, 1979.
3. Mabel Smith essay.
4. "A Half Century of Progress" 1890-1940,: Iberia Junior College Bulletin, semicentennial number, New Series, vol. 15, no. 2, p. 1.
5. Ibid., p. 15.
6. Mabel Smith essay.
7. "A Half Century of Progress: 1890-1940." p. 4.
8. Dr. John Bearden, unpublished doctoral dissertation, "Determination of Needs, Potential support and Planning Sequences for a Lake of the Ozarks Junior College," 1970.
9. Personal interview with Rev. Earl Brown, former publisher of New Iberian, by Launa Jones, April 7, 1979.

FOR HCRS USE ONLY
RECEIVED
DATE ENTERED

NATIONAL REGISTER OF HISTORIC PLACES INVENTORY -- NOMINATION FORM

IBERIA ACADEMY AND JUNIOR COLLEGE

CONTINUATION SHEET

ITEM NUMBER 9 PAGE 1

2. Iberia Junior College Bulletin. "A Half Century of Progress: 1890-1940." semicentennial number, new series, vol. 15, no. 2, 1940.
3. Bearden, John. Interview, 4 April 1979.
4. Brown, Earl Basil. Interview, April, 1979.
5. "Half Century of Progress: 1890-1940." Iberia Junior College Bulletin, vol. 15, no. 2, p. 3.
6. Law, Robert. Interview, April, 1979.
7. Smith, Mabel. "An Experiment in the Ozarks." Iberia Junior College Bulletin, 1929.
8. Wilson, Oscar. Interview, April, 1979.

ITEM NUMBER 10 PAGE 1

approximately 187 yards Southeast to a rock wall along Highway 42 to an intersection with the line previously established along U.S. Highway 42. Contains approximately 2.66 acres.

ITEM NUMBER 11 PAGE 1

- | | |
|---|---|
| <ol style="list-style-type: none"> 2. James M. Denny, Section Chief, Nominations-Survey and State Contact Person
Department of Natural Resources
Historic Preservation Program
P.O. Box 176
Jefferson City | <p>March 18, 1980</p> <p>314/751-4096</p> <p>Missouri 65102</p> |
|---|---|

ITEM NUMBER 6 PAGE 1

- | | |
|--|------------------------------------|
| <ol style="list-style-type: none"> 2. Missouri State Historical Survey
1980
Department of Natural Resources
P.O. Box 176
Jefferson City | <p>state</p> <p>Missouri 65102</p> |
|--|------------------------------------|

SITE PLAN MAP
IBERIA ACADEMY
IBERIA, MISSOURI



NOT TO SCALE

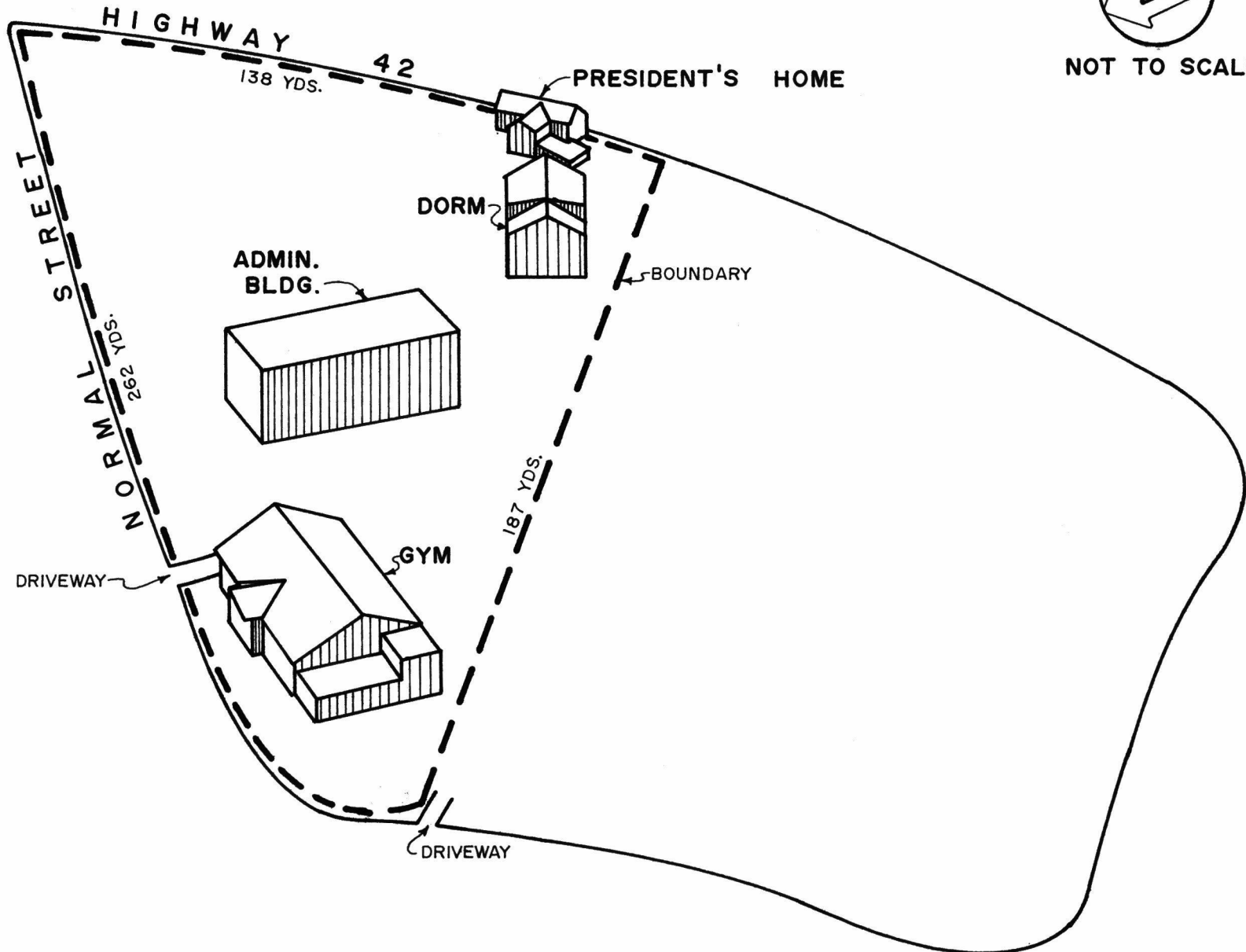

IBERIA, MISSOURI
IBERIA BOARDING
SITE PLAN



NOT TO SCALE



SEP 7 1933

JUN 25 1930

Property

Sberia Academy and Junior College

80002379

State

ME, Miller

Working Number

6.25.80.1647

TECHNICAL

CONTROL

Photos

9

Maps

41

HISTORIAN

This complex is significant as a small private educational facility which operated ^{in rural New York} from 1890-1951. Most of the buildings date from the early 20th century although the "President's house" is probably older. It was, when it began, the only secondary school over a large area (said to be the size of the state of Connecticut) and helped to train many public school teachers in this area of New York.

ARCHITECTURAL HISTORIAN

ARCHEOLOGIST

*Accept. P. Reed.
9/29/80*

OTHER

HAER

Inventory _____

Review _____

REVIEW UNIT CHIEF

Accept. P. Reed 8/29/80

BRANCH CHIEF

KEEPER

National Register Write-up

2.3.81

Send-back _____

Entered

SEP 4 1980

Federal Register Entry

Re-submit _____



IBERIA ACADEMY & JR. COLLEGE
Iberia, Mo. *Miller Co*
Photographer: Tom Chesser
July 1978
Lake of the Ozarks Council of Local Government
BOX 786

CAMDENTON, MISSOURI 65020
Aerial shot of the campus

JUN 25 1980 SEP 4 1980 1 of 9



IBERIA ACADEMY & JR. COLLEGE

Iberia, Mo.

Photographer: Tom Chesser

July 1978 2 of 9

Lake of the Ozarks Council of Local Governments
BOX 786

CAMDENTON, MISSOURI 65020

JUN 25 1980

East entranceway to the campus:
view of gateposts, 'Gettysburg
Address' monument & admin. bldg.

SEP 4 1980



IBERIA ACADEMY & JR. COLLEGE

Iberia, Missouri

Miller Co

Photographer: Tom Chesser

July 1978

LOCLG

P.O.Box 786

Camdenton, Mo. 65020

JUN 25 1980

Administration Bldg.

main entrance, n.e. side

SEP 4 1980

3 of 9



IBERIA ACADEMY & JR. COLLEGE
Iberia, Mo. *Miller Co*
Photographer: Tom Chesser
July 1978

LOCLG

P.O. Box 786

Camdenton, Mo. 65020

Martin Gymnasium
main entrance, north side

SEP 4 1980

JUN 25 1980
4 of 9

MARTIN
GYMNASIUM



IBERIA ACADEMY & JR. COLLEGE
Iberia, Mo. *Miller Co*

Photographer: Tom Chesser

SEP 4 1980 July 1978

Lake of the Ozarks Council of Local Governments
BOX 786

CAMDENTON, MISSOURI 65020

Martin Gymnasium
main entrance

JUN 25 1980

5 of 9



IBERIA ACADEMY & JR. COLLEGE

Iberia, Mo.

Miller co

Photographer: Tom Chesser

July 1978

LOCLG

JUN 25 1980

P.O. Box 786

Camdenton, Mo. 65020

SEP

4 1980

Girl's Dormitory

north entrance (main)

6 of 9



IBERIA ACADEMY & JR. COLLEGE
Iberia, Mo. *Miller co.*

Photographer: Tom Chesser
July 1978

JUN 25 1980

Lake of the Ozarks Council of Local Government
BOX 786

CAMDENTON, MISSOURI 65020

President's Home

Main entrance, south side

SEP 4 1980
7 of 9



IBERIA ACADEMY & JR. COLLEGE

Iberia, Mo.

Photographer: Tom Chesser

086L 5 2 NNC July 1978

Miller ca

Lake of the Ozarks Council of Local Government

BOX 786

CAMDENTON, MISSOURI 65020

Administration Building

Whitelaw Chapel, first floor

SEP 4 1980

8 of 9



IBERIA ACADEMY & JR. COLLEGE
Iberia, Mo. *Miller Co*

SEP 4 1980
Photographer: Tom Chesser
July 1978

Lake of the Ozarks Council of Local Governments
BOX 786

CAMDENTON, MISSOURI 65020

JUN 25 1980
Administration Building
View from library into Whitelaw
Chapel, first floor

9 of 9

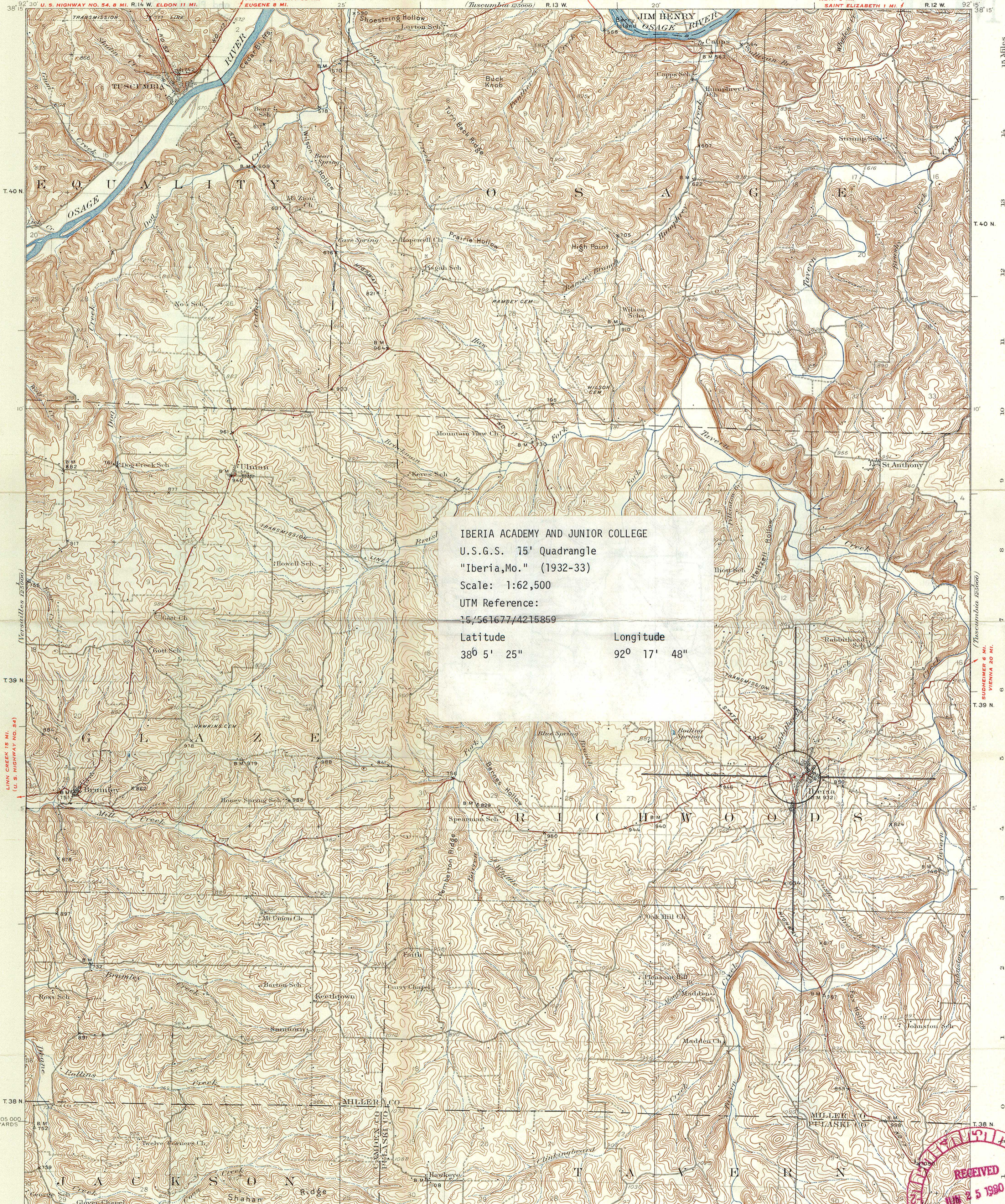

IBERIA ACADEMY AND JUNIOR COLLEGE
U.S.G.S. 15' Quadrangle
"Iberia, Mo." (1932-33)
Scale: 1:62,500
UTM Reference:
15,561677/4215859
Latitude 38° 5' 25" Longitude 92° 17' 48"

Topography by J.B. Leavitt, J.M. Rawls, Daniel Kennedy,
J.B. Leachman, and T.V. Cummins
Control by U.S. Geological Survey
Surveyed in 1932-1933

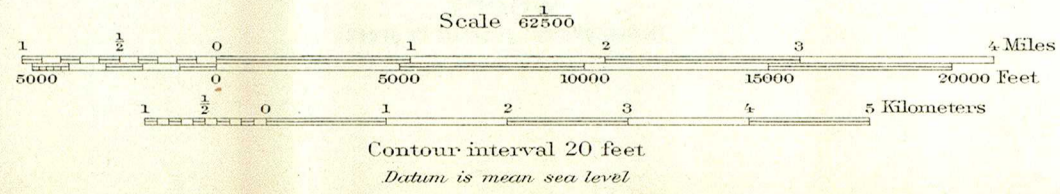

WAYNESVILLE 14 MI. CROCKER 4 MI. R. 12 W. 92° 38' 00"
Polyconic projection, North American datum
5000 yard grid based upon 63 zone system



IBERIA, MO.
Edition of 1937



June 13, 1980



MISSOURI DEPARTMENT OF NATURAL RESOURCES

P.O. Box 176 Jefferson City, Missouri 65102 (314) 751-2479

Ms. Carol Shull
Acting Keeper of the National Register
Department of the Interior
Heritage Conservation & Recreation Service
440 G Street, N.W.
Washington, D.C. 20243

Dear Ms. Shull:

Please find enclosed five (5) completed National Register Inventory-Nomination Forms for:

CONFEDERATE CHAPEL, CEMETERY AND COTTAGE
HARRIS-CHILTON RUBLE HOUSE
HA HA TONKA
CENTRAL METHODIST COLLEGE CAMPUS HISTORIC DISTRICT
IBERIA ACADEMY AND JUNIOR COLLEGE

and related data approved by Missouri's review board, the Missouri Advisory Council on Historic Preservation. These forms are signed by Fred A. Lafser, State Historic Preservation Officer and the Secretary of Interior's most recent owner notification procedures have been observed. These sites are thereby formally nominated to the National Register of Historic Places.

Sincerely,

DIVISION OF PARKS AND HISTORIC PRESERVATION

James M. Denny
James M. Denny
Section Chief, Nominations-Survey

JMD:kld

Enclosures: as stated

cc: Milton Perry

Joseph P. Teasdale Governor
Fred A. Lafser Director

Division of Parks and Historic Preservation
John Karel Director

ENTRIES IN THE NATIONAL REGISTER

STATE MISSOURI

Date Entered SEP 4 1980

<u>Name</u>	<u>Location</u>
Social Institutions of Columbia's Black Community Thematic Resources	Columbia Boone County
Iberia Academy and Junior College	Iberia Miller County
Missouri State Teachers Association	Columbia Boone County
Missouri United Methodist Church	Columbia Boone County
James, Jesse, House	St. Joseph Buchanan County
Eighth and Center Streets Baptist Church	Hannibal Marion County
Harris-Chilton-Ruble House	New Franklin Howard County

Also Notified

Honorable John C. Danforth
Honorable Thomas F. Eagleton
Honorable Richard H. Ichord
Honorable E. Thomas Coleman
Honorable Harold L. Volkmer
Honorable Ike Skelton

State Historic Preservation Officer
Mr. Fred A. Lafser
Director, State Department of
Natural Resources
P.O. Box 176
Jefferson City, Missouri 65102

NR

Byers/jms

9/19/80