

**NATIONAL REGISTER OF HISTORIC PLACES
INVENTORY - NOMINATION FORM**

(Type all entries - complete applicable sections)

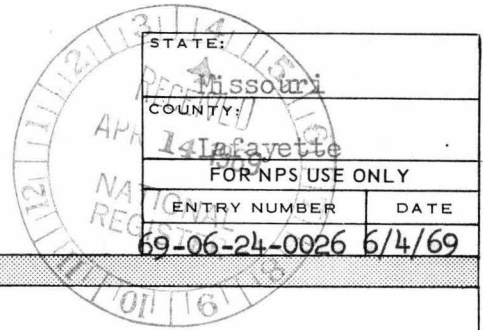

STATE: Missouri	
COUNTY: Lafayette	
FOR NPS USE ONLY	
ENTRY NUMBER 69-06-24-0026	DATE 6/4/69

1. NAME

COMMON:
Anderson House and Lexington Battlefield

AND/OR HISTORIC:
Colonel Oliver Anderson House

2. LOCATION

STREET AND NUMBER:
Sections 27 and 28, Township 51N, Range 27W

CITY OR TOWN:
Lexington

STATE Missouri	CODE 61067	COUNTY: Lafayette	CODE 107
-------------------	---------------	----------------------	-------------

3. CLASSIFICATION

CATEGORY (Check One)	OWNERSHIP	STATUS	ACCESSIBLE TO THE PUBLIC
District <input type="checkbox"/> Building <input checked="" type="checkbox"/>	Public <input checked="" type="checkbox"/> Private <input type="checkbox"/> Both <input type="checkbox"/>	Occupied <input type="checkbox"/> Unoccupied <input checked="" type="checkbox"/> Preservation work in progress <input type="checkbox"/>	Yes: Restricted <input checked="" type="checkbox"/> Unrestricted <input type="checkbox"/> No: <input type="checkbox"/>
Site <input checked="" type="checkbox"/> Structure <input type="checkbox"/> Object <input type="checkbox"/>	Public Acquisition: In Process <input type="checkbox"/> Being Considered <input type="checkbox"/>		

PRESENT USE (Check One or More as Appropriate)

Agricultural <input type="checkbox"/>	Government <input type="checkbox"/>	Park <input checked="" type="checkbox"/>	Transportation <input type="checkbox"/>	Comments <input type="checkbox"/>
Commercial <input type="checkbox"/>	Industrial <input type="checkbox"/>	Private Residence <input type="checkbox"/>	Other (Specify) <input type="checkbox"/>	
Educational <input type="checkbox"/>	Military <input type="checkbox"/>	Religious <input type="checkbox"/>		
Entertainment <input type="checkbox"/>	Museum <input type="checkbox"/>	Scientific <input type="checkbox"/>		

4. OWNER OF PROPERTY

OWNERS NAME:
State of Missouri

STREET AND NUMBER:
Missouri State Park Board
P.O. Box 176, 1204 Jefferson Building

CITY OR TOWN:
Jefferson City

STATE: Missouri	CODE 24
STATE: Missouri	CODE 65101

5. LOCATION OF LEGAL DESCRIPTION

COURTHOUSE, REGISTRY OF DEEDS, ETC:
County Recorder's Office

STREET AND NUMBER:

CITY OR TOWN:
Lexington

STATE: Missouri	CODE 24
STATE: Missouri	CODE 61067

APPROXIMATE ACREAGE OF NOMINATED PROPERTY: 90

6. REPRESENTATION IN EXISTING SURVEYS

TITLE OF SURVEY:
Missouri Historic Sites Catalogue

DATE OF SURVEY: 1963 Federal State County Local

DEPOSITORY FOR SURVEY RECORDS:
State Historical Society of Missouri

STREET AND NUMBER:
Corner, Hitt and Lowry streets

CITY OR TOWN:
Columbia

STATE: Missouri	CODE 24
STATE: Missouri	CODE 65201

SEE INSTRUCTIONS

STATE: Missouri
COUNTY: Lafayette
ENTRY NUMBER: 69-06-24-0026
DATE: 6/4/69
FOR NPS USE ONLY

7. DESCRIPTION

CONDITION	(Check One)					
	Excellent <input type="checkbox"/>	Good <input checked="" type="checkbox"/>	Fair <input type="checkbox"/>	Deteriorated <input type="checkbox"/>	Ruins <input type="checkbox"/>	Unexposed <input type="checkbox"/>
INTEGRITY	(Check One)			(Check One)		
	Altered <input checked="" type="checkbox"/>	Unaltered <input type="checkbox"/>		Moved <input type="checkbox"/>	Original Site <input checked="" type="checkbox"/>	

DESCRIBE THE PRESENT AND ORIGINAL (if known) PHYSICAL APPEARANCE

Two and one-half story brick house facing west with two story brick ell projecting from the east (rear) wall. Ell north wall is a slightly inset continuation of north wall of main block. Built 1853 with slave labor.

A late example of the Federal style house in Missouri with some features showing innovative mid-nineteenth century details. Traditional in basic form having rectangular block under ridge roof, symmetrical facade. A width of five bays expresses interior plan of large central hallway flanked on both sides by two rooms (one in front and one behind).

Stone foundation. Facade brick work notable as is laid up entirely in stretcher courses with no headers, a departure from the more typical English bond of Missouri houses of this period.

Double chimneys on top of each main block gable wall with modest brick courses ornamenting the top of the stacks.

Broad wooden Federal style cornice appropriately without dentil courses or brackets. Windows and doors vertically proportioned with cast iron sills and lintels. Cast iron capitols in a modified Corinthian order on front porch columns. (See accompanying photographs). Use of cast iron shows knowledge by the builder of period building art developments.

One story front porch at center of facade has balcony above which is accessible through doorway at west end of second floor central hall. Front porch may be a later addition as it was not included in an early engraving of the Battle of Lexington. However, as other details of the house are incorrect in this view, its reliability is questionable. (Frank Leslie's Illustrated Newspaper, October 12, 1861.) On rear of house and portion of ell there is a two story wooden gallery.

Interior is surprisingly spacious. Fireplaces are open in each of the eight rooms of main block of house. Stairway, "U" in plan, at rear of central hallway gives access both to second floor and attic. Native black walnut woodwork throughout. Interior partition walls are of brick construction, $13\frac{1}{2}$ - 14 inches thick.

House suffered minor damage when used as a field hospital during the Battle of Lexington, September 19, 20, 21, 1861. Many bullet holes are in evidence.

SEE INSTRUCTIONS

**NATIONAL REGISTER OF HISTORIC PLACES
INVENTORY - NOMINATION FORM**

(Continuation Sheet)

STATE	
Missouri	
COUNTY	
Lafayette	
FOR NPS USE ONLY	
ENTRY NUMBER	DATE

(Number all entries)

ANDERSON HOUSE AND LEXINGTON BATTLEFIELD

2.

Bounded on the west by 10th Street, on the northwest by Missouri Pacific Railroad, on the south by Utah and Wood streets and on the east by the continuation of 15th Street.

NATIONAL REGISTER OF HISTORIC PLACES
INVENTORY - NOMINATION FORM

(Continuation Sheet)

STATE	
Missouri	
COUNTY	
Lafayette	
FOR NPS USE ONLY	
ENTRY NUMBER	DATE
69-06-24-0026	6/4/69

(Number all entries)

ANDERSON HOUSE AND LEXINGTON BATTLEFIELD

6. Missouri State Historical Survey (state)

1968

Missouri State Park Board

P.O. Box 176

1204 Jefferson Building

Jefferson City, Missouri 65101

Code: 24

Historic American Buildings Survey (federal)

1940

Office of Archeology and Historic Preservation

National Park Service

801 19th Street, N.W.

Washington, D.C. 20006

Code: 08



NATIONAL REGISTER OF HISTORIC PLACES
INVENTORY - NOMINATION FORM

(Continuation Sheet)

STATE	
Missouri	
COUNTY	
Lafayette	
FOR NPS USE ONLY	
ENTRY NUMBER	DATE
69-06-24-0026	6/4/69

(Number all entries)

ANDERSON HOUSE AND LEXINGTON BATTLEFIELD

7. House suffered neglect 1923-1925. Repaired 1933-1934 as a WPA project. During 1955 and years following, restoration work was carried on by the Anderson House Foundation, Inc. Missouri State Park Board became owner in 1959 and has continued restoration. House was recorded in an Historic American Buildings Survey project by Kansas City Architect, Kenneth E. Coombs in 1965.

Trenches used by the Union forces during the Battle of Lexington are in evidence on a hilltop adjoining the house site. Battlefield site and slightly rounded trenches are landscaped and maintained as a park by the Missouri State Park Board. Battlefield has not been restored.



B. SIGNIFICANCE

PERIOD (Check One or More as Appropriate)

Pre-Columbian 16th Century 18th Century 20th Century
 15th Century 17th Century 19th Century

SPECIFIC DATE(S) (If Applicable and Known)

AREAS OF SIGNIFICANCE (Check One or More as Appropriate)

Aboriginal <input type="checkbox"/>	Education <input type="checkbox"/>	Political <input type="checkbox"/>	Urban Planning <input type="checkbox"/>
Prehistoric <input type="checkbox"/>	Engineering <input type="checkbox"/>	Religion/Philosophy <input type="checkbox"/>	Other (Specify) <input checked="" type="checkbox"/>
Historic <input type="checkbox"/>	Industry <input type="checkbox"/>	Science <input type="checkbox"/>	<u>Architecture</u>
Agriculture <input type="checkbox"/>	Invention <input type="checkbox"/>	Sculpture <input type="checkbox"/>	_____
Art <input type="checkbox"/>	Landscape <input type="checkbox"/>	Social/Humanitarian <input type="checkbox"/>	_____
Commerce <input type="checkbox"/>	Architecture <input type="checkbox"/>	Theater <input type="checkbox"/>	_____
Communications <input type="checkbox"/>	Literature <input type="checkbox"/>	Transportation <input type="checkbox"/>	_____
Conservation <input type="checkbox"/>	Military <input checked="" type="checkbox"/>		
	Music <input type="checkbox"/>		

STATEMENT OF SIGNIFICANCE (Include Personages, Dates, Events, Etc.)

SEE INSTRUCTIONS

+ The Anderson House, which overlooks the Missouri River, was built in 1853 by Colonel Oliver Anderson, a native of Lexington, Kentucky. Anderson, who came to Missouri in 1851, established a rope and bag manufactory which processed the locally grown hemp.

+ At the outbreak of the Civil War, all inhabitants of Missouri were required to take an oath of allegiance to the United States. Because of his Southern heritage, Col. Anderson refused to take the oath and was imprisoned by the Federal troops. His house and property were confiscated.

Lexington, a strategically located river town, was under the Union command of Col. James Mulligan. Confederate General Sterling Price planned to capture Lexington, cut off the Federal water route to Kansas and secure more recruits from northern Missouri. This area had been cut off by the Federal control of the Missouri River.

+ During the Battle of Lexington, September 18, 19, 20, 1861, the Anderson House was used as a field hospital by both the Union and Confederate forces. The hospital changed hands three times during the three-day battle. Interior and exterior of house show battle scars incurred during the fighting.

+ Most of the battle was fought on an adjoining hilltop approximately $\frac{1}{4}$ mile from the Anderson House. Mulligan fortified his headquarters within the Masonic College located on this hill. Mulligan ordered the construction of earthen trenches to encircle the college.

+ General Price successfully laid seige to the entrenched Union troops and within three days forced their surrender. Battle is often referred to as the Battle of the Hemp Bales. Price made use of the hemp bales manufactured by Col. Anderson as breast-works for his men as they ascended the hill toward the Federal troops.

House and battlefield are historically significant as one of Missouri's few Civil War Battle sites remaining almost entirely intact.

9. MAJOR BIBLIOGRAPHICAL REFERENCES

1. State Historical Society of Missouri's Historic Sites File, ref. Lafayette County.
2. Meyer, Duane. The Heritage of Missouri: A History, (St. Louis: State Publishing Co., Inc. 1965), pp. 373-374.

10. GEOGRAPHICAL DATA

LATITUDE AND LONGITUDE COORDINATES DEFINING A RECTANGLE LOCATING THE PROPERTY				O R	LATITUDE AND LONGITUDE COORDINATES DEFINING THE CENTER POINT OF A PROPERTY OF LESS THAN ONE ACRE			
CORNER	LATITUDE				LONGITUDE			
	Degrees	Minutes	Seconds	Degrees	Minutes	Seconds		
NW	39°	11'	44"	93°	52'	57"		
NE	39°	11'	44"	93°	52'	34"		
SE	39°	11'	25"	93°	52'	34"		
SW	39°	11'	25"	93°	52'	58"		

LIST ALL STATES AND COUNTIES FOR PROPERTIES OVERLAPPING STATE OR COUNTY BOUNDARIES

STATE:	CODE	COUNTY	CODE
STATE:	CODE	COUNTY:	CODE
STATE:	CODE	COUNTY:	CODE
STATE:	CODE	COUNTY:	CODE

11. FORM PREPARED BY

NAME AND TITLE:
Martha L. Kusiak, Research Historian

ORGANIZATION State Historical Survey and Planning Office DATE April 4, 1969
Missouri State Park Board

STREET AND NUMBER:
P.O. Box 176, 1201 Jefferson Building

CITY OR TOWN: Jefferson City STATE Missouri 65101 CODE 24

12. STATE LIAISON OFFICER CERTIFICATION

As the designated State Liaison Officer for the National Historic Preservation Act of 1966 (Public Law 89-665), I hereby nominate this property for inclusion in the National Register and certify that it has been evaluated according to the criteria and procedures set forth by the National Park Service. The recommended level of significance of this nomination is:

National State Local

Name *Joseph Jaeger, Jr.*

Title Director, Missouri State Park Board, and Missouri State Liaison Officer

Date April 7, 1969

NATIONAL REGISTER VERIFICATION

I hereby certify that this property is included in the National Register.

Ernest Allen Cunnally
Chief, Office of Archeology and Historic Preservation

Date JUN 4 1969

ATTEST:

William P. Whitteck
Keeper of The National Register

Date JUN 4 1969

No UTM
HL

SEE INSTRUCTIONS



Name of Site: Anderson House - BATTLE OF LEXINGTON
Site Number _____
Photographer: HADLEY IRWIN - MISSOURI STATE PARK BOARD
Date of Photo: CA. 1950
View of Photo: Looking north west, view of south west facade
Neg. Size _____

NPS Number _____

Title: AND

BA

Loc. LAFAYETTE

LEXINGTON

(#)

SEE INSTRUCTIONS

UNITED STATES DEPARTMENT OF THE INTERIOR
NATIONAL PARK SERVICE

NATIONAL REGISTER OF HISTORIC PLACES
PROPERTY PHOTOGRAPH FORM

(Type all entries - attach to or enclose with photograph)

STATE	
Missouri	
COUNTY	
Lafayette	
FOR NPS USE ONLY	
ENTRY NUMBER	DATE
69-06-24-0026	6/4/69

1. NAME			
COMMON:		Anderson House and Lexington Battlefield	
AND/OR HISTORIC:		Colonel Oliver Anderson House	
2. LOCATION			
STREET AND NUMBER:			
Sections 27 and 28, Township 51N, Range 27W			
CITY OR TOWN:			
Lexington			
STATE:	CODE	COUNTY:	CODE
Missouri	64067	Lafayette	107
3. PHOTO REFERENCE			
PHOTO CREDIT: Hadley Irwin - Missouri State Park Board			
DATE OF PHOTO: ca. 1950			
NEGATIVE FILED AT: Missouri State Park Board, P.O. Box 176 1204 Jefferson Building, Jefferson City, Missouri 65101			
4. IDENTIFICATION			
DESCRIBE VIEW, DIRECTION, ETC.			
Looking northeast, view of the southwest facade and south gable wall. Well is to right of the house. Back porch is barely visible on the rear of building (east).			





Name of Site: Anderson House - Battle of Lexington
Site Number _____
Photographer: HADLEY IRWIN - MISSOURI STATE PARK BOARD
Date of Photo: CA. 1950
View of Photo: Looking Southeast, view of northeast corner
Neg. Size _____

NPS Number _____

Title: _____

Loc. LA
LA
(

SEE INSTRUCTIONS

UNITED STATES DEPARTMENT OF THE INTERIOR
NATIONAL PARK SERVICE

NATIONAL REGISTER OF HISTORIC PLACES
PROPERTY PHOTOGRAPH FORM

(Type all entries - attach to or enclose with photograph)

STATE	
Missouri	
COUNTY	
Lafayette	
FOR NPS USE ONLY	
ENTRY NUMBER	DATE
69-06-24-0026	6/4/69

1. NAME			
COMMON: Anderson House and Lexington Battlefield			
AND/OR HISTORIC: Colonel Oliver Anderson House			
2. LOCATION			
STREET AND NUMBER:			
Sections 27 and 28, Township 51N, Range 27W			
CITY OR TOWN:			
Lexington			
STATE:	CODE	COUNTY:	CODE
Missouri	64067	Lafayette	107
3. PHOTO REFERENCE			
PHOTO CREDIT: Hadley Irwin - Missouri State Park Board			
DATE OF PHOTO: ca. 1950			
NEGATIVE FILED AT: Missouri State Park Board, P.O. Box 176 1201 Jefferson Building, Jefferson City, Missouri 65101			
4. IDENTIFICATION			
DESCRIBE VIEW, DIRECTION, ETC.			
Looking southeast, view of northwest corner of Anderson House. North gable wall at left with "L" continuation to rear (east).			

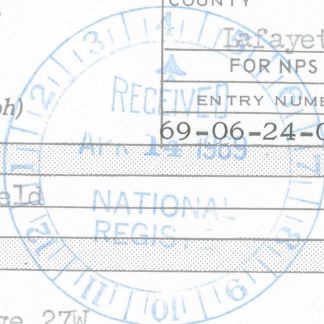



UNITED STATES DEPARTMENT OF THE INTERIOR
NATIONAL PARK SERVICE

NATIONAL REGISTER OF HISTORIC PLACES
PROPERTY PHOTOGRAPH FORM

(Type all entries - attach to or enclose with photograph)

STATE	
Missouri	
COUNTY	
Lafayette	
FOR NPS USE ONLY	
ENTRY NUMBER	DATE
69-06-24-0026	6/4/69

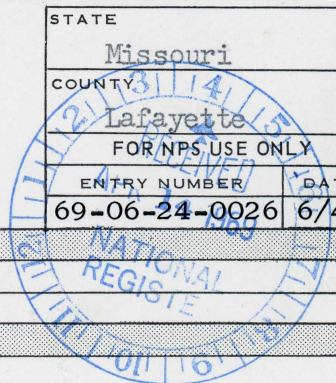

1. NAME

COMMON: Anderson House and Lexington Battlefield
AND/OR HISTORIC: Colonel Oliver Anderson House

2. LOCATION

STREET AND NUMBER:
Sections 27 and 28, Township 51N, Range 27W
CITY OR TOWN:
Lexington

STATE:	CODE	COUNTY:	CODE
Missouri	64067	Lafayette	107

3. PHOTO REFERENCE

PHOTO CREDIT: M. Patricia Holmes - State Historical Survey
DATE OF PHOTO: October 31, 1968 1 p.m.
NEGATIVE FILED AT: Missouri State Park Board, P.O. Box 176
1201 Jefferson Building, Jefferson City, Missouri 65107

4. IDENTIFICATION

DESCRIBE VIEW, DIRECTION, ETC.
Detail of the cast iron window caps found on every window of building. View of the southern-most window on the west facade, first floor.

SEE INSTRUCTIONS



UNITED STATES DEPARTMENT OF THE INTERIOR
NATIONAL PARK SERVICE

NATIONAL REGISTER OF HISTORIC PLACES
PROPERTY PHOTOGRAPH FORM

(Type all entries - attach to or enclose with photograph)

STATE

Missouri

COUNTY

Lafayette

FOR NPS USE ONLY

ENTRY NUMBER

DATE

69-06-24-0026 6/4/69

1. NAME

COMMON: Anderson House and Lexington Battlefield

AND/OR HISTORIC: Colonel Oliver Anderson House

2. LOCATION

STREET AND NUMBER:

Sections 27 and 28, Township 51N, Range 27W

CITY OR TOWN:

Lexington

STATE:

Missouri 61067

CODE

24

COUNTY:

Lafayette

CODE

107

3. PHOTO REFERENCE

PHOTO CREDIT: M. Patricia Holmes - State Historical Survey

DATE OF PHOTO: October 31, 1968 1 p.m.

NEGATIVE FILED AT: Missouri State Park Board, P.O. Box 176
1204 Jefferson Building, Jefferson City, Missouri 65101

4. IDENTIFICATION

DESCRIBE VIEW, DIRECTION, ETC.

Detail of column capitol (facade northwest corner of porch)
cast iron. Looking east.

SEE INSTRUCTIONS

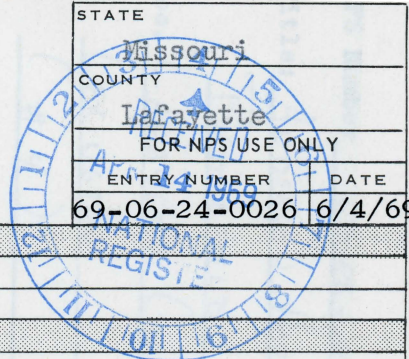

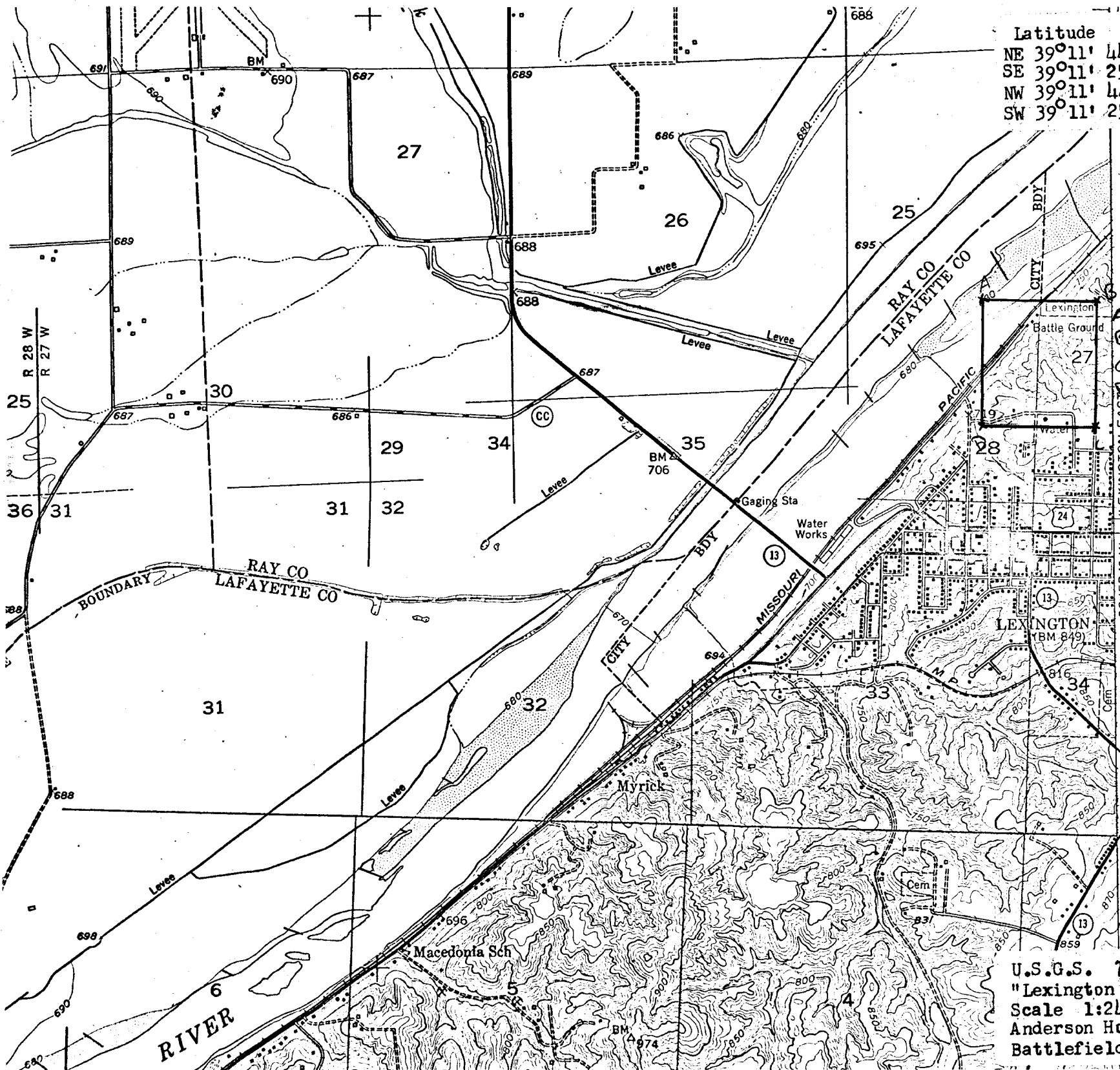

	Latitude	Longitude
NE	39° 11' 44"	93° 52' 34"
SE	39° 11' 25"	93° 52' 34"
NW	39° 11' 44"	93° 52' 57"
SW	39° 11' 25"	93° 52' 58"

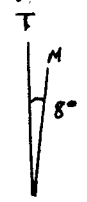

- A: 15/423790/4338645
- B: 15/424340/4338640
- C: 15/424340/4339050
- D: 15/423765/4338055

DOVER 10 MI
WAVELY 20 MI

T. 51 N.
T. 50 N.

U.S.G.S. 7½ Quadrangle Map
"Lexington West" (1950)
Scale 1:24,000
Anderson House and Lexington
Battlefield

Form 10-301
(Dec. 1968)

UNITED STATES DEPARTMENT OF THE INTERIOR
NATIONAL PARK SERVICE

NATIONAL REGISTER OF HISTORIC PLACES

PROPERTY MAP FORM

(Type all entries - attach to or enclose with map)

STATE	
Missouri	
COUNTY	
Lafayette	
FOR NPS USE ONLY	
ENTRY NUMBER	DATE
69-06-24-0026	6/4/69

SEE INSTRUCTIONS

1. NAME			
COMMON: Anderson House and Lexington Battlefield			
AND/OR HISTORIC: Colonel Oliver Anderson House			
2. LOCATION			
STREET AND NUMBER:			
Sections 27 and 28, Township 51N, Range 27W			
CITY OR TOWN:			
Lexington			
STATE:	CODE	COUNTY:	CODE
Missouri 61067	24	Lafayette	107
3. MAP REFERENCE			
SOURCE:			
U.S.G.S. 7.5 quadrangle Lexington West			
SCALE: 1:24,000			
DATE: 1950			
4. REQUIREMENTS			
TO BE INCLUDED ON ALL MAPS			
1. Property boundaries where required.			
2. North arrow.			
3. Latitude and longitude reference.			

NATIONAL REGISTER OF HISTORIC PLACES
INVENTORY - NOMINATION FORM

(Continuation Sheet)

STATE Missouri	
COUNTY Lafayette	
FOR NPS USE ONLY	
ENTRY NUMBER	DATE

(Number all entries)

ANDERSON HOUSE and
LEXINGTON BATTLEFIELD

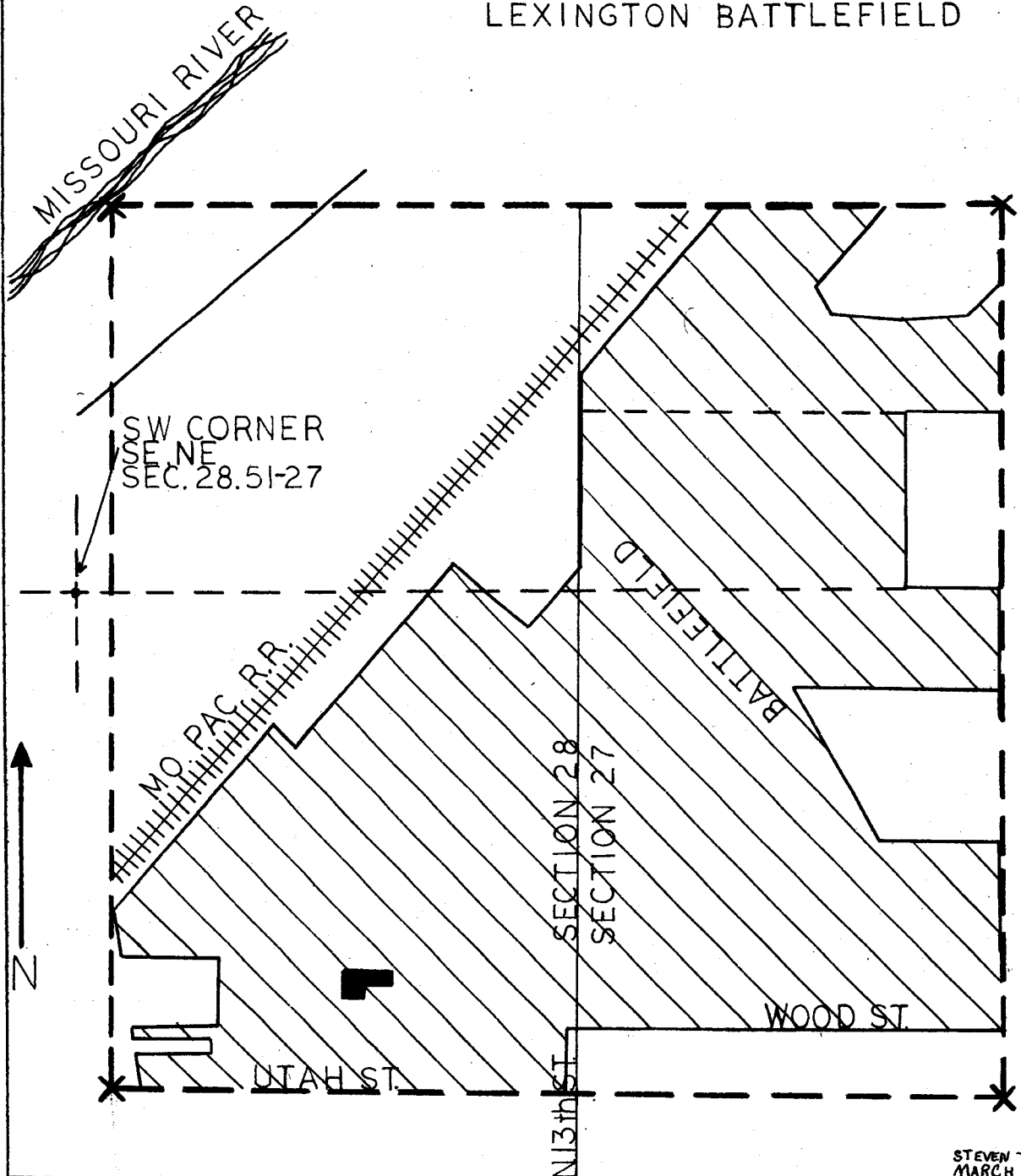

STEVEN TECZAR
MARCH 25, 1969

Form 10-301
(Dec. 1968)

UNITED STATES DEPARTMENT OF THE INTERIOR
NATIONAL PARK SERVICE

**NATIONAL REGISTER OF HISTORIC PLACES
PROPERTY MAP FORM**

(Type all entries - attach to or enclose with map)

STATE	
Missouri	
COUNTY	
Lafayette	
FOR NPS USE ONLY	
ENTRY NUMBER	DATE
69-06-24-0026	6/4/69

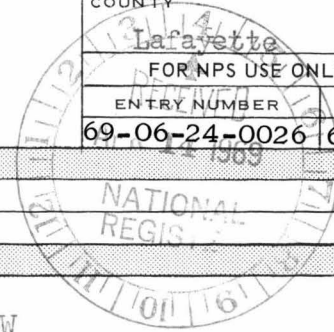

SEE INSTRUCTIONS

1. NAME			
COMMON:		Anderson House and Lexington Battlefield	
AND/OR HISTORIC:		Colonel Oliver Anderson House	
2. LOCATION			
STREET AND NUMBER:			
Sections 27 and 28, Township 51N, Range 27W			
CITY OR TOWN:			
Lexington			
STATE:	CODE	COUNTY:	CODE
Missouri	64067	Lafayette	107
3. MAP REFERENCE			
SOURCE:			
Based on Missouri State Park Board Property Map of Anderson House and Lexington Battlefield			
SCALE:			
Approximate scale			
DATE:			
March 1969			
4. REQUIREMENTS			
TO BE INCLUDED ON ALL MAPS		Lined area indicates property of the State of Missouri and the historic district.	
1. Property boundaries where required.			
2. North arrow.			
3. Latitude and longitude reference.			

SN

H30-HR

June 12, 1969

Miss Martha L. Kusiak
Research Historian
Missouri State Historical Survey
212 South Eighth Street
Columbia, Missouri 65201

Dear Miss Kusiak:

In order to prepare for the publication of the National Register of Historic Places, additional information is urgently needed about the Anderson House and Lexington Battlefield in Lexington, Missouri. In Part one of Section 2 (Location) of the National Register Inventory-Nomination form, it is necessary to have the site located in relation to major highways or at least local streets rather than township sections. This particular site might be described as being in an area bounded by Utah Street on the south, the Missouri Pacific Railroad on the west, and two other streets or by lines running so many feet east of the railroad and so many feet north of Utah Street.

In our publication, all National Register properties are located by their proximity to commonly recognized points of reference such as street addresses, geographic features, or roadways. We would greatly appreciate it if you would follow this practice in nominating other properties to the Register.

It will not be possible to publish this entry in the National Register unless we have this information in hand by Friday, June 20. Would you be kind enough to send it to us at your earliest convenience?

Sincerely yours,

Elizabeth A. Dippel
Editor

HR
EADippel: bh
12 Jun 69

JUN 6 1969

H30-HR

Mr. Joseph Jaeger, Jr.
Director
Missouri State Park Board
P.O. Box 571
1204 Jefferson Building
Jefferson City, Missouri 65101

Dear Mr. Jaeger:

We wish to inform you that the property indicated on the enclosed forms has been added to the National Register of Historic Places.

Sincerely yours,

William J. Murtagh

William J. Murtagh
Keeper of the National
Register

Enclosure

cc:
Regional Director, Midwest Region-w/c encl.
T, Butterfield-w/c encl.

HR

Anderson House and Lexington
Battlefield

BASIC FILE RETAINED IN HR



MISSOURI STATE PARK BOARD

STATE HISTORICAL SURVEY AND PLANNING OFFICE

AREA CODE 314 TELEPHONE 449-0725

212 SOUTH EIGHTH STREET

COLUMBIA, MISSOURI 65201

June 18, 1969

WARREN E. HEARNES
GOVERNOR

JOSEPH JAEGER, JR.
DIRECTOR

BOARD

•
GERALD B. ROWAN
CHAIRMAN
KANSAS CITY

CARTER V. BLANTON
VICE-CHAIRMAN
SHELBYNA

CONN C. WINFREY
LEBANON

CHARLES TYE EVANS
ST. JOSEPH

ROBERT M. WOLPERS
POPLAR BLUFF

HUBERT E. LAY
HOUSTON

Miss Elizabeth A. Dippel
Editor
Office of Archaeology and Historic Preservation
National Park Service, United States Department
of the Interior
801 19th Street, N.W.
Washington, D.C. 20006

Dear Miss Dippel:

In reply to your letter of June 12, 1969 (H30-HR) concerning the location of Anderson House and Lexington Battlefield in Lexington, Missouri, the following description locates the site more specifically:

Bounded on the west by 10th Street, on the northwest by Missouri Pacific Railroad, on the south by Utah and Wood streets and on the east by the continuation of 15th Street.

I hope that this information is sufficient and is received in time for publication in the National Register of Historic Places.

Sincerely yours,

MISSOURI STATE HISTORICAL SURVEY

Martha L. Kusiak

(Miss) Martha L. Kusiak
Research Historian

MIK:rmc

Enclosure