

UNITED STATES DEPARTMENT OF THE INTERIOR
NATIONAL PARK SERVICE

NATIONAL REGISTER OF HISTORIC PLACES
EVALUATION/RETURN SHEET

REQUESTED ACTION: ADDITIONAL DOCUMENTATION

PROPERTY NAME: Stuart Area Historic District

MULTIPLE NAME: Kalamazoo MRA

STATE & COUNTY: MICHIGAN, Kalamazoo

DATE RECEIVED: 3/16/95 DATE OF PENDING LIST:
DATE OF 16TH DAY: DATE OF 45TH DAY: 4/30/95
DATE OF WEEKLY LIST:

REFERENCE NUMBER: 83000874

NOMINATOR: STATE

REASONS FOR REVIEW:

APPEAL: N DATA PROBLEM: N LANDSCAPE: N LESS THAN 50 YEARS: N
OTHER: N PDIL: N PERIOD: N PROGRAM UNAPPROVED: N
REQUEST: N SAMPLE: N SLR DRAFT: N NATIONAL: N

COMMENT WAIVER: N

ACCEPT RETURN REJECT 4/28/95 DATE Entered in the
National Register

ABSTRACT/SUMMARY COMMENTS:

RECOM./CRITERIA _____

REVIEWER _____ DISCIPLINE _____

TELEPHONE _____ DATE _____

DOCUMENTATION see attached comments Y/N see attached SLR Y/N

United States Department of the Interior
National Park Service

National Register of Historic Places Continuation Sheet

Section number _____ Page _____

Stuart Area Historic District Kalamazoo County MICHIGAN 83000874
(Kalamazoo MRA)

ADDITIONAL DOCUMENTATION APPROVED

Guy M. Rapsley 4/28/75



~~RICHARD H. AUSTIN~~
Candice S. Miller

SECRETARY OF STATE

Bureau of Michigan History
State Historic Preservation Office
Michigan Library and Historical Center
717 West Allegan Street
Lansing, Michigan 48918-1800

March 6, 1995

Ms. Carol D. Shull, Keeper
National Register of Historic Places
National Park Service
U. S. Department of the Interior
P. O. Box 37127
Washington, D. C. 20013-7127

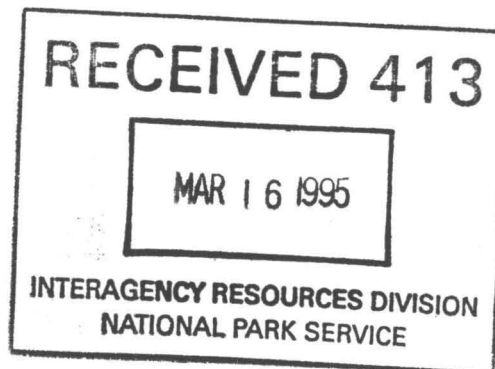

Dear Ms. Shull:

Enclosed are National Register nomination materials for the Stuart Neighborhood/Henderson Park Historic District Boundary Increase in Kalamazoo, Kalamazoo County, Michigan. WE ARE ALSO REQUESTING AT THIS TIME THAT THE NAME OF THE DISTRICT BE CHANGED TO "STUART AREA HISTORIC DISTRICT." Through this name change, the national register and local historic districts, which will now have identical boundaries, will also have the same name. The name change will also avoid confusion between this district and a Henderson Park/West Main Hill Historic District, which will soon be nominated to the national register.

This property is being submitted for listing in the National Register. The city of Kalamazoo is a certified local government. We enclose a copy of the Certified Local Government National Register Final Review Report from the city providing evidence of the views of the local commission and chief elected local official. No letters of objection or other written comments concerning this nomination were submitted to us prior to the submission of this nomination to you.

Questions concerning this nomination may be directed to Robert O. Christensen, National Register Coordinator (517/335-2719).

Sincerely,

Kathryn B. Eckert

State Historic Preservation Officer

KBE:roc

**United States Department of the Interior
National Park Service**

**National Register of Historic Places
Inventory—Nomination Form**

For NPS use only
received
date entered

Continuation sheet

Item number

Page 35

Historic Name: Stuart Neighborhood/Henderson Park Historic District
Common Name: Stuart Historic District
Location: West Main Street and Douglas and Kalamazoo Avenues
Classification:
Category: district
Ownership: multiple public/private
Public Acquisition: N/A
Status: occupied
Accessible: yes: restricted; no
Present Use: commercial, educational, park, private residence, religious

Description:

Condition: good
Altered
Original site

The Stuart Neighborhood/Henderson Park Historic District (see photos 28-51 and 112-123) contains two, non-contiguous parts of Kalamazoo's late nineteenth- and early twentieth-century, near west side located a short distance to the west of downtown Kalamazoo. The 32^d-building district contains the Stuart neighborhood, a several-hundred-building, old residential area bounded (roughly) on the east by the Michigan Central tracks, on the north by North Street, on the west by Douglas Avenue, and on the south by West Main Street. Separated from the Stuart area by a narrow strip of land, a second large tract contains the Henderson Park area--an early twentieth-century residential neighborhood which, presided over by the "Henderson Castle," Kalamazoo's most imposing Late Victorian mansion, flanks the triangular Henderson Park--and, to the north, the Mountain Home Cemetery, a fine, nineteenth-century, rural burial ground set in hilly topography.

The streets in the district are narrow and tree-lined and contain detached houses--most of them frame and many large in size and handsomely detailed--set well back from the street. The district's housing stock dates mainly from the 1860s to the 1920s and Queen Anne and Queen Anne/Colonial Revival structures predominate. Most of the houses were built as single-family residences; however, many have been converted into apartments over the years. The district also contains two churches, a school, a fire station, and three commercial buildings. Only a very small number of non-contributing structures are present.

CONTRIBUTING AND NON-CONTRIBUTING STRUCTURES AND SITES

Contributing Structures (all are frame houses unless otherwise stated)

- 214 Douglas Avenue hip-roof early 20th C.
- 218 " " hip-roof early 20th C.
- 222 " " Queen Anne/Colonial Rev.

**United States Department of the Interior
National Park Service**

**National Register of Historic Places
Inventory—Nomination Form**

For NPS use only

received

date entered

Continuation sheet

Item number

Page 36

227	"	"	Brick Late Victorian
228	"	"	Queen Anne/Colonial Rev.
231	"	"	Queen Anne/Colonial Rev.
301	"	"	Queen Anne/Colonial Rev.
302	"	"	Queen Anne
303	"	"	Colonial Rev.
306	"	"	Queen Anne
309	"	"	Late Victorian
310	"	"	Early 20th C.
314	"	"	Queen Anne
315	"	"	Hip-roof early 20th C.
325	"	"	Queen Anne
331	"	"	James Kent House (photo 46)
401	"	"	Queen Anne/Colonial Rev.
405	"	"	Late Victorian
411	"	"	Late Victorian
412	"	"	Queen Anne
416	"	"	Queen Anne
417	"	"	Queen Anne
420	"	"	Stucco early 20th C.
421	"	"	Queen Anne/Colonial Rev.
424	"	"	Dutch Colonial
425	"	"	Brick hip roof early 20th C.
428	"	"	Brick and stucco early 20th C.
429	"	"	Tudor-inspired stucco and half-timber
431	"	"	Queen Anne/Colonial Rev.
432	"	"	Tudor-inspired stucco and half-timber
436	"	"	Turn-of-the-century cottage
440	"	"	Queen Anne/Colonial Rev.
501	"	"	Bungalow
502	"	"	Queen Anne/Colonial Rev.
504	"	"	Late Victorian
507	"	"	Queen Anne/Colonial Rev.
512	"	"	Queen Anne
516	"	"	Queen Anne/Colonial Rev.
520	"	"	Queen Anne/Colonial Rev.
526	"	"	Hip-roof early 20th C.
527	"	"	Queen Anne/Colonial Rev.
530	"	"	Colonial
531	"	"	Queen Anne
604	"	"	Queen Anne/Colonial Rev.
605	"	"	Queen Anne/Colonial Rev.
606	"	"	Hip-roof early 20th-C. two-family
612	"	"	Queen Anne/Colonial Rev.
613	"	"	Queen Anne
617	"	"	Queen Anne

**United States Department of the Interior
National Park Service**

**National Register of Historic Places
Inventory—Nomination Form**

For NPS use only
received
date entered

Continuation sheet

Item number

Page 37

619	"	"	Engine House No. 5 (photo 45)
702	Eleanor	Street	C. 1900 apartment block
705	"	"	C. 1900 cottage
708	"	"	C. 1900
709	"	"	Queen Anne/Colonial Rev.
712	"	"	Queen Anne/Colonial Rev.
713	"	"	Queen Anne/Colonial Rev.
715	"	"	Queen Anne/Colonial Rev.
716	"	"	Queen Anne/Colonial Rev.
717	"	"	Queen Anne/Colonial Rev.
718	"	"	Queen Anne/Colonial Rev.
722	"	"	Queen Anne/Colonial Rev.
723	"	"	Queen Anne/Colonial Rev.
726	"	"	Stucco hip-roof early 20th C.
121	Elm	Street	Late Victorian
127	"	"	1873 Italianate
203	"	"	1871-1872 Italianate
207	"	"	Italianate/Colonial Rev.
208	"	"	Italianate
212	"	"	Queen Anne/Colonial Rev. apartment block
213	"	"	Chappell-Stewart House (photos 33-34)
220	"	"	Queen Anne
223	"	"	Italianate
224	"	"	Late Victorian
302	"	"	Amariah T. Prouty House (photos 35-36)
303	"	"	Italianate
307	"	"	Colonial Rev. two-family
310	"	"	Italianate
311	"	"	Bungalow
316	"	"	Queen Anne/Colonial Rev.
319	"	"	Brick Italianate
320-22	"	"	Queen Anne
410	"	"	Stucco hip-roof early 20th C.
411	"	"	Hip-roof early 20th C.
412	"	"	Stucco hip-roof early 20th C.
414	"	"	Stucco Dutch Colonial
415	"	"	Queen Anne/Colonial Rev.
418	"	"	Late Victorian
422	"	"	Queen Anne/Colonial Rev.
423	"	"	Italianate
426	"	"	Italianate
427	"	"	Queen Anne
430	"	"	Italianate
431	"	"	Queen Anne

**United States Department of the Interior
National Park Service**

**National Register of Historic Places
Inventory—Nomination Form**

For NPS use only

received

date entered

Continuation sheet

Item number

Page 38

501	"	"	Italianate
502	"	"	Queen Anne/Colonial Rev.
505	"	"	Italianate
506	"	"	Queen Anne/Colonial Rev.
508	"	"	Queen Anne/Colonial Rev.
514	"	"	Hip-roof early 20th C.
520	"	"	Queen Anne/Colonial Rev.
521	"	"	Late Victorian
523	"	"	Stucco hip-roof early 20th C.
524	"	"	Queen Anne/Colonial Rev.
528	"	"	Queen Anne/Colonial Rev.
529	"	"	Queen Anne
533	"	"	Queen Anne
601	"	"	Queen Anne/Colonial Rev.
602	"	"	Queen Anne/Colonial Rev.
603	"	"	Queen Anne/Colonial Rev.
606	"	"	Queen Anne/Colonial Rev.
609	"	"	Stucco hip-roof early 20th C.
614	"	"	Greek Rev.
615	"	"	Late Victorian
618	"	"	Queen Anne/Colonial Rev.
619	"	"	Late Victorian
509	Elmwood Court		Queen Anne/Colonial Rev.
513	"	"	Dutch Colonial
517	"	"	Dutch Colonial
521	"	"	Queen Anne/Colonial Rev.
603	"	"	Hip-roof early 20th C.
611	"	"	Queen Anne/Colonial Rev.
810	Elmwood Street		Queen Anne/Colonial Rev.
811	"	"	Queen Anne/Colonial Rev.
814-16	"	"	Queen Anne
815	"	"	Queen Anne/Colonial Rev.
817	"	"	Late Victorian
820	"	"	Queen Anne
822	"	"	Queen Anne/Colonial Rev.
823	"	"	Late Victorian
824	"	"	Queen Anne/Colonial Rev.
826	"	"	Queen Anne/Colonial Rev.
832	"	"	W. G. Bartholomew House (photo 38)
805	Ferris Court		Late Victorian
813	"	"	Early 20th-C. two-family
817	"	"	Stucco early 20th-C. two-family

**United States Department of the Interior
National Park Service**

**National Register of Historic Places
Inventory—Nomination Form**

For NPS use only

received

date entered

Continuation sheet

Item number

Page 39

1209 Grand Avenue	Stucco early 20th-C.
1213 " "	Dutch Colonial
1219 " "	Tudor-Inspired stucco and half-timber
1223 " "	Queen Anne/Colonial Rev.
1227 " "	Tudor-Inspired stucco and half-timber
1301 " "	Queen Anne/Colonial Rev.
1315 " "	Queen Anne/Colonial Rev.
1319 " "	Queen Anne/Colonial Rev.
1325 " "	Queen Anne
1331 " "	Queen Anne/Colonial Rev.
1341 " "	Colonial Rev. duplex
1403 " "	Queen Anne/Colonial Rev.
1411 " "	Queen Anne/Colonial Rev.
602 W. Kalamazoo Ave.	Queen Anne
605 " "	Queen Anne
608 " "	Brick Late Victorian
609 " "	L-plan Late Victorian
610 " "	Queen Anne/Colonial Rev.
621 " "	Queen Anne/Colonial Rev.
628 " "	Queen Anne
632 " "	Stucco hip-roof early 20th-C.
701 " "	L-plan Late Victorian
705 " "	Stucco hip-roof early 20th-C.
709 " "	Queen Anne/Colonial Rev.
710 " "	Italianate
712 " "	Bungalow
713-15 " "	Colonial Rev.
716 " "	Stucco Late Victorian
717 " "	Late Victorian
718 " "	Stucco hip-roof early 20th-C.
722 " "	Late Victorian
725 " "	Brick Queen Anne
726 " "	Hip-roof early 20th-C.
730 " "	Stucco hip-roof early 20th-C.
734 " "	Stucco hip-roof early 20th-C.
802 " "	Mansard (photo 30, left)
808 " "	Queen Anne
811 " "	Queen Anne/Colonial Rev.
814 " "	Hip-roof early 20th-C. two-family
815 " "	Queen Anne
821 " "	Stucco hip-roof early 20th-C.
828 " "	Queen Anne/Colonial Rev.
832 " "	Queen Anne/Colonial Rev.
834 " "	Queen Anne
904 " "	Tudor-Inspired stucco and half-timber

**United States Department of the Interior
National Park Service**

**National Register of Historic Places
Inventory—Nomination Form**

For NPS use only
received
date entered

Continuation sheet

Item number

Page 40

916-22	"	"	Brick Late Victorian
917	"	"	Dutch Colonial
921	"	"	Early 20th-C. brick duplex
926	"	"	Queen Anne
930	"	"	Queen Anne
936	"	"	Queen Anne/Colonial Revival
1015	"	"	Queen Anne
1019	"	"	Queen Anne
1020	"	"	Queen Anne
1025	"	"	Queen Anne
1026	"	"	Queen Anne
1032	"	"	Late Victorian
823 Lucas Court			Hip-roof early 20th-C.
824	"	"	L-plan Late Victorian
827	"	"	Stucco early 20th-C.
816 W. Main Street			Queen Anne/Colonial Rev.
820	"	"	Queen Anne/Colonial Rev.
822	"	"	1920s Colonial
830	"	"	Queen Anne/Colonial Rev.
834	"	"	Queen Anne/Colonial Rev.
838	"	"	Queen Anne/Colonial Rev.
918	"	"	Second Church of Christ, Scientist (Georgian Revival-1938)
926	"	"	Italianate
1022	"	"	Late Victorian
1030	"	"	Rufus Tyler House (photo 47)
100 Monroe Street			Henderson Castle (photos 50-51)
109	"	"	Queen Anne/Colonial Rev.
115	"	"	Queen Anne/Colonial Rev.
116	"	"	Queen Anne/Colonial Rev.
119	"	"	Queen Anne/Colonial Rev.
Mountain Home Cemetery			Lodge (photos 48 and 119)
821 W. North Street			Late Victorian
823	"	"	Queen Anne/Colonial Revival
824	"	"	Queen Anne/Colonial Rev.
827	"	"	Queen Anne/Colonial Rev.
828	"	"	Queen Anne/Colonial Rev.
833	"	"	Queen Anne/Colonial Rev.
836	"	"	Queen Anne/Colonial Rev.
902	"	"	Queen Anne/Colonial Rev.
912-14	"	"	Queen Anne/Colonial Rev.
918-20	"	"	Queen Anne/Colonial Rev.

**United States Department of the Interior
National Park Service**

**National Register of Historic Places
Inventory—Nomination Form**

For NPS use only

received

date entered

Continuation sheet

Item number

Page 41

1002	"	"	Greek Rev.
1008	"	"	Stucco early 20th-C.
1009	"	"	Dutch Colonial
1011	"	"	Early 20th-C.
1012	"	"	Bungalow
200	Stuart Avenue		Italianate
216	"	"	Queen Anne/Colonial Rev.
220	"	"	Stucco hip-roof early 20th-C.
226	"	"	Late Victorian
229	"	"	Bartlett-Upjohn House (photo 41)
234	"	"	Queen Anne/Colonial Rev.
237	"	"	Queen Anne/Colonial Rev.
240	"	"	Late Victorian
301	"	"	Hip-roof early 20th-C.
302	"	"	Colonial Rev.
305	"	"	Mansard
308	"	"	Queen Anne
315	"	"	Queen Anne/Colonial Rev.
316	"	"	Taylor-Hatfield-Sutherland House (photo 42)
321	"	"	Davidson-McKee House (photo 43)
324	"	"	Queen Anne
405	"	"	Queen Anne
409	"	"	Late Victorian
412	"	"	Queen Anne/Colonial Rev.
415	"	"	Queen Anne/Colonial Rev.
418	"	"	Queen Anne
422	"	"	Queen Anne
427	"	"	Charles E. Stuart House (photo 44)
428	"	"	Italianate
432	"	"	Queen Anne/Colonial Rev.
435	"	"	Stucco early 20th-C. Italian
436	"	"	Brick Late Victorian
440	"	"	Brick Late Victorian
441	"	"	Queen Anne/Colonial Rev.
443	"	"	Queen Anne/Colonial Rev.
447	"	"	Queen Anne
500	"	"	Brick Late Victorian
504	"	"	Queen Anne
505	"	"	Queen Anne
507-09	"	"	Brick Italianate
515	"	"	Brick Late Victorian
519	"	"	Queen Anne/Colonial Rev.

**United States Department of the Interior
National Park Service**

**National Register of Historic Places
Inventory—Nomination Form**

For NPS use only

received

date entered

Continuation sheet

Item number

Page 42

521	"	"	Queen Anne/Colonial Rev.
525	"	"	Stucco bungalow
603	"	"	Stucco hip-roof early 20th-C.
606	"	"	Woodward Avenue School--early 20th-C. Georgian Revival
607	"	"	Queen Anne/Colonial Rev.
611	"	"	Early 20th-C. cottage
617	"	"	Early 20th-C. cottage
704	"	"	Stucco early 20th-C.

106 Thompson Street Brick early 20th-C. Italian

110	Woodward Avenue		Late Victorian
116	"	"	Queen Anne/Colonial Rev.
206	"	"	Late Victorian
208	"	"	Queen Anne
211	"	"	William A. Johnson House (photos 40 and 112)
214	"	"	Late Victorian
218	"	"	Queen Anne/Colonial Rev.
219	"	"	Stucco-clad Italianate
226	"	"	Grant Tuttle House (photo 39)
229	"	"	Brick bungalow
232	"	"	Brick Queen Anne
303	"	"	Italianate
306	"	"	Late Victorian
312	"	"	Queen Anne
315	"	"	Italianate
318	"	"	Queen Anne/Colonial Rev.
323	"	"	Queen Anne
324	"	"	Queen Anne
409	"	"	Late Victorian
412	"	"	Queen Anne/Colonial Rev.
417	"	"	Late Victorian
418	"	"	Late Victorian
421	"	"	Late Victorian
424	"	"	Queen Anne
427	"	"	Queen Anne
428	"	"	Queen Anne/Colonial Rev.
432	"	"	Late Victorian cottage
433	"	"	Queen Anne
438	"	"	Queen Anne
439-41	"	"	Queen Anne/Colonial Rev.
502	"	"	Queen Anne
505	"	"	Queen Anne/Colonial Rev.
506	"	"	Queen Anne
511	"	"	Greek Rev.
522	"	"	Late Victorian

**United States Department of the Interior
National Park Service**

**National Register of Historic Places
Inventory—Nomination Form**

For NPS use only
received
date entered

Continuation sheet

Item number

Page 43

530	"	"	Queen Anne
534	"	"	Queen Anne
602	"	"	Early 20th-C. cottage
606	"	"	Queen Anne
610	"	"	Queen Anne
616-18	"	"	Hip-roof early 20th-C. duplex

Non-Contributing Structures

521 Douglas Avenue	Brick ranch house
806 Elmwood Street	Garrison Colonial
532 W. Kalamazoo Avenue	1920s commercial building
615 W. Kalamazoo Avenue	Modern auto-repair facility
622 W. Kalamazoo Avenue	Mid-20th-C. church
706 W. Kalamazoo Avenue	Denatured Late Victorian
824 W. Kalamazoo Avenue	Denatured Queen Anne
817 W. North St.	20th - C. store
311 Woodward Avenue	The Colonial - mid-20th-C. apartment house

Significance:

Period: 1800-1900, 1900-

Areas of Significance: architecture, art, commerce, industry, politics/government.

The Stuart Neighborhood/Henderson Park Historic District is significant as Kalamazoo's finest late nineteenth- and early twentieth-century residential neighborhood, containing the architecturally significant homes of a large number of the city's commercial, industrial, and civic leaders. The district is also notable for the Mountain Home Cemetery, a fine rural cemetery with winding roadways, handsome funerary art, and an 1892, stone, sexton's lodge.

The Stuart neighborhood saw its beginnings in the 1840s and 1850s as a largely rural suburban adjunct of Kalamazoo. Mountain Home Cemetery, located on the hilly ground above what is now the Stuart area, was established in the late 1840s and in the 1840s and early 1850s the first suburban residences were built in the area. The building of United States Senator Charles E. Stuart's villa (1854-58) at 427 Stuart Avenue and the platting of the area in the 1850s led to further development in the 1860s and 1870s. However, the area's real growth began in 1884, when a horse-car line was introduced, and continued into the early twen-

**United States Department of the Interior
National Park Service**

**National Register of Historic Places
Inventory—Nomination Form**

For NPS use only

received

date entered

Continuation sheet

Item number

Page 44

tieth century. In this period the Stuart neighborhood became the city's most fashionable residential quarter, as the city's leading carriage, paper, and plow manufacturers and other businessmen and professionals and no less than three United States senators--Charles E. Stuart, Francis B. Stockbridge, and Julius C. Burrows--located there.

The district is notable in architectural terms for its fine houses exemplifying the Greek and Gothic modes and the Italianate, Mansard, Eastlake, Queen Anne, and Colonial Revival styles. The Bartholomew House at 832 Elmwood Street is Kalamazoo's finest example of a flank-gable, Greek Revival house. The Amariah T. Prouty House at 302 Elm Street is a particularly pleasing example of an early, Gothic cottage; it is trimmed with open-work bargeboards, label moldings over the windows, and a cluster-column veranda. Representative of the district's handsome Italianate structures is the cupola-crowned, four-square William A. Johnson House at 211 Woodward Avenue. The bracketed Davidson-McKee double house at 321 Stuart Avenue typifies the district's relatively small number of mansard houses. With its very steeply pitched roofs, jagged roofline, and pattern of vertical, horizontal, and diagonal planking, the Chappell-Stewart House at 213 Elm Street is a most unusual example of the Eastlake style. The district is particularly rich in fine examples of Queen Anne, such as the Bartlett-Upjohn House at 229 Stuart Avenue and the Taylor-Hatfield-Sutherland House at 316-18 Stuart Avenue. Both houses have broad verandas, a multitude of gables, and corner towers. However, in the "Henderson Castle" at 100 Monroe Street, the district contains Kalamazoo's finest Queen Anne mansion.

The district is also significant for containing the Mountain Home Cemetery, a handsome example of a rural cemetery. The Mountain Home Cemetery Association was incorporated in 1849 and, in January, 1850, purchased the bulk of the present cemetery grounds, a hilly, heavily wooded tract overlooking the central part of town. Luther H. Trask (1807-1888), a local surveyor and civil engineer, laid out the grounds. The plan and the winding roadways conform to the hilly nature of the terrain and the grounds remain heavily wooded to the present time. The present, stone gatehouse/sexton's lodge, built in 1892 from the plans of U. D. Wheaton (replacing an earlier, frame structure), is a particularly notable example of the gatehouse genre. The cemetery is also notable for its 1878, Gothic Revival receiving vault and for its funerary art, which includes a broad representation of Late Victorian and early twentieth-century monument types, including several 1890s, zinc, stone-imitation monuments made by the Detroit Monumental Bronze Company.

The following are some of the pivotal structures in the district:

Chappell-Stewart House (Photos 33 and 34)
213 Elm Street
Eastlake
1880

Delos A. Chappell, an engineer with a national reputation, completed this unique home in 1880. His father, Allen, was a contractor and apparently oversaw its construction. Delos didn't live here long, however. He went west in 1881, made his fortune in hydraulic engineering, and settled in Denver, Colorado. In the 1890s, Chappell's relatives sold this Kalamazoo home to a family friend, Judge Nathaniel A. Stewart. When Delos Chappell passed away in 1916, his death was announced in the New York Times. Judge Stewart brought the body back to Kalamazoo where the funeral was held in the old home.

The Chappell House has an asymmetrical facade with a large gable balanced by a square tower with a pyramidal roof. The house has an irregular roofline with lofty chimney stacks; open timberwork porches;

**United States Department of the Interior
National Park Service**

**National Register of Historic Places
Inventory—Nomination Form**

For NPS use only

received

date entered

Continuation sheet

Item number

Page 45

and exterior cladding of vertical, horizontal, and diagonal boarding held together by a timberwork grid. The lot is very deep and has the original carriage house which is now employed as a studio. On the interior, each room is finished in a different hardwood; oak, walnut, and cherry are each used. Stained glass windows accent the main stairway and the billiard room. The house contains early electroliners in working order.

Amariah T. Prouty House (Photos 35 and 36)
302 Elm Street
Gothic Revival
1852

This Gothic house, moved a short distance from its original site, was the home of Amariah T. Prouty, said to be the first nurseryman in the area. A cabinetmaker by trade, Prouty came to Kalamazoo from New York State in 1835 and constructed this home in 1852 in what was then a rural setting.

The Prouty House is one of only a few Gothic cottages in the Kalamazoo area. The two-story, frame house has a rectangular plan with a delicate open porch on two sides, facing Elm and Eleanor Streets. The gabled Elm Street end has scroll-motif, sawn bargeboards, turned finials, an oriel window, and a bay window. The wooden porch is composed of thin colonettes supporting Gothic tracery.

Charles C. Capen House (Photo 37)
808 W. Kalamazoo Avenue
Queen Anne
1885

Charles C. Capen, owner of a local millinery store, and his wife, Rosamond, and family moved into this new residence in the fall of 1885. In the following years, the local press commented on the annual buying trips he made to the East to restock his millinery store, as well as a pleasure trip to the 1893 Chicago World's Fair. Capen died in this home in 1903.

The Capen House is one of many fine Queen Anne homes built in the Stuart neighborhood in the late nineteenth century. The house is two and one-half stories in height and of frame construction. The facade is enlivened by an open, two-story porch, whose upper level has a gable roof with bargeboards and a gable screen. The balustrade is composed of small boards with a floral, cut-out design. This pierced floral motif appears time and time again on many Kalamazoo homes--including the Edgar A. Crane House at 324 Woodward, the James B. Cobb House at 526 South Burdick, and the Culver-Austin House at 215 Rose Place. The lower level of the porch is also gabled and has a bargeboard. Both levels of the porch employ paired turned posts. At the southwest corner of the house there is a two-story, square bay with an open porch on the second story.

W. G. Bartholomew House (Photo 38)
832 Elmwood Street

**United States Department of the Interior
National Park Service**

**National Register of Historic Places
Inventory—Nomination Form**

For NPS use only

received

date entered

Continuation sheet

Item number

Page 46

Greek Revival
Date Uncertain

Local legend suggests that this house was once the tenant's house on the old Woodward farm which earlier covered much of the area. It is known that the house was moved to this Elmwood site in the early 1870s and that a cabinetmaker by the name of W. G. Bartholomew was then its occupant.

This house is the best example of a flank-gable, Greek Revival home in Kalamazoo. Facing south on Elmwood Street, the house consists of a main block with open front porch, an open porch on the east, and a large, twentieth-century, rear addition which includes a garage. The facade is asymmetrical. The entrance is flanked by two bays on the west and one on the east. The fine entrance is flanked by sidelights and Doric pilasters and fronted by a square-post front porch. The house's attic windows are covered with wooden, Greek-key-pattern grilles.

Pond-Upjohn House (no photo)
409 Woodward Avenue
Queen Anne
1882

Edward F. Pond, this home's first occupant, was a businessman associated with a local lumber company. Pond purchased the Woodward Avenue property from Charles A. Dewing, his employer, in the spring of 1882. He built the home and lived there until 1888. Between 1892 and 1907, the home belonged to Dr. James T. Upjohn of the Upjohn Company. James T. Upjohn was one of the movers behind the Upjohn Company, having served as its vice-president and later as treasurer. Shortly before the First World War, Upjohn sold his interest in the family company and pursued other interests, notably business and politics.

Compared with other large structures in the Stuart area, this home is fairly conservative in design. What makes it appealing is the wraparound porch in the Queen Anne style which features fine balustrades. The house is two stories in height and is of frame construction. It follows a basic T-shaped plan.

Edgar A. Crane House (no photo)
324 Woodward Avenue
Queen Anne
Architect: Martin W. Roberts
1884-1885

This home, designed by local architect Martin Roberts, was built for Kalamazoo lawyer E. A. Crane. Roberts was an important local architect whose achievements are known to include the Ihling-Everard Building on East Michigan Avenue, Old Fire House No. 4 at 526 North Burdick, and his own residence at 703 Wheaton Avenue. The Michigan-born E. A. Crane was a soldier in the Civil War who collaborated in the capture of Jefferson Davis. Crane's personal life was marked by the tragic early deaths of his wife and only two sons. Crane moved shortly thereafter to a large house on the edge of what is now Crane Park (a gift to the city upon his death) on the city's south side.

Like many of the homes in the Stuart neighborhood, this is a wooden residence in the Queen Anne style.

**United States Department of the Interior
National Park Service**

**National Register of Historic Places
Inventory—Nomination Form**

For NPS use only

received

date entered

Continuation sheet

Item number

Page 47

The two-and-one-half-story home displays the characteristic irregular roofline with many gables. Several of these gables exhibit "fish-scale" exterior shingles. There is a small one-story bay on the northeast corner of the house and a large gabled porch. The side and rear porches feature a pierced lattice which has a floral motif.

Grant Tuttle House (Photo 39)
226 Woodward Avenue
Queen Anne
1885

Grant Tuttle was born in Kalamazoo in 1838, the son of pioneer builder Lyman Tuttle. After distinguished service in the Civil War, Grant joined his father in the construction trade. This home, constructed in 1885, demonstrates Tuttle's skills. Tuttle lived in the house only a short time, after which it became the residence of local druggist David McDonald. In this century, the occupants included local businessman William Crowe, whose family occupied the home between 1931 and 1968.

Built in the Queen Anne style, this house is a two-and-one-half-story, frame building set upon a cut stone foundation. It is L-shaped with a porch set in the angle. The open porch is gabled and features elaborate spindlework and sawn brackets. The facade is further enlivened by a beveled corner window on the first floor. The window is flanked by elaborate filigree brackets.

William A. Johnson House (Photos 40 and 112)
211 Woodward Avenue
Italianate
1864

After attending Albion College and practicing medicine in Albion, Michigan, Dr. William Johnson moved to Kalamazoo where he worked in a pharmaceutical concern. A wealthy man, Johnson lived in this house until his death in 1883. From then until the 1920s, Johnson's stepdaughter, Madelon Stockwell Turner (who was somewhat of a recluse), made her home here. Turner was an exceptional woman of her day. She was the first female to earn a literary degree from the University of Michigan, where a dormitory was named in her honor.

This brick structure is one of the outstanding Italianate homes in the city. It has a hooded entrance porch, a square cupola, round-headed windows with rounded hoods on the second floor, and wide eaves supported by intricate wooden brackets. This home, like many others in the Stuart neighborhood, has been restored in recent years.

Bartlett-Upjohn House (Photo 41)
229 Stuart Avenue
Queen Anne
1886

**United States Department of the Interior
National Park Service**

**National Register of Historic Places
Inventory—Nomination Form**

For NPS use only

received

date entered

Continuation sheet

Item number

Page 48

Kalamazoo publisher Edgar E. Bartlett built this massive home in 1886, but lived in it only a short time. Bartlett left town a few years later to head an Illinois newspaper. In 1907, Dr. James T. Upjohn, one of the founders of the Upjohn Company, moved here from a few blocks away. Upjohn sold his interests in the drug firm and became a successful businessman and politician. He was elected to the state legislature in the 1920s and he served several terms.

This sprawling structure is one of the most elaborate Queen Anne residences in Kalamazoo. It features the irregular roofline and floor plan characteristic of the style. Designed for its street-corner location, the home is dominated by a tower set diagonally across the corner. The facade of the two-and-one-half-story structure is enlivened by multiple gables, beveled corners with brackets, and a spindlework veranda.

Taylor-Hatfield-Sutherland House (Photo 42)
316-18 Stuart Avenue
Queen Anne
1889

This residence was built in 1889 for Frederick Taylor, an agricultural implement manufacturer. Soon after the turn of the century, James H. Hatfield, president of the Kalamazoo Corset Company and the Kalamazoo Paper Box Company, bought the house. From 1922 to 1948 Louis Sutherland of the Sutherland Paper Company lived here. Each of these men were leaders of important local industries.

The house is a large, two-and-one-half-story, hip-roof, Queen Anne structure with a pyramid-roof, square tower placed diagonally across one corner and with prominent front and side gables. A frame structure whose walls are clad in clapboarding with decorative accents of vertical tongue-and-groove sheathing and patterned shingling of various types, this imposing structure has a broad veranda which, sweeping across the front and around part of one side, displays some of Kalamazoo's most elaborate turned-post columns; a bracketed cornice; panel-brick chimneys; and an octagon-butt-pattern, slate roof. A broad-fronted "bay window" in front has curved plate glass windows in its quarter-circle side panels. The Taylor-Hatfield-Sutherland House is one of Kalamazoo's finest Queen Anne structures.

Davidson-McKee House (Photo 43)
321 Stuart Avenue
Mansard
1867

Local builder Manly Davidson constructed this home in 1867 and occupied it for several years when the scheduled owner defaulted on the mortgage. In 1872 Davidson sold the home to furniture salesman John McKee. Born in Northern Ireland, McKee came to Kalamazoo shortly before the Civil War and associated himself with the prominent local firm of Carder and Gilbert. McKee was later successful in his own business and lived in this duplex home until his death in 1896.

This symmetrical-fronted, two-and-one-half-story, frame dwelling is one of the few mansard structures in Kalamazoo. The house, which has turn-of-the-century, gabled, colonial entrance porches at each end of the facade, has a concave mansard roof pierced by segmental-arch-head dormers and supported on a paired-bracket cornice.

**United States Department of the Interior
National Park Service**

**National Register of Historic Places
Inventory—Nomination Form**

For NPS use only

received

date entered

Continuation sheet

Item number

Page 49

Charles E. Stuart House (Photo 44)
427 Stuart Avenue
Italianate
1854-1858

Local businessman Hiram Arnold had this fine house constructed but sold it in the summer of 1859 to Charles E. Stuart. Stuart was one of Michigan's leading citizens; he served as (Democratic) United States Senator from 1852 to 1858. The Senator's home was the scene of elaborate entertainment. In 1860 Stuart was host here to presidential candidate Stephen A. Douglas. Stuart named nearby Douglas Avenue in honor of the "Little Giant." Senator Stuart lived in this home until 1883. Later occupants included local horseman Samuel Brown and prominent businessman and real estate developer Charles B. Hays.

The Stuart House is a large, square, two-story, brick, Italianate structure. The basic conservatism of design is seen in the symmetry of the facade and in the simple, paired windows. (The present Georgian front entranceway is an early twentieth-century alteration.) Small frieze windows are located under the eaves and the structure is crowned by a large cupola. The interior, which includes a third-floor ballroom, features paneled mahogany walls and Italian marble fireplaces. The home also boasted of the town's first indoor plumbing, complete with wooden pipes.

Fire Station No. 5 (Photo 45)
619 Douglas Avenue
Tudor Revival
Architect: F. D. Van Volkenberg
1907-1908

In the first decade of this century, the Kalamazoo Fire Department built several new engine houses outside the central city area to keep pace with the town's growing suburban population. Fire Station No. 5 was one of these new stations. Planned by local architect Forrest D. Van Volkenberg, the station was designed to match its neighborhood's suburban character. Van Volkenberg was also responsible for several other fire stations built in the town, including Engine House No. 3 at 607 Charlotte Avenue and the Central Fire Station (since destroyed). Fire records show that on August 30, 1908, the horse-driven firemen made their first run from the station to extinguish an auto fire. Nearly three-quarters of a century later, the building still houses a city fire station.

This two-and-one-half-story, brick and stucco building is built in a twentieth-century Tudor Revival form that complements the Tudor Revival residences which were being built in the Stuart area at this time. In fact, it can be said that the station looks somewhat like a residence with an over-sized garage.

James A. Kent House (Photo 46)
331 Douglas Avenue
Late Victorian

**United States Department of the Interior
National Park Service**

**National Register of Historic Places
Inventory—Nomination Form**

For NPS use only

received

date entered

Continuation sheet

Item number

Page 50

1865

James Kent came to Kalamazoo from New York in 1856 as a young carpenter and was soon a full partner in a sash and door factory. A few years later, Kent left this company to concentrate on home building. It seems likely that Kent built his own house. He lived here for fifty years, until his death in the autumn of 1915.

The Kent House is an unusual structure which defies stylistic classification. It has a low, concave, mansard roof and a prominent front gable whose roofline repeats the roof's concave form. The flush-boarded walls are pierced by tall, centrally mullioned windows with crisp, Tudor-inspired hood moldings and the plain eaves are sparingly trimmed with brackets.

Rufus Tyler House (Photo 47)
1030 W. Main Street
Italianate
1872

Rufus Tyler was the co-owner of a large lumber planing mill established in 1870. Capitalizing on Michigan's lumbering boom, the company prospered, enabling Tyler to build this substantial residence. In 1884 Tyler sold the home to businessman Hiram Brooks Miller, whose family retained the property until 1925.

This large, two-and-one-half-story, frame, Italianate house has an L-shaped plan with an open porch located in the angle. The facade is enlivened with round-headed windows, thin cornerboards, an oculus window in the gable, and a bracketed and paneled frieze. The paired brackets which support the broadly projecting eaves slant at an angle corresponding to the angle of the gable.

Mountain Home Cemetery Sexton's Lodge (Photos 48 and 119)
Mountain Home Cemetery, West Main Street
Queen Anne
Architect: U. D. Wheaton
1892

Mountain Home Cemetery was established in the spring of 1848. Designed to be an elegant cemetery in a pastoral setting, it soon became the town's prestigious final resting place. Many local notables are interred here, including arctic explorer Edward Israel; United States Senators Charles E. Stuart, Francis B. Stockbridge, and Julius C. Burrows; and Michigan Governor Epaphroditus Ransom. The present sexton's lodge, the cemetery's second, was constructed in 1892 to the specifications of local architect and contractor Ulysses D. Wheaton. For many years it was the home and workshop of sexton/florists James Fraser and later James Borland. Though the cemetery was ceded to the city of Kalamazoo shortly before World War II, a florist shop remained in this building until the late 1950s. Since this time the lodge has been rented out as an apartment.

The former sexton's lodge is an irregular, one-and-one-half-story structure of rock-faced, random-ashlar, brown sandstone construction, with a round, conical-roof tower and open, square-pier entrance porch. Two hip-roof dormers have fishscale-shingle side walls.

**United States Department of the Interior
National Park Service**

**National Register of Historic Places
Inventory—Nomination Form**

For NPS use only

received

date entered

Continuation sheet

Item number

Page 51

Ihling-Burdick House (Photo 49)
1903 Grand Avenue
Queen Anne/Colonial Revival
1905

One of the first residents of the Henderson Park Addition, Carl W. Ihling had this home built in 1905. Ihling was the son of Reinhold Ihling of the Ihling and Everard Company, publishers and printers. Carl was engaged in the furniture business as a young man, but joined the family firm upon his father's death in 1919. Ihling lived in this house only a short time. Willis J. Burdick, a banker, purchased the residence in 1915 and lived here until the late Fifties.

The lofty, two-and-one-half-story Ihling-Everard House is one of Kalamazoo's finest Queen Anne/Colonial Revival residences. It combines Queen Anne irregularity of form and bracketed cornices and fishscale shingling characteristic of the Queen Anne mode with Colonial details such as fanlights, broken and triangular window pediments, and arched, pilaster-framed openings.

Henderson Castle (Photos 50 and 51)
Monroe at West Main Street (100 Monroe Street)
Queen Anne
Architect: Charles A. Gombert of Milwaukee
1890-1895

Crowning the hill which overlooks downtown Kalamazoo from the west, the Henderson Castle is Kalamazoo's outstanding Late Victorian residence and one of Michigan's nineteenth-century showplaces. The house was constructed in 1890-95 for Frank Henderson, a successful regalia manufacturer. In the late 1880s Henderson had had the Henderson Park area, previously farm land belonging to the family of his wife, Mary Taylor Henderson, platted into streets and lots. Laid out with winding roads to take advantage of the area's rolling topography, the subdivision became Kalamazoo's first exercise in "natural-site" planning.

Henderson Castle crowns the area's highest ground, at the head of the triangular Henderson Park. In 1890, Henderson hired Milwaukee architect Charles A. Gombert to provide the plans. Gombert was no stranger to the town; he was the brother-in-law of Kalamazoo's Otto Ihling. He had lived in the town for a short while some years earlier and had designed some local homes. Five years and \$72,000 later, the mansion was completed. But Henderson did not enjoy it long. In 1899, he died after an extended illness. The Castle is still a single-family home.

This remarkable Queen Anne structure rests on a large hill overlooking the town and is imposing from any direction. The home employs wood, brick, and Lake Superior red sandstone for exterior materials and has an impressive roofline which features complex finial-topped towers, gables, and dormers. The structure is further noted for its profuse use of stained glass and the many porches and balconies. The home's interior is just as extraordinary, featuring mahogany, bird's-eye maple, quartered oak, birch, and sycamore-wood trim.

**United States Department of the Interior
National Park Service**

**National Register of Historic Places
Inventory—Nomination Form**

For NPS use only
received
date entered

Continuation sheet

Item number

Page 52

Bibliography:

Graham, Ann, Henderson Park: The Design and Development of Kalamazoo's Most Fashionable Suburb 1888-1930, Kalamazoo College Local History Program, 1979 (unpublished paper available at Kalamazoo College Archives).

Hill, Roderick, A History of Kalamazoo Street Railways, Kalamazoo College History Seminar, paper no. 26 (unpublished paper available at Kalamazoo College Archives).

McCain, Anne, A Biography of Charles E. Stuart, Kalamazoo's First Senator, Kalamazoo College History Seminar, paper no. 65 (unpublished paper available at Kalamazoo College Archives).

Minutes of Mountain Home Cemetery Trustees 1890-1895.

"The Work of F. D. Van Volkenberg," in Ohio Architect and Builder, Vol. 26, No. 2 (Aug., 1915).

Dunbar.

Hendry.

Portrait and Biographical Record, pp. 239-40.

Kalamazoo Gazette: 2-15-1856, p. 2; 7-30-1892, p. 1; 2-3-1911, p. 1; 2-10-1916, p. 6; 5-28-1944.

Kalamazoo Weekly Gazette: 8-15-1884, p. 5; 10-9-1885, p. 5.

Kalamazoo Semi-Weekly Telegraph: 9-29-1880, p. 4.

Kalamazoo Telegraph: 5-12-1903, p. 6.

Geographical Data:

Acreage: 122 acres

Quadrangle Name: Kalamazoo

Quadrangle Scale: 1: 24000

UTM References:	A	16	615380	4683530
	B	16	615825	4683600
	C	16	616190	4683250
	D	16	615840	4682910
	E	16	615340	4682930
	F	16	614720	4682950
	G	16	615040	4683300

Verbal Boundary Description and Justification:

**United States Department of the Interior
National Park Service**

**National Register of Historic Places
Inventory—Nomination Form**

For NPS use only

received

date entered

Continuation sheet

Item number

Page 53

1. Stuart Neighborhood

Commencing at the SW corner of lot 24 of Trask's Addition to the City of Kalamazoo as recorded at the Kalamazoo County Register of Deeds office in Liber 2, page 26 for place of beginning. Thence westerly along the south right-of-way line of West Main Street a distance of 1150 feet, then north 350 feet, thence east 30 feet, thence north 200 feet, thence west 10 feet, thence north 80 feet, then west 10 feet, thence north 180 feet, thence west 110 feet to the east right-of-way line of Ingleside Terrace. Thence north along said right-of-way line 200 feet, thence east 110 feet, thence north 130 feet to the south line of Forbes Street, thence east along south line of Forbes Street a distance of 60 feet, said point being 80 feet west of the SW intersection point of Forbes Street and Douglas Avenue. Thence north 90 feet, thence west 10 feet, thence north 120 feet to the south line of Jefferson Avenue, said point being 100 feet west of the NW intersection corner of Jefferson Avenue and Douglas Avenue. Thence west 70 feet, thence north 450 feet to the south right-of-way line of West North Street. Thence east 160 feet to the NE lot corner of lot number 6 of Doubledays Second Revised Addition to the City of Kalamazoo as recorded in Liber 5, page 14 of the Kalamazoo County Register of Deeds Office, said point being the SW intersection corner of Douglas Avenue and W. North Street. Thence continuing south-easterly a distance of 120 feet to the SW corner of lot 25 of Hawleys Addition to the City of Kalamazoo (unrecorded). Thence east 40 feet, thence south 10 feet, thence east 85 feet, thence north 30 feet, thence east 60 feet, thence south 10 feet, thence east 20 feet, thence north 25 feet, thence east 10 feet, thence east 10 feet, thence north 65 feet to the south right-of-way line of West North Street. Thence east along said right-of-way line 75 feet to the NE corner of Lot 10 of said Hawleys Addition. Thence northeasterly 75 feet to the SW corner of Lot 1 of Brown and Hoekstra's Addition of the City of Kalamazoo as recorded in Liber 8, page 30 at the Kalamazoo County Register of Deeds Office. Thence north along east right-of-way line of Stuart Avenue a distance of 80 feet, thence east 170 feet to the west right-of-way line of Staples Avenue. Thence north along said right-of-way line 40 feet, thence east 140 feet to the NE corner of lot 3, block 2 of Winslow's Addition to the City of Kalamazoo as recorded in Liber 3, page 36 at the Kalamazoo County Register of Deeds Office. Thence north 30 feet, thence east 150 feet to the west of the right-of-way line of Woodward Avenue. Thence southeasterly 70 feet to the NW corner of lot 4, block 1 of said plat. Thence east along said north line of lot 4 to the NE corner of lot 3, block 1 of said plat. Thence north 20 feet, thence east 60 feet, thence south 20 feet, thence east 80 feet to the west right-of-way line of Cobb Avenue. Thence south 150 feet to a point on the south right-of-way line of West North Street, said point being 150.5 feet west of the SW intersection corner of W. North and Elm Street. Thence continuing south 50 feet, thence east 115.5 feet to the west street line of Elm Street, thence continuing east along said line a distance of 130 feet, said point being 60 feet south of the NE corner of lot 90 of Wabeke's Addition to the City of Kalamazoo as recorded in Liber 2, page 16 at the Kalamazoo County Register of Deeds Office, thence south 100 feet to the SE corner of said lot 90, thence east 10 feet, thence south 100 feet to the SE corner of lot 83 of said plat, said point being on north of right-of-way line of Ransom Street, thence east along said right-of-way line 30 feet, thence south 250 feet to the SE corner of lot 180 of said plat, said point being 1030 feet west of the quarter post of section 16 Township 2 South Range 11 West. Thence continuing south 220 feet to the south right-of-way line of Willard Street, said point being NE corner of lot 67 of Prouty's Revised Addition to the City of Kalamazoo as recorded in Liber L, page 480 at the Kalamazoo County Register of Deeds Office. Thence continuing south a distance of 35 feet, thence east 30 feet, thence south 90 feet, thence west 50 feet, thence south 90 feet, thence east 40 feet, thence south 20 feet, thence east 70 feet, thence south 40 feet, thence east 30 feet, thence south 30 feet, thence east 40 feet, thence north 100 feet, thence east 160 feet, thence south 50 feet,

**United States Department of the Interior
National Park Service**

**National Register of Historic Places
Inventory—Nomination Form**

For NPS use only

received

date entered

Continuation sheet

Item number

Page 54

thence east 90 feet to the west right-of-way line of Greenwich Place, said point being 120 feet north of the NW intersection corner of said Greenwich Place and W. Kalamazoo Avenue. Thence continuing east 50 feet, thence south 25 feet, thence east 60 feet, thence north 40 feet, thence east 30 feet, thence north 40 feet, thence east 70 feet, thence north 20 feet to the south right-of-way line of the New York Central Railroad. Thence southeasterly along said right-of-way line 350 feet more or less to a point 80 feet north of the NW intersection corner of North Westnedge and Kalamazoo Avenues, said point also being the northernmost of right-of-way line of the Penn Central Railroad. Thence southwesterly along said northerly railroad right-of-way line a distance of 1700 feet, said point being 220 feet southeasterly from place of beginning. Thence northwesterly 220 feet to place of beginning.

2. Henderson Park Commencing at the NE corner lot 22 of University Addition to the City of Kalamazoo as recorded in Liber 1, Page 9 at the office of the Kalamazoo County Register of Deeds, for place of beginning of land hereafter described. Thence southerly 150 feet along said east line of lot 22, thence west 150 feet, thence south 60 feet, thence west 60 feet, thence north 60 feet, thence west 290 feet, thence south 70 feet, thence west 200 feet, thence south 75 feet, thence west 130 feet to the east line of Monroe Street. Thence continuing northwesterly 80 feet to a point on the east line of lot 53 of the Revised Plat of Henderson Park Terrace, as recorded in Liber 5, Page 40 at the office of the Kalamazoo County Register of Deeds, said point being 35 feet north of the SE corner of said lot. Thence continuing northwesterly 110 feet, thence northerly 40 feet, thence southwesterly 40 feet, thence northwesterly 110 feet to a point on the south line of Grand Avenue, said point being 120 feet northeasterly of the NW corner of lot 54 of said Revised Plat of Henderson Park Terrace. Thence continuing northwesterly 70 feet to the SE corner of lot 4 of said plat. Thence continuing westerly on the north street line of Prospect Street to the SW corner of lot 4 of said Revised Plat of Henderson Park Terrace. Thence continuing northeasterly along the west side of lots 4 and 6 to West Main Street. Thence southeasterly along the south street line of West Main Street a distance of 1050 feet to the NW corner of lot 24 of the University Addition to the City of Kalamazoo. Thence east 198 feet to the place of beginning.

3. Mountain Home Cemetery
Commencing at the SE corner of lot 38 of Forbes Addition to the City of Kalamazoo as recorded in Liber 3, page 40 at the office of the Kalamazoo County Register of Deeds. Thence southeasterly 220 feet to the NE corner of lot 48 of said plat. Thence south 340 feet to the SE corner of lot 53 of said plat, said point being on the northerly right-of-way line of West Main Street. Thence southeasterly along the north right-of-way line of West Main Street a distance of 1100 feet to an angle point in West Main Street, said point being 700 feet northwesterly of the west right-of-way line of Ingleside Terrace. Thence continuing 540 feet southeasterly to a point 160 feet west of the west right-of-way line of said Ingleside Terrace. Thence north 950 feet, thence west 49.5 feet, thence north 132 feet to the south street line of Forbes Street, said point being 150.5 feet west of the west right-of-way line of Ingleside Terrace. Thence west 930 feet to the NE corner of lot 22 of said Forbes Addition. Thence south along the easterly plat line of Forbes Addition 211 feet to the SE corner of said lot. Thence west along the southerly plat line of Forbes Addition 438.24 feet to the NE corner of lot 38 of said plat. Thence south 148.5 feet to the SE corner of said lot 38 to the place of beginning.

The district as presently defined represents the earliest and most historically and architecturally significant residential areas on the near west side. It is recognized that other areas adjoining these core areas also possess considerable significance and may meet the National Register criteria. However, because they are either newer or do not possess the same level of architectural or historical significance that the

**United States Department of the Interior
National Park Service**

**National Register of Historic Places
Inventory—Nomination Form**

For NPS use only

received

date entered

Continuation sheet

Item number

Page 55

core area possesses, the necessary research and documentation work has been given a lower priority. Thus, the present western boundary of the Stuart neighborhood part of the district and the boundaries of the Henderson Park section were drawn to include the most architecturally and historically significant, late nineteenth- and very early twentieth-century sections of the west side and to exclude other early twentieth-century areas to the west which appear to possess somewhat less historic and architectural importance.

The strip of land to the west of the Stuart neighborhood and east of Mountain Home Cemetery was excluded because its homes, located along a narrow alley in what were originally the backyards of the properties on the west side of Douglas Avenue, are somewhat newer than those in the remainder of the area and are very modest and often heavily altered structures which bear little relation to the other Stuart structures and do not contribute positively to the area's historic character. The Stuart neighborhood's southern boundary was drawn to correspond with West Main Street because of the extensive alterations to and demolitions of historic structures south of the street. The southeastern boundary corresponds with the former Michigan Central Railroad tracks, which mark the edge of the central business district. The Stuart neighborhood's irregular northeastern boundary was drawn to include all of Kalamazoo Avenue west of the tracks (despite the presence of several, early and mid-twentieth-century, commercial structures at its east end) because the street serves as the main entranceway to the neighborhood from downtown, but to exclude the ramshackle and deteriorated warehouses, shops, and commercial facilities (interspersed with some housing) along the west side of the New York Central tracks south of North Street. The northern boundary along North Street was drawn to include several blocks of fine turn-of-the-century housing stock on the north side west to Stuart Street and to exclude a twentieth-century, commercial cluster at the intersection of North Street and Douglas Avenue.

The Mountain Home Cemetery was included in the district because its hilly, wooded topography forms a visual backdrop for both Henderson Park and the entire Stuart neighborhood and because of the close historical relationship between it and the two neighborhoods, whose upper- and middle-class character was at least in part established and promoted by the presence of the rural, park-like cemetery.

United States Department of the Interior
National Park Service

National Register of Historic Places
Inventory—Nomination Form

For NPS use only

received

date entered

Continuation sheet

Item number

Page 1 of 3

Multiple Resource Area
Thematic Group

dnr-11

Name Kalamazoo Multiple Resource Area
State Michigan

Nomination/Type of Review

Date/Signature

- | | | | |
|--|--|------------|--|
| 1. Bronson Park Historic District | Entered in the
National Register | for Keeper | <u>Melona Byers 5/27/83</u> |
| | | Attest | _____ |
| 2. Haymarket Historic District | Entered in the
National Register | for Keeper | <u>Melona Byers 5/27/83</u> |
| | | Attest | _____ |
| 3. Stuart Neighborhood/Henderson
Park Historic District | Entered in the
National Register | for Keeper | <u>Melona Byers 5/27/83</u> |
| | | Attest | _____ |
| 4. Vine Area Historic District | Substantive Review | Keeper | <u>Beth Grosvenor 8/16/83</u> |
| | | Attest | _____ |
| 5. Rose Place Historic District | Entered in the
National Register | for Keeper | <u>Melona Byers 5/27/83</u> |
| | | Attest | _____ |
| 6. Marlborough | Entered in the
National Register | for Keeper | <u>Melona Byers 5/27/83</u> |
| | | Attest | _____ |
| * see #29
7. Lilienfeld, David, House | Substantive Review
Determined Eligible
DOE/OWNER OBJECTION | Keeper | <u>Eligible - Beth Grosvenor 5/27/83</u> |
| | | Attest | _____ |
| 8. Gilbert, Henry, House | Substantive Review | Keeper | <u>Beth Grosvenor 5/27/83</u> |
| | | Attest | _____ |
| 9. Brown, Isaac, House | Entered in the
National Register | for Keeper | <u>Melona Byers 5/27/83</u> |
| | | Attest | _____ |
| 10. State Theater | Substantive Review
Determined Eligible
DOE/OWNER OBJECTION | Keeper | <u>Eligible - Beth Grosvenor 5/27/83</u> |
| | | Attest | _____ |

United States Department of the Interior
National Park Service

STUART
Stewart Neighborhood/Henderson Park Historic
District (Kalamazoo MRA)
Kalamazoo County
MICHIGAN

Working No. 4/13/83
Fed. Reg. Date: 2-7-84
Date Due: 5/19/83-5/24/83
Action: ACCEPT 5/27/83
 RETURN
 REJECT
Entered in the
National Register
Federal Agency: _____

- resubmission
- nomination by person or local government
- owner objection
- appeal

Substantive Review: sample request appeal NR decision

Reviewer's comments:

Recom./Criteria _____
Reviewer _____
Discipline _____
Date _____
see continuation sheet

Nomination returned for: technical corrections cited below
 substantive reasons discussed below

1. Name

2. Location

3. Classification

Category _____ Ownership _____ Status _____ Present Use _____
Public Acquisition _____ Accessible _____

4. Owner of Property

5. Location of Legal Description

6. Representation in Existing Surveys

has this property been determined eligible? yes no

7. Description

Condition _____ Check one _____ Check one _____
 excellent deteriorated unaltered original site
 good ruins altered moved date _____
 fair unexposed

Describe the present and original (if known) physical appearance

- summary paragraph
- completeness
- clarity
- alterations/integrity
- dates

8. Significance

Period _____ Area of Significance—Check and justify below _____

Specific dates _____ Builder/Architect _____

Statement of Significance (in one paragraph)

- _____ summary paragraph
- _____ completeness
- _____ clarity
- _____ applicable criteria
- _____ justification of areas checked
- _____ relating significance to the resource
- _____ context
- _____ relationship of integrity to significance
- _____ justification of exception
- _____ other

9. Major Bibliographical References

10. Geographical Data

Address of nominated property _____

Quadrangle name _____

USGS References _____

Verbal boundary description and justification _____

11. Form Prepared By

12. State Historic Preservation Officer Certification

The evaluated significance of this property within the state is:

_____ national _____ state _____ local

State Historic Preservation Officer signature _____

title _____ date _____

13. Other

- _____ Maps
- _____ Photographs
- _____ Other

Questions concerning this nomination may be directed to _____

Signed _____ Date _____ Phone: 202 272-3504

Comments for any item may be continued on an attached sheet



Stuart Neighborhood/Henderson Park Historic District
Kalamazoo, Kalamazoo County, Michigan

R. Parzyck June 1981
Neg.: Kalamazoo Historical Commission

Kalamazoo Ave. looking west from Stuart Ave.
Photo no. 28 of 105

19-12A

28



Stuart Neighborhood/Henderson Park Historic District
Kalamazoo, Kalamazoo County, Michigan

R. Parzyck June 1981
Neg.: Kalamazoo Historical Commission

Kalamazoo Ave. looking west
Photo no. 29 of 105

17-54

29



Stuart Neighborhood/Henderson Park Historic District
Kalamazoo, Kalamazoo County, Michigan

R. Parzyck June 1981
Neg.: Kalamazoo Historical Commission

Elm St. looking north from Kalamazoo Ave.
Photo no. 30 of 105



Stuart Neighborhood/Henderson Park Historic District
Kalamazoo, Kalamazoo County, Michigan

R. Parzyck June 1981

Neg.: Kalamazoo Historical Commission

Woodward Ave. looking north from W. Main St.

Photo no. 31 of 105

17-3A



22-7

Stuart Neighborhood/Henderson Park Historic District
Kalamazoo, Kalamazoo County, Michigan

R. Parzyck June 1981

Neg.: Kalamazoo Historical Commission

Mountain Home Cemetery grounds looking north
from near lodge

Photo no. 32 of 105



#33

51

Stuart Neighborhood/Henderson Park Historic District
Kalamazoo, Kalamazoo County, Michigan

B. Korab 1976

Neg.: Kalamazoo Historical Commission

Chappell-Stewart House from east

Photo no. 33 of 105

33



Stuart Neighborhood/Henderson Park Historic District
Kalamazoo, Kalamazoo County, Michigan

B. Korab 1976

Neg.: Kalamazoo Historical Commission

Chappell-Stewart House detail from east
Photo no. 34 of 105

51

34 #7



#34

Stuart Neighborhood/Henderson Park Historic District
Kalamazoo, Kalamazoo County, Michigan

B. Korab 1976

Neg.: Kalamazoo Historical Commission

Amariah T. Prouty House from SW

Photo no. 35 of 105



#22 7E

50

Stuart Neighborhood/Henderson Park Historic District
Kalamazoo, Kalamazoo County, Michigan

B. Korab 1976

Neg.: Kalamazoo Historical Commission

Amariah T. Prouty House detail from south
Photo no. 36 of 105

36



#3

49

Stuart Neighborhood/Henderson Park Historic District
Kalamazoo, Kalamazoo County, Michigan

Gary Cialdella April 1981
Neg.: Kalamazoo Historical Commission

Charles C. Capen House from SW
Photo no. 37 of 105

37



ELMWOOD ST

WOODWARD ST

#34

48

Stuart Neighborhood/Henderson Park Historic District
Kalamazoo, Kalamazoo County, Michigan

B. Korab 1976

Neg.: Kalamazoo Historical Commission

W. G. Bartholomew House from SW

Photo no. 38 of 105



47

Stuart Neighborhood/Henderson Park Historic District
Kalamazoo, Kalamazoo County, Michigan

B. Korab 1976

Neg.: Kalamazoo Historical Commission

Grant Tuttle House from west

Photo no. 39 of 105

#39
39



#40

Stuart Neighborhood/Henderson Park Historic District
Kalamazoo, Kalamazoo County, Michigan

Gary Cialdella April 1981
Neg.: Kalamazoo Historical Commission

William A. Johnson House from SE
Photo no. 40 of 105

40



134#

Stuart Neighborhood/Henderson Park Historic District
Kalamazoo, Kalamazoo County, Michigan

B. Korab 1976

Neg.: Kalamazoo Historical Commission

Bartlett-Upjohn House from east
Photo no. 41 of 105

45
41



27#

44

Stuart Neighborhood/Henderson Park Historic District
Kalamazoo, Kalamazoo County, Michigan

B. Korab 1976

Neg.: Kalamazoo Historical Commission

Taylor-Hatfield-Sutherland House from NE
Photo no. 42 of 105

42



Stuart Neighborhood/Henderson Park Historic District
Kalamazoo, Kalamazoo County, Michigan

Gary Cialdella April 1981
Neg.: Kalamazoo Historical Commission

Davidson-McKee House from east
Photo no. 43 of 105

43

43



#45

42

Stuart Neighborhood/Henderson Park Historic District
Kalamazoo, Kalamazoo County, Michigan

B. Korab 1976

Neg.: Kalamazoo Historical Commission

Charles E. Stuart House from NE
Photo no. 44 of 105

44



#10

41

Stuart Neighborhood/Henderson Park Historic District
Kalamazoo, Kalamazoo County, Michigan

Gary Cialdella April 1981
Neg.: Kalamazoo Historical Commission

Fire Station No. 5 from NE
Photo no. 45 of 105



Stuart Neighborhood/Henderson Park Historic District
Kalamazoo, Kalamazoo County, Michigan

B. Korab 1976

Neg.: Kalamazoo Historical Commission

James A. Kent House from east
Photo no. 46 of 105

47
46
L17#



87-~~A~~

Stuart Neighborhood/Henderson Park Historic District
Kalamazoo, Kalamazoo County, Michigan

Gary Cialdella April 1981
Neg.: Kalamazoo Historical Commission

Rufus Tyler House from south
Photo no. 47 of 105

39

47



65-#

Stuart Neighborhood/Henderson Park Historic District
Kalamazoo, Kalamazoo County, Michigan

Gary Cialdella April 1981
Req.: Kalamazoo Historical Commission

Sexton's Lodge, Mountain Home Cemetery, from east
Photo no. 48 of 105

124



Stuart Neighborhood/Henderson Park Historic District
Kalamazoo, Kalamazoo County, Michigan

Gary Cialdella April 1981
Neg.: Kalamazoo Historical Commission

Ihling-Burdick House from NW
Photo no. 49 of 105

37

49

880



#51

35

Stuart Neighborhood/Henderson Park Historic District
Kalamazoo, Kalamazoo County, Michigan

B. Korab 1976

Neg.: Kalamazoo Historical Commission

Henderson Castle from NE

Photo no. 50 of 105



#51

Stuart Neighborhood/Henderson Park Historic District
Kalamazoo, Kalamazoo County, Michigan

B. Korab 1976

Neg.: Kalamazoo Historical Commission

Detail of north side of Henderson Castle
Photo no. 51 of 105

96

51



12

#42

Rose Place Historic District
Kalamazoo, Kalamazoo County, Michigan

Gary Cialdella April 1981
Neg.: Kalamazoo Historical Commission

Culver-Austin House from NE
Photo no. 74 of 105



Stuart Neighborhood/Henderson Park
Historic District
Kalamazoo, Kalamazoo County, Michigan

R.O. Christensen Jan, 1983
Neg.. Michigan History Division

William A. Johnson House from ESE
Photo No. 112 of 123



Stuart Neighborhood/Henderson Park
Historic District
Kalamazoo, Kalamazoo County, Michigan

R.O. Christensen Jan, 1983
Neg.. Michigan History Division

East side of Woodward Avenue south from
Kalamazoo Avenue from SW
Photo no. 113 of 123



Stuart Neighborhood/Henderson Park
Historic District
Kalamazoo, Kalamazoo County, Michigan

R. O. Christensen Jan, 1983
Neg.. Michigan History Division

East side of Woodward Avenue north of
West Main Street from SW
Photo no. 114 of 123



Stuart Neighborhood/Henderson Park
Historic District
Kalamazoo, Kalamazoo County, Michigan

R.O. Christensen Jan, 1983
Neg.. Michigan History Division

East side of Woodward Avenue north of
Kalamazoo Avenue from SW
Photo no. 115 of 123



Stuart Neighborhood/Henderson Park
Historic District
Kalamazoo, Kalamazoo County, Michigan

R.O. Christensen Jan, 1983
Neg.. Michigan History Division

West side of Woodward Avenue north of
Kalamazoo Avenue from east
Photo no. 116 of 123



Stuart Neighborhood/Henderson Park
Historic District
Kalamazoo, Kalamazoo County, Michigan

R.O. Christensen Jan, 1983
Neg.. Michigan History Division

North side of Kalamazoo Avenue
East of Woodward Avenue from south
Photo no. 117 of 123



Stuart Neighborhood/Henderson Park
Historic District
Kalamazoo, Kalamazoo County, Michigan

R.O. Christensen Jan, 1983
Neg.. Michigan History Division

North side of Kalamazoo Avenue west
of Woodward Avenue from SE
Photo no. 118 of 123



Stuart Neighborhood/Henderson Park
Historic District
Kalamazoo, Kalamazoo County, Michigan

R.O. Christensen Jan, 1983
Neg.. Michigan History Division

Mountain Home Cemetery Sexton's Lodge
from NE (Henderson Castle in background)
Photo no. 119 of 123



Stuart Neighborhood/Henderson Park
Historic District
Kalamazoo, Kalamazoo County, Michigan

R.O. Christensen Jan, 1983
Neg..Michigan History Division

Mountain Home Cemetery, Henderson Park,
and Henderson Castle from NE
Photo no. 120 of 123



Stuart Neighborhood/Henderson Park
Historic District
Kalamazoo, Kalamazoo County, Michigan

R.O. Christensen Jan, 1983
Neg.. Michigan History Division

Looking east along West Main Street toward
downtown Kalamazoo: Mountain Home
Cemetery (L), Henderson Park (R)
Photo no. 121 of 123



Stuart Neighborhood/Henderson Park
Historic District
Kalamazoo, Kalamazoo County, Michigan

R.O. Christensen Jan, 1983
Neg.. Michigan History Division

Mountain Home Cemetery Receiving Vault
and grounds from south
Photo no. 122 of 123



Stuart Neighborhood/Henderson Park
Historic District
Kalamazoo, Kalamazoo County, Michigan

R.O. Christensen Jan, 1983
Neg.. Michigan History Division

South side of Grand Avenue from west
Photo no. 123 of 123

Please refer to the map in the
Multiple Property Cover Sheet
for this property

Multiple Property Cover Sheet Reference Number: 64000327

STUART HISTORIC DISTRICT

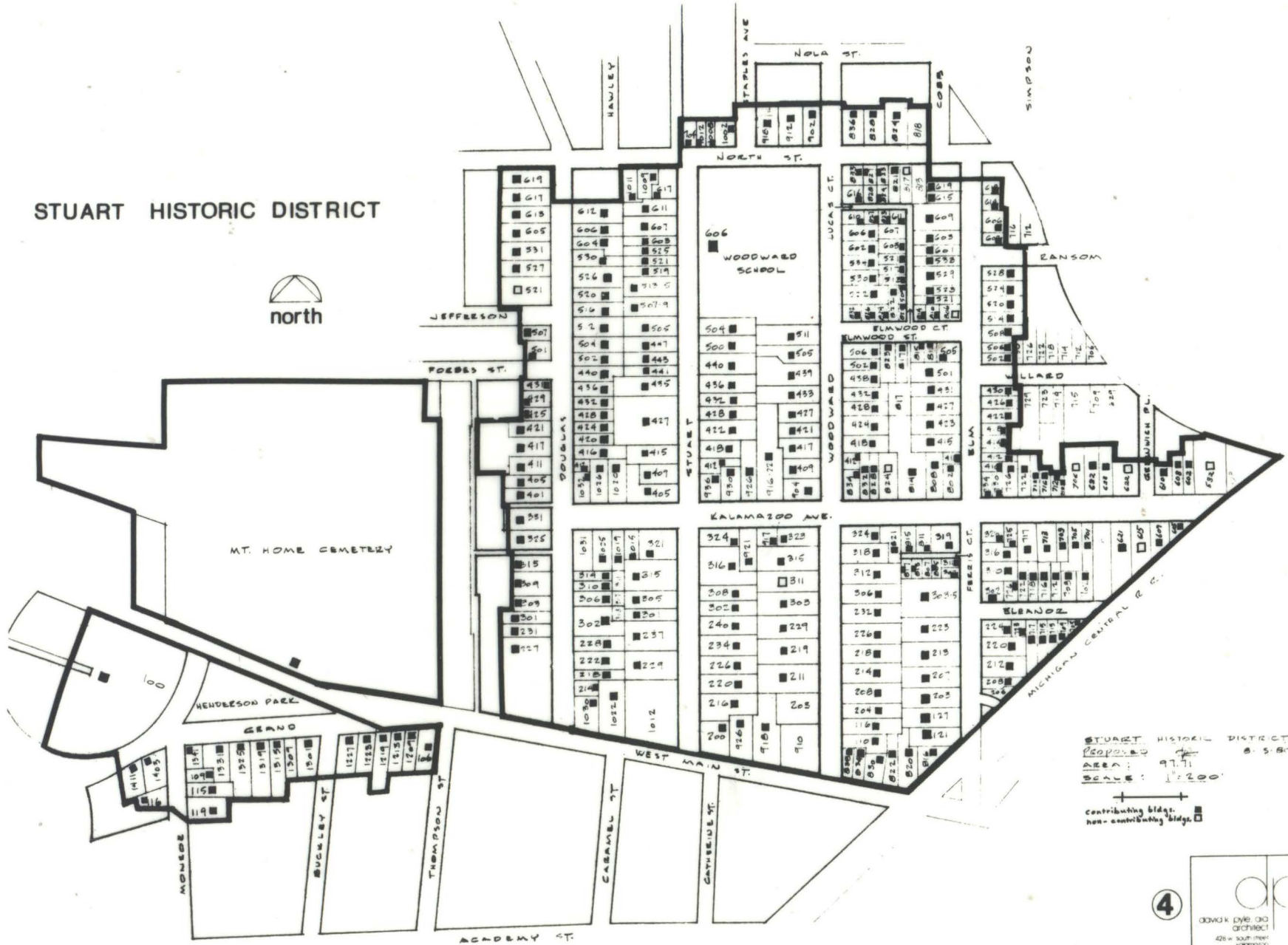

STUART HISTORIC DISTRICT
 Prepared by: [Signature] 8-5-87
 Date: 9-7-77
 Scale: 1" = 200'
 Contributing bldg. [Symbol]
 Non-contributing bldg. [Symbol]

4

david k. pyle, aa
 architect
 426 w. south street
 kalamazoo,
 michigan 49001



Stuart Area Restoration Association
910 W. Main, Kalamazoo, MI 49007

MAY 10 1982
MICHIGAN HISTORY DIVISION

May 6, 1982

Dr. Martha Bigelow
Michigan History Division
Michigan Department of State
Lansing, Mi. 48918

Dear Dr. Bigelow:

The Stuart Area Restoration Association Board of Directors endorses the application for our neighborhood to be placed on the National Register of Historic Places.

It has been the neighborhood's goal for many years to achieve the formal recognition of a national listing. We feel it will be a great benefit to the continuing restoration of our neighborhood.

We were not able to send a representative to attend the hearing, but that in no way diminishes our approval and desire to be granted a listing in the National Register.

Yours truly,

Patrick Rothi

Patrick Rothi
SARA Chairman

