

JAN 24 1990 FORM NO.

2

MASSACHUSETTS HISTORICAL COMMISSION  
80 BOYLSTON STREET  
BOSTON, MA 02116

PHOTOGRAPHS:

- 54:08 Front and left facades
- 54:01 Transverse summer beam into front story post which has been cut of left room (1st floor)
- 54:00 Transverse summer beam into rear story post of first-floor left room
- 54:03 chimney girt into rear chimney post of first-floor left room
- 54:07 Scarf joint of front plate over window in upper vestibule
- 54:06 Front plate and summer tie beam in right chamber

Town BEVERLY 009

Address 337 Cabot Street

Historic Name Hazadiah Smith House

Use: Present residence

Original residence

DESCRIPTION

Date c. 1686

Source deeds

Style First Period

Architect unknown

Exterior Wall Fabric clapboard

Outbuildings none

Major Alterations (with dates) rear room

added in 18th century

Condition good

Moved no Date n/a

Acreage less than an acre

Setting residential and commercial

urban streetscape - properties on small city

lots - major route to city center.

Recorded by James Kyptianos

Organization Boston University

Date May 1986

Sketch Map:

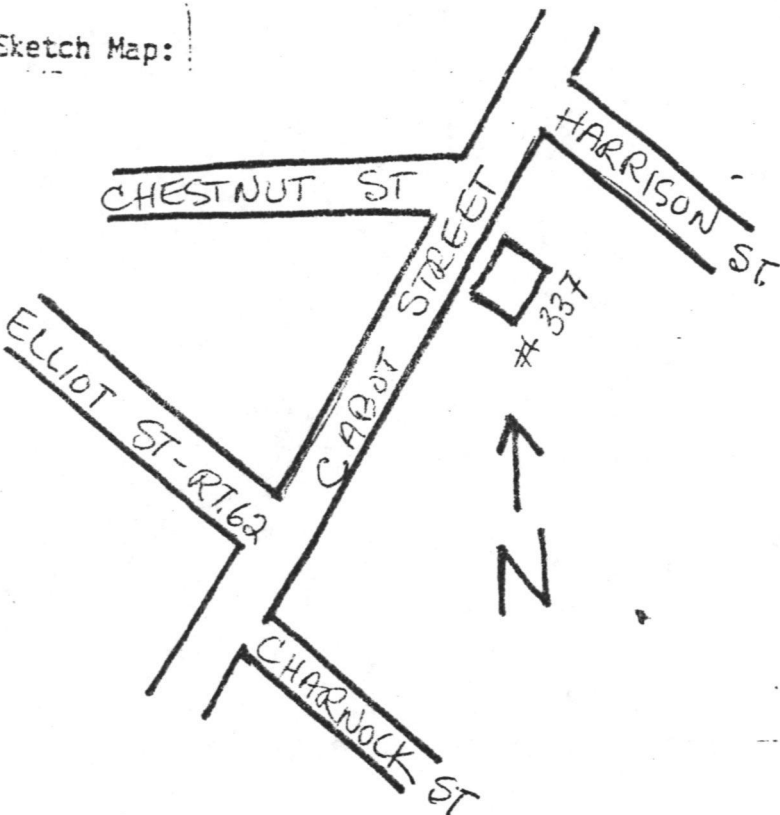

Z E N

TM REFERENCE 19 / 345-760 / 4712-840

GS QUADRANGLE Salem

SCALE 1:25,000

INVENTORY FORM CONTINUATION SHEET

MASSACHUSETTS HISTORICAL COMMISSION  
Office of the Secretary, Boston

Community: BEVERLY	Form No: 2
Property Name: Hazadiah Smith House	

Indicate each item on inventory form which is being continued below.

SIGNIFICANCE

The Hazadiah Smith House retains integrity of location, materials, design and workmanship in its decorated First-Period frame under Criterion C. The transverse summer beams and pine frame are typical traits of early Beverly houses worthy of further study under Criterion D. The visibility of most of the frame reveals a systematic housewide apportioning of certain chamfer and stop types to certain classes of framing members, which when further studied, will reveal information important to our understanding of the First-Period carpenter's concept of the house and its frame.

EXTERIOR DESCRIPTION:

The Hazadiah Smith House is a two-and-a-half story, five-bay clapboarded building, two rooms deep with a central chimney plan. The original First-Period house was a double-cell, central chimney structure; the later addition of rear rooms and new roof has left the central chimney stack protruding through the front slope below the ridge of the present roof. The original main facade, adorned with a nineteenth century gabled entrance porch, is now obscured by mature plantings. The left gable end of the house faces the street.

MAJOR FIRST-PERIOD FEATURES

The front rooms on both floors exhibit a complete and consistent system of decorated pine framing members. The first floor rooms have transverse summer beams, typical in Beverly, with bevel chamfers and lamb's tongue stops. The story and chimney posts in the left hand room have bevel chamfers with taper stops and molded jowls. The chimney girt has a bevel chamfer with lamb's tongue stops; the corner posts and end girt have bevel chamfers with taper stops. The 9' wide fireplace opening is probably original, although the present beehive oven seems to be reconstructed. As this room is larger (15'6" x 16' 6") than the right-hand room (15' 6" x 14'), and contains a very large fireplace, it may have been the original "hall" (or kitchen) of the dwelling except for its position in the house toward the street. The right first-floor room has little framing visible besides the summer beam, but the visible heads of the cut-off posts are similarly molded and jowled. There is evidence that the walls were infilled with brick nogging.

The two second floor chambers also exhibit chamfers on all visible framing members. All of the tie beams have bevel chamfers and lamb's tongue stops. The plates and posts have bevel chamfers with taper stops. A scarf joint is visible in the plate over the window in the second floor vestibule.

HISTORICAL INFORMATION

The house is also associated with three important local craftsmen who were part of the broad pattern of local production of goods in colonial America. Hazadiah Smith, who moved to Beverly c. 1675 and acquired the parcel of land containing the present house in 1686, was called a "carpenter" or "house carpenter" in all deeds recording

INVENTORY FORM CONTINUATION SHEET

MASSACHUSETTS HISTORICAL COMMISSION  
Office of the Secretary, Boston

Community: BEVERLY	Form No: 2
Property Name: Hazadiah Smith House	

Indicate each item on inventory form which is being continued below.

his many land transactions. He is probably the builder as well as first owner of the present house. If the house was built soon after he acquired the land, it represents an early example of the late First-Period simplified decorative system using bevel chamfers and lamb's tongue and taper stops. As Smith was active in Beverly from 1675 until sometime before his death in 1726, it is possible that he was responsible for building some of Beverly's other surviving First Period houses; detailed comparison would reveal any stylistic similarities. Smith's son, Hazadiah Jr., was also a carpenter. he left the house in 1729/30 to his son Ebenezer Smith, silversmith, who owned it until his death in 1817. Examples of Ebenezer's pewter and lamp work still survive on display at the Beverly Historical Society. The house's association with three craftsmen whose work still remains visible in Beverly today is of particular interest.

1/24/90

United States Department of the Interior  
National Park Service

National Register of Historic Places  
Continuation Sheet

Section number \_\_\_\_\_ Page \_\_\_\_\_

Multiple Resource Area  
Thematic Group

Name First Period Buildings of Eastern Massachusetts TR  
State \_\_\_\_\_

Nomination/Type of Review

Date/Signature

71. Putnam, Deacon Edward, Jr., House  
Entered in the  
National Register

Keeper *Melrose Byers* 3/9/90

Attest \_\_\_\_\_

72. Putnam, James, Jr., House Entered in the  
National Register

Keeper *Melrose Byers* 3/9/90

Attest \_\_\_\_\_

73. Ross Tavern **Substantive Review**

Keeper *Betty L. Savage* 3/9/90

Attest \_\_\_\_\_

74. Sawyer House Entered in the  
National Register

Keeper *Melrose Byers* 3/9/90

Attest \_\_\_\_\_

75. Smith House Entered in the  
National Register

Keeper *Melrose Byers* 3/9/90

Attest \_\_\_\_\_

76. Smith, Hazariah, House Entered in the  
National Register

Keeper *Melrose Byers* 3/9/90

Attest \_\_\_\_\_

77. Thorndike, Capt. John, House Entered in the  
National Register

Keeper *Melrose Byers* 3/9/90

Attest \_\_\_\_\_

78. Titcomb, Benaiah, House Entered in the  
National Register

Keeper *Melrose Byers* 3/9/90

Attest \_\_\_\_\_

79. Tufts, Rev. John, House Entered in the  
National Register

Keeper *Melrose Byers* 3/9/90

Attest \_\_\_\_\_

80. White--Ellery House Entered in the  
National Register

Keeper *Melrose Byers* 3/9/90

Attest \_\_\_\_\_

UNITED STATES DEPARTMENT OF THE INTERIOR  
NATIONAL PARK SERVICE

NATIONAL REGISTER OF HISTORIC PLACES  
EVALUATION/RETURN SHEET

REQUESTED ACTION: NOMINATION

PROPERTY NAME: Smith, Hazadiah, House

MULTIPLE NAME: First Period Buildings of Eastern Massachusetts TR

STATE & COUNTY: MASSACHUSETTS, Essex

DATE RECEIVED: 1/24/90      DATE OF PENDING LIST: 2/07/90  
DATE OF 16TH DAY: 2/23/90      DATE OF 45TH DAY: 3/10/90  
DATE OF WEEKLY LIST:

REFERENCE NUMBER: 90000200

NOMINATOR: STATE

REASONS FOR REVIEW:

APPEAL: N    DATA PROBLEM: N    LANDSCAPE: N    LESS THAN 50 YEARS: N  
OTHER: N    PDIL: N    PERIOD: N    PROGRAM UNAPPROVED: N  
REQUEST: N    SAMPLE: N    SLR DRAFT: N    NATIONAL: N

COMMENT WAIVER: N

ACCEPT     RETURN     REJECT    3/9/90 DATE    Entered in the National Register

ABSTRACT/SUMMARY COMMENTS:

RECOM./CRITERIA \_\_\_\_\_  
REVIEWER \_\_\_\_\_  
DISCIPLINE \_\_\_\_\_  
DATE \_\_\_\_\_

DOCUMENTATION see attached comments Y/N see attached SLR Y/N

---

CLASSIFICATION

count       resource type

---

STATE/FEDERAL AGENCY CERTIFICATION

---

FUNCTION

historic       current

---

DESCRIPTION

architectural classification  
 materials  
 descriptive text

---

SIGNIFICANCE

Period      Areas of Significance--Check and justify below

Specific dates      Builder/Architect  
Statement of Significance (in one paragraph)

summary paragraph  
 completeness  
 clarity  
 applicable criteria  
 justification of areas checked  
 relating significance to the resource  
 context  
 relationship of integrity to significance  
 justification of exception  
 other

---

BIBLIOGRAPHY

---

GEOGRAPHICAL DATA

acreage       verbal boundary description  
 UTM's       boundary justification

---

ACCOMPANYING DOCUMENTATION/PRESENTATION

sketch maps       USGS maps       photographs       presentation

---

OTHER COMMENTS

Questions concerning this nomination may be directed to

\_\_\_\_\_ Phone \_\_\_\_\_

Signed \_\_\_\_\_ Date \_\_\_\_\_



Beverly, MA  
Hazariah Smith House  
337 Cabot Street  
transverse summer  
beam  
1985

1st Period Buildings of E. May, TR

54:00



Beverly, MA

Hazaliah Smith House

337 Cabot Street

transverse summer beam

1985

1st Period Buildings of E. Mass, TR

54:01



Beverly, MA  
Hazadiah Smith House  
337 Cabot Street  
Chimney girt into rear  
chimney post  
1985

1st World Building of Earth, MA

54:03

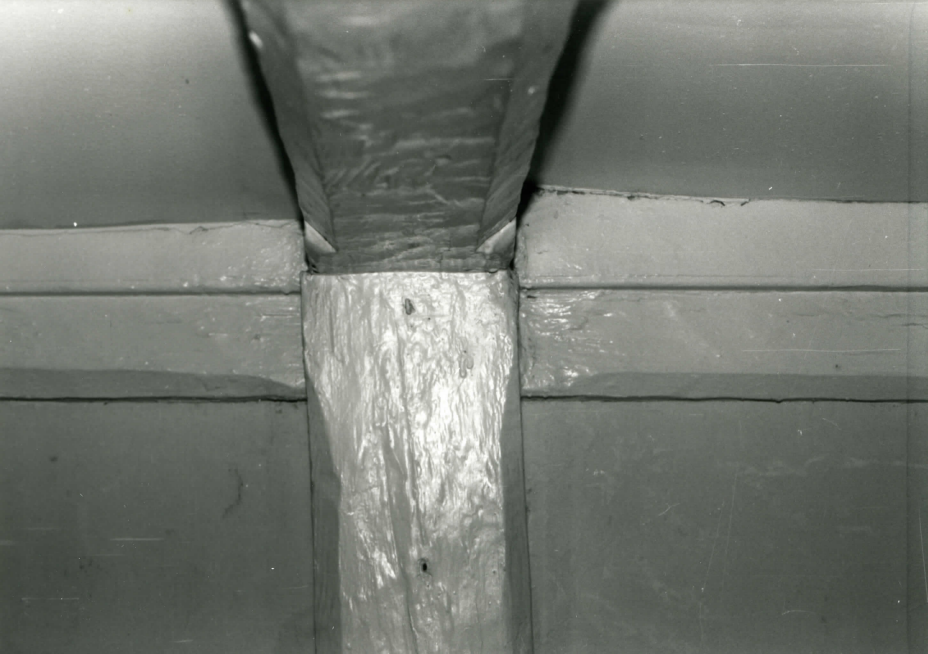

Beverly, MA  
Hazadiah Smith House  
337 Cabot Street  
front plate + summer tie beams  
1985

54:06



Beverly, MA

Hazariah Smith House

337 Cabot Street

Scarl joint of front plate  
1985

54:07



BUILT BY  
HANCOCK BROS.  
1876

337 Cabot Street, Beverly  
Beverly, MA

Huzariah Smith House

337 Cabot Street  
front + left facade

1985

1st Period Buildings of E. May, TR

(54-08)



LEGEND  
 PARCEL NUMBERS ..... 1  
 ADJACENT MAPS ..... 2  
 MATCH LINE .....

*Hazadiah Smith House*  
 337 Cabot Street  
 TAP 20 Lot 331

PROPERTY MAP  
 CITY OF BEVERLY  
 ESSEX COUNTY, MASSACHUSETTS  
 PREPARED BY  
 JAMES W. SEWALL COMPANY OLD TOWN, MAINE  
 SCALE 1 INCH = 100 ± FEET

Please refer to the map in the  
Multiple Property Cover Sheet  
for this property

Multiple Property Cover Sheet Reference Number: 64000281