

2261

DEC 05 1989

FORM F - STRUCTURE

AREA	FORM NO.
	3-4

MASSACHUSETTS HISTORICAL COMMISSION
80 BOYLSTON STREET
BOSTON, MA 02116

Town Framingham

Address Between U.S. 30 and Mass. Route

Name Framingham Reservoir #3, Dam and Gate-
house

Ownership: MDC Public
Private

Type of Structure (check one):

- bridge _____
- canal _____
- dam XX
- fort _____
- gate _____
- kiln _____
- lighthouse _____
- pound _____
- powder house _____
- street _____
- tower _____
- tunnel _____
- wall _____
- windmill _____
- other and gatehouse

Photo (3"x3" or 3"x5" black and white)
Indicate address on back of photo.
Staple to left side of form.

Sketch Map: Draw map showing structure's location
in relation to nearest cross streets, buildings
and/or geographical features. Indicate all
buildings between inventoried property and nearest
intersection.
Indicate north. see attached

DESCRIPTION

Date 1876-1878

Source Internal Report, Desmond Fitzgerald,
1898

Architect Engineer/Designer (if known):
George Clough, Architect

Construction material granite, earth, concrete

Alterations (with dates) n/a

Condition good

Moved no Date _____

Acreage approximately one acre

Setting dense suburban residential and
commercial area

Recorded by Jane Carolan

Organization Louis Berger & Associates

Date January 1984; revised 1989

UTM REFERENCE 19/297190/468560

USGS QUADRANGLE Framingham, MA

SCALE 1:25,000

NATIONAL REGISTER CRITERIA STATEMENT (if applicable)

Framingham Reservoir #3 Dam and Gatehouse are significant for their association with the Sudbury Supply, the second water supply system built by the Metropolitan Water Board of the City of Boston. The Dam and Gatehouse are examples of municipal water technology and architecture of the mid to end of the nineteenth century (1876-1878). The gatehouse is further considered eligible since it was designed by George Clough, Boston City Architect from 1873 to 1883. The Dam and Gatehouse retain integrity of location, design, setting, materials, workmanship and feeling and meet Criteria A and C of the National Register of Historic Places. The boundary of the Framingham #3 Reservoir Dam and Gatehouse which are being nominated is only the gatehouse and dam and does not include any land around these structures. The boundary is shown on (cont.)

ARCHITECTURAL SIGNIFICANCE Describe important architectural features and evaluate in terms of other buildings within the community.

Framingham Reservoir #3 is located in the crowded suburban town of Framingham. Reservoir #3 is the largest of the three Framingham Reservoirs. It is about two miles long and extends northwest from its dam and gatehouse. It is separated into two parts by the Massachusetts Turnpike, built in the mid-1950s and the tracks of Conrail.

The gatehouse has a rectangular main block and wing, both with steep hipped roofs. The building is constructed of two shades of gray granite, with the darker color used for walls and the lighter color for quoins, string course and window surrounds. Windows are narrow, vertical, and rectangular and the door has a round arch. The building is topped with a brass cupola.

The granite gate chamber contains a 48" main connecting the reservoir to Framingham #1; six 4'x5' gates which control three chambers through which water flows into the 48" pipe; three 4'x5' gates which control water into an additional 48" pipe.

The dam for Reservoir #3 is located at the southeast end of the southeast portion of the reservoir. A spillway is centered between two earthen embankments, which are six feet higher than the overfall, are 2,180 long and have core walls of granite rubble with a berm (continued)

HISTORICAL SIGNIFICANCE Explain the role owners played in local or state history and how the building relates to the development of the community.

The three Framingham Reservoirs, including dams and gatehouses, were constructed during the phase II expansion of Boston's municipal water supply system (1875-95; refer to Overview, Section 8, pp. 2-6 for additional information). Basically this phase supplemented the Cochituate Aqueduct (Area A) of phase I by extending the system further west to the Sudbury River water shed. The major nominated resources associated with this phase are the Sudbury Aqueduct (Area B) and the three Framingham Reservoirs (3-2, 3, 4). Although its water quality was not the highest, the Sudbury River was selected as Boston's new source in 1872 because it would provide a large and consistent amount of water. The Framingham Reservoirs were built in an attempt to ameliorate the problem of water quality. They served as giant settling basins that allowed natural cleansing of the water by pooling it and letting heavier foreign material fall to the bottom. Mains in the dams were placed so that water could be taken at higher levels to avoid pollution. Under the direction of Joseph P. Davis, a civil engineer, and Alphonse Fteley, Resident Water Board Engineer, the Sudbury Aqueduct was constructed from Farm Pond in Framingham to the Chestnut Hill Reservoir (Area E) in Brighton, along with three settling and storage reservoirs on the north branch of the Sudbury River in Framingham, and a conduit from the dam at Framingham Reservoir #1 to Farm Pond. The Ashland Reservoir (4-3) was added to the system in 1885 as reservoir #4, as was the Hopkinton Reservoir (4-4) in 1891 as reservoir #6. The long-planned Sudbury Reservoir (see Area F) was added as reservoir #5 in 1893. While the Framingham Reservoirs, Gatehouses and Dams are intact today, increasing industrial development in the area surrounding the reservoirs has made the water unsuitable for use. Thus they have been removed from service.

BIBLIOGRAPHY and/or REFERENCES

Metropolitan Water Works, Sudbury Department, Photographs, Vol. 1, 6201-7651, 1907-1920.
Internal Report, Desmond Fitzgerald to Frederic Stearns on the Sudbury River Works, 15 June 1898
Boston Water Works, Additional Supply from Sudbury River, Description of the Work, 1882.

INVENTORY FORM CONTINUATION SHEET

MASSACHUSETTS HISTORICAL COMMISSION
Office of the Secretary, Boston

Community: Framingham	Form No: 3-4
Property Name: Framingham #3	

Indicate each item on inventory form which is being continued below.

NATIONAL REGISTER CRITERIA STATEMENT:

attached map, Framingham Reservoir No.1, Metropolitan Water Works, Land Plans, January 1915.
Scale: 100' = 1".

ARCHITECTURAL SIGNIFICANCE:

on the upstream side of the embankment. The 100.25 foot long overflow is constructed of granite rubble laid in cement mortar. Above ground the rubble is faced and coped with cut granite. The bottom of the sheet piling extends 14' below the bottom of the masonry which itself extends 15' below the level of the meadow. The overflow was protected with flashboards held in place by stone pins.

The dam above the foundation was constructed by J.E. Fuller and V.H. Nash, Worcester; the gatehouse, designed by the office of George A. Clough, Boston City Architect, was built by Benjamin F. Dewing, Boston.

For additional information, please refer to Overview, Section 7: Reservoirs, Dams.

Large passive reservoirs of this type have not been included for nomination due to their large size and lack of readily perceivable man-made features.

Staple to Inventory form at bottom

United States Department of the Interior
National Park Service

National Register of Historic Places
Continuation Sheet

Section number _____ Page _____

Water Supply System of Metropolitan Boston MPS
Middlesex, Norfolk, Suffolk and Worcester Counties, MASSACHUSETTS

DATE LISTED

- COVER
- 1. Ashland Dam and Spillway
- 2. Framingham Reservoir No. 3 Dam and Gatehouse **Substantive Review**
- 3. Framingham Reservoir No. 2 Dam and Gatehouse
- 4. Framingham Reservoir No. 1 Dam and Gatehouse
- 5. Hopkinton Dam and Spillway
- 6. Lake Cochituate Dam
- 7. Medford Pipe Bridge
- 8. Middlesex Fells Reservoirs Historic District **Substantive Review**
- 9. Mystic Dam
- 10. Mystic Gatehouse **Substantive Review**
- 11. Mystic Pumping Station
- 12. Sudbury Aqueduct Linear District
- 13. Sudbury Dam Historic District
- 14. Weston Aqueduct Linear District
- 15. Fisher Hill Reservoir and Gatehouse
- 16. Forbes Hill Standpipe
- 17. Bellevue Standpipe
- 18. Chestnut Hill Reservoir Historic District
- 19. Marlborough Brook Filter Beds **Substantive Review**

Beth L. Swartz 01-18-90
Helene Byers 1-18-90
Beth L. Swartz 01-18-90
Helene Byers 1-18-90
Helene Byers 1-18-90
Helene Byers 1-18-90
Helene Byers 1-18-90
Beth L. Swartz 01-18-90
Helene Byers 1-18-90
Beth L. Swartz 01-18-90
Helene Byers 1-18-90
Helene Byers 1-18-90
Helene Byers 1-18-90
Helene Byers 1-18-90
Helene Byers 1-18-90
Helene Byers 1-18-90
Helene Byers 1-18-90
Beth L. Swartz 01-18-90

L 5/12/91

L 5/12/91

L 5/12/91

L 5/12/91

United States Department of the Interior
National Park Service

National Register of Historic Places
Continuation Sheet

Section number _____ Page _____

SUPPLEMENTARY LISTING RECORD

NRIS Reference Number: 89002261

Date Listed: 01/18/90

Framingham Reservoir No. 3
Dam and Gatehouse
Property Name

Middlesex
County

MA
State

Water Supply System of Metropolitan Boston MPS
Multiple Name

This property is listed in the National Register of Historic Places in accordance with the attached nomination documentation subject to the following exceptions, exclusions, or amendments, notwithstanding the National Park Service certification included in the nomination documentation.

for Beth A. Savage
Signature of the Keeper

01-18-90
Date of Action

Amended Items in Nomination:

10. Geographical Data

The UTM provided is incomplete; it should read 19/297190/4685130.
This information was confirmed by Ann Tait, MASHPO, by telephone.

DISTRIBUTION:

- National Register property file
- Nominating Authority (without nomination attachment)

UNITED STATES DEPARTMENT OF THE INTERIOR
NATIONAL PARK SERVICE

NATIONAL REGISTER OF HISTORIC PLACES
EVALUATION/RETURN SHEET

REQUESTED ACTION: NOMINATION

PROPERTY NAME: Framingham Reservoir No. 3 Dam and Gatehouse

MULTIPLE NAME: Water Supply System of Metropolitan Boston MPS

STATE & COUNTY: MASSACHUSETTS, Middlesex

DATE RECEIVED: 12/05/89 DATE OF PENDING LIST: 12/19/89
DATE OF 16TH DAY: 1/04/90 DATE OF 45TH DAY: 1/19/90
DATE OF WEEKLY LIST:

REFERENCE NUMBER: 89002261

NOMINATOR: STATE

REASONS FOR REVIEW:

APPEAL: N DATA PROBLEM: N LANDSCAPE: N LESS THAN 50 YEARS: N
OTHER: N PDIL: N PERIOD: N PROGRAM UNAPPROVED: N
REQUEST: N SAMPLE: N SLR DRAFT: Y NATIONAL: N

COMMENT WAIVER: N

ACCEPT RETURN REJECT 1/18/90 DATE

ABSTRACT/SUMMARY COMMENTS:

Locally significant dam and gatehouse within the context of Boston's metropolitan water supply development.

RECOM./CRITERIA Accept at C
REVIEWER Jaege
DISCIPLINE Architectural History
DATE 01-18-90

DOCUMENTATION see attached comments Y (N) see attached SLR (Y) N

CLASSIFICATION

count resource type

STATE/FEDERAL AGENCY CERTIFICATION

FUNCTION

historic current

DESCRIPTION

architectural classification
 materials
 descriptive text

SIGNIFICANCE

Period Areas of Significance--Check and justify below

Specific dates Builder/Architect
Statement of Significance (in one paragraph)

summary paragraph
 completeness
 clarity
 applicable criteria
 justification of areas checked
 relating significance to the resource
 context
 relationship of integrity to significance
 justification of exception
 other

BIBLIOGRAPHY

GEOGRAPHICAL DATA

acreage verbal boundary description
 UTM's boundary justification

ACCOMPANYING DOCUMENTATION/PRESENTATION

sketch maps USGS maps photographs presentation

OTHER COMMENTS

Questions concerning this nomination may be directed to

_____ Phone _____

Signed _____

Date _____



MDC - TRA, MASS.

Framingham Reservoir Dam + Gate house #3,
Jane Carolina / Martha Bowers 1924 Framingham,
Louis Berger + Ass. Mo.

Water supply system of Metropolitan Boston MPS

Framingham Reservoir #3, Dam and Gatehouse
 Framingham Reservoir No.1, Metropolitan
 Water Board, Land Plans, January 1913.
 Scale: 200' = 1".

#3-4

MDC - TRA, MASS.

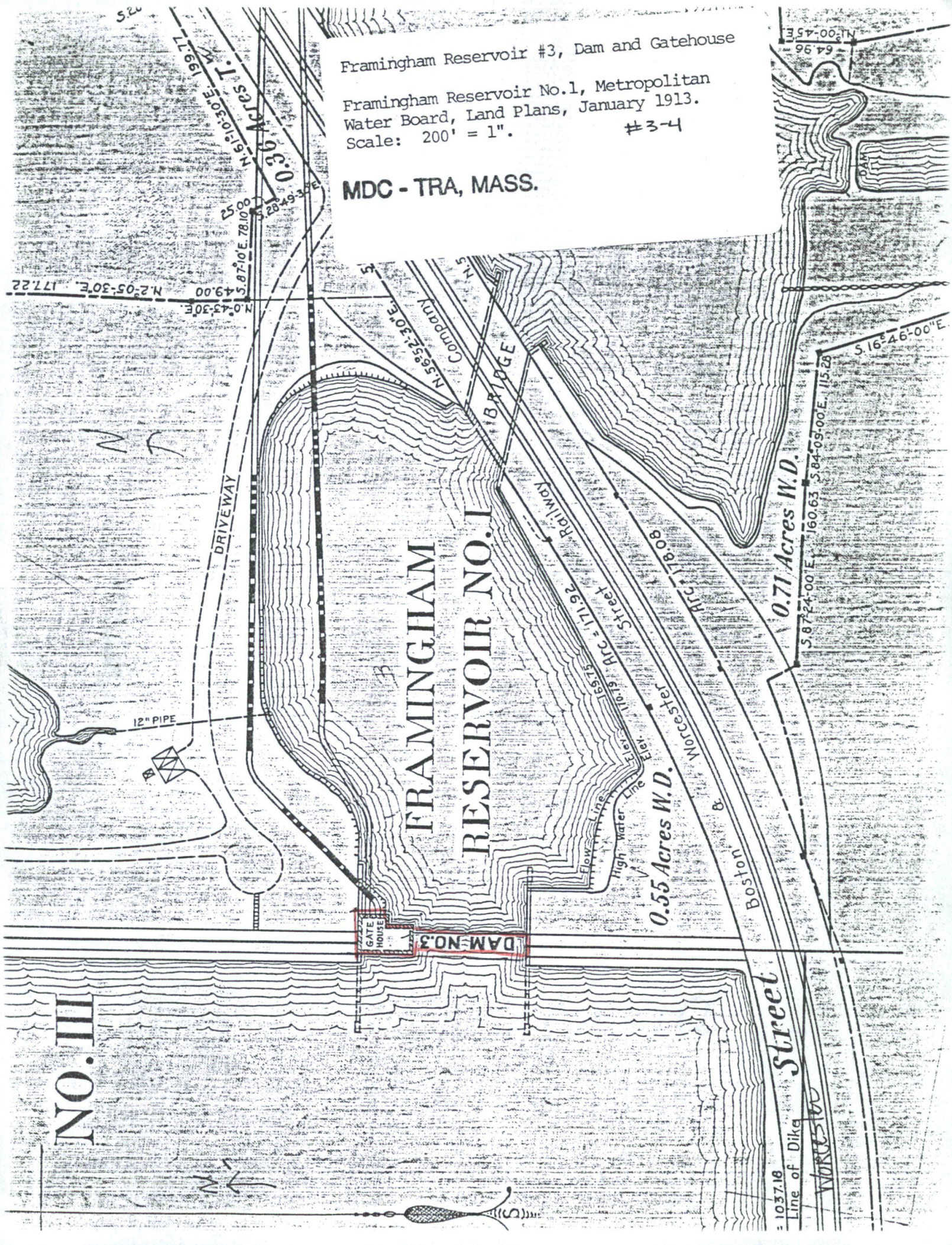

Please refer to the map in the
Multiple Property Cover Sheet
for this property

Multiple Property Cover Sheet Reference Number: 64500254