

AUG 21 1989

1565

NATIONAL REGISTER

AREA	FORM NO.
	66,

MASSACHUSETTS HISTORICAL COMMISSION
80 BOYLSTON STREET
BOSTON, MA 02116

WALTHAM, MA MRA

Town Waltham, MA

Address 29-31 Heard Street

Historic Name Richard Holbrook Houses

Use: Present Residential

Original Residential

DESCRIPTION

Date 1844

Source Deeds

Style Greek Revival

Architect Richard Holbrook, house-wright

Exterior Wall Fabric Clapboard

Outbuildings garage-NC

Major Alterations (with dates) Connecting link built 1900-1911

Condition Good

Moved no Date n/a

Acreage 0.2 A. 7, 018 sq. ft. 61-14-5

Setting On very narrow street with closely-spaced mid-19th c. houses

Recorded by Nancy S. Seasholes

Organization Waltham Historical Comm.

Date August 1986

revised C. Jenkins 2/88

Photo (3"x3" or 3"x5", black and white) Indicate address of property on back of photo. Staple to left side of form.

Sketch Map: Draw map showing property's location in relation to nearest cross streets and/or geographical features. Indicate all buildings between inventoried property and nearest intersection(s). Indicate north

UTM REFERENCE 19/316320/4693750

USGS QUADRANGLE LEXINGTON

SCALE 1:25,000

NATIONAL REGISTER CRITERIA STATEMENT (if applicable)

The Richard Holbrook Double House is a well detailed and unusual Greek Revival style house form in the city of Waltham. It is one of a very few 1½ story cottages in the style, and the only double house. Both sections are clapboard clad and detailed with pedimented gables, entablatures, cornerboards, and entries with sidelights, entablatures and lintel shelves. Architectural significance is enhanced by the fact that the housewright is known. The house also illustrates the development of the Main Street area in the mid-19th century as a home for workers and small businessmen. It possesses integrity of location, design, materials, setting, workmanship, feeling and association, and meets criteria A and C of the National Register of Historic Places.

ARCHITECTURAL SIGNIFICANCE Describe important architectural features and evaluate in terms of other buildings within the community.

Set on a very narrow residential street with closely-spaced mid-nineteenth century houses, these two one-and-a-half story Greek Revival cottages are some of the very few of this type in the city and the only surviving example of houses built as a pair. The two apparently were identical and retain many of their original finishes; both have pedimented attics, a deep cornice, a full entablature, cornerboards, windows in the gables, and center entrances on the side. The entrance at 31 Heard has been altered but that at 29 Heard retains the original corniced entablature and sidelights. Both retain original clapboard siding and 6/6 window sash.

HISTORICAL SIGNIFICANCE Explain the role owners played in local or state history and how the building relates to the development of the community.

These houses were built about 1844 by Richard Holbrook, a housewright. In 1843 Holbrook had acquired both lots from George Miller, the developer of this part of Central Street. At the time Central Street was called Miller Street and Heard Street, which was laid out when Miller sold the lots to Holbrook, was referred to as a passageway. It was later variously known as Church Avenue (because it was the way to the Trinitarian Congregational Church at the corner of Main and Heard streets), Hurd Street (after a property owner in the area), and finally Heard Street.

Holbrook apparently built the house at 31 Heard in 1844 and sold it that year to Rowland Wetherbee, another carpenter. Rowland in turn sold it to Josiah Wetherbee, one of the large property owners of the time. After several more transactions it was acquired in 1856 by a Stephen Connelly, who owned it for 30 years before selling it in 1886 to Patrick Welch, a farm hand on the Lyman estate.

The history of the house at 29 Heard is somewhat different. Holbrook probably built it in 1844, too, although he did not sell it until 1847. It was then acquired in turn by some of the large property owners of the time, was purchased in 1849 by Daniel Stratton, a mechanic, and in 1854 by Philip McDonough, a laborer. In 1882 it was bought by Alexander McCollough, a grocer, and finally, in 1892, by Patrick Welch, the owner of the house at 31 Heard. The two houses were probably joined by Welch, who continued to own them well into the twentieth century.

BIBLIOGRAPHY and/or REFERENCES

Middlesex Deeds - (31 Heard) 430:415; 456:16; 538:431; 657:409; 683:322; 755:209;
1736:527
(29 Heard) - 513:207; 523:62; 525:324; 525:194; 677:536; 1603:241;
2098:341
Maps and atlases - 1854, 1875, 1886, 1900, 1911, 1915, 1923
Directories - 1899, 1923

United States Department of the Interior
National Park Service

AUG 21 1989

National Register of Historic Places
Continuation Sheet

Section number _____ Page _____

Multiple Resource Area
Thematic Group

Name Waltham MRA
State Middlesex County, MASSACHUSETTS

Nomination/Type of Review	Date/Signature
41. Hall, Henry C., House <i>Entered in the National Register</i>	f Keeper <u>Melrose Byers 9/28/89</u> Attest _____
42. Hammond, Ephraim, House <i>Substantive Review</i>	sn Keeper <u>Beth J. Savage 9/16/89</u> Attest _____
43. Hammond, Jonathan, House <i>Entered in the National Register</i>	f Keeper <u>Melrose Byers 9/28/89</u> Attest _____
44. Hardy, Nahum, House <i>Entered in the National Register</i>	v Keeper <u>Melrose Byers 9/28/89</u> Attest _____
45. Harrington Block <i>Entered in the National Register</i>	v Keeper <u>Melrose Byers 9/28/89</u> Attest _____
46. Harrington, Samuel, House <i>Entered in the National Register</i>	v Keeper <u>Melrose Byers 9/28/89</u> Attest _____
47. Hill, Rev. Thomas, House <i>Entered in the National Register</i>	v Keeper <u>Melrose Byers 9/28/89</u> Attest _____
48. Hobbs Brook Basin Gate House <i>Entered in the National Register</i>	f Keeper <u>Melrose Byers 9/28/89</u> Attest _____
49. Holbrook, Richard, Houses <i>Entered in the National Register</i>	f Keeper <u>Melrose Byers 9/28/89</u> Attest _____
50. Johnson, Edwin C., House <i>Entered in the National Register</i>	f Keeper <u>Melrose Byers 9/28/89</u> Attest _____

sn

UNITED STATES DEPARTMENT OF THE INTERIOR
NATIONAL PARK SERVICE

NATIONAL REGISTER OF HISTORIC PLACES
EVALUATION/RETURN SHEET

REQUESTED ACTION: NOMINATION

PROPERTY NAME: Holbrook, Richard, Houses

MULTIPLE NAME: Waltham MRA

STATE & COUNTY: MASSACHUSETTS, Middlesex

DATE RECEIVED: 8/21/89 DATE OF PENDING LIST: 9/05/89
DATE OF 16TH DAY: 9/21/89 DATE OF 45TH DAY: 10/05/89
DATE OF WEEKLY LIST:

REFERENCE NUMBER: 89001565

NOMINATOR: STATE

REASONS FOR REVIEW:

APPEAL: N DATA PROBLEM: N LANDSCAPE: N LESS THAN 50 YEARS: N
OTHER: N PDIL: N PERIOD: N PROGRAM UNAPPROVED: N
REQUEST: N SAMPLE: N SLR DRAFT: N NATIONAL: N

COMMENT WAIVER: N

ACCEPT RETURN REJECT 9/28/89 DATE Entered in the
National Register

ABSTRACT/SUMMARY COMMENTS:

RECOM./CRITERIA _____
REVIEWER _____
DISCIPLINE _____
DATE _____

DOCUMENTATION see attached comments Y/N see attached SLR Y/N

CLASSIFICATION

count resource type

STATE/FEDERAL AGENCY CERTIFICATION

FUNCTION

historic current

DESCRIPTION

architectural classification
 materials
 descriptive text

SIGNIFICANCE

Period Areas of Significance--Check and justify below

Specific dates Builder/Architect
Statement of Significance (in one paragraph)

summary paragraph
 completeness
 clarity
 applicable criteria
 justification of areas checked
 relating significance to the resource
 context
 relationship of integrity to significance
 justification of exception
 other

BIBLIOGRAPHY

GEOGRAPHICAL DATA

acreage verbal boundary description
 UTMs boundary justification

ACCOMPANYING DOCUMENTATION/PRESENTATION

sketch maps USGS maps photographs presentation

OTHER COMMENTS

Questions concerning this nomination may be directed to

_____ Phone _____

Signed _____ Date _____



Holbrook HOUSES

29-31 Heard St

WALTHAM, MA MRA

66,



Holbrook Houses

29-31 Heard St.

WALTHAM, MA MRA

66,

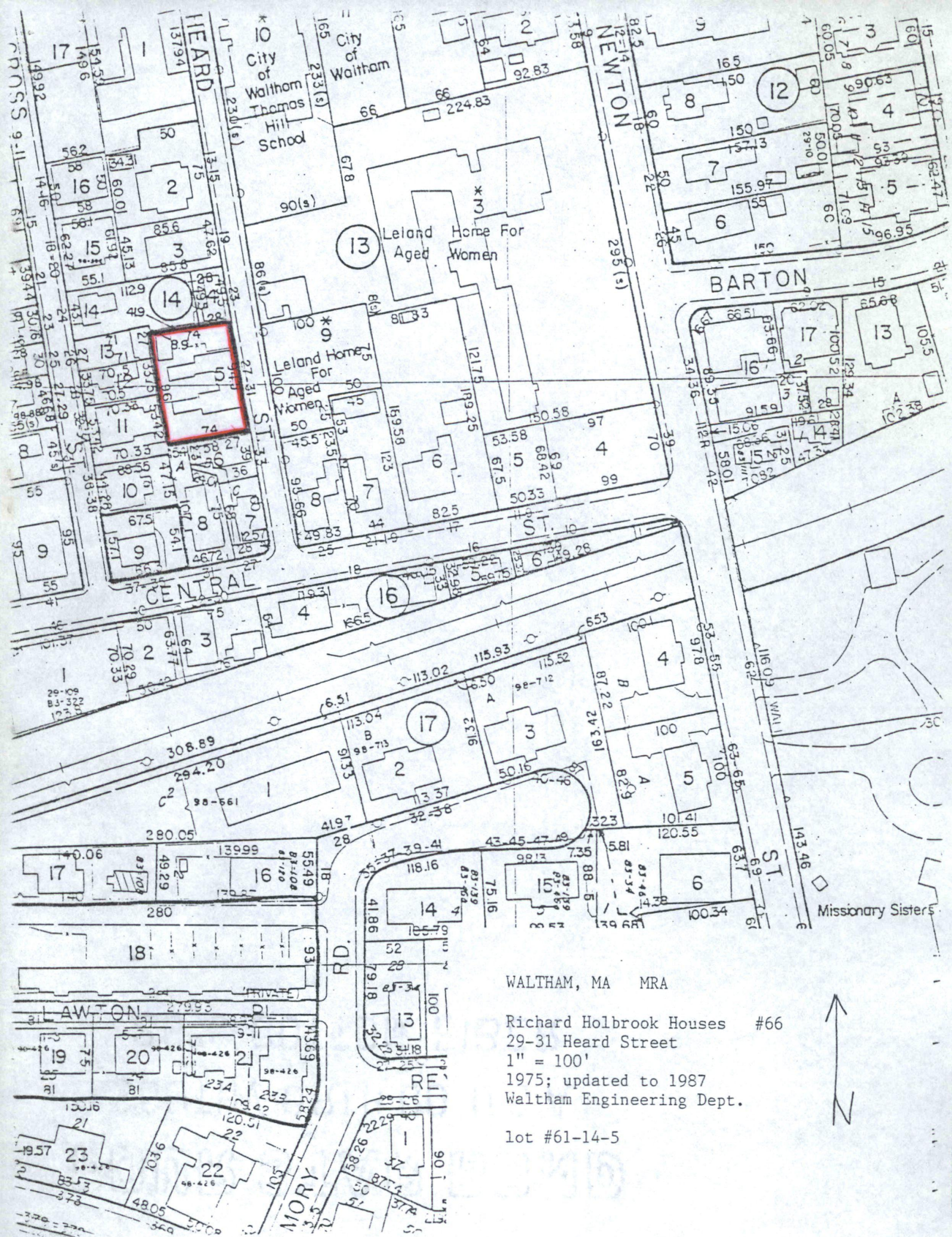

WALTHAM, MA MRA

Richard Holbrook Houses #66

29-31 Heard Street

1" = 100'

1975; updated to 1987

Waltham Engineering Dept.

lot #61-14-5

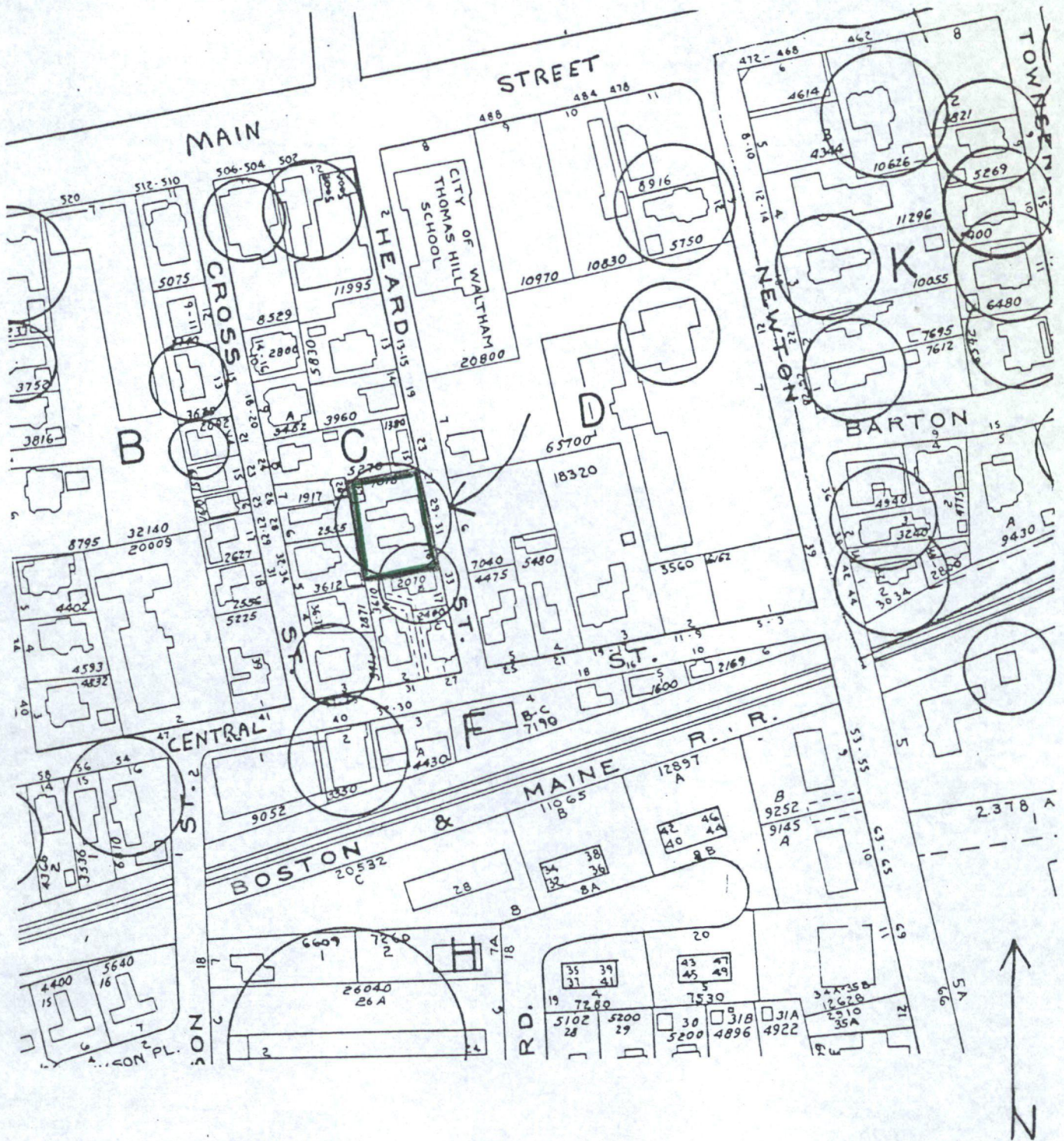

1970 Atlas, City of Waltham
 Compiled by the Waltham
 Engineering Division
 Scale: 1 inch = 140 feet

Waltham, Massachusetts MRA
 29-31 Heard Street
 Holbrook House
 13-C-16

Please refer to the map in the
Multiple Property Cover Sheet
for this property

Multiple Property Cover Sheet Reference Number: 64000301