

AUG 07 1989

1366

AREA

FORM NO.

MASSACHUSETTS HISTORICAL COMMISSION  
80 BOYLSTON STREET  
BOSTON, MA 02116

PH 77

Town Quincy, MA / MRAAddress 248 President's LaneHistoric Name Charles Marsh HouseUse: Present single family dwellingOriginal single family dwelling

## DESCRIPTION

Date ca. 1860sSource Map and directory researchStyle ItalianateArchitect unknownExterior Wall Fabric wood clapboardsOutbuildings two-car garage (1930s)--ncMajor Alterations (with dates) noneCondition GoodMoved no Date n/aAcreage less than one acre: 16, 620 sq. ftSetting The house is on a spacious lotat the edge of President's Hill one blockfrom a busy commercial intersection.Recorded by Fannin and Lehner/ J. JohnsonOrganization Quincy Historical CommissionDate June 14, 1986/ May 1987

Photo (3"x3" or 3"x5", black and white) Indicate address of property on back of photo. Staple to left side of form.

Sketch Map: Draw map showing property's location in relation to nearest cross streets and/or geographical features. Indicate all buildings between inventoried property and nearest intersection(s).  
Indicate north

SEE ATTACHED MAP

UTM REFERENCE 19/334,580 E/ 4,679,120 NUSGS QUADRANGLE Blue Hills, MASCALE 1: 25,000

**NATIONAL REGISTER CRITERIA STATEMENT (if applicable)**

This finely-detailed, Italianate-style house is one of two well-preserved examples of this type in Quincy. The Charles Marsh House retains integrity of design, location, materials, feeling and association. The house fulfills Criterion C of the National Register of Historic Places on the local level.

**ARCHITECTURAL SIGNIFICANCE** Describe important architectural features and evaluate in terms of other buildings within the community.

SEE INVENTORY FORM CONTINUATION SHEET

**HISTORICAL SIGNIFICANCE** Explain the role owners played in local or state history and how the building relates to the development of the community.

SEE INVENTORY FORM CONTINUATION SHEET

**BIBLIOGRAPHY and/or REFERENCES**

"A Brief Historical Sketch of the City of Quincy, Mass." issued by the President's Hill, President's Hill Annex, and Cranch Hill Real Estate Trusts." circa. 1903 Assessor's Records.  
Robinson's Atlas of the Norfolk County, Mass., 1888.  
Atlases of the City of Quincy, 1897; 1907; 1923.  
City Directories.

INVENTORY FORM CONTINUATION SHEET

MASSACHUSETTS HISTORICAL COMMISSION  
Office of the Secretary, Boston

Community: <b>QUINCY, MA</b>	Form No: <b>PH-77</b>
Property Name: <i>Charles Marsh Hse.</i>	

Indicate each item on inventory form which is being continued below.

**HISTORICAL SIGNIFICANCE -- 248 PRESIDENT'S LANE  
CHARLES MARSH HOUSE**

This house is located just outside the former Charles Francis Adams estate and thus precedes the late 19th century subdivision of President's Hill. One of the older houses on President's Lane, number 248 has been owned by a succession of prominent Quincy citizens. The house was built for Charles Marsh, a prosperous leather dealer who worked on Purchase Street in Boston. Marsh was also the president of the Granite Trust Company (established 1836) in 1863 and president of the Quincy Savings Bank (established 1845) in 1879. The house was acquired by A.D. Chase in the 1880s who passed it down to his son Richard D. Chase in 1887. Richard Chase was founder of his own insurance firm, secretary and treasurer of the Quincy Co-operative Bank and active in the Bethany Congregational Church. By 1907, number 248 Marsh was owned by Luther S. Anderson. Anderson, who owned several pieces of property in the President's Lane area, was the manager and treasurer of the Granite Railway Company. From 1922 to 1935 the house was occupied by the Morrissey family owners of Morrissey Brothers Taxi.

Staple to Inventory form at bottom

INVENTORY FORM CONTINUATION SHEET

MASSACHUSETTS HISTORICAL COMMISSION  
Office of the Secretary, Boston

Community: Quincy, MA	Form No: PH-77
Property Name: <i>Charles Marsh Hse.</i>	

Indicate each item on inventory form which is being continued below.

**ARCHITECTURAL SIGNIFICANCE -- 248 PRESIDENT'S LANE  
CHARLES MARSH HOUSE**

This house at 248 President's Lane is one of a few two-and-a-half story sidehall plans in Quincy, and one of two well-preserved examples included in this nomination (the other example is at 183 Pine Street, #566). Gable-end to the street, the main facade is composed of a gable with return eaves supported by double brackets, signature of the style. Within the gable is an arched window. The entrance porch has chamfered posts, small scrolled brackets supporting the roof and a dentiled frieze. The fenestration is regular composed of double windows with two narrow lights. On the side elevation is an angular one-story bay with a bracketed roof. The house is set on a typical granite foundation. A two-car garage at the rear of the lot is noncontributing.

Staple to Inventory form at bottom

United States Department of the Interior  
National Park Service

AUG 7 1989

National Register of Historic Places  
Continuation Sheet

Section number \_\_\_\_\_ Page \_\_\_\_\_

Multiple Resource Area  
Thematic Group

Name Quincy MRA  
State Norfolk County, MASSACHUSETTS

Nomination/Type of Review	Date/Signature
41. House at 32 Bayview Avenue <i>Entered in the National Register</i>	Keeper <u><i>Melrose Byers</i></u> 9/20/89 Attest _____
42. House at 92 Willard Street <i>Entered in the National Register</i>	Keeper <u><i>Melrose Byers</i></u> 9/20/89 Attest _____
43. House at 94 Grandview Avenue <i>Entered in the National Register</i>	Keeper <u><i>Melrose Byers</i></u> 9/20/89 Attest _____
44. Jewell, David L., House <i>Entered in the National Register</i>	Keeper <u><i>Melrose Byers</i></u> 9/20/89 Attest _____
45. Lennon, Edward J., House <i>Entered in the National Register</i>	Keeper <u><i>Melrose Byers</i></u> 9/20/89 Attest _____
46. Marsh, Charles, House <i>Entered in the National Register</i>	Keeper <u><i>Melrose Byers</i></u> 9/20/89 Attest _____
47. Marsh, Edwin W., House <i>Entered in the National Register</i>	Keeper <u><i>Melrose Byers</i></u> 9/20/89 Attest _____
48. McIntire, Herman, House <i>Entered in the National Register</i>	Keeper <u><i>Melrose Byers</i></u> 9/20/89 Attest _____
49. Miller, Edward, House Substantive Review	Keeper <u><i>Barbara Savage</i></u> 3/8/90 Attest _____
50. Munroe Building <i>Entered in the National Register</i>	Keeper <u><i>Melrose Byers</i></u> 9/20/89 Attest _____

UNITED STATES DEPARTMENT OF THE INTERIOR  
NATIONAL PARK SERVICE

NATIONAL REGISTER OF HISTORIC PLACES  
EVALUATION/RETURN SHEET

REQUESTED ACTION: NOMINATION

PROPERTY NAME: Marsh, Charles, House

MULTIPLE NAME: Quincy MRA

STATE & COUNTY: MASSACHUSETTS, Norfolk

DATE RECEIVED: 8/07/89      DATE OF PENDING LIST: 8/22/89  
DATE OF 16TH DAY: 9/07/89      DATE OF 45TH DAY: 9/21/89  
DATE OF WEEKLY LIST:

REFERENCE NUMBER: 89001366

NOMINATOR: STATE

REASONS FOR REVIEW:

APPEAL: N    DATA PROBLEM: N    LANDSCAPE: N    LESS THAN 50 YEARS: N  
OTHER: N    PDIL: N    PERIOD: N    PROGRAM UNAPPROVED: N  
REQUEST: N    SAMPLE: N    SLR DRAFT: N    NATIONAL: N

COMMENT WAIVER: N

ACCEPT     RETURN     REJECT    9/20/89 DATE

Entered in the  
National Register

ABSTRACT/SUMMARY COMMENTS:

RECOM./CRITERIA \_\_\_\_\_  
REVIEWER \_\_\_\_\_  
DISCIPLINE \_\_\_\_\_  
DATE \_\_\_\_\_

DOCUMENTATION see attached comments Y/N see attached SLR Y/N

---

CLASSIFICATION

count       resource type

---

STATE/FEDERAL AGENCY CERTIFICATION

---

FUNCTION

historic       current

---

DESCRIPTION

architectural classification  
 materials  
 descriptive text

---

SIGNIFICANCE

Period      Areas of Significance--Check and justify below

Specific dates      Builder/Architect  
Statement of Significance (in one paragraph)

summary paragraph  
 completeness  
 clarity  
 applicable criteria  
 justification of areas checked  
 relating significance to the resource  
 context  
 relationship of integrity to significance  
 justification of exception  
 other

---

BIBLIOGRAPHY

---

GEOGRAPHICAL DATA

acreage       verbal boundary description  
 UTM's       boundary justification

---

ACCOMPANYING DOCUMENTATION/PRESENTATION

sketch maps       USGS maps       photographs       presentation

---

OTHER COMMENTS

Questions concerning this nomination may be directed to

\_\_\_\_\_ Phone \_\_\_\_\_

Signed \_\_\_\_\_ Date \_\_\_\_\_



248 President's Lane Lane  
Charles Marsh House

by: Julie Johnson

at: Planning Dept - Quincy

date: July 1987

view: North

Pict# PH - 777

Quincy, <sup>MA</sup> Mass.

JUL 1987

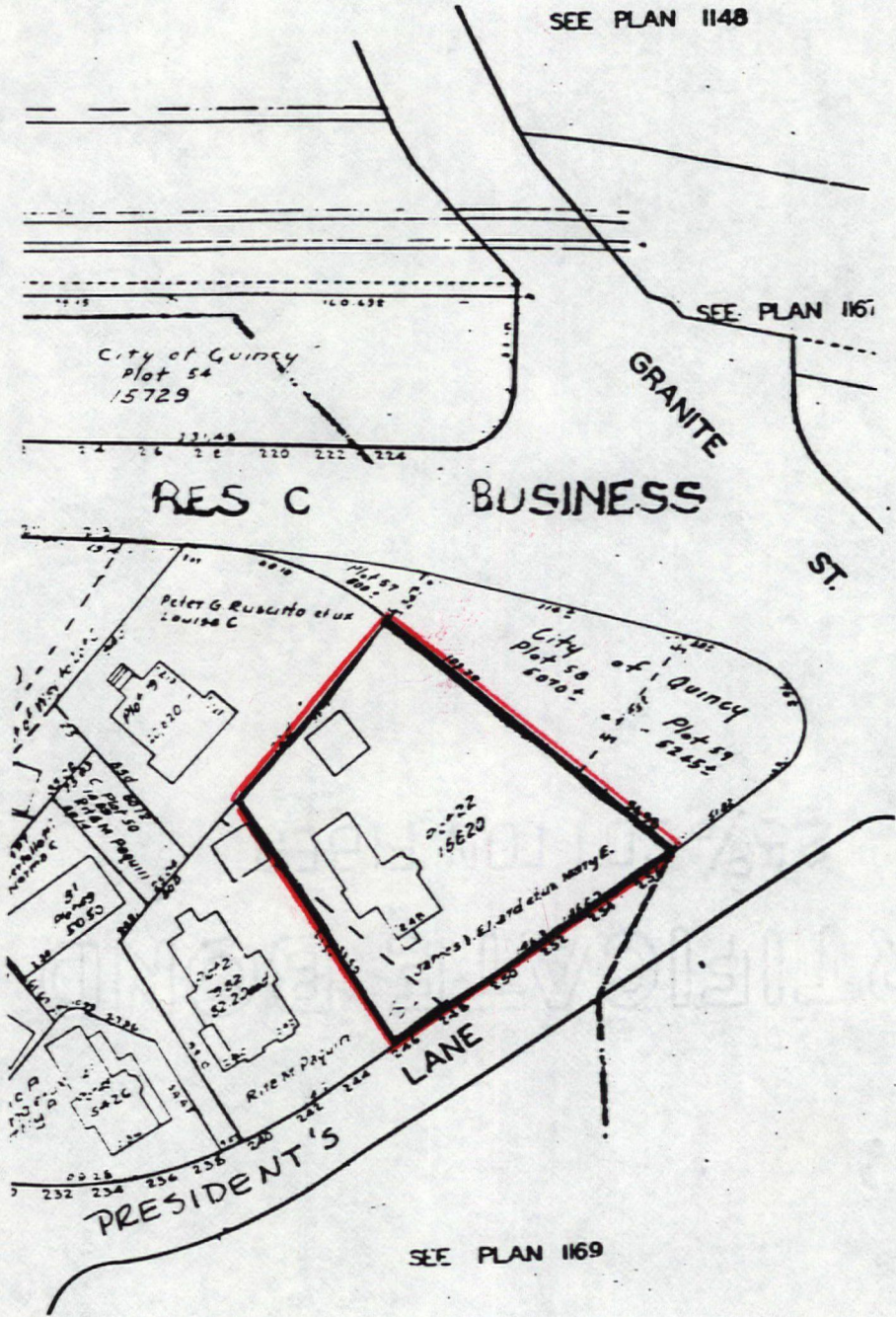
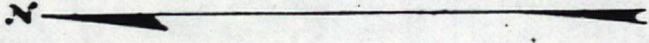

Address 248 President's Lane

QUINCY, MASSACHUSETTS / MRA  
Assessors Map # 1164

1979

Scale: 1 inch equals 80 feet

Please refer to the map in the  
Multiple Property Cover Sheet  
for this property

Multiple Property Cover Sheet Reference Number: 64000289