

MAY 23 1989

681

FORM B - BUILDING

MASSACHUSETTS HISTORICAL COMMISSION  
80 BOYLSTON STREET  
BOSTON, MA 02116

AREA	FORM NO.
A	70

Photo (3"x3" or 3"x5", black and white) Indicate address of property on back of photo. Staple to left side of form.

Sketch Map: Draw map showing property's location in relation to nearest cross streets and/or geographical features. Indicate all buildings between inventoried property and nearest intersection(s).  
Indicate north

Town Wakefield

Address 23 Lawrence Street

Historic Name NA

Use: Present dwelling

Original dwelling

DESCRIPTION

Date 1896-1899

Source Street list for Poll taxes

Visual analysis and 1906 map

Style Colonial Revival

Architect NA

Exterior Wall Fabric clapboard/shingle

Outbuildings Garage & Barn

Contributing (c. 1899)

Major Alterations (with dates) \_\_\_\_\_

None

Condition Fair

Moved NA Date NA

Acreage Less than one acre

Setting on corner, in area of suburban houses.

UTM REFERENCE 19/32990 /4708380

USGS QUADRANGLE Reading, MA

SCALE 1:25,000

Recorded by architectural Preservation Associates

Organization Wakefield Historical Commission

Date March 1985

**NATIONAL REGISTER CRITERIA STATEMENT (if applicable)**

A well preserved example of high-style Colonial Revival domestic architecture, This house represents the fashionable middle class neighborhood that was Lawrence Street in the late 19th century. The building retains integrity of location, setting, design, materials, workmanship, feeling and association, and meets criterion C of the NRHP on the local level.

**ARCHITECTURAL SIGNIFICANCE Describe important architectural features and evaluate in terms of other buildings within the community.**

This is one of the best examples of relatively high style Colonial Revival houses in this upper class neighborhood. The 2½ story rectangular, gable roofed massing is relieved by a generously curved, two story, round, corner bay stack, and a front porch with paired colonettes. The surface is enlivened by a Palladian window in the gable field, a carved swag applied as a window spandrel, and an exterior brick chimney.

The house appears to be replacement for an earlier one built on this lot.

**HISTORICAL SIGNIFICANCE Explain the role owners played in local or state history and how the building relates to the development of the community.**

John Vinton is shown as owning the house at 28 Cordis Street on the map of 1857, and as owning a house here, probably now demolished or entirely altered. Vinton kept a tavern on Main at Albion Street, in the recycled first parsonage, built c. 1681, and now demolished.

Lawrence Street was laid out by the Emerson family in the 1850s. They were joined by S. O. Richardson, owner of the medicinal Sherry Wine and Bitters Co. in developing it in the 1870s. The Emersons owned houses on Main near Lawrence Street and Wave Ave. Their important shoe manufacturing business was founded in 1805 by Thomas Emerson (1785-1871), and continued by his sons and grandsons, who built houses south of his along Main Street. Their shoe shop was located between Wave and Lawrence Streets, but most of the actual shoemaking was done by local residents in their own small shops throughout town. In 1862 the firm was the first to introduce the McKay sewing machine. This changed the town's historic shoe manufacturing practice when production was centralized in a factory on Main Street and Yale Ave.

In the 1870s and 80s Lawrence Street became a fashionable middle class neighborhood, though small shoe factories continued to function here to the twentieth century.

**BIBLIOGRAPHY and/or REFERENCES**

maps 1874, J. W. Vinton  
1889, J. W. Vinton

Eaton, Chester, and Eaton, Warren. Proceedings of the 250th Anniversary of the Ancient Town of Redding, Reading, 1896.

United States Department of the Interior  
National Park Service

National Register of Historic Places  
Continuation Sheet

Section number \_\_\_\_\_ Page \_\_\_\_\_

Multiple Resource Area  
Thematic Group

Name Wakefield MRA  
State Middlesex County, MASSACHUSETTS

Nomination/Type of Review

Date/Signature

41. House at 23 Avon Street

Entered in the  
National Register

Keeper Shelous Byers 7/6/89

Attest \_\_\_\_\_

42. House at 23 Lawrence Street

Entered in the  
National Register

Keeper Shelous Byers 7/6/89

Attest \_\_\_\_\_

43. House at 25 Avon Street

Entered in the  
National Register

Keeper Shelous Byers 7/6/89

Attest \_\_\_\_\_

44. House at 26 Francis Avenue

Entered in the  
National Register

Keeper Shelous Byers 7/6/89

Attest \_\_\_\_\_

45. House at 28 Cordis Street

Entered in the  
National Register

Keeper Shelous Byers 7/6/89

Attest \_\_\_\_\_

46. House at 28 Wiley Street

Entered in the  
National Register

Keeper Shelous Byers 7/6/89

Attest \_\_\_\_\_

47. House at 30 Sheffield Road

Entered in the  
National Register

Keeper Shelous Byers 7/6/89

Attest \_\_\_\_\_

48. House at 32 Morrison Road

Entered in the  
National Register

Keeper Shelous Byers 7/6/89

Attest \_\_\_\_\_

49. House at 38 Salem Street

Entered in the  
National Register

Keeper Shelous Byers 7/6/89

Attest \_\_\_\_\_

50. House at 380 Albion Street

Entered in the  
National Register

Keeper Shelous Byers 7/6/89

Attest \_\_\_\_\_

UNITED STATES DEPARTMENT OF THE INTERIOR  
NATIONAL PARK SERVICE

NATIONAL REGISTER OF HISTORIC PLACES  
EVALUATION/RETURN SHEET

REQUESTED ACTION: NOMINATION

PROPERTY House at 23 Lawrence Street  
NAME:

MULTIPLE Wakefield MRA  
NAME:

STATE & COUNTY: MASSACHUSETTS, Middlesex

DATE RECEIVED: 5/23/89 DATE OF PENDING LIST: 6/06/89  
DATE OF 16TH DAY: 6/22/89 DATE OF 45TH DAY: 7/07/89  
DATE OF WEEKLY LIST:

REFERENCE NUMBER: 89000681

NOMINATOR: STATE

REASONS FOR REVIEW:

APPEAL: N DATA PROBLEM: N LANDSCAPE: N LESS THAN 50 YEARS: N  
OTHER: N PDIL: N PERIOD: N PROGRAM UNAPPROVED: N  
REQUEST: N SAMPLE: N SLR DRAFT: N NATIONAL: N

COMMENT WAIVER: N

ACCEPT  RETURN  REJECT 7/6/89 DATE

Entered in the  
National Register

ABSTRACT/SUMMARY COMMENTS:

RECOM./CRITERIA \_\_\_\_\_  
REVIEWER \_\_\_\_\_  
DISCIPLINE \_\_\_\_\_  
DATE \_\_\_\_\_

DOCUMENTATION see attached comments Y/N see attached SLR Y/N

---

CLASSIFICATION

count       resource type

---

STATE/FEDERAL AGENCY CERTIFICATION

---

FUNCTION

historic       current

---

DESCRIPTION

architectural classification  
 materials  
 descriptive text

---

SIGNIFICANCE

Period              Areas of Significance--Check and justify below

Specific dates                      Builder/Architect  
Statement of Significance (in one paragraph)

summary paragraph  
 completeness  
 clarity  
 applicable criteria  
 justification of areas checked  
 relating significance to the resource  
 context  
 relationship of integrity to significance  
 justification of exception  
 other

---

BIBLIOGRAPHY

---

GEOGRAPHICAL DATA

acreage               verbal boundary description  
 UTM's               boundary justification

---

ACCOMPANYING DOCUMENTATION/PRESENTATION

sketch maps       USGS maps       photographs       presentation

---

OTHER COMMENTS

Questions concerning this nomination may be directed to

\_\_\_\_\_ Phone \_\_\_\_\_

Signed \_\_\_\_\_ Date \_\_\_\_\_



A-70

23 Lawrence St.

# 23 LAWRENCE ST

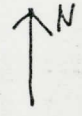

SCALE: 1" = 80'

WAWAPOWITT

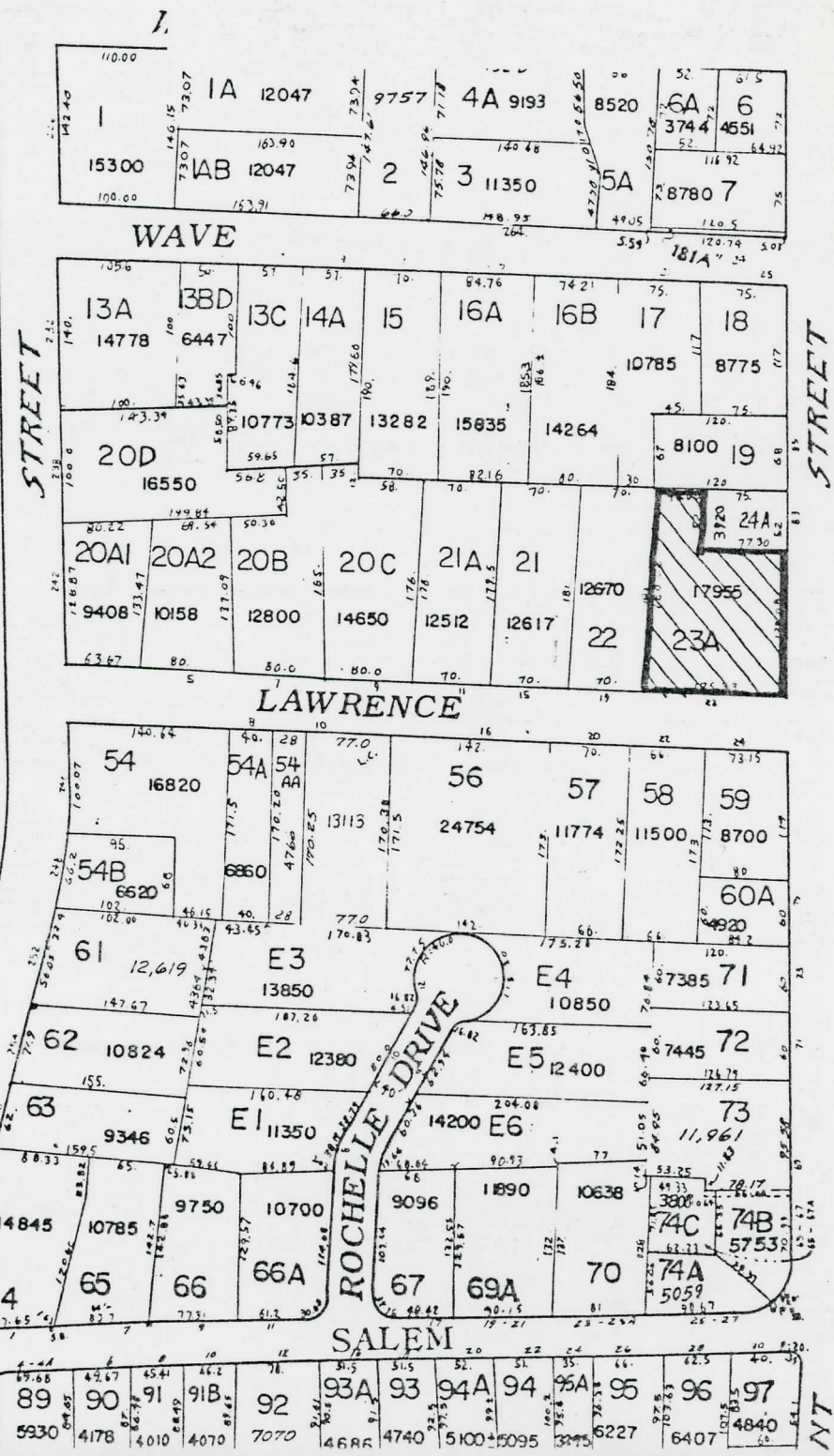

53  
PARK  
675 Acres

MAIN

ROCHELLE DRIVE

STREET

ST

SALEM

Please refer to the map in the  
Multiple Property Cover Sheet  
for this property

Multiple Property Cover Sheet Reference Number: 64000300