

MAY 22 1989

637

AREA

FORM NO.

E

301

MASSACHUSETTS HISTORICAL COMMISSION
80 BOYLSTON STREET
BOSTON, MA 02116

(Winchester, Mass. M.R.A.)

Town WINCHESTER

Address 233 Main Street

Historic Name Marshall Symmes Tenant
House

Use: Present dwelling

Original dwelling

Photo (3"x3" or 3"x5", black and white) Indicate address of property on back of photo. Staple to left side of form.

DESCRIPTION

Date 1870s

Source Stylistic analysis, maps

Style Italianate (Bracketed)

Architect unknown

Exterior Wall Fabric clapboard

Outbuildings none

Major Alterations (with dates) _____

Condition Excellent

Moved no Date _____

Acreage .63 acre 06-035'

Setting Suburban residential along major early road to Woburn.

Recorded by Carol Ely

Organization Winchester Historical Comm

Date 12/78; revised by H.White 10/87

Sketch Map: Draw map showing property's location in relation to nearest cross streets and/or geographical features

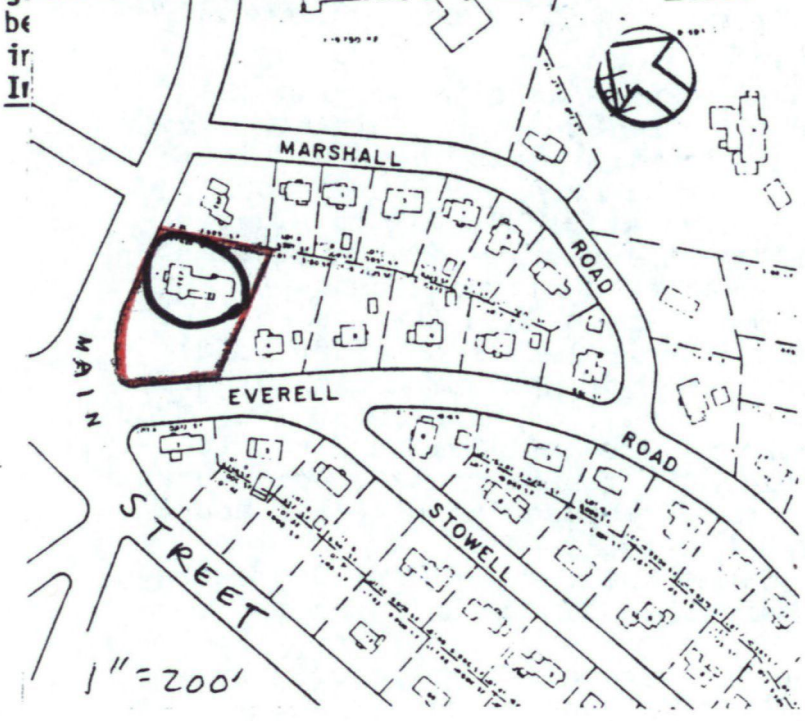

UTM REFERENCE 19, 324300, 4700970

USGS QUADRANGLE LEXINGTON, MASS.

SCALE 1:25,000

NATIONAL REGISTER CRITERIA STATEMENT (if applicable)

The Marshall Symmes Tenant House is notable for its associations with the Symmes family, whose members were among Winchester's first settlers, and have figured prominently in local affairs throughout Winchester's history. Therefore the Symmes Tenant House meets Criteria A of the National Register of Historic Places.

ARCHITECTURAL SIGNIFICANCE Describe important architectural features and evaluate in terms of other buildings within the community.

The Symmes Tenant House built during the 1870s and represents a conservative Italianate design. It is a three-bay, gable-roofed structure, with the ridge parallel to the street. The roof is clad in gray slate, and the eaves broadly overhang at the cornice. Paired cornice brackets have been lost, but tell-tale outlines indicate their former location.

The center entrance is set within a flat-roofed open porch with square columns. The double entrance doors are set within a pavilion of shallow projection. Windows have a two-over-two sash configuration, with bracketed lintels and sills. A full-height polygonal bay stands on the south elevation. A border of granite curbing encircles the property.

A two-and-one-half story gabled ell stands to the rear. A two bay barn is attached to the ell.

HISTORICAL SIGNIFICANCE Explain the role owners played in local or state history and how the building relates to the development of the community.

The Symmes Tenant House is one of four houses associated with the Symmes family in the vicinity of "Symmes Corner" along Main Street. Three of the four houses are proposed for the National Register of Historic Places, including this house; the others are the Marshall Symmes House (c.1817, #300) and the Deacon John Symmes House (c.1807, #298). Just before 1650 the Reverend Zachariah Symmes of the Charlestown Church, received a land grant of approximately 300 acres centered around present-day Symmes Corner. Although Reverend Symmes remained in Charlestown, his sons moved to Winchester, and began to farm their land soon after 1650.

Marshall Symmes (1789-1889) was a grandson of Rev. Zachariah Symmes, and worked as a blacksmith in a shop at the corner of Main and Bacon Streets. His own residence is the previously mentioned Marshall Symmes House (c.1817, #300) at 230 Main Street, directly opposite the tenant house bearing his name. Marshall's brother, Deacon John Symmes resided in the other house (c.1807, #298) bearing his name, at 212-214 Main Street.

Three nearby streets are named for Symmes family members: Symmes Road, Marshall Road, and Stowell Road (after Marshall Symmes wife, Relief (Lephe) Stowell).

The Marshall Symmes Tenant House, built several years before the owner's death at age 100, was erected on the grounds of his estate, and was used as a rental property.

BIBLIOGRAPHY and/or REFERENCES

Assessor's Records.

INVENTORY FORM CONTINUATION SHEET

MASSACHUSETTS HISTORICAL COMMISSION
Office of the Secretary, Boston

Community: Winchester, Mass.	Form No: 301
Property Name: Marshall Symmes	

Indicate each item on inventory form which is being continued below. Tenant House

HISTORICAL SIGNIFICANCE continued:

Chain of ownership:

1. Marshall Symmes 1881-1912
2. Anna E. Symmes 1913-1934
3. Russell Symmes 1942-1961
4. Winifred G. Knopf 1962-1987

MAY 22 1989

United States Department of the Interior
National Park Service

National Register of Historic Places
Continuation Sheet

Section number _____ Page _____

Multiple Resource Area
Thematic Group

Name Winchester MRA
State Middlesex County, MASSACHUSETTS

Nomination/Type of Review	Date/Signature
51. Symmes, Deacon John, House Entered in the National Register	Keeper <u>Melrose Byers</u> 7/5/89 Attest _____
52. Symmes, Marshall, House Entered in the National Register	Keeper <u>Melrose Byers</u> 7/5/89 Attest _____
53. Symmes, Marshall, Tenant House Entered in the National Register	Keeper <u>Melrose Byers</u> 7/5/89 Attest _____
54. Thompson, Abijah, House Entered in the National Register	Keeper <u>Melrose Byers</u> 7/5/89 Attest _____
55. Trowbridge--Badger House Entered in the National Register	Keeper <u>Melrose Byers</u> 7/5/89 Attest _____
56. Vinton, Alfred, House Entered in the National Register	Keeper <u>Melrose Byers</u> 7/5/89 Attest _____
57. Wedgemere (H.D.) Entered in the National Register	Keeper <u>Melrose Byers</u> 7/5/89 Attest _____
58. White, S.B., House Entered in the National Register	Keeper <u>Melrose Byers</u> 7/5/89 Attest _____
59. Wildwood Cemetery Substantive Review	Keeper <u>Boyd Savage</u> 7-5-89 Attest _____
60. Wyman, George, House Entered in the National Register	Keeper <u>Melrose Byers</u> 7/5/89 Attest _____

UNITED STATES DEPARTMENT OF THE INTERIOR
NATIONAL PARK SERVICE

NATIONAL REGISTER OF HISTORIC PLACES
EVALUATION/RETURN SHEET

REQUESTED ACTION: NOMINATION

PROPERTY NAME: Symmes, Marshall, Tenant House

MULTIPLE NAME: Winchester MRA

STATE & COUNTY: MASSACHUSETTS, Middlesex

DATE RECEIVED: 5/22/89 DATE OF PENDING LIST: 6/06/89
DATE OF 16TH DAY: 6/22/89 DATE OF 45TH DAY: 7/06/89
DATE OF WEEKLY LIST:

REFERENCE NUMBER: 89000637

NOMINATOR: STATE

REASONS FOR REVIEW:

APPEAL: N DATA PROBLEM: N LANDSCAPE: N LESS THAN 50 YEARS: N
OTHER: N PDIL: N PERIOD: N PROGRAM UNAPPROVED: N
REQUEST: N SAMPLE: N SLR DRAFT: N NATIONAL: N

COMMENT WAIVER: N

ACCEPT RETURN REJECT 7/5/89 DATE

Entered in the
National Register

ABSTRACT/SUMMARY COMMENTS:

RECOM./CRITERIA _____
REVIEWER _____
DISCIPLINE _____
DATE _____

DOCUMENTATION see attached comments Y/N see attached SLR Y/N

CLASSIFICATION

count resource type

STATE/FEDERAL AGENCY CERTIFICATION

FUNCTION

historic current

DESCRIPTION

architectural classification
 materials
 descriptive text

SIGNIFICANCE

Period Areas of Significance--Check and justify below

Specific dates Builder/Architect
Statement of Significance (in one paragraph)

summary paragraph
 completeness
 clarity
 applicable criteria
 justification of areas checked
 relating significance to the resource
 context
 relationship of integrity to significance
 justification of exception
 other

BIBLIOGRAPHY

GEOGRAPHICAL DATA

acreage verbal boundary description
 UTMS boundary justification

ACCOMPANYING DOCUMENTATION/PRESENTATION

sketch maps USGS maps photographs presentation

OTHER COMMENTS

Questions concerning this nomination may be directed to

_____ Phone _____

Signed _____

Date _____



^{Marshel}
Symmes, Tenant House
233 Main St. 1/88
Winchester, Ma. MRA

MHC Inv. #301

Area E

Please refer to the map in the
Multiple Property Cover Sheet
for this property

Multiple Property Cover Sheet Reference Number: 64000303