

MAY 22 1989

610

AREA

FORM NO.

38

MASSACHUSETTS HISTORICAL COMMISSION
80 BOYLSTON STREET
BOSTON, MA 02116

(Winchester, Mass. M.R.A.)

Town WINCHESTER

Address 287 Cambridge Street

Historic Name Edmund Parker Jr. House

Photo (3"x3" or 3"x5", black and white) Indicate address of property on back of photo. Staple to left side of form.

Use: Present dwelling

Original dwelling

DESCRIPTION

Date circa 1826

Source deed research

Style transitional Federal-Greek Revival

Architect unknown

Exterior Wall Fabric shingle

Outbuildings garage/barn / NC

Major Alterations (with dates) exterior walls clad with wood shingles; window sash altered to 2/2-dates unknown

Condition Good

Moved no Date 0019-02

Acreage .33 acre

Setting Suburban fringe along early road to Woburn from Cambridge

Recorded by Carol Ely

Organization Winchester Historical Comm

Date 9/78; revised by H. White 10/87

Sketch in re geogr between inter Indi

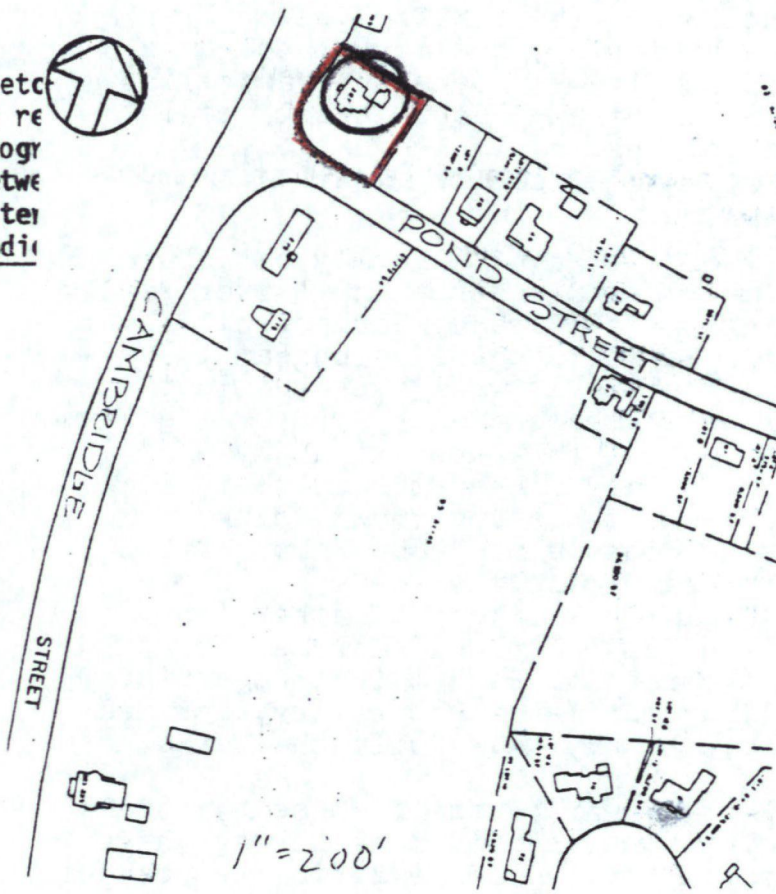

UTM REFERENCE 19, 3 22400, 47 02470

USGS QUADRANGLE LEXINGTON, MASS.

SCALE 1:25,000

NATIONAL REGISTER CRITERIA STATEMENT (if applicable)

The Edmund Parker House is an important example of the Late Federal style in Winchester and is associated with the Parker family, which owned land in the Pond Street/Cambridge Street vicinity since at least 1798. The Edmund Parker House therefore meets Criteria A and C of the National Register of Historic Places.

ARCHITECTURAL SIGNIFICANCE Describe important architectural features and evaluate in terms of other buildings within the community.

The Parker House (c.1826) reflects the gradual transition from the Federal to the Greek Revival style in American domestic architecture. Winchester has several examples of this type, including the Robert Bacon House (c.1830, #343) and the Charles Russell House (1841, #519).

The Parker house, located in the upper Cambridge Street neighborhood, belonged to a family that once had extensive landholdings in the vicinity. Mary Parker was married to Dana Fay, a local builder, who may have been responsible for the construction of the Parker House.

The Parker House is a two and one-half story dwelling based on a rectangular plan, with the characteristic five-bay facade organization of a Federal period farmhouse. The center entrance door is set within a one-story Doric portico with fluted columns.

HISTORICAL SIGNIFICANCE Explain the role owners played in local or state history and how the building relates to the development of the community.

Edmund Parker, Sr. was the first of the Parker family of Woburn to settle in the vicinity of Pond & Cambridge Streets. The Parker family would accumulate extensive land holdings in the area, which eventually became part of the town of Winchester. Parker's house, stood at the southeast corner of Pond & Cambridge Streets. It was described in the 1798 tax survey of Massachusetts real estate conducted by the U.S. government, as "almost new." That house was one of only approximately 35 dwellings within the boundaries of present-day Winchester at that time. The Pond St.-Cambridge St. neighborhood was to become known as the "Parker neighborhood" as the family's holdings expanded. Edmund Sr.'s house was a local landmark until it burned during the 1890s.

Edmund's two sons, Thaddeus (a wheelwright like his father) and Edmund Jr. divided the acreage. By then Edmund Jr. had already built his own house on land at the northeast corner of Pond & Cambridge Sts. which he had previously purchased. Edmund Sr.'s daughter Mary, married a neighbor, and local builder Dana Fay, who may have built the Parker house.

The farm was owned from 1885-1924 by Edward Russell whose homestead stood opposite on Cambridge Street. The house & remaining acreage have been under the ownership of the Baghdoyan family from 1924 to the present.

(This property was formerly known as # 2 Pond Street.)

BIBLIOGRAPHY and/or REFERENCES

- Assessor's Records, Winchester Town Hall. Deeds.

INVENTORY FORM CONTINUATION SHEET

MASSACHUSETTS HISTORICAL COMMISSION
Office of the Secretary, Boston

Community: Winchester	Form No: 38
Property Name: Edmund Parker Jr. House	

Indicate each item on inventory form which is being continued below.

HISTORICAL SIGNIFICANCE:

Chain of ownership;

1. Edmund Parker 1826-1879
2. David Adams 1879-1881
3. Edward Russell 1885-1924
4. Vazken Baghdoyan 1924-

Staple to Inventory form at bottom

MAY 22 1989

United States Department of the Interior
National Park Service

National Register of Historic Places
Continuation Sheet

Section number _____ Page _____

Multiple Resource Area
Thematic Group

Name Winchester MRA
State Middlesex County, MASSACHUSETTS

Nomination/Type of Review	Date/Signature
31. Hatch, Horace, House Entered in the National Register	Keeper <u>Helene Byers</u> 7/5/89 Attest _____
32. Maxwell, Louis N., House Entered in the National Register	Keeper <u>Helene Byers</u> 7/5/89 Attest _____
33. ^{sc 12-D} McCall, Samuel W., House Entered in the National Register	Keeper <u>Boyd L. Savage</u> 7-5-89 Attest _____
34. Mitchell, Amy B., House Entered in the National Register	Keeper <u>Helene Byers</u> 7/5/89 Attest _____
35. Moore House Entered in the National Register	Keeper <u>Helene Byers</u> 7/5/89 Attest _____
36. Oak Knoll Entered in the National Register	Keeper <u>Helene Byers</u> 7/5/89 Attest _____
37. Parker House Entered in the National Register	Keeper <u>Helene Byers</u> 7/5/89 Attest _____
38. Parker, Edmund, Jr., House Entered in the National Register	Keeper <u>Helene Byers</u> 7/5/89 Attest _____
39. Parker, Harrison, Sr., House Entered in the National Register	Keeper <u>Helene Byers</u> 7/5/89 Attest _____
40. Pressey--Eustis House Entered in the National Register	Keeper <u>Helene Byers</u> 7/5/89 Attest _____

UNITED STATES DEPARTMENT OF THE INTERIOR
NATIONAL PARK SERVICE

NATIONAL REGISTER OF HISTORIC PLACES
EVALUATION/RETURN SHEET

REQUESTED ACTION: NOMINATION

PROPERTY NAME: Parker, Edmund, Jr., House

MULTIPLE NAME: Winchester MRA

STATE & COUNTY: MASSACHUSETTS, Middlesex

DATE RECEIVED: 5/22/89 DATE OF PENDING LIST: 6/06/89
DATE OF 16TH DAY: 6/22/89 DATE OF 45TH DAY: 7/06/89
DATE OF WEEKLY LIST:

REFERENCE NUMBER: 89000610

NOMINATOR: STATE

REASONS FOR REVIEW:

APPEAL: N DATA PROBLEM: N LANDSCAPE: N LESS THAN 50 YEARS: N
OTHER: N PDIL: N PERIOD: N PROGRAM UNAPPROVED: N
REQUEST: N SAMPLE: N SLR DRAFT: N NATIONAL: N

COMMENT WAIVER: N

ACCEPT RETURN REJECT 7/5/89 DATE

Entered in the
National Register

ABSTRACT/SUMMARY COMMENTS:

RECOM./CRITERIA _____
REVIEWER _____
DISCIPLINE _____
DATE _____

DOCUMENTATION see attached comments Y/N see attached SLR Y/N

CLASSIFICATION

count resource type

STATE/FEDERAL AGENCY CERTIFICATION

FUNCTION

historic current

DESCRIPTION

architectural classification
 materials
 descriptive text

SIGNIFICANCE

Period Areas of Significance--Check and justify below

Specific dates Builder/Architect
Statement of Significance (in one paragraph)

summary paragraph
 completeness
 clarity
 applicable criteria
 justification of areas checked
 relating significance to the resource
 context
 relationship of integrity to significance
 justification of exception
 other

BIBLIOGRAPHY

GEOGRAPHICAL DATA

acreage verbal boundary description
 UTM's boundary justification

ACCOMPANYING DOCUMENTATION/PRESENTATION

sketch maps USGS maps photographs presentation

OTHER COMMENTS

Questions concerning this nomination may be directed to

_____ Phone _____

Signed _____

Date _____



Edmund Parker House
287 Cambridge St. 1/88
Winchester, Ma. MRA

MHC Inv. #38



Edmund Parker House
287 Cambridge St. 1/88
Winchester, Ma. MRA

MHC Inv. # 38

Please refer to the map in the
Multiple Property Cover Sheet
for this property

Multiple Property Cover Sheet Reference Number: 64000303