

14
JRM A - AREA

Area Letter Form numbers in this Area

WBB	
-----	--

MASSACHUSETTS HISTORICAL COMMISSION
3 BOYLSTON STREET, BOSTON, MA 02116



Town Barnstable (West Barnstable)

Name of Area (if any) Meetinghouse Way

(W. Barnst. Vil) Historic District

Present Use residential, institutional,
commercial

General Date or Period 1717-1920

General Condition poor to excellent

Acreage c175A (see data sheets)

Recorded by Wendy Frontiero/Candace Jenkins

Organization Barnstable Historical Comm.

Date 1986

see attached map

The West Barnstable Village (Meetinghouse Way) Historic District includes 26 main buildings, 40 outbuildings, and one site (former Poor Farm). Its boundaries were chosen to encompass the traditional village settlement center for West Barnstable. Thus all properties fronting on Meetinghouse Way from County Road to the Meetinghouse are included, and represent the village's rich 18th, 19th and 20th century heritage.

M REFERENCE A 19/385 640 14618150
B 19/385 820 1461800
C 19/384 720 14617040
D 19/384 920 14616840

GS QUADRANGLE Sandwich/Hyannis
 ALE 1:25,000

NATIONAL REGISTER CRITERIA STATEMENT (if applicable)

The West Barnstable Village Historic District possesses integrity of location, design, setting, materials, workmanship, feeling and association. As the second part of the town to be settled, West Barnstable Village has sustained a remarkable level of prosperity and community focus through several centuries of creative adaptation to cultural change. Political, religious, institutional and economic activities which have clustered here over time drew numbers of prominent local families- along with a notable population of foreign immigrants- to the area, as represented in its rich array of architecture. The district thus meets criteria A, B, and C of the National Register of Historic Places.

ARCHITECTURAL SIGNIFICANCE Describe important architectural features and evaluate in terms of other areas within the community.

The West Barnstable Village Historic District is a dispersed linear settlement of old homesteads, interspersed with a diversity of later buildings required to service new village and townwide needs. Most of the domestic buildings date from the late 18th and early 19th centuries, while the several surviving non-residential buildings date to the late 19th and early 20th centuries. Generally speaking, most of the district's architecture is relatively simple, yet quite competently designed; traditionally based interpretations of popular styles often show an unexpected hint of urbanity. The most significant building in the district both historically and architecturally, is the West Parish Meetinghouse of 1717. Individual examples are described below:

WBB66- Moody Crocker House (c1789-1805). A fine early example of residential building, this three bay, 1 and 1/2 story cottage is built in a vernacular Federal period style. Clad in wood shingles, the structure also features an offset chimney and entry- the latter with a five light transom- and large 12/12 windows. Simple trim marks the entry, fenestration, cornerboards, and cornice, in a manner characteristic of Barnstable's Federal period

HISTORICAL SIGNIFICANCE Explain historical importance of area and how the area relates to the development of other areas of the community.

Soon after the town's first settlement c1640, extensive salt hay marshes and rich agricultural land attracted residents to West Barnstable Village, which was further enhanced by the establishment of the County Road in 1685. The history of West Barnstable, as distinct from that of Barnstable Village to the east, began in the early 18th century when citizens petitioned for a separate parish to lessen the time involved in travelling to the original meetinghouse at Lothrop's Hill. The formal split came in 1715-1717 when the new West Parish Meetinghouse was built on what is now Meetinghouse Way; the handsome building still stands (restored back from a mid 19th century remodeling) at the southern end of the district.

While West Barnstable did not enjoy the substantial 18th century growth experienced at Barnstable Village, the county seat, the community prospered well enough. Through the early 19th century, important farming families such as the Crockers, Chipmans, Hamlins, Otises, Blossoms, Parkers, Jenkinsons, Bursleys, and Bodfishes left their mark in a number of sturdy and well formed houses, though only one, the Rev. Enoch Pratt House, shows any high style pretensions. A poor house erected by the town in 1769 through a Parker family endowment was unfortunately demolished in the 1960s.

Construction of the Cape Cod Branch Railroad through West Barnstable Village in 1854 sparked much new population growth, along with business activity and building development. Within a few years, the West Barnstable Village Historic District was thriving with a new Railroad station, a school and post office, workshops and stores, several parsonages, and a

BIBLIOGRAPHY and/or REFERENCES

- Trayser, Donald. Barnstable, Three Centuries of a Cape Cod Town. 1939.
Otis, Amos. Genealogical Notes of Barnstable Families. 1888.
Deyo, Simon. History of Barnstable County. 1890.
Barnstable County Atlases, 1858, 1880, 1907.
Barnstable County Registry of Deeds and Probate.

INVENTORY FORM CONTINUATION SHEET

MASSACHUSETTS HISTORICAL COMMISSION
Office of the Secretary, Boston

Community: Barnstable (West Barnstable)	Form No: WBB
Property Name: West Barnstable Village Historic District Meetinghouse Way	

Indicate each item on inventory form which is being continued below.

Architectural Significance (cont)

cottages.

WBB58- Rev. Enoch Pratt House (1808). This house exhibits a much more sophisticated Federal period treatment. The cubical mass rises two stories to a hip roof with interior end chimneys. Wood shingles cover the front facade, while the end walls are made of brick; a wide fascia and panelled pilasters also distinguish the facades. The regular five bay facade comprises 6/6 windows with simple moldings, a center entrance with fanlight and 1/2 sidelights, and a columned portico. The final touch is a Palladian window centered above the entry.

WBB54- Captain Josiah Crocker House (1854). This house provides the most elaborate example of the transitional Greek Revival/Italianate style in the district. The 2 and 1/2 story clapboarded building is organized around a side hall plan with moderately pitched gable roof. The Greek Revival style is evident in the full width front porch with fluted Doric columns, the pedimented gable end, wide entablature, and heavy panelled pilasters. Modest Italianate style eaves brackets, and tiny paired brackets ornamenting the pilaster capitals, add a light Victorian finish. The building's windows feature wide lintels with a simple cornice molding; sash at the porch contain elongated 6/9 lights, at the gable field 6/6, and in other windows 2/2.

WBB45- John Parker House (c1865-1880). A pair of stylistically related and adjoining houses exhibit increasingly sober examples of the Italianate style. Both are L-shaped with clapboard siding, gable roofs, and a front wing of three bays with offset entry. The Parker House is the more advanced of the two, being 2 and 1/2 stories tall and framed by a full, wide entablature and corner pilasters; 2/2 windows feature a simple cornice molding which on the second story projects forward from the horizontally continuous entablature molding. One story polygonal bay windows grace each gable end at the ground floor, while the front gable is particularized by a heavy bracketed hood over double leaf doors, and by a small oculus in the gable field. A one story porch with broad entablature, but surely replacement 6"x6" posts, spans between the front and side wings, to protect a single entry centered on the facade of the side wing.

WBB44- Melvin and Elvira Parker House (c1865). Next door is a 1 and 1/2 story cottage with plain cornerboards and friezeboard. Its main entry is defined by a relatively small bracketed door hood, and an unusual L-shaped porch joins the front and side wings, again leading to a secondary entry. Partially enclosed, this porch retains its original flat pilaster posts with simple arched brackets. Simple cornice moldings surmount the porch doorway and 2/2 windows in this version as well.

WBB55- Zebina Jenkins House (c1898-1904). A skillful volumetric sensibility, modestly ornamented, distinguishes the late Victorian residence. The square-shaped plan takes shape in 2 and 1/2 stories dominated by a steep hip roof with offset pavilions at the front and north sides; the front pavilion rises from a polygonal bay window on the ground floor. Shingled walls are bordered by plain cornerboards and fascia, flaring out at the base of the gable fields to meet the main cornice line. Across the front, a hip roofed verandah supported by turned posts wraps around the front and cut-away side corners; it is bisected by a pedimented gable to mark the center entry with its double leaf doors. Regularly set fenestration consists of single and paired windows with 2/2 sash.

Staple to Inventory form at bottom

INVENTORY FORM CONTINUATION SHEET

MASSACHUSETTS HISTORICAL COMMISSION
Office of the Secretary, Boston

Community: Barnstable (West Barnstable)	Form No: WBB
Property Name: West Barnstable Village Historic District Meetinghouse Way	

Indicate each item on inventory form which is being continued below.

Architectural Significance (cont)

WBB68- West Parish Meetinghouse (1717-1719). The Meetinghouse is the most conspicuous visual and architectural landmark in the district in addition to being the catalyst of village independence and growth. Built in a typical 18th century meetinghouse design, the building features a 2 and 1/2 story gabled block, sheathed in clapboards, with its gable end to the street. A central tower projects from the front facade, while a two story gabled entrance pavilion is centered on its long east side. Relatively small 12/12 window sash break the broad expanses of walls, enframed by simple architraves with prominent cornice caps. The Meetinghouse was remodelled in the Classical Revival style in 1852-1853, but was restored to its original condition between 1953 and 1956. The early 18th century frame remains intact.

WBB60- First Selectmen's Office (1889). This office stands at another end of the aesthetic spectrum. The essentially one room plan again features a simple rectangular structure, gable end to the street. In this case, however, the building is only 1 and 1/2 stories, and its use of textures and ornament celebrates a more exuberant age. Bands of plain and fancy-cut wood shingles and a decoratively sawn vergeboard (now deteriorated and fallen from the building) enliven the facades. The front features a three bay facade with a single center entry under a deep flat hood; originally, a narrow entablature with sawn brackets supported this lintel shelf. Prominent cornice moldings top original 2/1 windows.

WBB59- West Barnstable Elementary School (1903). This is a small, one story building with a T-shaped plan and clapboarded facades, inspired by the Colonial Revival style. Its broad hip roof bends and extends over the various wings and projections; the simple three room volume is elaborated only by a low dormer centered on the forward-most ell, and by a plain entry porch and vestibule tucked in to the northern corner of the T. Tall 6/6 windows occupy a large proportion of the facades, and a massive corbelled chimney strikes an unusual position perpendicular to the ridge line from which it projects. The general effect one of appealing, level-headed design.

B52- A.D. Makepeace Company Office Building (1905-1907). The most architecturally significant commercial/industrial buildings extant in the district include a vernacular turn-of-the-century office structure and a relatively high style train station. The Makepeace office building is a very modest 2 and 1/2 story structure, gable parallel to the street, sheathed with clapboards, and extended to the rear by a perpendicular two story ell. The four window bays across the second story of the front facade contain 6/6 sash surrounded by plain architraves. Their rhythm is completely unrelated to the livelier first floor: here, chamfered posts support a shallow hip roofed porch that spans the entire facade; beyond is an asymmetrical composition of typical double hung windows and a Queen Anne style door at the south end, with a second Queen Anne door flanked by 20 pane display windows at the building's north end.

WBB47- West Barnstable Railroad Depot (1910). This is a more pretentious design and equally rare example of its building type; furthermore, it provides an excellent example of the Arts & Crafts/Mission style in Barnstable. The rectangular structure is built of concrete with a slightly projecting base that rises approximately three feet. Punched windows with subtly raised concrete surrounds feature modern 1/1 sash. Overhead, a hip roof covered with Spanish tiles flares out over widely projecting eaves. The track side entrance features a single door with sidelights and transom, while the opposite entrance on the south facade contains double leaf doors with a diamond pane transom. Covered platforms originally

~~the depot's roof in form and material.~~

Staple to Inventory form at bottom

INVENTORY FORM CONTINUATION SHEET

MASSACHUSETTS HISTORICAL COMMISSION
Office of the Secretary, Boston

Community: Barnstable (West Barnstable)	Form No: WBB
Property Name: West Barnstable Village Historic District Meetinghouse Way	

Indicate each item on inventory form which is being continued below.

Architectural Significance (cont)

extended to either side, matching the depot's roof in form and material, and supported by sturdy bracketed posts.

Historical Significance (cont)

newly updated meetinghouse.

As small-scale farming began a gradual decline in the later 19th century, however, and maritime activities drew attention to the town's southern villages, the village of West Barnstable resourcefully rebounded with the development of local industrial manufacture. Hats, chairs, leather, pottery, and especially bricks (from 1878-1919) were among West Barnstable's leading products. Abel Makepeace, one of the prime movers of the brickyard, also revived local agriculture with his highly successful cultivation of multifarious crops, most notably, cranberries; Makepeace's original office building provides a rare symbol of the importance of this industry to the turn-of-the-century West Barnstable and town-wide economy. Also in the late 19th century, Finnish and Portuguese immigrants began to arrive in significance numbers, found work in the new industries.

Other signs of the district's continued vitality are found in the public places of the community. These include the New Otis Hall, 1897 (WBB53), built as a social and political gathering place by village residents (and occupied from the 1930s through the 1960s by the Finnish Congregational Church); the Public Library, 1905 (WBB57), begun and supported by local donors; the West Barnstable Elementary School, 1903 (WBB59), the district's third such structure; the First Selectmen's Office, 1889 (WBB60), which served Barnstable until a new town hall was built in the village of Hyannis in 1926; the Old Village Store, 1880 (WBB50), the most elaborate of the three late 19th century stores remaining in the district; and of course the West Barnstable Railroad Depot, 1910 (WBB47), the third such building on the site and one of the few remaining on the Cape.

Altogether, the West Barnstable Historic District presents a remarkably complete and continuous picture of village life in Barnstable.

Staple to Inventory form at bottom

RECEIVED

Village:

Barnstable MA, MRA
West Barnstable

District Name: Meetinghouse Way

Map & Parcel	Acreage	Street Address	Historic Name/Inventory #	Date	Style	Status	
155/43	.48	2469 Meetinghouse Way	WBRR Depot	WBB47	1910	Arts & Crafts	C
155/49	.1	Meetinghouse Way	Vacant		n/a	n/a	NC
155/17	.3	2455 Meetinghouse Way	Old Village Store	WBB50	1880	Vernacular	C
155/38	.41	2439 Meetinghouse Way	A.D. Makepeace Office	WBB52	1905-07	Vernacular	C
155/20	.45	2429 Meetinghouse Way	Finnish Cong. Church	WBB53	1897	Arts & Crafts	C
155/18	.86	2415 Meetinghouse Way	Zebina H. Jenkins House (barn)	WBB55	1898-1904	Queen Anne	C
155/19	.58	2401 Meetinghouse Way	Whelden Mem. Library	WBB57	1905	Arts & Crafts	C
155/25	.57	2506 Meetinghouse Way	Bursley-Parker House (garage)	WBB44	c. 1860	Greek Revival/ Italianate	C
155/26	.86	2482 Meetinghouse Way	John W.B. Parker House (barn)	WBB45	c. 1865	Greek Revival/ Italianate	C
155/26	.86	2482 Meetinghouse Way	Seth Parker, Jr. Store & P.O.	WBB46	c. 1865-80	Vernacular	C
155/27	.81	2472 Meetinghouse Way	Shadrack Howland Store (barn)	WBB48	1876	Vernacular	C
155/28	.6	Meetinghouse Way	Bodfish-Howland House (garage)	WBB49	c. 1835-42	Federal	C

MASS. HIST. COMM.

Village: Barnstable MA, MRA
West Barnstable

District Name: Meetinghouse Way

Map & Parcel	Acreage	Street Address	Historic Name/Inventory #	Date	Style	Status	
155/29	3.83	2454 Meetinghouse Way	Makepeace Cranberry Industry Complex (1 house, 8 out-buildings)	WBB51	1882	Vernacular	C
155/44	.56	2454 Meetinghouse Way	1 house, 8 out-buildings	WBBSI	1882	Vernacular	C
155/30	14.96	2420 Meetinghouse Way	Capt. Josiah Crocker House (garage, shed)	WBB54	1854	Greek Revival/ Italianate	C
155/31	2.19	2412 Meetinghouse Way	Nye House & Parsonage (barn, shed)	WBB56	c. 1820	Federal	C
155/45	1.62	2400 Meetinghouse Way	Rev. Enoch Pratt House & Pars.	WBB58	1808	Federal	C
155/46	5.53	Meetinghouse Way	Vacant		n/a	n/a	NC
155-32	33.72 26.57	Meetinghouse Way	Vacant		n/a	n/a	NC
154-2	partial 93.10	Meetinghouse Way	Town Conservation Land		n/a	n/a	NC
154-3	2.0	Meetinghouse Way	Crocker-Nye House (barn)	WBB65	1835-45	Federal	C
154-4	2.64	Meetinghouse Way/ Church	New House		n/a	n/a	NC
154-5	2.6	40 Church	New House		n/a	n/a	NC
154-7	6.22	72 Church	Stephen R. Crocker House (barn, shed)	WBB70	1833	Federal	C

Village: Barnstable MA, MA
West Barnstable

District Name: Meetinghouse Way

Map & Parcel	Acreage	Street Address	Historic Name/Inventory #	Date	Style	Status
130-16	1.5	29 Church	Bridgham Crocker Homestead (barn, shed) WBB69	c. 1832-50	Greek Revival (2 sheds)	C
130-17	5.65	2049 Meetinghouse Way	W. Parish Meetinghouse (parish house)	B68 1717-19	Georgian	C
130-13	3.35	46 Cedar Street	Moody Crocker House	B66 c. 1789-1805	Federal	C
130-14	6.71 partial	2175B Meetinghouse Way	Paine-Black House (shed, greenhouse)	B64 c. 1780	Georgian	C
130-12	20.75	2175 Meetinghouse Way	Moses Crocker House (barn)	B63 c. 1790	Federal	C
154-8	.75	2175 Meetinghouse Way	Vacant	c. 1790	Federal	C
155-1	4.65	Meetinghouse Way	B			
155-47	2.32	2231-57 Meetinghouse Way	Tannery & Fish Hatchery Site	B62		C
155-2	6.33	2311 Meetinghouse Way	Town Poor Farm Site	B61		C
155-2	6.33	2311 Meetinghouse Way	First Selectman's Office	B60 1889	QA/Stick	C
155-40	4.08		W.B. Village School	B59 1903	A/C	C

NATIONAL REGISTER OF HISTORIC PLACES
EVALUATION/RETURN SHEET

West Barnstable Village--Meetinghouse Way
Historic District (Barnstable MRA)
Barnstable County
MASSACHUSETTS

Substantive Review

Working No. JAN 27 1987
Fed. Reg. Date: _____
Date Due: 2/26/87 - 3/13/87
Action: ACCEPT
 RETURN 3-13-87
 REJECT
Federal Agency: _____

- resubmission
- nomination by person or local government
- owner objection
- appeal

Substantive Review: sample request appeal NR decision

Reviewer's comments:

*see general comments
for MRA.*

Recom./Criteria Return
Reviewer Salove
Discipline Architectural History
Date 3/13/87
_____ see continuation sheet

Nomination returned for: technical corrections cited below
 substantive reasons discussed below

1. Name

2. Location

3. Classification

Category	Ownership	Status	Present Use
	Public Acquisition	Accessible	

4. Owner of Property

5. Location of Legal Description

6. Representation in Existing Surveys

Has this property been determined eligible? yes no

7. Description

Condition

- excellent
- good
- fair
- deteriorated
- ruins
- unexposed

Check one

- unaltered
- altered

Check one

- original site
- moved date _____

Describe the present and original (if known) physical appearance

- summary paragraph
- completeness
- clarity
- alterations/integrity
- dates
- boundary selection

8. Significance

Period _____ Areas of Significance—Check and justify below

Specific dates _____ Builder/Architect _____
Statement of Significance (*in one paragraph*)

- summary paragraph
- complete
- clarity
- applicable criteria
- justification of areas checked
- relating significance to the resource
- context
- relationship of integrity to significance
- justification of exception
- other

9. Major Bibliographical References

10. Geographical Data

Acreage of nominated property _____
Quadrangle name _____
UTM References _____

Verbal boundary description and justification _____

11. Form Prepared By

12. State Historic Preservation Officer Certification

The evaluated significance of this property within the state is:

_____ national _____ state _____ local

State Historic Preservation Officer signature

title _____ date _____

13. Other

- Maps
- Photographs
- Other

Questions concerning this nomination may be directed to _____

Signed Patrick Andrus Date 3/13/87 Phone: _____

FORM A - AREA

Area Letter Form numbers in this Area

WBB	
-----	--

MASSACHUSETTS HISTORICAL COMMISSION
80 BOYLSTON STREET, BOSTON, MA 02116

Town Barnstable (West Barnstable)

Name of Area (if any) Meetinghouse Way

(W. Barnst. Vil.) Historic District

Present Use residential, institutional,
commercial

General Date or Period 1717-1920

General Condition poor to excellent

Acreage c175A (see data sheets)

Recorded by Wendy Frontiero/Candace Jenkins

Organization Barnstable Historical Comm.

Date 1986

Photos (3"x3" or 3"x5" black & white) Indicate on back of each photo street addresses for buildings shown. Staple to left side of form.

Sketch Map. Draw a general map of the area indicating properties within it. Number each property for which individual inventory forms have been completed. Label streets including route numbers, if any. Indicate north. (Attach a separate sheet if space here is not sufficient).

see attached map

The West Barnstable Village (Meetinghouse Way) Historic District includes 26 main buildings, 30 outbuildings, and three sites. Its boundaries were chosen to encompass the traditional village settlement center for West Barnstable. Thus all properties fronting on Meetinghouse Way from County Road to the Meetinghouse are included, and represent the village's rich 18th, 19th and 20th century heritage.

Contributing/Non-contributing Status

Buildings: 24C, 2NC
Structures*: 15C, 15NC
Vacant lots: 4NC
Monuments: 1C, 1NC
Sites: 3C

*small barns, barns, garages, and greenhouses were counted as structures because they are temporary in nature.

UTM REFERENCE A 19/385640 14618150
B 19/385 820 14618100
C 19/384720 14617040
D 19/384920 14616840
USGS QUADRANGLE Sandwich/Hyannis
SCALE 1:25,000

SEP 28 1987

NATIONAL REGISTER CRITERIA STATEMENT (if applicable)

The West Barnstable Village Historic District possesses integrity of location, design, setting, materials, workmanship, feeling and association. As the second part of the town to be settled, West Barnstable Village has sustained a remarkable level of prosperity and community focus through several centuries of creative adaptation to cultural change. Political, religious, institutional and economic activities which have clustered here over time drew numbers of prominent local families- along with a notable population of foreign immigrants- to the area, as represented in its rich array of architecture. The district thus meets criteria A, B and C of the National Register of Historic Places.

The town conservation land (lot 154-2) is considered to be a contributing element of the district because it conserves the open, rural feeling that has always been a hallmark of the area.

ARCHITECTURAL SIGNIFICANCE Describe important architectural features and evaluate in terms of other areas within the community.

The West Barnstable Village Historic District is a dispersed linear settlement of old homesteads, interspersed with a diversity of later buildings required to service new village and townwide needs. Most of the domestic buildings date from the late 18th and early 19th centuries, while the several surviving non-residential buildings date to the late 19th and early 20th centuries. Generally speaking, most of the district's architecture is relatively simple, yet quite competently designed; traditionally based interpretations of popular styles often show an unexpected hint of urbanity. The most significant building in the district both historically and architecturally, is the West Parish Meetinghouse of 1717. Individual examples are described below:

WBB66- Moody Crocker House (c1789-1805). A fine early example of residential building, this three bay, 1 and 1/2 story cottage is built in a vernacular Federal period style. Clad in wood shingles, the structure also features an offset chimney and entry- the latter with a five light transom- and large 12/12 windows. Simple trim marks the entry, fenestration, cornerboards, and cornice, in a manner characteristic of Barnstable's Federal period

HISTORICAL SIGNIFICANCE Explain historical importance of area and how the area relates to the development of other areas of the community.

Soon after the town's first settlement c1640, extensive salt hay marshes and rich agricultural land attracted residents to West Barnstable Village, which was further enhanced by the establishment of the County Road in 1685. The history of West Barnstable, as distinct from that of Barnstable Village to the east, began in the early 18th century when citizens petitioned for a separate parish to lessen the time involved in travelling to the original meetinghouse at Lothrop's Hill. The formal split came in 1715-1717 when the new West Parish Meetinghouse was built on what is now Meetinghouse Way; the handsome building still stands (restored back from a mid 19th century remodeling) at the southern end of the district.

While West Barnstable did not enjoy the substantial 18th century growth experienced at Barnstable Village, the county seat, the community prospered well enough. Through the early 19th century, important farming families such as the Crockers, Chipmans, Hamlins, Otises, Blossoms, Parkers, Jenkinsons, Bursleys, and Bodfishes left their mark in a number of sturdy and well formed houses, though only one, the Rev. Enoch Pratt House, shows any high style pretensions. A poor house erected by the town in 1769 through a Parker family endowment was unfortunately demolished in the 1960s.

Construction of the Cape Cod Branch Railroad through West Barnstable Village in 1854 sparked much new population growth, along with business activity and building development. Within a few years, the West Barnstable Village Historic District was thriving with a new Railroad station, a school and post office, workshops and stores, several parsonages, and a

BIBLIOGRAPHY and/or REFERENCES

Trayser, Donald. Barnstable, Three Centuries of a Cape Cod Town. 1939.

Otis, Amos. Genealogical Notes of Barnstable Families. 1888.

Deyo, Simon. History of Barnstable County. 1890.

Barnstable County Atlases, 1858, 1880, 1907.

Barnstable County Registry of Deeds and Probate.

INVENTORY FORM CONTINUATION SHEET

MASSACHUSETTS HISTORICAL COMMISSION
Office of the Secretary, Boston

Community: Barnstable (West Barnstable)	Form No: WBB
Property Name: West Barnstable Village Historic District Meetinghouse Way	

Indicate each item on inventory form which is being continued below.

Architectural Significance (cont)

cottages.

WBB58- Rev. Enoch Pratt House (1808). This house exhibits a much more sophisticated Federal period treatment. The cubical mass rises two stories to a hip roof with interior end chimneys. Wood shingles cover the front facade, while the end walls are made of brick; a wide fascia and panelled pilasters also distinguish the facades. The regular five bay facade comprises 6/6 windows with simple moldings, a center entrance with fanlight and 1/2 sidelights, and a columned portico. The final touch is a Palladian window centered above the entry.

WBB54- Captain Josiah Crocker House (1854). This house provides the most elaborate example of the transitional Greek Revival/Italianate style in the district. The 2 and 1/2 story clapboarded building is organized around a side hall plan with moderately pitched gable roof. The Greek Revival style is evident in the full width front porch with fluted Doric columns, the pedimented gable end, wide entablature, and heavy panelled pilasters. Modest Italianate style eaves brackets, and tiny paired brackets ornamenting the pilaster capitals, add a light Victorian finish. The building's windows feature wide lintels with a simple cornice molding; sash at the porch contain elongated 6/9 lights, at the gable field 6/6, and in other windows 2/2.

WBB45- John Parker House (c1865-1880). A pair of stylistically related and adjoining houses exhibit increasingly sober examples of the Italianate style. Both are L-shaped with clapboard siding, gable roofs, and a front wing of three bays with offset entry. The Parker House is the more advanced of the two, being 2 and 1/2 stories tall and framed by a full, wide entablature and corner pilasters; 2/2 windows feature a simple cornice molding which on the second story projects forward from the horizontally continuous entablature molding. One story polygonal bay windows grace each gable end at the ground floor, while the front gable is particularized by a heavy bracketed hood over double leaf doors, and by a small oculus in the gable field. A one story porch with broad entablature, but surely replacement 6"x6" posts, spans between the front and side wings, to protect a single entry centered on the facade of the side wing.

WBB44- Melvin and Elvira Parker House (c1865). Next door is a 1 and 1/2 story cottage with plain cornerboards and friezeboard. Its main entry is defined by a relatively small bracketed door hood, and an unusual L-shaped porch joins the front and side wings, again leading to a secondary entry. Partially enclosed, this porch retains its original flat pilaster posts with simple arched brackets. Simple cornice moldings surmount the porch doorway and 2/2 windows in this version as well.

WBB55- Zebina Jenkins House (c1898-1904). A skillful volumetric sensibility, modestly ornamented, distinguishes the late Victorian residence. The square-shaped plan takes shape in 2 and 1/2 stories dominated by a steep hip roof with offset pavilions at the front and north sides; the front pavilion rises from a polygonal bay window on the ground floor. Shingled walls are bordered by plain cornerboards and fascia, flaring out at the base of the gable fields to meet the main cornice line. Across the front, a hip roofed verandah supported by turned posts wraps around the front and cut-away side corners; it is bisected by a pedimented gable to mark the center entry with its double leaf doors. Regularly set fenestration consists of single and paired windows with 2/2 sash.

Staple to Inventory form at bottom

1861 87 FCS

INVENTORY FORM CONTINUATION SHEET

MASSACHUSETTS HISTORICAL COMMISSION
Office of the Secretary, Boston

Community: Barnstable (West Barnstable)	Form No: WBB
Property Name: West Barnstable Village Historic District Meetinghouse Way	

Indicate each item on inventory form which is being continued below.

Architectural Significance (cont)

WBB68- West Parish Meetinghouse (1717-1719). The Meetinghouse is the most conspicuous visual and architectural landmark in the district in addition to being the catalyst of village independence and growth. Built in a typical 18th century meetinghouse design, the building features a 2 and 1/2 story gabled block, sheathed in clapboards, with its gable end to the street. A central tower projects from the front facade, while a two story gabled entrance pavilion is centered on its long east side. Relatively small 12/12 window sash break the broad expanses of walls, enframed by simple architraves with prominent cornice caps. The Meetinghouse was remodelled in the Classical Revival style in 1852-1853, but was restored to its original condition between 1953 and 1956. The early 18th century frame remains intact.

WBB60- First Selectmen's Office (1889). This office stands at another end of the aesthetic spectrum. The essentially one room plan again features a simple rectangular structure, gable end to the street. In this case, however, the building is only 1 and 1/2 stories, and its use of textures and ornament celebrates a more exuberant age. Bands of plain and fancy-cut wood shingles and a decoratively sawn vergeboard (now deteriorated and fallen from the building) enliven the facades. The front features a three bay facade with a single center entry under a deep flat hood; originally, a narrow entablature with sawn brackets supported this lintel shelf. Prominent cornice moldings top original 2/1 windows.

WBB59- West Barnstable Elementary School (1903). This is a small, one story building with a T-shaped plan and clapboarded facades, inspired by the Colonial Revival style. Its broad hip roof bends and extends over the various wings and projections; the simple three room volume is elaborated only by a low dormer centered on the forward-most ell, and by a plain entry porch and vestibule tucked in to the northern corner of the T. Tall 6/6 windows occupy a large proportion of the facades, and a massive corbelled chimney strikes an unusual position perpendicular to the ridge line from which it projects. The general effect is one of appealing, level-headed design.

WBB52- A.D. Makepeace Company Office Building (1905-1907). The most architecturally significant commercial/industrial buildings extant in the district include a vernacular turn-of-the-century office structure and a relatively high style train station. The Makepeace Office building is a very modest 2 and 1/2 story structure, gable parallel to the street, sheathed with clapboards, and extended to the rear by a perpendicular two story ell. The four window bays across the second story of the front facade contain 6/6 sash surrounded by plain architraves. Their rhythm is completely unrelated to the livelier first floor: here, chamfered posts support a shallow hip roofed porch that spans the entire facade; beyond is an asymmetrical composition of typical double hung windows and a Queen Anne style door at the south end, with a second Queen Anne door flanked by 20 pane display windows at the building's north end.

WBB47- West Barnstable Railroad Depot (1910). This is a more pretentious design and equally rare example of its building type; furthermore, it provides an excellent example of the Arts & Crafts/Mission style in Barnstable. The rectangular structure is built of concrete with a slightly projecting base that rises approximately three feet. Punched windows with subtly raised concrete surrounds feature modern 1/1 sash. Overhead, a hip roof covered with Spanish tiles flares out over widely projecting eaves. The track side entrance features a single door with sidelights and transom, while the opposite entrance on the south facade contains double leaf doors with a diamond pane transom. Covered platforms originally

~~Staple to inventory form at bottom.~~
the depot's roof in form and material.

SEP 28 1987

INVENTORY FORM CONTINUATION SHEET

MASSACHUSETTS HISTORICAL COMMISSION
Office of the Secretary, Boston

Community: Barnstable (West Barnstable)	Form No: WBB
Property Name: West Barnstable Village Historic District Meetinghouse Way	

Indicate each item on inventory form which is being continued below.

Architectural Significance (cont)

extended to either side, matching the depot's roof in form and material, and supported by sturdy bracketed posts.

Historical Significance (cont)

newly updated meetinghouse.

As small-scale farming began a gradual decline in the later 19th century, however, and maritime activities drew attention to the town's southern villages, the village of West Barnstable resourcefully rebounded with the development of local industrial manufacture. Hats, chairs, leather, pottery, and especially bricks (from 1878-1919) were among West Barnstable's leading products. Abel Makepeace, one of the prime movers of the brickyard, also revived local agriculture with his highly successful cultivation of multifarious crops, most notably, cranberries; Makepeace's original office building provides a rare symbol of the importance of this industry to the turn-of-the-century West Barnstable and town-wide economy. Also in the late 19th century, Finnish and Portuguese immigrants began to arrive in significance numbers, found work in the new industries.

Other signs of the district's continued vitality are found in the public places of the community. These include the New Otis Hall, 1897 (WBB53), built as a social and political gathering place by village residents (and occupied from the 1930s through the 1960s by the Finnish Congregational Church); the Public Library, 1905 (WBB57), begun and supported by local donors; the West Barnstable Elementary School, 1903 (WBB59), the district's third such structure; the First Selectmen's Office, 1889 (WBB60), which served Barnstable until a new town hall was built in the village of Hyannis in 1926; the Old Village Store, 1880 (WBB50), the most elaborate of the three late 19th century stores remaining in the district; and of course the West Barnstable Railroad Depot, 1910 (WBB47), the third such building on the site and one of the few remaining on the Cape.

Altogether, the West Barnstable Historic District presents a remarkably complete and continuous picture of village life in Barnstable.

Staple to Inventory form at bottom

DISTRICT DATA SHEET

1

Village: Barnstable MA, MRA
West Barnstable

District Name: Meetinghouse Way

Map & Parcel	Acreage	Street Address	Historic Name/Inventory #	Date	Style	Status
155/43 ✓	.48	2469 Meetinghouse Way	WBRR Depot WBB47	1910	Arts & Crafts	C
155/49	.1	Meetinghouse Way	Vacant	n/a	n/a	NC
155/17 ✓	.3	2455 Meetinghouse Way	Old Village Store WBB50	1880	Vernacular	C
155/38 ✓	.41	2439 Meetinghouse Way	A.D. Makepeace Office WBB52	1905-07	Vernacular	C
155/20 ✓	.45	2429 Meetinghouse Way	Finnish Cong. Church WBB53	1897	Arts & Crafts	C
155/18 ✓	.86	2415 Meetinghouse Way	Zebina H. Jenkins House (barn) C WBB55	1898-1904	Queen Anne	C
155/19 ✓	.58	2401 Meetinghouse Way	Whelden Mem. Library WBB57	1905	Arts & Crafts	C
155/19 ✓	.58	2401 Meetinghouse Way	Veterans Memorial World War I & II WBB907	1946	n/a	NC
155/25 ✓	.57	2506 Meetinghouse Way	Bursley-Parker House (garage) NC WBB44	c. 1860	Greek Revival/ Italianate	C
155/26 ✓	.86	2482 Meetinghouse Way	John W.B. Parker House (barn) C WBB45	c. 1865	Greek Revival/ Italianate	C
155/26	.86	2482 Meetinghouse Way	Seth Parker, Jr. Store & P.O. WBB46	c. 1865-80	Vernacular	C
155/27 ✓	.81	2472 Meetinghouse Way	Shadrack Howland Store (barn) C WBB48	1876	Vernacular	C
155/28 ✓	.6	Meetinghouse Way	Bodfish-Howland House (garage) NC WBB49	c. 1835-42	Federal	C

SEP 28 1987

DISTRICT DATA SHEET

2

Village: Barnstable MA, MRA
West Barnstable

District Name: Meetinghouse Way

Map & Parcel	Acreage	Street Address	Historic Name/Inventory #	Date	Style	Status
155/29	3.83	2454 Meetinghouse Way	Makepeace Cranberry Industry Complex 5 out-buildings) C	WBB51 1882	Vernacular	C
155/44	.56	2454 Meetinghouse Way	1 house, 1 out-buildings C	WBB51 1882	Vernacular	C
155/30	14.96	2420 Meetinghouse Way	Capt. Josiah Crocker House NC NC (garage, shed)	WBB54 1854	Greek Revival/ Italianate	C
155/31	2.19	2412 Meetinghouse Way	Nye House & Parsonage (barn, shed) C NC	WBB56 c. 1820	Federal	C
155/45	1.62	2400 Meetinghouse Way	Rev. Enoch Pratt House & Pars. Garage NC	WBB58 1808	Federal	C
155/46	5.53	Meetinghouse Way	Vacant	n/a	n/a	NC
155-32	33.72 26.57	Meetinghouse Way	Vacant	n/a	n/a	NC
154-2	partial 93.10	Meetinghouse Way	Town Conservation Land	n/a	n/a	C
154-3	2.0	2140 Meetinghouse Way	Crocker-Nye House (barn) C	WBB65 1835-45	Federal	C
154-4	2.64	Meetinghouse Way/ Church	New House	n/a	n/a	NC
154-5	2.6	40 Church	New House	n/a	n/a	NC
154-7	6.22	72 Church	Stephen R. Crocker House (barn, shed) C NC	WBB70 1833	Federal	C

SEP 28 1987

DISTRICT DATA SHEET

Village: Barnstable MA, MRA
West Barnstable

District Name: Meetinghouse Way

Map & Parcel	Acreage	Street Address	Historic Name/Inventory #	Date	Style	Status	
130-16	1.5	29 Church	Bridgham Crocker Homestead AK (barn, shed) NC	c. 1832-50	Greek Revival	C	
130-17 adj. to	5.65	2049 Meetinghouse Way	Veterans Monument WBB69 WBB908	1932	n/a	C	
130-17	5.65	2049 Meetinghouse Way	W. Parish Meetinghouse (parish house) NC	B68	1717-19	Georgian	C
130-13	3.35	46 Cedar Street	Moody Crocker House (barn & shed) C NC	B66	c. 1789-1805	Federal	C
130-14 partial	6.71	2175B Meetinghouse Way	Paine-Black House (shed, greenhouse) NC NC	B64	c. 1780	Georgian	C
130-12	20.75	2175 Meetinghouse Way	Moses Crocker House (barn) C	B63	c. 1790	Federal	C
154-8	.75	Meetinghouse Way	Vacant			NC	
155-1	4.65	2231 Meetinghouse Way	new hse, shed, greenhouse new barn - all NC	N/A		NC	
155-47	2.32	2231-57 Meetinghouse Way	Tannery & Fish Hatchery Site	B62		C	
155-2	6.33	2311 Meetinghouse Way	Town Poor Farm Site	B61		C	
155-2	6.33	2311 Meetinghouse Way	First Selectman's Office	B60	1889	QA/Stick	C
155-40	4.08	2377 " "	W.B. Village School	B59	1903	A/C	C

SEP 28 1987

**United States Department of the Interior
National Park Service**

**National Register of Historic Places
Inventory—Nomination Form**

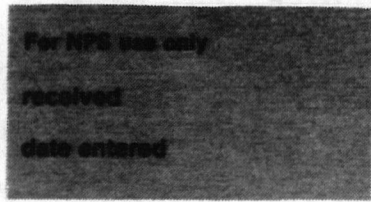

Continuation sheet

Item number

Page

Multiple Resource Area
Thematic Group

Name Barnstable MRA
State Barnstable Co., MA

Nomination/Type of Review

Date/Signature

11. Municipal Group Historic District

~~Substantive Review~~ Keeper

Patrick Andrus 11/10/87

Attest

Beth L. Savage 11/10/87

12. Old King's Highway Historic District

~~Substantive Review~~ Keeper

Patrick Andrus 3/12/87

Attest

Beth L. Savage 3/12/87

13. Pleasant--School Street Historic District

~~Substantive Review~~ Keeper

Patrick Andrus 11/10/87

Attest

Beth L. Savage 11/10/87

14. Santuit Historic District

~~Substantive Review~~ Keeper

Patrick Andrus 11/10/87

Attest

Beth L. Savage 11/10/87

15. Sandy Neck Cultural Resources District

~~Substantive Review~~ Keeper

John J. Knowlton 5-7

Attest

11/13/87

16. West Barnstable Village--Meetinghouse Way Historic District

~~Substantive Review~~ Keeper

Patrick Andrus 11/10/87

Attest

Beth L. Savage 11/10/87

17. Wianno Historic District

~~Substantive Review~~ Keeper

Patrick Andrus 11/10/87

Attest

Beth L. Savage 11/10/87

18. Adams--Crocker--Fish House

Entered in the National Register

Keeper

Delores Byrum 3-13-87

Attest

19. Ames, Josiah A., House

Substantive Review

Keeper

Patrick Andrus 9/18/87

Attest

Beth L. Savage 9/18/87

20. Ancient Burying Ground

Entered in the National Register

Keeper

Delores Byrum 3-13-87

Attest

0700255

NATIONAL REGISTER OF HISTORIC PLACES
EVALUATION/RETURN SHEET

West Barnstable Village-Meeting House Way Historic District

(Barnstable MRA)

Barnstable County

MASSACHUSETTS

Substantive Review

Working No. 1/27/87

Fed. Reg. Date: 2/7/89

Date Due: 11/2/87

Action: ACCEPT 11-10-87

RETURN

REJECT

Federal Agency: _____

- resubmission
- nomination by person or local government
- owner objection
- appeal

Substantive Review: sample request appeal NR decision

Reviewer's comments:

Political, religious, institutional and economic center of Barnstable Village encompassing rich collection of architecturally and historically important buildings. Initial review comments have been addressed.

Recom./Criteria: Accept A+C

Reviewer: Swasey

Discipline: Architectural History

Date: 11/10/87

see continuation sheet

Nomination returned for: technical corrections cited below
 substantive reasons discussed below

1. Name

2. Location

3. Classification

Category	Ownership	Status	Present Use
	Public Acquisition	Accessible	

4. Owner of Property

5. Location of Legal Description

6. Representation in Existing Surveys

Has this property been determined eligible? yes no

7. Description

Condition

- excellent
- good
- fair
- deteriorated
- ruins
- unexposed

Check one

- unaltered
- altered

Check one

- original site
- moved date _____

Describe the present and original (if known) physical appearance

- summary paragraph
- completeness
- clarity
- alterations/integrity
- dates
- boundary selection

8. Significance

Period _____ Areas of Significance—Check and justify below _____

Specific dates _____ Builder/Architect _____

Statement of Significance (*in one paragraph*) _____

- summary paragraph
- completeness
- clarity
- applicable criteria
- justification of areas checked
- relating significance to the resource
- context
- relationship of integrity to significance
- justification of exception
- other

9. Major Bibliographical References

10. Geographical Data

Acreage of nominated property _____

Quadrangle name _____

UTM References _____

Verbal boundary description and justification _____

11. Form Prepared By

12. State Historic Preservation Officer Certification

The evaluated significance of this property within the state is:

____ national ____ state ____ local

State Historic Preservation Officer signature _____

title _____ date _____

13. Other

- Maps
- Photographs
- Other

Questions concerning this nomination may be directed to _____

Signed _____ Date _____ Phone: _____



Barnstable, Mass. MRA WBB

West Barnstable Village H.D.

Meetinghouse Way

Moses Crocker House WBB63



Barnstable, Mass. MRA W13B

West Barnstable Village H.D.
Meetinghouse Way

A.D. Makepeace Co. Office WKB52



Barnstable, Mass. MRA WBB

West Barnstable Village H.D.
Meetinghouse Way
Railroad Station WBB47



Barnstable, Mass. MRA WBB

West Barnstable Village H.D.
Meetinghouse Way
New Otis Hall WBB53



Barnstable, Mass. MRA

W. Barnstable Village HD WBIS
Meetinghouse Way,
W. Parish Meetinghouse

AUG 1986

AUG 1986



Barnstable, Mass. MRA WBB

West Barnstable Village H.D.
Meetinghouse Way W. Barnst
Village Store WBB50 Village



Barnstable, Mass. MRA

W. Barnstable Village HD WB3
Meetinghouse Way
Selectmans' Office

AUG 1986

Barnstable, MA MRA

West Barnstable (Meetinghouse Way)
Village Historic District

Assessors' Map

Scale: 1"=100' (reduced)

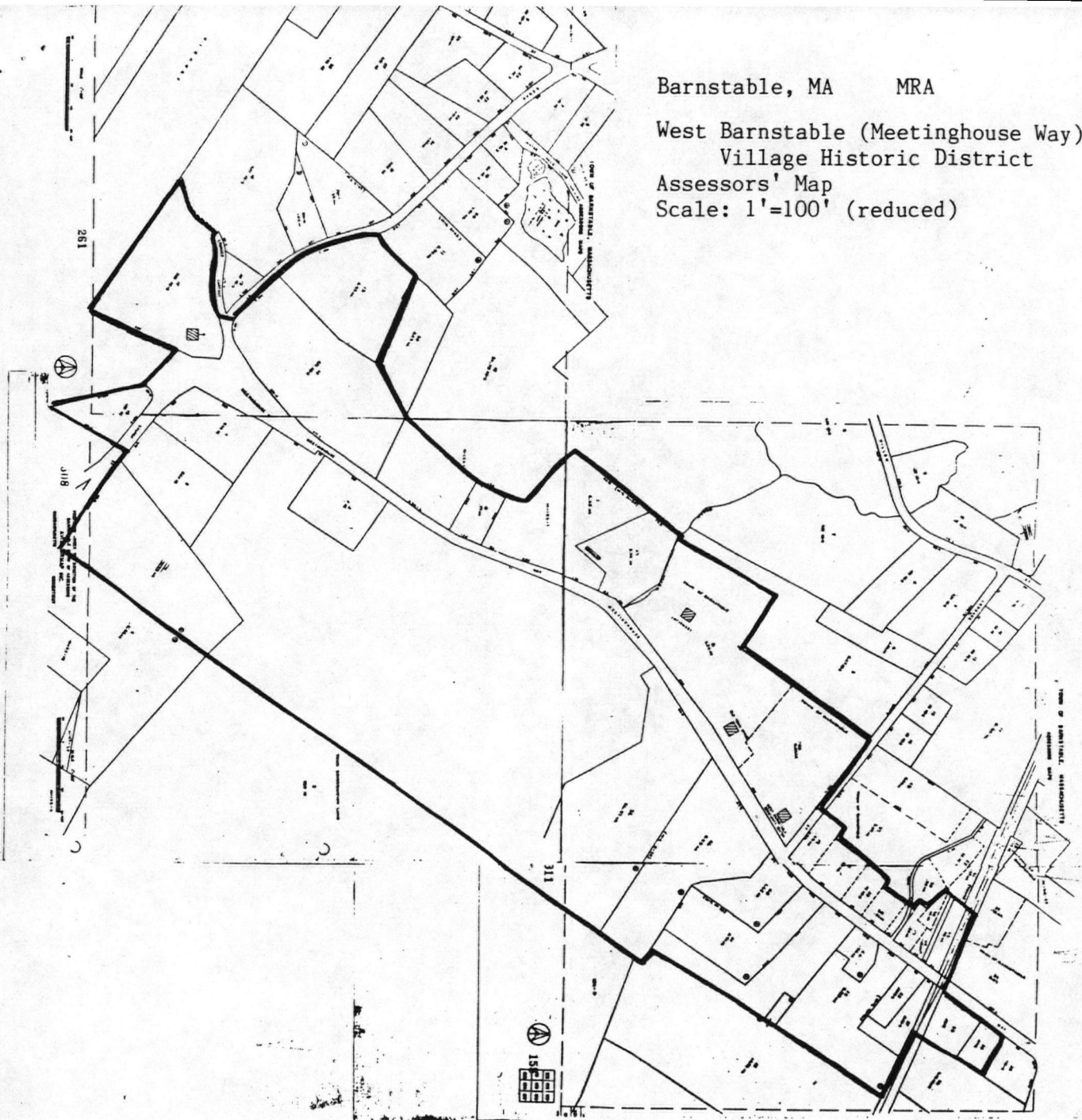

Please refer to the map in the
Multiple Property Cover Sheet
for this property

Multiple Property Cover Sheet Reference Number: 64000271