

**United States Department of the Interior
National Park Service**

For NPS use only

**National Register of Historic Places
Inventory—Nomination Form**

received JUN 25 1986
date entered

See instructions in *How to Complete National Register Forms*
Type all entries—complete applicable sections

1. Name

historic Locke-Ober Restaurant

and or common same

2. Location

street & number 3-4 Winter Pl. N/A not for publication

city, town Boston n/a vicinity of

state Massachusetts code 025 county Suffolk code 025

3. Classification

Category	Ownership	Status	Present Use	
<input type="checkbox"/> district	<input type="checkbox"/> public	<input checked="" type="checkbox"/> occupied	<input type="checkbox"/> agriculture	<input type="checkbox"/> museum
<input checked="" type="checkbox"/> building(s)	<input checked="" type="checkbox"/> private	<input type="checkbox"/> unoccupied	<input checked="" type="checkbox"/> commercial	<input type="checkbox"/> park
<input type="checkbox"/> structure	<input type="checkbox"/> both	<input type="checkbox"/> work in progress	<input type="checkbox"/> educational	<input type="checkbox"/> private residence
<input type="checkbox"/> site	Public Acquisition	Accessible	<input type="checkbox"/> entertainment	<input type="checkbox"/> religious
<input type="checkbox"/> object	<input type="checkbox"/> in process	<input checked="" type="checkbox"/> yes: restricted	<input type="checkbox"/> government	<input type="checkbox"/> scientific
	<input checked="" type="checkbox"/> N/A being considered	<input type="checkbox"/> yes: unrestricted	<input type="checkbox"/> industrial	<input type="checkbox"/> transportation
		<input type="checkbox"/> no	<input type="checkbox"/> military	<input type="checkbox"/> other:

4. Owner of Property

name Steven Carabro

street & number 70 Green St.

city, town Watertown n/a vicinity of state Massachusetts 02172

5. Location of Legal Description

courthouse, registry of deeds, etc. Suffolk County Registry of Deeds

street & number Pemberton Square

city, town Boston state Massachusetts

6. Representation in Existing Surveys

title Inventory of Historic Assets of the Commonwealth of Massachusetts has this property been determined eligible? yes no

date 1980 federal state county local

depository for survey records Massachusetts Historical Commission, 80 Boylston Street

city, town Boston state Massachusetts

7. Description

Locke-Ober Restaurant, Boston, Mass.

Condition

excellent
 good
 fair

deteriorated
 ruins
 unexposed

Check one

unaltered
 altered

Check one

original site
 moved date _____

Describe the present and original (if known) physical appearance

The Locke-Ober Restaurant is housed in a pair of attached three story, red brick Greek Revival rowhouses, which are united by a late 19th century restaurant storefront. Located at 3 and 4 Winter Place, a narrow alleylike street in Boston's central business district, the buildings are three and five bays in width respectively. The front walls abut the sidewalk, and the combined lots total 2,410 square feet. The first story features cast iron piers, stained glass in the window tympanums, and original wooden double-leaved doors. Both units have rectangular window openings with stone sills and lintels on the second and third stories. Elongated second-floor windows and smaller third-floor windows are found at number 3. Some windows have diamond panes and some have 16/16 sash, all with leaded glass. A continuous brick dentil cornice crowns the facade.

The restaurant's present-day interior is largely the result of an 1886 remodelling. Most noticeable is the intricately carved seasoned mahogany from San Domingo on the front of the long L-shaped counter and adjoining bar, around the huge plate glass backbar mirrors and backbar clock. Stained glass in Art Nouveau motifs is found in the vestibule and above the exterior windows.

The first floor walls are paneled with oak wainscoting, above which are flocked and etched gold wall coverings. The finely painted ceiling, from which hang graceful "electrolier" chandeliers, depicts an Etruscan Spring with leaves, lilies, rosettes, and mythical animals in colors of soft greens, golds, yellows, and rusty pinks.

Also contained in the first floor is a forty-two-inch-tall bronze sculpture, "Gloria Victus," which stands on a mahogany pedestal in the center of the dining room, and a painting of a rosy nude female on the north wall. German silver steam dishes, their covers lifted by an elaborate system of weights and counterweights, adorn the bar, and there is an original hand-operated dumbwaiter of brass on brass poles.

On the upper floors, the wall surface above the paneled oak wainscoting is smoothly plastered with a raised plaster fleur-de-lis design, still visible in the third floor and in the stairwells.

The area around Locke-Ober's is little known archaeologically, but the scale of the building and the location suggest it may have archaeological potential.

8. Significance

Locke-Ober Restaurant, Boston, Mass.

Period	Areas of Significance—Check and justify below					
<input type="checkbox"/> prehistoric	<input type="checkbox"/> archeology-prehistoric	<input type="checkbox"/> community planning	<input type="checkbox"/> landscape architecture	<input type="checkbox"/> religion		
<input type="checkbox"/> 1400-1499	<input type="checkbox"/> archeology-historic	<input type="checkbox"/> conservation	<input type="checkbox"/> law	<input type="checkbox"/> science		
<input type="checkbox"/> 1500-1599	<input type="checkbox"/> agriculture	<input type="checkbox"/> economics	<input type="checkbox"/> literature	<input type="checkbox"/> sculpture		
<input type="checkbox"/> 1600-1699	<input checked="" type="checkbox"/> architecture	<input type="checkbox"/> education	<input type="checkbox"/> military	<input type="checkbox"/> social/		
<input type="checkbox"/> 1700-1799	<input type="checkbox"/> art	<input type="checkbox"/> engineering	<input type="checkbox"/> music	<input type="checkbox"/> humanitarian		
<input checked="" type="checkbox"/> 1800-1899	<input checked="" type="checkbox"/> commerce	<input type="checkbox"/> exploration/settlement	<input type="checkbox"/> philosophy	<input type="checkbox"/> theater		
<input type="checkbox"/> 1900-	<input type="checkbox"/> communications	<input type="checkbox"/> industry	<input type="checkbox"/> politics/government	<input type="checkbox"/> transportation		
		<input type="checkbox"/> invention		<input type="checkbox"/> other (specify)		

Specific dates c. 1832; 1886 Builder/Architect unknown

Statement of Significance (in one paragraph)

Locke-Ober's Restaurant possesses integrity of location, design, materials, workmanship, setting, and association, and as such meets criteria A and C of the National Register of Historic Places. It is significant architecturally because of its magnificent Victorian barroom interior, housed in one of the few remaining Greek Revival residential buildings in Boston's Central Business District, and historically as an eating establishment which has been located on the same site for over 100 years, making it one of the city's longest-lived restaurant traditions. In the Boston Landmarks Commission's Central Business District Preservation Study (1980) of 809 buildings, this building was evaluated to be of "Major Significance" (Group II) to the City, the Commonwealth, and the New England Region.

The restaurant bears the name of two men, Louis Ober and Frank Locke, who were rivals, never partners, in two Winter Place restaurants. Louis Ober opened his eating establishment on the alley by 1870. Initially it was probably a small cellar cafe. In 1875 he took out a permit to remodel #3-4 into a cafe and dwelling.¹ In 1883, King's Dictionary of Boston reported, "The leading French restaurant of the City is 'Ober's' on Winter Place, off Winter Street. This has more than a local fame. It is most patronized by the possessors of long purses. It has a large general dining-room, a cafe, and several private supper rooms. The viands here are unsurpassed by any place in the City."¹ As then remodelled, the main dining room and kitchen were on the first floor, the north end of the second floor held two private dining rooms; the south end and the third floor served as living quarters for the Ober family.

By 1886, Ober had prospered to such an extent that he could again remodel the building. The private dining rooms were removed to the third floor and the whole building, with the exception of a small apartment on the third floor, was given over to the business. The large dining room on the ground floor became the Men's Bar. The work Ober did then still remains. He sent to San Domingo for mahogany and to France for wood carvers. The bronze statue "Gloria Victus" also came from France, and the polished metal steam dishes were designed in Germany and manufactured by Reed and Barton, silversmiths. The cash register acquired at that time is still in use. The requisite female nude painting was done by Italian artist Tommaso Juglaris, who was born in Turin and studied at the Turin Academy of Fine Arts and in Paris under Thomas Coutiere.²

Continued

6-11-86
137813

9. Major Bibliographical References

see continuation sheet

10. Geographical Data

Acreage of nominated property less than one

Quadrangle name Boston South

Quadrangle scale 1:25,000

UTM References

A

1	9	3	3	0	1	0	5	4	6	9	1	0	9	0
Zone			Easting				Northing							

B

Zone			Easting				Northing							

C

Zone			Easting				Northing							

D

Zone			Easting				Northing							

E

Zone			Easting				Northing							

F

Zone			Easting				Northing							

G

Zone			Easting				Northing							

H

Zone			Easting				Northing							

Verbal boundary description and justification

Nominated property conforms to assessor's parcel number 4772; this conforms to entire lot. See attached Assessor's Map.

List all states and counties for properties overlapping state or county boundaries

state	N/A	code	county	code
-------	-----	------	--------	------

state	code	county	code
-------	------	--------	------

11. Form Prepared By

name/title Carol Kennedy
Boston Landmarks Commission

organization Massachusetts Historical Commission

date May 1986

street & number 80 Boylston St.

telephone 725-3850

city or town Boston

state Massachusetts 02116

12. State Historic Preservation Officer Certification

The evaluated significance of this property within the state is:

national state local

As the designated State Historic Preservation Officer for the National Historic Preservation Act of 1966 (Public Law 89-665), I hereby nominate this property for inclusion in the National Register and certify that it has been evaluated according to the criteria and procedures set forth by the National Park Service.

State Historic Preservation Officer signature

Valerie A. Talmage

title

Executive Director, Massachusetts Historical Commission
State Historic Preservation Officer

date

6/12/86

For NPS use only

I hereby certify that this property is included in the National Register

Entered in
National Register

date

7-24-86

for Allene Byers
Keeper of the National Register

Attest:

date

Chief of Registration

**United States Department of the Interior
National Park Service**

**National Register of Historic Places
Inventory—Nomination Form**

For NPS use only

received

date entered

Continuation sheet Locke-Ober Restaurant, Boston, Mass. Item number 8

Page 1

In 1891, Frank Locke, a retired Maine sea captain, backed by Dudley S. McDonald owner of the building at #1 and #2 Winter Place, remodelled the adjacent building into his "Wine Rooms", specializing in plain Maine cooking, lobsters, steaks and hard liquor. By May of 1894, Wood and Pollard, wholesale liquor dealers, bought both businesses. Openings were then made in the party wall, joining the two. Wood and Pollard renamed the restaurant the Winter Place Tavern. Emil Camus was retained as manager.

In 1898 Wood and Pollard sold the property to John Merrow, the manager of the Revere House in Bowdoin Square. Merrow's occupancy was short. In August of 1900 he became bankrupt and in 1901 the restaurant passed into the hands of the Locke-Ober Company, headed by Emil Camus, the former manager under Wood and Pollard. In the 38 years from 1901 until his death in 1939, Camus established the synthesis of French and American cooking which has given the restaurant its distinctive character. Locke-Obers has remained largely unchanged except that the dining rooms at 1 and 2 Winter Place were abandoned during the Prohibition era. The second floor on the old Locke side was redecorated and reopened in 1950; Locke's plush "Wine Room" interior has been lost. In 1949, Locke-Ober's also took over Joseph's restaurant in the Back Bay.

The stained glass in Art Nouveau motifs found in Locke-Ober's resembles that being designed and manufactured by Louis Comfort Tiffany in Brooklyn in the 1880's, although similar glass of high quality was being produced by Redding Baird and Company, just around the corner from Ober's on Franklin Street.

NOTES

1. Sherman L. Whipple III, "The Locke-Ober Cafe" (undated booklet, copy in Boston Landmark Commission files)
2. Deeds are not helpful in determining a date for the building, although it would appear to date after 1832 and was probably built as a rental property by Samuel Cabot who was a merchant in partnership with Thomas H. Perkins and T.G. Cary at 52 Central Wharf. (Reference: Suffolk County Courthouse 1026/18, 575/79, 362/118)

**United States Department of the Interior
National Park Service**

**National Register of Historic Places
Inventory—Nomination Form**

Locke-Ober Restaurant, Boston, Mass.

For NPS use only

received

date entered

Continuation sheet

Item number 10

Page 1

BIBLIOGRAPHY

Beebe, Lucius. "A Report on Locke-Ober's," Gourmet Magazine. March, 1949.

Boston City Directories, 1840-1900.

City of Boston. Building Department Records.

City of Boston. Tax Assessor's Records.

Bradford, Ned and Pam. Boston's Locke-Ober Cafe. Published privately, 1978.

Parker, Thomas W. "Dining in Victorian Boston," 19th Century Magazine,
Vol. III, No. 2. Summer, 1977.

Simmons, Sharon L. Boston University Student Report on the Potential
Designation of the Locke-Ober Cafe as a Landmark. 1981.

Suffolk County Deed Records: 1026/18, 575/79, 362/118.

Whipple III, Sherman L. "The Locke-Ober Cafe" (undated booklet, copy in
Boston Landmark Commission files)

Locke-Ober's
3 Winter Place
Boston, MA (So. Quad)

UTM References: 19/330105/4691090
scale: 1" = 100"

Boston Assessor's Map 

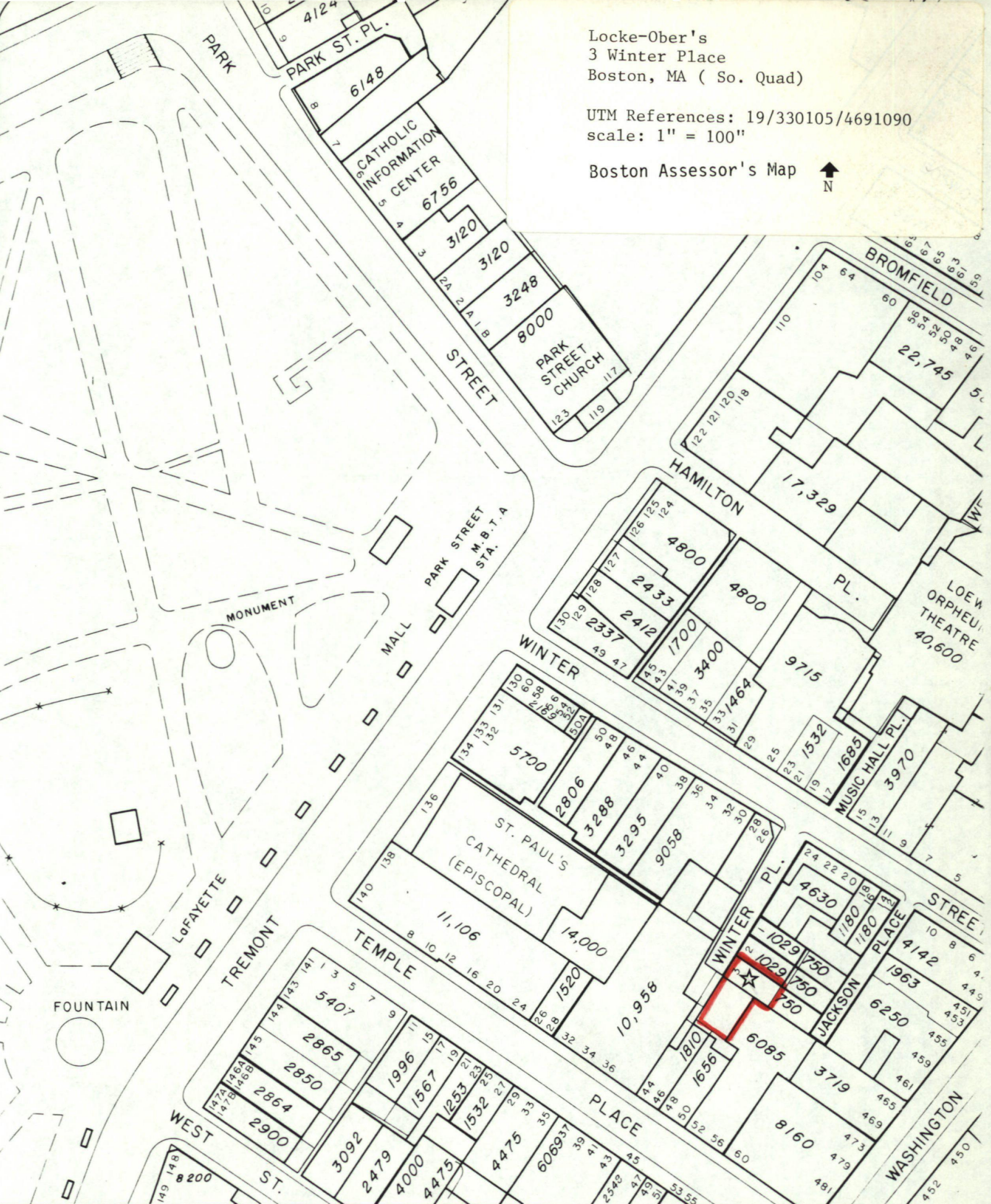

86001911

NATIONAL REGISTER OF HISTORIC PLACES
EVALUATION/RETURN SHEET

Locke--Ober Restaurant
Suffolk County
MASSACHUSETTS

JUN 25 1986

Working No. _____

Fed. Reg. Date: 2/3/87

Date Due: 7/24/86 - 8/9/86

Action: ACCEPT 7-24-86

RETURN

REJECT

Federal Agency: _____

- resubmission
- nomination by person or local government
- owner objection
- appeal

Substantive Review: sample request appeal NR decision

Reviewer's comments:

Recom./Criteria _____

Reviewer _____

Discipline _____

Date _____

_____ see continuation sheet

Nomination returned for: _____ technical corrections cited below
_____ substantive reasons discussed below

1. Name _____

2. Location _____

3. Classification

Category	Ownership	Status	Present Use
	Public Acquisition	Accessible	

4. Owner of Property _____

5. Location of Legal Description _____

6. Representation in Existing Surveys

Has this property been determined eligible? yes no

7. Description

Condition		Check one	Check one
<input type="checkbox"/> excellent	<input type="checkbox"/> deteriorated	<input type="checkbox"/> unaltered	<input type="checkbox"/> original site
<input type="checkbox"/> good	<input type="checkbox"/> ruins	<input type="checkbox"/> altered	<input type="checkbox"/> moved date _____
<input type="checkbox"/> fair	<input type="checkbox"/> unexposed		

Describe the present and original (if known) physical appearance

- summary paragraph
- completeness
- clarity
- alterations/integrity
- dates
- boundary selection

8. Significance

Period _____ Areas of Significance—Check and justify below

Specific dates _____ Builder/Architect _____

Statement of Significance (*in one paragraph*)

- summary paragraph
- completeness
- clarity
- applicable criteria
- justification of areas checked
- relating significance to the resource
- context
- relationship of integrity to significance
- justification of exception
- other

Locke--Opera Restaurant
Suffolk County
MASSACHUSETTS

9. Major Bibliographical References

10. Geographical Data

Acreage of nominated property _____

Quadrangle name _____

UTM References _____

Verbal boundary description and justification _____

11. Form Prepared By

12. State Historic Preservation Officer Certification

The evaluated significance of this property within the state is:

____ national ____ state ____ local

State Historic Preservation Officer signature _____

title _____ date _____

13. Other

- Maps
- Photographs
- Other

Questions concerning this nomination may be directed to _____

Signed _____ Date _____ Phone: _____

i CLEANERS
LAUNDERERS



The
Pro
Institu

30
36
Op
Wor

YES!
WE DO
TAILORING

ALTERATIONS

Garza



Locke-Ober's Restaurant
3 Winter Place
Boston, Massachusetts

Carol Kennedy, 1985
Negative on file at Boston Landmarks
Commission

Photograph number 1 of 1
Oblique view of northwest (front)
elevation; camera facing south



Locke-Ober's
3 Winter Place
Boston, MA (So. Quad)

UTM References: 19/330105/4691090
scale: 1" = 25,000'

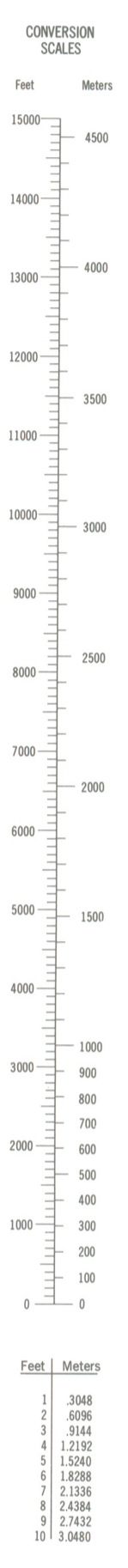

Mapped, edited, and published by the Geological Survey
Control by USGS, USC&GS, and Massachusetts Geodetic Survey
Topography by planimetric surveys 1943. Revised from
aerial photographs taken 1969. Field checked 1970
Selected hydrographic data compiled from USC&GS Charts 246
and 248 (1971). This information is not intended for navigational
purposes
Polyconic projection. 1927 North American datum
10,000-foot grid based on Massachusetts coordinate system,
mainland zone
1 000-meter Universal Transverse Mercator grid,
zone 19
Boundaries in tidewater areas from information supplied
by Massachusetts Department of Public Works
Red tint indicates areas in which only landmark buildings are shown

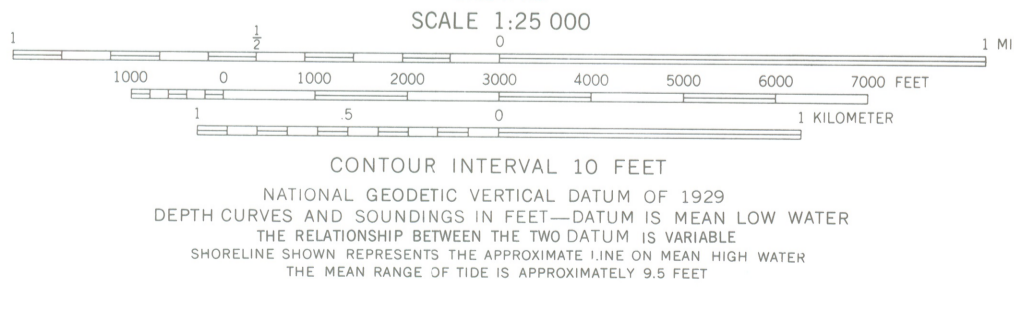
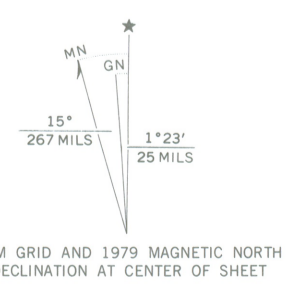

ROAD CLASSIFICATION
Primary highway, hard surface
Secondary highway, hard surface
Light-duty road, hard or improved surface
Unimproved road
Interstate Route
U. S. Route
State Route

THIS MAP COMPLIES WITH NATIONAL MAP ACCURACY STANDARDS
FOR SALE BY U. S. GEOLOGICAL SURVEY, RESTON, VIRGINIA 22092
A FOLDER DESCRIBING TOPOGRAPHIC MAPS AND SYMBOLS IS AVAILABLE ON REQUEST

There may be private inholdings within the boundaries of
the National or State reservations shown on this map
Revisions shown in purple compiled in cooperation with the State of
Massachusetts agencies from aerial photographs taken 1975 and other
source data. This information not field checked. Map edited 1979

BOSTON SOUTH, MASS.
N4215-W7100/7.5
1970
PHOTOREVISED 1979
AMS 6768 1 SE-SERIES V814



The Commonwealth of Massachusetts

Office of the Secretary of State
Michael Joseph Connolly, Secretary

Massachusetts Historical Commission
Valerie A. Talmage
Executive Director
State Historic Preservation Officer

June 12, 1986

Carol Shull
Chief of Registration
National Register of Historic Places
Dept. of Interior, NPS
P.O. Box 37127
Washington, D.C. 20013-7127

Dear Ms. Shull:

Enclosed you will find fifteen nominations forms for properties in Boston and Richmond, Massachusetts. Eleven of the Boston properties are being submitted for Determinations of Eligibility due to owner objection. The remaining properties are being submitted for nomination to the National Register.

Owner objections have been received for the Appleton, Auchmuty, Federal Reserve, 20-30 Bromfield, Hemenway, National Shawmut Bank, Parker House, Phoenix, Richardson, Sears Block and Crescent, and Tremont Temple buildings.

All of the properties have been voted eligible by the State Review Board and have been signed by the State Historic Preservation Officer. Owners were notified of pending State Review Board consideration 30-75 days before the meeting and were afforded the opportunity to comment. Comments received to date are attached to the nomination forms.

Sincerely,
Sarah Zimmerman
Sarah Zimmerman
Director of Preservation Planning

/sjz
enc.

JUN 25 1986