

MASSACHUSETTS HISTORICAL COMMISSION  
80 BOYLSTON STREET  
BOSTON, MA 02116

AREA	FORM NO.
	4383

Town Newton, Mass. M.R.A.  
Newton (Auburndale)

Address 64 Hancock Street

Historic Name Auburndale Congregational Church

Use: Present church  
Original church

Photo (3"x3" or 3"x5", black and white) Indicate address of property on back of photo. Staple to left side of form.

DESCRIPTION

Date 1857

Source King's Handbook of Newton

Style Romanesque

Architect Charles Edward Parker

Exterior Wall Fabric clapboard

Outbuildings carriage barn

Sketch Map: Draw map showing property's location in relation to nearest cross streets and/or geographical features. Indicate all buildings between inventoried property and nearest intersection(s).  
Indicate north

Major Alterations (with dates) \_\_\_\_\_  
1878, 1892, 1950

Condition Very good

SEE ATTACHED MAP

Moved no Date \_\_\_\_\_

Acreage over one acre (1.33 acres)  
57935

Setting suburban residential

UTM REFERENCE 19.314640.4690200

USGS QUADRANGLE Natick, Mass.

SCALE 1:25,000

Recorded by Bruce Fernald

Organization Newton Historical Comm.

Date 8/15/79; rev. by H. White 3/86

#### NATIONAL REGISTER CRITERIA STATEMENT (if applicable)

The Auburndale Congregational Church is one of the Boston area's finest examples of a mid-nineteenth century wooden, Romanesque style church. It also has important associations with a group of men who in addition to founding the church were active in local real estate speculation and the village's other major social forces, the Lasell Female Seminary (now Lasell Jr. College) and the Walker Missionary Homes. Therefore the Auburndale Congregational Church meets Criteria A and C of the National Register of Historic Places.

#### ARCHITECTURAL SIGNIFICANCE Describe important architectural features and evaluate in terms of other buildings within the community.

Charles Edward Parker, (1826-1890) designed this church in the Romanesque Revival style. Parker, who maintained a Boston office, was also the architect for Williston and Barrett Halls at Amherst College (1850) and the town halls in Easthampton and Chicopee Massachusetts (1871). Parker was also responsible for the Shawmut Congregational Church (1864) in Boston. In 1857, the year that the Congregational Church was completed, Parker married Isabel Jennings, a graduate of the Lasell Seminary, and eventually an instructor there. The Parkers own house was located in Auburndale at 7 Williston Road. A second Auburndale building attributed to Parker was the Church of the Messiah (1881).

The wood frame Auburndale Congregational Church follows the basic Federal meetinghouse form embellished with Romanesque-influenced ornament.

#### HISTORICAL SIGNIFICANCE Explain the role owners played in local or state history and how the building relates to the development of the community.

The Auburndale Evangelical Congregational Society was founded in 1850. Among the 34 founding members, were a group of men primarily responsible for the transformation of South Auburndale from a rural farming village into a prestigious commuter railroad suburb of Boston. The neighborhood came to be known as "Saints' Rest" because of the many ministers, who became involved in real estate speculation upon their retirement from the ministry. Several of these men who founded the church, were also major figures in the organization of two other important local institutions; the Lasell Female Seminary (later Lasell Junior College) in 1851 and the Walker Missionary Home in 1868.

#### BIBLIOGRAPHY and/or REFERENCES

M.F. Sweetser, King's Handbook of Newton (1887), p. 196.  
S.F. Smith. History of Newton (1880).  
Newton Atlases: 1874, 1886, 1895, 1907.  
Middlesex Registry of Deeds.  
Auburndale Congregational Church records.

INVENTORY FORM CONTINUATION SHEET

MASSACHUSETTS HISTORICAL COMMISSION  
Office of the Secretary, Boston

Community: Auburndale	Form No: 4383
Property Name: Aub. Congreg. Church	

Indicate each item on inventory form which is being continued below.

Newton, Mass. ICA

Architectural Significance:

The meetinghouse form consists of a two-story, gable end rectangular block with a three-stage belfry. This was a dominant church form throughout suburban Boston during the 1850s. The choice of Romanesque decorative motifs was favored by church architects in the Boston area after 1850, particularly for Congregational churches.

The steep, three-stage belfry terminates in a polygonal spire clad in slate with a ball finial and wind-vane. Each stage of the belfry contains Romanesque-inspired round headed windows of varying proportions. The topmost stage of the belfry is open, with a triple portal on each elevation. The portals are flanked by colonnettes with stiff leaf capitals. The spire rests on a broach with a clock face on each elevation.

Romanesque ornament includes the round-headed windows of varying size and placement, and Romanesque mouldings employed throughout the design. Both lateral and raking eaves rest on corbelled cornices. The main entrance is centered on the gabled street facade, with the belfry offset to the right. The entrance is set within a round, compound arched opening. A secondary entrance is located on the south elevation, and is set within a gabled porch with spiral colonnettes, with cushion, crocket, and stiff leaf capitals.

A number of alterations have been made to the building. The spire blew over and was rebuilt in 1862. Church records indicate that the east end of the nave was extended by 21 feet in 1878. The addition carries pilasters and corbelling and is indistinguishable from the original section of the building. A one-story chapel was added on the east elevation in 1878.

The ornate porch on the south elevation was added circa 1880. In addition to its stubby spiral colonnettes, the porch has a roof embellished with dentil moulding at the eaves, and a gable field with trefoil and quatrefoil pierced designs.

In 1892 a second-story was added to the chapel. The enlarged chapel was designed in the Colonial Revival style. Interior renovations to the church occurred in 1907, at which time the stained glass windows were added. In 1950 a one-story wing east of the chapel was added.

Another local church designed by Charles Parker is the Evangelical Baptist Church (1873) located at 23 Chapel Street in Nonantum.

Staple to Inventory form at bottom

United States Department of the Interior  
National Park Service

National Register of Historic Places  
Inventory—Nomination Form

For NPS use only  
received 7/23/86  
date entered

Continuation sheet

Item number

Page

Multiple Resource Area  
Thematic Group

Name Newton MRA  
State Middlesex County, MA

Nomination/Type of Review

Date/Signature

21. West Newton Hill  
Historic District

Substantive Review

Keeper

Kathleen Anderson 9/4/86

Attest

Beth L. Savage 9/4/86

22. Adams, Amos, House

Substantive Review

Keeper

Kathleen Anderson 9/4/86

Attest

Beth L. Savage 9/4/86

23. Adams, Seth, House

Entered in the  
National Register

Keeper

Melrose Byers 9/4/86

Attest

24. Auburndale Congregational  
Church

Entered in the  
National Register

Keeper

Melrose Byers 9/4/86

Attest

25. Bartlett--Hawkes Farm

Entered in the  
National Register

Keeper

Melrose Byers 9/4/86

Attest

26. Bayley House

Entered in the  
National Register

Keeper

Melrose Byers 9/4/86

Attest

27. Bemis Mill

Entered in the  
National Register

Keeper

Melrose Byers 9/4/86

Attest

28. Bigelow, Henry, House

Entered in the  
National Register

Keeper

Melrose Byers 9/4/86

Attest

29. Blodgett, William,  
House

Entered in the  
National Register

Keeper

Melrose Byers 9/4/86

Attest

30. Brackett House

Entered in the  
National Register

Keeper

Melrose Byers 9/4/86

Attest

86001769

NATIONAL REGISTER OF HISTORIC PLACES  
EVALUATION/RETURN SHEET

Auburndale Congregational Church (Newton  
MRA)  
Middlesex County  
MASSACHUSETTS

Working No. 2/3/87  
Fed. Reg. Date: JUL 23 1986  
Date Due: 8/21/86 - 9/6/86  
Action:  ACCEPT 9-4-86  
 RETURN  
 REJECT  
Federal Agency: \_\_\_\_\_

- resubmission
- nomination by person or local government
- owner objection
- appeal

Substantive Review:  sample  request  appeal  NR decision

Reviewer's comments:

Recom./Criteria \_\_\_\_\_  
Reviewer \_\_\_\_\_  
Discipline \_\_\_\_\_  
Date \_\_\_\_\_  
\_\_\_\_\_ see continuation sheet

Nomination returned for: \_\_\_\_\_ technical corrections cited below  
\_\_\_\_\_ substantive reasons discussed below

1. Name

2. Location

3. Classification

Category	Ownership Public Acquisition	Status Accessible	Present Use
----------	---------------------------------	----------------------	-------------

4. Owner of Property

5. Location of Legal Description

6. Representation in Existing Surveys

Has this property been determined eligible?  yes  no

7. Description

Condition

- excellent
- good
- fair
- deteriorated
- ruins
- unexposed

Check one

- unaltered
- altered

Check one

- original site
- moved date \_\_\_\_\_

Describe the present and original (if known) physical appearance

- summary paragraph
- completeness
- clarity
- alterations/integrity
- dates
- boundary selection

---

**8. Significance**

Period \_\_\_\_\_ Areas of Significance—Check and justify below

Specific dates \_\_\_\_\_ Builder/Architect \_\_\_\_\_

Statement of Significance (*in one paragraph*)

- summary paragraph
- completeness
- clarity
- applicable criteria
- justification of areas checked
- relating significance to the resource
- context
- relationship of integrity to significance
- justification of exception
- other

*(Faint mirrored text from reverse side of page)*

---

**9. Major Bibliographical References**

---

**10. Geographical Data**

Acreage of nominated property \_\_\_\_\_

Quadrangle name \_\_\_\_\_

UTM References \_\_\_\_\_

Verbal boundary description and justification \_\_\_\_\_

---

**11. Form Prepared By**

---

**12. State Historic Preservation Officer Certification**

The evaluated significance of this property within the state is:

\_\_\_\_ national      \_\_\_\_ state      \_\_\_\_ local

State Historic Preservation Officer signature \_\_\_\_\_

title \_\_\_\_\_ date \_\_\_\_\_

---

**13. Other**

- Maps
- Photographs
- Other

Questions concerning this nomination may be directed to \_\_\_\_\_

Signed \_\_\_\_\_ Date \_\_\_\_\_ Phone: \_\_\_\_\_



Auburndale Congregational Church

Newton Mass MRA

64 Hancock St, Auburndale  
MR-A-5 (29)



Auburndale Congregational Church

Newton, Mass. MRA

64 Hancock St, Auburndale  
MR-A-5 (28)



Auburndale Congregational Church

Newton, Mass. MRA

64 Hancock St, Auburndale  
- MR-A-5 (26) -



Auburndale Congregational Church

Newton, Mass. MRA

64 Hancock St, Auburndale  
- Aub. Congreg. Church 77-D-17 -

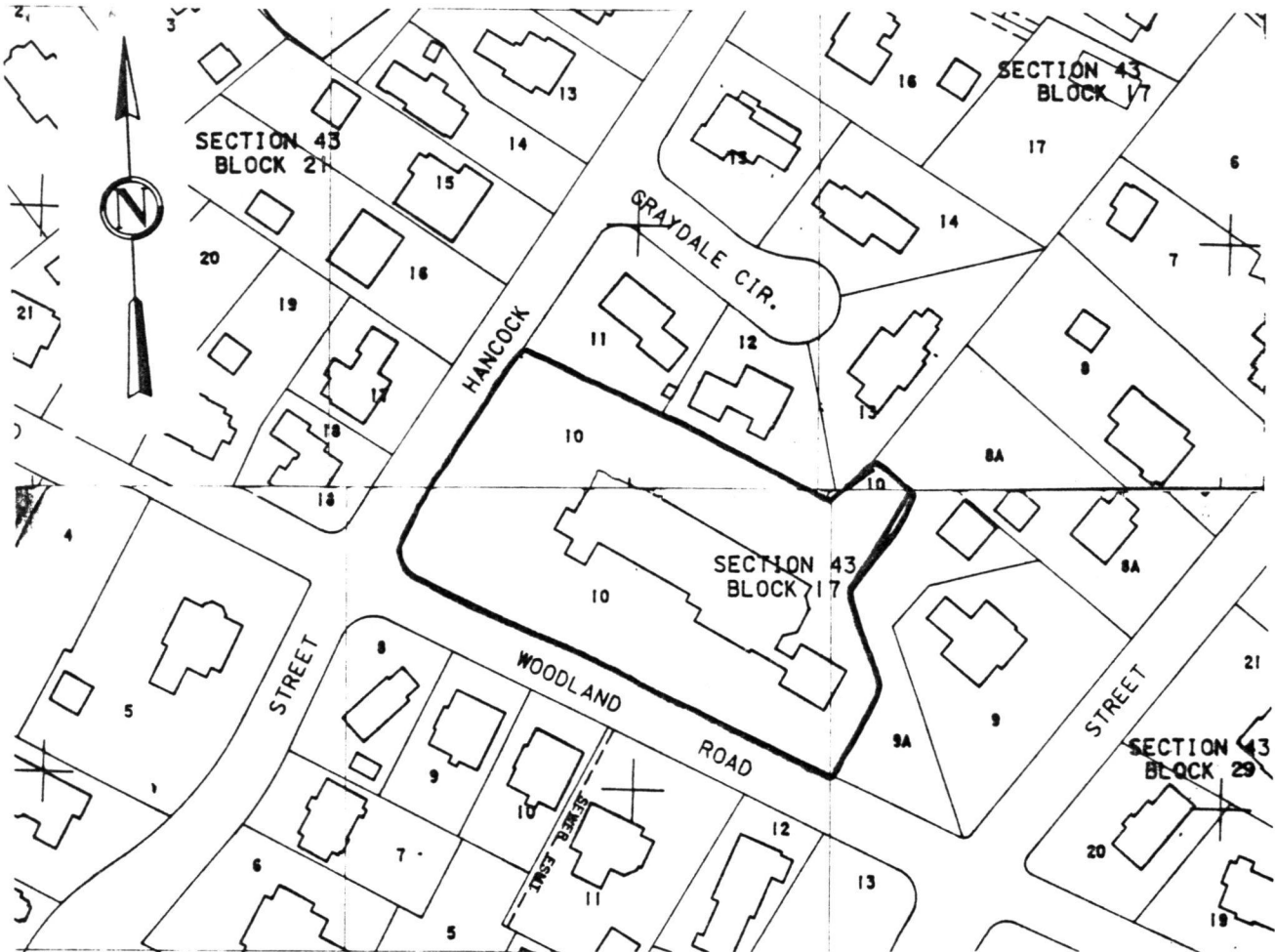

City of Newton Assessor's Maps. Sheet *51*  
 Metric Series. 1979  
 Scale: UTM grid line interval = 100 meters (328 feet)

Newton, Mass. M.R.A.  
 64 Hancock Street, Auburndale  
 Auburndale Congregational Church  
 43-17-10