

NOV 20 1985

FORM A - AREA

Form numbers in this area 59,79-87,123,126-131, 146-152,174-175	Area letter A
---	----------------------

MASSACHUSETTS HISTORICAL COMMISSION
80 Boylston Street, Boston, MA 02116

JAN 33 1986

Photo (3x3" or 3x5")
Staple to left side of form

Photo number _____

See attached photos.

Town Sherborn

Name of area (if any) Sherborn Center

Historic District _____

General date or period 1680-1925

Sketch map. Draw a general map of the area indicating properties within it.
Number each property for which individual inventory forms have been completed.
Label streets (including route numbers, if any) and indicate north. (Attach a
separate sheet if space here is not sufficient)

See attached map.

Acreage: approx. 85 acres

Quad: Medfield

Scale: 1:25,000

UTM References:

A: 19 304430 4679560

B: 19 304640 4679180

C: 19 304580 4678620

D: 19 304220 4678740

E: 19 304080 4679540

Recorded by Betsy Friedberg

Organization Mass. Historical Commission

Date May 1985

(Staple additional sheets here)

ARCHITECTURAL SIGNIFICANCE of area. (Describe physical setting, general character, and architecturally significant structures).

The proposed Sherborn Center Historic District encompasses 85 acres and is sited at the convergence of four major roadways--Main Street, Maple Street, Washington, and Farm Road. While most parts of Sherborn are overwhelmingly residential, Sherborn Center contains both public and private buildings. Most of the structures within the district were erected in the mid 19th century, and the principal building material is wood. Notable exceptions include such masonry structures as the Center School, the Dowse Memorial Building, the Sherborn Public Library, and the Deborah Perry Dowse Coolidge House, 2 North Main Street, all built during the 20th century. Structures within the district generally do not exceed 2½-stories in height. Domestic architectural styles represented in the district range from the central-hall-plan Georgian-style Flagg House (built 1740, enlarged 1772, #151) to an unusual example of an Edwardian country cottage, (the above-mentioned Deborah Perry Dowse Coolidge House, 1914, #80). Brief descriptions of key domestic and public buildings in the district follow. (Cont'd)

HISTORICAL SIGNIFICANCE of area. (Explain development of area, what caused it, and how it affected community; be specific).

The Sherborn Center Historic District has been, since the 1680s, the focus of Sherborn's religious, political, educational, and social life. During the 19th century its rise as a locally important commercial center paralleled and complemented that of Edwards Plain-Dowse's Corner to the north as a light manufacturing district. Both publicly and privately owned, the district over time has housed this rural community's most prominent citizens. The district includes thirty-one properties, twenty-five of which contribute to its significance.

Initially Sherborn's settlement was concentrated in the area's southern portion. The first English settlers came to Sherborn, or Boggestow, in 1652 and the town was incorporated in 1674. Sherborn Center's development began with the construction of the First Parish Church's first meetinghouse in the early 1680s. By the early 18th century, four major thoroughfares converged in the meetinghouse vicinity. These included "The Road to Natick" (now North Main Street), "The Road to Medfield" (now South Main Street), "The Road to the Farm" (Morse's farm) or Farm Road, and "The Road to Ashland" (Maple Street). For many years Washington Street was a segment of the Hartford Turnpike and was also known as "The Road to Holliston."

Throughout the 18th century, Sherborn Center remained sparsely settled. By 1750 it contained a burial ground (founded in 1689, #904), the meetinghouse, a school, and Richard Sanger's Tavern, which was a long, low structure on the site of present-day (Cont'd)

BIBLIOGRAPHY and/or REFERENCES

- Maps of 1788, 1857, 1875, 1889, and 1906.
- Anne C. Shaughnessy, A Guide to Sherborn and A History of Sherborn, 1974.
- Frances Bardwell, ed., "Historical Sketches-Sherborn Tercentenary, 1652-1952."
- Sherborn Historical Society, "The Century Turns," 1900.
- Sherborn Historical Society, Sherborn Past and Present, 1674-1924, 1924.

INVENTORY FORM CONTINUATION SHEET

MASSACHUSETTS HISTORICAL COMMISSION
Office of the Secretary, Boston

Community: Sherborn	Form No: A
Property Name: Sherborn Center	

Indicate each item on inventory form which is being continued below.

ARCHITECTURAL SIGNIFICANCE (Continued)

Several examples of the Federal style are included within the district boundaries and comprise the earliest structures in the area. Well-crafted Federal houses speak eloquently of the fact that talented local housewrights were at work in the early 19th century. The hip-roofed Col. Calvin Sanger House, 8 Washington Street, with its handsome fanlit entrance fronted by a columned entry porch, and interior woodwork and fine French wallpaper, was built by Ebenezer Mann in 1819 (#147). Its polygonal bay with Gothicized decorations is a late 19th century addition. The laundry ell of Col. Sanger's house was moved to 5 Zion's Lane (#174) in the 1850s. Bowen Adams, another accomplished Sherborn housewright, built his own hip-roofed residence at 27 South Main Street (#127) in 1815, as well as the Dr. Oliver Everett House at 1 North Main Street (#79). Built in 1833, the Everett House features entrance pilasters that display a distinctive Greek key pattern; the house is Sherborn's best example of the transition from Federal to Greek Revival styling.

Solid examples of side-hall-plan, front-facing gable Greek Revival dwellings are located at 15 North Main Street (the Amos Bigelow House, ca. 1845, #85) and at 27 Washington Street (the Dr. Albert Blanchard House, 1849, #152). These houses possess wide corner and fascia boards and fully pedimented attics.

Several small 1½-story central-hall-plan cottages built in the mid 19th century are also located in this district, including the Horatio Coolidge House, 39 South Main Street (ca. 1825, #131), and the Joshua Holbrook House, 5 South Main Street (ca. 1840, #126). The area of Zion's Lane/Linden Lane, along the western edge of the district, also deserves mention for its picturesque collection of diminutive cottages. In addition to the laundry ell of the Col. Sanger House, these include the Martha Austin House, 5 Linden Lane (ca. 1850-1875, #175), and the Onion House at the corner of Zion's Lane and North Main Street (9 North Main Street, ca. 1840, #84).

Sherborn's most significant 19th century residence architecturally is the George H. Clark House at 16 North Main Street (ca. 1853, #86). The source for this villa's irregular plan, distinctive profiles, loggias, balconies, and wide overhanging cornice apparently lies in the mid 19th century romantic patternbooks of the American landscape architect Andrew Jackson Downing. Alexander Rice Esty of Framingham is probably this house's architect.

Over time, Sherborn's public buildings have housed a variety of religious, political, educational, and social activities. The First Parish Church's third meetinghouse, located at 11 Washington Street, was built in 1830 by Hiram Jones of Dover (#148). This Greek Revival ecclesiastical building's octagonal steeple and spire are the major focal point in the area. Also noteworthy is its handsome pedimented portico. Immediately to the southeast of the First Parish Church is the wood-framed Italianate-style Town Hall, 3 Sanger Street (#123). It was built in 1859 by Elbridge Boyden, architect of Worcester's Mechanics Hall. The cupola-topped Town Hall's windows are fully enframed, its cornice is deeply bracketed, and its corners are boldly defined by quoins. This is one of the few unaltered examples of Boyden's work in Massachusetts.

Continued

Staple to Inventory form at bottom

INVENTORY FORM CONTINUATION SHEET

MASSACHUSETTS HISTORICAL COMMISSION
Office of the Secretary, Boston

Community: Sherborn	Form No: A
Property Name: Sherborn Center Historic District	

Indicate each item on inventory form which is being continued below.

ARCHITECTURAL SIGNIFICANCE (Cont'd, p. 2)

The high Victorian Gothic Sawin Academy, which housed the Thomas Dowse High School, is no longer extant. Built in 1874 and demolished in 1962, it stood on the site of the present Sherborn Public Library.

To the southeast of the Church Green, at 25 South Main Street, is the Pilgrim Church (#127). Built in 1830, it was remodelled in the Italianate style in the 1850s. A high rusticated basement, central pediment, and round-arched windows were added at that time. The nearby St. Theresa's Catholic Church (#130) at 33 South Main Street is an unpretentious frame vernacular structure, built in 1898 to house the town's almshouse. The building was sold to the church in 1924.

Finally, a picturesque example of the Tudor Revival-style, popular in the early 20th century, is the brick Dowse Memorial Building at 4 North Main Street (#82). Built on North Main Street in 1914, it was designed by the Boston architectural firm of Pray, Hubbard and White. A curvilinear Flemish gable dominates the facade.

During the late 18th and early 19th centuries, Sherborn Center's character was partly commercial. No longer extant are two 19th century general stores, an 18th century tavern on the site of a house at 3-5 North Main Street (see #81), and a post office. Col. Calvin Sanger's Store still stands at 12 Washington Street (built ca. 1805, #149). It is a Federal-style, five-bay building that received Italianate surface treatments later in the 19th century.

Within the district there are also several notable monuments, as well as Sherborn's oldest burying ground, Central Burying Ground (#904). Founded in the late 1680s, the latter contains a fine collection of the late 17th-early 19th century slate stones. Gravestone motifs represented here include winged skulls and faces, willows and urns, and floral patterns. The Leland Monument (#905) is a granite Egyptian obelisk, erected on the northern edge of the Church Green in 1847. It is a memorial to Henry Leland, one of the town's first settlers. The Memory Statue (#904) by sculptor Cyrus Dallin is located in front of the Central Burying Ground, facing Main Street. It is composed of an eight-foot-tall bronze statue of a woman, and stands in the center of a granite architectural setting by William Ware Dinsmore. The statute is dedicated to the memory of Sherborn's war dead, and was unveiled in 1924.

Intrusions in the Sherborn Center Historic District include a number of recent, commercial structures that are architecturally undistinguished. In addition, the Paleman Bickford Straw Hat Factory (#87), originally a Greek Revival-style structure, built in 1833, was moved to its present location at 15 North Main Street in 1860 and subsequently was significantly altered. The building no longer retains architectural integrity, but it is of historical significance for its associations with the Straw Hat industry as the only remaining element of that industry in Sherborn.

Staple to Inventory form at bottom

INVENTORY FORM CONTINUATION SHEET

MASSACHUSETTS HISTORICAL COMMISSION
Office of the Secretary, Boston

Community:	Form No:
Sherborn	A
Property Name: Sherborn Center Historic District	

Indicate each item on inventory form which is being continued below.

HISTORICAL SIGNIFICANCE (Cont'd)

3-5 North Main Street (#81). Three dwellings were located in this area: the nucleus of the Flagg House at 22 Washington Street (ca. 1740, #151), the Sparhawk House, which occupied the site of 27 South Main Street, and a parsonage, which stood at 8 Washington Street. Only the burial ground and the Flagg House remain from this period of settlement. It was not until the early 19th century that Sherborn Center became relatively densely settled and firmly established a recognizable architectural identity as the town center. This growth was spurred by increased light manufacturing activities to the north on Edward's Plain (including edge tool manufacturing, whippmaking, and, later, shoe manufacturing). The Sanger brothers, Joseph and Col. Calvin, built general stores to serve tradesmen as well as farmers. Col. Calvin Sanger's 1805 store/law office is still extant at 12 Washington Street (#149). Joseph Sanger's store, later the Hawes and Clark store, was built ca. 1805 and torn down in 1920. Its site is now occupied by the south lawn of the Dowse Memorial Building.

Handsome Federal-style houses were built in Sherborn Center between 1800 and 1835. These included Col. Bowen Adams' house at 27 South Main Street (ca. 1815, #128), Calvin Sanger's house at 8 Washington Street (ca. 1819, #147), and Joseph Sanger's house (1820) on the site of the Dowse Memorial Building. Bowen Adams was one of the town's two early 19th century master builders; the other was Ebenezer Mann, builder of the Sanger house. Col. Sanger was a well-to-do lawyer, politician, real estate speculator, and cotton factory owner, while his brother, Joseph Sanger, was a prominent landowner in Sherborn.

Crucial to the district's continued development was a 19th century ecclesiastical controversy. A schism twenty years in the making between conservative Trinitarians, or Congregationalists, and the liberal Unitarian faction resulted in the establishment of the two separate congregations. By 1830 Sherborn had become a two church town--both the First Parish Church's third meetinghouse (#148) and the Pilgrim Church (#127) were built in this year. The Pilgrim Church's Rev. Edmund Dowse, who served as its minister from 1838-1905, attracted parishioners from far beyond Sherborn's borders. He was also active in public affairs, and served on the school board for more than sixty years.

Between 1850 and 1875, Joseph Sanger's "Homestead Estate" was subdivided by his son Elbridge. The cul-de-sacs known as Zion's (originally Pratt's) and Linden Lanes were laid out to the north of the old Sanger Tavern and west of Main Street. By 1875 they were lined with diminutive cottages, including the ells of older houses and outbuildings. And George H. Clark, manager of Joseph Sanger's Store (later Hawe's Store), built a stylish Italian villa on twelve acres of land east of Main Street that he purchased from Elbridge Sanger in 1852. In 1870 the old Framingham and Mansfield Railroad was laid out to the north of George H. Clark's property, creating a man-made boundary between Sherborn Center and the southern portion of Edward's Plain. Other prominent citizens who resided in the district included landscape architect Jacob Pratt (9 North Main Street, ca. 1830, #84), and explorer Alfred Hawes (37 South Main Street, ca. 1835-1840, #129).

Continued

Staple to Inventory form at bottom

INVENTORY FORM CONTINUATION SHEET

MASSACHUSETTS HISTORICAL COMMISSION
Office of the Secretary, Boston

Community: Sherborn	Form No: A
Property Name: Sherborn Center Historic District	

Indicate each item on inventory form which is being continued below.

HISTORICAL SIGNIFICANCE (Cont'd, p. 2)

Between 1850 and 1941 the district's central role as a religious, political, educational, and social center was reinforced by the construction of several important public buildings. In 1859 Thomas Dowse, a leather dresser, philanthropist, and Sherborn native, gave five thousand dollars toward the erection of a Town Hall (#123). The building initially also contained a high school and public library. Sawin Academy (#903) was constructed in 1847 with funds provided by Martha Sawin of Natick, designed to serve as "a select school in the center of town." This high Victorian structure was located to the south of the Town Hall. Sawin Academy was demolished in 1962 to make room for the Sherborn Public Library. A community building program included the erection of an almshouse at 33 North Main Street in 1898 (#130). Soon determined to be of little use in prosperous Sherborn, the building had become home to the town's first Catholic parish by 1924.

The Dowse Memorial Building (#82) was built in 1914 to house the town's library, and presently contains the Town Offices. The building has historical associations with William Bradford Homer Dowse, lawyer, businessman, historian, and philanthropist. Dowse also provided the funds for the Memory Statue, a memorial to Sherborn's war dead, which was erected in 1924. In addition, Dowse also built a home for his sister nearby at 2 North Main Street (#80) in 1914. The Georgian Revival-style dwelling is built in the manner of an English country estate.

CRITERIA FOR EVALUATION

The Sherborn Center Historic District, with its 19th century churches, early burial ground, stone walls, and large concentration of well-preserved 19th and early 20th century buildings, has kept much of its pre-modern rural character. The district retains integrity of location, design, setting, materials, workmanship, feeling, and association with the town's development from early settlement to the mid 20th century, as well as with a number of prominent citizens. As such, it thus fulfills Criteria A, B, and C of the National Register of Historic Places.

VERBAL BOUNDARY DESCRIPTION AND JUSTIFICATION:

The bounds of the Sherborn Center Historic District were drawn to include a group of residential, civic, and ecclesiastical buildings distinguished by their cohesive mid-late 19th and early 20th century architectural styles and by the quality of setting that characterizes the district as a semirural village center. The Sherborn Center Historic District is also distinguished for the examples of works by two local master builders, Ebenezer Mann and Bowen Adams. District boundaries were defined by the presence of the railroad tracks and a small, modern commercial area adjoining the district's northern end, and by modern but sympathetic residential construction to the east, south, and west. Boundaries follow rear lot lines except in the case of the Paleman Bickford Straw Hat Factory, 17 N. Main Street, which sits on a lot of more than 42 acres; in this case, only the land immediately surrounding the building and its right-of-way to Main Street are included.

Continued

Staple to Inventory form at bottom

INVENTORY FORM CONTINUATION SHEET

MASSACHUSETTS HISTORICAL COMMISSION
Office of the Secretary, Boston

Community: Sherborn	Form No: A
Property Name: Sherborn Center Historic District	

Indicate each item on inventory form which is being continued below.

VERBAL BOUNDARY DESCRIPTION AND JUSTIFICATION, Cont.

Specifically, beginning at the northeast corner of the intersection of North Main Street and the tracks of the Conrail system and proceeding southeasterly along rear lot lines of properties on the east side of Main Street from 16 North Main Street to 35 South Main Street; then turning at a right angle at the southeast corner of 35 South Main Street and travelling west along the lot's southern boundary to the curblineline; thence turning at a right angle and proceeding northward along the eastern curblineline to the intersection of South Main, Sanger, and Sawin Streets, crossing to the northern side of Sawin Street, and traveling westerly along the curblineline to the southwestern (rear) corner of 27 Washington Street; thence turning at a right angle and following the property line of 27 Washington Street to the road; thence crossing Washington Street and proceeding in a northwesterly direction along the western property line of 22 Washington Street to the lot's northwestern corner; thence turning to follow the lot's rear property line and continuing across Maple Street to the southwestern corner of 8 Washington Street; thence following the western property lines of 8 Washington Street to its border with 8 Zion's Lane, turning at a right angle and following the south, west, and northern lot lines of 8 Zion's Lane to its junction with the southwest corner of 17 North Main Street; thence proceeding around the property at 17 North Main Street and following its right of way to the intersection of North Main Street and the Conrail tracks.

Staple to Inventory form at bottom

SHERBORN MULTIPLE RESOURCE AREA: SHERBORN, MASSACHUSETTS
 SHERBORN CENTER HISTORIC DISTRICT
DISTRICT DATA SHEET

NC = Noncontributing
 NA = Not Applicable

MHC #	HISTORIC NAME	STREET ADDRESS	DATE OF CONSTRUCTION	STYLE	MAP #
59	Martha Austin House	5 Linden Lane	ca. 1850-75 (with ca. 1940 modification)	Greek Revival	30
79	Dr. Oliver Everett House	1 N. Main Street	1833	Federal (Greek Revival details))	22
80	Deborah Perry Dowse Coolidge House	2 N. Main Street	1914	Georgian Revival	23
81	Sanford Leland House	3-5 N. Main Street	ca. 1870 (with mid 20th c. alterations)	Italianate	24
82	Dowse Memorial House	4 N. Main Street	1914	Tudor Revival	25
83	NA	7 N. Main Street	ca. 1885 (with mid 20th c. alterations)	NC	26
84	The Onion House	9 N. Main Street	ca. 1830-1840	Federal	27
NA	NA	11 N. Main Street	mid 20th c.	NC	31
85	Amos Bigelow House	15 N. Main Street	ca. 1840-1850	Greek Revival	32

SHERBORN MULTIPLE RESOURCE AREA: SHERBORN, MASSACHUSETTS
 SHERBORN CENTER HISTORIC DISTRICT
DISTRICT DATA SHEET

NC = Noncontributing
 NA = Not Applicable

MHC #	HISTORIC NAME	STREET ADDRESS	DATE OF CONSTRUCTION	STYLE	MAP #
86	George Clark House	16 N. Main Street	ca. 1853	Italianate	33
87	Paleman Bickford Straw Hat Factory	17 N. Main Street	1833, moved and alterations ca. 1959)	Federal ✓ (NC)	34
123	Town Hall	3 Sanger Street	1856	Greek Revival/ Italianate	13
NA	Town Library	4 Sanger Street	ca. 1970	NC	11
805	Central Cemetery	S. Main Street	1686-1822	NA - SITE	20
904	The Memory Statue	S. Main Street	1924	NA - 0135	21
NA	Sherborn Elderly Housing	S. Main Street	1982	NC	35
126	NA	5 S. Main Street	ca. 1840	Federal/Greek	19
NA	NA	11 S. Main Street	mid 20th c.	NC	7
NA	NA	21-23 S. Main Street	mid 20th c.	NC	6
127	Pilgrim Church	25 S. Main Street	1830, 1853	Italianate	5

4-5
 1 SITE
 1 0135

SHERBORN MULTIPLE RESOURCE AREA: SHERBORN, MASSACHUSETTS
 SHERBORN CENTER HISTORIC DISTRICT
DISTRICT DATA SHEET

NC = Noncontributing
 NA = Not Applicable

MHC #	HISTORIC NAME	STREET ADDRESS	DATE OF CONSTRUCTION	STYLE	MAP #
128	Bowen Adams House	27 S. Main Street	ca. 1815	Federal	4
129	Leland-Hawes House	31 S. Main Street	ca. 1835 (with ca. 1870 additions)	Greek Revival/ Victorian Gothic	3
130	St. Theresa's Church (originally Sherborn Almshouse)	35 S. Main Street	1898 (with 1924 alterations)	Colonial Revival	2
131	Horatio Coolidge House	39 S. Main Street	ca. 1820-1830	Federal/Greek Revival Cottage	1
146	George Fleming House	5 Washington Street	ca. 1878-1880 (with ca. 1940 alterations)	Second Empire	17
147	Col. Calvin Sanger House	8 Washington Street	1819	Federal	16
905	Leland Monument	Washington Street	1847	NA - 0135	18
148	First Parish Church	11 Washington Street	1830	Greek Revival	14
149	Col. Sanger's Store	12 Washington Street	1805	Federal	15
150	Center School	21 Washington Street	1910	Colonial Revival	12

SHERBORN MULTIPLE RESOURCE AREA: SHERBORN, MASSACHUSETTS
SHERBORN CENTER HISTORIC DISTRICT
DISTRICT DATA SHEET

NC = Noncontributing
NA = Not Applicable

MHC #	HISTORIC NAME	STREET ADDRESS	DATE OF CONSTRUCTION	STYLE	MAP #
151	Flagg House	22 Washington Street	ca. 1740	Georgian	10
NA	Richard Smart House	23 Washington Street	ca. 1893	Colonial Revival	9
152	Bickford-Blanchard House	27 Washington Street	1849	Greek Revival	8
174	Sanger Laundry E11	5 Zion's Lane	1819	Frame Vernacular	28
175	David Daniels House	8 Zion's Lane	ca. 1857	Greek Revival	29

United States Department of the Interior
National Park Service

National Register of Historic Places
Inventory—Nomination Form

For NPS use only
received 11/20/85
date entered

Continuation sheet

Item number

Page 13

Multiple Resource Area
Thematic Group

dnr-11

Name Sherborn Multiple Resource Area
State Middlesex County, MASSACHUSETTS

Cover Patrick Andrus 1/3/86

Nomination/Type of Review

Date/Signature

1. Assington

Substantive Review for Keeper

Patrick Andrus 1/3/86

Attest

Beth L. Savage 1-3-86

Determined Eligible

2. Buttonballs

DOE/OWNER OBJECTION
Substantive Review for Keeper

Eligible Patrick Andrus 1/3/86

Attest

Beth L. Savage 1-3-86

3. Edwards Plain-Dowse's
Corner Historic
District

Substantive Review for Keeper

Patrick Andrus 1/3/86

Attest

Beth L. Savage 1-3-86

4. Morse-Barber House

Substantive Review for Keeper

Patrick Andrus 1/3/86

Attest

Beth L. Savage 1-3-86

5. Sewall-Ware House

Substantive Review for Keeper

Patrick Andrus 1/3/86

Attest

Beth L. Savage 1-3-86

6. Sherborn Center Historic
District

Substantive Review for Keeper

Patrick Andrus 1/3/86

Attest

Beth L. Savage 1-3-86

7. Stannox Farm

DOE/OWNER OBJECTION
Substantive Review for Keeper

Determined Eligible
Eligible Patrick Andrus 1/3/86

Attest

Beth L. Savage 1-3-86

8. Sudbury Waste Weir A

Substantive Review Keeper

Attest

9. Bullen-Stratton-
Cozzen House

Entered in the for Keeper
National Register

Delores Byers 1/3/86

Attest

10. Clark-Northrup House

Entered in the for Keeper
National Register

Delores Byers 1/3/86

Attest

NATIONAL REGISTER OF HISTORIC PLACES
EVALUATION/RETURN SHEET

86000495

Substantive Review

Sherborn Center Historic District (Sherborn
MRA)
Middlesex County
MASSACHUSETTS

Working No. NOV/20 1985
Fed. Reg. Date 2/3/87
Date Due: 12/19/85 - 1/4/85
Action: ACCEPT 1-3-86
 RETURN
 REJECT

- resubmission
- nomination by person or local government
- owner objection
- appeal

Federal Agency: _____

Substantive Review: sample request appeal NR decision

Reviewer's comments:

The district represents a well-preserved late 19th - early 20th century rural New England hamlet. The district conveys significance of the town's development from early settlement to the mid 20th C, and associations with a number of prominent citizens. Distinguished by the cohesiveness of architectural styles, the quality of setting and examples of works by two local master builders, Chenzyer Mann and Bower Adams.

Recom./Criteria Accept A, B + C
Reviewer Savage
Discipline Architectural History
Date 1-3-86

Nomination returned for: technical corrections cited below
 substantive reasons discussed below

see continuation sheet

1. Name

2. Location

3. Classification

Category	Ownership	Status	Present Use
	Public Acquisition	Accessible	

4. Owner of Property

5. Location of Legal Description

6. Representation in Existing Surveys

Has this property been determined eligible? yes no

7. Description

- | | | |
|------------------------------------|---------------------------------------|---|
| Condition | Check one | Check one |
| <input type="checkbox"/> excellent | <input type="checkbox"/> deteriorated | <input type="checkbox"/> original site |
| <input type="checkbox"/> good | <input type="checkbox"/> ruins | <input type="checkbox"/> moved date _____ |
| <input type="checkbox"/> fair | <input type="checkbox"/> unexposed | |
| | <input type="checkbox"/> unaltered | |
| | <input type="checkbox"/> altered | |

Describe the present and original (if known) physical appearance

- summary paragraph
- completeness
- clarity
- alterations/integrity
- dates
- boundary selection

8. Significance

Period _____ Areas of Significance—Check and justify below

Specific dates _____ Builder/Architect _____

Statement of Significance (*in one paragraph*)

- summary paragraph
- completeness
- clarity
- applicable criteria
- justification of areas checked
- relating significance to the resource
- context
- relationship of integrity to significance
- justification of exception
- other

9. Major Bibliographical References

10. Geographical Data

Acreage of nominated property _____

Quadrangle name _____

UTM References _____

Verbal boundary description and justification _____

11. Form Prepared By

12. State Historic Preservation Officer Certification

The evaluated significance of this property within the state is:

____ national ____ state ____ local

State Historic Preservation Officer signature

title _____ date _____

13. Other

- Maps
- Photographs
- Other

Questions concerning this nomination may be directed to _____

Signed _____ Date _____ Phone: _____



TREES \$8.00 TREES
MADE IN YOUR OWN

#22 Washington Street
Sherborn Center Historic District
Sherborn, Mass. *MRA*

photo: Mark O'Brien

Photo #1
The Flagg House
View from the southeast,
showing southeast elevation
Neg: with photographer



8 Washington Street
Sherborn Center Historic District
Sherborn, Mass. *MLA*

photo: Mark O'Brien

Photo #2

Colonel Calvin Sanger House
View southeast, showing east
and south elevations
Neg: with photographer



Streetscape Sanger St. at Washington.

UU Church + Old Town Hall across library
+ church grounds.

11 Washington St + # 1 Sanger St.

#11 Washington St., #1 Sanger St.
Sherborn Center Historic District

Sherborn, Mass. MRA

1985



Streetscape Washington at Maple.

12 + 8 Washington St.

#10, #8 Washington Street
Sherborn Center Historic District

Sherborn, Mass. MRA

1985



SPEED
LIMIT
30

Streetscape N. Main toward N-S Main Triangle
from RR.

Shows L-R 1, 3-5, 7, 9 N. Main

#1, #3/5, #7, #9 North Main St.
Sherborn Center Historic District

Sherborn, Mass. *MRA*

1985

SHERBORN HISTORIC

CENTER DISTRICT
SHERBORN, MA

Scale:
approx. 1" = 200'

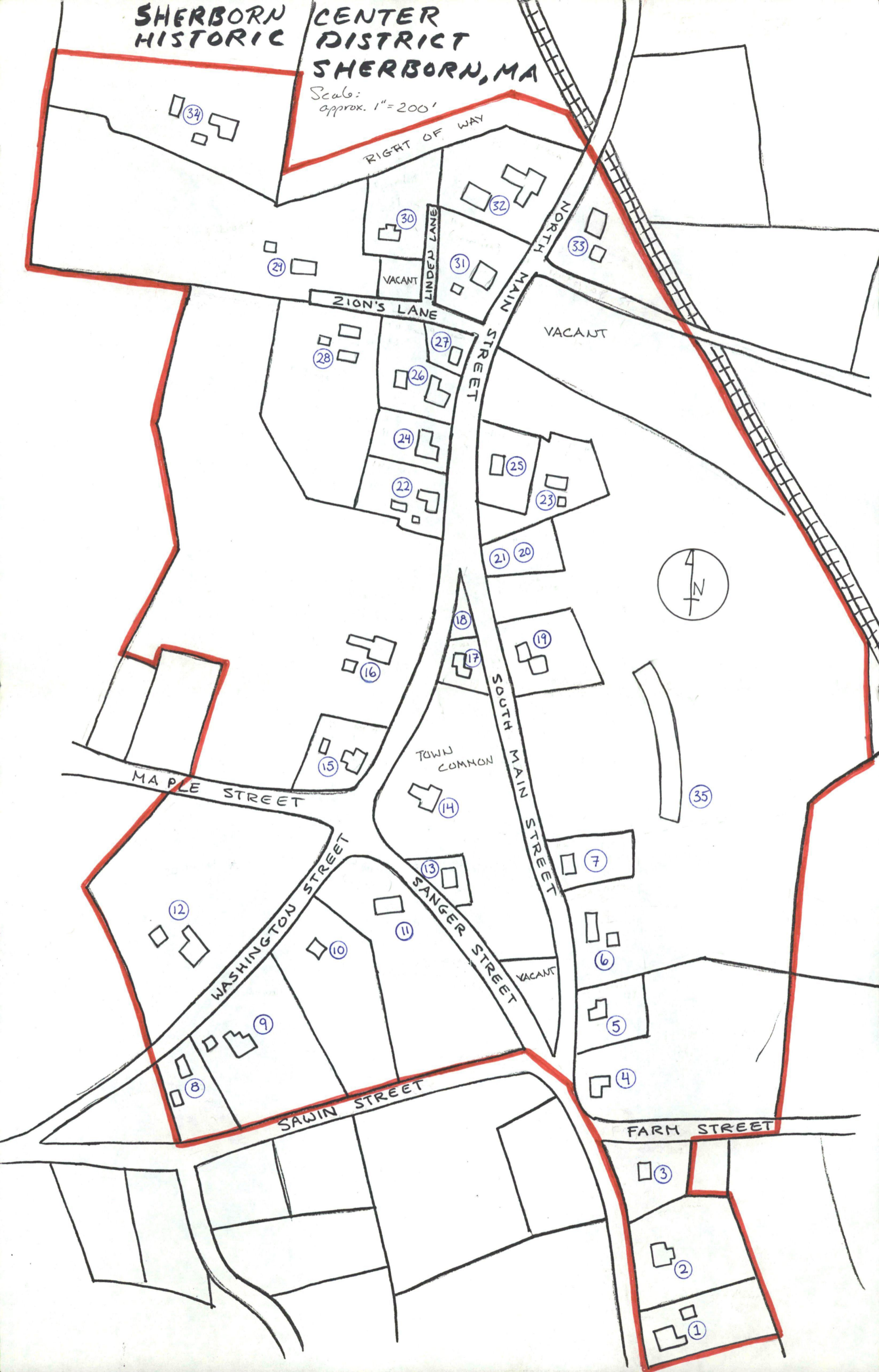

Please refer to the map in the
Multiple Property Cover Sheet
for this property

Multiple Property Cover Sheet Reference Number: 64000293