

United States Department of the Interior
National Park Service

For NPS use only

National Register of Historic Places
Inventory—Nomination Form

received JAN 23 1986

date entered FEB 20 1986

See instructions in *How to Complete National Register Forms*
Type all entries—complete applicable sections

1. Name

historic CAPTAIN DANIEL BRADFORD HOUSE

and/or common same

2. Location

street & number 251 Harrison Street N/A not for publication

city, town Duxbury N/A vicinity of

state Massachusetts code 025 county Plymouth code 023

3. Classification

Category	Ownership	Status	Present Use
<input type="checkbox"/> district	<input type="checkbox"/> public	<input checked="" type="checkbox"/> occupied	<input type="checkbox"/> agriculture
<input checked="" type="checkbox"/> building(s)	<input checked="" type="checkbox"/> private	<input type="checkbox"/> unoccupied	<input type="checkbox"/> commercial
<input type="checkbox"/> structure	<input type="checkbox"/> both	<input type="checkbox"/> work in progress	<input type="checkbox"/> educational
<input type="checkbox"/> site	Public Acquisition	Accessible	<input type="checkbox"/> entertainment
<input type="checkbox"/> object	<input checked="" type="checkbox"/> in process	<input checked="" type="checkbox"/> yes: restricted	<input type="checkbox"/> government
	<input type="checkbox"/> being considered	<input type="checkbox"/> yes: unrestricted	<input type="checkbox"/> industrial
		<input type="checkbox"/> no	<input type="checkbox"/> military
			<input type="checkbox"/> museum
			<input type="checkbox"/> park
			<input checked="" type="checkbox"/> private residence
			<input type="checkbox"/> religious
			<input type="checkbox"/> scientific
			<input type="checkbox"/> transportation
			<input type="checkbox"/> other:

4. Owner of Property

name Thomas Lanman

street & number Box 384, Snug Harbor

city, town Duxbury N/A vicinity of state Massachusetts

5. Location of Legal Description

courthouse, registry of deeds, etc. Plymouth County Registry of Deeds

street & number Russell Street

city, town Plymouth state Massachusetts

6. Representation in Existing Surveys

title Inventory of the Historic Assets of the Commonwealth of Massachusetts has this property been determined eligible? yes no

date 1968 #9 federal state county local

depository for survey records Massachusetts Historical Commission, 80 Boylston Street

city, Boston state Massachusetts

7. Description

CAPTAIN DANIEL BRADFORD HOUSE, DUXBURY, MA

Condition		Check one	Check one
<input checked="" type="checkbox"/> excellent	<input type="checkbox"/> deteriorated	<input type="checkbox"/> unaltered	<input checked="" type="checkbox"/> original site
<input type="checkbox"/> good	<input type="checkbox"/> ruins	<input checked="" type="checkbox"/> altered	<input type="checkbox"/> moved date _____
<input type="checkbox"/> fair	<input type="checkbox"/> unexposed	(as indicated)	

Describe the present and original (if known) physical appearance

The Captain Daniel Bradford House is a well-preserved Federal-style building constructed in 1808. It is located in the center of Duxbury, Massachusetts, a suburban town on Duxbury Bay, south of Boston. The house sits on an 8-acre partially wooded lot, set back on a small knoll 200 feet from Harrison Street. A golf course abuts the lot's eastern edge, while the other lots adjoining the property contain equally secluded residences.

The property consists of the north-facing house--a two-story, wood-frame structure with a two-story western ell, part of which is contemporary with the main block--and a barn believed to have been built at the same time as the house. The house sustained some alterations ca. 1880-1885, when a rooftop balustrade and small entry porch were added (now gone), as well as the ell's second story. Subsequent alterations occurred in 1927 and 1957, when the interior was modernized.

The Daniel Bradford House's rectangular main block rests on its original cut-granite foundation; the house rises two stories and is capped by a hipped roof. Its exterior is clapboard, and the roof is sheathed in wood shingles. The single, large chimney is placed off center and forward of the ridge.

The facade is five bays wide, with a central entrance. Its fenestration is somewhat asymmetrically aligned, and consists of simply enframed 12/12 sash, which is not original. Windows on the second story are topped by molded lintels and are set flush with the narrow cornice. Narrow cornerboards define the building. Windows at the block's northeastern portion are more closely set than those on the southeastern; together with the off-center chimney, this suggests that the house may have been built as a three-bay half house and enlarged early in the 19th century. No documentation exists to substantiate this hypothesis, however. The entryway is typical of the Federal style, with a surround of applied pilasters and open pediment flanking a door with sidelights and a graceful fan. It is reached by three wooden steps.

The eastern elevation is three bays deep; windows are again asymmetrically placed, with the two at the southern end more closely set than the northern bay. Fenestration on first and second stories is identical.

The rear elevation contains four bays; again they are asymmetrically placed. On the first story, a mid-20th century screened porch obscures the western three bays. Windows again are 12/12 sash. A bulkhead located beneath the easternmost bay provides access to the full basement.

Continued

United States Department of the Interior
National Park Service

**National Register of Historic Places
Inventory—Nomination Form**

For NPS use only

received

date entered

CAPTAIN DANIEL BRADFORD HOUSE

Continuation sheet

DUXBURY, MASSACHUSETTS

Item number

7

Page 1

Only one bay of the main block's eastern elevation (at its northern corner) is visible; the rest is covered by the narrow two-story double-hipped roof ell extending four bays to the west. The clapboarded ell is built on the side of the knoll; thus its basement's western end is fully exposed, while on the east it is set into the hillside. Like the main block, it too rests on a foundation of granite blocks. Originally one story, the ell is now two stories in height, having been enlarged in 1885 with its roofline broken by four inset shed-roof dormers on the front elevation and a broad three-light dormer on the rear. A single chimney is sited forward of the ridge between the two western bays. A ca. 1887 photo shows the existence of a second chimney nearer the main block--this was removed early in the 20th century, at the time of a kitchen remodeling. While most of the fenestration is 12/12 sash, the two first-story windows closest to the main block are 12/8. With the exception of those already mentioned, all are considered to be original.

On its western end, the ell displays a triangular arrangement of fenestration, with two 9/9 windows close set on the first story centered beneath a 12/12 inset shed-roof dormer on the second. A second bulkhead provides basement access.

The ell's rear facade is asymmetrical and multiplaned, reflecting a mid-20th century renovation. A brick patio is located at the eastern end, the juncture of ell and main block. A secondary entrance stands at the southwestern corner. A broad three-light shed-roofed dormer projects from the rear of the ell.

Sited to the west of the house is a 1 1/2-story, gable-roofed barn (ca. 1808), with a lean-to. It is now used as a garage.

The building's 14-room interior retains a number of notable original features, including paneled doors, hardware, fireplaces with paneling and mantels, and wide pine flooring. The ell was altered in the early 20th century when a modern kitchen was installed.

Archaeology

While no prehistoric sites are currently recorded on the property, it is likely that sites are present. One site (19-PL-326) is located adjacent to the property, and several others are within the immediate area. In spite of the many sites recorded, cultural and chronological information is slight. As a result, any remaining prehistoric sites would be significant in documenting Duxbury's prehistoric occupation.

Continued

**United States Department of the Interior
National Park Service**

National Register of Historic Places Inventory—Nomination Form

For NPS use only

received

date entered

Continuation sheet CAPTAIN DANIEL BRADFORD HOUSE Item number 7
DUXBURY, MASSACHUSETTS

Page 2

There is potential for occupation-related features (trash pits, privies, and wells) around the house and barn. Archaeological testing and examination may also assist in documenting the dates of any nonextant outbuildings. Any surviving historic archaeological resources would be significant in terms of documenting and defining the social, cultural, and economic patterns of this prosperous early 19th century maritime-oriented family.

8. Significance CAPTAIN DANIEL BRADFORD HOUSE, DUXBURY, MASSACHUSETTS

Period	Areas of Significance—Check and justify below			
<input type="checkbox"/> prehistoric	<input type="checkbox"/> archeology-prehistoric	<input type="checkbox"/> community planning	<input type="checkbox"/> landscape architecture	<input type="checkbox"/> religion
<input type="checkbox"/> 1400–1499	<input type="checkbox"/> archeology-historic	<input type="checkbox"/> conservation	<input type="checkbox"/> law	<input type="checkbox"/> science
<input type="checkbox"/> 1500–1599	<input type="checkbox"/> agriculture	<input type="checkbox"/> economics	<input type="checkbox"/> literature	<input type="checkbox"/> sculpture
<input type="checkbox"/> 1600–1699	<input checked="" type="checkbox"/> architecture	<input type="checkbox"/> education	<input type="checkbox"/> military	<input type="checkbox"/> social/ humanitarian
<input type="checkbox"/> 1700–1799	<input type="checkbox"/> art	<input type="checkbox"/> engineering	<input type="checkbox"/> music	<input type="checkbox"/> theater
<input checked="" type="checkbox"/> 1800–1899	<input checked="" type="checkbox"/> commerce	<input type="checkbox"/> exploration/settlement	<input type="checkbox"/> philosophy	<input type="checkbox"/> transportation
<input type="checkbox"/> 1900–	<input type="checkbox"/> communications	<input type="checkbox"/> industry	<input type="checkbox"/> politics/government	<input checked="" type="checkbox"/> other (specify) community development
<input type="checkbox"/> invention				

Specific dates 1808 **Builder/Architect** unknown

Statement of Significance (in one paragraph)

The Daniel Bradford House, Duxbury, retains integrity of location, design, setting, materials, workmanship, feeling, and association. Architecturally, the Bradford House is distinguished as a particularly well-executed and well-preserved building in the Federal style. The house holds historical significance for its associations with early 19th century Duxbury during its brief yet intense period of substantial growth and prosperity as a maritime community. The building is also significant as the home of Daniel Bradford and, later, Jacob and Moxon Smith, all Duxbury shipmasters and sea captains. It thus fulfills Criteria A, B, and C of the National Register of Historic Places on the local level.

By the late 18th century, Duxbury was expanding rapidly, changing from the farming and milling offshoot of nearby Plymouth that it had been for much of its earliest settlement period (incorporated 1637) into a substantial and self-sufficient maritime community. Duxbury's coastal location and fine, small harbor made the development of maritime activities almost inevitable in the town, and indeed, by the close of the century, a well-organized shipbuilding industry had been established. Along with other Massachusetts' coastal communities, Duxbury experienced an intense period of sea-related growth between ca. 1780 and ca. 1840.

In common with such smaller maritime centers as Beverly, Gloucester, Marshfield, Plymouth, Kingston and New Bedford, Duxbury experienced rapid growth in the Federal period. In contrast to most of these communities, Duxbury's economy evolved solely as a result of shipbuilding. Relative to the great Massachusetts' shipbuilding center at Newburyport, South Shore shipbuilding, concentrated at the North River in Marshfield and on Plymouth Bay at Duxbury, Plymouth and Kingston, constituted a more modest enterprise. Nevertheless, the South Shore shipyards produced large numbers of the small coasting and ocean-going vessels that supported the state's great commerce and trade in the Federal period.

Duxbury is exceptional in the excellent state of preservation of its Federal period maritime-related resources. Few of the other communities which experienced similar growth in the period have retained as extensive or well-contained an area of well-detailed shipbuilders' houses as is found in Duxbury Village. This is due primarily to the dramatic decline in the town's economy which occurred after 1850.

By 1840, the town's largest shipbuilder, Samuel Hall, relocated his works to far-more-profitable Boston, and with his departure, decline in the town was swift and dramatic. Industry slowed--and ultimately ceased--in the 1840s, and with its exit, the impetus for building high-style residences also vanished.

Continued

9. Major Bibliographical References

Inventory of the Cultural Assets of Duxbury, 1968
Duxbury Town Records, 1776-1850
Duxbury Assessors Records, 1776-1858
Wentworth, Dorothy, Settlement and Growth of Duxbury, Duxbury, 1973
Winsor, Justin, History of the Town of Duxbury, Boston, 1849

10. Geographical Data

Acreeage of nominated property 7.0
Quadrangle name Duxbury, Quadrangle Quadrangle scale 1:24000

UTM References

A	<u>19</u> Zone	<u>360480</u> Easting	<u>4655290</u> Northing	B	<u> </u> Zone	<u> </u> Easting	<u> </u> Northing
C	<u> </u> Zone	<u> </u> Easting	<u> </u> Northing	D	<u> </u> Zone	<u> </u> Easting	<u> </u> Northing
E	<u> </u> Zone	<u> </u> Easting	<u> </u> Northing	F	<u> </u> Zone	<u> </u> Easting	<u> </u> Northing
G	<u> </u> Zone	<u> </u> Easting	<u> </u> Northing	H	<u> </u> Zone	<u> </u> Easting	<u> </u> Northing

Verbal boundary description and justification

See assessors map

List all states and counties for properties overlapping state or county boundaries

state	code	county	code
<u>N/A</u>			

11. Form Prepared By

name/title Betsy Friedberg, Preservation Planner, Massachusetts Historical Commission, with Duxbury Historical Commission

organization Massachusetts Historical Commission date December, 1985

street & number 80 Boylston Street telephone (617) 727-8470

city or town Boston state Massachusetts

12. State Historic Preservation Officer Certification

The evaluated significance of this property within the state is:

national state local

As the designated State Historic Preservation Officer for the National Historic Preservation Act of 1966 (Public Law 89-665), I hereby nominate this property for inclusion in the National Register and certify that it has been evaluated according to the criteria and procedures set forth by the National Park Service.

State Historic Preservation Officer signature Valerie Talmage

Executive Director, Massachusetts Historical Commission
title State Historic Preservation Officer date Jan. 15, 1986

For NPS use only

I hereby certify that this property is included in the National Register

for Alvina Byers date 2/20/86
Keeper of the National Register
Entered in the National Register

AI : _____ date _____

Chief of Registration

United States Department of the Interior
National Park Service

National Register of Historic Places
Inventory—Nomination Form

For NPS use only

received

date entered

CAPTAIN DANIEL BRADFORD HOUSE

Continuation sheet DUXBURY, MASSACHUSETTS

Item number

8

Page 1

Thus while other coastal towns continued to evolve and grow, Duxbury's development came to an abrupt halt, leaving the town with an outstanding concentration of Federal-period residential buildings that stand as a relic of the community's brief period of maritime-related prosperity.

During the early years of the republic, settlement extended radially from Tremont Street, just above the harbor in the center of Duxbury, and was oriented primarily toward residences for shipyard owners, workers, and sea captains. Most of the buildings were ambitious and well-detailed Federal-style structures. The nominated property, somewhat isolated from the rest, is exemplary of this style and stands as a significant remnant of this important albeit brief period in Duxbury's development, one which saw the most significant construction boom in the community's history.

Born in 1771, Daniel Bradford was the grandson of a Representative to the General Court and son of a Revolutionary War colonel, Gamaliel Bradford. At the age of 17, Bradford married Sarah Drew, the daughter of a Duxbury shipbuilder, James Drew, and went to sea. In 1799, Daniel bought the land comprising 15 acres and located just east of Tremont Street from his father, who had since 1764 owned substantial acreage in the center of Duxbury. Daniel did not build upon the land for several years. In 1807, Col. Bradford, Daniel's father, died; shortly thereafter, his three sons, Daniel, Gershom, and Gamaliel, each began to build substantial residences on land that had belonged to their father. Gershom's and Gamaliel's (both listed on the National Register in 1978), were a third of a mile away from Daniel's property, on Tremont Street. In 1808, a year after he had become master of his own ship, the Brutus, Daniel Bradford built the nominated residence for his family, which now included two children.

In 1809, Bradford's wife accompanied him on a voyage on the Hercules. The trip was fraught with disaster: after losing its mast in the mid Atlantic during a bad storm, the ship was seized by privateers. A year later, the Bradfords returned to Duxbury, with Daniel determined to abandon the sea and turn to farming. By 1811, he had bought a house and farmland in New Hampshire and sold his Duxbury residence for \$2,000 to Jacob Smith, another sea captain and part owner of a fleet of ocean-going vessels berthed in Duxbury.

Smith and his son, Moxon, lived in the house through the Civil War. Both were engaged in shipping activities. Between 1832 and 1837, 71 ships were built and 900 men employed in the shipyards; 46 fishing vessels and 300 fishermen were active in the peak year of 1837. After 1840, however, as mentioned above, shipwrights began moving north, closer to Boston, and yards began to close. By 1865, only two ships were launched, and the last fully rigged ship left a Duxbury yard in 1869. Duxbury began a long period of stagnation, with little new residential construction taking place over the next two decades.

Continued

United States Department of the Interior
National Park Service

For NPS use only

received

date entered

National Register of Historic Places Inventory—Nomination Form

CAPTAIN DANIEL BRADFORD HOUSE

Continuation sheet DUXBURY, MASSACHUSETTS

Item number

8

Page 2

In 1865, after Moxon Smith's death, the house returned to the Bradford family, coming into possession of Lawrence Bradford, a grand-nephew of Daniel Bradford. Like the house's prior owners, Lawrence too had been a seaman, but he abandoned that trade ca. 1865 and took up surveying. The business prospered, and in 1885, he was able to enlarge the house, adding a second story and dormers to the building's western ell. In addition, he built a pretentious rooftop balustrade atop the main block, as well as an entry porch (both features have been removed).

In 1877, Lawrence Bradford had sold a strip of land on the eastern boundary of the property to the Cohasset and Duxbury Railroad. (The rail line is now abandoned and its bed filled in with a new stand of trees and undergrowth.) With the arrival of the railroad in 1871, Duxbury found a new source of prosperity, becoming accessible and popular as a summer colony. At the close of the 19th century, the house with its now 7.9 acres was sold to a summer resident, Jane Anderson of Providence. The house changed hands a number of times through the late 19th century and well into the 20th, seeing use both as a vacation home and as a year-round residence. It remains a single-family home today.

Architecturally, the Daniel Bradford House is significant for its fully realized Federal design, representative of a unique period of growth in Duxbury's history. Five bays wide and two stories high, with a pedimented central entryway, the house is prominently sited on a low rise, adding to its imposing appearance. Like other high-style residences of the period in Duxbury, the Bradford House's high-pitched hipped roof and absence of extensive elaborate details (save for the entryway) indicates a certain stylistic conservatism. The slightly off-center chimney and somewhat asymmetrical fenestration suggest that the house may have been built as a half house, and enlarged shortly thereafter to its present five-bay configuration.

CAPTAIN DANIEL BRADFORD HOUSE
251 Harrison Street
Duxbury, Massachusetts

Duxbury Assessors Map Sheet 190
Reduced to 1" = 330' 1979

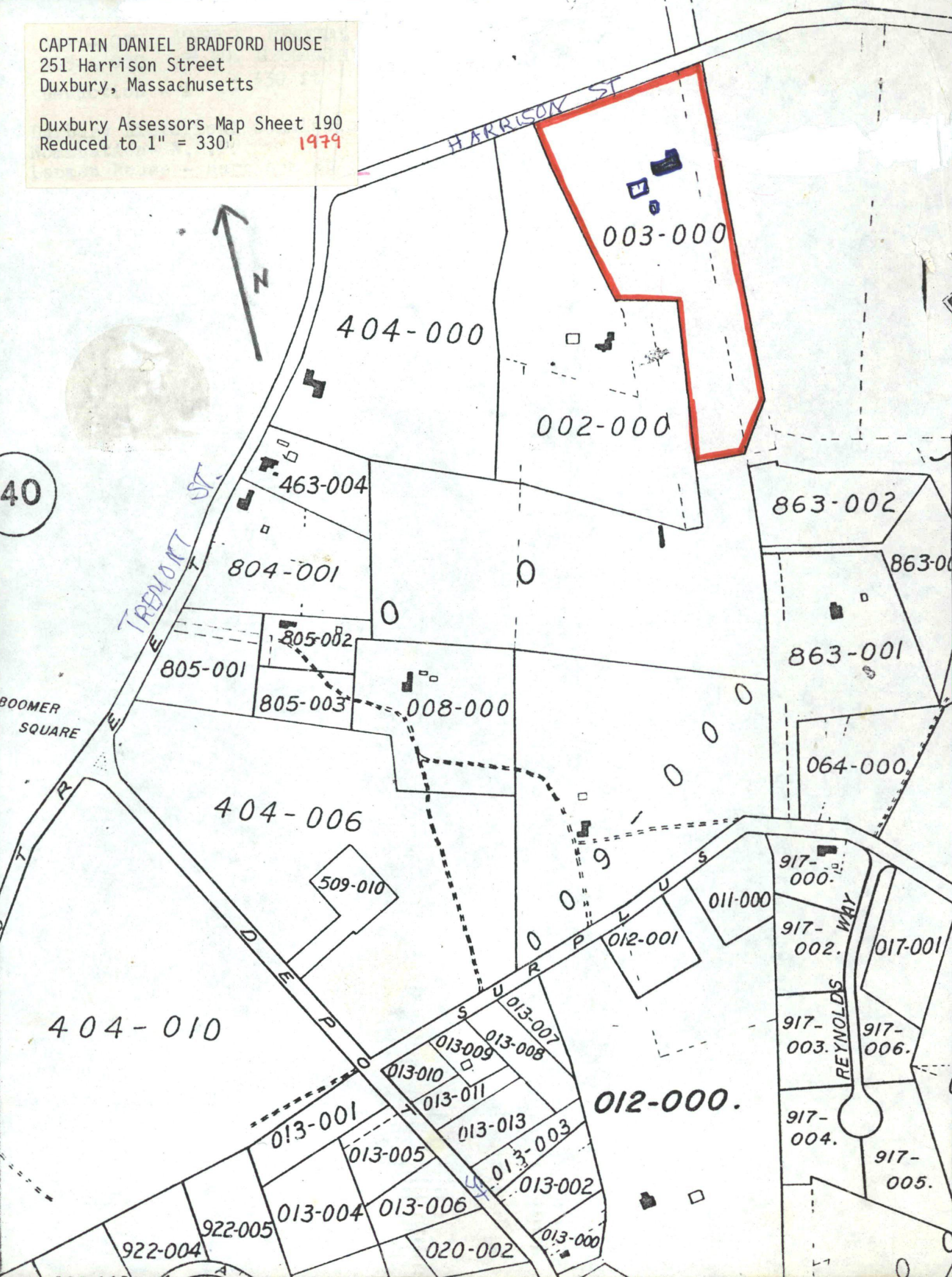

+01. Reference Number _____ (8)

*13. Non/Det Type S

+14. Multiple Name

(120)

*15. Nominator
S State _____ Federal _____ Local _____ Other _____

+16. Non. Name/Designations

(26)

+17. NPS Park Name _____

*18. New Certification LL

*18a. Certification Date / /
 / /
 / /

+19. Current Certification
Primary: _____

Other: _____

+19a. Other Certification Dates
____/____/____
____/____/____
____/____/____
____/____/____
____/____/____
____/____/____
____/____/____
____/____/____
____/____/____

+ This field should be left blank.
+ Field may be left blank if information is not given.
* Mandatory data element; field must be filled in.

†32. Other Documentation

____ NR ____ DOE ____ NHL ____ LCS

32a. ____ HAER/No. _____

32b. ____ HABS/No. _____

*33. Acreage _____ 7.0

*34. UTM Coordinates

A/ 19 1 13 6 0 48 0 1 46 55 29 0 1	B/ _ _ / / / _ _ / _ _ / / _ _ /
C/ _ _ / / / _ _ / _ _ / / _ _ /	D/ _ _ / / / _ _ / _ _ / / _ _ /
E/ _ _ / / / _ _ / _ _ / / _ _ /	F/ _ _ / / / _ _ / _ _ / / _ _ /
G/ _ _ / / / _ _ / _ _ / / _ _ /	H/ _ _ / / / _ _ / _ _ / / _ _ /
I/ _ _ / / / _ _ / _ _ / / _ _ /	J/ _ _ / / / _ _ / _ _ / / _ _ /
K/ _ _ / / / _ _ / _ _ / / _ _ /	L/ _ _ / / / _ _ / _ _ / / _ _ /
M/ _ _ / / / _ _ / _ _ / / _ _ /	N/ _ _ / / / _ _ / _ _ / / _ _ /
O/ _ _ / / / _ _ / _ _ / / _ _ /	P/ _ _ / / / _ _ / _ _ / / _ _ /
Q/ _ _ / / / _ _ / _ _ / / _ _ /	R/ _ _ / / / _ _ / _ _ / / _ _ /
S/ _ _ / / / _ _ / _ _ / / _ _ /	T/ _ _ / / / _ _ / _ _ / / _ _ /
U/ _ _ / / / _ _ / _ _ / / _ _ /	V/ _ _ / / / _ _ / _ _ / / _ _ /
W/ _ _ / / / _ _ / _ _ / / _ _ /	X/ _ _ / / / _ _ / _ _ / / _ _ /
Y/ _ _ / / / _ _ / _ _ / / _ _ /	Z/ _ _ / / / _ _ / _ _ / / _ _ /

+ This field should be left blank.
 * Mandatory data element; field must be filled in.

86000301

NATIONAL REGISTER OF HISTORIC PLACES
EVALUATION/RETURN SHEET

Bradford, Captain Daniel, House
Plymouth County
MASSACHUSETTS

Working No. JAN 23 1986
Fed. Reg. Date: 12-3-87
Date Due: 2/20/86 - 3/9/86
Action: ACCEPT 2-20-86
 RETURN
 REJECT
Federal Agency: _____

Entered in the
National Register

- resubmission
- nomination by person or local government
- owner objection
- appeal

Substantive Review: sample request appeal NR decision

Reviewer's comments:

Recom./Criteria _____
Reviewer _____
Discipline _____
Date _____
_____ see continuation sheet

Nomination returned for: _____ technical corrections cited below
_____ substantive reasons discussed below

1. Name

2. Location

3. Classification

Category	Ownership Public Acquisition	Status Accessible	Present Use
----------	---------------------------------	----------------------	-------------

4. Owner of Property

5. Location of Legal Description

6. Representation in Existing Surveys

Has this property been determined eligible? yes no

7. Description

Condition

- excellent
- good
- fair
- deteriorated
- ruins
- unexposed

Check one

- unaltered
- altered

Check one

- original site
- moved date _____

Describe the present and original (if known) physical appearance

- summary paragraph
- completeness
- clarity
- alterations/integrity
- dates
- boundary selection

8. Significance

Period _____ Areas of Significance—Check and justify below

Specific dates _____ Builder/Architect _____
Statement of Significance (*in one paragraph*)

- summary paragraph
- completeness
- clarity
- applicable criteria
- justification of areas checked
- relating significance to the resource
- context
- relationship of integrity to significance
- justification of exception
- other

9. Major Bibliographical References

10. Geographical Data

Acreage of nominated property _____

Quadrangle name _____

UTM References _____

Verbal boundary description and justification

11. Form Prepared By

12. State Historic Preservation Officer Certification

The evaluated significance of this property within the state is:

____ national ____ state ____ local

State Historic Preservation Officer signature

title _____ date _____

13. Other

- Maps
- Photographs
- Other

Questions concerning this nomination may be directed to _____

Signed _____ Date _____ Phone: _____



CAPTAIN DANIEL BRADFORD HOUSE
251 Harrison Street
Duxbury, Massachusetts

Main Elevation (North),
photo 1 of 3.
Neg. with Duxbury Hist. Comm.
Photographer: Holly Heidenreich

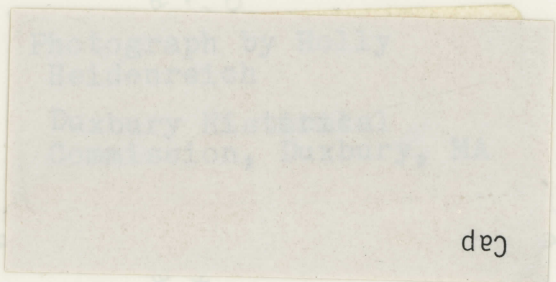
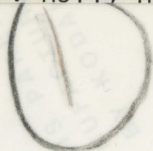



CAPTAIN DANIEL BRADFORD HOUSE
251 Harrison Street
Duxbury, Massachusetts

North and East Elevations
Photo #2 of 3
Neg. with Duxbury Hist. Comm.
Photographer: Holly Heidenreich



CAPTAIN DANIEL BRADFORD HOUSE
251 Harrison Street
Duxbury, Massachusetts

Barn

Photo 3 of 3

Neg. with Duxbury Hist. Comm.

Photographer: Holly Heidenreich

6868 II SW
CORNER
(CONTAINEE)

UNITED STATES
DEPARTMENT OF THE INTERIOR
GEOLOGICAL SURVEY

STATE OF MASSACHUSETTS
DEPARTMENT OF PUBLIC WORKS

Geodetic Map

DUXBURY QUADRANGLE
MASSACHUSETTS—PLYMOUTH CO.
15-MINUTE SERIES (TOPOGRAPHIC)

*Geological
Survey
U.S. Dept
of the Interior*



of the Interior
N. 2. 2. 2. 2. 2.
General
Geological

Geological

Topographical Map
PART II, 3. p. 14
Natl. Reg. Application
Lanman House, Duxbury,
291 Harrison St.
U.S. GEOLOGICAL SURVEY M

Nomination
page 14
MAP A

UNITED STATES
DEPARTMENT OF THE INTERIOR
GEOLOGICAL SURVEY



BAYSIDE MARINE CORP.

P.O. Box 158 - S.H.S.

Snug Harbor • Duxbury, Mass. 02331

617-934-2051

617-934-0561

RECEIVED ✓ 52

DEC - 6 1985

BF

DEC. 2, 1985

MASS. HIST. COMM.

Dear Ms. Talmage:

Thank you for your letter of Nov. 18, 1985 regarding my mother's house at 251 Harrison St., Duxbury Mass. The so called Captain Daniel Bradford House is very dear to me and all my family. We are most pleased to hear it will be considered by the State Review Board for nomination to the National Registry of Historic Places. We sincerely hope that the Board will indeed nominate the house to the National Registry. Should you need any other information, please do not hesitate to call me or write me.

Again thank you for your efforts.

Sincerely Yours.

Tom Lanman

THOMAS H. LANMAN SR. TR,
Box 384 S.H.S.,
DUXBURY, MASS 02331

P 284 880 9794

Town of Duxbury, Massachusetts

02332

BOARD OF SELECTMEN



Selectmen

JOHN P. LEONARD
Chairman

THOMAS J. BARRY
C. MARTIN DELANO

934-6586

RECEIVED

DEC 5 1985

MASS. HIST. COMM.

EDMUND A. DONDERO
Executive Assistant

December 3, 1985

The Commonwealth of Massachusetts
Mass. Historical Commission
80 Boylston Street
Boston, Ma. 02116

Dear Sir:

Please be advised, the Board of Seletmen feels it would be an honor to have the Captain Daniel Bradford House located at 251 Harrison Street, Duxbury listed in the National Register of Historic Places.

Very truly yours,
For the Board of Selectmen

Lois M. Beckman

Lois M. Beckman
Secretary



P 157 781 116

The Commonwealth of Massachusetts

Office of the Secretary of State
Michael Joseph Connolly, Secretary

Massachusetts Historical Commission

Valerie A. Talmage

Executive Director

State Historic Preservation Officer

January 16, 1986

Ms. Carol Shull, Chief
National Register of Historic Places
Department of Interior
National Park Service
P.O. Box 37127
Washington, D.C. 20013-7127

Dear Ms. Shull:

Enclosed you will find the following nomination forms:

Brewster, Nickerson Mansion, 2871 Main Street 2 HPCA's pending: 0421-83-MA-83-0413
and 0516-84-MA.

✓ Duxbury, Captain Daniel Bradford House, 251 Harrison Street.

All have been voted eligible by the State Review Board and have been signed by the State Historic Preservation Officer. Owners were notified of pending State Review Board consideration 30-75 days before the meeting and were afforded the opportunity to comment. Comments received to date are attached to the nomination forms.

Sincerely,

A handwritten signature in cursive script that reads "Sarah J. Zimmerman".

Sarah J. Zimmerman
Preservation Planning, Director
Massachusetts Historical Commission

SJZ/1k

Enclosure