

FORM A - AREA

MASSACHUSETTS HISTORICAL COMMISSION  
294 Washington Street, Boston, MA. 02108

Form numbers in this area	Area letter
None	43-G

Photo (3x3" or 3x5")  
Staple to left side of form

Photo number \_\_\_\_\_

Roll 10 frames 26-27

Town Uxbridge

Name of area (if any) \_\_\_\_\_

Waucantuck Mill *Complex (U.M.R.A.)*

General date or period 1838-1930

Mendon and Patrick Henry Sts.

Sketch map. Draw a general map of the area indicating properties within it. Number each property for which individual inventory forms have been completed. Label streets (including route numbers, if any) and indicate north. (Attach a separate sheet if space here is not sufficient)

SEE CONTINUATION SHEET #3

Acreage: 6 acres

UTM Quad BL

A 19 284330 4662190

B 19 284260 4661930

C 19 284160 4661920

D 19 284160 4662000

Recorded by B.R. Pfeiffer

Organization Uxbridge Historical Commission

Date May 1981

(Staple additional sheets here)

ARCHITECTURAL SIGNIFICANCE of area. (Describe physical setting, general character, and architecturally significant structures).

Originally characteristic of a number of moderate-size, wood-frame mills built in Uxbridge during the nineteenth century, the Waucantuck Mill has been enlarged several times between 1838 and 1928, resulting in a mill complex which preserves good local examples of industrial architecture. Buildings within the complex are (numbers correspond to those on the map on the reverse side of this form):

1. The Main Building is a three-storey wood-frame structure with an "L"-shaped floor plan. The building is enclosed by a low-pitched roof; exterior elevations are covered with stucco, except at the rear (east) where there are clapboards.

SEE CONTINUATION SHEET

HISTORICAL SIGNIFICANCE of area. (Explain development of area, what caused it, and how it affected community; be specific).

The Waucantuck Mill possesses historical associations with the early establishment of woolen manufacturing in Uxbridge, with the Taft and Wheelock families who were important in the local development of this industry and with the rapid growth of the Uxbridge's woolen industry in the early twentieth century. In addition, the mill retains architectural elements from all periods of its development.

Development of the Waucantuck Mill's site began in 1824, when Luke Taft built a dam on the West River to create water power for the original mill which was built in 1825. Until 1816, Taft had been a farmer; however, the purchase of a hand loom in 1816 led him to rent space and power in 1821 in Daniel Day's Mill where he learned about carding and other woolen-goods machines. Opened in the winter of 1825 for the manufacture of satinets, the original building was of wood-frame construction, three stories high (34' x 60'). In 1833, the elder Taft was joined in the business by his son, Moses Taft, who later developed the Central Woolen Mill (Form #46-D). Destroyed by fire in 1837, the original mill was replaced on its site, in 1828, by <sup>the</sup> present Main Building. At about the time of this fire, Luke Taft retired from an active interest in the mill, turning over management of the property to his son.

SEE CONTINUATION SHEET #2

#### BIBLIOGRAPHY and/or REFERENCES

- Barlow & Bancroft Insurance Plans. "C.A. & S.M. Wheelock's Woolen Mill" (No. 6065-Dec. 31, 1879 and Nov. 25, 1891).  
Biographical 1899: 147-149  
Chapin 1881: 70 & 149  
Hurd 1888 I: 170-171  
Jewett 1879 II: 433 (illustration)  
Sprague 1927: 36  
Stone 1930 II: 1966-1970

MASSACHUSETTS HISTORICAL COMMISSION  
Office of the Secretary, Boston

Community:	Form No:
Uxbridge	43-G
Property Name: Waucantuck Mill	

Indicate each item on inventory form which is being continued below.

ARCHITECTURAL SIGNIFICANCE

Built in 1838 on the site of Luke Taft's 1825 mill, the Main Building originally had a facade of eleven bays, each containing one window per storey, except for the third bay from the north which had loading doors; the present cupola (bell tower) and pediment on which it rests stood at the top of the stack of loading doors. Alterations to the building have included the installation of paired 6/6 and 9/6 sash to the first two stories, the reconstruction of the entry, the removal of original loading doors and the exterior application of stucco (early 20th century ?).

2. The Boiler and Dry House (ca. 1854) is a two-storey brick building with a low-pitched roof and an "L"-shaped floor plan. Originally free-standing with a smoke stack on its north elevation, this building has been altered by the construction of a one-storey addition to the Main Building (ca. 1930-40), the extension of its north elevation out to Mendon Street (1920's) and the removal of its smoke stack.
3. The Picker House (ca. 1872) is a three-storey brick building with a rectangular plan and a low-pitched roof. This structure is located at the rear of the Main Building to which it was originally joined by a bridge.
4. The Scouring and Storehouse (ca. 1872) is a two-storey brick building with a low-pitched roof. Standing at the east end of the Picker House, this building originally had a one-storey dye house at its south end which has since been removed and enlarged (1928).
5. The Office is a two-storey wood frame building, covered with stucco and attached to the southwest corner of the Main Building. Built between 1891 and 1898, this structure may contain the frame of an earlier office building, extensively rebuilt and moved to its present site.
6. The Spinning and Weaving Mill is a two-storey brick structure of utilitarian design, probably built shortly after World War I when new machinery was installed throughout the mill (ca. 1922).
7. The Dye House and Finishing Rooms are a series of one-storey structures of varied frame and brick construction, probably built between 1922 and 1928 during modernization of the manufacturing plant.

SEE CONTINUATION SHEET #2

Staple to Inventory form at bottom

MASSACHUSETTS HISTORICAL COMMISSION  
Office of the Secretary, Boston

Community: Uxbridge	Form No: 43-G
Property Name: Waucantuck Mill	

Indicate each item on inventory form which is being continued below.

### ARCHITECTURAL SIGNIFICANCE

8. Unlabelled factory buildings which extend east of the old portions of the mill appear to have been built mostly after 1925. These connected structures vary in construction, although all are utilitarian in design. These additions are not shown on insurance surveys of the mill.

### HISTORICAL SIGNIFICANCE

In 1840, the elder Taft sold his half of the mill to Jerry Wheelock & Son, a firm consisting of Jerry Wheelock, Charles A. Wheelock, and, later, Silas M. Wheelock. The Wheelock firm had been formed in 1834 and may have rented space in the Waucantuck Mill prior to 1840. Before 1834, Jerry Wheelock had built wool machinery, a skill he had learned first in 1810 at the mill of his father-in-law, Daniel Day, and which he had later developed under Artemas Dryden of Holden. Finding it impossible by the early 1830's to compete with the large-scale machine shops of Worcester, Wheelock turned his attention to the manufacture of woolen cloth until his retirement in 1846.

In 1846, Wheelock's sons, Silas M. and Charles A., purchased the other half of the mill from Moses Taft and soon re-named it the Waucantuck Mill after the Indian name for Uxbridge. The firm of C.A. & S.M. Wheelock made satinets and plaids until 1852-1855, after which cassimeres became the firm's sole product. Under the Wheelock's management the mill was remodelled in 1852 equipped with Uxbridge's first steam engine as auxiliary power in 1854, and enlarged in the 1870's. Employment in the mill rose from 12 men and 2 boys under Luke Taft in 1832 to 12 men and 12 women in 1850 to 33 men and 25 women in 1870. By 1879, 75 operatives were employed in the mill.

Direct management of the mill by the Wheelock family ceased around 1900 when Charles A. Root either rented or bought the mill under the name of C.A. Root Co.. In 1905, the firm had been re-organized as the Waucantuck Mills, Inc. at approximately the same time the Uxbridge Worsted Company was founded by Root and Louis Bachman of New York. Until 1909, the Uxbridge Worsted Company occupied part of the Waucantuck Mill. The mill was purchased for \$25,000 in 1905 and a program of enlargement was soon underway.

Part of the Firm's growth occurred at the time of World War I, although the business's success throughout 1905-1930 was thought to have been based on its close attention to changing styles, its close contact with markets and its policy of investing profits in new machinery (Stone 1930 II: 1970). By 1928, the business had grown to six times its original size, employing more than 500 operatives on three shifts which kept the mill open 24 hours daily. Although statistics of production and employment have not been compiled for the period after 1930, the company's business seems to have continued growing based on the additions made to the east end of the mill site during the 1930's or 1940's.

See Continuation Sheet #4

Staple to Inventory form at bottom

MASSACHUSETTS HISTORICAL COMMISSION  
Office of the Secretary, Boston

Community: Uxbridge	Form No: 43-G
Property Name: Waucantuck Mill	

Indicate each item on inventory form which is being continued below.

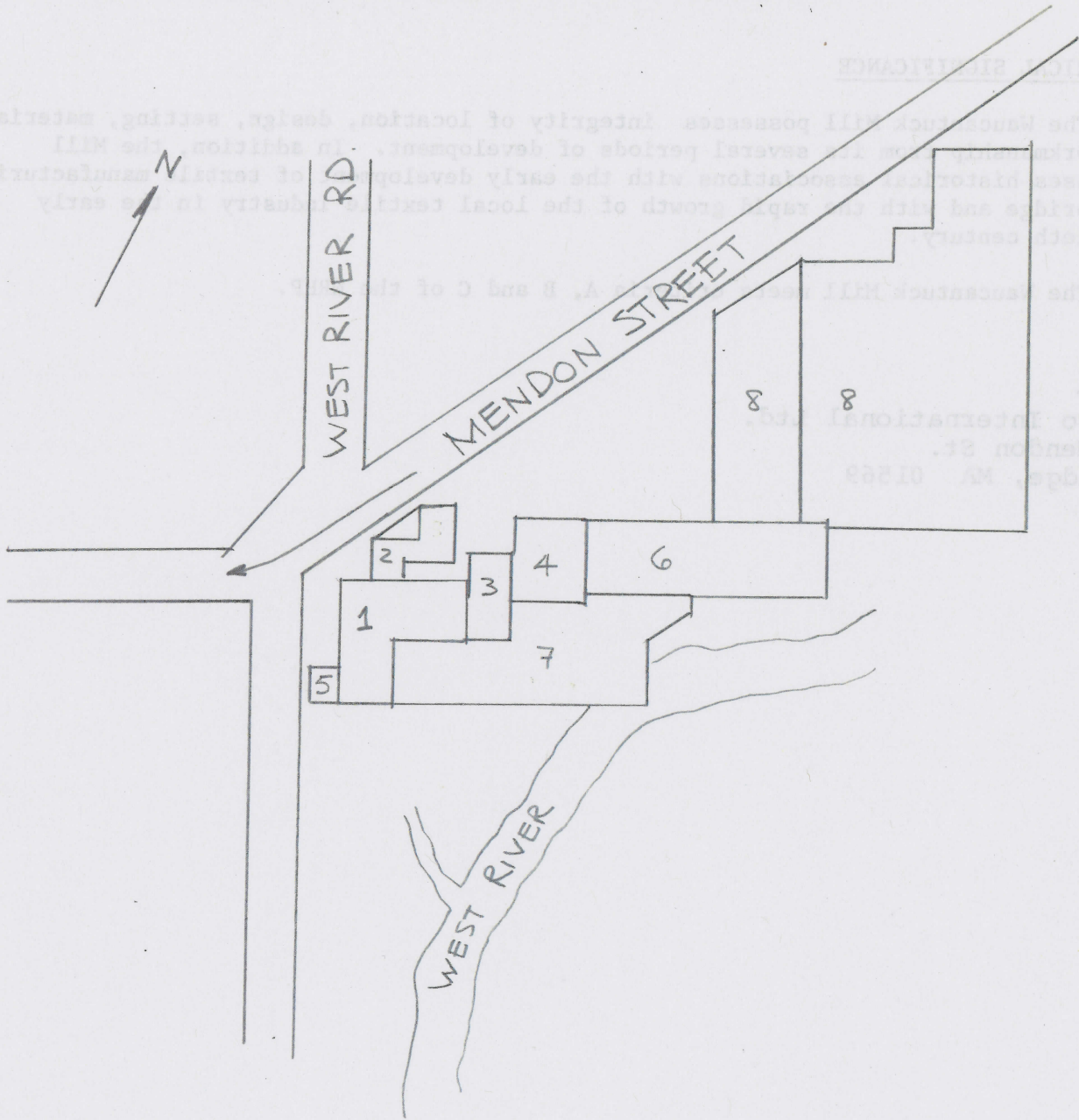

Staple to Inventory form at bottom

INVENTORY FORM CONTINUATION SHEET

MASSACHUSETTS HISTORICAL COMMISSION #4  
Office of the Secretary, Boston

Community: Uxbridge	Form No: 43-G
Property Name: Waucantuck Mill	

Indicate each item on inventory form which is being continued below.

HISTORICAL SIGNIFICANCE

The Waucantuck Mill possesses integrity of location, design, setting, materials and workmanship from its several periods of development. In addition, the Mill possesses historical associations with the early development of textile manufacturing in Uxbridge and with the rapid growth of the local textile industry in the early twentieth century.

The Waucantuck Mill meets criteria A, B and C of the NRHP.

OWNER

Spalco International Ltd.  
237 Mendon St.  
Uxbridge, MA 01569

Staple to Inventory form at bottom

NATIONAL REGISTER OF HISTORIC PLACES  
EVALUATION/RETURN SHEET

Waucantuck Mill Complex (Uxbridge MRA)  
Worcester County  
MASSACHUSETTS

AUG 26 1983

Working No. \_\_\_\_\_  
Fed. Reg. Date: \_\_\_\_\_  
Date Due: 9/22/83 - 10/10/83  
Action:  ACCEPT  
 RETURN 10/7/83  
 REJECT  
Federal Agency: \_\_\_\_\_

- resubmission
- nomination by person or local government
- owner objection
- appeal

Substantive Review:  sample  request  appeal  NR decision

Reviewer's comments:

Recom./Criteria \_\_\_\_\_  
Reviewer \_\_\_\_\_  
Discipline \_\_\_\_\_  
Date \_\_\_\_\_  
\_\_\_\_\_ see continuation sheet

Nomination returned for:  technical corrections cited below  
 substantive reasons discussed below

1. Name

2. Location

3. Classification

Category	Ownership	Status	Present Use
	Public Acquisition	Accessible	

4. Owner of Property

5. Location of Legal Description

6. Representation in Existing Surveys

Has this property been determined eligible?  yes  no

7. Description

Condition	Check one	Check one
<input type="checkbox"/> excellent	<input type="checkbox"/> deteriorated	<input type="checkbox"/> original site
<input type="checkbox"/> good	<input type="checkbox"/> ruins	<input type="checkbox"/> moved date _____
<input type="checkbox"/> fair	<input type="checkbox"/> unexposed	
	<input type="checkbox"/> unaltered	
	<input type="checkbox"/> altered	

Describe the present and original (if known) physical appearance

- summary paragraph
- completeness
- clarity
- alterations/integrity
- dates
- boundary selection

**8. Significance**

Period \_\_\_\_\_ Areas of Significance—Check and justify below

Specific dates \_\_\_\_\_ Builder/Architect \_\_\_\_\_

Statement of Significance (in one paragraph)

- summary paragraph
- completeness
- clarity
- applicable criteria
- justification of areas checked
- relating significance to the resource
- context
- relationship of integrity to significance
- justification of exception
- other

WASHINGTON STATE HISTORICAL SOCIETY  
 1000 UNIVERSITY AVENUE  
 SEASIDE, WA 98134

**9. Major Bibliographical References**

**10. Geographical Data**

Acreage of nominated property \_\_\_\_\_

Quadrangle name \_\_\_\_\_

UTM References \_\_\_\_\_

*Please provide acreage*

Verbal boundary description and justification

**11. Form Prepared By**

**12. State Historic Preservation Officer Certification**

The evaluated significance of this property within the state is:

\_\_\_ national \_\_\_ state \_\_\_ local

State Historic Preservation Officer signature

title \_\_\_\_\_ date \_\_\_\_\_

**13. Other**

- Maps
- Photographs
- Other

Questions concerning this nomination may be directed to \_\_\_\_\_

Signed *Al Byers* Date *10/7/83* Phone: \_\_\_\_\_

United States Department of the Interior  
National Park Service

National Register of Historic Places  
Inventory—Nomination Form

For NPS use only  
received 5/26/83  
date entered

Continuation sheet

Item number

Page 4 of 5

Multiple Resource Area  
Thematic Group

Name Uxbridge Multiple Resource Area

State MA

Nomination/Type of Review

Substantive Review

Date/Signature  
Determined Eligible

31. Sprague, Albert, House

DOE/OWNER OBJECTION

Keeper Eligible Patrick Andrews 10/7/83

Attest

32. Southwick, Elisha, House

Entered in the  
National Register

for Keeper Melvyn Byers 10/7/83

Attest

33. Southwick, Israel, House

Entered in the  
National Register

for Keeper Melvyn Byers 10/7/83

Attest

231

34. Farnum, William and Mary,  
House

Substantive Review

for Keeper Bruce Lee David 1/20/84

Attest

35. Thomson, C. R., House  
and Barn

Entered in the  
National Register

for Keeper Melvyn Byers 10/7/83

Attest

36. Uxbridge Common District

Keeper Bruce Lee David 1/20/84

Attest

37. Uxbridge Passenger Depot

Entered in the  
National Register

for Keeper Melvyn Byers 10/7/83

Attest

38. Uxbridge Town Hall

Entered in the  
National Register

for Keeper Melvyn Byers 10/7/83

Attest

39. Waucantuck Mill Complex

Entered in the  
National Register

for Keeper Melvyn Byers 1/20/84

Attest

40. Wheelockville District

Entered in the  
National Register

for Keeper Melvyn Byers 1/20/84

Attest

NATIONAL REGISTER OF HISTORIC PLACES  
EVALUATION/RETURN SHEET

Waucantuck Mill Complex (Uxbridge MRA)  
Worcester County  
MA

Working No. 8-26-83

Fed. Reg. Date: 7-5-85

Date Due: 1/20/84

Action:  ACCEPT 1/20/84

RETURN

REJECT

Entered in the  
National Register

Federal Agency: \_\_\_\_\_

- resubmission
- nomination by person or local government
- owner objection
- appeal

Substantive Review:  sample  request  appeal  NR decision

Reviewer's comments:

*Survey provided.*

Recom./Criteria Accept / ABC

Reviewer Mr. [unclear]

Discipline A-11

Date 1-20-84

\_\_\_\_\_ see continuation sheet

Nomination returned for:  technical corrections cited below  
 substantive reasons discussed below

1. Name

2. Location

3. Classification

Category	Ownership	Status	Present Use
	Public Acquisition	Accessible	

4. Owner of Property

5. Location of Legal Description

6. Representation in Existing Surveys

Has this property been determined eligible?  yes  no

7. Description

Condition		Check one	Check one
<input type="checkbox"/> excellent	<input type="checkbox"/> deteriorated	<input type="checkbox"/> unaltered	<input type="checkbox"/> original site
<input type="checkbox"/> good	<input type="checkbox"/> ruins	<input type="checkbox"/> altered	<input type="checkbox"/> moved date _____
<input type="checkbox"/> fair	<input type="checkbox"/> unexposed		

Describe the present and original (if known) physical appearance

- summary paragraph
- completeness
- clarity
- alterations/integrity
- dates
- boundary selection

---

**8. Significance**

Period \_\_\_\_\_ Areas of Significance—Check and justify below

Specific dates \_\_\_\_\_ Builder/Architect \_\_\_\_\_

Statement of Significance (*in one paragraph*)

- summary paragraph
- completeness
- clarity
- applicable criteria
- justification of areas checked
- relating significance to the resource
- context
- relationship of integrity to significance
- justification of exception
- other

---

**9. Major Bibliographical References**

---

**10. Geographical Data**

Acreage of nominated property \_\_\_\_\_

Quadrangle name \_\_\_\_\_

UTM References \_\_\_\_\_

---

Verbal boundary description and justification

---

**11. Form Prepared By**

---

**12. State Historic Preservation Officer Certification**

The evaluated significance of this property within the state is:

\_\_\_\_\_ national \_\_\_\_\_ state \_\_\_\_\_ local

State Historic Preservation Officer signature

title

date

---

**13. Other**

- Maps
- Photographs
- Other

Questions concerning this nomination may be directed to \_\_\_\_\_

Signed \_\_\_\_\_ Date \_\_\_\_\_ Phone: \_\_\_\_\_



Town: Uxbridge

*W.R.A. Ma*

Form #43-G

Waucantuck Mill

left to right-

Sections #2, 1 & 5



Town: Uxbridge

*MRA, Ma*

Form #43-G

Waucantuck Mill

left to right-

Sections #7, 2 & 5



Please refer to the map in the  
Multiple Property Cover Sheet  
for this property

Multiple Property Cover Sheet Reference Number: 64000299