

MASSACHUSETTS HISTORICAL COMMISSION
294 Washington Street, Boston, MA 02108

Roll 18:26A

PHOTO (3x3" or 3x5", black & white)
Staple to left side of form
Photo number _____

Town Stoneham

Address 461 Main St.

Historic Name First Baptist Church

Use: Original church

Present church

Ownership: Private individual

Private organization First Baptist Church

Public

Original owner First Baptist Church

SKETCH MAP

Draw map showing property's location in relation to nearest cross streets and other buildings or geographical features. Indicate north.

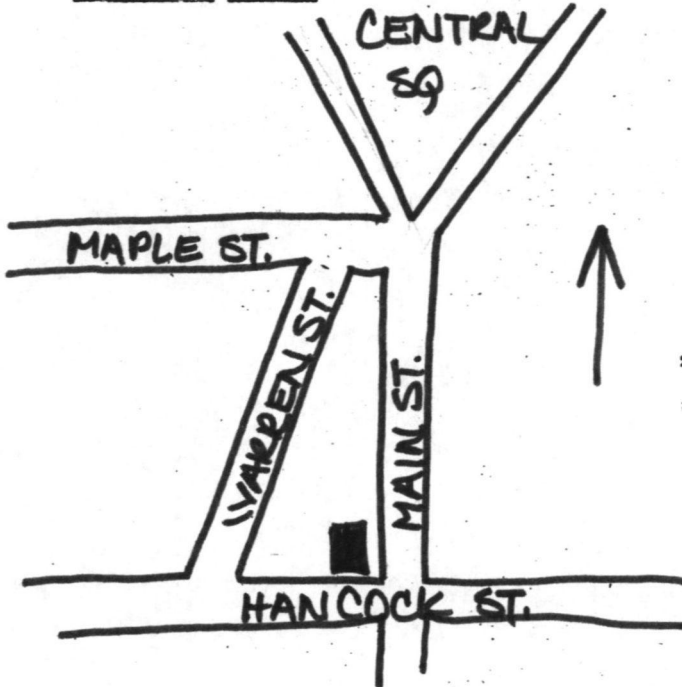

DESCRIPTION:

Date 1892

Source documents

Style Queen Anne

Architect L.B. Volk & Sons, Brooklyn, N.Y.

Exterior wall fabric brick

Outbuildings none

Major alterations (with dates) _____

roof slate changed to asphalt shingles

Moved no Date _____

Approx. acreage 14,498 sq. ft.

Setting mix of commercial, residential and institutional

Recorded by Candace Jenkins with Carole Zellie

Organization Landscape Research

Date May, 1979

Assessor's Map #13-296

UTM: Boston North Quad
13/327270/4704640

(Staple additional sheets here)

ARCHITECTURAL SIGNIFICANCE (describe important architectural features and evaluate in terms of other buildings within community)

The First Baptist Church is the latest of three well preserved nineteenth century churches, and the only one whose architect is known. Constructed in 1892, it is more complex in plan and massing than its predecessors and combines bricks and shingles in its construction. In general, the first story is brick, while the gabled areas and the tower are shingled. The main body of the church is rectangular with two cross gables facing east toward Main Street and a two story tower projecting out between them. The gables contain arched, stained glass windows and decorative corbeled courses. The three stage tower consists of a base with triangular hooded entry, an elongated belfry with paired arched openings containing stained glass rondels, and a four sided steeple. A secondary entry is located at the southern end of the facade.

HISTORICAL SIGNIFICANCE (explain the role owners played in local or state history and how the building relates to the development of the community)

The First Baptist Church possesses integrity of location, design, setting, materials, and workmanship. It is significant as a well detailed, architect designed, Queen Anne style church and for its associations with the First Baptist Society. Organized in 1870, the First Baptist Church began formal services as a chapel on Common Street which served until 1892 and the construction of the present church. This building is one of the finest masonry structures in central Stoneham, and few of its original features have been altered. The First Baptist Church replaced the estate of Luther Hill, a prominent local manufacturer of shoes.

It meets criteria A and C of the National Register of historic places.

BIBLIOGRAPHY and/or REFERENCES

W. Stevens, History of Stoneham

United States Department of the Interior
National Park Service

National Register of Historic Places
Inventory—Nomination Form

For NPS use only
received 3/28/84
date entered

Continuation sheet

Item number

Page 3 of 7

Multiple Resource Area
Thematic Group

Name Stoneham Multiple Resource Area
State Middlesex County, MASSACHUSETTS

Nomination/Type of Review

Date/Signature

- | | | | |
|---------------------------------------|---|--|--------------|
| 21. Farrier, Amasa, Boardinghouse | Entered in the
National Register | for Keeper <u>Delores Byers</u> <u>4/13/84</u> | Attest _____ |
| 22. Farrier, Amasa, House | Entered in the
National Register | for Keeper <u>Delores Byers</u> <u>4/13/84</u> | Attest _____ |
| 23. First Baptist Church | Entered in the
National Register | for Keeper <u>Delores Byers</u> <u>4/13/84</u> | Attest _____ |
| 24. First Congregational Church | Entered in the
National Register | for Keeper <u>Delores Byers</u> <u>4/13/84</u> | Attest _____ |
| 25. First Unitarian Church | Entered in the
National Register | for Keeper <u>Delores Byers</u> <u>4/13/84</u> | Attest _____ |
| 26. Foley, Michael, Cottage | Entered in the
National Register | for Keeper <u>Delores Byers</u> <u>4/13/84</u> | Attest _____ |
| 27. Foster, Walter K.,
House | Entered in the
National Register | for Keeper <u>Delores Byers</u> <u>4/13/84</u> | Attest _____ |
| 28. Fuller, Enoch, House | Entered in the
National Register | for Keeper <u>Delores Byers</u> <u>4/13/84</u> | Attest _____ |
| 29. Fuller, William Griffin,
House | Entered in the
National Register | for Keeper <u>Delores Byers</u> <u>4/13/84</u> | Attest _____ |
| 30. Gill, Charles, House | Entered in the
National Register | for Keeper <u>Delores Byers</u> <u>4/13/84</u> | Attest _____ |

NATIONAL REGISTER OF HISTORIC PLACES
EVALUATION/RETURN SHEET

First Baptist Church (Stoneham MRA)
Middlesex County
MASSACHUSETTS

Working No. FEB 28 1984

Fed. Reg. Date: 2/5/85

Date Due: 3-29-84 - 4-13-84

Action: ACCEPT 4-13-84

RETURN

REJECT

Federal Agency: _____

Entered in the
National Register

- resubmission
- nomination by person or local government
- owner objection
- appeal

Substantive Review: sample request appeal NR decision

Reviewer's comments:

Recom./Criteria _____
 Reviewer _____
 Discipline _____
 Date _____
 _____ see continuation sheet

Nomination returned for: _____ technical corrections cited below
 _____ substantive reasons discussed below

1. Name

2. Location

3. Classification

Category	Ownership Public Acquisition	Status Accessible	Present Use
----------	---------------------------------	----------------------	-------------

4. Owner of Property

5. Location of Legal Description

6. Representation in Existing Surveys

Has this property been determined eligible? yes no

7. Description

Condition

<input type="checkbox"/> excellent	<input type="checkbox"/> deteriorated	Check one	<input type="checkbox"/> original site
<input type="checkbox"/> good	<input type="checkbox"/> ruins	<input type="checkbox"/> unaltered	<input type="checkbox"/> moved date _____
<input type="checkbox"/> fair	<input type="checkbox"/> unexposed	<input type="checkbox"/> altered	

Describe the present and original (if known) physical appearance

- summary paragraph
- completeness
- clarity
- alterations/integrity
- dates
- boundary selection



First Baptist Church

Stonham MA, Ma

8120

TOWN OF STONEHAM PRESENT DATE ASSESSOR'S MAP

1" = 200'

Page 1 of 2 267 246

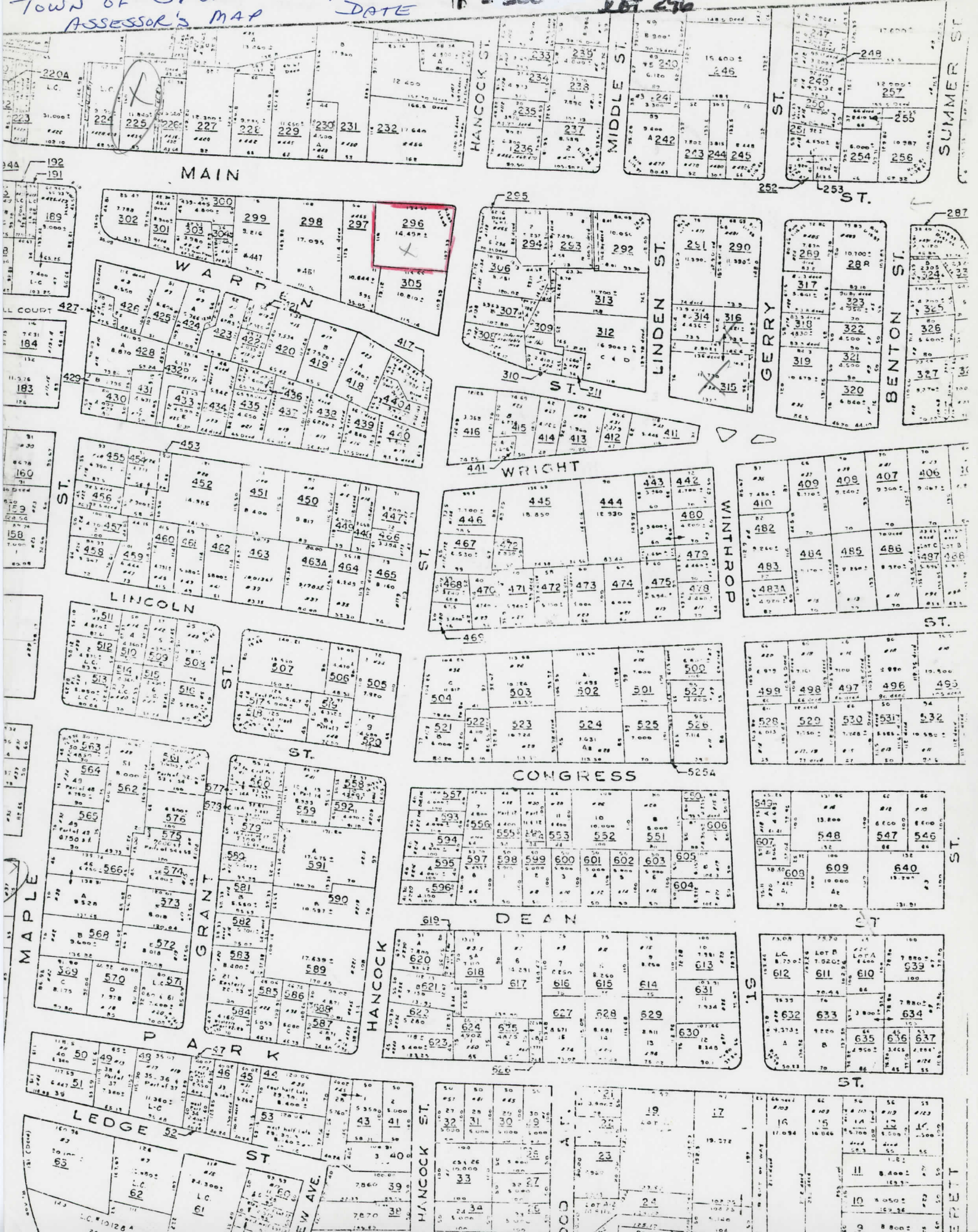

Please refer to the map in the
Multiple Property Cover Sheet
for this property

Multiple Property Cover Sheet Reference Number: 64000295