

FORM B - BUILDING

MASSACHUSETTS HISTORICAL COMMISSION
Office of the Secretary, State House, Boston

In Area no.	Form no.
Old Camb.	OC IIB3



1. Town Cambridge

Address 144 Coolidge Hill Street

Name Joseph Holmes House

Use residential

Present owner Elizabeth G. Ferry

Description:

Year 1801, 1929

Source deed records

Style Federal

Architect John Holmes, housewright

Exterior wall fabric wood clapboard

Outbuildings (describe) -----

Other features small Federal house

featuring a porch with delicate

triglyphs, papyrus leaf capitals.

Altered Yes- service wing added Date 1929

Moved Yes Date 1929

5. Lot size:

One acre or less XX Over one acre

Approximate frontage 100 feet

Approximate distance of building from street

18 feet

6. Recorded by Bainbridge Bunting

Organization Cambridge Historical Comm.

Date 1964

UTM-NEWTON

19/323790/4693000

4. Map. Draw sketch in relation to nearest cross streets and other buildings. Indicate north.

1110-22A

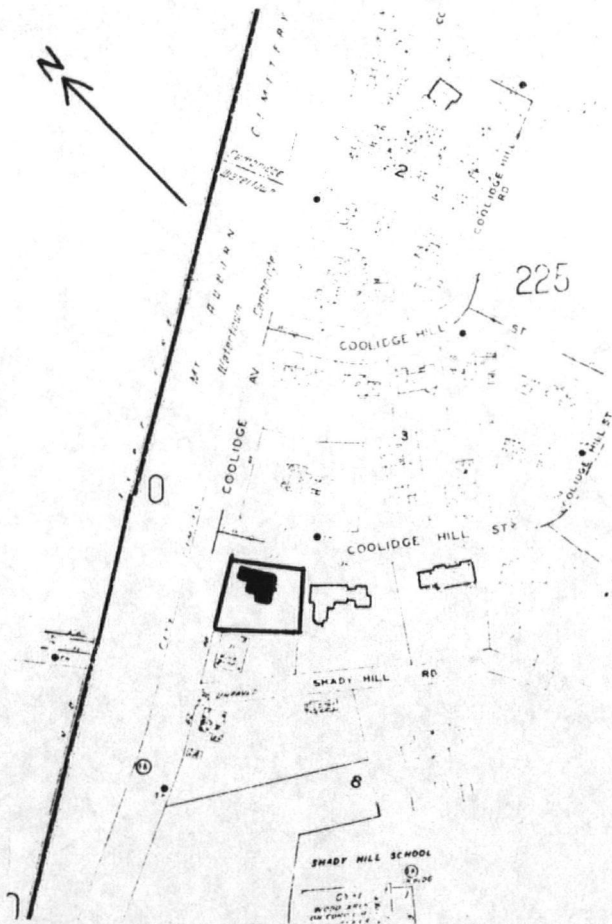

ASSESSOR # 242A-127

NOV 14 1980

7. Original owner (if known) Joseph Holmes
 Original use residential
 Subsequent uses (if any) and dates same

8. Themes (check as many as applicable)

Aboriginal	_____	Conservation	_____	Recreation	_____
Agricultural	_____	Education	_____	Religion	_____
Architectural	<u>XX</u>	Exploration/ settlement	_____	Science/ invention	_____
The Arts	_____	Industry	_____	Social/ humanitarian	_____
Commerce	_____	Military	_____	Transportation	_____
Communication	_____	Political	_____		
Community development	<u>XX</u>				

9. Historical significance (include explanation of themes checked above)

This trim Federal house was originally located at 15 Appian Way and moved to its present location and the service wing added in 1929.

The square plan house is adapted to its narrow lot by being turned with the entrance toward the side yard. The porch has delicate triglyphs, papyrus leaf capitals and an elliptical fan. Records indicate that John Holmes, father of Joseph Holmes, built other dwellings in Cambridge during the early nineteenth century.

The relocation of the house in 1929 when there was increasing pressure for development in Harvard Square saved it from demolition. The dearth of buildings of this early date makes this house worthy of recognition on its architectural merits despite the move.

10. Bibliography and/or references (such as local histories, deeds, assessor's records, early maps, etc.)

NATIONAL REGISTER OF HISTORIC PLACES

United States Department of the Interior
National Park Service

EVALUATION / RETURN SHEET

Property: Holmes, Joseph, House
Cambridge Multiple Resource Area
State, County: MA - Middlesex
Federal Agency: _____

Working No. 11-14-80 2862
Fed. Reg. Date: _____
Date Due: 4/17/82
Action: ACCEPT
 RETURN 4/13/82
 REJECT _____

- resubmission
- nomination by person or local government
- owner objection
- appeal

photos 1
maps _____

Substantive Review: sample request appeal NR decision

Reviewer's comments:

*Insufficient statement of architectural significance.
- Although an example of Federal architecture, no real contextual and evaluative information has been provided.*

Recom./Criteria Return
Reviewer Brachman
Discipline arch. historian
Date 4.2.82

see continuation sheet

Nomination returned for: technical corrections cited below
 substantive reasons discussed below

1. Name

2. Location

3. Classification

Category Ownership Status Present Use
Public Acquisition Accessible

4. Owner of Property

5. Location of Legal Description

6. Representation in Existing Surveys

has this property been determined eligible? yes no

7. Description

Condition excellent good fair deteriorated ruins unexposed
Check one unaltered altered
Check one original site moved date _____

Describe the present and original (if known) physical appearance

- summary paragraph
- completeness
- clarity
- alterations/integrity
- dates
- boundary selection

8. Significance

Period _____ Areas of Significance—Check and justify below

Specific dates _____ Builder/Architect _____

Statement of Significance (in one paragraph)

- _____ summary paragraph
- _____ completeness
- _____ clarity
- _____ applicable criteria
- _____ justification of areas checked
- _____ relating significance to the resource
- _____ context
- _____ relationship of integrity to significance
- _____ justification of exception
- _____ other

9. Major Bibliographical References

10. Geographical Data

Average of nominated property _____

Quadrangle name _____

USIT References _____

Verbal boundary description and justification _____

11. Form Prepared By

12. State Historic Preservation Officer Certification

The evaluated significance of this property within the state is:

_____ national _____ state _____ local

State Historic Preservation Officer signature _____

title _____ date _____

13. Other

- _____ Maps
- _____ Photographs
- _____ Other

Questions concerning this nomination may be directed to Patrick Andrews

Signed Brabban Date 4.13.82 Phone: 202 272-3504

Comments for any item may be continued on an attached sheet

FORM B - BUILDING

MASSACHUSETTS HISTORICAL COMMISSION
Office of the Secretary, State House, Boston

In Area no.	Form no.
Old Camb.	OC IIB3

1. Town Cambridge

Address 144 Coolidge Hill Street

Name Joseph Holmes House

Present use residential

Present owner Elizabeth G. Ferry

3. Description:

Date 1801, 1929

Source deed records

Style Federal

Architect John Holmes, housewright

Exterior wall fabric wood clapboard

Outbuildings (describe) -----

Other features small Federal house

featuring a porch with delicate

triglyphs, papyrus leaf capitals.

Altered Yes- service wing added Date 1929

Moved Yes Date 1929

5. Lot size:

One acre or less Over one acre

Approximate frontage 100 feet

Approximate distance of building from street

18 feet

6. Recorded by Bainbridge Bunting

Organization Cambridge Historical Comm.

Date 1964

UTM-NEWTON

19/323790/4693060

2. Photo (3x3" or 3x5")
Staple to left side of form
Photo number 1110-22A

4. Map. Draw sketch of building location in relation to nearest cross streets and other buildings. Indicate north.

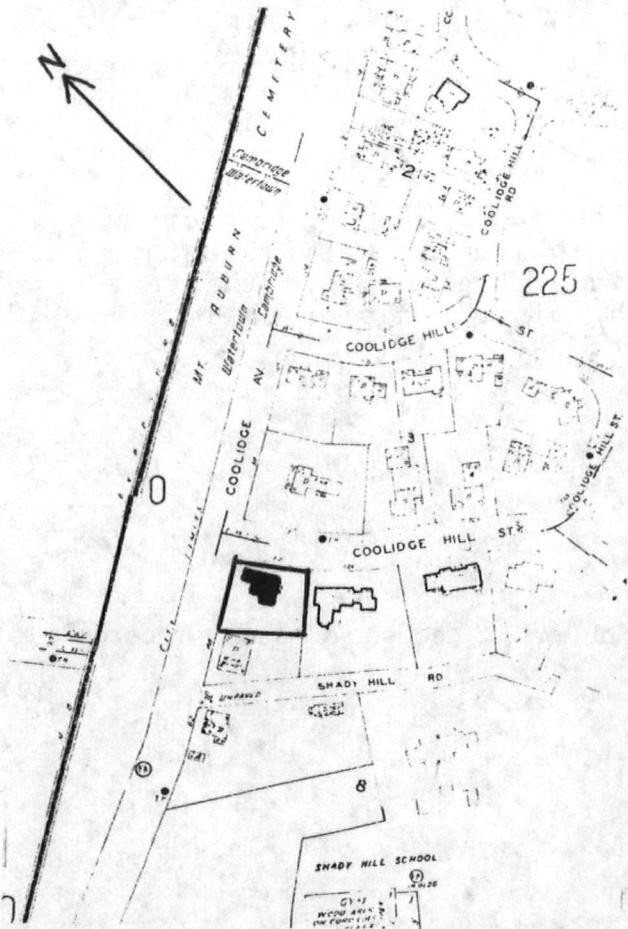

ASSESSOR # 242A-127

NOV 14 1980

7. Original owner (if known) Joseph Holmes
 Original use residential
 Subsequent uses (if any) and dates same

8. Themes (check as many as applicable)

Aboriginal	<input type="checkbox"/>	Conservation	<input type="checkbox"/>	Recreation	<input type="checkbox"/>
Agricultural	<input type="checkbox"/>	Education	<input type="checkbox"/>	Religion	<input type="checkbox"/>
Architectural	<input checked="" type="checkbox"/>	Exploration/ settlement	<input type="checkbox"/>	Science/ invention	<input type="checkbox"/>
The Arts	<input type="checkbox"/>	Industry	<input type="checkbox"/>	Social/ humanitarian	<input type="checkbox"/>
Commerce	<input type="checkbox"/>	Military	<input type="checkbox"/>	Transportation	<input type="checkbox"/>
Communication	<input type="checkbox"/>	Political	<input type="checkbox"/>		
Community development	<input checked="" type="checkbox"/>				

9. Historical significance (include explanation of themes checked above)

This trim Federal house was originally located at 15 Appian Way and moved to its present location and the service wing added in 1929.

The square plan house is adapted to its narrow lot by being turned with the entrance toward the side yard. The porch has delicate triglyphs, papyrus leaf capitals and an elliptical fan. Records indicate that John Holmes, father of Joseph Holmes, built other dwellings in Cambridge during the early nineteenth century.

The relocation of the house in 1929 when there was increasing pressure for development in Harvard Square saved it from demolition. The dearth of buildings of this early date makes this house worthy of recognition on its architectural merits despite the move.

10. Bibliography and/or references (such as local histories, deeds, assessor's records, early maps, etc.)

INVENTORY FORM CONTINUATION SHEET

MASSACHUSETTS HISTORICAL COMMISSION
Office of the Secretary, Boston

Community: Old Cambridge	Form No: OC II.B.3
Property Name: Joseph Holmes House	

Indicate each item on inventory form which is being continued below.

The Joseph Holmes House is one of only 28 houses remaining in Old Cambridge which were built between 1800 and 1833, a period in which development in Cambridge was taking place in East Cambridge and Cambridgeport at the expense of the older section of town. The house is an unpretentious example of a rather standard, five bay, center entrance Federal period house that is significant because of its relative rarity and excellent state of preservation.

Its present location in Coolidge Hill, a real estate subdivision of the 1920s, is indicative of the regard shown for Federal houses during that period and the frequency with which they were moved. Other examples of this trend are the Hall Tavern (also nominated), built in 1798 and moved from Duxbury in 1930, and the Edward Marrett House, built in 1760 and moved from Dunster Street to Manchester, Massachusetts, in 1926.

The Holmes House is significant under Criterion C, as embodying the distinctive characteristics of its type and period.

Staple to Inventory form at bottom

United States Department of the Interior
National Park Service

National Register of Historic Places
Inventory—Nomination Form

For NPS use only
received
date entered

Continuation sheet

Item number

Page 11 of 17

Multiple Resource Area
Thematic Group

Name Cambridge Multiple Resource Area

State MA

Nomination/Type of Review

Date/Signature

101. Harvard Graduate Center ~~Substantive Review~~ Keeper

DOE/OWNER OBJECTION

Attest

Ret 6/10/82

Harvard

102. Child, Francis J., House ~~Substantive Review~~ ✓ Keeper

Attest

William H. Brackham 6.30.83

103. Hill, Aaron, House ~~Substantive Review~~ ✓ Keeper

Attest

William H. Brackham 6.30.82

104. Cook, William, House ~~Substantive Review~~ ✓ Keeper

Attest

William H. Brackham 4.13.82

105. Building at 10 Follen Street ~~Substantive Review~~ ✓ Keeper

Attest

William H. Brackham 4.13.82

106. Hall Tavern ~~Substantive Review~~ ✓ Keeper

Attest

William H. Brackham 6.30.83

107. Cloverden (Mann House) ~~Substantive Review~~ ✓ Keeper

Attest

William H. Brackham 6.30.83

108. The Fairfax ~~Substantive Review~~ ✓ Keeper

DOE/OWNER OBJECTION

Attest

Ret 6/10/82

Harvard

109. Larches, The ~~Substantive Review~~ ✓ Keeper

Attest

William H. Brackham 4.13.82

110. Holmes, Joseph, House ~~Substantive Review~~ ✓ Keeper

Attest

William H. Brackham 6.30.83

United States Department of the Interior
National Park Service

Substantive Review

Holmes, Joseph, House (Cambridge MRA)
Middlesex County
MA

Working No. 11.14.80-2862
Fed. Reg. Date: 2-7-84
Date Due: 7/4/83
Action: ACCEPT 6/30/83
 RETURN
 REJECT

- resubmission
- nomination by person or local government
- owner objection
- appeal

Federal Agency: _____

Substantive Review: sample request appeal NR decision

Reviewer's comments:

Context and significance provided.

Recom./Criteria c/accept
Reviewer [Signature]
Discipline A.H.
Date 6.30.83
see continuation sheet

Nomination returned for: technical corrections cited below
 substantive reasons discussed below

1. Name

2. Location

3. Classification

Category Ownership Status Present Use
Public Acquisition Accessible

4. Owner of Property

5. Location of Legal Description

6. Representation in Existing Surveys

has this property been determined eligible? yes no

7. Description

Condition excellent deteriorated good fair
Check one unaltered altered
Check one original site moved date _____
 unexposed

Describe the present and original (if known) physical appearance

- summary paragraph
- completeness
- clarity
- alterations/integrity

8. Significance

Period _____ Area of Significance—Check and justify below

Specific dates _____ Builder Architect _____

Statement of Significance (in one paragraph)

- summary paragraph
- completeness
- clarity
- applicable criteria
- justification of areas checked
- relating significance to the resource
- context
- relationship of integrity to significance
- justification of exception
- other

9. Major Bibliographical References

10. Geographical Data

Acres of nominated property _____

Quadrangle name _____

UMT References _____

Verbal boundary description and justification _____

11. Form Prepared By

12. State Historic Preservation Officer Certification

The evaluated significance of this property within the state is:

national state local

State Historic Preservation Officer signature _____

title _____ date _____

13. Other

- Maps
- Photographs
- Other

Questions concerning this nomination may be directed to _____

Signed _____ Date _____ Phone: 202 272-3504

Comments for any item may be continued on an attached sheet



1110-22A

NOV 14 1980

Cambridge MRA, Ma

Holmes, Joseph, House

144 Coolidge Hill St.

1110-22A

Please refer to the map in the
Multiple Property Cover Sheet
for this property

Multiple Property Cover Sheet Reference Number: 64000275