

FORM B - BUILDING

MASSACHUSETTS HISTORICAL COMMISSION
Office of the Secretary, State House, Boston

In Area no.	Form no.
Old Camb.	OC IIB9

1. Town Cambridge

Address 24 Coolidge Hill Road

Building Josiah Coolidge House

Present use residential

Present owner Alexander A. Anderson

Description:

Period 1822-25, 1900

Source deed records

Style Originally Federal

Architect unknown

Exterior wall fabric clapboard

Outbuildings (describe) -----

Other features extensive alterations

include addition of dormers, and

formation of two front bays.

Altered Yes-alterations Date primarily

Moved No Date 1900

5. Lot size:

One acre or less Over one acre

Approximate frontage 36 feet

Approximate distance of building from street

56 feet

6. Recorded by Bainbridge Bunting

Organization Cambridge Historical Comm.

Date 1964

UTM - NEWTON QUAD

19/323940/4693320



4. Map. 1110-21A
in relation to nearest cross streets and
other buildings. Indicate north.

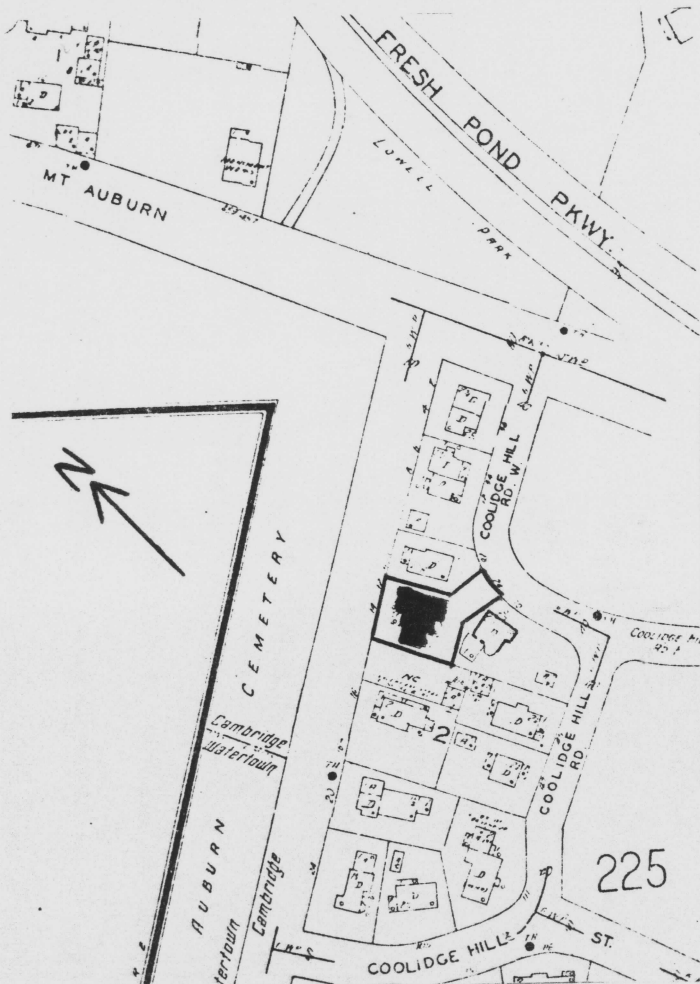

ASSESSOR # 242A-23

7. Original owner (if known) Josiah Coolidge
 Original use residential
 Subsequent uses (if any) and dates same

8. Themes (check as many as applicable)

Aboriginal	<input type="checkbox"/>	Conservation	<input type="checkbox"/>	Recreation	<input type="checkbox"/>
Agricultural	<input type="checkbox"/>	Education	<input type="checkbox"/>	Religion	<input type="checkbox"/>
Architectural	<input checked="" type="checkbox"/>	Exploration/ settlement	<input type="checkbox"/>	Science/ invention	<input type="checkbox"/>
The Arts	<input type="checkbox"/>	Industry	<input type="checkbox"/>	Social/ humanitarian	<input type="checkbox"/>
Commerce	<input type="checkbox"/>	Military	<input type="checkbox"/>	Transportation	<input type="checkbox"/>
Communication	<input type="checkbox"/>	Political	<input type="checkbox"/>		
Community development	<input checked="" type="checkbox"/>				

9. Historical significance (include explanation of themes checked above)

This is the much remodelled Coolidge farmhouse, one of five structures of some antiquity surviving on the hill.

In 1821 Josiah Coolidge bought 33-1/2 acres of land and began to build the house the next year, starting with the ell. It was completely finished by 1828.

The original Federal house has been altered greatly over the years: the roof line was changed, dormers were added, and the two sides of the front porch were enclosed and made into bays.

Because of the extensive alterations, the house is more significant^{as} a study of the development of a house over a period of 150 years than as an example of Federal architecture.

It is also the last remnant of the last surviving farm in Cambridge to succumb to development. Until the early twentieth century, the Coolidge Farm preserved the farm open spaces which once typified Cambridge.

10. Bibliography and/or references (such as local histories, deeds, assessor's records, early maps, etc.)

NOV 4 1980

NATIONAL REGISTER OF HISTORIC PLACES

United States Department of the Interior
National Park Service

EVALUATION / RETURN SHEET

Property: Coolidge, Josiah, House
Cambridge Multiple Resource Area
State, County: MA - Middlesex
Federal Agency: _____

Working No. 11-14-80-2862
Fed. Reg. Date: _____
Date Due: 4-17-82
Action: ACCEPT
 RETURN 4/13/82
 REJECT

- resubmission
- nomination by person or local government
- owner objection
- appeal

photos
maps _____

Substantive Review: sample request appeal NR decision

Reviewer's comments:

Significance as an evolutionary architectural example needs to be thoroughly defined. ~~It is not an appearance~~ ~~should be kept~~ A statement justifying just why this property meets criterion C needs to be provided.

Recom./Criteria Return
Reviewer Brakman
Discipline Arch. His
Date 4.13.82

Former associations with open spaces seem rather useless now.

____ see continuation sheet

Nomination returned for: technical corrections cited below
 substantive reasons discussed below

1. Name

2. Location

3. Classification

Category Ownership Status Present Use
Public Acquisition Accessible

4. Owner of Property

5. Location of Legal Description

6. Representation in Existing Surveys

Has this property been determined eligible? yes no

7. Description

Condition: excellent deteriorated good ruins fair unexposed
Check one: unaltered altered
Check one: original site moved date _____

Describe the present and original (if known) physical appearance

- ____ summary paragraph
- ____ completeness
- ____ clarity
- ____ alterations/integrity
- ____ dates
- ____ boundary selection

8. Significance

Period _____ Area of Significance—Check and justify below

Specific dates _____ Builder/Architect _____

Statement of Significance (in one paragraph)

- summary paragraph
- completeness
- clarity
- applicable criteria
- justification of areas checked
- relating significance to the resource
- context
- relationship of integrity to significance
- justification of exception
- other

9. Major Bibliographical References

10. Geographical Data

Acres of nominated property _____

Quadrangle name _____

USGS Reference _____

Verbal boundary description and justification _____

11. Form Prepared By

12. State Historic Preservation Officer Certification

The evaluated significance of this property within the state is:

national state local

State Historic Preservation Officer signature _____

title _____ date _____

13. Other

- Maps
- Photographs
- Other

Questions concerning this nomination may be directed to _____

Signed Brathorn Date 4.13.82 Phone: 202 272-3504

Comments for any item may be continued on an attached sheet

FORM B - BUILDING

MASSACHUSETTS HISTORICAL COMMISSION
Office of the Secretary, State House, Boston

In Area no.	Form no.
Old Camb.	OC IIB9

1. Town Cambridge

Address 24 Coolidge Hill Road

Name Josiah Coolidge House

Present use residential

Present owner Alexander A. Anderson

3. Description:

Date 1822-25, 1900

Source deed records

Style Originally Federal

Architect unknown

Exterior wall fabric clapboard

Outbuildings (describe) -----

Other features extensive alterations

include addition of dormers, and
formation of two front bays.

Altered Yes-alterations Date primarily

Moved No Date 1900

5. Lot size:

One acre or less Over one acre

Approximate frontage 36 feet

Approximate distance of building from street
56 feet

6. Recorded by Bainbridge Bunting

Organization Cambridge Historical Comm.

Date 1964

UTM - NEWTON QUAD

19/323940/4693320

2. Photo (3x3" or 3x5")
Staple to left side of form
Photo number 1110-21A

4. Map. Draw sketch of building location
in relation to nearest cross streets and
other buildings. Indicate north.

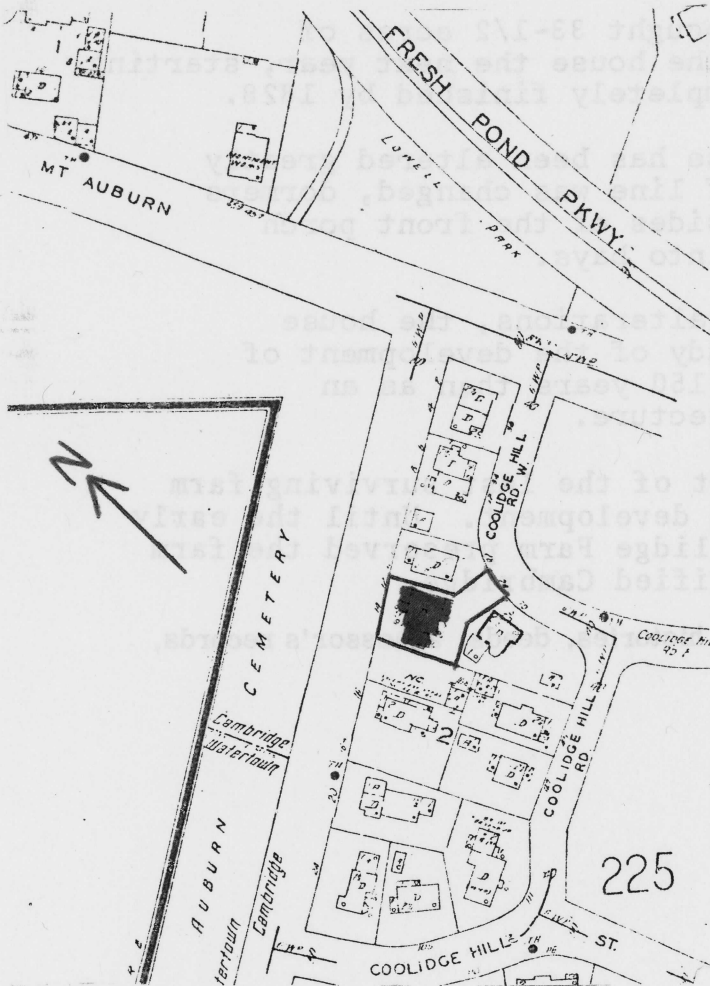

ASSESSOR # 242A-23

7. Original owner (if known) Josiah Coolidge

Original use residential

Subsequent uses (if any) and dates same

8. Themes (check as many as applicable)

Aboriginal	_____	Conservation	_____	Recreation	_____
Agricultural	_____	Education	_____	Religion	_____
Architectural	<u>XX</u>	Exploration/ settlement	_____	Science/ invention	_____
The Arts	_____	Industry	_____	Social/ humanitarian	_____
Commerce	_____	Military	_____	Transportation	_____
Communication	_____	Political	_____		
Community development	<u>XX</u>				

9. Historical significance (include explanation of themes checked above)

This is the much remodelled Coolidge farmhouse, one of five structures of some antiquity surviving on the hill.

In 1821 Josiah Coolidge bought 33-1/2 acres of land and began to build the house the next year, starting with the ell. It was completely finished by 1828.

The original Federal house has been altered greatly over the years: the roof line was changed, dormers were added, and the two sides of the front porch were enclosed and made into bays.

Because of the extensive alterations, the house is more significant^{as} a study of the development of a house over a period of 150 years than as an example of Federal architecture.

It is also the last remnant of the last surviving farm in Cambridge to succumb to development. Until the early twentieth century, the Coolidge Farm preserved the farm open spaces which once typified Cambridge.

10. Bibliography and/or references (such as local histories, deeds, assessor's records, early maps, etc.)

NOV 14 1980

INVENTORY FORM CONTINUATION SHEET

MASSACHUSETTS HISTORICAL COMMISSION
Office of the Secretary, Boston

Community: Old Cambridge	Form No: OC II.B.9
Property Name: Josiah Coolidge House	

Indicate each item on inventory form which is being continued below.

The Josiah Coolidge House is associated with the Josiah Coolidge Farm, which occupied a drumlin on the banks of the Charles River within sight of Harvard Square until it was sold for subdivision in 1910. It was the last working farm in Cambridge, and the last of the Old Cambridge estates to be subdivided. The following description of the area is drawn from Report Four: Old Cambridge of the Survey of Architectural History in Cambridge:

The history as well as the location of Coolidge Hill sets it somewhat apart from Brattle Street. Here, at what later became known as Gerry's Landing, the bank of the Charles River offered a firm landing place, and it was near this point that Sir Richard Saltonstall in 1630 established the first Watertown settlement.

Until Memorial Drive was extended through to Fresh Pond Parkway in 1946, this valley was meadowland leading down to the Charles River.

When the initial settlers removed toward Watertown Square after 1635 the allotments were gathered into farms by a few remaining families. Most of Coolidge Hill was acquired by the Samuel Thatcher family, in whose possession it remained until 1793. Owned later by Elbridge Gerry - and thus briefly annexed to Elmwood estate - it came eventually into the hands of Josiah Coolidge and his son Joseph, who kept the farm together until World War I, except for some 11 acres sold in 1865 to the city for the Cambridge Cemetery. The last remnant of the farm disappeared in 1924. Near what had earlier been an access road to a farm further south on the river, Coolidge Avenue was laid out in 1830 and became the boundary of the newly founded Mt. Auburn Cemetery.

Partitioning of Coolidge Hill began in 1910 with sales of the lower meadows to Browne and Nichols School and in 1925 to Shady Hill School; the eastern crest was purchased by the Forbes family in 1910 and developed as a family enclave. The more intensive subdivision of the hill's northern slope as Coolidge Hill Road took place in 1915, while larger hilltop lots were laid out in 1924.

Surrounded by cemeteries, school grounds, and a traffic artery, Coolidge Hill is very much of an island, and it is further protected by one-way streets that seem only to lead 'out'. As a result, the district's streets are as quiet as they were forty years ago and their layout [Prof. Henry V. Hubbard of Pray, Hubbard & White] attains the same picturesque informality as Larchwood, although the houses on top of the hill are larger. Like Larchwood [a nearby development of 1915], they provide a perfect locality in which to study and compare high-grade residential building before and after the First World War.

(see over - continuation)

Staple to Inventory form at bottom

Though the 17th-century Thatcher farmhouse near the corner of Coolidge Avenue and Mt. Auburn Street disappeared in 1831, five other structures of some antiquity survive on the hill. Numbers 8 and 10 Coolidge Hill Road are the service wing and main portion (separated in 1936) of the Widow Orne's house. This building began life in 1807 as a store across the parkway, on the grounds of the Home for Aged People; two years later it was moved to its present site and adapted as a house. Its barn (6 Coolidge Hill Road) was remodeled as a residence in 1900 by Ralph Adams Cram. The two Coolidge houses also survive: 24 Coolidge Hill Road (1822, remodeled 1900) and 34 Coolidge Avenue built in 1856. And finally, there is the trim little Federal house of 1801 at 144 Coolidge Hill, moved here in 1929, from 15 Appian Way.

In 1821 Josiah Coolidge bought 33½ acres of land which included the present 24 Coolidge Hill Road. He began to build the house next year, starting with the ell. Work on the major portion of the house probably did not begin until 1825 since Coolidge was not taxed for a new house until 1826. It was finished by 1828, the last year it was taxed as a "new" house.

In its present form, the Josiah Coolidge House reflects the gradual residential development of Coolidge Hill during the 19th century. Constructed in the 1820's in the Greek Revival style, it was later remodeled with jerkin-headed gables and front porches. C. 1900, just before final subdivision of the Coolidge Farm, it assumed its present form. Alterations carried out in 1900 included removal of a jerkin-headed cross gable and substitution of three dormers; enclosure of the porches, retaining the original triglyph detailing on the fireze boards; and addition of two bay windows on the north end of the house. These alterations clearly changed the original Federal character of house, as shown on the accompanying photo of about 1870. The architect of the alterations is unknown.

Because of the extensive alterations, the house is not significant as an example of Federal architecture. It is, however, an interesting study of the development of a house over a period of 150 years.

The Coolidge House is significant under Criterion A for its association with the Coolidge Farm and the development of this section of Cambridge.

United States Department of the Interior
National Park Service

National Register of Historic Places
Inventory—Nomination Form

For NPS use only
received
date entered

Continuation sheet

Item number

Page 12 of 17

Multiple Resource Area
Thematic Group

Name Cambridge Multiple Resource Area
State MA

Nomination/Type of Review	Date/Signature
111. <input checked="" type="checkbox"/> Mason, W. A., House <i>Substantive Review</i> Keeper Attest	<u><i>[Signature]</i> 6-30-83</u>
112. Building at 259 Mount Auburn Street <i>Substantive Review</i> Keeper Attest	<u><i>[Signature]</i> 6-30-83</u>
113. Howells, William Dean, House <i>Substantive Review</i> Keeper Attest	<u>William H. Braman 4.13.82</u>
114. Mount Auburn Cemetery Reception House <i>Substantive Review</i> Keeper Attest	<u><i>[Signature]</i> 6-30-83</u>
115. Mount Auburn Hospital - Main Building <i>Determined Eligible</i> Keeper DOE/OWNER OBJECTION Attest	<u><i>[Signature]</i> 6-30-83</u>
116. Higginson, Colonel Thomas Wentworth, House <i>Substantive Review</i> Keeper Attest	<u>William H. Braman 4.13.82</u>
117. Noyes, J. A., House <i>Substantive Review</i> Keeper Attest	<u>William H. Braman 4.13.82</u>
118. Coolidge, Josiah, House <i>Substantive Review</i> Keeper Attest	<u><i>[Signature]</i> 6-30-83</u>
119. Orne, Sarah, House <i>Substantive Review</i> Keeper Attest	<u><i>[Signature]</i> 6-30-83</u>
120 Hooper-Eliot House <i>Substantive Review</i> Keeper Attest	<u><i>[Signature]</i> 6-30-83</u>

United States Department of the Interior
National Park Service

Substantive Review

Coolidge, Josiah, House (Cambridge MRA)
Middlesex County
MA

Working No. 11-14-80-2862

Fed. Reg. Date: 2-7-84

Date Due: 7/4/83

Action: ACCEPT 6/30/83

RETURN

REJECT

Federal Agency: _____

- resubmission
- nomination by person or local government
- owner objection
- appeal

Substantive Review: sample request appeal NR decision

Reviewer's comments:

Recom./Criteria accept/A

Reviewer Mr. Brown

Discipline A.H.O.

Date 6-30-83

see continuation sheet

Nomination returned for: technical corrections cited below
 substantive reasons discussed below

1. Name

2. Location

3. Classification

Category	Ownership	Status	Present Use
	Public Acquisition	Accessible	

4. Owner of Property

5. Location of Legal Description

6. Representation in Existing Surveys

has this property been determined eligible? yes no

7. Description

Condition		Check one	Check one
<input type="checkbox"/> excellent	<input type="checkbox"/> deteriorated	<input type="checkbox"/> unaltered	<input type="checkbox"/> original site
<input type="checkbox"/> good	<input type="checkbox"/> ruins	<input type="checkbox"/> altered	<input type="checkbox"/> moved date _____
<input type="checkbox"/> fair	<input type="checkbox"/> unexposed		

Describe the present and original (if known) physical appearance

- summary paragraph
- completeness
- clarity
- alterations/integrity

8. Significance

Period _____ Area of Significance—Check and justify below

Specific dates _____ Builder Architect _____

Statement of Significance (in one paragraph)

- summary paragraph
- completeness
- clarity
- applicable criteria
- justification of areas checked
- relating significance to the resource
- context
- relationship of integrity to significance
- justification of exception
- other

9. Major Bibliographical References

10. Geographical Data

Acres of nominated property _____

Quadrangle name _____

UMT References _____

Verbal boundary description and justification _____

11. Form Prepared By

12. State Historic Preservation Officer Certification

The evaluated significance of this property within the state is:

national state local

State Historic Preservation Officer signature _____

title _____ date _____

13. Other

- Maps
- Photographs
- Other

Questions concerning this nomination may be directed to _____

Signed _____ Date _____ Phone: 202 272 - 3504

Comments for any item may be continued on an attached sheet



Cambridge MRA, Ma

Coolidge, Josiah, House

24 COOLIDGE HILL RD.

196/3



1110-21A

NOV 14 1980

Cambridge MA Ma

043C

Coolidge, Josiah, House

24 Coolidge Hill Rd.

1110-21A

Please refer to the map in the
Multiple Property Cover Sheet
for this property

Multiple Property Cover Sheet Reference Number: 64000275