

FORM B - BUILDING

MASSACHUSETTS HISTORICAL COMMISSION
Office of the Secretary, State House, Boston

In Area no. 528	Form no. M-28-6
--------------------	-------------------------------

1. Town Fall River, Mass

Address 542 Walnut Street

Name Woman's Club of Fall River

Present use Club-House

Present owner Woman's Club of Fall River

3. Description: 1 and 2-story frame institution

Date 1897/1925

Source deeds, local history

Style Colonial Revival

Architect 1925-Maud Darling-Parlin

Exterior wall fabric clapboard

Outbuildings (describe) _____

Other features 2-story Pedimented Entrance

Pavillion at left with Corinthian Pilasters, quoins, roof balustrade along-side wing

Altered X Date 1925

Moved _____ Date _____

5. Lot size: 8019 sq ft v2

One acre or less X Over one acre _____

Approximate frontage _____

Approximate distance of building from street _____

6. Recorded by V. Lasky/Pam Fox

Organization FROHP

Date November 10, 1980

2. Photo (3x3" or 3x5")
Staple to left side of form
Photo number INST. 4-10A

4. Map. Draw sketch of building location in relation to nearest cross streets and other buildings. Indicate north.

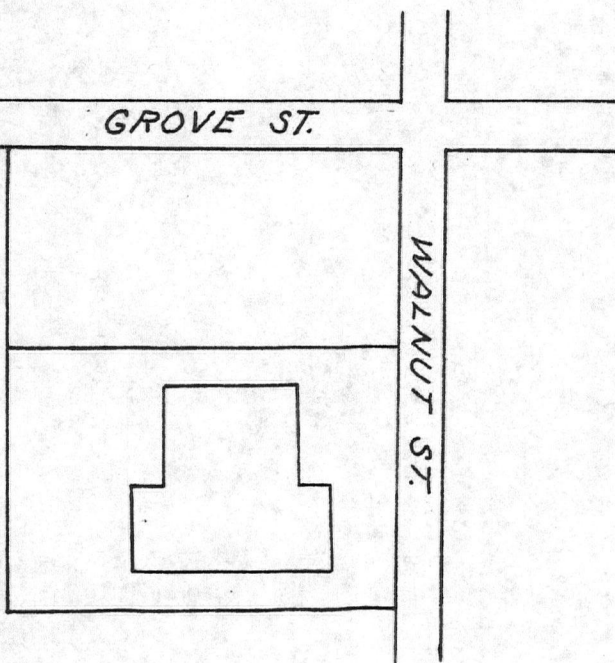

(over)

7. Original owner (if known) Susan P.H. Winslow

Original use Private School, Church

Subsequent uses (if any) and dates _____

8. Themes (check as many as applicable)

Aboriginal	_____	Conservation	_____	Recreation	_____
Agricultural	_____	Education	_____	Religion	_____
Architectural	X	Exploration/ settlement	_____	Science/ invention	_____
The Arts	X	Industry	_____	Social/ humanitarian	X
Commerce	_____	Military	_____	Transportation	_____
Communication	_____	Political	_____		
Community development	_____				

9. Historical significance (include explanation of themes checked above)

The Woman's Club of Fall River (1897/1925) is among the city's finest examples of the Colonial Revival style also of interest as the work of Fall River's best-known woman architect.

The Colonial Revival facade of the clubhouse appears to date from 1925, when an earlier building was remodelled to serve the present use. The building was originally a private school dating from 1897 and during the 1910's served as St. Paul's Evangelical Lutheran Church. It is not clear how much of the plan or structure of the late 19th century building was retained during the 1925 remodelling. As was appropriate for a Woman's Club, the group hired the well-regarded woman architect Maude Darling Parlin, a local resident who graduated from Durfee High School and was the only woman in her college class at M.I.T. She later studied at the Pratt Institute. Early in her career she joined the family architectural firm founded by her father and later on she and her brother carried on the business as Darling and Parlin. In association with her brother, she designed the Durfee Theatre, Eagle Restaurant, and Fall River Cooperative Bank. She was sole designer of the Woman's Club and north wing extension of the Home for Aged People. She retired at age 91 and died in 1979 at age 94.

The exterior utilizes the quintessential Colonial Revival forms- the pedimented entrance pavillion, pilasters, small-paned double hung sash, quoins and side wing with arched windows and a blind roof balustrade. The delicate interior moldings were not stock items but were carved from the architects' specifications drawings.

As a distinctive example of its style, carefully-crafted and well-preserved, and as a building associated for over half a century with one of the city's principal social institutions, the Woman's Club of Fall River meets criteria A and C of the National Register, individually.

10. Bibliography and/or references (such as local histories, deeds, assessor's records, early maps, etc.)

City Directory 1897 Susan P.H. Winslow, private school, 542 Walnut St., boards 259 Highland Ave. S.P.H. Winslow was principal of Westall School 1913 St. Pauls' Evangelical Lutheran Church-Johann Moeller and Henry Zobel, Treasurers 8019 so ft 3-31-10

United States Department of the Interior
National Park Service

National Register of Historic Places
Inventory—Nomination Form

For NPS use only
received 1/5/83
date entered

Continuation sheet

Item number

Page 9 of 10

Multiple Resource Area
Thematic Group

Name Fall River Multiple Resource Area
State MA

Nomination/Type of Review

Date/Signature

81. St. Joseph's Orphanage

Substantive Review

Keeper

2/16/83 *[Signature]*

Attest

82. St. Louis Church

Entered in the
National Register

Keeper

2/16/83 *[Signature]*

Attest

83. St. Mary's Cathedral and Rectory

Entered in the
National Register

Keeper

2/16/83 *[Signature]*

Attest

84. St. Patrick's Church

Entered in the
National Register

Keeper

2/16/83 *[Signature]*

Attest

85. Stafford Mills

Entered in the
National Register

Keeper

2/16/83 *[Signature]*

Attest

86. Union Mills

Entered in the
National Register

Keeper

2/16/83 *[Signature]*

Attest

87. Valentine-French House

Entered in the
National Register

Keeper

2/16/83 *[Signature]*

Attest

88. Wampanoag Mills

Entered in the
National Register

Keeper

2/16/83 *[Signature]*

Attest

89. Winslow, Luther Jr., House

Entered in the
National Register

Keeper

2/16/83 *[Signature]*

Attest

90. Woman's Club of Fall River

Entered in the
National Register

Keeper

2/16/83 *[Signature]*

Attest

United States Department of the Interior
National Park Service

Woman's Club of Fall River (Fall River MRA)
Bristol County
MASSACHUSETTS

Working No. 115/83-15
Fed. Reg. Date: 2.7.84
Date Due: 2/3/83 - 2/19/83
Action: ACCEPT 2/16/83
Entered In the RETURN
National Register REJECT
Federal Agency: _____

- resubmission
- nomination by person or local government
- owner objection
- appeal

Substantive Review: sample request appeal NR decision

Reviewer's comments:

Recom. / Criteria _____
Reviewer _____
Discipline _____
Date _____
 see continuation sheet

Nomination returned for: technical corrections cited below
 substantive reasons discussed below

1. Name

2. Location

3. Classification

Category	Ownership	Status	Present Use
	Public Acquisition	Accessible	

4. Owner of Property

5. Location of Legal Description

6. Representation in Existing Surveys

has this property been determined eligible? yes no

7. Description

Condition		Check one	Check one
<input type="checkbox"/> excellent	<input type="checkbox"/> deteriorated	<input type="checkbox"/> unaltered	<input type="checkbox"/> original site
<input type="checkbox"/> good	<input type="checkbox"/> ruins	<input type="checkbox"/> altered	<input type="checkbox"/> moved date _____
<input type="checkbox"/> fair	<input type="checkbox"/> unexcavated		

Describe the present and original (if known) physical appearance

- summary paragraph
- completeness
- clarity
- alterations/integrity
- dates
- boundary selection

8. Significance

Period _____ Area of Significance—Check and justify below

Specific dates _____ Builder/Architect _____

Statement of Significance (in one paragraph)

- _____ summary paragraph
- _____ completeness
- _____ clarity
- _____ applicable criteria
- _____ justification of areas checked
- _____ relating significance to the resource
- _____ context
- _____ relationship of integrity to significance
- _____ justification of exception
- _____ other

9. Major Bibliographical References

10. Geographical Data

Acres of nominated property _____

Quadrangle name _____

UNIT References _____

Verbal boundary description and justification _____

11. Form Prepared By

12. State Historic Preservation Officer Certification

The evaluated significance of this property within the state is:

_____ national _____ state _____ local

State Historic Preservation Officer signature _____

title _____ date _____

13. Other

- _____ Maps
- _____ Photographs
- _____ Other

Questions concerning this nomination may be directed to _____

Signed _____ Date _____ Phone: 202 272 - 3504

Comments for any item may be continued on an attached sheet



NAME: Woman's Club of Fall River

LOCATION: 542 Walnut Street
Fall River, ^{MA} Mass.

PHOTO CREDIT: Pamela Shields (1981)

NEGATIVE FILED AT: Fall River Office of Historic
Preservation
One Government Center
Fall River, Mass. 02722
(PSNR-6-16)

IDENTIFICATION: Woman's Club
South Facade, looking north

Photo # 1 of 2



542

walnut HL I

Fall River NRA, Mo

Werners Club of Fall River

H_A - HL II

Please refer to the map in the
Multiple Property Cover Sheet
for this property

Multiple Property Cover Sheet Reference Number: 64000279