

FORM B - BUILDING

AREA	FORM NO.
	62

MASSACHUSETTS HISTORICAL COMMISSION
294 WASHINGTON STREET, BOSTON, MA 02108

Town Rehoboth

Address 144 Hornbine Road

Historic Name Hornbine School

Use: Present museum

Original school

DESCRIPTION:

Date 1862

Source 325th Anniversary of Rehoboth;
Town Records

Style Greek Revival

Architect unknown

Exterior wall fabric clapboard

Outbuildings none

Major alterations (with dates) modified
as residence ca. 1940; restored 1968

Moved no Date _____

Approx. acreage less than one acre

Setting 50 feet from Hornbine Road
at intersection of Baker

PHOTO: (3x3" or 3x5", black & white)
staple to left side of form

Photo number _____

SKETCH MAP

Show property's
to nearest cross
geographical fe
all buildings b
property and ne
Indicate north.

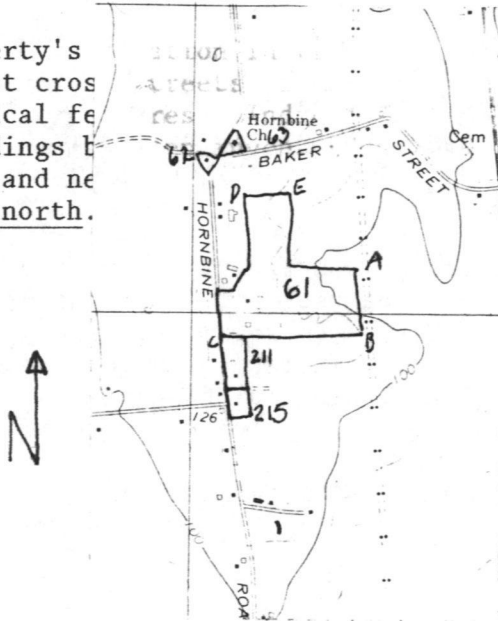

UTM: 19317060/4629500

Recorded by Leslie C. Abernathy, III

Organization Rehoboth Historical Commission

Date April 1976

(Staple additional sheets here)

ARCHITECTURAL SIGNIFICANCE (Describe important architectural features and evaluate in terms of other buildings within the community.)

The Hornbine School is an archetypical example of a 19th century eight grade one-room schoolhouse. It is a modest one-story wood frame clapboard building with entrance in the three-bay gable end facing the street and a stove chimney at the opposite end. This schoolhouse was built at its present location in 1862 in the Hornbine section of southeastern Rehoboth and stands as the best preserved example of a mid 19th century schoolhouse in the town.

HISTORICAL SIGNIFICANCE (Explain the role owners played in local or state history and how the building relates to the development of the community.)

One of the fifteen one-room district schools in town during the 19th and early 20th centuries, the Hornbine School was known as District #10 School until districts were abolished in 1883. Beginning in the 1920s, the district schools began to close as students consolidated in larger facilities. The Hornbine School, discontinued in 1937, was the last to close. During the 1930s, Hornbine had a pupil exchange arrangement with Swansea, Hornbine taking lower grades, and Swansea high school pupils.

The Hornbine School was (subsequently) sold, modified for use as a residence, then later deteriorated from disuse. In 1968, when Rehoboth celebrated its 325th Anniversary, the Hornbine School Association was organized to purchase the school, restore it and turn it over to the town as a museum. Formal preservation of the one-room school heritage of Rehoboth reflects the sentiments of a town which had, from first settlement, committed itself to maintaining universal public education.

In addition to its role as a school, its location has significance. The Hornbine School and the earlier Hornbine Baptist Church (#63) face each other across Hornbine Road at a small curving intersection which has changed little since about 1900. There is an intimacy of scale and an interplay between the two buildings which deserves to be preserved.

(Continued)

BIBLIOGRAPHY and/or REFERENCES (name of publication, author, date and publisher)

Snape, Sue Ellen, ed. In Old Rehoboth, 1979, pp.53, 62-64.

Trim, et al. Rehoboth's 325th Anniversary, 1968, pp.52-58.

INVENTORY FORM CONTINUATION SHEET

MASSACHUSETTS HISTORICAL COMMISSION
Office of the Secretary, Boston

Community: Rehoboth	Form No: 62
Property Name: Hornbine School	

Indicate each item on inventory form which is being continued below.

Historical Significance (Continued)

The Hornbine School possesses integrity of location, design, materials, workmanship, setting, feeling and association and meets criteria A and C of the National Register of Historic Places individually.

Staple to Inventory form at bottom

United States Department of the Interior
National Park Service

National Register of Historic Places
Inventory—Nomination Form

For NPS use only

received

date entered

Continuation sheet

Item number

Page 3 of 4

Multiple Resource Area
Thematic Group

Name Rehoboth Multiple Resource Area
State Massachusetts

Nomination/Type of Review

Date/Signature

- | | | | |
|--|-------------------------------------|------------|------------------------------|
| 21. Goff Farm | Substantive Review | Keeper | <u>Thomas W. Boyd 6/6/83</u> |
| | Entered in the
National Register | Attest | _____ |
| 22. Goff Homestead | | for Keeper | <u>Delores Byers 6/6/83</u> |
| | | Attest | _____ |
| 23. Hornbine Baptist Church | Entered in the
National Register | for Keeper | <u>Delores Byers 6/6/83</u> |
| | | Attest | _____ |
| 24. Hornbine School | Entered in the
National Register | for Keeper | <u>Delores Byers 6/6/83</u> |
| | | Attest | _____ |
| 25. Horton, Welcome, Farm | Entered in the
National Register | for Keeper | <u>Delores Byers 6/6/83</u> |
| | | Attest | _____ |
| 26. House at 197 Hornbine Road | Entered in the
National Register | for Keeper | <u>Delores Byers 6/6/83</u> |
| | | Attest | _____ |
| 27. House at 30 Kelton Street | Entered in the
National Register | for Keeper | <u>Delores Byers 6/6/83</u> |
| | | Attest | _____ |
| 28. Ingalls-Wheeler-Horton
Homestead Site | Entered in the
National Register | for Keeper | <u>Delores Byers 6/6/83</u> |
| | | Attest | _____ |
| 29. Kingsley House | Entered in the
National Register | for Keeper | <u>Delores Byers 6/6/83</u> |
| | | Attest | _____ |
| 30. Knapp, Seth, Jr., House | Entered in the
National Register | for Keeper | <u>Delores Byers 6/6/83</u> |
| | | Attest | _____ |

8. Significance

Period _____ Area of Significance—Check and justify below

Specific dates _____ Builder/Architect _____

Statement of Significance (in one paragraph)

- _____ summary paragraph
- _____ completeness
- _____ clarity
- _____ applicable criteria
- _____ justification of areas checked
- _____ relating significance to the resource
- _____ context
- _____ relationship of integrity to significance
- _____ justification of exception
- _____ other

9. Major Bibliographical References

10. Geographical Data

Acres of nominated property _____

Quadrangle name _____

UMT References _____

Verbal boundary description and justification _____

11. Form Prepared By

12. State Historic Preservation Officer Certification

The evaluated significance of this property within the state is:

_____ national _____ state _____ local

State Historic Preservation Officer signature _____

title _____ date _____

13. Other

- _____ Maps
- _____ Photographs
- _____ Other

Questions concerning this nomination may be directed to _____

Signed _____ Date _____ Phone: 202 272 - 3504

Comments for any item may be continued on an attached sheet



Hornbine Sch. Assn.

4/15/75

Hornbine School
Rehoboth MRA, Ma

Please refer to the map in the
Multiple Property Cover Sheet
for this property

Multiple Property Cover Sheet Reference Number: 64000292