

FORM B - BUILDING

MASSACHUSETTS HISTORICAL COMMISSION
294 WASHINGTON STREET, BOSTON, MA 02108

AREA	FORM NO.
	63

Town Rehoboth
 Address 141 Hornbine Road
 Historic Name Hornbine Baptist Church

Use: Present church
 Original church

DESCRIPTION:

Date 1753
 Source 325th Anniversary of Rehoboth

Style vernacular
 Architect unknown
 Exterior wall fabric clapboard
 Outbuildings none

Major alterations (with dates) _____
see text

Moved no Date _____

Approx. acreage less than one acre

Setting center of triangular lot at
intersection of Hornbine Road and
Baker Street

PHOTO: (3x3" or 3x5", black & white)
 staple to left side of form

Photo number _____

SKETCH MAP

Show property's
 to nearest cross
 geographical fe
all buildings
 property and ne
 Indicate north.

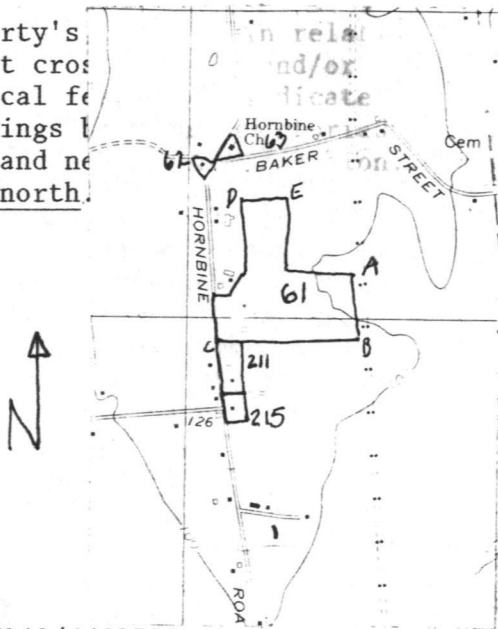

UTM: 19/317140/4629550

Recorded by Leslie C. Abernathy, III

Organization Rehoboth Historical Commission

Date April 1976

(Staple additional sheets here)

ARCHITECTURAL SIGNIFICANCE (Describe important architectural features and evaluate in terms of other buildings within the community.)

The Hornbine Baptist Church, a small one-story frame structure with a diminutive projecting hip roof porch with double entrances, is the earliest surviving Baptist meetinghouse in southeast Massachusetts. Originally, when erected in 1753, this building was a simple barn-like structure with a single large room. The entrance was in the bagle flank facing south onto Baker Street (stone step still in place) and the pulpit was on the north wall opposite. By 1802, the parish had grown, and increase in the congregation necessitated remodelling. A gallery was built at both ends of the room and pews were installed. The pulpit, made of hornbeam (presumably

HISTORICAL SIGNIFICANCE (Explain the role owners played in local or state history and how the building relates to the development of the community.)

(Continued)

The First Baptist Church in Massachusetts was established in Swansea, adjacent to Rehoboth, in 1663. It was a Six Principle Baptist Church under Rev. John Myles. In 1753, some thirty members withdrew from the second church in Swansea, Church of Christ and, with its blessing, organized what was to be known as the Hornbine Baptist Church in southeast Rehoboth. This was the third Baptist congregation in present-day Rehoboth. Daniel Martin was ordained as pastor with Mial Pearce as assistant. Initially, monthly meetings were held in the Mial Pearce House (#61) and occasionally at the Nathaniel Baker home on Baker Street. During the 18th and 19th centuries, the parish grew to such a large size that two major renovations were necessary to the original church of 1753 in 1802 and 1869. The parish has always been active in the community. Suppers are often held at the Church and clambakes have been an annual event since 1860 when the first clambake held in a nearby orchard, netted a thirty-cents profit. Since 1950, they have been held elsewhere in Rehoboth and serve one hundred-eighty to two hundred-fifty people. As champions of civic and religious freedom, the parishoners voted in 1888 to become non-denominational and rename the church as the First Free Baptist Church and Society of southeast Rehoboth, Massachusetts, Incorporated." This act by the Church encouraged participation in church-sponsored social activities by local residents belonging to other parishes. Consequently, the Hornbine Church has been instrumental in maintaining community life in Rehoboth and has many supportive ties outside the immediate, now small congregation.

(Continued)

BIBLIOGRAPHY and/or REFERENCES (name of publication, author, date and publisher)

"A brief history of the Hornbine Baptist Church," pamphlet, n.d.

Massachusetts Historical Commission, Historic and Archaeological Resources of Southeast Massachusetts. Boston, 1982.

Trim, et al. Rehoboth's 325th Anniversary, 1968, pp.43-44.

INVENTORY FORM CONTINUATION SHEET

MASSACHUSETTS HISTORICAL COMMISSION
Office of the Secretary, Boston

Community: Rehoboth	Form No: 63
Property Name: Hornbine Baptist Church	

Indicate each item on inventory form which is being continued below.

Architectural Significance (Continued)

the origin of "Hornbine"), was enlarged with stairs on either side. This pulpit has since been cut down several tiems and is presently located in the southeast corner of the main floor. Further renovations in 1869 consisted of moving the entrance to its present location, lowering the ceiling, and erecting a raised alcove to serve as a pulpit. The chandelier and four bracket lamps, now electrified and still in use, were installed at this time. A social hall sixteen feet square added to the northwest corner that same year was enlarged by nineteen feet in 1874 and remodelled in the 1960s when a kitchen was installed. A four-stall horse shed and several storage sheds of the 1870s were removed in the mid 20th century. The potential for subsurface remains of these structures is undetermined.

Aside from modifications of the social hall and removal of late 19th century sheds, the Hornbine Church has not altered significantly since the 1870s, nor has its setting. It is located where Baker Street meets Hornbine, a minor intersection which is unmarred by any attempts to straighten or widen the roads. Another historically significant structure, the Hornbine School (#62) is directly across Hornbine Street.

Historical Significance (Continued)

As the earliest surviving Baptist Meetinghouse in southeast Massachusetts, well-maintained and still occupied by its original congregation, the Hornbine Baptist Church meets criteria A and C of the National Register of Historic Places individually.

no

Staple to Inventory form at bottom

**United States Department of the Interior
National Park Service
National Register of Historic Places
Inventory—Nomination Form**

For NPS use only
received
date entered

Continuation sheet

Item number

Page 3 of 4

Multiple Resource Area
Thematic Group

Name Rehoboth Multiple Resource Area
State Massachusetts

Nomination/Type of Review

Date/Signature

- | | | | |
|--|-------------------------------------|---------------|-----------------------------|
| 21. Goff Farm | Substantive Review | Keeper | <u>Anna M. Boyd 6/6/83</u> |
| | | Attest | _____ |
| 22. Goff Homestead | Entered in the
National Register | for
Keeper | <u>Delores Byers 6/6/83</u> |
| | | Attest | _____ |
| 23. Hornbine Baptist Church | Entered in the
National Register | for
Keeper | <u>Delores Byers 6/6/83</u> |
| | | Attest | _____ |
| 24. Hornbine School | Entered in the
National Register | for
Keeper | <u>Delores Byers 6/6/83</u> |
| | | Attest | _____ |
| 25. Horton, Welcome, Farm | Entered in the
National Register | for
Keeper | <u>Delores Byers 6/6/83</u> |
| | | Attest | _____ |
| 26. House at 197 Hornbine Road | Entered in the
National Register | for
Keeper | <u>Delores Byers 6/6/83</u> |
| | | Attest | _____ |
| 27. House at 30 Kelton Street | Entered in the
National Register | for
Keeper | <u>Delores Byers 6/6/83</u> |
| | | Attest | _____ |
| 28. Ingalls-Wheeler-Horton
Homestead Site | Entered in the
National Register | for
Keeper | <u>Delores Byers 6/6/83</u> |
| | | Attest | _____ |
| 29. Kingsley House | Entered in the
National Register | for
Keeper | <u>Delores Byers 6/6/83</u> |
| | | Attest | _____ |
| 30. Knapp, Seth, Jr., House | Entered in the
National Register | for
Keeper | <u>Delores Byers 6/6/83</u> |
| | | Attest | _____ |

United States Department of the Interior
National Park Service

Hornbine Baptist Church (Rehoboth MRA)
Bristol County
MASSACHUSETTS

Working No. 4/25/83
Fed. Reg. Date: 2.7.83
Date Due: 5/26/83 - 6/9/83
Action: ACCEPT 8/6/87
 RETURN
Entered in the National Register REJECT
Federal Agency: _____

- resubmission
- nomination by person or local government
- owner objection
- appeal

Substantive Review: sample request appeal NR decision

Reviewer's comments:

Recom./Criteria _____
Reviewer _____
Discipline _____
Date _____
see continuation sheet

Nomination returned for: technical corrections cited below
 substantive reasons discussed below

1. Name

2. Location

3. Classification

Category Ownership Status Present Use
 Public Acquisition Accessible

4. Owner of Property

5. Location of Legal Description

6. Representation in Existing Surveys

has this property been determined eligible? yes no

7. Description

Condition excellent deteriorated good ruins fair unexposed
Check one unaltered altered
Check one original site moved date _____

Describe the present and original (if known) physical appearance

- summary paragraph
- completeness
- clarity
- alterations/integrity
- dates
- boundary selection

8. Significance

Period _____ Areas of Significance—Check and justify below

Specific dates _____ Builder/Architect _____

Statement of Significance (in one paragraph)

- _____ summary paragraph
- _____ completeness
- _____ clarity
- _____ applicable criteria
- _____ justification of areas checked
- _____ relating significance to the resource
- _____ context
- _____ relationship of integrity to significance
- _____ justification of exception
- _____ other

9. Major Bibliographical References

10. Geographical Data

Acres of nominated property _____

Quadrangle name _____

UNIT References

Verbal boundary description and justification

11. Form Prepared By

12. State Historic Preservation Officer Certification

The evaluated significance of this property within the state is:

_____ national _____ state _____ local

State Historic Preservation Officer signature _____

title _____ date _____

13. Other

- _____ Maps
- _____ Photographs
- _____ Other

Questions concerning this nomination may be directed to _____

Signed _____ Date _____ Phone: 202 272-3504

Comments for any item may be continued on an attached sheet



BAPTIST
HORNBINE CHURCH
SUNDAY SCHOOL 9:30 A.M.
WEDNESDAY 7:30 P.M.

4/15/75

Hornbire School Assoc.

Hornbire Baptist Church

Rebecca W. MRA/Me

SWANSLA

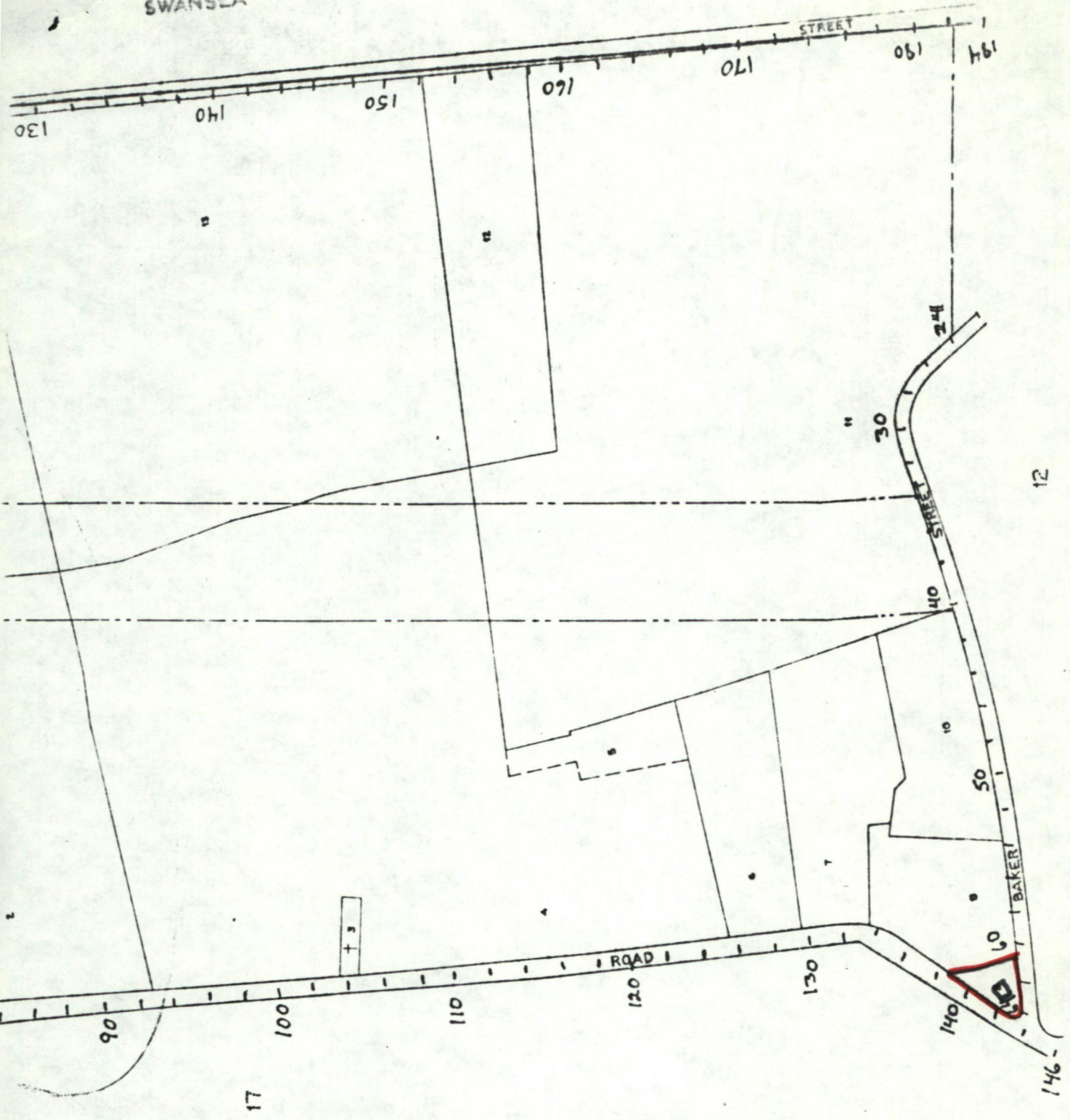

LEGEND
 --- ERS
 --- PS

141 Hornbine Road
 Hornbine Baptist Church
 (form 63) Town of Rehoboth
 Property Map 1978
 scale 1" = 200'

Please refer to the map in the
Multiple Property Cover Sheet
for this property

Multiple Property Cover Sheet Reference Number: 64000292