

FORM B - BUILDING

AREA	FORM NO.
	160

MASSACHUSETTS HISTORICAL COMMISSION
294 WASHINGTON STREET, BOSTON, MA 02108

Town REHOBOTH
Address 108 Homestead Rd
Historic Name Elisha Allen House

PHOTO: (3x3" or 3x5", black & white)
staple to left side of form

Photo number _____

Use: Present residence
Original residence

DESCRIPTION:

Date between 1738 and 1759

Source MLM, p. 133; Bristol Co. Deeds
68/527

Style Georgian

Architect unknown

Exterior wall fabric clapboards

Outbuildings mid 20th century sheds

Major alterations (with dates) see text

Moved no Date _____

Approx. acreage 8

Setting 70 feet from road, gable
flank to road; rural context

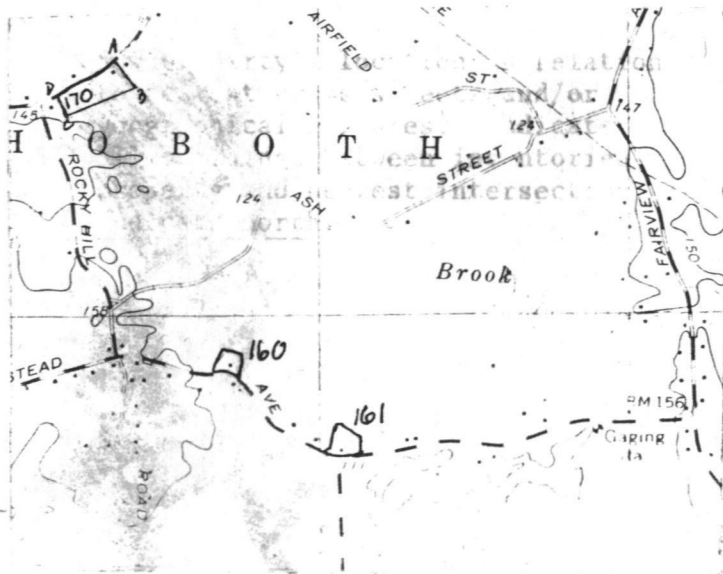

UTM: 19/311720/4638830

Recorded by Leslie C. Abernathy III

Organization Rehoboth Historical Commission

Date April 1976; revised 1981

(Staple additional sheets here)

ARCHITECTURAL SIGNIFICANCE (Describe important architectural features and evaluate in terms of other buildings within the community.)

Deteriorated and damaged by fire in the past, this center cape has been undergoing painstaking and cautious renovation by the present owners over the past eight years. The first, central portion of the house, was constructed between ca.1738 to 1759. A rear ell was added between ca.1775 and 1825, and in ca.1830 a formerly free-standing "new kitchen" was attached to the east end. In that ell, a new chimney was constructed complete with oven, fireplace, and boiler in the cellar. This is one of a handful of structures built before 1750 in Rehoboth which is still standing and not totally obscured by later alterations. Major reconstructed features are the main chimney stack, window sashes, and interior walls. (Continued)

HISTORICAL SIGNIFICANCE (Explain the role owners played in local or state history and how the building relates to the development of the community.)

Rehoboth proprietors conveyed this land in the northwest section of Rehoboth to Deacon Ezekiel Read in 1738. By 1755, a house was built here by him or his son, Ezekiel, Jr. The latter conveyed the house and a twelve-acre tract to Elisha Allen in 1759 for thirty pounds. He and/or his son Isaiah, who inherited in 1815, ran a cordwainer business at the small farm. Another son, Elisha, Jr. was killed in the Battle of Rhode Island at the age of twenty-five while serving under Colonel Thomas Carpenter. He is buried in the Rehoboth Village Cemetery. The property remained in the Allen family until 1895, when Isaiah N. Allen (see attached sheet) sold parcels on both sides of the road to Anne S. Brummit of Framingham for "\$1.00 and other valuable considerations." Prior to that time, a barn had been built across the road. It was still standing in 1905 when the property was again sold, this time to Sarah S. Brummit for \$10, but is now gone. A mulberry tree east of the house may be a remnant of silk industry here in the mid-nineteenth century.

BIBLIOGRAPHY and/or REFERENCES (name of publication, author, date and publisher)

- Snape, Sue Ellen. Mighty Liberty Men, 1976, pp.26, 102, 133.
Bristol County Registry of Deeds, Book 68, p.527; Book 97,p.532 and Book 71, p.22.
Tilton, A History of Rehoboth, Massachusetts, Boston 1918, p.354.

INVENTORY FORM CONTINUATION SHEET

MASSACHUSETTS HISTORICAL COMMISSION
Office of the Secretary, Boston

Community: Rehoboth	Form No: 160
Property Name: Elisha Allen House	

Indicate each item on inventory form which is being continued below.

Architectural Significance (Continued)

Careful attention to deteriorated original features, structural clues and documentary information has guided these restorations.

Sensitive restoration work served to reveal distinctive and typical aspects of period construction methods. This fact was recognized in the early 20th century by a photograph published in Tilton's history of the town. Despite reconstructed elements, the Elisha Allen House retains a high degree of architectural integrity and is one of Rehoboth's best preserved examples of the extended cottage form from this period. The Elisha Allen House thus meets criterion C of the National Register of Historic Places individually.

Staple to Inventory form at bottom

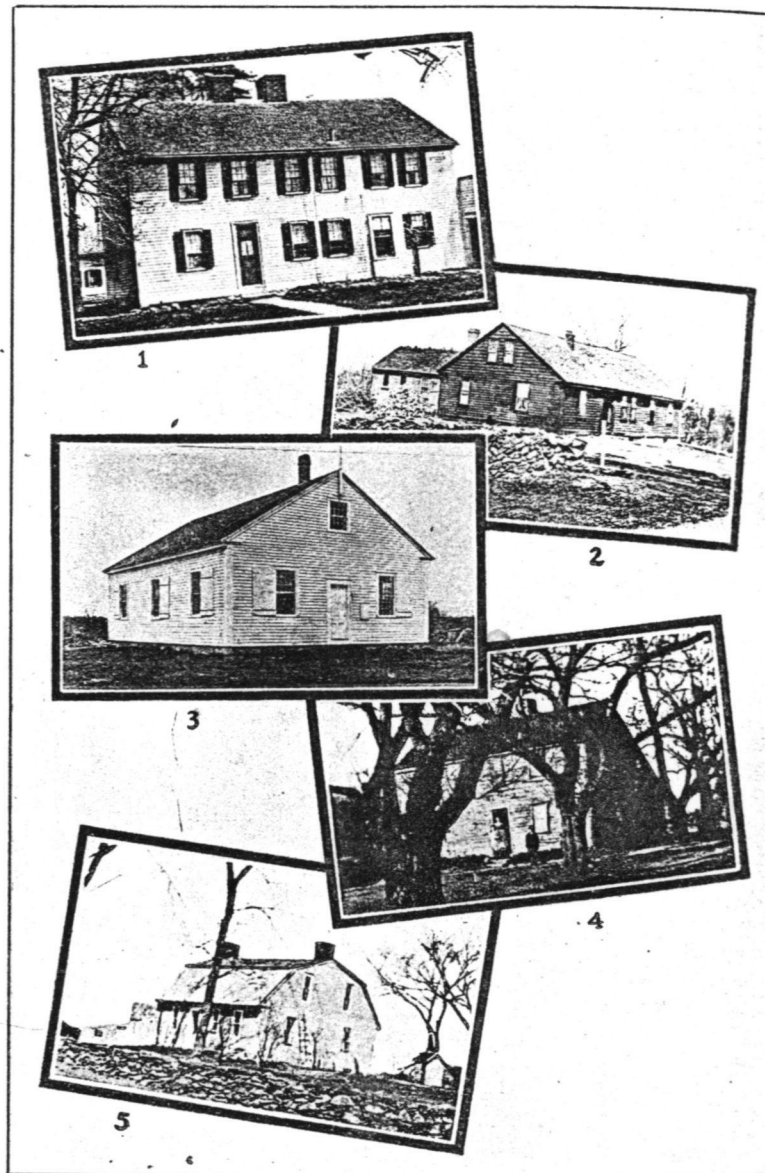

1. ABIAH BLISS HOUSE, Agriculture Avenue.
2. ISAIAH N. ALLEN HOUSE, Homestead Avenue.
3. TOWN HOUSE.
4. JOHN EARLE HOUSE, County Street.
5. LAKE HOUSE, Water Street; Birthplace of Dr. Lake.

From Tilton, G.H. A History of Rehoboth, Massachusetts, 1918, p.46.

United States Department of the Interior
National Park Service

National Register of Historic Places
Inventory—Nomination Form

For NPS use only
received
date entered

Continuation sheet

Item number

Page 1 of 4

Multiple Resource Area
Thematic Group

dnr-11

Name Rehoboth Multiple Resource Area
State Massachusetts

Nomination/Type of Review

Date/Signature

- | | | | | |
|-----|---|----------------------------------|------------|------------------------------|
| 1. | Rehoboth Village Historic District | Substantive Review | Keeper | <u>Oliver W. Boyd 6/6/83</u> |
| | | | Attest | _____ |
| 2. | Allen, Elisha, House | Entered in the National Register | Keeper | <u>Delores Byers 6/6/83</u> |
| | | | Attest | _____ |
| 3. | Anawan Club Caretaker's House | | Keeper | _____ |
| | <i>Combined</i> | | Attest | _____ |
| 4. | Anawam Club Clubhouse AND CARETAKER'S HOUSE | Entered in the National Register | for Keeper | <u>Delores Byers 6/6/83</u> |
| | | | Attest | _____ |
| 5. | Anawan Rock | Entered in the National Register | for Keeper | <u>Delores Byers 6/6/83</u> |
| | | | Attest | _____ |
| 6. | Baker House | Entered in the National Register | for Keeper | <u>Delores Byers 6/6/83</u> |
| | | | Attest | _____ |
| 7. | Bliss, Abiah, House | Entered in the National Register | for Keeper | <u>Delores Byers 6/6/83</u> |
| | | | Attest | _____ |
| 8. | Bliss, Daniel, Homestead | Entered in the National Register | for Keeper | <u>Delores Byers 6/6/83</u> |
| | | | Attest | _____ |
| 9. | Bowen, Nathan, House | Entered in the National Register | for Keeper | <u>Delores Byers 6/6/83</u> |
| | | | Attest | _____ |
| 10. | Bramble Hill | Entered in the National Register | for Keeper | <u>Delores Byers 6/6/83</u> |
| | | | Attest | _____ |

8. Significance

Period _____ Area of Significance—Check and justify below

Specific dates _____ Builder/Architect _____

Statement of Significance (in one paragraph)

- _____ summary paragraph
- _____ completeness
- _____ clarity
- _____ applicable criteria
- _____ justification of areas checked
- _____ relating significance to the resource
- _____ context
- _____ relationship of integrity to significance
- _____ justification of exception
- _____ other

9. Major Bibliographical References

10. Geographical Data

Acres of nominated property _____

Quadrangle name _____

UNIT References _____

Verbal boundary description and justification _____

11. Form Prepared By

12. State Historic Preservation Officer Certification

The evaluated significance of this property within the state is:

_____ national _____ state _____ local

State Historic Preservation Officer signature _____

title _____ date _____

13. Other

- _____ Maps
- _____ Photographs
- _____ Other

Questions concerning this nomination may be directed to _____

Signed _____ Date _____ Phone: 202 272 - 3504

Comments for any item may be continued on an attached sheet



#160

Allen, Elisha, Hase

Reheboth Mass Ma

105:28



108 Homestead Avenue
 Elisha Allen House (form 160)
 Town of Rehoboth Property Map
 scale 1"=200' 1978

Please refer to the map in the
Multiple Property Cover Sheet
for this property

Multiple Property Cover Sheet Reference Number: 64000292