

FORM A - AREA SURVEY

MASSACHUSETTS HISTORICAL COMMISSION
Office of the Secretary, State House, Boston

Form numbers in this area	Area no.
Mid-Cambridge	mc I.1

2. Photo (3x3" or 3x5")
Staple to left side of form
Photo number 1093-30A
 1093-31A
 " -32A
 " -36A
 1106-33A

1. Town Cambridge
Name of area (if any) Bigelow Street
National Register District

3. General date or period 1870-1875

4. Is area uniform (explain):
in style? yes, almost entirely Mansard.
in condition? yes, good condition
in type of ownership? yes, privately owned
in use? yes, residential

5. Map. Use space below to draw a general map of the area involved. Indicate any historic properties for which individual reports are completed on Forms B thru F, using corresponding numbers. Show street names (including route numbers, if any) and indicate north. Indicate with an "x" existing houses not inventoried on Form B.

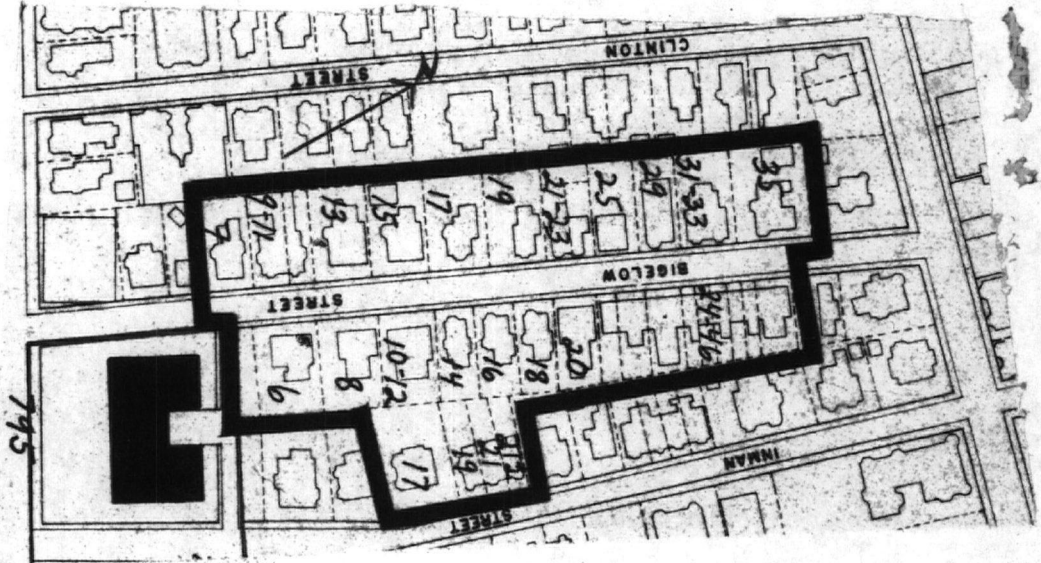

NOV 14 1980

DO NOT WRITE IN THIS SPACE
USGS Quadrant _____
MHC Photo no. _____

6. Recorded by Bainbridge Bunting
Organization Cambridge Historical Comm.
Date 1965

3.487 Acres

(over)

UTM-BOSTON SOUTH
19/326620/4692600

7. Historical data. Explain the historical/architectural importance of this area.

Bigelow Street is host to a series of pretentious Mansard houses built between 1869 and 1874. The street was laid out in 1868 by Albert Vinal and almost completely developed within a few years. Vinal sold most of the land as house lots to individual housewrights and masons. Although no attempt was made to build identical houses, there is a consistent appearance to the group, attributable to the relatively short time span during which the structures were erected. The houses along Bigelow Street feature an abundance of high quality decorative detail and variations in plan. Rooflines and setback are uniform, following the rising incline of the street. When built, the average cost of these elegant and imposing houses was about \$11,000, a high price for the period. Occupants of the houses included prosperous businessmen and government officials, including a Clerk of the Courts, a government detective, a commission merchant at Central Wharf, the Treasurer of the Cambridgeport Savings Bank, and a successful leather merchant.

1. Simeon Snow House (1869), 7 Bigelow Street

A side-hall Mansard with flush-boarded facade, quoins and an entrance porch with segmental quadrant struts; the home of Simeon Snow, a leather merchant.

2. 9-11 Bigelow Street (1874)

A double Mansard house of red brick with paired center entrances polygonal end bays.

3. Henry Bird House (1874), 13 Bigelow Street

A square Mansard with center pavilion and curvilinear dormers on a patterned slate roof. Henry Bird owned a Cambridge iron foundry.

continued

8. Bibliography and/or references such as local histories, deeds, assessor's records, early maps, etc.

INVENTORY FORM CONTINUATION SHEET

MASSACHUSETTS HISTORICAL COMMISSION
Office of the Secretary, Boston

page 2

Community: Mid. Cambridge	Form No: MC I.1
Property Name: Bigelow St. N.R.D.	

Indicate each item on inventory form which is being continued below.

4. 15 Bigelow Street (1873)
A center-pavilioned Mansard with spring eaves and a porch with chamfered posts and Corinthian capitals.
5. Hiram Whitely House (1873), 17 Bigelow Street
A side-hall Mansard with a steep, straight-edged roof and flush-boarded facade; the residence of Hiram Whitely, a government detective.
6. 21-23 Bigelow Street (1873)
Russell Snow was the builder of this unusual side entrance double Mansard.
7. Joseph Jessop House (1872), 25 Bigelow Street
A symmetrical, center-hall dwelling. The original Mansard roof has been replaced by a hip roof. This was the residence of Joseph Jessop, a local confectioner.
8. John W. Davis House (1870) 35 Bigelow Street
A small Mansard house with quoins and a steep, set-back roof. One-story octagonal bays flank the entrance. Built for John W. Davis, a commission merchant at Boston's Central Wharf.
9. Charles Montague House (1873), 6 Bigelow Street
A large, center-hall Mansard with paired porch columns and ornate capitals. Built for Charles Montagu, the treasurer of the Star Collar Company.
10. Theodore Hurd House (1883-84), 10-12 Bigelow Street
A Queen Anne house with a gable-on-hip roof and side entrances. Theodore Hurd was the Clerk of the Courts.
11. Edward Hyde House (1870), 22 Bigelow Street
An imposing symmetrical towered Mansard, moved to its present site to make way for the construction of City Hall. Notable features include its towered center pavilion, rusticated wooden facade and corner quoins. The house was the residence of Edward Hyde, Treasurer of the Cambridgeport Savings Bank.

continued

Staple to Inventory form at bottom

INVENTORY FORM CONTINUATION SHEET

MASSACHUSETTS HISTORICAL COMMISSION
Office of the Secretary, Boston

Page 3

Community: Mid Cambridge	Form No: MC I.1
Property Name: Bigelow St. N.R.D.	

Indicate each item on inventory form which is being continued below.

The Bigelow Street National Register District encompasses both sides of Bigelow Street between Harvard Street and Massachusetts Avenue (see Cambridge Community Development P. D. Quad Map 3). Boundaries were chosen to include properties from the mid nineteenth century development of this street.

-END-

Staple to Inventory form at bottom

United States Department of the Interior
National Park Service

National Register of Historic Places
Inventory—Nomination Form

For NPS use only
received
date entered

Continuation sheet

Item number

Page / of 17

Multiple Resource Area
Thematic Group

dnr-11

Name Cambridge Multiple Resource Area
State MA

Nomination/Type of Review

Date/Signature

- ✓ 1. East Cambridge Historic District
Substantive Review
Keeper ✓ William H. Braham 6-30-83
Attest _____
- ✓ 2. Winter Street Historic District
Substantive Review
Keeper ✓ William H. Braham 4-13-82
Attest _____
- ✓ 3. Upper Magazine Street Historic District
Substantive Review
Keeper ✓ William H. Braham 4-13-82
Attest _____
- ✓ 4. Hastings Square Historic District
Substantive Review
Keeper ✓ William H. Braham 4-13-82
Attest _____
- ✓ 5. Salem-Auburn Streets Historic District
Substantive Review
Keeper ✓ William H. Braham 4-13-82
Attest _____
- ✓ 6. Inman Square Historic District
Substantive Review
Keeper ✓ William H. Braham 4-13-82
Attest _____
- ✓ 7. Old Cambridgeport Historic District
Substantive Review
Keeper ✓ William H. Braham 6-30-83
Attest _____
- ✓ 8. Norfolk Street Historic District
Substantive Review
Keeper ✓ William H. Braham 4-13-82
Attest _____
- ✓ 9. Cambridge Gateway Historic District
Substantive Review
Keeper ✓ return 4-13-82
Attest _____
DOE/OWNER OBJECTION
- ✓ 10. Bigelow Street Historic District
Substantive Review
Keeper ✓ William H. Braham 4-13-82
Attest _____

0-1-1-1-2
7-05-67

NATIONAL REGISTER OF HISTORIC PLACES

EVALUATION / RETURN SHEET

Property: Bigelow Street Historic District
 (Cambridge Multiple Resource Area)
 State, County: MA - Middlesex
 Federal Agency: _____

Working No. 11-14-80-2862
 Fed. Reg. Date: _____
 Date Due: 4/17/82
 Action: ACCEPT 4/13/82
 RETURN _____
 REJECT _____

- resubmission
- nomination by person or local government
- owner objection
- appeal

photos 5
 maps _____

Substantive Review: sample request appeal NR decision

Reviewer's comments:

fine row of mansard houses

Recom./Criteria C
 Reviewer Bracham
 Discipline Arch Hist
 Date 4.5.82
 see continuation sheet

Nomination returned for: technical corrections cited below
 substantive reasons discussed below

1. Name

2. Location

3. Classification

Category	Ownership	Status	Present Use
	Public Acquisition	Accessible	

4. Owner of Property

5. Location of Legal Description

6. Representation in Existing Surveys

Has this property been determined eligible? yes no

7. Description

Condition		Check one	Check one
<input type="checkbox"/> excellent	<input type="checkbox"/> deteriorated	<input type="checkbox"/> unaltered	<input type="checkbox"/> original site
<input type="checkbox"/> good	<input type="checkbox"/> ruins	<input type="checkbox"/> altered	<input type="checkbox"/> moved date _____
<input type="checkbox"/> fair	<input type="checkbox"/> unexposed		

Describe the present and original (if known) physical appearance

- summary paragraph
- completeness
- clarity
- alterations/integrity
- dates
- boundary selection

8. Significance

Period _____ Area of Significance—Check and justify below

Specific dates _____ Builder/Architect _____

Statement of Significance (in one paragraph)

- summary paragraph
- completeness
- clarity
- applicable criteria
- justification of areas checked
- relating significance to the resource
- context
- relationship of integrity to significance
- justification of exception
- other

9. Major Bibliographical References

10. Geographical Data

Acres of nominated property _____

Quadrangle name _____

USGS References

Verbal boundary description and justification

11. Form Prepared By

12. State Historic Preservation Officer Certification

The evaluated significance of this property within the state is:

national state local

State Historic Preservation Officer signature _____

Title _____ Date _____

13. Other

- Maps
- Photographs
- Other

Questions concerning this nomination may be directed to _____

Signed _____ Date _____ Phone: 202 272-3504

Comments for any item may be continued on an attached sheet



1093-30A

NOV 14 1980

980C

7 Bigelow

1093-30A



1093-31A

NOV 14 1980

9300

6 Bigelow

1093-31A



1093-36A

NOV 14 1980

9800

42-46 Bigelow St.

1093-36A



1093-32A

NOV 14 1980

9800

22 Bigelow

1093-32A



1106-33A

NOV 1 4 1980

064C

BIGELOW ST.

19-21 1/2 Inman

1106 -33A

Please refer to the map in the
Multiple Property Cover Sheet
for this property

Multiple Property Cover Sheet Reference Number: 64000275

LAW OFFICES

KIRK S. GIFFEN

11 BEACON STREET
P. O. BOX 866
BOSTON, MA 02103-0866
AREA CODE 617
227-1900

• December 21, 1981

RECEIVED

DEC 28 1981

MASS. HIST. COMM.

Patricia L. Weslowski, Executor Director
Massachusetts Historical Commission
294 Washington Street
Boston, Mass. 02108

Dear Ms. Weslowski:

RE: Lewis Macauley
8 Bigelow Street (118-35)
Cambridge, Mass.
Bigelow Street National Register District

I, Lewis Macauley, hereby certify that I am the owner of the house and land at 8 Bigelow Street, Cambridge, Massachusetts, and in accordance with the National Historic Preservation Act Amendments of 1980 and Federal Regulations 36 CFR Part 60, hereby object to the listing of my property at 8 Bigelow Street, Cambridge, as part of the proposed Bigelow Street National Register District.

I feel strongly about having any additional limitations placed on my use of the property. There are, in my opinion, more than enough restrictions imposed by zoning, sanitary code standards, and Rent Control, now.

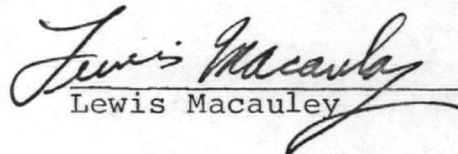

Lewis Macauley

COMMONWEALTH OF MASSACHUSETTS

Middlesex SS

12/23 / 1981

Then personally appeared the above named Lewis Macauley, known to me, and made oath to the foregoing and acknowledged that he executed the same as his free act and deed, before me.

Kirk S. Giffen, Notary Public

My Commission expires 9/8/88

MAR 3 1982