

PH0006408

STATE:
Massachusetts

COUNTY:
Essex

FOR NPS USE ONLY

**NATIONAL REGISTER OF HISTORIC PLACES
INVENTORY - NOMINATION FORM**

(Type all entries - complete applicable sections)

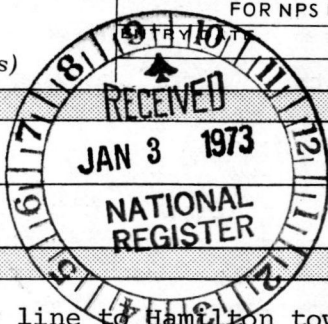

APR 13 1973

1. NAME

COMMON:
Wenham Historic District

AND/OR HISTORIC:
same

2. LOCATION

STREET AND NUMBER:
Main Street, both sides, from Beverly city line to Hamilton town line

CITY OR TOWN:
Wenham

CONGRESSIONAL DISTRICT:
6th

STATE: Massachusetts

CODE: 025

COUNTY: Essex

CODE: 009

3. CLASSIFICATION

CATEGORY (Check One)	OWNERSHIP	STATUS	ACCESSIBLE TO THE PUBLIC
<input checked="" type="checkbox"/> District <input type="checkbox"/> Site <input type="checkbox"/> Building <input type="checkbox"/> Structure <input type="checkbox"/> Object	<input type="checkbox"/> Public <input type="checkbox"/> Private <input checked="" type="checkbox"/> Both	<input checked="" type="checkbox"/> Occupied <input type="checkbox"/> Unoccupied <input type="checkbox"/> Preservation work in progress <input type="checkbox"/> In Process <input type="checkbox"/> Being Considered	Yes: <input checked="" type="checkbox"/> Restricted <input type="checkbox"/> Unrestricted <input type="checkbox"/> No

PRESENT USE (Check One or More as Appropriate)

<input type="checkbox"/> Agricultural	<input checked="" type="checkbox"/> Government	<input checked="" type="checkbox"/> Park	<input type="checkbox"/> Transportation	<input type="checkbox"/> Comments
<input checked="" type="checkbox"/> Commercial	<input type="checkbox"/> Industrial	<input checked="" type="checkbox"/> Private Residence	<input type="checkbox"/> Other (Specify)	
<input checked="" type="checkbox"/> Educational	<input type="checkbox"/> Military	<input checked="" type="checkbox"/> Religious		
<input type="checkbox"/> Entertainment	<input checked="" type="checkbox"/> Museum	<input type="checkbox"/> Scientific		

4. OWNER OF PROPERTY

OWNER'S NAME:
Multiple

STREET AND NUMBER:
Main Street, both sides, from Beverly city line to Hamilton town line

CITY OR TOWN:
Wenham

STATE:
Massachusetts

CODE:
025

5. LOCATION OF LEGAL DESCRIPTION

COURTHOUSE, REGISTRY OF DEEDS, ETC.:
Essex County Registry of Deeds

STREET AND NUMBER:
Federal Street

CITY OR TOWN:
Salem

STATE:
Massachusetts

CODE:
025

6. REPRESENTATION IN EXISTING SURVEYS

TITLE OF SURVEY:
Inventory of Historic Assets of the Commonwealth

DATE OF SURVEY: 1971

Federal State County Local

DEPOSITORY FOR SURVEY RECORDS:
Massachusetts Historical Commission

STREET AND NUMBER:
40 Beacon Street

CITY OR TOWN:
Boston

STATE:
Massachusetts

CODE:
025

STATE: Massachusetts

COUNTY: Essex

ENTRY NUMBER: APR 13 1973

FOR NPS USE ONLY

DATE

SEE INSTRUCTIONS

7. DESCRIPTION

CONDITION	(Check One)					
	<input checked="" type="checkbox"/> Excellent	<input checked="" type="checkbox"/> Good	<input checked="" type="checkbox"/> Fair	<input type="checkbox"/> Deteriorated	<input type="checkbox"/> Ruins	<input type="checkbox"/> Unexposed
	(Check One)			(Check One)		
	<input checked="" type="checkbox"/> Altered	<input checked="" type="checkbox"/> Unaltered		<input checked="" type="checkbox"/> Moved	<input checked="" type="checkbox"/> Original Site	

DESCRIBE THE PRESENT AND ORIGINAL (if known) PHYSICAL APPEARANCE

Wenham Historic District extends for 1.8 miles along both sides of Main Street (Route 1A), starting at the Beverly line and ending at the Hamilton line. The road runs in a northerly direction for about one mile, then, curving as it enters the center of town, continues on to the Hamilton line in a north-easterly direction. State Route 1A is a well traveled highway through the center of this small, tree-shaded New England village.

Entrance to Wenham from the south is marked by two striking landscape features. The shores of Wenham Lake appear on the westerly side, while to the east, Pond Hill rises sharply, then falls to flood plain level. A series of low hills and ridges continue along this side of the road as far as the center of town. Beyond this point, both sides are completely level. Prominent open space features between Pond Hill and the town center include two golf courses, both of which slope upward to ridges slightly beyond the District boundaries. Between these golf courses is located the town cemetery. Bordering the street is Old Burial Hill, its use dating from the 17th century. On the westerly side of the road, open areas appear at intervals, including a town park of 13.5 acres.

The Historic District contains 89 buildings, the majority of which are located rather close to the street. Buildings other than residences include the Town Hall, a fire and police station, public library, the First Church, the Wenham Historical Association & Museum, a tea house and a dress shop, the post office, a real estate office, a small grocery, a sport shop and an office building. Except for the church and town hall, all are very small in scale. The form of Main Street is typical of a small New England town in which may be traced a pattern of evolution from early beginnings as a farming community.

Wenham Historic District represents three centuries of architecture, including buildings of a wide variety of styles, from the 17th century through the 19th century, with modifications of the more formal and conventional city styles to fit the needs of a rural community. Main Street's houses of all periods are modest in size, seldom pure in style, a mix of features often altered to suit the needs of successive generations.

Architecturally important buildings include the following. (All are of clapboard, wood frame construction, with the exception of the brick Lummus Tavern.)

Clafin-Richards House - built in 1662 with a 1673 addition; already submitted to the National Register.

John Solart, Sr. House - c. 1670; ridge roof, center chimney with gable end to the street; enlarged in 1696 and again in 1740; five bays wide and one bay deep.

Richard Hutton House - c. 1679; originally one room; enlarged to two-story, two rooms with center chimney. Due to alterations in 1726, 1745, 1842 and 1870's, house now has Greek Revival pediments on end gables and is five bays wide with covered center entrance on facade; two small chimneys set in rear slope of ridge roof.

Hobbs House - core of house built in 1688, incorporated into present gambrel roof colonial in 1760; two large chimneys set in from sides of roof; five bays wide and two deep, with simple pedimented and pilastered center entrance.

Ebenezer Batchelder, Sr. House - early 18th century with two interior chimneys replacing original center chimney; center entrance with enclosed porch.

(continued)

SEE INSTRUCTIONS

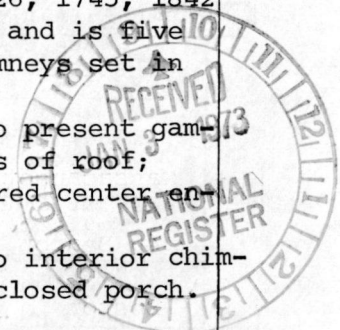

already

**NATIONAL REGISTER OF HISTORIC PLACES
INVENTORY - NOMINATION FORM**

(Continuation Sheet)

STATE	Massachusetts
COUNTY	Essex
FOR NPS USE ONLY	
ENTRY NUMBER	DATE
	APR 13 1973

(Number all entries)

WENHAM HISTORIC DISTRICT

7. Physical Appearance (continued)

Dr. Samuel Dodge House - c. 1804; Federal style with small center chimney; gable end to street; center entrance on five bay facade.

Lummas Tavern - 1826 late Federal style; only old brick structure in the District. Excellent example of stage coach inn of the period with four end chimneys set in the front and rear slopes of the broad ridge roof; arched center entrance with fanlight; original kitchen wing to the rear.

Town Hall - modified Italian Villa style; main center block, with arched second floor windows, protrudes two bays from two large side wings; latter have wooden quoins.

Other nineteenth century buildings include early to mid-century country style farmhouse "colonials" (many with Greek Revival features), two mid-century mansard style, several in the carpenter Gothic style (one an exceptionally beautiful example) and a large variety of mixed Victorian styles with Greek Revival or Gothic features. 60% of the buildings along Main Street were built by 1900. With a few exceptions, buildings in the area are in excellent condition. Buildings and grounds are well maintained and enhance the natural charm and beauty of the entire town.



8. SIGNIFICANCE

PERIOD (Check One or More as Appropriate)

- Pre-Columbian 16th Century 18th Century 20th Century
 15th Century 17th Century 19th Century

SPECIFIC DATE(S) (If Applicable and Known) 1638, 1643, 1710

AREAS OF SIGNIFICANCE (Check One or More as Appropriate)

- | | | | |
|--------------------------------------------------|-------------------------------------------------|---------------------------------------------------------|------------------------------------------|
| <input type="checkbox"/> Aboriginal | <input type="checkbox"/> Education | <input checked="" type="checkbox"/> Political | <input type="checkbox"/> Urban Planning |
| <input type="checkbox"/> Prehistoric | <input type="checkbox"/> Engineering | <input checked="" type="checkbox"/> Religion/Philosophy | <input type="checkbox"/> Other (Specify) |
| <input checked="" type="checkbox"/> Historic | <input checked="" type="checkbox"/> Industry | <input type="checkbox"/> Science | |
| <input checked="" type="checkbox"/> Agriculture | <input type="checkbox"/> Invention | <input type="checkbox"/> Sculpture | |
| <input checked="" type="checkbox"/> Architecture | <input type="checkbox"/> Landscape Architecture | <input type="checkbox"/> Social/Humanitarian | |
| <input type="checkbox"/> Art | <input type="checkbox"/> Literature | <input type="checkbox"/> Theater | |
| <input checked="" type="checkbox"/> Commerce | <input checked="" type="checkbox"/> Military | <input checked="" type="checkbox"/> Transportation | |
| <input type="checkbox"/> Communications | <input type="checkbox"/> Music | | |
| <input type="checkbox"/> Conservation | | | |

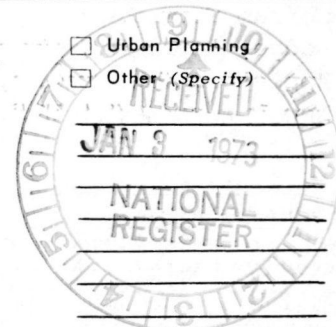

STATEMENT OF SIGNIFICANCE

Wenham Historic District presents the picture of a typical old New England main street with village green, essentially unchanged during the greater part of its long history. Its atmosphere is of a semi-rural residential community, yet many characteristics of its early beginnings as a completely rural agricultural settlement are retained. Several factors unite the individual buildings in this area, which is defined by natural boundaries. Of great importance is the continuous thread of history which shows a pattern of participation in the significant events of town, state and nation as they have occurred during the more than 325 years of Wenham's existence. Of equal importance is architecture, but not in the usual sense of numerous buildings of the same period or style. Rather the area is important because of its architectural variety, a quite unusual picture of changing styles covering a span of three centuries. Many buildings were the homes of craftsmen who carried on small local industries: millers, tanners, shoemakers, blacksmiths, wheelwrights, carpenters, weavers and spinners. Other residents were beekeepers, farmers, shopkeepers or innkeepers. Occasionally more ambitious businesses were conducted in buildings now destroyed, including at least two shoe manufactories.

The main street of the town was originally an Indian path skirting the shores of the Great Pond (Wenham Lake). This area was the fishing and hunting ground as well as the home of Naumkeag Indians from the Algonquin tribe, an agricultural people who left evidence of their occupation of the land near the pond. Large numbers of stone implements have been found, and remains of their hillocks, planted with corn and fertilized with alewives from the stream running to the lake, can be seen upon the nearby golf course.

White settlement of the area began in 1635 with grants of land to the "Old Planters" along the now North Beverly shore, followed shortly by grants to other settlers who spread northward along the old "Bay Path". In 1638, Hugh Peter, pastor of the church in Salem, preached a sermon of encouragement to prospective Wenham settlers from a small hill beside the lake, a spot now commemorated by a plaque. Peter, politically involved with Oliver Cromwell before coming to Salem, later returned to England where he continued his association with Cromwell as a chaplain and as a famous preacher among the Puritans. In 1643 Wenham was established as a town by the General Court.

Topography not only influenced the choice of site for the early settlement but very likely favored as well the location of the entire Bay Path between Salem and Newburyport as it left the coast to cut inland, following Indian pathways to connect early land grants around the pond with neighboring settlements to the north. Three half-milestones dated 1710 still re-

(continued)

SEE INSTRUCTIONS

UTM
 W M 9-11-75
 A 346200
 B 345310
 C 344460
 D 345350
 20N19
 4718940
 4716870
 4717210
 4719310

SEE INSTRUCTIONS

9. MAJOR BIBLIOGRAPHICAL REFERENCES

1. Allen, Myron O., The History of Wenham, Boston 1860
2. Cole, Adeling P., Notes on Wenham History 1643-1943, Salem, 1943
3. Phillips, John C., Wenham Great Pond, Salem 1938
4. Dodge, Louis A., Early Wenham Meeting Houses, Wenham 1959
5. Wenham Town Records, 1642 - 1810
6. Dodge, Louis A., Wenham As It Used To Be, Wenham 1968
7. Appleton, Wm. Sumner, A Description of Robert McClaflin's House, Old Time New England, S.P.N.E.A., April, 1926

10. GEOGRAPHICAL DATA

LATITUDE AND LONGITUDE COORDINATES DEFINING A RECTANGLE LOCATING THE PROPERTY			O R	LATITUDE AND LONGITUDE COORDINATES DEFINING THE CENTER POINT OF A PROPERTY OF LESS THAN TEN ACRES		
CORNER	LATITUDE	LONGITUDE		LATITUDE	LONGITUDE	
NW	Degrees Minutes Seconds 42 ° 36 ' 45 1/2 "	Degrees Minutes Seconds 70 ° 53 ' 08 "	Degrees Minutes Seconds ° ' "	Degrees Minutes Seconds ° ' "		
NE	42 ° 36 ' 34 1/2 "	70 ° 52 ' 30 "				
SE	42 ° 35 ' 25 "	70 ° 53 ' 08 "				
SW	42 ° 35 ' 36 "	70 ° 53 ' 44 "				

APPROXIMATE ACREAGE OF NOMINATED PROPERTY: C. 190

LIST ALL STATES AND COUNTIES FOR PROPERTIES OVERLAPPING STATE OR COUNTY BOUNDARIES

STATE:	CODE	COUNTY	CODE



11. FORM PREPARED BY

NAME AND TITLE: Elizabeth R. Amadon, Regional Director 727-8470

ORGANIZATION: Massachusetts Historical Commission DATE: 4/11/72

STREET AND NUMBER: 40 Beacon Street

CITY OR TOWN: Boston 02108 STATE: Massachusetts CODE: 025

12. STATE LIAISON OFFICER CERTIFICATION NATIONAL REGISTER VERIFICATION

As the designated State Liaison Officer for the National Historic Preservation Act of 1966 (Public Law 89-665), I hereby nominate this property for inclusion in the National Register and certify that it has been evaluated according to the criteria and procedures set forth by the National Park Service. The recommended level of significance of this nomination is:

National State Local

Name: John F. X. Davoren
 JOHN F. X. DAVOREN, Secretary of the Commonwealth, Chairman of the Massachusetts Historical Commission
 Title: _____
 Date: 12/18/72

I hereby certify that this property is included in the National Register.

Robert M. Utley
 Director, Office of Archeology and Historic Preservation

Date: 4/13/73

ATTEST:

W. Bradford
 Keeper of The National Register
 Date: April 9, 1973

NATIONAL REGISTER OF HISTORIC PLACES
INVENTORY - NOMINATION FORM

(Continuation Sheet)

STATE Massachusetts	
COUNTY Essex	
FOR NPS USE ONLY	
ENTRY NUMBER JAN 3 1973	DATE APR 18 1973

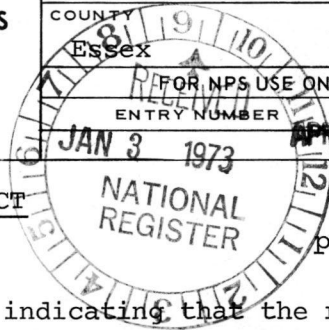

p.2

(Number all entries)

WENHAM HISTORIC DISTRICT

8. Significance (continued)

main in place on the easterly side of Main Street indicating that the road, at an early date, followed along below the ridge line to the east and avoided the great swamplands to the west. These half-milestones indicate distances to Salem, Boston, Ipswich and Newburyport.

Not far from the lake is the town cemetery, with its old Burial Hill prominently located beside the roadway. Though the hill was probably used for this purpose from earliest settlement, first mention as to its use and care appears in the Town Records of 1681. The earliest legible gravestone is dated 1713.

Use was continually made of the pond area for recreational purposes. Early 18th century town records are filled with regulations as to its use and the preservation of common rights. The beauty of the lake and its profusion of fish and water fowl attracted not only local residents but also summer visitors and travelers from abroad. By the time of the Revolution, political and literary figures were familiar with the area. In 1774 General Gage changed his residence from Boston to Danvers and made frequent excursions to nearby Wenham Lake for rides on a "pleasure barge".

Little occurred to disturb the serenity of the lake until the coming of the ice industry in the mid-19th century. Beginning with the construction of ice houses in 1842, Wenham Lake ice became internationally famous as it was shipped all over the world. So great was the demand for this ice that an imitation was marketed from a lake in Norway renamed Wenham Lake. In 1873 fire destroyed most of the ice plant and only local markets were supplied for the remainder of the century. Almost no trace of this industry remains today.

Two other sites within the District serve today as reminders of Wenham's past. Pingree Field, now a park of 13 acres, was, during the Civil War period, a principle part of Camp Lander. 130 Wenham men served in this war. During the late 19th century, horse cars were a familiar mode of transportation. A small grassy plot in the center of town is the site on which the Naumkeag Street Railroad, having received permission to extend its line into Wenham, erected a house for the cars and a stable for forty horses. The line proved to be most profitable and was one of the last to be discontinued.

Of the early houses still standing on Main Street, a number have particularly important associations. The Claflin-Richards House was built in 1662 by Robert MacClaflin, with an addition in 1673 for the use of the Rev. Joseph Ger-rish. This house has previously been submitted to the National Register.

The Richard Hutton House (c. 1679), at 185 Main Street, was the home of one of the early settlers of the town. Hutton was seven times a selectman and active in other town affairs in the latter half of the 17th century. Occupying the house in the late 18th century was Dr. Daniel Killam. He was a member of both branches of the General Court, member of the Governor's Council, political friend of John Quincy Adams and of Timothy Pickering and one of the founders of the American Academy of Arts and Sciences.

The Hobbs House (1688) at the corner of Monument Square and Main Street was, in 1760, the home of Nathaniel Brown, a justice of the peace and long active in town affairs in pre-revolutionary times, a loyalist who remained in Wenham during the war. The house was later occupied by Deacon Moses Foster, a town

(continued)

NATIONAL REGISTER OF HISTORIC PLACES
INVENTORY - NOMINATION FORM

(Continuation Sheet)

STATE	
COUNTY	
FOR NPS USE ONLY	
ENTRY NUMBER	DATE
	APR 13 1973

(Number all entries)

WENHAM HISTORIC DISTRICT

8. Significance (continued)

p.3

clerk for many years and representative to the General Court during the 1830's. Henry Hobbs acquired the house in 1865 and operated an adjoining harness shop.

The Lummus Tavern of 1826, located at 188 Main Street, was an important inn on the road from Salem to Newburyport. It included a cluster of buildings geared to the comfort of stagecoach passengers and the care of vehicles and horses. The old tavern sign with its symbol of Masonry still exists and points out the use of the tavern for Masonic meetings. The house also served as a post office between 1830 and 1837 and sometime later as a district school.

The First Church in Wenham, at Main and Arbor Streets, was organized in 1644 in what was probably a very rude and temporary meeting house. The present church building was constructed in 1843, the fifth in a series of meetinghouses erected to keep pace with the changing needs of the community. Although in 1833 separation of church and state became a law of the Commonwealth, town meetings continued to be held in the church until 1853. In 1815 a Sunday School was organized, one of the first in the country. The steeple clock has been serving as a town clock since 1867.

Wenham Town Hall, 134 Main Street, was constructed in 1853, the first building to be built specifically for the use of town meetings. It contained a large meeting room on the second floor, while the first floor housed the town offices as well as a schoolroom. The latter room became available for use as a public library in 1885.

A series of buildings deserve mention because of local historical interest. These are located in the business section of the town center and include the Perkins Drug Store (1877) now a grocery, the Stanton-Porter grocery store (1897) now a dwelling, the old fire house of 1849 and the "new" fire house of 1901, the latter two still used for other town facilities.

The town of Wenham voted this district a local Historic District in March, 1972.



PROPERTY Wendham Historic District STATE Mass.

WORKING NUMBER 1.3.73.2064

Essex

6-4-73

TECH REVIEW
Photos 2
Maps 2

DB # 73 006852

CONTROL REVIEW

maf
2-27-73

HISTORIAN

Accept - AML
3/26/73
Accept 4-3-73
shull

ARCHITECTURAL HISTORIAN although form says "moved" the majority of buildings seem original and on moved. Really nice

Accept
141
4/4/73

ARCHEOLOGIST

REVIEW UNIT CHIEF

BRANCH CHIEF

DR [Signature]
4/6/73

KEEPER

OT
[Signature]
4/9/73

National Register write-up _____

Send-back _____

Federal Register entry 6-5-73

Re-submit _____

Entered APR 13 1973



WENHAM MUSEUM
CLAFIN-RICHARDS
HOUSE

MONDAY-FRIDAY
1-4 PM

FIRE
STATION
RIGHT

WENHAM PUBLIC
LIBRARY

ONE
WAY

WENHAM MUSEUM
CLAFIN-RICHARDS HOUSE
MONDAY-FRIDAY 1-4 PM

S-24-A
WENHAM, MASS.
TOWN HALL

LOOKING NORTH FROM SOUTH
SIDE OF MAIN ST, WITH BUSINESS
DISTRICT IN THE DISTANCE

PHOTOGRAPHER
NEWTON HYSLOP
151 MAIN ST

1972

NPS Number 4/13/73

FORM 10-301 A
(6/72)

UNITED STATES DEPARTMENT OF THE INTERIOR
NATIONAL PARK SERVICE

NATIONAL REGISTER OF HISTORIC PLACES
PROPERTY PHOTOGRAPH FORM

(Type all entries - attach to or enclose with photograph)

#1

1. NAME

COMMON

Wenham Historic District

AND/OR HISTORIC

same

NUMERIC CODE (Assigned by NPS)

APR 13 1973

2. LOCATION

STATE

Massachusetts

COUNTY

Essex

TOWN

Wenham

STREET AND NUMBER

Both sides of Main Street, from Beverly city line to Hamilton town line

3. PHOTO REFERENCE

PHOTO CREDIT

Newton Hyslop

DATE

1972

NEGATIVE FILED AT

151 Main Street, Wenham

4. IDENTIFICATION

DESCRIBE VIEW, DIRECTION, ETC.

Looking north from south side of Main Street, with Town Hall on right

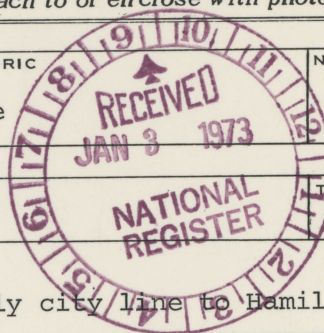



N-24-C
WENHAM, MASS.
MONUMENT SQ.

LOOKING N.W., WITH VIEW OF
HOBBS HOUSE AND FIRST CHURCH,
FROM TOWN HALL ACROSS MAIN ST

PHOTOGRAPHER
NEWTON HYSLOP
151 MAIN ST

1972

NPS Number 4/13/73

Tit:

Loc

FORM 10-301 A
(6/72)

UNITED STATES DEPARTMENT OF THE INTERIOR
NATIONAL PARK SERVICE

NATIONAL REGISTER OF HISTORIC PLACES
PROPERTY PHOTOGRAPH FORM

(Type all entries - attach to or enclose with photograph)

1. NAME

COMMON

Wenham Historic District

AND/OR HISTORIC

same

NUMERIC CODE (Assigned by NPS)

APR 13 1973

2. LOCATION

STATE

Massachusetts

COUNTY

Essex

TOWN

Wenham

STREET AND NUMBER

Both sides of Main Street, from Beverly city line to Hamilton town line

3. PHOTO REFERENCE

PHOTO CREDIT

Newton Hyslop

DATE

1972

NEGATIVE FILED AT

151 Main St., Wenham

4. IDENTIFICATION

DESCRIBE VIEW, DIRECTION, ETC.

Looking northwest across Main Street, with view of Hobbs House and First Church on Monument Square



PROPERT

UNITED STATES DEPARTMENT OF THE INTERIOR
NATIONAL PARK SERVICE

**NATIONAL REGISTER OF HISTORIC PLACES
PROPERTY MAP FORM**

(Type all entries - attach to or enclose with map)

1. NAME

COMMON

Wenham Historic District

AND/OR HISTORIC

same

NUMERIC CODE *(Assigned by NPS)*

APR 13 1973

2. LOCATION

STATE

Massachusetts

COUNTY

Essex

TOWN

Wenham

STREET AND NUMBER

Both sides of Main Street, from Beverly city line to Hamilton town line

3. MAP REFERENCE

SOURCE

USGS Salem, Mass. series
V814

DATE

1956

SCALE

1: 24,000

REQUIREMENTS: PROPERTY BOUNDARIES, WHERE REQUIRED, AND NORTH ARROW



WENHAM HISTORIC DISTRICT

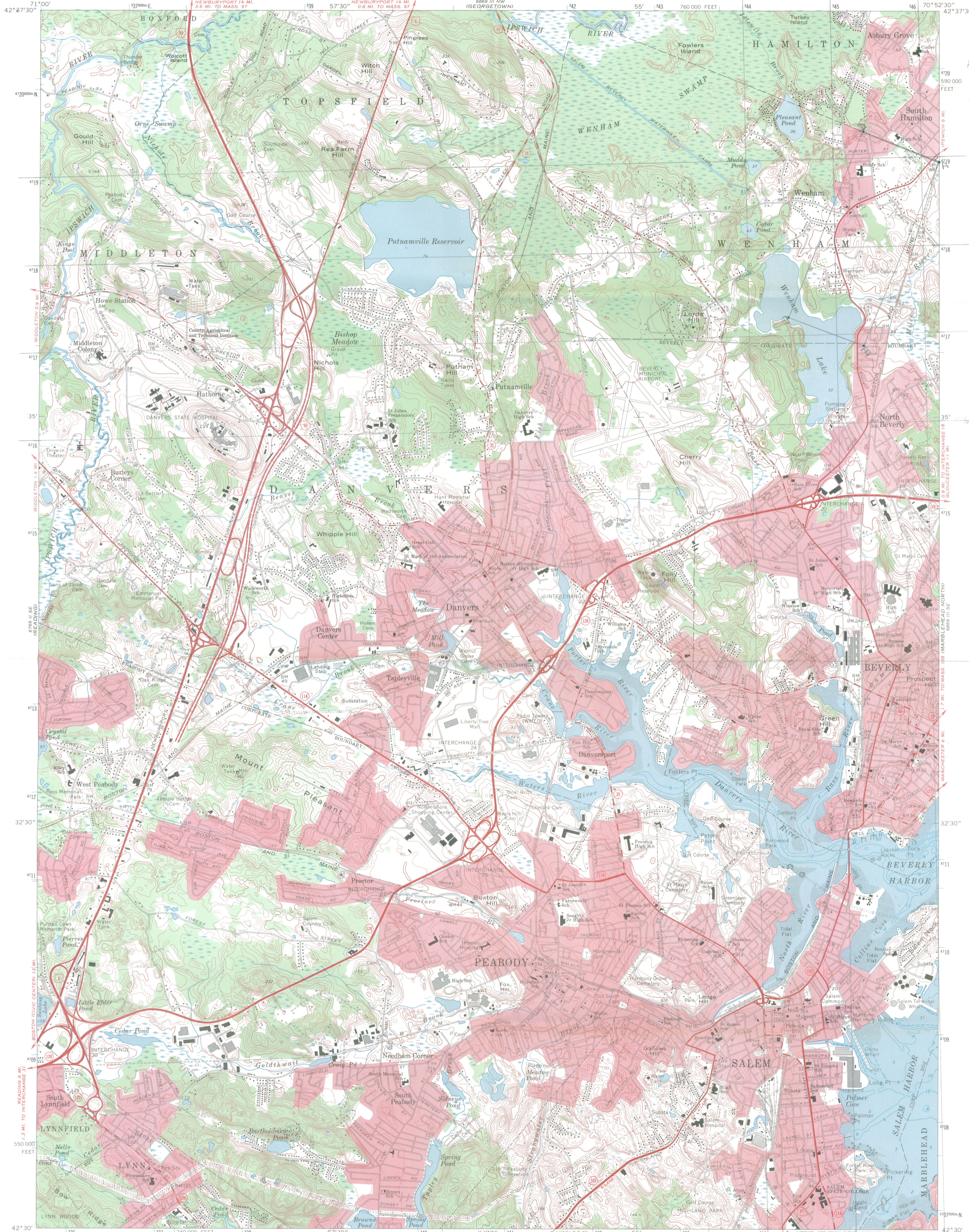

UTM W 11-15
Zone 19
A 346200
4718940
B 345310
4716870
C 344460
4717210
D 345350
4719310

Mapped, edited, and published by the Geological Survey
Control by USGS, USC&GS, and Massachusetts Geodetic Survey
Planimetry by photogrammetric methods from aerial photographs
taken 1938. Topography by planetable surveys 1942
Revised from aerial photographs taken 1969. Field checked 1970
Selected hydrographic data compiled from USC&GS Charts 240 and
241 (1970). This information is not intended
for navigational purposes.
Polyconic projection. 1927 North American datum
10,000-foot grid based on Massachusetts coordinate system
mainland zone
1000-meter Universal Transverse Mercator grid ticks,
zone 19, shown in blue
Boundaries in tidalwater areas from information supplied
by Massachusetts Department of Public Works
Red tint indicates areas in which only landmark buildings are shown

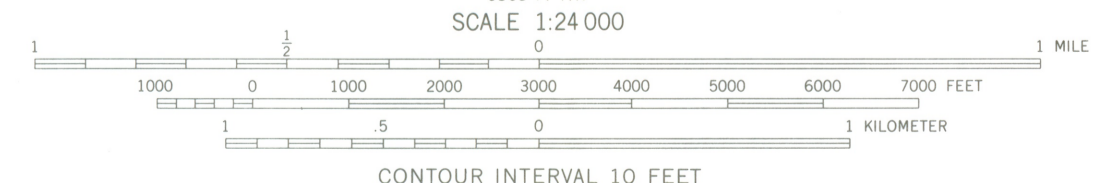
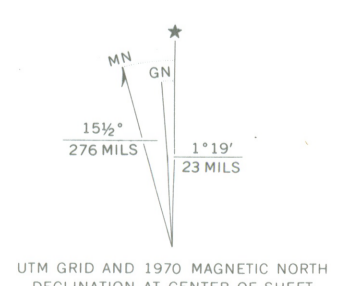

SCALE 1:24 000
CONTOUR INTERVAL 10 FEET
DATUM IS MEAN SEA LEVEL
DEPTH CURVES AND SOUNDINGS IN FEET—DATUM IS MEAN LOW WATER
SHORELINE SHOWN REPRESENTS THE APPROXIMATE LINE OF MEAN HIGH WATER
THE MEAN RANGE OF TIDE IS APPROXIMATELY 9 FEET



ROAD CLASSIFICATION
Primary highway, hard surface
Secondary highway, hard surface
Light-duty road, hard or improved surface
Unimproved road
Interstate Route
U. S. Route
State Route

SALEM, MASS.
N4230—W7052.5/7.5
1970
AMS 6869 III SW—SERIES V814

THIS MAP COMPLIES WITH NATIONAL MAP ACCURACY STANDARDS
FOR SALE BY U. S. GEOLOGICAL SURVEY, WASHINGTON, D. C. 20242
A FOLDER DESCRIBING TOPOGRAPHIC MAPS AND SYMBOLS IS AVAILABLE ON REQUEST

SETTS
WORKS
N 8 MI.
4 MI.

SALEM QUADRANGLE
MASSACHUSETTS - ESSEX CO.
7.5 MINUTE SERIES (TOPOGRAPHIC)

6869 III NE
(IPSWICH)

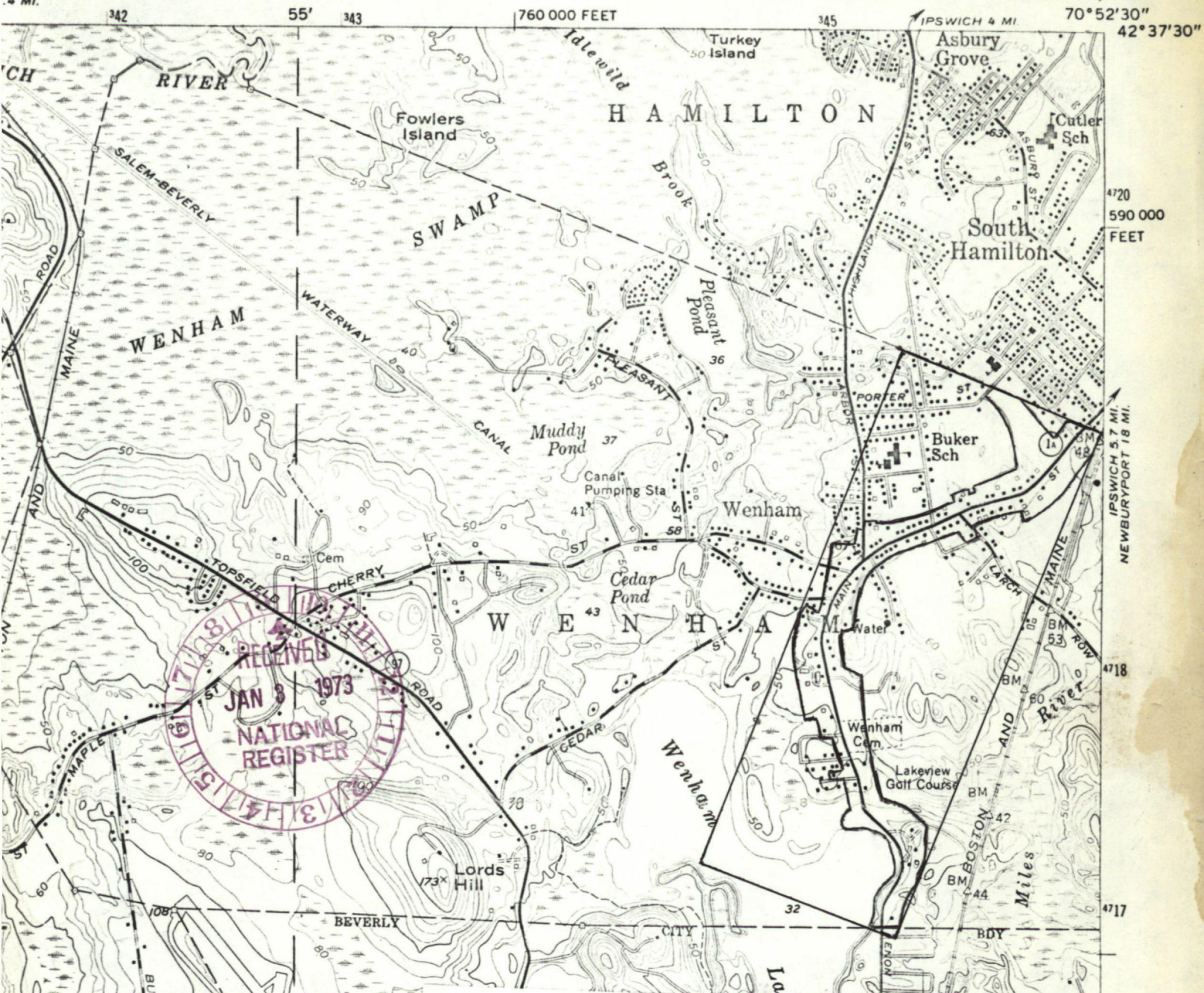

RECEIVED
JAN 8 1973
NATIONAL REGISTER

WENHAM, MASSACHUSETTS
WENHAM HISTORIC DISTRICT
U.S.G.S. Salem, Mass.
N4230 - W7052.5/7.5
1956
AMS 6869 III SW - SERIES V814



lat.	NW	42° 36' 45½"	long.	70° 53' 08"
	NE	42° 36' 34½"		70° 52' 30"
	SE	42° 35' 25"		70° 53' 08"
	SW	42° 35' 36"		70° 53' 44"

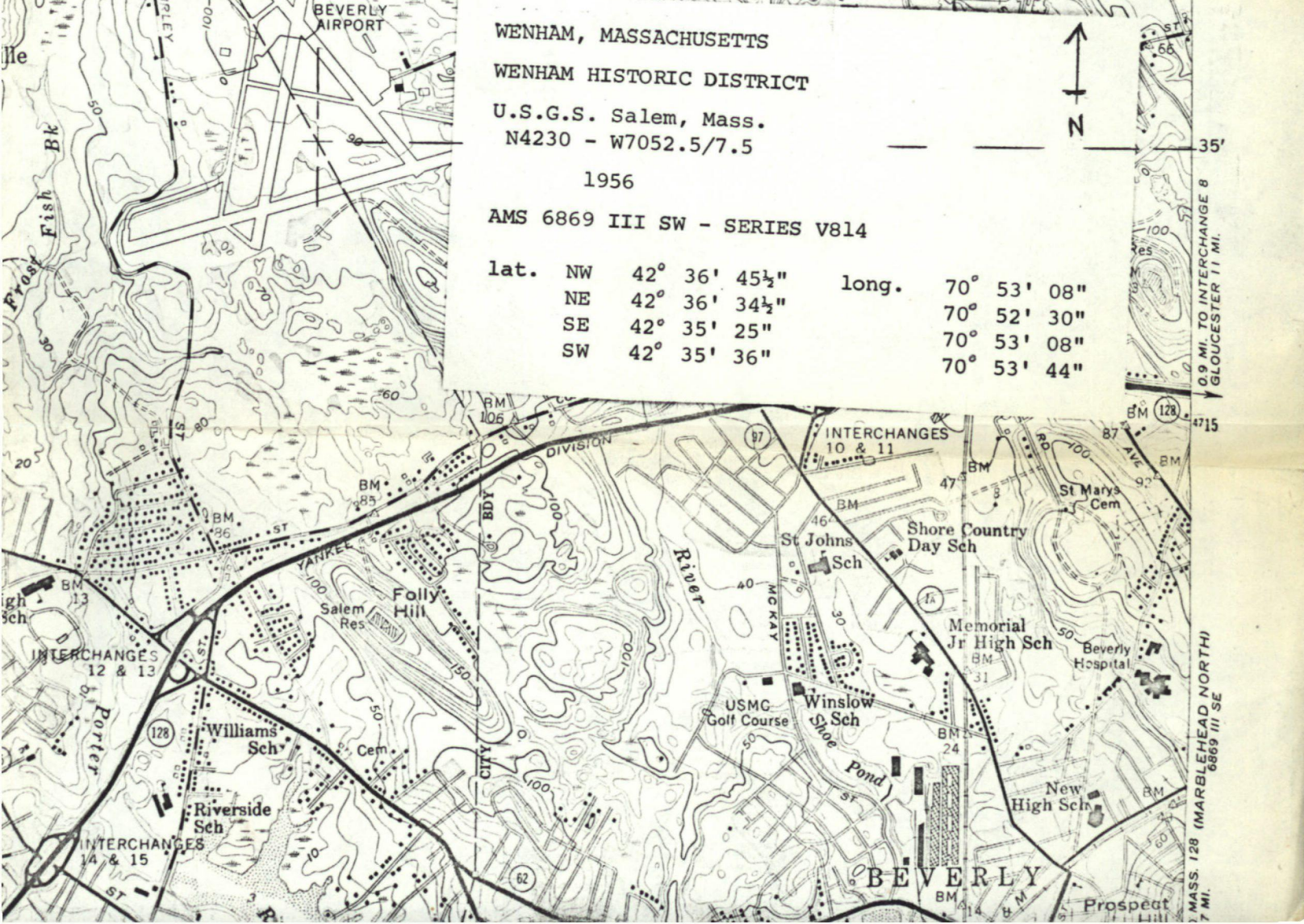

0.9 MI. TO INTERCHANGE 8
GLOUCESTER 11 MI.

MASS. 128 (MARBLEHEAD NORTH)
6869 III SE
7 MI.

**NATIONAL REGISTER OF HISTORIC PLACES
PROPERTY MAP FORM**

(Type all entries - attach to or enclose with map)

1. NAME

COMMON

Wenham Historic District

AND/OR HISTORIC

same

NUMERIC CODE *(Assigned by NPS)*

APR 13 1973

2. LOCATION

STATE

Massachusetts

COUNTY

Essex

TOWN

Wenham

STREET AND NUMBER

Both sides of Main Street, from Beverly city line to Hamilton town line

3. MAP REFERENCE

SOURCE

Sketch of entire Historic Dis.

DATE

1972

SCALE

1 in.: 300 ft.

REQUIREMENTS: PROPERTY BOUNDARIES, WHERE REQUIRED, AND NORTH ARROW



WENHAM

HISTORIC DISTRICT
1972

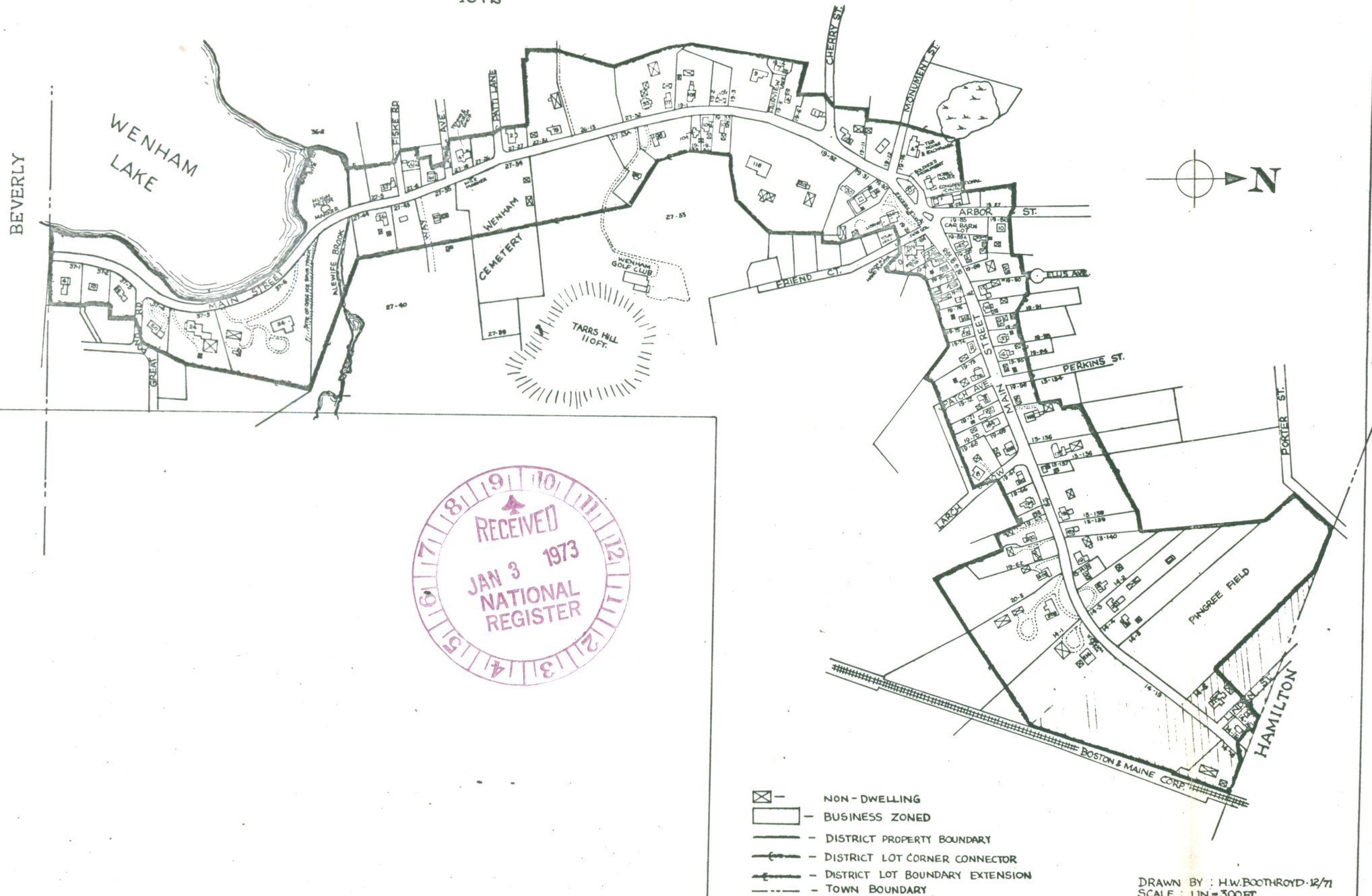

RECEIVED
JAN 3 1973
NATIONAL REGISTER

- ☒ - NON-DWELLING
- - BUSINESS ZONED
- - DISTRICT PROPERTY BOUNDARY
- - DISTRICT LOT CORNER CONNECTOR
- - DISTRICT LOT BOUNDARY EXTENSION
- - - - - TOWN BOUNDARY

DRAWN BY: H.W. BOOTHROYD-12/71
SCALE: 1 IN. = 300 FT.
0 150 300 600 1000 1200

ENTRIES IN THE NATIONAL REGISTER

STATE MASSACHUSETTS

Date Entered APR 13 1973

<u>Name</u>	<u>Location</u>
Cambridge Common Historic District	Cambridge Middlesex County
Wenham Historic District	Wenham Essex County
"Old Stone Church"	West Boylston Worcester County
Hamilton Historic District	Hamilton Essex County
Cyclorama Building	Boston (South End) Suffolk County

Also Notified

Hon. Edward M. Kennedy
Hon. Edward W. Brooke
Hon. Thomas P. O'Neill, Jr.
Hon. Michael J. Harrington
Hon. Robert Drinan
Mr. Floyd H. Hyde, HUD
Director, Northeast Region

State Historic Preservation Officer
Hon. John F.X. Davoren
Secretary of the Commonwealth
Chairman, Massachusetts Historical
Commission
40 Beacon Street
Boston, Massachusetts 02103

PHR

NRowland:pc1 4/27/73