

PH006785

H13 No utm

Form 10-300
(July 1969)

UNITED STATES DEPARTMENT OF THE INTERIOR
NATIONAL PARK SERVICE

NATIONAL REGISTER OF HISTORIC PLACES INVENTORY - NOMINATION FORM

(Type all entries - complete applicable sections)

STATE: Massachusetts	
COUNTY: Worcester	
FOR NPS USE ONLY	
ENTRY NUMBER 9/12.25.0019	DATE 12/16/71

1. NAME

COMMON:
Massachusetts Avenue Historic District

AND/OR HISTORIC:

2. LOCATION

Cong. District #4, Harold Donohue

STREET AND NUMBER:
between Salisbury Street and Drury Lane

CITY OR TOWN:
Worcester

STATE Massachusetts	CODE 25	COUNTY: Worcester	CODE 27
------------------------	------------	----------------------	------------

3. CLASSIFICATION

CATEGORY (Check One)	OWNERSHIP	STATUS	ACCESSIBLE TO THE PUBLIC
<input checked="" type="checkbox"/> District <input type="checkbox"/> Site <input type="checkbox"/> Building <input type="checkbox"/> Structure <input type="checkbox"/> Object	<input type="checkbox"/> Public <input type="checkbox"/> Private <input checked="" type="checkbox"/> Both	<input checked="" type="checkbox"/> Occupied <input type="checkbox"/> Unoccupied <input type="checkbox"/> Preservation work in progress	Yes: <input checked="" type="checkbox"/> Restricted <input type="checkbox"/> Unrestricted <input type="checkbox"/> No exteriors
PRESENT USE (Check One or More as Appropriate)			
<input type="checkbox"/> Agricultural <input type="checkbox"/> Commercial <input checked="" type="checkbox"/> Educational <input type="checkbox"/> Entertainment	<input type="checkbox"/> Government <input type="checkbox"/> Industrial <input type="checkbox"/> Military <input type="checkbox"/> Museum	<input checked="" type="checkbox"/> Park <input checked="" type="checkbox"/> Private Residence <input type="checkbox"/> Religious <input type="checkbox"/> Scientific	<input type="checkbox"/> Transportation <input checked="" type="checkbox"/> Other (Specify) <u>institutional</u> <u>(dormitory)</u>

4. OWNER OF PROPERTY

OWNER'S NAME:
private, city of Worcester (park)

STREET AND NUMBER:
Mass. Avenue

CITY OR TOWN:
Worcester

STATE: Mass.	CODE 25
-----------------	------------

5. LOCATION OF LEGAL DESCRIPTION

COURTHOUSE, REGISTRY OF DEEDS, ETC.:
Worcester County Registry of Deeds

STREET AND NUMBER:
2 Main Street

CITY OR TOWN:
Worcester

STATE: Mass.	CODE 25
-----------------	------------

6. REPRESENTATION IN EXISTING SURVEYS

TITLE OF SURVEY:
Massachusetts State-Wide Historic Preservation Plan

DATE OF SURVEY: 1970
 Federal State County Local

DEPOSITORY FOR SURVEY RECORDS:
Massachusetts Historical Commission

STREET AND NUMBER:
Office of the Secretary, State House

CITY OR TOWN:
Boston

STATE: Mass.	CODE 25
-----------------	------------

SEE INSTRUCTIONS

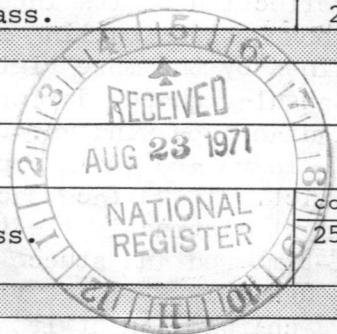

STATE: Mass.

COUNTY: Worcester

ENTRY NUMBER: 9/12.25.00

DATE: 12/16/71

FOR NPS USE ONLY

7. DESCRIPTION

CONDITION	(Check One)					
	<input checked="" type="checkbox"/> Excellent	<input type="checkbox"/> Good	<input type="checkbox"/> Fair	<input type="checkbox"/> Deteriorated	<input type="checkbox"/> Ruins	<input type="checkbox"/> Unexposed
	(Check One)			(Check One)		
	<input type="checkbox"/> Altered	<input checked="" type="checkbox"/> Unaltered		<input type="checkbox"/> Moved	<input checked="" type="checkbox"/> Original Site	

DESCRIBE THE PRESENT AND ORIGINAL (if known) PHYSICAL APPEARANCE

The Massachusetts Avenue Historic District runs in a north-south direction for one block between Salisbury Street, which crosses it on the north, and Drury Lane at the south end. A grassy mall thirty feet wide divides the Avenue. Tall shade trees form green arches over the street and the mall along whose edges they are planted. Lawns lead from the sidewalks to the green shubbery which surrounds all but one of the eleven residences in the district. These dwellings are evenly spaced along both sides of the street, and, with one exception, are set well back from it.

These impressive houses are examples typical of the fashionable trends and architectural styles of the seventeen-year period, from 1889-1906, during which they were built. The interest of the era in preservation is illustrated by the Trumbull Mansion which was built in 1751 as the Second Worcester County Court House. In 1899 this two story Colonial house with a hipped roof and end chimneys was moved to its present location and converted to residential use. This house is the focal point of the district because of its situation at the mid-point on the street and because it is the only example of the late Colonial period here. Its neat uncluttered lines, low rectangular mass, symmetrical five bay facade and two story height are elements which make it typical of this style.

In contrast to the simplicity and dignity of the Trumbull Mansion are its Colonial Revival neighbors. Eight of the eleven houses in the district are built in this style. Although all of these large and elaborately ornamented buildings possess some or most of the stylistic characteristics - the rectangular plan, two-and-one-half story height, hipped roofs with pedimented dormer windows (one has a gambrel roof) and symmetrical facades - each is individually designed to reflect the taste of the owner and architect. The heavy proportions, deep (and therefore prominent) roofs, the ells and piazzas placed asymmetrically for convenience, as well as the use of large windows and bays, are influences from the Shingle and Queen Anne styles. In one of these houses, the freedom of the Shingle style is expressed not only by the above characteristics, but also in the asymmetry of its main facade (a reflection of its interior plan) and in the use of shingles instead of clapboards as a building material. However, in this building this freedom is confined by the more rigid elements of the Colonial Revival style - the rectangular shape, dormered hipped roof, balustraded entrance porch, and Palladian-type windows.

There are two exceptions to the Colonial architectural tradition in the district. These face each other across the mall at the south end of the street. The most distinctive features of these houses are their large and decorative half-timbered and stucco gables which are elements typical of the Tudor style. Although this style is visually dominant, influences of the Queen Anne, Shingle and Richardsonian styles are also apparent in one or both of the buildings. #12 Massachusetts Ave. illustrates the Queen Anne and Shingle styles in the deep intersecting gambrelled roofs and the use of shingles as a prominent building material. The first story of #15 is low and faced with fieldstone which extends as a wall beyond the facade of the house. This creates a horizontality which is accented by the stone lintels covering the windows on this floor. The use of this material and the effect of horizontality when combined with a deep roof recalls some of the work of Richardson.

S E E I N S T R U C T I O N S

NATIONAL REGISTER OF HISTORIC PLACES
INVENTORY - NOMINATION FORM

(Continuation Sheet)

STATE	
Massachusetts	
COUNTY	
Worcester	
FOR NPS USE ONLY	
ENTRY NUMBER	DATE
11.12.25.0019	12/16/71

(Number all entries) Massachusetts Avenue Historic District

7. DESCRIPTION, cont.

All of the buildings are in excellent condition, and except for the Trumbull Mansion, retain their original appearances. The planting is typical of the period, and there have been no later intrusions.



8. SIGNIFICANCE

PERIOD (Check One or More as Appropriate)

- Pre-Columbian | 16th Century | 18th Century | 20th Century
 15th Century | 17th Century | 19th Century

SPECIFIC DATE(S) (If Applicable and Known) 1889-1906 (1751)

AREAS OF SIGNIFICANCE (Check One or More as Appropriate)

- | | | | |
|--|---|--|--|
| <input type="checkbox"/> Aboriginal | <input type="checkbox"/> Education | <input type="checkbox"/> Political | <input checked="" type="checkbox"/> Urban Planning |
| <input type="checkbox"/> Prehistoric | <input type="checkbox"/> Engineering | <input type="checkbox"/> Religion/Philosophy | <input type="checkbox"/> Other (Specify) _____ |
| <input type="checkbox"/> Historic | <input type="checkbox"/> Industry | <input type="checkbox"/> Science | _____ |
| <input type="checkbox"/> Agriculture | <input type="checkbox"/> Invention | <input type="checkbox"/> Sculpture | _____ |
| <input checked="" type="checkbox"/> Architecture | <input type="checkbox"/> Landscape Architecture | <input type="checkbox"/> Social/Humanitarian | _____ |
| <input type="checkbox"/> Art | <input type="checkbox"/> Literature | <input type="checkbox"/> Theater | _____ |
| <input type="checkbox"/> Commerce | <input type="checkbox"/> Military | <input type="checkbox"/> Transportation | _____ |
| <input type="checkbox"/> Communications | <input type="checkbox"/> Music | | |
| <input type="checkbox"/> Conservation | | | |

STATEMENT OF SIGNIFICANCE

The Massachusetts Avenue Historic District is a significant illustration of the single-family residential designs chosen by industrialists and professional men throughout New England at the turn of the last century. The eleven houses in this small area also provide the best examples of the "high style" of Worcester's architectural taste in that period. Their first owners were among Worcester's leading citizens, lawyers, physicians, bankers and the City's mayor.

The land on which the Massachusetts Avenue District is located was originally the property of Stephen Salisbury. Though Salisbury played a major role in the development of Worcester, Massachusetts Avenue is his only attempt at street planning on this large scale. The property was not sold to speculators; the relatively high prices paid for the lots indicate that both Salisbury and his purchasers were aware that they were creating a special residential area. Building restrictions accompanied the deed for each lot, including an unusual one that a house must be built on the land within one year. The design which resulted from Salisbury's division of the tract is a step beyond the grid pattern usual for the turn of the century; in particular, the park-like mall at the center of Massachusetts Avenue gives the block-long area the character of a "square" rather than that of a linear streetscape.

The buildings in the Massachusetts Avenue Historic District display an unusual degree of architectural coherence. With the exception of the Trumbull Mansion at No. 6, the houses were built in the short period from 1889 to 1906 and are basically Colonial Revival with elements of Queen Anne, Jacobean and Shingle style. The Trumbull Mansion is a late Colonial structure, built in 1751 to serve as the Second Worcester County Court House and moved to its present location in 1899. Its presence on Massachusetts Avenue is evidence of the current (1900) interest in restoring old buildings. Its architectural contrast provides a focal point for the district.

The coherence of the district is reinforced by basic similarities in all the buildings. Parallels in construction materials, building size and height, spacing between buildings, distance from the street and planting combine with the unifying effect of the central greenscape to create an atmosphere of harmony and order for the Massachusetts Avenue District.

SEE INSTRUCTIONS

9. MAJOR BIBLIOGRAPHICAL REFERENCES

Crane, Ellery C., ed., Historic Homes and Institutions and Genealogical and Personal Memoirs of Worcester County. 4 v., N.Y., The Lewis Publishing Co. 1907.

Nutt, Charles, History of Worcester and its People, 4 v., N.Y. Lewis Historical Publishing Co., 1919.

Washburn, Charles G., Manufacturing and Mechanical Industries of Worcester. Philadelphia: J.W. Lewis & Co., 1889.

Registry of Deeds, Title search by L. P. O'Connell.

10. GEOGRAPHICAL DATA

LATITUDE AND LONGITUDE COORDINATES DEFINING A RECTANGLE LOCATING THE PROPERTY			O R	LATITUDE AND LONGITUDE COORDINATES DEFINING THE CENTER POINT OF A PROPERTY OF LESS THAN TEN ACRES		
CORNER	LATITUDE	LONGITUDE		LATITUDE	LONGITUDE	
	Degrees Minutes Seconds	Degrees Minutes Seconds		Degrees Minutes Seconds	Degrees Minutes Seconds	
NW	42° 16' 47"	71° 48' 43"		0	0	
NE	42° 16' 43"	71° 48' 39"				
SE	42° 16' 37½"	71° 48' 46"				
SW	42° 16' 40"	71° 48' 50"				

APPROXIMATE ACREAGE OF NOMINATED PROPERTY: 5

LIST ALL STATES AND COUNTIES FOR PROPERTIES OVERLAPPING STATE OR COUNTY BOUNDARIES

STATE:	CODE	COUNTY:	CODE

11. FORM PREPARED BY

NAME AND TITLE:
Anne R. Wardwell, Survey Director

ORGANIZATION: Massachusetts Historical Commission

DATE: June 1971

STREET AND NUMBER:
Office of the Secretary, State House

CITY OR TOWN: Boston

STATE: Mass.

CODE: 25

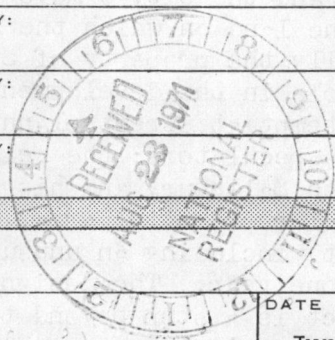

SEE INSTRUCTIONS

UTM REF 9-23-75 W.N. 19/268110/4654260

12. STATE LIAISON OFFICER CERTIFICATION

As the designated State Liaison Officer for the National Historic Preservation Act of 1966 (Public Law 89-665), I hereby nominate this property for inclusion in the National Register and certify that it has been evaluated according to the criteria and procedures set forth by the National Park Service. The recommended level of significance of this nomination is:

National State Local

Name: John F. Kennedy
Secretary of the Commonwealth,
Chairman, Massachusetts Historical
Title: Commission

Date: July 27, 1971

NATIONAL REGISTER VERIFICATION

I hereby certify that this property is included in the National Register.

Ernest A. Connally
Chief, Office of Archeology and Historic Preservation

DEC 16 1971

Date: _____

ATTEST:
William M. Muntz
Keeper of The National Register

Date: DEC 16 1971

Massachusetts Avenue Historic District

Mass.
Mass.
Worcester Co.

RECEIPT

PROPERTY

71006356

STATE

REGISTER NUMBER

71,12,25,0019

DATE OF RECEIPT

8/23/71 YES

NO

NUMBER

DATA PAGE

✓

PHOTO (S)

✓

2

PHOTO DESCRIP (S)

✓

MAP (S)

✓

MAP DESCRIPTION (S)

✓

LOGGED

✓

ACKNOWLEDGE

8/24/71

RESUBMIT

REVIEW

Gj Tech. 9/30/71

geographic data listed in wrong space acreage less than 10, but 4 co. ordinates given. Let's ask for winter photos + perhaps better coverage of the one 1751 house moved here in 1899. agree w/Mary.

OK Means 10/14/71

5 Marcusin 10/19/71

HISTORIAN

HISTORIAN

ARCHITECT

I'd also like better photographic coverage, but see no need for focus on 1751 structure, since it is the district, not the 1751 bldg., nominated.

OK Chambers 10-21-71

OK Muller 12-9-71

ASST. KEEPER

KEEPER

I have been shown this district & find it viable as such

OK Wynn 12/10/71

ENTRY

CHIEF, OAHF

ENC 12-14

EDITORIAL PROCESSING, EDITOR

Will go along with above comments. Seems passable.

CD 11/4/71

Date

Federal Register Entry

2-72

Annual Edition Entry

Logged Card

12/16/71
12/16/71

WORKING NUMBER

COMMENTS:

SPECIAL

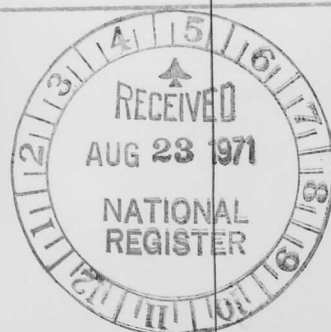

cong. dist. #4 Harold Donohue

**NATIONAL REGISTER OF HISTORIC PLACES
PROPERTY MAP FORM**

(Type all entries - attach to or enclose with map)

STATE Mass.	
COUNTY Worcester	
FOR NPS USE ONLY	
ENTRY NUMBER 71.12.25.0019	DATE 12/18/71

SEE INSTRUCTIONS

1. NAME			
COMMON: Massachusetts Avenue Historic District			
AND/OR HISTORIC:			
2. LOCATION			
STREET AND NUMBER: between Salisbury Street & Drury Lane			
CITY OR TOWN: Worcester			
STATE: Massachusetts	CODE 25	COUNTY: Worcester	CODE 27
3. MAP REFERENCE			
SOURCE: U.S.G.S. Worcester North, Mass.			
SCALE: 1:24,000			
DATE: 1960			
4. REQUIREMENTS			
TO BE INCLUDED ON ALL MAPS			
1. Property boundaries where required.			
2. North arrow.			
3. Latitude and longitude reference.			

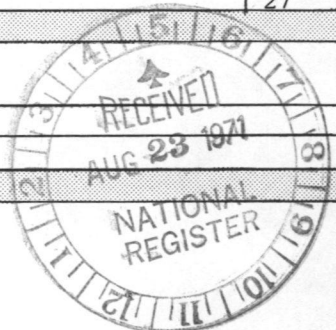



Addendum #2

WORCESTER, MASS.

MASSACHUSETTS AVENUE HISTORIC DISTRICT

Atlas of the City of Worcester, Mass.
Richards Map Company
Springfield, 1922

NATIONAL REGISTER OF HISTORIC PLACES
PROPERTY MAP FORM

(Type all entries - attach to or enclose with map)

STATE Mass.	
COUNTY Worcester	
FOR NPS USE ONLY	
ENTRY NUMBER 71.12.25.0019	DATE 12/16/71

SEE INSTRUCTIONS

1. NAME

COMMON: Massachusetts Avenue Historic District
AND/OR HISTORIC:

2. LOCATION

STREET AND NUMBER:

between Salisbury Street and Drury Lane

CITY OR TOWN:

Worcester

STATE:	CODE	COUNTY:	CODE
Mass.	25	Worcester	27

3. MAP REFERENCE

SOURCE:

Atlas of the City of Worcester, Mass.

SCALE: 1 inch = 200 feet

DATE: 1922

4. REQUIREMENTS

- TO BE INCLUDED ON ALL MAPS
1. Property boundaries where required.
 2. North arrow.
 3. Latitude and longitude reference.

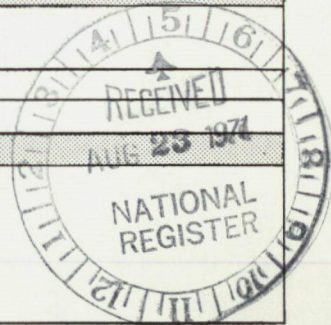

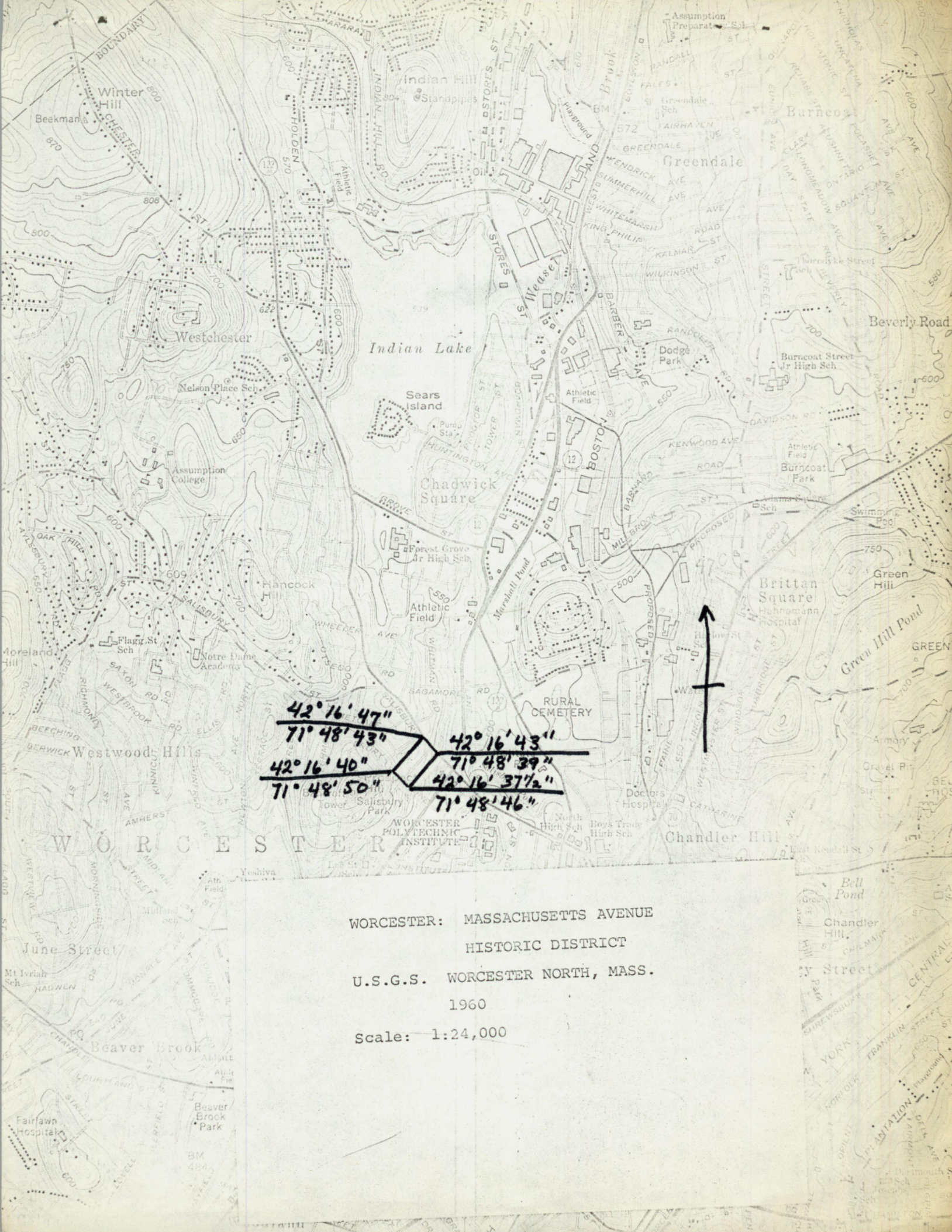

WORCESTER: MASSACHUSETTS AVENUE
 HISTORIC DISTRICT
 U.S.G.S. WORCESTER NORTH, MASS.
 1960
 Scale: 1:24,000



November 9, 1971

Dr. William J. Murtagh
Keeper of the National Register
National Parks Service
801 19th Street, N. W.
Washington, D. C. 20006

Dear Dr. Murtagh:

A year ago when you came to speak to our Society, you advised us to submit Massachusetts Avenue for consideration as an Historic District. We did so, submitting the information initially to the Massachusetts Historical Commission. They have informed us that our application was forwarded to your office in August.

Our reason for writing to you now is that we would like to know, if possible, when we might expect to hear if our application has been accepted--or rejected. This being our first venture, we are perhaps, unduly anxious but we would appreciate any help you can give us in this matter.

Very truly yours,

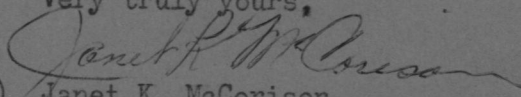
(Mrs. M.A.) Janet K. McCorison
Executive Director

HP- MASS- MASS. Avenue
Historic District

NTR 12/16/71 LHI

FORM A - AREA SURVEY

MASSACHUSETTS HISTORICAL COMMISSION
Office of the Secretary, State House, Boston

Form numbers in this area	Area no.
88-A-1	88-A

2. Photo (3x3" or 3x5")
Staple to left side of form
Photo number _____

1. Town Worcester

Name of area (if any) Massachusetts Avenue
Historic District

3. General date or period ca. 1889-1906

4. Is area uniform (explain):
in style? no (mixed late Victorian)
in condition? yes (excellent)
in type of ownership? no & institutional (private - individual)
in use? no (residential & institutional)

5. Map. Use space below to draw a general map of the area involved. Indicate any historic properties for which individual reports are completed on Forms B thru F, using corresponding numbers. Show street names (including route numbers, if any) and indicate north. Indicate with an "x" existing houses not inventoried on Form B.

AREA IS LISTED ON THE NATIONAL REGISTER OF HISTORIC PLACES, SEE ATTACHED INVENTORY - NOMINATION FORM.

Listed 12/16/71

DO NOT WRITE IN THIS SPACE
USGS Quadrant _____
MHC Photo no. _____

6. Recorded by see attached form

Organization see attached form

Date information prepared June 1971

UTM:

A 19/267960/4684230
B 19/268260/4684380
C 19/268040/4684260
D 19/268040/4684090

(over)

7. Historical data. Explain the historical/architectural importance of this area.

The Massachusetts Avenue Historic District is both listed on the National Register of Historic Places and a locally legislated historic district; for further information see attached form or "Report of the Historic District Study Committee" (City of Worcester, 1974).

8. Bibliography and/or references such as local histories, deeds, assessor's records, early maps, etc.



WORCESTER - MASSACHUSETTS AVENUE
VIEW FROM NORTH

HOUSES - FROM RIGHT: #4, #6, #8

NPS Number 71.12.25.0019
Title: Massachusetts Avenue
Historic District
Loc. Worcester Co, Mass.
Mass Avenue



PROPERTY OF THE NATIONAL REGISTER

PHOTOGRAPH: JACK PERRY MAY 1971

WORCESTER HERITAGE SOCIETY



WORCESTER MASSACHUSETTS

MASSACHUSETTS AVENUE FROM SOUTH @ DRURY

LANE SHOWING HOUSES ON EAST SIDE

#S 15, 11, 7, & 5

NPS Number 71.12.25.0019

Title: Massachusetts

Avenue Historic Dist

Loc. Worcester Co, Mass.

View from South



PROPERTY OF THE NATIONAL REGISTER

PHOTO CREDIT: JACK PERRY - MAY 1971

PHOTO ON FILE: WORCESTER HERITAGE SOCIETY

MASSACHUSETTS



30 AUG 1979

88-A

Massachusetts Ave. H.P.

#5, 7, 11 + 15

Massachusetts Ave.

west + south elevations

Worcester MRA, Ma

MAR 5 1980