

**United States Department of the Interior
National Park Service**

**National Register of Historic Places
Inventory—Nomination Form**

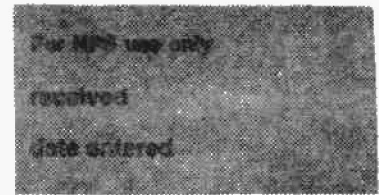

Continuation sheet Central Spfld. H.D. B.E. Item number 4

Page 1

Owners of Property in the Central Springfield Historic District Boundary Extension

1. Marine Bank of Springfield, Trust #53-0064-0
East Old State Capitol Plaza
Springfield, IL 62701

Properties: Leland Hotel, 529 E. Capitol
321 S. Sixth Street (Eagle Financing)

2. The State Journal-Register
1 Copley Plaza
P.O. Box 219
Springfield, IL

Property: The State Journal Building
315 S. Sixth Street

3. Philip and Ilda E. McFadden
P.O. Box 5027
Springfield, IL

Property: 524 E. Monroe (Ferguson Building, corner of Monroe and S. Sixth)

4. First Presbyterian Church
S. Seventh and E. Capitol
Springfield, IL 62701

Properties: 316-318 S. Sixth Street
320-322 S. Sixth Street
324 S. Sixth Street

**United States Department of the Interior
National Park Service**

**National Register of Historic Places
Inventory—Nomination Form**

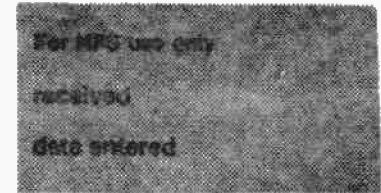

Continuation sheet Central Spfld. H.D. B.E. Item number 6

Page 1

Representation in Surveys

Title: Illinois Historic Structures Survey

Date: October 1974 X state

Depository: Illinois Historic Preservation Agency, 210-214 S. Sixth Street

City: Springfield

State: Illinois

Structures in Boundary Extension

321 S. Sixth Street

324 S. Sixth Street

Leland Hotel, Northwest corner of Sixth and Capitol

**United States Department of the Interior
National Park Service**

**National Register of Historic Places
Inventory—Nomination Form**

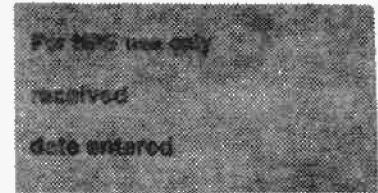

Continuation sheet Central Spfld. H.D. B.E. Item number 7

Page 1

Central Springfield Historic District Boundary Extension

Description

The extension comprises seven commercial buildings on S. Sixth Street between Capitol and Monroe. The masonry buildings in the extension constitute all the structures in the 300 block, except one at the northeast corner of S. Sixth Street and Capitol which was irreversibly remodelled on the exterior after 1936. Buildings on both sides of the block are included, and they are the Leland Hotel (1911) 321 S. Sixth, the Illinois State Journal Building (1929), Ferguson Building (1906) on the west, and 316-318 S. Sixth, 320-322 S. Sixth, and 324 S. Sixth on the east. The present historic district is geographically linked to the extension at its southern boundary on Monroe and the south lot line of the U.S. Post Office Building on Monroe.

Visually and historically the 300 block of S. Sixth Street is and was an integral part of Springfield's commercial district. Its physical characteristics in terms of scale, materials, and building heights are similar to other streetscapes within the historic district. Masonry buildings of varying heights from two to nine stories face directly onto the sidewalk. All but the Leland Hotel had a first floor storefront with commercial or residential space above. As is generally true of urban commercial buildings, the Sixth Street buildings have street facades of finished or patterned masonry with an ordered or symmetrical fenestration. Side and rear facades are of common brick with no windows or a functional fenestration pattern. The street structures on the east side of the street abut each other. Only a small service lane behind the post office breaks the solid line of buildings on the street. On the west, the line of buildings is broken by two openings. Until 1969 a portion of the earlier Ferguson Building stood to the south of the present Ferguson building. Now there is a small parking lot. To the south of State Journal Building is a small service lane. The original Leland Hotel had occupied this space until 1908, however, when its more compact and taller replacement was built, the lots to the north were left vacant. 326-330 S. Sixth was constructed shortly therefore, leaving the small lane to the north. In terms of the density and number of buildings on the street, the integrity of the streetscape is very good. All but one building has been retained since the period of significance before 1936.

Building Integrity

In general the integrity of the extension buildings is good. Although almost all of the street level storefronts have been altered, the upper floors have remained intact. The Ferguson Building is the one exception to this general rule in that its upper eight stories have also been significantly

**United States Department of the Interior
National Park Service**

**National Register of Historic Places
Inventory—Nomination Form**

For NPS use only
received <i>10/6/86</i>
date entered

Continuation sheet Central Spfld. H.D. B.E. Item number 7

Page 2

altered. Metal piers and grillwork sheath the upper street facades; however, their removal would reveal the intact original facade beneath. Only the prominent roof cornice was completely removed in 1948. The Leland Hotel has also undergone some inappropriate exterior remodeling. In the 1970s the original double hung windows were replaced by single pane windows, and the arched street level windows were covered with decorative wooden panels. Also, the small structure above the entrance portico was refaced with metal siding. Nevertheless, the Leland Hotel and all the buildings in the extension, with the Ferguson Building being an exception, have sufficient integrity of location, setting, materials, feeling, and association to be considered contributing buildings in the historic district.

Contributing and Non-contributing Buildings

Those buildings listed below as contributing to the Central Springfield Historic District meet a number of criteria. They were built during the period of significance, i.e. 1822-1936. They also retain sufficient exterior integrity from the period of significance to provide a positive contribution to the district. The one building listed as non-contributing presently lacks sufficient exterior design integrity from the period of significance. This designation would be reversed if the exterior sheathing was removed.

List of Buildings

1. Leland Hotel

Northwest corner of S. Sixth and Capitol

Original Owner: Springfield Hotel Company

Architect: Holabird & Roche

Chicago, IL

Date: 1911

Contributing Building

The Leland Hotel is an eight-story, U-shaped brick building with its main facades on the east and south on S. Sixth and Capitol. Stylistically, these facades exhibit a variety of classical motifs and details which recall earlier American classical design. The facade design of the multi-storied building is horizontally divided into three sections: a pronounced first floor with tall arched windows and the second story windows above; five stories of regular,

**United States Department of the Interior
National Park Service**

**National Register of Historic Places
Inventory—Nomination Form**

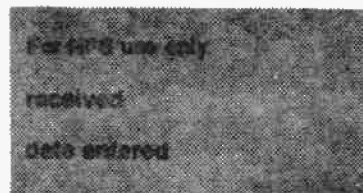

Continuation sheet Central Spfld H.D. B.E. Item number 7

Page 3

nearly-square fenestration; and the eighth story with a decorative stringcourse, metal cornice and flat parapet concealing the ninth floor above. Each section is separated by a stone stringcourse. Classical motifs and details include the paired column entrance portico, shallow recessed arched windows on the first floor, stone keystones on all windows, and the Flemish bond exterior masonry walls with glazed headers.

The fenestration pattern of the east and south facades is very simple. The south facade has a centered portico entrance with three flanking arched windows on either side. The east facade has a smaller entrance asymmetrically placed at the fourth bay of an eight bay first floor. The entrance opening is similar to the other seven arched window openings. Floors two through eight are identical, except for the small portico structure at the second floor, level which encloses the three central bays. The ninth floor is at the roof parapet level. Each story has a single window at either end with paired windows between. The south facade has five paired windows and the east facade six.

The interior of the building was radically remodelled in the 1970s. Very little of the original interiors can be seen on the lobby level. It is not known whether the interior details have been destroyed or only covered up by drop ceilings and partitions.

2. 321 S. Sixth Street

Owner and architect unknown

Date: ca. 1915

Contributing building

This structure is a two-story, rectangular masonry building with a street facade of pressed red brick and cream-colored terra-cotta on the upper story and a glass, wood and marble-based storefront below. The flat roofline is finished with a projecting terracotta cornice and garlanded parapets above. A terra cotta shield adorns the center of the roofline with coping to either side. The overall stylistic theme is classical, typical of 1910s and 20s small commercial building design. Garlanded terracotta surrounds on the symmetrical second story fenestration and the heavy roofline ornament above are indicative of this classical styling. An interesting art nouveau-like arched metal canopy covers the recessed double entrance. A separate entrance at the south end of the facade provides access to the second floor.

The building's exterior is unaltered.

**United States Department of the Interior
National Park Service**

**National Register of Historic Places
Inventory—Nomination Form**

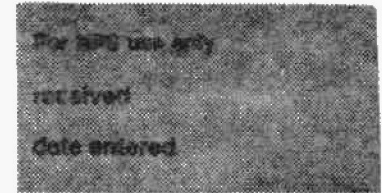

Continuation sheet Central Spfld. H.D. B.E. Item number 7

Page 4

3. Illinois State Journal Building

Original Owner: Colonel Ira C. Copley

Architect: Helmle & Helmle

Springfield, IL

Date: 1929

Contributing Building

The Illinois State Journal Building is a three-story masonry building with a white terra cotta front facade. The Art Deco front facade is characterized by vertical piers separated by multi-paned casement windows. Two slightly projecting bays, one at the south end of the building, and one near the building's center mark the two main entrances to the building. The entrances have arched transoms above with a metal grillwork design. During the 1970s the original glass storefronts were removed. A stuccoed wall now covers the first floor of the building. Only the arched door entrances remain exposed. The rear of the building is finished in common brick and is very utilitarian in appearance. However, the successful operation of a newspaper depended upon this functional, efficient building design.

The interior lobby of the building is decorated with Art Deco plasterwork designs on the ceiling, wall frieze, and door archways. These areas have designs based on floral and geometric patterns painted in metallic colors - golds, browns, and greens. The coffered ceiling is especially beautiful with alternating star and rosette designs. The lobby is also finished with green and black marble and textured plaster walls.

4. Ferguson Building

301-303 S. Sixth Street (522 E. Monroe)

Original Owner: B.H. Ferguson

Architect: Samuel J. Hanes

Date: 1906

Non-contributing Building

The Ferguson Building is an eight-story, rectangular masonry building which has a gray metal pier and grillwork sheathing on the north and east

**United States Department of the Interior
National Park Service**

**National Register of Historic Places
Inventory—Nomination Form**

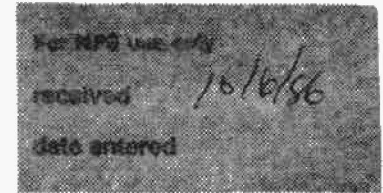

Continuation sheet Central Spfld. H.D. B.E.-Item number 7

Page 5

street facades above the first story. The original south facade is exposed. The original design of the street facades can be seen through the metal grillwork. This flat-roofed commercial building has a c.1958 remodelled ground story. Although the original support columns appear to be intact the entire storefront was rebuilt out of handmade copper fused brick from Holland, Kentucky bluestone and green sheets of Zourite. None of the original storefront walls remain. However, some features of the original ground floor interior are still present, namely the two-story support columns with Composite capitals.

5. 316-318 S. Sixth Street

Original Owner: Possibly Joseph D. Myers and Walter Van Duyn

Architect: Unknown

Date: ca. 1885, rebuilt front facade ca. 1910

Contributing Building

This building is a two-story rectangular masonry building with a flat roof and glass first story storefront. It is apparent that the simple classical front facade of cream colored pressed brick dates from the early 20th century, while the rear of the building is the original 1880s design. Brick piers and corbelling on the side facade contrast sharply with the symmetrical triple paired window design of the front. A heavy metal cornice below the brick parapet roof terminates the top. The black glass storefront frame and windows are a later remodelling, c. 1940s.

6. 320-322 S. Sixth Street

Original Owner/Architect: Unknown

Date: ca. 1910, although the storefront may be earlier

Contributing Building

This is a two story rectangular masonry building with only the front and rear facades exposed. The front facade is composed of a glass and wood storefront and a brown tapestry brick second story. At present two storefronts open into the building. Each appear to have been remodelled to some degree, however, the remodelling probably dates from the 1940s and 50s. Three large arched doublehung sash windows light the second floor interior and a metal modillioned cornice is below the low parapet wall.

**United States Department of the Interior
National Park Service**

**National Register of Historic Places
Inventory—Nomination Form**

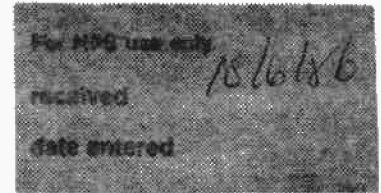

Continuation sheet Central Spfld. H.D. B.E. Item number 7

Page 6

7. 324 S. Sixth Street

Original Owner/Architect: Unknown

Date: ca. 1895

Contributing building

This two-story masonry building has a high parapet front roofline and a c.1940s remodelled storefront. The wall of the upper floor is composed of a variety of pressed and geometric patterned dark red brick and three tall round-arched windows. The windows are linked by light-colored stone blocks at the base and the spring of the arch. Intricate metal cornices at the top of the parapet wall and piers at the storefront ends have survived intact.

This nomination contains six contributing buildings and one non-contributing building.

**United States Department of the Interior
National Park Service**

**National Register of Historic Places
Inventory—Nomination Form**

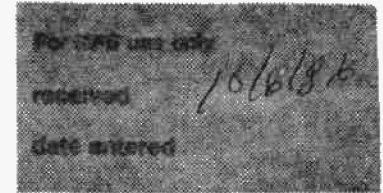

Continuation sheet Central Spfld. H.D. B.E. Item number 8

Page 7

Justification of Boundary Extension for the Central Springfield Historic District:

The buildings in the extension include the best preserved buildings with historical significance in downtown Springfield that are not within its National Register district. All contributed significantly to the county seat's surrounding business zone. One (Leland Hotel) also contributed significantly to the county seat's unique role as the state capital. Three buildings, the Leland Hotel, the State Journal Building, and the Ferguson Building were architecturally important at the local level. The buildings were designed by prominent, well-respected firms from both Springfield and Chicago.

Information sufficient to justify this boundary extension for the National Register has accumulated since the original designation of the Central Springfield Historic District.

This extension delineates the last place of the business zone's expansion on the southeastern corner. When commercial buildings in this extension were constructed none were built beyond it. Thereafter, commercial growth was along the automobile-convenient Strips on the city's hithermost periphery. And, this extension represents a later phase of growth than the 200 block of Sixth Street which is within the district; this corridor to the north of the extension is part of the county seat's pre-1900 core. All of the buildings within the extension, however, complement the architectural features of the existing district. First, the extension includes mostly building forms which are long, narrow, rectangular boxes and mostly two-story. Second, while facades are decorated elements of style current at their construction date, the facades are essentially plain and intended for the utilitarian purpose of providing light on the second floor and displaying wares on the first floor. Apartment residences on some second floors seem not to have required features common to residential styles of their era. In addition, the considerable height of two of the buildings (the Ferguson Building and the Leland Hotel) complete the collection of tall structures which helped symbolize the downtown with those already in the district.

United States Department of the Interior
National Park Service
National Register of Historic Places
Inventory—Nomination Form

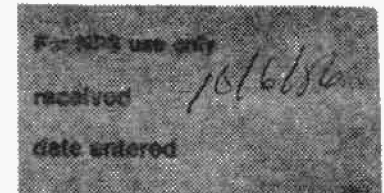

Continuation sheet Central Spfld. H.D. B.E.-Item number 8

Page 8

Central Springfield Historic District Boundary Extension

1. Leland Hotel

NW corner of Sixth and Capitol

SIGNIFICANCE:

The single most important building in the boundary extension, the Leland Hotel, was a primary focal point for lodging, conventions, politics, and revelry in downtown Springfield before its subsidence into less intensive use recently as a college campus and office space. The corner and this building have always mobilized the attention of Springfieldians who have wanted to sustain its commercial contribution to the city and managers have assumed responsibility to introducing their city to outsiders by the information and image projected at the Leland.

HISTORY

The Leland Hotel's predecessor was a four-story hotel on the same corner that was built in 1867. The predecessor was named shortly after construction for Horace S. Leland a local businessman who bought a controlling interest with his brother-in-law. When a fire in 1908 destroyed the building, a consortium of Springfield businessmen led by George Pasfield rallied to build an even larger hotel. The Springfield Hotel Company spent \$500,000 to build the new Leland Hotel as a result. In the hey-day of railroad transportation through the 1940s, the Leland grew to one of the capitol's major hotels, one of the "Big Three," competing with the Abraham Lincoln (one block west; razed) and The St. Nicholas (three blocks northwest). The Leland's success was due partly to the management (1911-1934) of Edward O. Perry who was attracted downstate to continue his career as hotel manager after a good start in Chicago. Perry himself practiced and instructed the entire staff in working to convey a favorable "first impression" of Springfield through courtesies and efficiency at the Leland. The Leland became a subsidiary of the Nicollet Hotel Company of Minneapolis in 1948 and was remodeled for post-war expectations.

The Leland also developed as the unofficial downstate headquarters of the Republican Party. (The St. Nick gained the same reputation for the Democrats.) However, its single most prominent political association was as the presidential campaign headquarters in 1952 for the Democratic candidate, Illinois Governor Adlai E. Stevenson II. Just outside the Leland, before

**United States Department of the Interior
National Park Service**

**National Register of Historic Places
Inventory—Nomination Form**

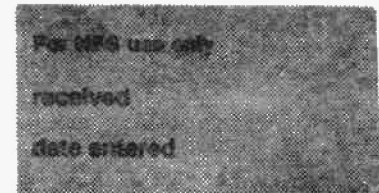

Continuation sheet Central Spfld. H.D. B.E. Item number 8

Page 9

delivering a less memorable concession speech, the defeated Stevenson was quoted as having said "he felt like a little boy who had stubbed his toe in the dark." He said, "he was too old to cry, but it hurt too much to laugh." In 1956, the Leland achieved notoriety as the scene for the "tape scandal." In the rooms of the Leland, the Better Government Association secretly recorded informal discussions between legislators and lobbyists in an effort to detect illegal negotiations.

Although the management never believed the hotel overcame the negative public impression derived from the episode of 1956, the larger centripetal forces away from downtown Springfield really caused the hotel's demise in the 1950s. Primarily the legislators who once roomed and conducted informal business at the Leland and the other "Big Three" were able to afford private apartments about town or preferred the motels on the edge of the capitol. Successive remodelings and new services, such as the "Red Lion Tavern" (begun 1956) with "Anglo-Saxon" motif but an "ultramodern open hearth" failed to attract sufficient business. By 1969, the American State's Investment Corporation, headed by Springfield businessman, R.M. Johnston, scurried to purchase the hotel rather than permit its purchase by less locally concerned interests outside the capitol. The Leland closed in 1970 and its fate seemed uncertain until it was reclaimed by for several business offices, including the Illinois Commerce Commission which occupied the upper three floors (starting 1971) and Sangamon State University for a downtown campus (starting 1972).

The Leland Hotel was designed by the important Chicago firm of Holabird & Roche in 1911. The partnership had been in practice since 1883 and undoubtedly their reputation for designing stylistically handsome and functional buildings landed them the Leland Hotel commission. Holabird and Roche designed a very straight-forward hotel design, incorporating simple classical motifs and a functional spatial design. The high quality of the materials on the exterior is evidenced by the excellent integrity of the masonry, both brick and stone, and the intricate metal cornice and parapet roof. The U shape of the building allowed for light to enter nearly all the hotel rooms. The elevators occupied the base of the U where the light could least penetrate.

Although the Hotel has undergone some exterior remodelling, the restrained, simple classical detailing in the Flemish bond brickwork and uniform fenestration is still quite evident. Holabird and Roche were responsible for hundreds of buildings and their reputation as consistent designers has brought both praise and criticism from critics. However, the Leland Hotel is the only known Springfield design by the long-lived partnership, and it is an important representative of their work outside of Chicago.

**United States Department of the Interior
National Park Service
National Register of Historic Places
Inventory—Nomination Form**

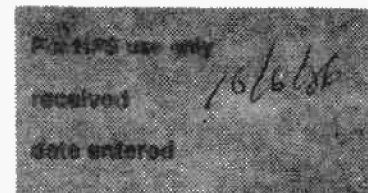

Continuation sheet Central Spfld. H.D. B.E. Item number 8

Page 10

2. 321 S. Sixth

Significance:

This building is principally significant within the boundary extension as the structure most unaltered since its construction. Its occupants have been a succession of small businesses typical of most of those in the boundary extension, and apartment dwellers, in the period before the 1950s when downtown was a respectable residential location. The aggregate helped convey the impression of "downtown" as a vital residential and commercial mix.

History:

Built c.1915, this building housed a pool hall on the first floor by 1917. The second floor was a series of rooms for residents. By 1935, at the fifty-year limit for the National Register, the Leland Hotel's business next door had prospered sufficiently to require partial occupancy of this building as the Leland Hotel Annex.

3. The Illinois State Journal Building

Significance:

The building is significant for its early association with one of Springfield's two leading newspapers, The Illinois State Journal.

History: The Journal.

The Journal began in 1826 as The State Journal and became, after Springfield's designation as the capital (1839), its Whig and later Republican party organ. Rivalry with the city's Democratic Illinois State Register dated from the start of Springfield as capital but was marked by a special theme during the period (1929-1942) when the Journal occupied the building which is the subject of this nomination.

History:

In the years 1929-1942, Colonel Ira C. Copley published the Journal in competition with the Illinois State Register. Copley began as a utilities company owner who by 1900 controlled numerous gas, electricity, and streetcar companies in the area just outside Chicago. He purchased newspapers in the principal cities served by his companies, Aurora, Elgin, and Joliet, in order to advocate private ownership of utilities, a lively issue of the time with

**United States Department of the Interior
National Park Service**

**National Register of Historic Places
Inventory—Nomination Form**

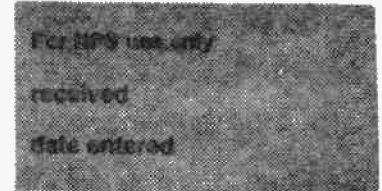

Continuation sheet Central Spfld. H.D. B.E. Item number 8

Page 11

equally ardent advocates for publicly owned utilities. It was one of his most important issues as a U.S. Congressman, 1910-1922. Springfield businessmen arranged conditions favorable to Copley in order to retain the Journal at the present location when he bought it in 1928 and planned an expanded operation on a new site. (The Journal had been located on this downtown side for nearly 50 years.) Copley agreed to retain his new business acquisition at the traditional site but commissioned rapid design and construction of a new building to dramatize the paper's new image as well as provide ample space for its accelerated production. Copley retained Springfield's principal architectural firm, Helmle and Helmle, and completed construction in nine months in 1929. Thereafter, Copley's Journal enjoined a spirited debate with the Illinois State Register about the utilities question. Copley continued advocacy of private ownership while, Vincent Y. Dallman spoke for public ownership, as Register editor. Dallman extended attacks on Copley throughout Illinois and southern California where Copley's holdings were branded as a corrupt "powertrust." Accusations stopped only after they emerged in the U.S. Congress and the Register was leased to Copley in 1942. He had won the capital's newspaper competition by serving readership in the greater Springfield area with more frequent publication which attracted 5,000 more readers to the Journal than the Register by 1939.

The present name of the Springfield Journal-Register has existed since 1974. The ordering of the two parts of the hyphenated newspaper name reflects the Journal's ultimate victory in the competition.

The Illinois State Journal Building was the first newspaper building commission by the prolific Springfield firm, Helmle & Helmle. The building is indicative of the 1920s Art Deco design in the stylized "Gothic" terra cotta upper facade and the interior decorative plasterwork. The modern, yet traditional appearance, fits the image of a modern, fast-paced publishing enterprise located on the site of a fifty-year old newspaper. Although the front facade has been marred by the storefront remodeling, the lobby plasterwork designs are intact. They may well be unique in Springfield. St. Louis sculptors were responsible for the clay models for the plasterwork, according to an article written by Henry Helmle and published in the Journal on June 18, 1930.

The workmanship of the plasterwork is of high quality and its intricacy and plasticity is without match in Springfield. The lobby of the Journal Building is a significant 1920s public space, and it should be preserved.

4. Ferguson Building

SW corner of Monroe and Sixth, 301-303 Sixth Street

**United States Department of the Interior
National Park Service**

**National Register of Historic Places
Inventory—Nomination Form**

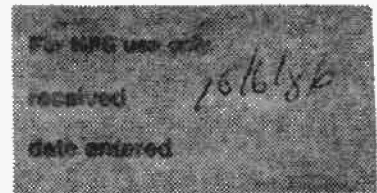

Continuation sheet Central Spfld. H.D. B.E Item number 8

Page 12

SIGNIFICANCE:

The building is significant for its design by one of Springfield's early architects, Samuel J. Hanes. The building also has been the location of offices and shops which have survived the general lag in commercial activity in the capital downtown; hence it is an unmistakable business node helping the downtown commercial core.

HISTORY

The Ferguson Building was designed by Springfield architect, Samuel J. Hanes in 1906. Hanes had received his construction and design training as an apprentice to a building contractor. In 1885 he went into business as a contractor with Nelson Ohlson, and in 1894 he began his own architectural firm. Hanes practiced alone until his son, Murray, formally joined the firm in 1914, and S.J. Hanes & Son, Architects continued to receive commercial and institutional commissions until 1924, when the elder partner retired.

Samuel Hanes was responsible for a number of Springfield's turn-of-the-century commercial buildings, including the Ferguson Building of 1906-07. The eight-story building was an early "skyscraper" in Springfield, and its exterior design clearly expresses the height of the building. Although the building is presently sheathed in a modern metal cover, the original design is intact beneath. Removal of the metal would uncover a building reminiscent of Louis Sullivan's tall building designs of the 1890s. Prominent eight-story piers divide the very simple paired-window fenestration. They, and light-colored stone elliptical arches above, give a strong vertical emphasis to the masonry building design. The first leads the eye to the top of the building, and the latter carries the eye the building's length. Small square attic windows below the original projecting cornice are clearly taken from Sullivan designs. The success of the design is linked to its simplicity and clarity in expressing the tall building form.

5. 316-318 S. Sixth

Significance:

This building is significant as an early downtown structure which has survived by facade alterations. A view from the north side reveals two district periods in the capital's development symptomatic of the way by which its downtown has persisted as a commercial center. The building has served various shops and offices to fulfill downtown Springfield's function before the Second World War as the place to shop.

**United States Department of the Interior
National Park Service**

**National Register of Historic Places
Inventory—Nomination Form**

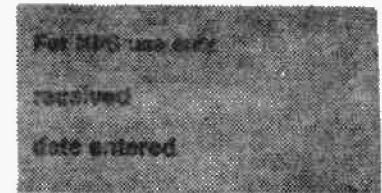

Continuation sheet Central Spfld. H.D. B.E. Item number 8

Page 13

History:

Before the advent of the automobile as the leading mode of private transportation, Joseph D. Myers and Walter Van Duyn opened (c.1888) a carriage manufactory in this building. Their company developed a reputation for fine products and offered one of the city's most extensive inventories. The present building served as the paint and trim shop. (A free-standing two-story section to the east housed the construction site. It stood until at least 1917 although the Myers and Van Duyn Carriage Works succumbed to competition from the automobile shortly after 1905.) By 1915, the building was occupied by a millinery shop on the first floor and on the second floor by two doctors and two private apartments. The millinery shop operated by Helen Zartien remained by 1935 but in this Depression-period the Illinois State Employment Service shared the first floor. A beauty shop and music school operated on the second floor.

6. 320-322 S. Sixth

Significance:

This building combined small apartments on the second floor with small shops on the first floor since its construction near the turn-of-the-century. In this dual function it was similar to many downtown buildings at the time of construction.

History:

This building was constructed sometime between 1895 and 1917 and between then and 1936, the fifty-year limit of the National Register, a sampling of occupants at ten-year intervals reveals the following. In 1905 and 1915 the building was entirely apartments. By 1925, part continued as apartments but Hamann the Printer had begun a long occupancy. In 1915, Hamann utilized the building immediately south, at 324 S. Sixth. In 1925, small businesses also included the National Detective Bureau, and the Lincoln College of Law. All apartment renters had moved out by 1935 and the occupants were Louis A. Danner, a tailor, the OK Barber Shop, the Sowle Insurance Agency, and Hamann the Printer.

**United States Department of the Interior
National Park Service**

**National Register of Historic Places
Inventory—Nomination Form**

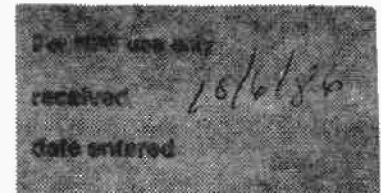

Continuation sheet Central Spfld. H.D. B.E. Item number 8

Page 14

7. 324 S. Sixth

Significance:

Like the building to the north in the nomination, this property is significant for its contribution to the central business district and the architectural qualities which symbolize the southeastern perimeter of that district. Some people also occupied the second-floor apartments during the building's early years.

History:

Built sometime between 1895 and 1917, this building has been mostly the location for a succession of small businesses. In 1905, it included the Electric Manufacturing Company, Illinois Plumbing and Heating, and two apartment dwellers. Hamann the Printer had began his occupancy by 1915 at this address before moving to the north, adjacent building by 1925. In 1915 the second floor was an apartment. The Sylva Cafe utilized the first floor in 1925 and the second floor was apartments. Mingle's Cafe occupied the first floor in 1935.

**United States Department of the Interior
National Park Service**

**National Register of Historic Places
Inventory—Nomination Form**

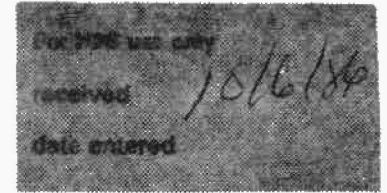

Continuation sheet Central Spfld. H.D. B.E Item number 9

Page 1

Section 9

Bibliography:

Hanes, Murray
1975 Interview by R.E. Knack

Polk's Springfield City Directory
1905, 1915, 1925, and 1935

Van Meter, Andy
1981 Always My Friend: A History of the State Journal Register and
Springfield, Springfield, Copley Press.

Vertical files at Lincoln Library, Sangamon Valley Collection,
Springfield, Illinois, including "Hotels," "Sixth Street," "Hanes
Biography," and "Helmle and Helmle Biography."

**United States Department of the Interior
National Park Service**

**National Register of Historic Places
Inventory—Nomination Form**

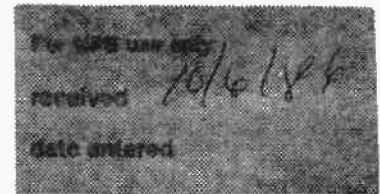

Continuation sheet Central Spfld. H.D. B.E. Item number 10

Page 3

Acreage of nominated property -- 4 acres

Quadrangle name: Springfield West, IL

Quadrangle scale: 1:24000

Revised Verbal Boundary Description

....the structure on the SE corner of Sixth Street and Monroe. The boundary then continues south along the east property lines of 316-324 S. Sixth and then turns west to the center of S. Sixth. The line then turns south to a point parallel with the south property line of the Leland Hotel, west to a point parallel with the west property line of the Leland Hotel, then north along the west property lines of 321 S. Sixth, the State Journal Building and 522 E. Monroe. Then the line cuts along alleys on the interior property lines of 229-219 S. Sixth.....

UTM Reference

A	<u>Easting</u> 16273260	<u>Northing</u> 4408640	E	<u>Easting</u> 16273240	<u>Northing</u> 4408530
B	16273300	4408640			
C	16273340	4408540			
D	16273300	4408520			

Form Prepared By:
Keith A. Sculle, National Register Coordinator
Ann V. Swallow, Assistant National Register Coordinator
Illinois Historic Preservation Agency
Old State Capitol
Springfield, Illinois
(217) 785-4512
August 1, 1986

**United States Department of the Interior
National Park Service**

**National Register of Historic Places
Inventory—Nomination Form**

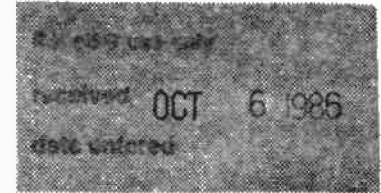

Central Springfield Historic

Continuation sheet District Boundary Extension Item number 12

Page 2

The evaluated significance of this property within the state is local.

As the designated State Historic Preservation Officer for the National Historic Preservation Act of 1966 (Public Law 89-665), I hereby nominate this property for inclusion in the National Register and certify that it has been evaluated according to the criteria and procedures set forth by the National Park Service.

State Historic Preservation Officer

(Signature)

Title

9-22-86

(date)

United States Department of the Interior
National Park Service

National Register of Historic Places
Inventory—Nomination Form

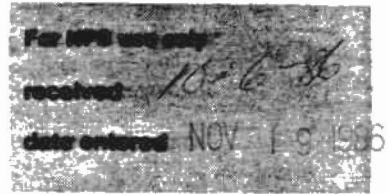

Continuation sheet

Item number

Page

Name Central Springfield Historic District
State Sangamon County, IL

Nomination/Type of Review

Date/Signature

Boundary Increase Approval

Substantive Review

Keeper

Beth Groves 11/19/86

Attest

Keeper

Attest

Keeper

Attest

Keeper

Attest

Keeper

Attest

Keeper

Attest

Keeper

Attest

Keeper

Attest



Keeper

Attest

Keeper

Attest

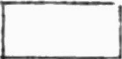
CENTRAL
SPRINGFIELD
HISTORIC DISTRICT
BOUNDARY EXTENSION

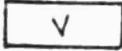
CONTRIBUTING 
NON-CONTRIBUTING 
VACANT LOT 

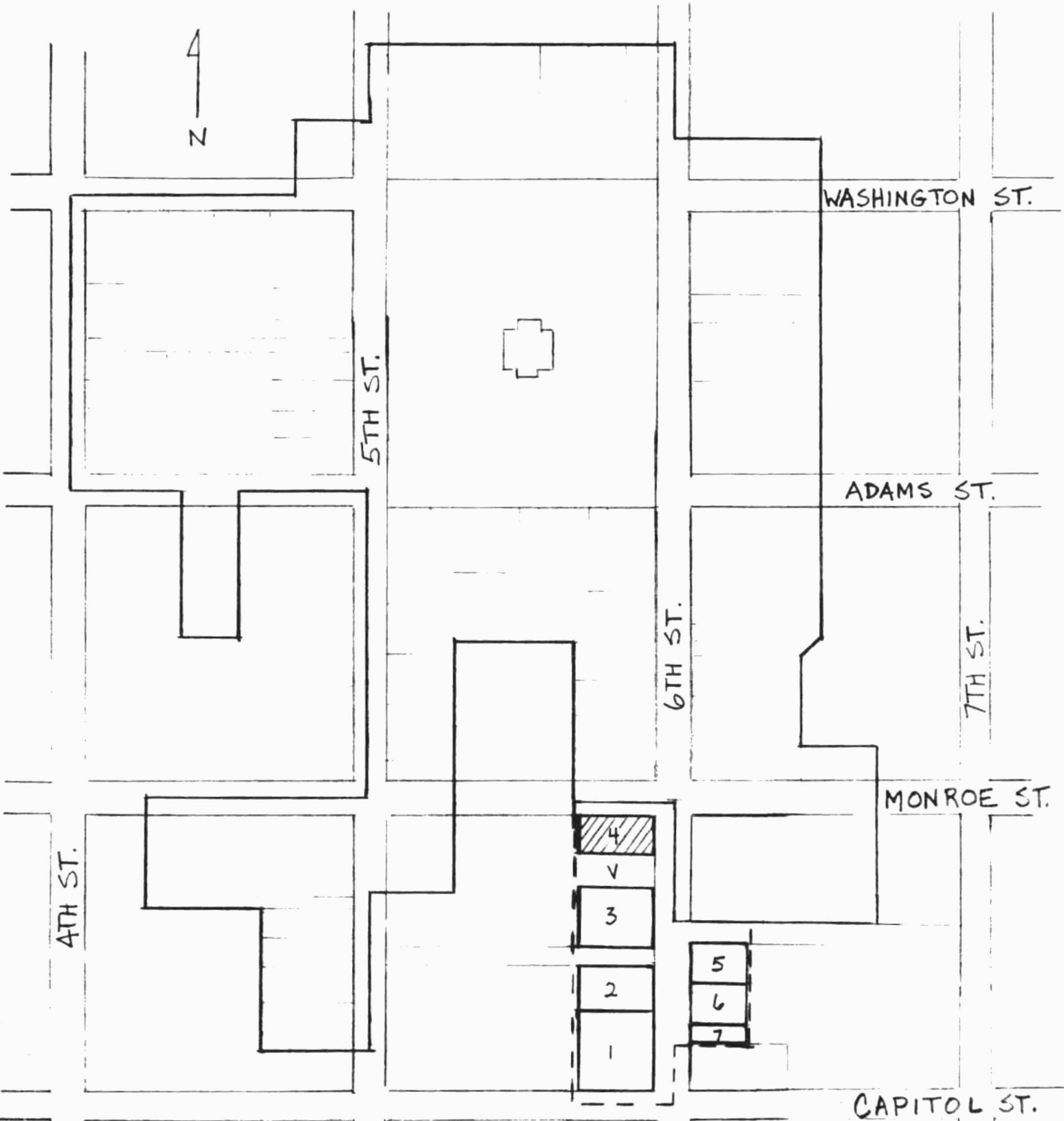

8600 3/84

NATIONAL REGISTER OF HISTORIC PLACES
EVALUATION/RETURN SHEET

Central Springfield Historic District (Boundary Increase)
Sangamon County
ILLINOIS

Substantive Review

Working No. OCT 6 1986
Fed. Reg. Date: 2/2/88
Date Due: 11/6/86 - 11/20/86
Action: ACCEPT 11-19-86
 RETURN
 REJECT
Federal Agency: _____

- resubmission
- nomination by person or local government
- owner objection
- appeal

Substantive Review: sample request appeal NR decision

Reviewer's comments:

Recom./Criteria Accept - A, C
Reviewer Andrew
Discipline Historian
Date 11/19/86
_____ see continuation sheet

Nomination returned for: _____ technical corrections cited below
_____ substantive reasons discussed below

1. Name

2. Location

3. Classification

Category	Ownership	Status	Present Use
	Public Acquisition	Accessible	

4. Owner of Property

5. Location of Legal Description

6. Representation in Existing Surveys

Has this property been determined eligible? yes no

7. Description

Condition

- excellent
- good
- fair
- deteriorated
- ruins
- unexposed

Check one

- unaltered
- altered

Check one

- original site
- moved date _____

Describe the present and original (if known) physical appearance

- summary paragraph
- completeness
- clarity
- alterations/integrity
- dates
- boundary selection

8. Significance

Period _____ Areas of Significance—Check and justify below

Specific dates _____ Builder/Architect _____

Statement of Significance (*in one paragraph*)

- summary paragraph
- completeness
- clarity
- applicable criteria
- justification of areas checked
- relating significance to the resource
- context
- relationship of integrity to significance
- justification of exception
- other

9. Major Bibliographical References

10. Geographical Data

Acreage of nominated property _____

Quadrangle name _____

UTM References _____

Verbal boundary description and justification _____

11. Form Prepared By

12. State Historic Preservation Officer Certification

The evaluated significance of this property within the state is:

____ national ____ state ____ local

State Historic Preservation Officer signature _____

title _____ date _____

13. Other

- Maps
- Photographs
- Other

Questions concerning this nomination may be directed to _____

Signed _____ Date _____ Phone: _____



Leland Hotel
Central Springfield Historic
District Boundary Extension
Springfield, IL

Ann V. Swallow, photog.

July, 1986

Neg. Ill. Hist. Pres. Agency

Looking NW

Photo No. 1



321 S. Sixth
Central Springfield Historic
District Boundary Extension
Springfield, IL

Ann V. Swallow, photog.

July, 1986

Neg: Ill. Historic Preservation Agency

Looking West

Photo No. 2



The State Journal Building
Central Springfield H.D.
Boundary Extension
Springfield, IL

Ann V. Swallow, photog.

July 1986

Neg.
Looking West
Photo No. 3



SPRINGFIELD
SYMPHONY ORCHESTRA

OPTOMETRISTS
SUNGLASSES & MORE

SHAPIRO'S BOOK MART

322 1/2

SONOTONE OF SPRINGFIELD
HOUSE OF HEARING

Sieb
SHOE

John C. Roberts
FOR MEN

EMERGENCY CHAPLAIN

CONTACT MINISTRIES

320-322 S. Sixth St.
Central Springfield H.D.
Boundary Extension
Springfield, IL
Ann V. Swallow, photog.

July, 1986.

Neg: Ill Historic Preservation Agency
Looking east
Photo. No. 4

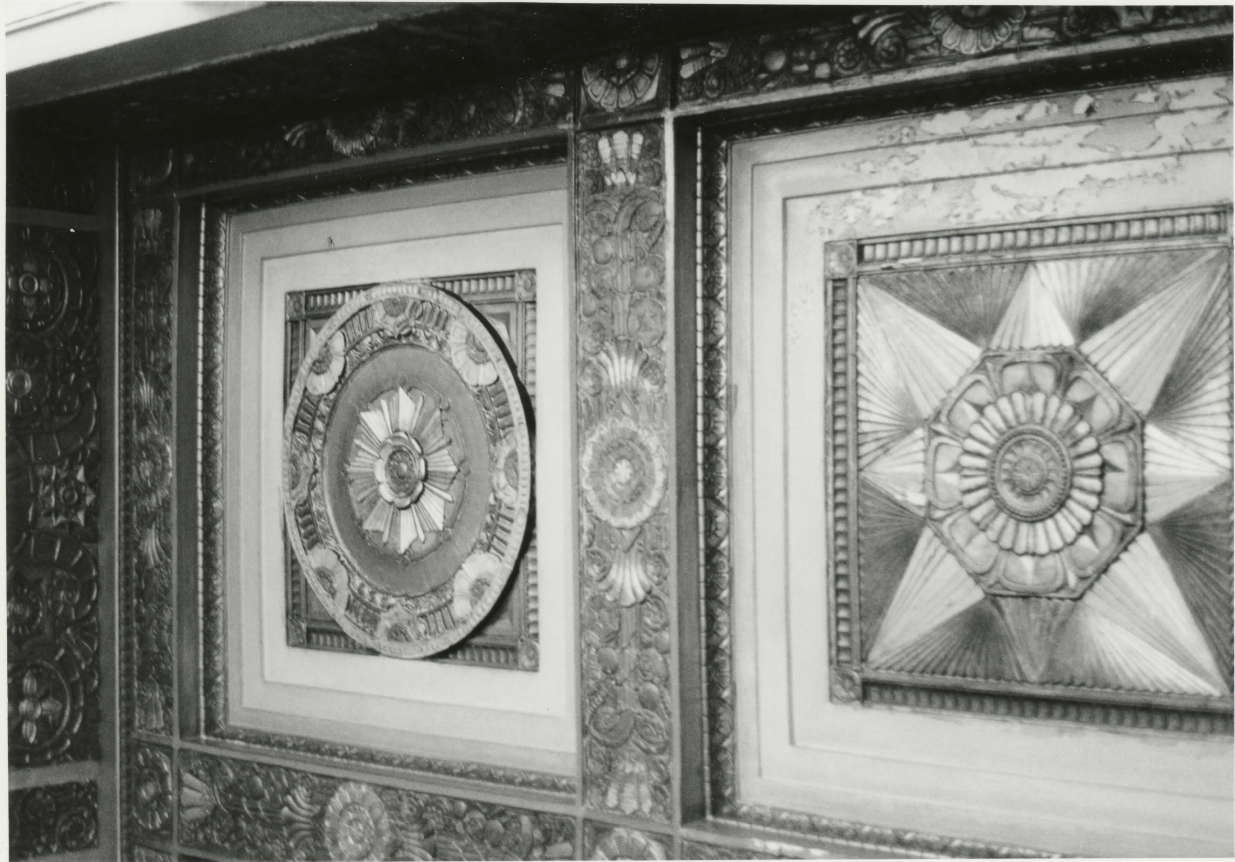

Illinois State Journal Building
Central Springfield Historic
District Boundary Extension
Springfield, IL

Ann V. Swallow, photog.

July, 1986

Neg: Ill. Historic Preservation Agency

Lobby ceiling

Photo. No. 5



Siebert's
SHOE STORE

John C. Roberts
FOR MEN

Grace Walker
FOR WOMEN

SONOTONE
OF SPRINGFIELD

HOUSE OF HEARING

NO PARKING
ANY TIME
DAY OR NIGHT
EXCEPT
2 HOUR PERMIT
EXEMPT
1 HOUR PERMIT
EXEMPT

PEARSON

322



324 S. Sixth Street
Central Springfield H.D.
Boundary Extension
Springfield, IL
Ann V. Swallow, photog.
July, 1986

Neg: Illinois Hist. Preservation Agy.
Looking east
Photo. No. 6



A CENTURY
CELEBRATION
100
1886 - 1986

VISIT
MARK TWAIN
CAVE
HANNIBAL, MO

Siebert's
ICE CREAM

Downtown Comics

Lincoln Home
Walker Center

Marvack

East Side of 300 Block of S. Sixth Street
Central Springfield H.D.

Boundary Extension
Springfield, IL

Ann V. Swallow, photog.

July, 1986

Neg. Ill. Historic Preservation Agency

Looking north

Photo. No. 7

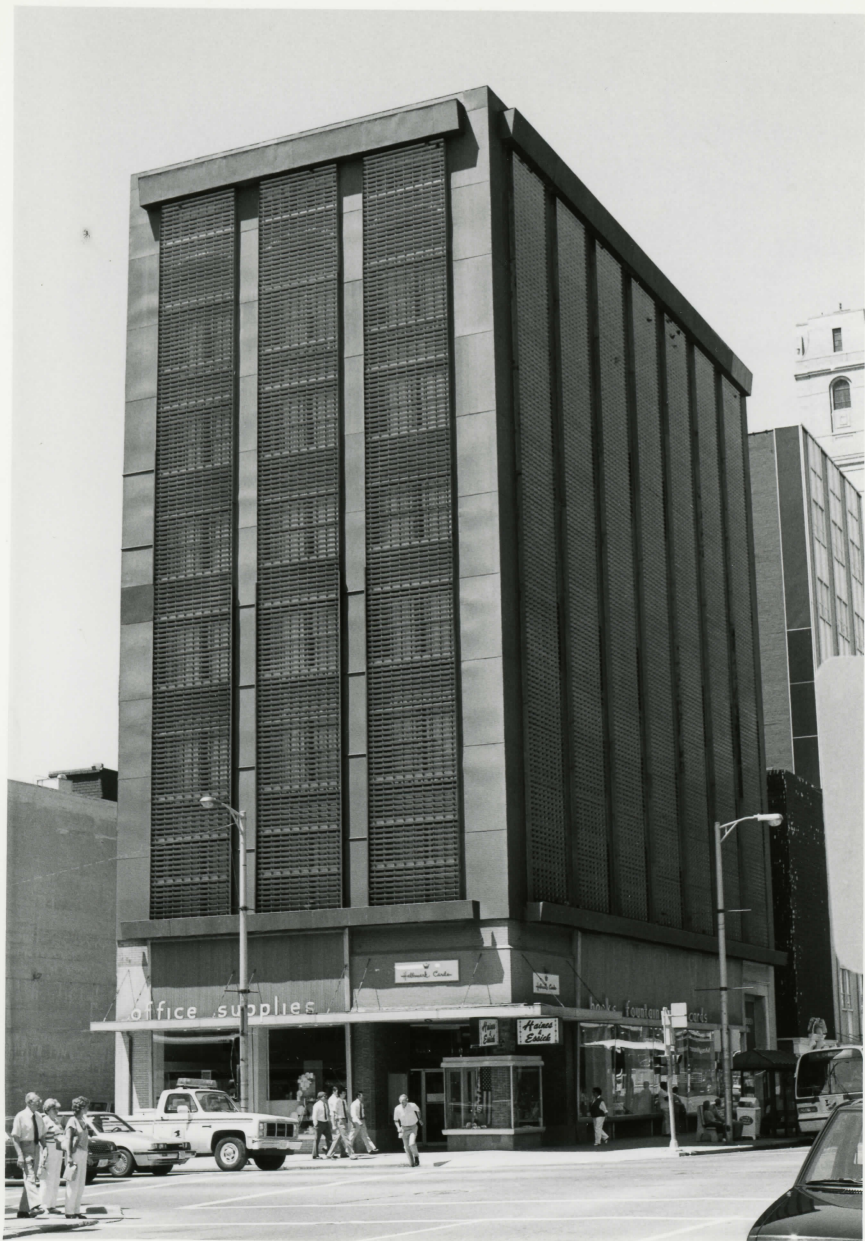

Ferguson Building
Central Springfield H.D.
Boundary Extension
Springfield, IL

Ann V Swallow, photog.

July 1986

Neg: Ill Historic Preservation Agency

Looking west

Photo No. 8



FOR RENT
Call 212-1234

ACCESS
TO
BUS

316-318 S. Sixth St
Central Springfield H D.
Boundary Extension
Springfield, IL
Ann V. Swallow, photog.

July, 1986
Neg: Ill. Historic Preservation Agency
Looking SE
Photo. No. 9



South Sixth Street
Central Springfield Historic
District Boundary Extension
Springfield, IL

Ann V Swallow, photoq.

July, 1986

Neg: Ill. Hist. Pres. Agency

Looking NW

Photo. No. 10



South Sixth Street - West side
Central Springfield Historic
District Boundary Extension

Springfield, IL

Ann V. Swallow, photog.

July, 1986

Neg. Ill. Hist Pres Agency

Looking SW

Photo. No. 11



South Sixth Street - east side
Central Springfield Historic
District Boundary Extension
Springfield, IL

Ann V. Swallow, photog.

July, 1986

Neg. Ill. Hist. Pres. Agency

Looking SE

Photo. No. 12



South Sixth Street - west side
Central Springfield Historic
District Boundary Extension
Springfield, IL

Ann V. Swallow, photog.

July, 1986

Neg: Ill. Hist. Pres. Agency

looking NW

Photo No. 13



324 S. Sixth Street - detail

Central Springfield Historic
District Boundary Extension

Springfield, IL

Ann V. Swallow, photoq.

July, 1986

Neg: Ill. Hist. Pres. Agency

Looking east

Photo. No. 14



Rear view of 320-322 S. Sixth Street
Central Springfield Historic
District Boundary Extension
Springfield, IL

Ann V. Swallow, photog.

July, 1986

Neg: Ill. Hist. Pres. Agency

Photo No. 15

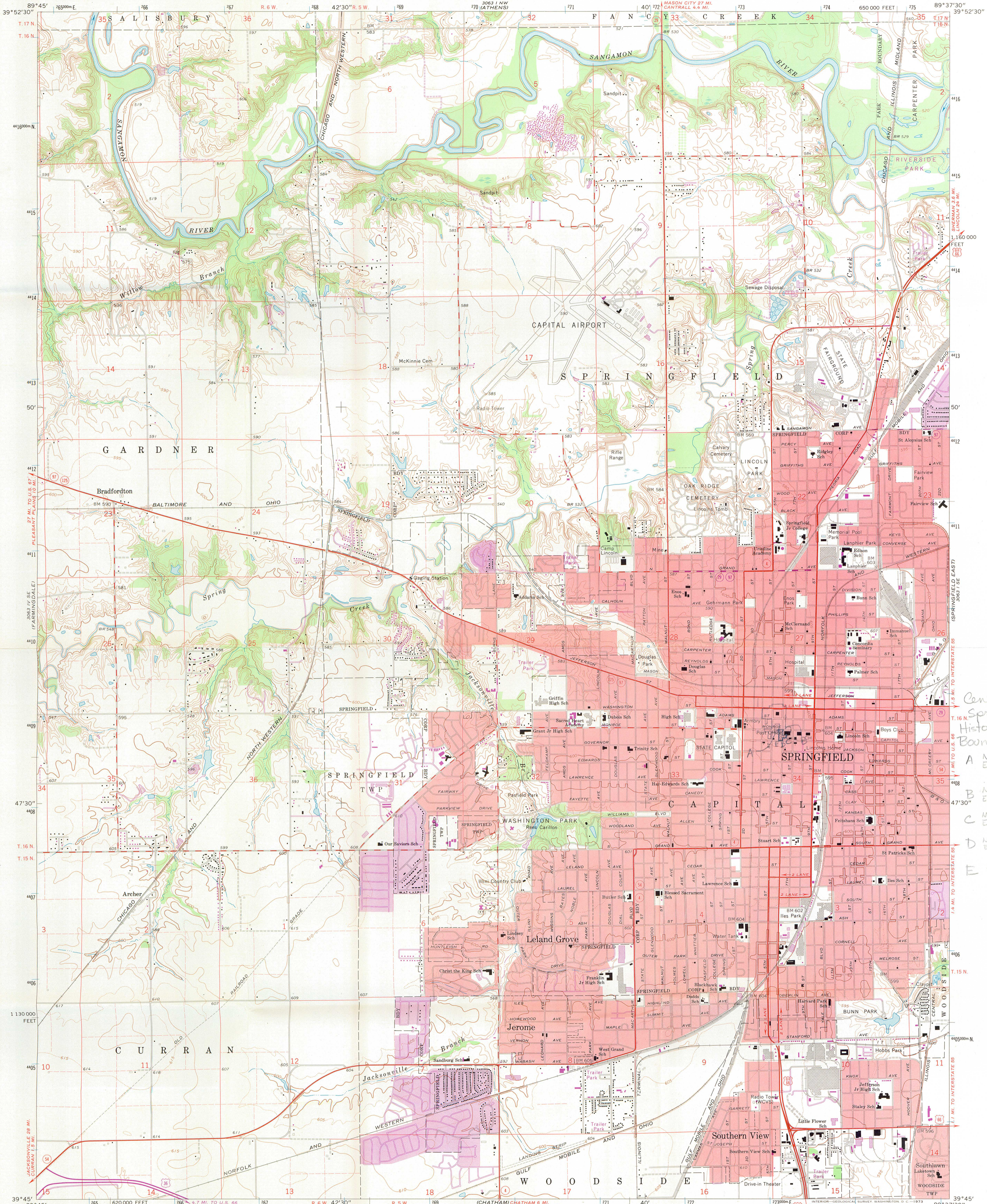

Central
Springfield
Historic District
Boundary Ext.

A N	4408640
A E	273260
B N	4408640
B E	273300
C N	4408540
C E	273340
D N	4408530
D E	273300
E N	4408530
E E	273240

Mapped, edited, and published by the Geological Survey

Control by USGS and USC&GS

Topography by photogrammetric methods from aerial photographs taken 1964 and planetab surveys 1965. Supersedes map dated 1948.

Polyconic projection. 1927 North American datum. 10,000-foot grid based on Illinois coordinate system, west zone 1000-meter Universal Transverse Mercator grid ticks, zone 16, shown in blue.

Red tint indicates areas in which only landmark buildings are shown. Fine red dashed lines indicate selected fence and field lines where generally visible on aerial photographs. This information is unchecked.

Revisions shown in purple compiled from aerial photographs taken 1971. This information not field checked.

Purple tint indicates extension of urban areas.

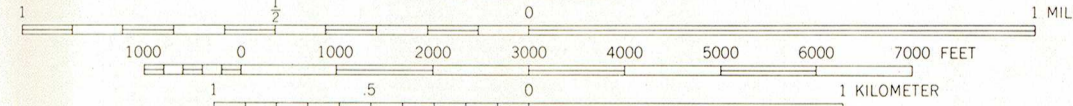
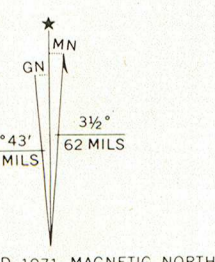

CONTOUR INTERVAL 10 FEET
DOTTED LINES REPRESENT 5-FOOT CONTOURS
DATUM IS MEAN SEA LEVEL

THIS MAP COMPLIES WITH NATIONAL MAP ACCURACY STANDARDS
FOR SALE BY U. S. GEOLOGICAL SURVEY, WASHINGTON, D. C. 20242
AND BY THE STATE GEOLOGICAL SURVEY, URBANA, ILLINOIS 61801
A FOLDER DESCRIBING TOPOGRAPHIC MAPS AND SYMBOLS IS AVAILABLE ON REQUEST

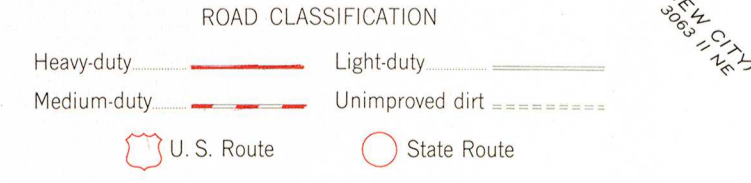

SPRINGFIELD WEST, ILL.
N 3945—W 8937.5/7.5

1965
PHOTOREVISED 1971
AMS 3063 I SW—SERIES V863



RS



Illinois Historic Preservation Agency

Old State Capitol • Springfield • 62701

September 30, 1986

Beth Grosvenor
National Register Program
National Park Service
Department of Interior
1100 L Street, N.W.
Washington, DC 20240

Dear Beth:

Enclosed please find the National Register nomination forms and accompanying materials for the following properties:

Ayers Bank Building, Jacksonville, IL
Balaban and Katz Uptown Theatre, Chicago, IL
George Blackman House, Hillsboro IL
Central Springfield Historic District Boundary Extension
Chicago and Eastern Illinois Railroad Depot, Tamms, IL
East Grove Street Historic District, Bloomington, IL
Goddard Chapel, Marion, IL
Henry E. Legler Regional Branch Public Library, Chicago, IL

Thank you for your attention.

Sincerely yours,

Ann V. Swallow
Assistant National Register
Coordinator

AVS;tb
Enclosures

OCT 6 1986