

INDIVIDUAL PROPERTY FORM

PROPERTY NAME: Starved Rock Lodge and Cabins  
CITY/TOWN/VICINITY: LaSalle-Peru vicinity  
COUNTY: LaSalle Code: 099  
ADDRESS: Box 116  
Utica, IL 61373

OWNER'S NAME: Illinois Department of Conservation  
ADDRESS: 524 South Second, Springfield, Illinois

LOCATION OF LEGAL DESCRIPTION: Same as Owner

VERBAL BOUNDARY DESCRIPTION: The nominated area includes the lodge, all cabins, and surrounding woods. This complex is best understood by reference to the enclosed site plan.

APPROXIMATE ACREAGE: approximately seventeen

DATE OF CONSTRUCTION: 1933-1939

ARCHITECT AND/OR BUILDER: Joseph F. Booten

DESCRIPTION - SECTION 7:

The lodge building includes a central lounge flanked by dining room and hotel wings. The complex also includes twelve cabins. The buildings are sited on a heavily wooded bluff overlooking Starved Rock and the Illinois River.

Stone, unhewn log, clapboards, and wood shingles comprise the exterior finishes of the lodge building. The central portion of the lodge, the lounge, is defined by unhewn logs with random corner notching resting on a limestone foundation. Principal entry to the lounge is from the south, where carved logs support a small gabled porch. The north side of the lounge, where a change in grade provides a two story facade, contains a continuous band of windows and three doors, providing light to the interior and access to a flagstone terrace. To the east of the lounge is a two-story dining room/service wing; a three-story hotel wing is west of the lounge. Both are covered in a combination of clapboard and wood shingles stained a light green. Exterior alterations to the lodge appear to be limited to the replacement of the hotel wing's wood casement windows with modern single pane metal casements.

The principal interior spaces are the lounge and the dining room. The lounge is a two-story space with a stone double fireplace in the center. The

main lounge area is raised three steps above the concessions and business office area, and further defined by a log railing. Interior features include unhewn log walls and board and batten siding in the gables. The log roof trusses are left exposed. The dining room contains similar finishes, including a stone fireplace on the east wall. The hotel wing contains modern guest rooms decorated with knotty pine paneling.

There are twelve cabins located adjacent to the lodge. Two four-room cabins are just west of the hotel wing. The remaining single cabins are separated from the lodge by a steep ravine (called Fox Canyon). Access to these cabins from the lodge is by a footbridge. All the cabins are built of unhewn logs with random corner notching. The siting of the cabins amidst a heavily wooded area and their physical separation from the lodge emphasize their "camping in the woods" character.

#### SIGNIFICANCE - Section 8:

Starved Rock State Park Lodge satisfies the themes of the architecture and recreation for which this thematic nomination is proposed for the National Register.

#### ARCHITECTURE:

Starved Rock's lodge and cabins are rivaled in size and geographic extent only by the same at Pere Marquette. They represent the upper echelon of the Lodge with cabins complex at the state parks and visually convey their rank among the others at the time of construction. Both the lodge and cabins embody picturesque qualities.

The lodge has a special place in this nomination because it is the largest structure built primarily in wood to convey the picturesque mode which unifies this thematic nomination. Booten designed round log purlins with unevenly hewn ends that extend beyond the roofedge for the lodge in order to capture the atmosphere of a woodsy retreat. Although the towering three-story dormitory diminishes this mood, the public lounge replicates the cathedral-like qualities of its counterparts at Black Hawk, Giant City, and Pere Marquette.

#### RECREATION:

Illinois officially ranked this lodge with its dormitory as the finest in the state parks when it was built. For example, it was observed in the first issue of the state organ for state parks that,

Starved Rock Lodge is a magnificent structure of stone and logs. It is one of the finest buildings of its kind in the country. Up-to-date in every respect, there are 48 rooms with private bath. The high and colorful lounge is inviting in its informality. The beautiful pine-paneled dining room is noted for its cuisine. The basement

recreation room is a popular spot (Bates 1944:28).

Clearly, the state believed the benefits of urban and country life were compatibly combined and rid of their preceived disadvantages in this recreational setting, much as suburbs offered middle class residents.

Starved Rock was reckoned worthy of this effort because it had the largest attendance of Illinois' state parks when the lodge was designed. Acquisition had been justified in terms of scenic and historic conservation; but the rationale shifted to recreation by the mid-1930's and accounts dwelled on the heavy traffic counts.

This is the most extensively used state park in Illinois, being only 90 miles from Chicago and readily accessible by automobile. As evidenced by the variety of facilities offered, the park is used for a wide number of recreational purposes of which picknicing, hiking, boating, camping and swimming are the most important. (Division 1938: 90)

**United States Department of the Interior  
National Park Service**

**National Register of Historic Places  
Inventory—Nomination Form**

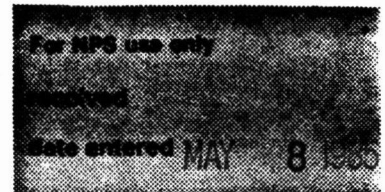

Continuation sheet

Item number 10

Page 1

STARVED ROCK

Acreeage of nominated property: approximately 17  
Quadrangle name: Stavred Rock, IL

Quadrangle Scale: 1:24000

UTM References

	<u>Zone</u>	<u>Easting</u>	<u>Northing</u>
A:	16	332940	4575880
B:	16	333160	4575940
C:	16	333400	4575780
D:	16	333360	4575720

United States Department of the Interior  
National Park Service

National Register of Historic Places  
Inventory—Nomination Form

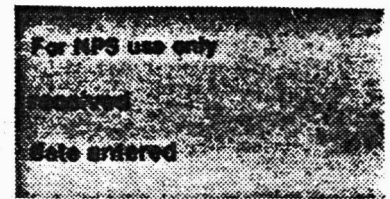

Continuation sheet

Item number 10

Page 1

STARVED ROCK

Acreage of nominated property: 1  
Quadrangle name: Starved Rock, IL

Quadrangle Scale: 1:24000

UTM References

	<u>Zone</u>	<u>Easting</u>	<u>Northing</u>
A:	16	332940	4575880
B:	16	333160	4575940
C:	16	333400	4575780
D:	16	333360	4575720

**United States Department of the Interior  
National Park Service**

**National Register of Historic Places  
Inventory—Nomination Form**

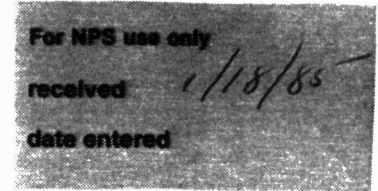

Continuation sheet

Item number

Page

Multiple Resource Area  
Thematic Group

dnr-11

Name Illinois State Parks Lodges and Cabins Thematic Resources

State ILLINOIS *La Salle Co*

Nomination/Type of Review

Date/Signature

1. Black Hawk Museum and Lodge **Substantive Review** Keeper

*Beth Grosvenor 3/4/85*

Attest

2. Giant City State Park Lodge and Cabins **Substantive Review** Keeper

*Beth Grosvenor 3/4/85*

Attest

3. White Pines State Park Lodge and Cabins **Substantive Review** Keeper

*Beth Grosvenor 3/4/85*

Attest

4. Pere Marquette State Park Lodge and Cabins **Substantive Review** Keeper

*Beth Grosvenor 3/4/85*

Attest

5. Starved Rock Lodge and Cabins Keeper

*Beth Grosvenor 5/8/85*

**Substantive Review**

Attest

6. Keeper

Attest

7. Keeper

Attest

8. Keeper

Attest

9. Keeper

Attest

10. Keeper

Attest

NATIONAL REGISTER OF HISTORIC PLACES  
EVALUATION/RETURN SHEET

*Substantive Review*

Starved Rock Lodge and Cabins (Illinois State  
Parks Lodges and Cabins TR)  
LaSalle County  
ILLINOIS

JAN 18 1985

Working No. \_\_\_\_\_  
Fed. Reg. Date: \_\_\_\_\_  
Date Due: 2/4/85 - 3/4/85  
Action:  ACCEPT  
 RETURN 3-4-85  
 REJECT  
Federal Agency: \_\_\_\_\_

- resubmission
- nomination by person or local government
- owner objection
- appeal

Substantive Review:  sample  request  appeal  NR decision

Reviewer's comments:

Recom./Criteria Return  
Reviewer Grosvont  
Discipline Historian  
Date 3/4/85  
\_\_\_\_\_ see continuation sheet

Nomination returned for:  technical corrections cited below  
 substantive reasons discussed below

1. Name

2. Location

3. Classification

Category	Ownership	Status	Present Use
	Public Acquisition	Accessible	

4. Owner of Property

5. Location of Legal Description

6. Representation in Existing Surveys

Has this property been determined eligible?  yes  no

7. Description

Condition		Check one	Check one
<input type="checkbox"/> excellent	<input type="checkbox"/> deteriorated	<input type="checkbox"/> unaltered	<input type="checkbox"/> original site
<input type="checkbox"/> good	<input type="checkbox"/> ruins	<input type="checkbox"/> altered	<input type="checkbox"/> moved date _____
<input type="checkbox"/> fair	<input type="checkbox"/> unexposed		

Describe the present and original (if known) physical appearance

- summary paragraph
- completeness
- clarity
- alterations/integrity
- dates
- boundary selection

8. Significance

Period Areas of Significance—Check and justify below

Specific dates

Builder/Architect

Statement of Significance (in one paragraph)

in this thematic  
As with all of the properties, it is unclear how to interpret this date range. Did it take six years to build the lodge? Did it also take six years to build each cabin? Or - are specific construction dates of shorter duration known for each structure, all falling between the years 1933 and 1939? If the latter is the case, the more specific construction dates should be provided for each structure.

- summary paragraph
- completeness
- clarity
- applicable criteria
- justification of areas checked
- relating significance to the resource
- context
- relationship of integrity to significance
- justification of exception
- other

9. Major Bibliographical References

X 10. Geographical Data

Acreage of nominated property \_\_\_\_\_

Quadrangle name \_\_\_\_\_

UTM References \_\_\_\_\_

draw the boundaries on the site plan and

X Verbal boundary description and justification

Please provide scale for site maps. Currently there is no indication where the specific boundaries are located.

11. Form Prepared By

12. State Historic Preservation Officer Certification

The evaluated significance of this property within the state is:

\_\_\_ national \_\_\_ state \_\_\_ local

State Historic Preservation Officer signature

title \_\_\_\_\_ date \_\_\_\_\_

13. Other

- Maps See 10 above - please draw the boundaries on the sketch maps.
- Photographs
- Other

Questions concerning this nomination may be directed to \_\_\_\_\_

Signed Beth Casanova Date 3/4/85 Phone: \_\_\_\_\_

NATIONAL REGISTER OF HISTORIC PLACES  
EVALUATION/RETURN SHEET

REF#  
85002702

Starved Rock Lodge and Cabins (Illinois State  
Parks Lodges and Cabins TR)  
LaSalle County  
ILLINOIS

~~Substantive Review~~

Working No. 3/18/85  
Fed. Reg. Date: 2/4/86  
Date Due: 5/25/85  
Action:  ACCEPT 5-8-85  
 RETURN  
 REJECT  
Federal Agency: \_\_\_\_\_

- resubmission
- nomination by person or local government
- owner objection
- appeal

Substantive Review:  sample  request  appeal  NR decision

Reviewer's comments:

Recom./Criteria \_\_\_\_\_  
Reviewer \_\_\_\_\_  
Discipline \_\_\_\_\_  
Date \_\_\_\_\_  
\_\_\_\_\_ see continuation sheet

Nomination returned for: \_\_\_\_\_ technical corrections cited below  
\_\_\_\_\_ substantive reasons discussed below

1. Name

2. Location

3. Classification

Category	Ownership Public Acquisition	Status Accessible	Present Use
----------	---------------------------------	----------------------	-------------

4. Owner of Property

5. Location of Legal Description

6. Representation in Existing Surveys

Has this property been determined eligible?  yes  no

7. Description

Condition	Check one	Check one
<input type="checkbox"/> excellent	<input type="checkbox"/> deteriorated	<input type="checkbox"/> original site
<input type="checkbox"/> good	<input type="checkbox"/> ruins	<input type="checkbox"/> moved date _____
<input type="checkbox"/> fair	<input type="checkbox"/> unexposed	
	<input type="checkbox"/> unaltered	
	<input type="checkbox"/> altered	

Describe the present and original (if known) physical appearance

- summary paragraph
- completeness
- clarity
- alterations/integrity
- dates
- boundary selection





STARVED ROCK LODGE AND CABINS  
LaSalle-Peru, IL vicinity  
Keith Sculle  
October 1984  
Illinois Dept. of Conservation

View of hotel facing NW

1/29/85



STARVED ROCK LODGE AND CABINS  
LaSalle-Peru, IL vicinity  
Keith Sculle  
October 1984

Illinois Dept. of Conservation  
View of Lodge entrance looking North

1/24/85



STARVED ROCK LODGE AND CABINS  
LaSalle-Peru, IL vicinity  
Keith Sculle  
October 1984

Illinois Dept. of Conservation  
View of interior of lodge  
Camera facing SE

1/29/05



STARVED ROCK LODGE AND CABINS  
LaSalle-Peru IL vicinity  
Keith Sculle  
October 1984  
Illinois Dept. of Conservation

View of one cabin type

i/29/85



STARVED ROCK LODGE AND CABINS  
LaSalle-Peru, IL vicinity  
Keith Sculle  
October 1984  
Illinois Dept. of Conservation

View of cabin

1/24/85



STARVED ROCK LODGE AND CABINS  
LaSalle-Peru, Ill. vicinity  
Keith Sculle  
October 1984  
Illinois Dept. of Conservation

A view of one cabin type

1/29/85



Illinois State Park Lodges, Thematic  
Starved Rock Lodge and Cabins  
Illinois Historic Preservation Agency  
June 1985  
exterior view of lodge



Illinois State Park Lodges, Thematic  
Starved Rock Lodge and Cabins  
Illinois Historic Preservation Agency  
June 1985  
exterior view of Cabin



Illinois State Park Lodges, Thematic  
Starved Rock Lodge and Cabins  
Illinois Historic Preservation Agency  
June 1985

interior view of lodge



Illinois State Park Lodges, Thematic  
Starved Rock Lodge and Cabins  
Illinois Historic Preservation Agency  
June 1985  
exterior view of cabin



Illinois State Park Lodges, Thematic  
Starved Rock Lodge and Cabins  
Illinois Historic Preservation Agency  
June 1985  
interior view of lodge



Illinois State Park Lodges, Thematic  
Starved Rock Lodge and Cabins  
Illinois Historic Preservation Agency  
June 1985  
interior view of lodge



Illinois State Park Lodges, Thematic  
Starved Rock Lodge and Cabins  
Illinois Historic Preservation Agency  
June 1985  
interior view of lodge



Illinois State Park Lodges, Thematic  
Starved Rock Lodge and Cabins  
Illinois Historic Preservation Agency

June 1984

interior view of lodge

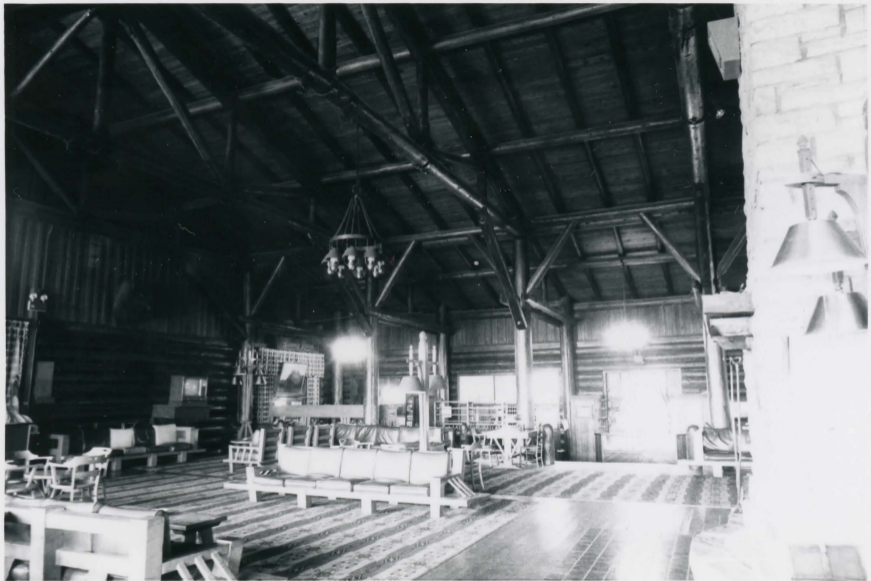

Illinois State Park Lodges, Thematic  
Starved Rock Lodge  
Illinois Historic Preservation Agency  
June 1985  
view of interior of Lodge

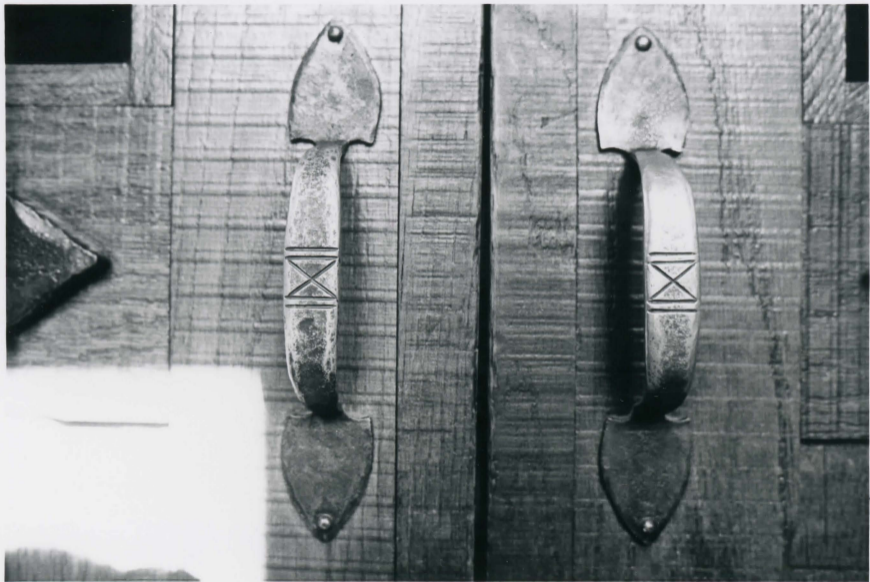

Illinois State Park Lodges, Thematic  
Starved Rock Lodge and Cabin  
Illinois Historic Preservation Agency  
June 1985  
close up view of doors in lodge



Illinois State Park Lodges, Thematic  
Starved Rock Lodge and Cabins  
Illinois Historic Preservation Agency  
June 1985  
view of exterior of Lodge

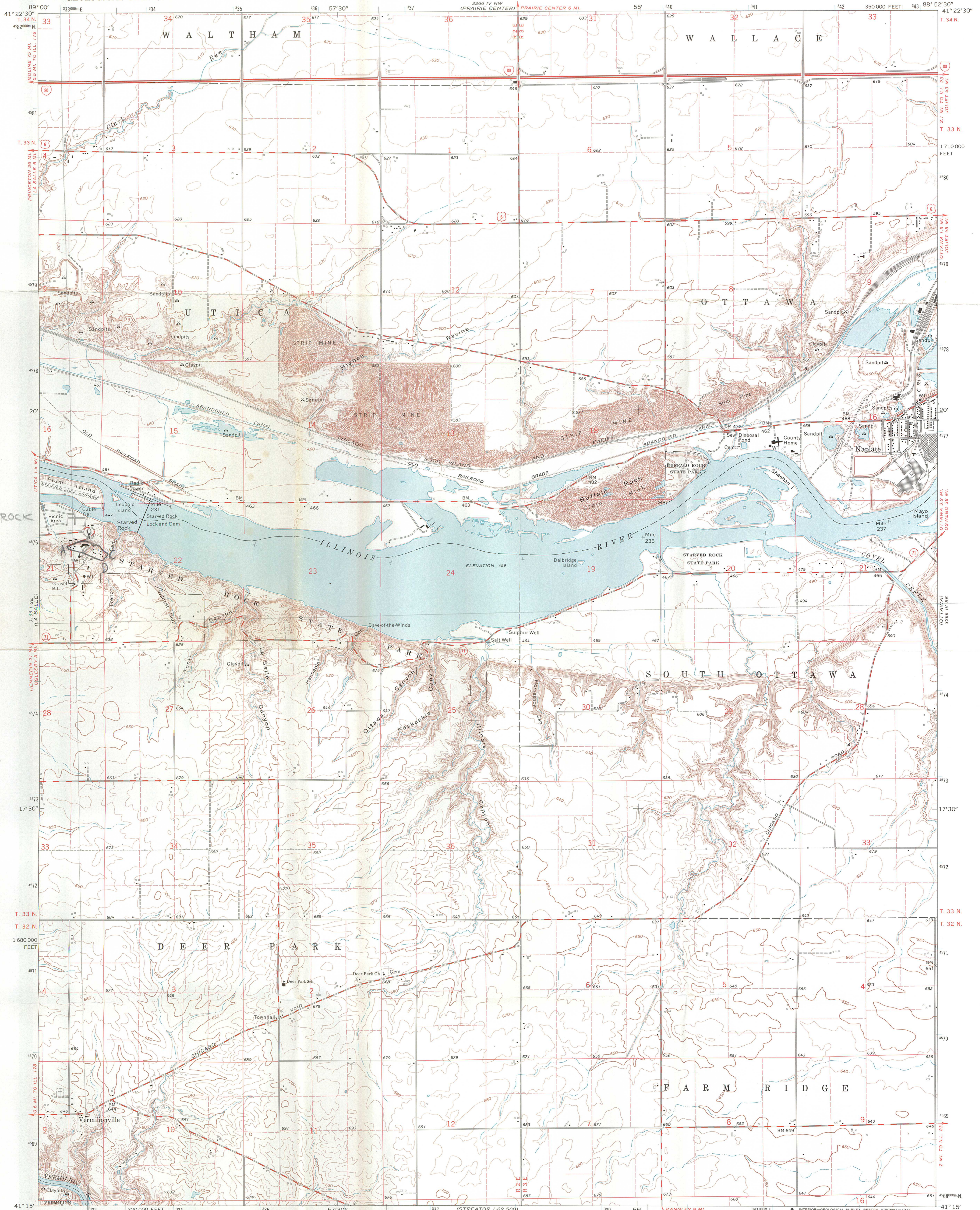

STARVED ROCK  
 A E 332940  
 N 4575880  
 B E 333160  
 N 4575940  
 C E 333400  
 N 4575780  
 D E 333360  
 N 4575720

Mapped, edited, and published by the Geological Survey  
 Control by USGS and USC&GS  
 Topography by photogrammetric methods from aerial  
 photographs taken 1967. Field checked 1970  
 Polyconic projection. 1927 North American datum  
 10,000-foot grid based on Illinois coordinate system, east zone  
 1000-metre Universal Transverse Mercator grid ticks,  
 zone 16, shown in blue  
 Fine red dashed lines indicate selected fence and field lines where  
 generally visible on aerial photographs. This information is unchecked

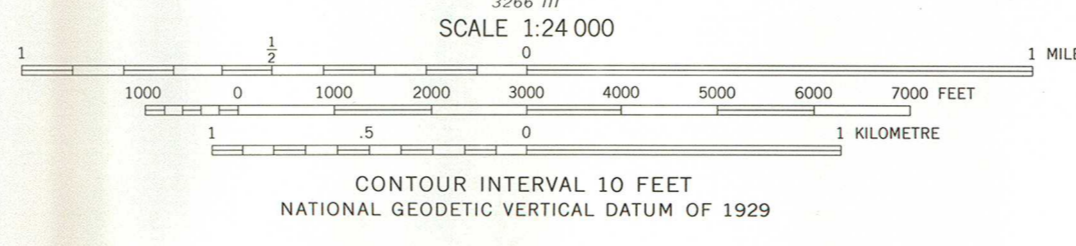

ROAD CLASSIFICATION  
 Primary highway, all weather, improved surface  
 Secondary highway, all weather, hard surface  
 Unimproved road, fair or dry weather  
 Interstate Route  
 U. S. Route  
 State Route

THIS MAP COMPLIES WITH NATIONAL MAP ACCURACY STANDARDS  
 FOR SALE BY U. S. GEOLOGICAL SURVEY, RESTON, VIRGINIA 22092  
 AND BY THE STATE GEOLOGICAL SURVEY, URBANA, ILLINOIS 61801  
 A FOLDER DESCRIBING TOPOGRAPHIC MAPS AND SYMBOLS IS AVAILABLE ON REQUEST

STARVED ROCK, ILL.  
 SW/4 OTTAWA 15' QUADRANGLE  
 N4115-W8852.5/7.5  
 1970  
 AMS 3266 IV SW—SERIES V863

1/29/85

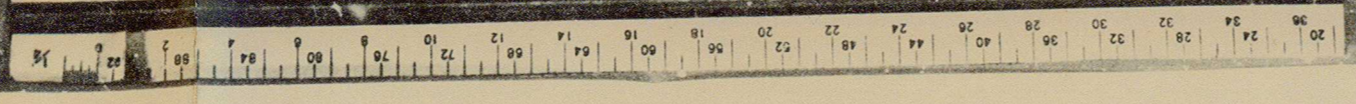

TO STARVED ROCK, DANCE PAVILION,  
MAIN PARKING AREA AND RIVER FRONT

NOTE: ENTIRE AREA HAS TREE COVERAGE WITH BLACK OAK PREDOMINATING HOWEVER, MOST OF TREES ONLY ARE 10-15" AND THE ESTIMATE THAT 80% OF THEM WILL NOT LIVE MORE THAN 10-20 YEARS. IT IS RECOMMENDED THAT 2000 BE PLANTED AMONG EXISTING TREES AND THAT THERE IS HEAVY 50% TO BE PLACED BEHIND EACH LOCATION FOR PROTECTION. NOTE: 5000 CUBIC YD. OF BLACK SANDY LOAM TO BE SCATTERED OVER ENTIRE AREA TO A DEPTH OF 3 TO 4" WHEN THIS IS TO BE SPREAD AND WORKED INTO EXISTING SOIL. ALL PLANTING AND ACCESS TO A LANE TO BE EXCEPTED TO A DEPTH OF 2 TO 18" AND BE PLACED WITH GOOD TOP SOIL.

UPPER TRAIL TO PICNIC AREA AND CANYONS

UPPER TRAIL TO PICNIC AREA AND CANYONS

Trail to be Obliterated

Trail to be Obliterated

PROPERTY LINE

- KEY TO SYMBOLS**
- EXISTING ROCK OUTCROP
  - PROPOSED TRVERSE POINT
  - TREES
  - WO WHITE OAK
  - BO BLACK OAK
  - WP WHITE PINE
  - RO RED CEDAR
  - HAWTHORNE
  - SHEEPBERRY
  - CONTOUR LINE
  - TRAIL STEPS
  - PLANT GROUP
  - GRASS AREA
  - ASPHALT WALK
  - GRAVEL WALK

- KEY TO PLANT LIST**
- 15 CORYLUS COCCINEA
  - 2 CERCIS CANADENSIS
  - 3 JUNIPERUS C. PFITZERIANA
  - 4 VIBURNUM LENTAGUM
  - 5 VIBURNUM DENTATUM
  - 6 VIBURNUM PRUNIFOLIUM
  - 7 AMELANCHIER CANADENSIS
  - 8 RHUS COPALLINA
  - 9 PHYSCARPUS OPULIFOLIUS
  - 10 RHUS CANADENSIS
  - 11 ZANTHOXYLUM AMERICANUM
  - 12 CORNUS PANICULATA
  - 13 SYMPHORICARPUS VULGARIS
  - 14 ROSA SETIGERA
  - 15 ROSA BLANDA
  - 16 LONICERA SEMPERVIRENS
  - 17 AMPELOPSIS QUINQUEFOLIA
  - 18 EUONYMUS RAD VEGETUS
  - 19 EUONYMUS ATROPURPUREUS
  - 20 STAPHYLEA TRIFOLIA
  - 21 CORYLUS AMERICANA
  - 22 LIGUSTRUM I. REGELIANUM
  - 23 RUBUS OCCIDENTALIS
  - 24 SMILAX ROTUNDIFOLIA
  - 25 BERBERIS THUNBERGI
  - 26
  - 27
  - 28 CELTIS OCCIDENTALIS
  - 29 ULMUS AMERICANA
  - 30

SUPERVISION IS AVAILABLE IN THE FIELD FOR THE CORRECT INTERPRETATION OF THIS PLAN. ALL PLANT MATERIAL USED IN THIS PLAN IS HARDY AND MAY BE FOUND GROWING IN THE PARK OR WITHIN ITS ADJACENT VICINITY.

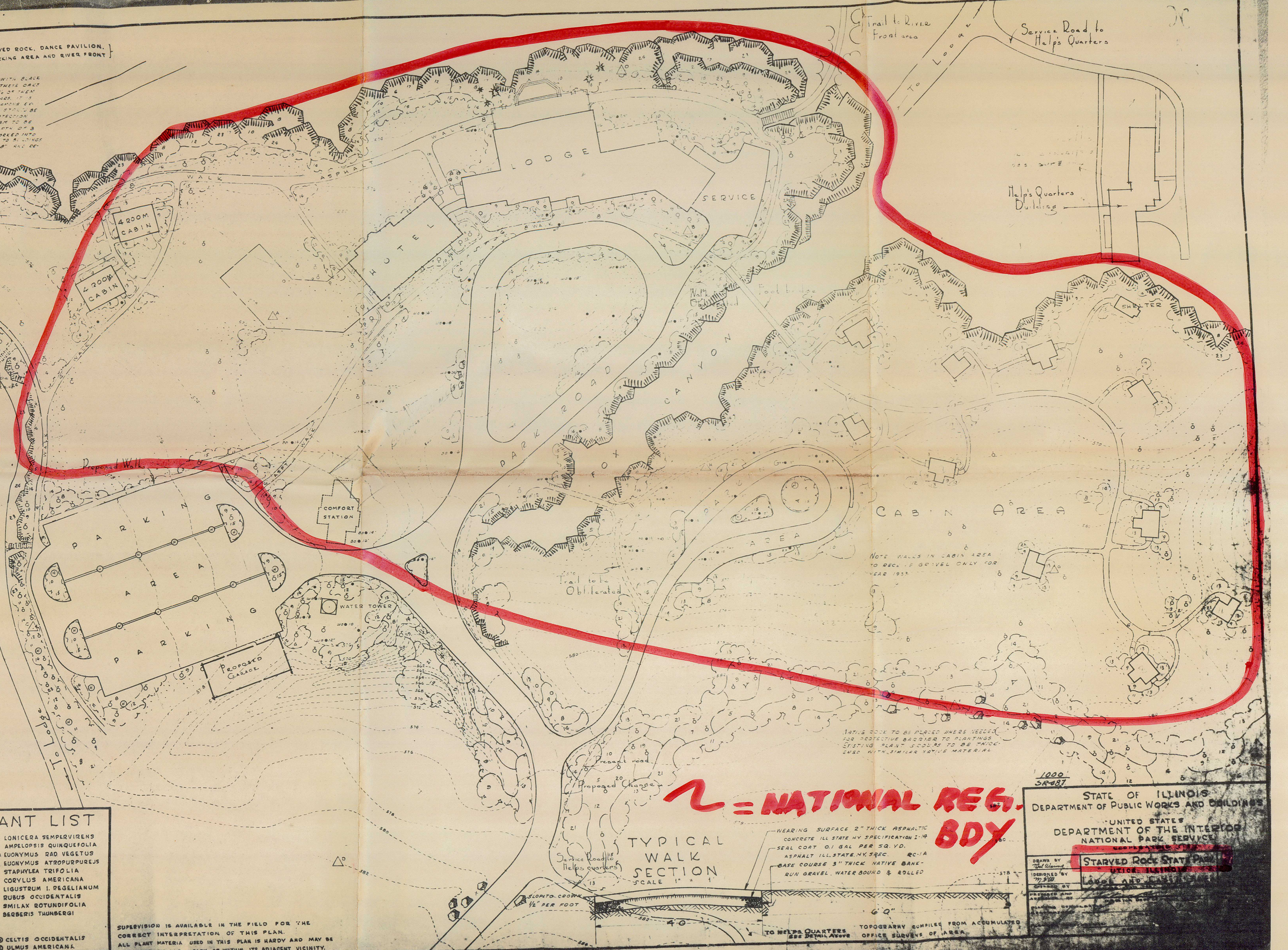

NOTE: WALLS IN CABIN AREA TO BE 1/2" GRVEL ONLY FOR YEAR 1933

1/4" IS ROCK TO BE PLACED WHERE NEEDED FOR PROTECTIVE BARRIER TO PLANTING. EXISTING PLANT SCOUR TO BE THICK ENDS WITH SIMILAR TYPE MATERIAL

**NATIONAL REG. BDY**

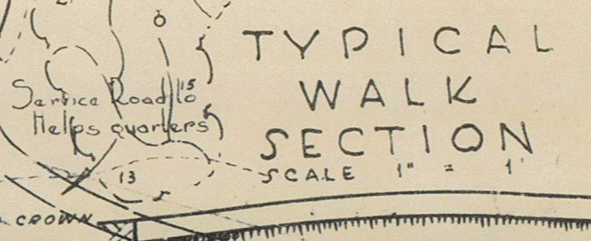

WEARING SURFACE 2" THICK ASPHALT CONCRETE ILL STATE HY SPECIFICATION I-19 SEAL COAT 01 GAL PER SQ. YD. ASPHALT ILL STATE HY SPEC RC-1A BASE COURSE 3" THICK NATIVE BANK-RUN GRAVEL WATER BOUND & ROLLED

STATE OF ILLINOIS DEPARTMENT OF PUBLIC WORKS AND BUILDINGS

UNITED STATES DEPARTMENT OF THE INTERIOR NATIONAL PARK SERVICE

1000 SR-87

DRAWN BY: [Name]

DESIGNED BY: [Name]

CONTROLLED BY: [Name]

PREPARED AND APPROVED BY: [Name]

STARVED ROCK STATE PARK

UTICA, ILLINOIS

LOVELL AND PARTNER

TOPOGRAPHY COMPILED FROM ACCUMULATED OFFICE SURVEYS OF AREA

**STARVED ROCK  
LODGE + CABINS**

A E 332940  
N 4575880

B E 333100  
N 4575940

C E 333400  
N 4575780

D E 333360  
N 4575720

La Salle Co. 12. 17'30"

Illinois State  
Parks Lodge and  
Cabins TR

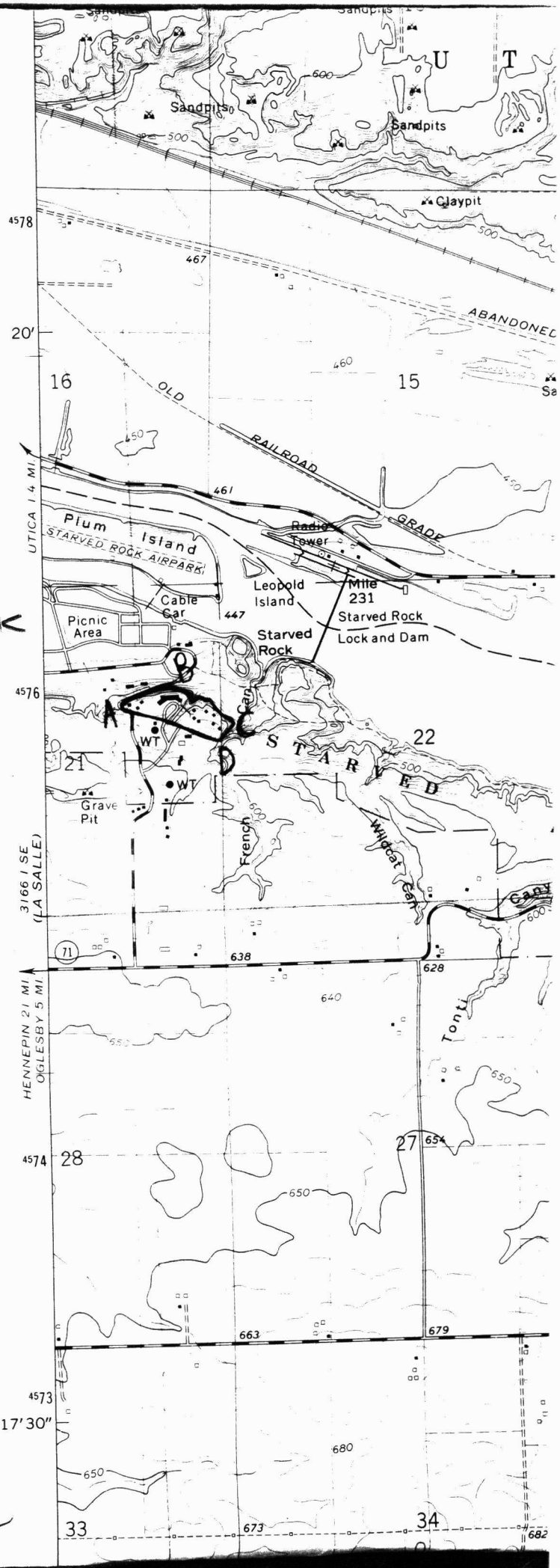

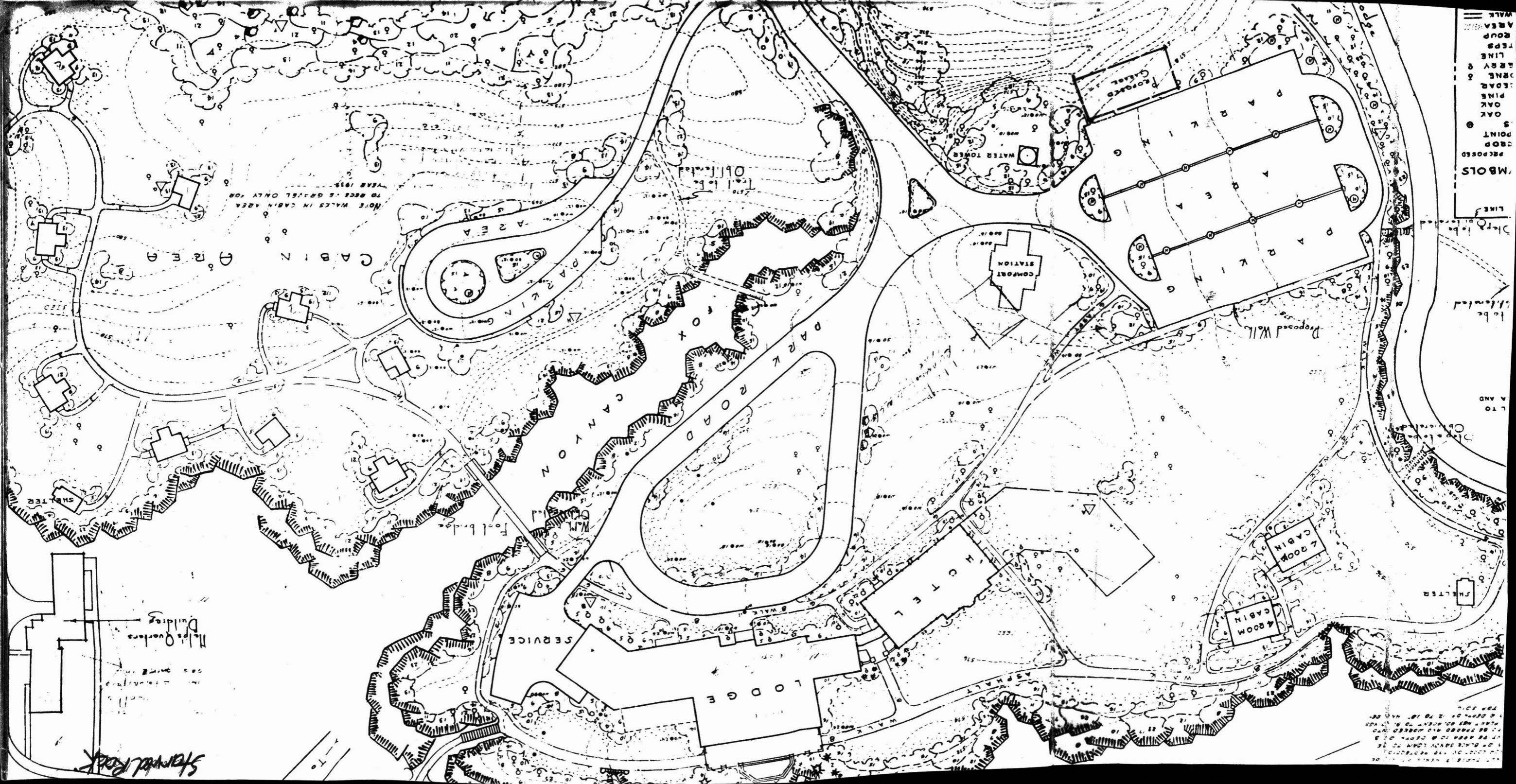

- WALK
- AREA
- GROUP
- TENTS
- LINE
- DRAIN
- SLOPE
- LEAD
- OAK
- PINE
- POINT
- PROPPOSED
- W/BOLTS

NOTE: WALKS IN CABIN AREA TO BE GRAVEL ONLY FOR YEAR 1955

TOP SOIL TO BE REMOVED AT 2 TO 18 IN. AND RE-PLACED WITH SAND AND GRAVEL TO BE PLACED IN 4 IN. LAYERS

Hills Quarters Buildings

Shawnee Rock



## Illinois Historic Preservation Agency

Old State Capitol • Springfield • 62701

April 24, 1986

Richard Henderson  
Department of Interior  
National Park Service  
Washington D.C. 20240

Dear Mr. Henderson:

Enclosed please find the requested information regarding the Starved Rock Lodge and Cabins of the thematic National Register nomination, Illinois State Park Lodges and Cabins.

The information I have provided you with includes a photo copy of the USGS map, UTM references, Starved Rock Lodge and Cabin form, and photos.

Please let me know if I can be of help to you in the future. I do apologize that this transmittal was not more timely.

Sincerely,

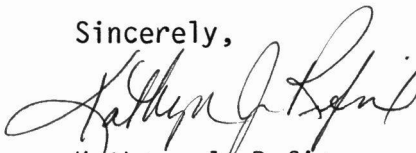

Kathryn J. Refine

*Duplicate*

*never data collected*

APR 29 1986