

**United States Department of the Interior
Heritage Conservation and Recreation Service**

**National Register of Historic Places
Inventory—Nomination Form**

For HCERS use only

received

date entered

Continuation sheet

Schultz Barn

Item number 7 & 8

Page

Section 7 - Description

This 60 foot diameter barn rests on a poured concrete foundation. Verticle wooden siding and asphalt shingles cover the barn. It is distinguished from Illinois' average utilitarian round barn, represented by all others in this nomination, by several architectural amenities: (1) a semi-circular shaped roof, (2) four tranversely located dormers, and (3) ornate cupola. A centrally-located poured concrete silo provides feed from the second floor loft to a ground level manger for cows and horses. Entrance is through doors on the east and west quadrants. The cupola is an estimated 40 feet above grade.

The barn is in excellent condition. It retains all its original building materials, save for the roof shingles, and has no adaptive alterations of the original design.

Section 8 - Significance

This barn is significant as an architecturally distinguished contrast with Illinois' average round barns. In addition, it can be linked directly to the demonstration barns at the University of Illinois to which its owner traveled for the express purpose of seeing those barns. It is noteworthy too, as one of the last round barns built in the state; and, thereby, helps demonstrate the temporal dimension of this type.

History

Matt Diemer had this barn built by a local carpenter, E. J. McCoy (Pontiac) after viewing the barns at the University of Illinois (Schultz to Sculle, 21 May 1981).

OWNER: Raymond Schultz
RR #4
Pontiac, IL. 61764

M.R.A. _____
PROPERTY NO. _____
IN DISTRICT _____
NOT IN DISTRICT _____

(Round Barn in Illinois JTR)

PROPERTY NAME Raymond Schultz Round Barn *S of Pontiac off 4566*
LOCATION T27N, R5E, NW $\frac{1}{4}$, NW $\frac{1}{4}$, CITY/TOWN/VICINITY Pontiac vicinity ✓
✓ COUNTY Livingston (105) sec. 3 STATE IL (012) ZIP _____
ACREAGE less than one U.T.M. REFERENCES see below
VERBAL BOUNDARY DESCRIPTION circular area measuring 80 feet in diameter from
the central point of the barn.
(see attached sketch map)

LOCATION OF LEGAL DESCRIPTION Livingston County Courthouse
County Recorder
Pontiac, IL.

REPRESENTATION IN LOCAL SURVEY(S) None

REPRESENTATION IN OTHER SURVEYS: NHL NR DOE HABS/HAER TI IHSS IHLS
OTHER None

DATE OF CONSTRUCTION 1918 STYLE Round Barn ARCHITECT AND/OR BUILDER:
E.J. McCoy, senior
(Pontiac, IL.)

DESCRIPTION (See attached)

DATE AND NATURE OF ALTERATIONS (IF ANY) (see attached)

DATE OF RELOCATION AND ORIGINAL LOCATION (IF APPLICABLE) Not applicable

SIGNIFICANT OUTBUILDINGS AND/OR OTHER CULTURAL RESOURCES ON PROPERTY (IF APPLICABLE)
(ATTACH SKETCH PLAN OF PROPERTY) Not applicable

UTM COORDINATES: Pontiac, IL Quad. scale: 1:62500 UTM"s not available

80° 39' 41" / 40° 51' N
80° 38' 30" W 40° 50' 46" N 9/22/83 OMB

SIGNIFICANCE (see attached)

Lined area for handwritten notes.

FORM PREPARED BY Keith A. Sculle
National Register Coordinator
Ill. Dept. of Conservation TEL 217) 782-3340

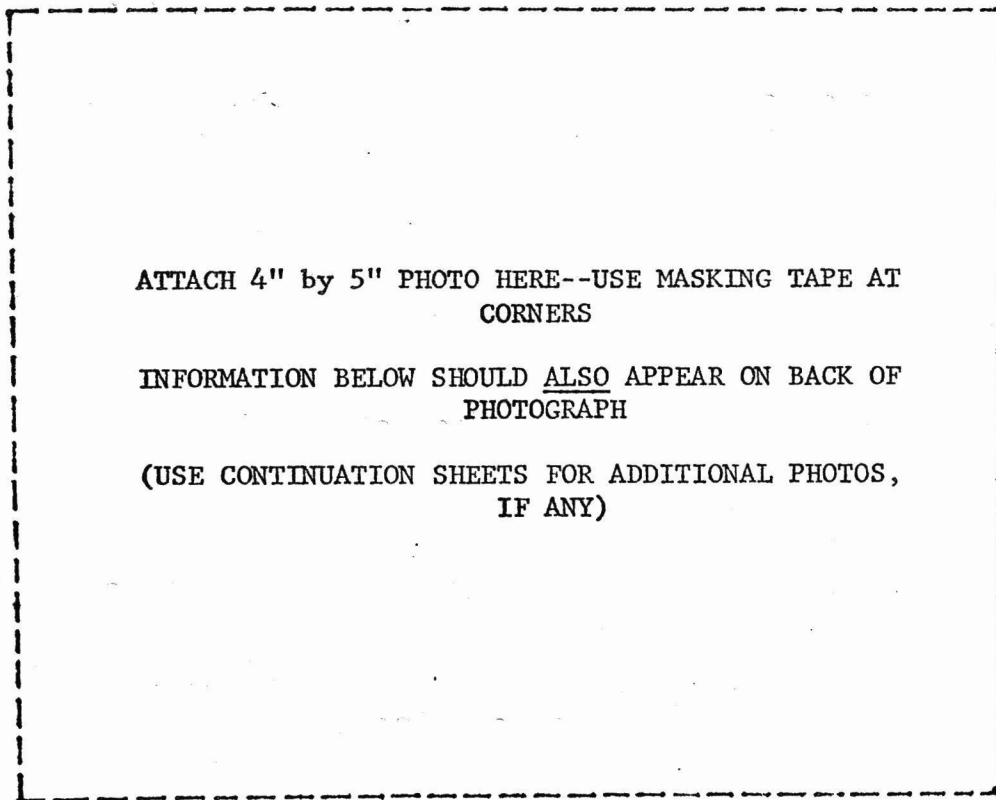

ATTACH 4" by 5" PHOTO HERE--USE MASKING TAPE AT CORNERS

INFORMATION BELOW SHOULD ALSO APPEAR ON BACK OF PHOTOGRAPH

(USE CONTINUATION SHEETS FOR ADDITIONAL PHOTOS, IF ANY)

PHOTO NO. OF . NAME OF PROPERTY VIEW
PHOTOGRAPHER DATE
LOCATION OF NEGATIVE



NOT TO SCALE

COUNTY ROAD

□ FARMHOUSE

○ ROUND BARN

SEC. 3

RAYMOND
SCHULTZ
ROUND
BARN

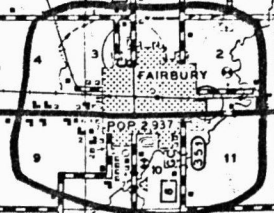
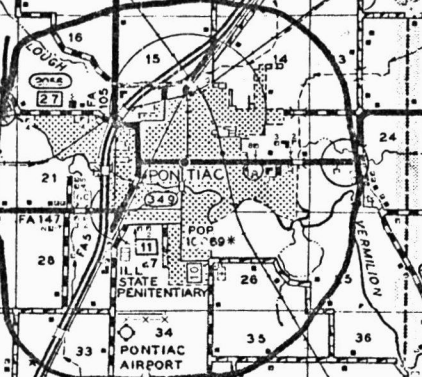
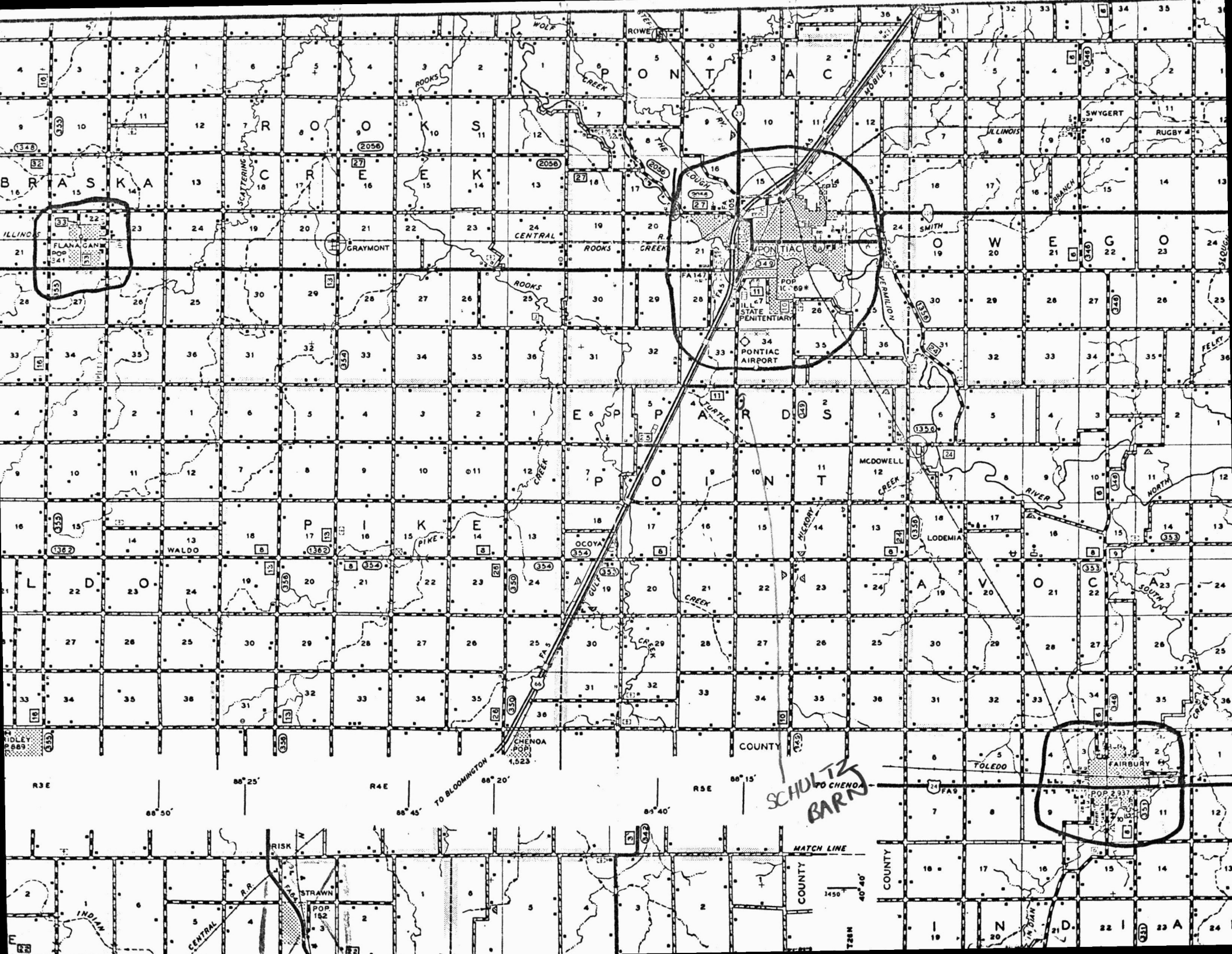

SCHULTZ
TO CHENOA
BARN

MATCH LINE

COUNTY

1450' 40' 40"

R3E

86° 50'

86° 25'

R4E

86° 45'

TO BLOOMINGTON

86° 20'

R5E

86° 15'

84° 40'

COUNTY

TOLEDO

FA9

POP 2 337

FAIRBURY

POP 1 62

STRAWN

B R A S K A

R O O K S

C E N T R A L

P O N T I A C

I L L I N O I S

S W Y G E R T

R U G B Y

E P P

J U R T L E

P O I N T

M C D O W E L L

L O D E M I A

N O R T H

L D O

W A L D O

P I K E

O C O Y A

M E K O Y N

A V O

S O U T H

W A L D O

869

835

835

835

835

835

835

835

835

835

E 63

835

835

835

835

835

835

835

835

835

INDIAN

CENTRAL

R.R.

STRAWN

POP. 162

835

835

835

835

835

INDIAN

CENTRAL

R.R.

STRAWN

POP. 162

835

835

835

835

835

INDIAN

CENTRAL

R.R.

STRAWN

POP. 162

835

835

835

835

835

United States Department of the Interior
National Park Service

National Register of Historic Places
Inventory—Nomination Form

For NPS use only
received
date entered

1982

Continuation sheet

Item number

Page

Multiple Resource Area
Thematic Group

dnr-11

Name Round Barns in Illinois Thematic Resources
State Illinois

Nomination/Type of Review

Date/Signature

1. Kleinkopf, Clarence, Round Barn

Entered in the
National Register

for Keeper Delores Byers 8/26/82

Attest

2. Forehand, Clarence, Round Barn

Keeper Bob Grosvenor 12/7/82

Attest

3. Tillery, Virginia, Round Barn
82002536

for Keeper Delores Byers 8/26/82

Attest

4. Schultz, Raymond, Round Barn

for Keeper Delores Byers 8/26/82

Attest

5. George, Ron, Round Barn

Substantive Review

Keeper Bob Grosvenor - 12/7/82

Attest

6. McCarty, John, Round Barn

Entered in the
National Register

Keeper Delores Byers 12/7/82

Attest

7. White, Willard, Round Barn

DOE/OWNER OBJECTION

Keeper TYS

Attest

8. Buckles, Robert, Barn

Substantive Review

Keeper Linda McClelland 2/10/83

Attest

9. Lewis Round Barn

Entered in the
National Register

for Keeper Delores Byers 8/10/84

Attest

10.

Keeper

Attest

United States Department of the Interior
National Park Service

82002582

Schultz, Raymond, Round Barn (Round Barns in Illinois TR), Livingston County, ILLINOIS,

Working No. 7/12/82-1960

Fed. Reg. Date: 2.1.83

Date Due: 8/12/82 - 8/26/82

Action: ACCEPT 8/26/82

Entered in the RETURN

National Register REJECT

Federal Agency: _____

- resubmission
- nomination by person or local government
- owner objection
- appeal

Substantive Review: sample request appeal NR decision

Reviewer's comments:

vhd. ok LMC 8/25/82

Recom./Criteria Accept

Reviewer _____

Discipline _____

Date _____

see continuation sheet

Nomination returned for: technical corrections cited below
 substantive reasons discussed below

1. Name

2. Location

3. Classification

Category	Ownership	Status	Present Use
	Public Acquisition	Accessible	

4. Owner of Property

5. Location of Legal Description

6. Representation in Existing Surveys

has this property been determined eligible? yes no

7. Description

Condition	Check one	Check one
<input type="checkbox"/> excellent	<input type="checkbox"/> deteriorated	<input type="checkbox"/> original site
<input type="checkbox"/> good	<input type="checkbox"/> ruins	<input type="checkbox"/> altered
<input type="checkbox"/> fair	<input type="checkbox"/> unexposed	<input type="checkbox"/> moved date _____

Describe the present and original (if known) physical appearance

- summary paragraph
- completeness
- clarity
- alterations/integrity
- dates
- boundary selection

8. Significance

Period _____ Areas of Significance—Check and justify below

Specific dates _____ Builder/Architect _____

Statement of Significance (in one paragraph)

- _____ summary paragraph
- _____ completeness
- _____ clarity
- _____ applicable criteria
- _____ justification of areas checked
- _____ relating significance to the resource
- _____ context
- _____ relationship of integrity to significance
- _____ justification of exception
- _____ other

9. Major Bibliographical References

10. Geographical Data

Acreage of nominated property _____

Quadrangle name _____

UMT References _____

Verbal boundary description and justification _____

11. Form Prepared By

12. State Historic Preservation Officer Certification

The evaluated significance of this property within the state is:

_____ national _____ state _____ local

State Historic Preservation Officer signature _____

title _____ date _____

13. Other

- _____ Maps
- _____ Photographs
- _____ Other

Questions concerning this nomination may be directed to _____

Signed _____ Date _____ Phone: 202 272 - 3504

Comments for any item may be continued on an attached sheet



SCHULTZ ROUND BARN

Pontiac, IL. vicinity

Keith A. Sculle

May 1981

Ill. Dept. Conservation

405 E. Washington, Springfield, IL.

62706

Camera pointing southeast

1 of 1

UNITED STATES
DEPARTMENT OF THE INTERIOR
GEOLOGICAL SURVEY

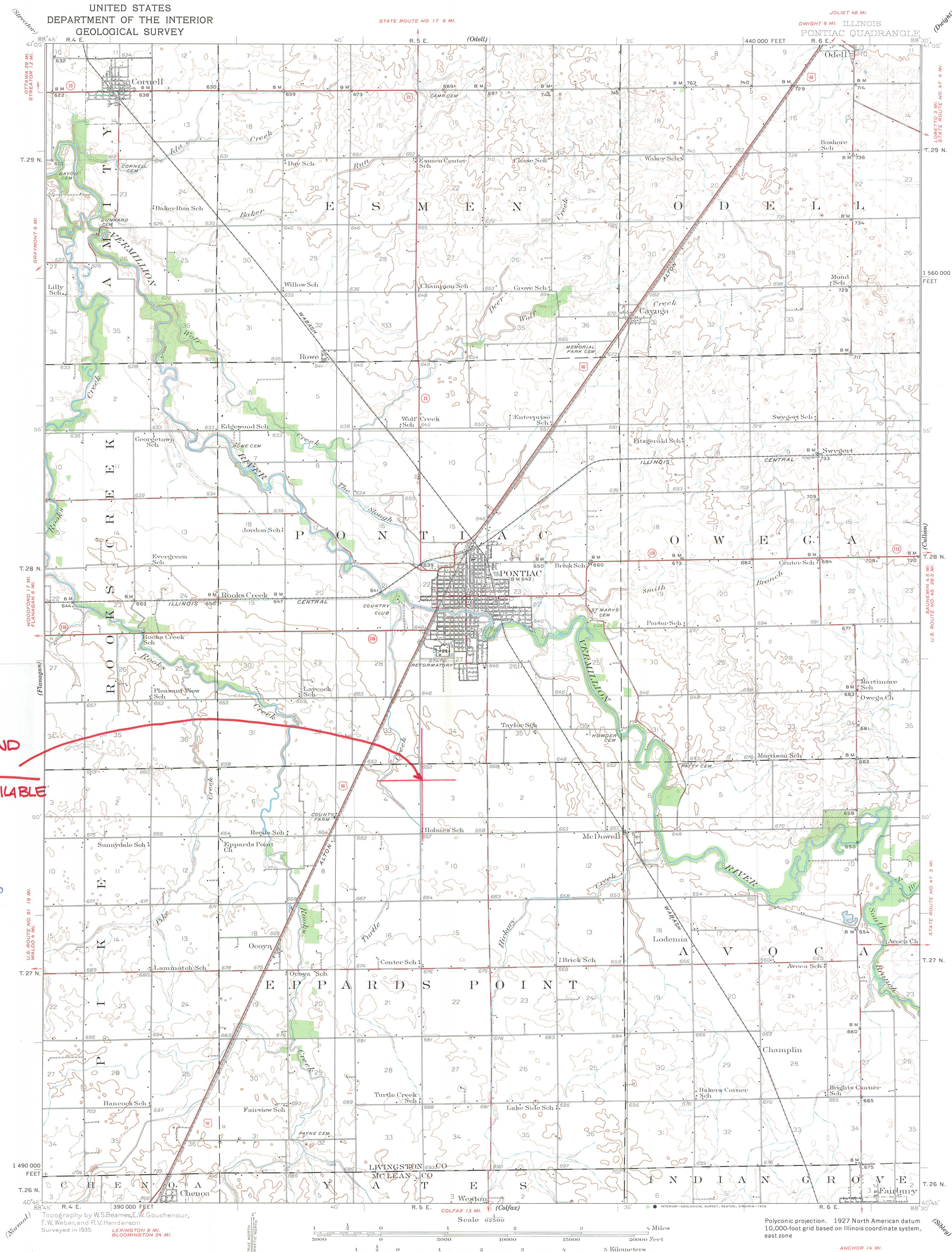

SCHULTZ ROUND BARN

UTM NOT AVAILABLE

38° 30' E

80° 39' W

40° 51' N

50 46' N

16/361595/4522190