

## Missing Core Documentation

**Property Name**

Calico Rock Historic District  
(Boundary Increase)

**County, State**

Izard, Arkansas

**Reference Number**

88002827

The following Core Documentation is missing from this entry:

Nomination Form (Partial)

Photographs

USGS Map

2827

United States Department of the Interior  
National Park Service

RECEIVED

NOV 8 1988

NATIONAL  
REGISTER

# National Register of Historic Places Continuation Sheet

Section number 7 Page 1

## Physical description

The River View Hotel is a rectangular, two-story pattern concrete block structure covered with an asphalt shingle, hipped roof with a ridge and rafters with exposed ends; the southern two-story porch is covered with a simple shed roof of an angle slightly at variance with the main roof pitch. The eastern or front elevation features the closed-in porch to the south, the wooden second story porch with balustrade (originally cover-ed) supported on four concrete piers, with three first story entrances placed symmet-rically beneath the balcony and one on the second story opening onto the balcony. Nine original five-over-one wooden double-hung sash windows light the second story, and seven light the first; all are of the same size, with the sole exception of the southern-most in the main building, which lights the lobby, and is therefore larger. The northern elevation is composed of two centrally-placed entrances on each floor, with a window on either side of the same configuration as on the eastern elevation. A simple transom surmounts the first floor entrance, while the second floor entrance, now filled with a window, led out to a wooden fire escape that was added in 1983. The western elevation faces out onto a hillside and retaining wall, and is composed entirely of evenly-spaced windows (one for each of the interior rooms) with the exception of the central first story entrance. There are two chimneys, one at the southern end of the western side of the ridge, and one near the center to the east. There have been several alterations, though none of them drastic. The southern elevation's two-story porch, composed entirely of windows except for the central entry on the first floor, was originally open (as shown by historic photographs), and was closed-in in the 1940's. It was at this time also that the roof was removed from the eastern porch, and the slate roof was replaced with shingles. Since the 1960's the original hotel rooms were remodeled into apartments, and the storm doors and windows were added.

The landscaping around the building features terracing, steps, and retaining walls, all constructed of the same pattern concrete block as the building, and are original to it.

## Boundaries

The River View Hotel and associated property are being added to the Calico Rock Historic District by virtue of new information regarding the date and original use of this building that has been provided by the owner since the original District was surveyed.

*Cathryn H. Buford*  
 \_\_\_\_\_  
 State Historic Preservation Officer

*11-1-88*  
 \_\_\_\_\_  
 Date

United States Department of the Interior  
National Park Service

# National Register of Historic Places Continuation Sheet

RECEIVED

NOV 8 1988

Section number 8 Page 1

NATIONAL  
REGISTER

---

Statement of Significance

The River View Hotel stands to the west of and contiguous to the Calico Rock Historic District (listed 11/19/85). It dates from the second period of building in Calico Rock, which occurred after the fire of 1923, destroyed the bulk of the downtown commercial area that developed after the construction of the St. Louis and Iron Mountain Railroad in 1903. In its function as a hotel, this building served the abundant commercial traffic that occurred in Calico Rock during its rise as a river and railroad transportation hub, and also shares in the architectural character of the neighboring commercial district by virtue of its plain masonry construction and lack of any distinguishable architectural style. It contributes to the district's significance as an intact, early twentieth century commercial and transportation center in northern Arkansas, and is therefore being amended to it.

United States Department of the Interior  
National Park Service

RECEIVED

National Register of Historic Places  
Continuation Sheet

NOV 8 1988

NATIONAL  
REGISTERSection number 10 Page 1

Acreage: 2.5 acres

Quadrangle name: Calico Rock, 1964, 7.5'

Quadrangle scale: 1:24000

UTM: A) 15 577060 3997070  
B) 15 577210 3997085  
C) 15 577215 3997005  
D) 15 577060 3997035

## Verbal Boundary Description and Justification (as amended):

The Calico Rock Historic District, its structures oriented along Main Street running one block north and south, begins at the intersection of Rodman and Main Streets. The northern edge of Rodman Street forms the south border of the district on the west side of Main Street for one block, to the point where Rodman Street turns north. At this point the boundary proceeds westerly, across Rodman Street, to the point of intersection with the perpendicular line formed by the western edge of Rodman Street. The boundary then proceeds southerly along the eastern boundary of the amended property to the point of intersection with the railroad right of way, thence proceeds westerly along said right of way to intersection with perpendicular line formed by continuous western edge of Lots 1 and 2, thence proceeds northerly along said boundary to intersection with southern edge of South Main Street, thence proceeds easterly to intersection with eastern edge of Rodman Street. The boundary thence proceeds northerly along Rodman Street to intersection with perpendicular line formed by northern boundary of the Sharp Realty Building (CR-6), which also forms the northern boundary of the district. The north border continues across Main Street to Walnut Street and runs along the south side of the street one lot deep. The district line turns south and Peppersauce Alley forms the eastern border of the block. Peppersauce Alley then turns west and forms the southern border East of Main Street concluding the southern border to the beginning. These new boundaries include a physically contiguous historically associated with the original historic district, but not included earlier due to its location one block from Main Street itself.

The legal description of the amended property is Lots 1 and 2, Stoner's Block, Stoner's Addition, City of Calico Rock.

UNITED STATES DEPARTMENT OF THE INTERIOR  
NATIONAL PARK SERVICE

NATIONAL REGISTER OF HISTORIC PLACES  
EVALUATION/RETURN SHEET

REQUESTED ACTION: NOMINATION

PROPERTY NAME: Calico Rock Historic District (Boundary Increase)

MULTIPLE NAME:

STATE & COUNTY: ARKANSAS, Izard

DATE RECEIVED: 11/08/88      DATE OF PENDING LIST: 11/22/88  
DATE OF 16TH DAY: 12/08/88      DATE OF 45TH DAY: 12/23/88  
DATE OF WEEKLY LIST:

REFERENCE NUMBER: 88002827

NOMINATOR: STATE

REASONS FOR REVIEW:

APPEAL: N    DATA PROBLEM: N    LANDSCAPE: N    LESS THAN 50 YEARS: N  
OTHER: N    PDIL: N    PERIOD: N    PROGRAM UNAPPROVED: N  
REQUEST: N    SAMPLE: N    SLR DRAFT: N

COMMENT WAIVER: N

ACCEPT     RETURN     REJECT    12/13/88 DATE

ABSTRACT/SUMMARY COMMENTS:

*Please provide a sketch map to scale showing old and new boundaries*

RECOM./CRITERIA \_\_\_\_\_  
REVIEWER \_\_\_\_\_  
DISCIPLINE \_\_\_\_\_  
DATE \_\_\_\_\_

DOCUMENTATION see attached comments Y/N see attached SLR Y/N

CLASSIFICATION

     count                 resource type

STATE/FEDERAL AGENCY CERTIFICATION

FUNCTION

     historic                 current

DESCRIPTION

     architectural classification  
     materials  
     descriptive text

SIGNIFICANCE

Period            Areas of Significance--Check and justify below

Specific dates                            Builder/Architect  
Statement of Significance (in one paragraph)

     summary paragraph  
     completeness  
     clarity  
     applicable criteria  
     justification of areas checked  
     relating significance to the resource  
     context  
     relationship of integrity to significance  
     justification of exception  
     other

BIBLIOGRAPHY

GEOGRAPHICAL DATA

     acreage                 verbal boundary description  
     UTMs                     boundary justification

ACCOMPANYING DOCUMENTATION/PRESENTATION

sketch maps         USGS maps         photographs         presentation

OTHER COMMENTS

Questions concerning this nomination may be directed to

Phone 202-343-9553

Signed *Dr. Byus*

Date 12/13/88

2827

United States Department of the Interior  
National Park Service

RECEIVED

NOV 8 1988

NATIONAL REGISTER

National Register of Historic Places  
Continuation Sheet

Section number 7 Page 1

Physical description

The River View Hotel is a rectangular, two-story pattern concrete block structure covered with an asphalt shingle, hipped roof with a ridge and rafters with exposed ends; the southern two-story porch is covered with a simple shed roof of an angle slightly at variance with the main roof pitch. The eastern or front elevation features the closed-in porch to the south, the wooden second story porch with balustrade (originally cover-ed) supported on four concrete piers, with three first story entrances placed symmet-rically beneath the balcony and one on the second story opening onto the balcony. Nine original five-over-one wooden double-hung sash windows light the second story, and seven light the first; all are of the same size, with the sole exception of the southern-most in the main building, which lights the lobby, and is therefore larger. The northern elevation is composed of two centrally-placed entrances on each floor, with a window on either side of the same configuration as on the eastern elevation. A simple transom surmounts the first floor entrance, while the second floor entrance, now filled with a window, led out to a wooden fire escape that was added in 1983. The western elevation faces out onto a hillside and retaining wall, and is composed entirely of evenly-spaced windows (one for each of the interior rooms) with the exception of the central first story entrance. There are two chimneys, one at the southern end of the western side of the ridge, and one near the center to the east. There have been several alterations, though none of them drastic. The southern elevation's two-story porch, composed entirely of windows except for the central entry on the first floor, was originally open (as shown by historic photographs), and was closed-in in the 1940's. It was at this time also that the roof was removed from the eastern porch, and the slate roof was replaced with shingles. Since the 1960's the original hotel rooms were remodeled into apartments, and the storm doors and windows were added.

The landscaping around the building features terracing, steps, and retaining walls, all constructed of the same pattern concrete block as the building, and are original to it.

Boundaries

The River View Hotel and associated property are being added to the Calico Rock Historic District by virtue of new information regarding the date and original use of this building that has been provided by the owner since the original District was surveyed.

Cathryn H. Buford  
State Historic Preservation Officer

11-1-88  
Date

United States Department of the Interior  
National Park Service

# National Register of Historic Places Continuation Sheet

RECEIVED

NOV 8 1988

NATIONAL  
REGISTER

Section number 8 Page 1

---

## Statement of Significance

The River View Hotel stands to the west of and contiguous to the Calico Rock Historic District (listed 11/19/85). It dates from the second period of building in Calico Rock, which occurred after the fire of 1923, destroyed the bulk of the downtown commercial area that developed after the construction of the St. Louis and Iron Mountain Railroad in 1903. In its function as a hotel, this building served the abundant commercial traffic that occurred in Calico Rock during its rise as a river and railroad transportation hub, and also shares in the architectural character of the neighboring commercial district by virtue of its plain masonry construction and lack of any distinguishable architectural style. It contributes to the district's significance as an intact, early twentieth century commercial and transportation center in northern Arkansas, and is therefore being amended to it.

**United States Department of the Interior  
National Park Service**

**National Register of Historic Places  
Continuation Sheet**

RECEIVED

NOV 8 1988

NATIONAL  
REGISTER

Section number 10 Page 1

---

Acreage: 2.5 acres

Quadrangle name: Calico Rock, 1964, 7.5'

Quadrangle scale: 1:24000

UTM: A) 15 577060 3997070  
B) 15 577210 3997085  
C) 15 577215 3997005  
D) 15 577060 3997035

Verbal Boundary Description and Justification (as amended):

The Calico Rock Historic District, its structures oriented along Main Street running one block north and south, begins at the intersection of Rodman and Main Streets. The northern edge of Rodman Street forms the south border of the district on the west side of Main Street for one block, to the point where Rodman Street turns north. At this point the boundary proceeds westerly, across Rodman Street, to the point of intersection with the perpendicular line formed by the western edge of Rodman Street. The boundary then proceeds southerly along the eastern boundary of the amended property to the point of intersection with the railroad right of way, thence proceeds westerly along said right of way to intersection with perpendicular line formed by continuous western edge of Lots 1 and 2, thence proceeds northerly along said boundary to intersection with southern edge of South Main Street, thence proceeds easterly to intersection with eastern edge of Rodman Street. The boundary thence proceeds northerly along Rodman Street to intersection with perpendicular line formed by northern boundary of the Sharp Realty Building (CR-6), which also forms the northern boundary of the district. The north border continues across Main Street to Walnut Street and runs along the south side of the street one lot deep. The district line turns south and Peppersauce Alley forms the eastern border of the block. Peppersauce Alley then turns west and forms the southern border East of Main Street concluding the southern border to the beginning. These new boundaries include a physically contiguous historically associated with the original historic district, but not included earlier due to its location one block from Main Street itself.

The legal description of the amended property is Lots 1 and 2, Stoner's Block, Stoner's Addition, City of Calico Rock.

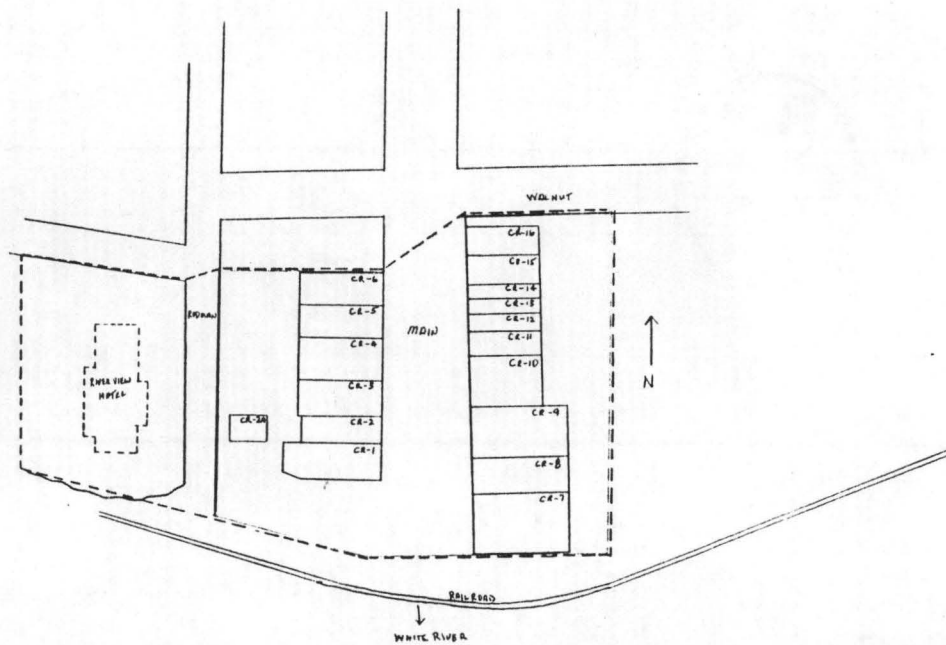

LEAD COUNTY: CALICO ROCK HISTORIC DISTRICT  
 ———: INDICATES EXISTING HISTORIC DISTRICT BOUNDARIES  
 - - - - : INDICATES AMENDED BOUNDARIES TO HISTORIC DISTRICT TO INCLUDE RIVER VIEW HOTEL  
 SCALE: 1" = 50'-0"

AR

UNITED STATES DEPARTMENT OF THE INTERIOR  
NATIONAL PARK SERVICE

NATIONAL REGISTER OF HISTORIC PLACES  
EVALUATION/RETURN SHEET

REQUESTED ACTION: RESUBMISSION

PROPERTY NAME: Calico Rock Historic District (Boundary Increase)

MULTIPLE NAME:

STATE & COUNTY: ARKANSAS, Izard

DATE RECEIVED: 10/16/89      DATE OF PENDING LIST:  
DATE OF 16TH DAY:                      DATE OF 45TH DAY: 11/30/89  
DATE OF WEEKLY LIST:

REFERENCE NUMBER: 88002827

NOMINATOR: STATE

DETAILED EVALUATION: N

ACCEPT       RETURN       REJECT      10/26/89 DATE

ABSTRACT/SUMMARY COMMENTS:

RECOM./CRITERIA \_\_\_\_\_  
REVIEWER \_\_\_\_\_  
DISCIPLINE \_\_\_\_\_  
DATE \_\_\_\_\_

DOCUMENTATION see attached comments Y/N see attached SLR Y/N

---

CLASSIFICATION

count       resource type

---

STATE/FEDERAL AGENCY CERTIFICATION

---

FUNCTION

historic       current

---

DESCRIPTION

architectural classification  
 materials  
 descriptive text

---

SIGNIFICANCE

Period      Areas of Significance--Check and justify below

Specific dates      Builder/Architect  
Statement of Significance (in one paragraph)

summary paragraph  
 completeness  
 clarity  
 applicable criteria  
 justification of areas checked  
 relating significance to the resource  
 context  
 relationship of integrity to significance  
 justification of exception  
 other

---

BIBLIOGRAPHY

---

GEOGRAPHICAL DATA

acreage       verbal boundary description  
 UTMS       boundary justification

---

ACCOMPANYING DOCUMENTATION/PRESENTATION

sketch maps       USGS maps       photographs       presentation

---

OTHER COMMENTS

Questions concerning this nomination may be directed to

\_\_\_\_\_ Phone \_\_\_\_\_

Signed \_\_\_\_\_ Date \_\_\_\_\_

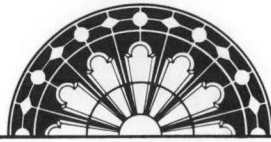

ARKANSAS  
HISTORIC  
PRESERVATION  
PROGRAM

October 11, 1989

Carol D. Shull  
Chief of Registration  
United States Department of the Interior  
National Register of Historic Places  
National Park Service  
1100 "L" Street, N.W.  
Washington, D.C. 20240

OCT 16 1989

RE: Amendment to the Calico Rock  
Historic District  
Calico Rock - Izard County, Arkansas

Dear Carol:

We are enclosing for your review the nomination for the Amendment to the Calico Rock Historic District. The Arkansas Historic Preservation Program has complied with all applicable nominating procedures and notification requirements in the nomination process.

Thank you for your consideration in this matter.

Sincerely,

Cathy Buford  
State Historic Preservation Officer

CB/KS/lss

Enclosures



**INSERT  
PHOTOS**



RIVER VIEW HOTEL  
Calico Rock Historic District  
Calico Rock, IZARD Co.  
Photographed by T. Jones  
February 1988  
Negatives on file at AHPP

W. H. H.



RIVERVIEW HOTEL  
Calico Rock Historic District  
Calico Rock, Izard Co.  
Photographed by T. Jones  
February 1988  
Negatives on file at AHPP

11/1/88

7556 II SW  
INORFORK

UNITED STATES  
DEPARTMENT OF THE INTERIOR  
GEOLOGICAL SURVEY

Calico Rock Historic District (As Amended)  
Calico Rock, Arkansas  
Izard County  
A) 15/577060/3997070 B) 15/577210/3997085  
C) 15/577215/3997005 D) 15/577060/3997035  
Calico Rock Quadrangle  
1:24000

CALICO ROCK QUADRANGLE  
ARKANSAS  
7.5 MINUTE SERIES (TOPOGRAPHIC)

7556 II SW  
INORFORK

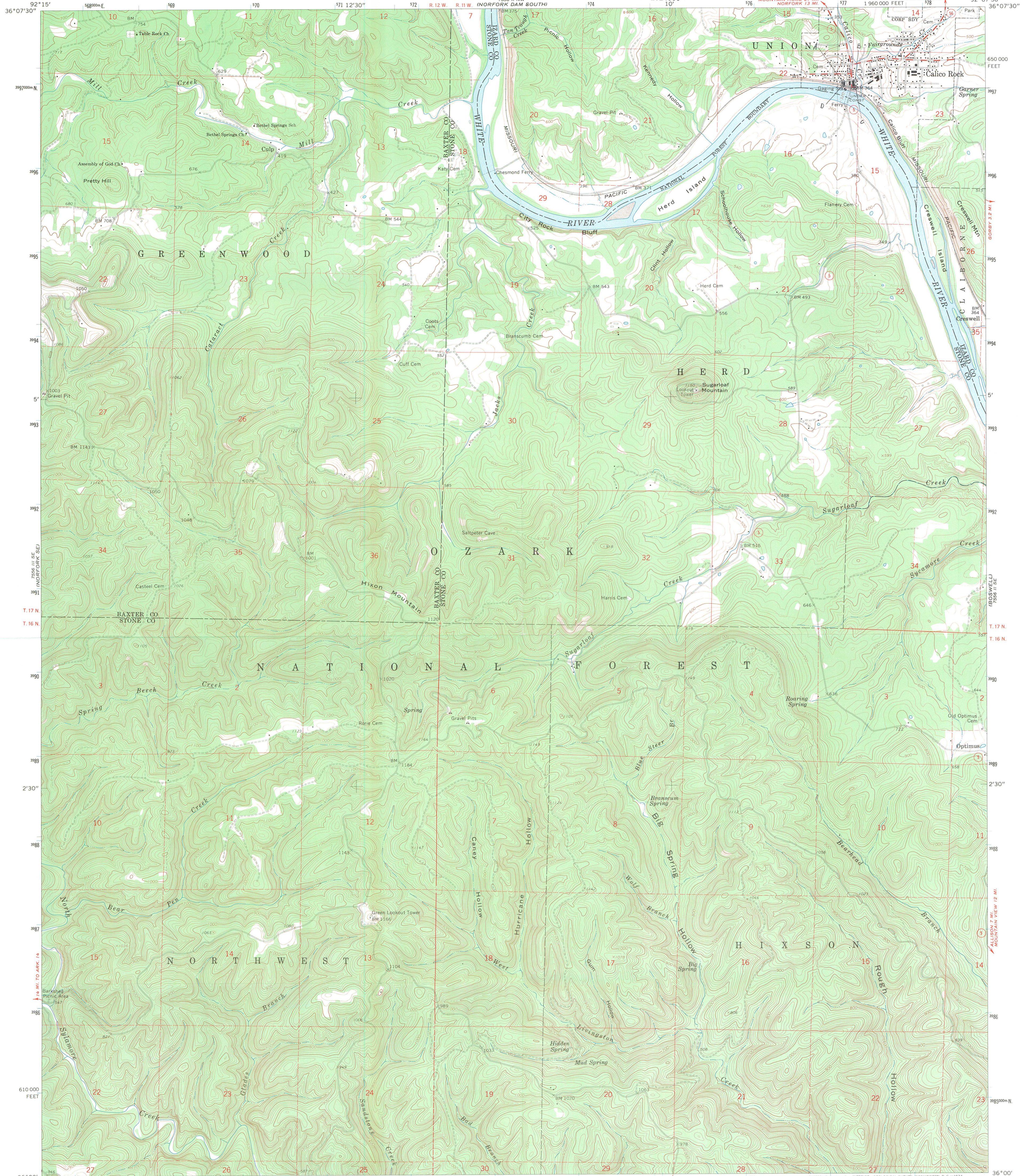

Mapped, edited, and published by the Geological Survey  
Control by USGS, USC&GS, and USCE  
Topography by photogrammetric methods from aerial  
photographs taken 1959. Field checked 1964  
Polyconic projection. 1927 North American datum  
10,000-foot grid based on Arkansas coordinate system, north zone  
1000-meter Universal Transverse Mercator grid ticks,  
zone 15, shown in blue  
Fine red dashed lines indicate selected fence and field lines where  
generally visible on aerial photographs. This information is unchecked

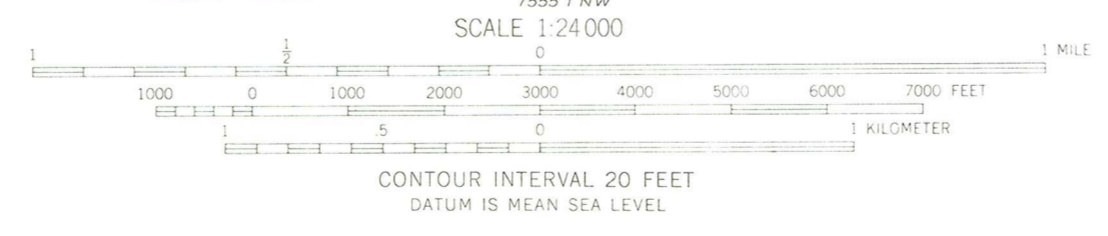
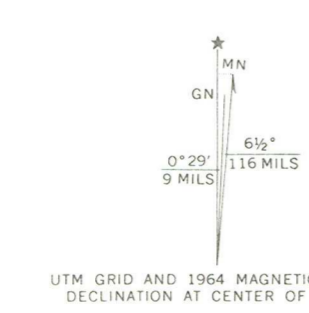

ROAD CLASSIFICATION  
Medium-duty ——— Light-duty ———  
Unimproved dirt - - - - -  
State Route ○

THIS MAP COMPLIES WITH NATIONAL MAP ACCURACY STANDARDS  
FOR SALE BY U.S. GEOLOGICAL SURVEY, DENVER, COLORADO 80225, OR WASHINGTON, D. C. 20242  
AND BY THE ARKANSAS GEOLOGICAL COMMISSION, LITTLE ROCK, ARKANSAS 72201  
A FOLDER DESCRIBING TOPOGRAPHIC MAPS AND SYMBOLS IS AVAILABLE ON REQUEST

CALICO ROCK, ARK.  
N3600—W9207.5/7.5  
1964

AMS 7556 II SW—SERIES V884